



LAKE MONONA

City of Madison
Department of Public Works
PARKS DIVISION
330 E Lakeside St.
Madison, WI 53715

play
**MADISON
PARKS**

Graphical Scale
0 30



PROJECT:

***346 E LAKESIDE ST
DEMOLITION***

PROJECT ADDRESS:

***OLIN PARK
346 E LAKESIDE ST***

Although every effort has been made in preparing these plans and checking them for accuracy, the contractor and subcontractors must check all details and dimensions of their trade and be responsible for the same.

ITEM	DATE
<i>DRAWN BY: IW</i>	<i>07-07-2025</i>

PUBLIC WORKS PROJECT #:

SHEET TITLE:

EXISTING CONDITONS

SHEET NUMBER:

1.0

NOTE: ALL DISTURBED AREAS WILL BE REPLACED WITH TOPSOIL, SEED, AND MULCH UNLESS SPECIFIED OTHERWISE. THE PROPOSED AREA OF DISTURBANCE IS APPROX. 3,900 SQ. FT.

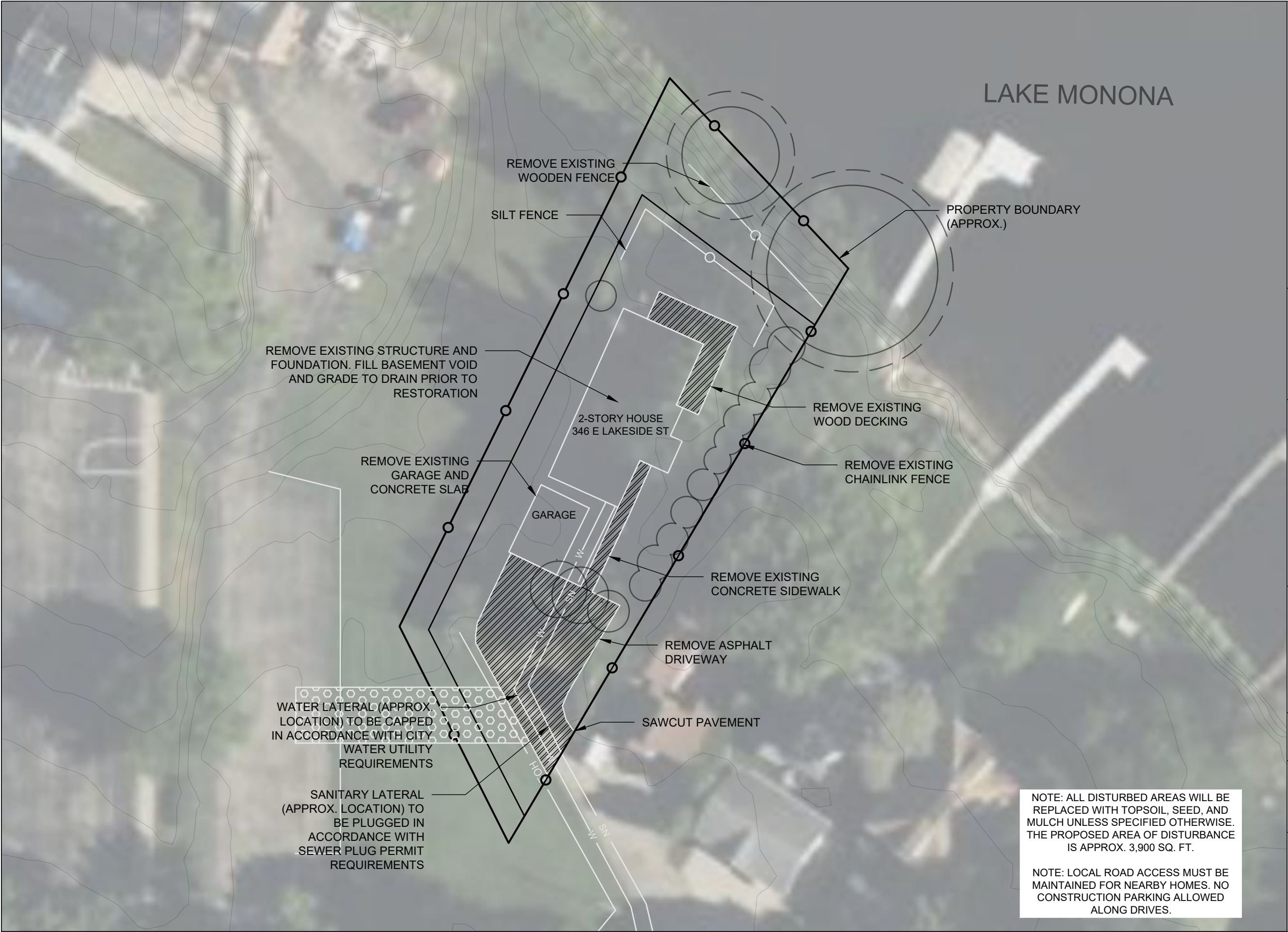

City of Madison
Department of Public Works
PARKS DIVISION
330 E Lakeside St.
Madison, WI 53715

play
**MADISON
PARKS**

Graphical Scale
0 30



PROJECT:

**346 E LAKESIDE ST
DEMOLITION**

PROJECT ADDRESS:

**OLIN PARK
346 E LAKESIDE ST**

Although every effort has been made in preparing these plans and checking them for accuracy, the contractor and subcontractors must check all details and dimensions of their trade and be responsible for the same.

ITEM	DATE
<i>DRAWN BY: IW</i>	<i>07-07-2025</i>

PUBLIC WORKS PROJECT #:

SHEET TITLE:

DEMOLITION PLAN

SHEET NUMBER:

2.0



City of Madison
Department of Public Works
PARKS DIVISION
330 E Lakeside St.
Madison, WI 53715



Graphical Scale
0 30



PROJECT:

*346 E LAKESIDE ST
DEMOLITION*

PROJECT ADDRESS:

*OLIN PARK
346 E LAKESIDE ST*

Although every effort has been made in preparing these plans and checking them for accuracy, the contractor and subcontractors must check all details and dimensions of their trade and be responsible for the same.

ITEM	DATE
<i>DRAWN BY: IW</i>	<i>07-07-2025</i>

PUBLIC WORKS PROJECT #:

SHEET TITLE:

RESTORATION PLAN

SHEET NUMBER:

3.0