

City of Madison

2022-2027

Transportation Improvement Program



How Does A Project Make it into the City's Transportation Budget

- Safety
- Deteriorated Pavement Condition
- Pedestrian & Bicycle Improvements
- Bridge Deteriorated Condition
- Utility Infrastructure
- Requests by Adjoining Municipalities
- Timely Ability to get Developer Contributions
- Extensions or Realignment in Accordance with Adopted Neighborhood Plans
- Roadway Congestion



Downtown

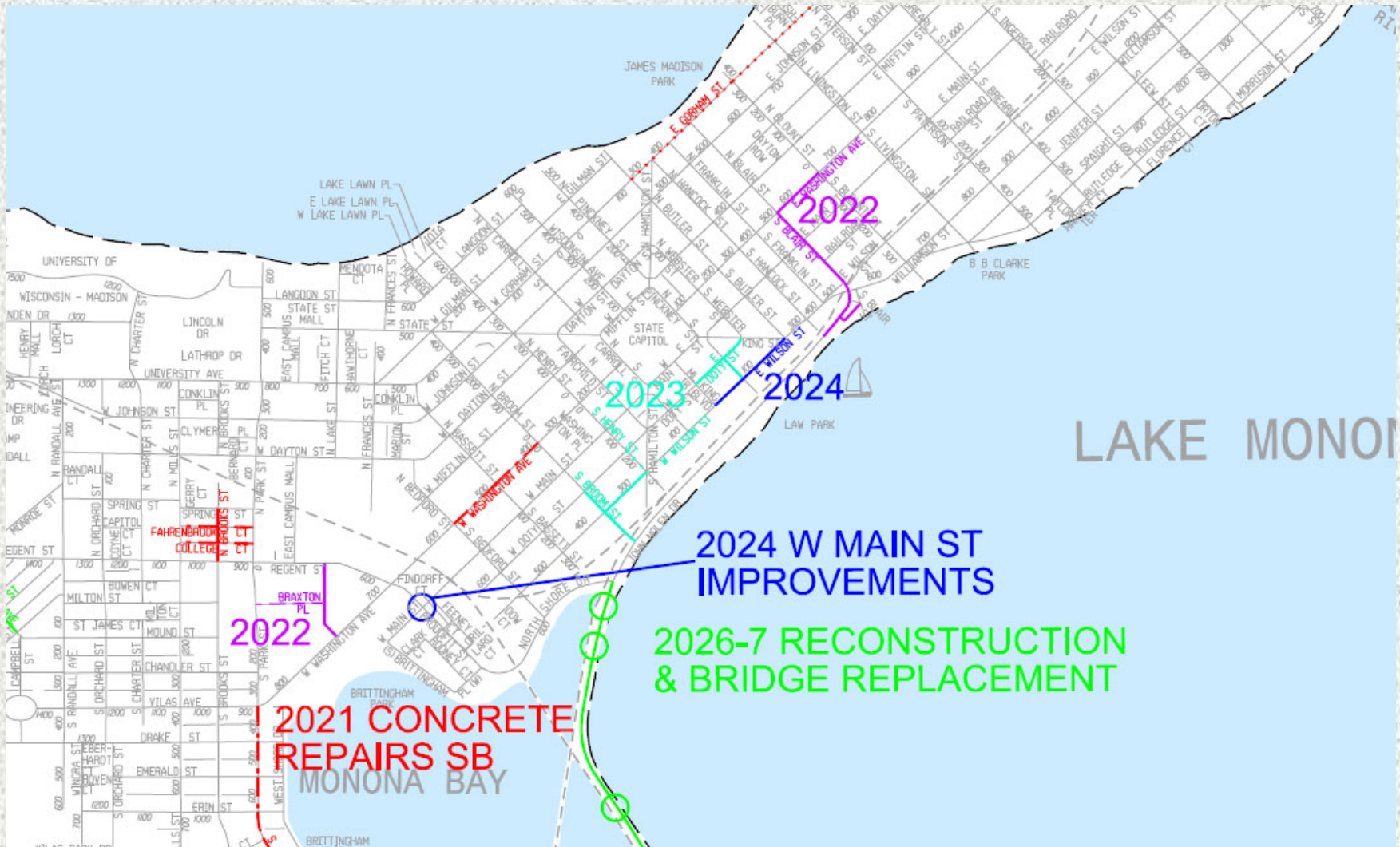

John Nolen Dr

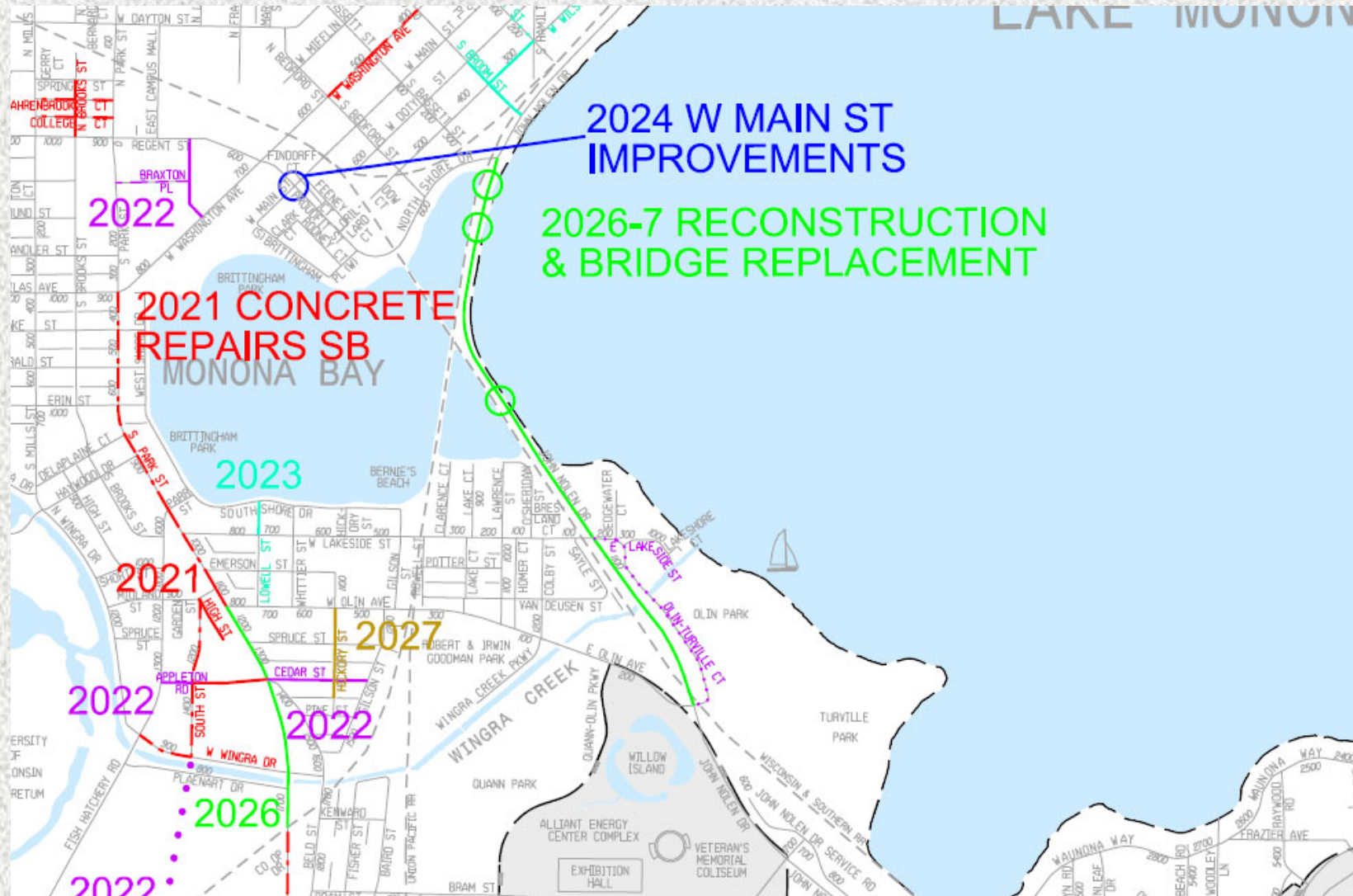

- STBG Federal Fund Request

City of Madison Engineering



University Ave

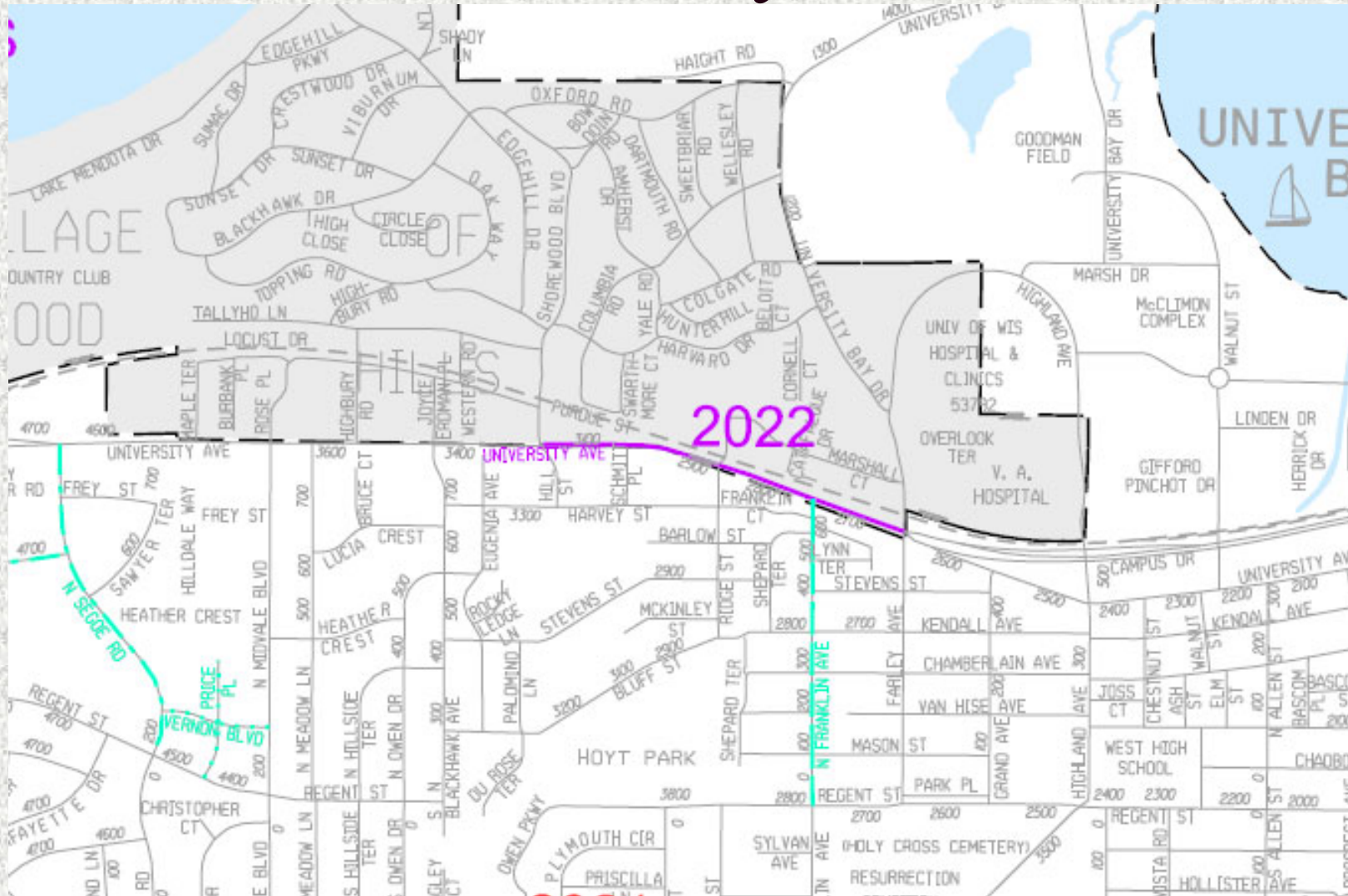

- STBG Federal Fund Awarded



City of Madison Engineering

Old Middleton Rd & Underpass

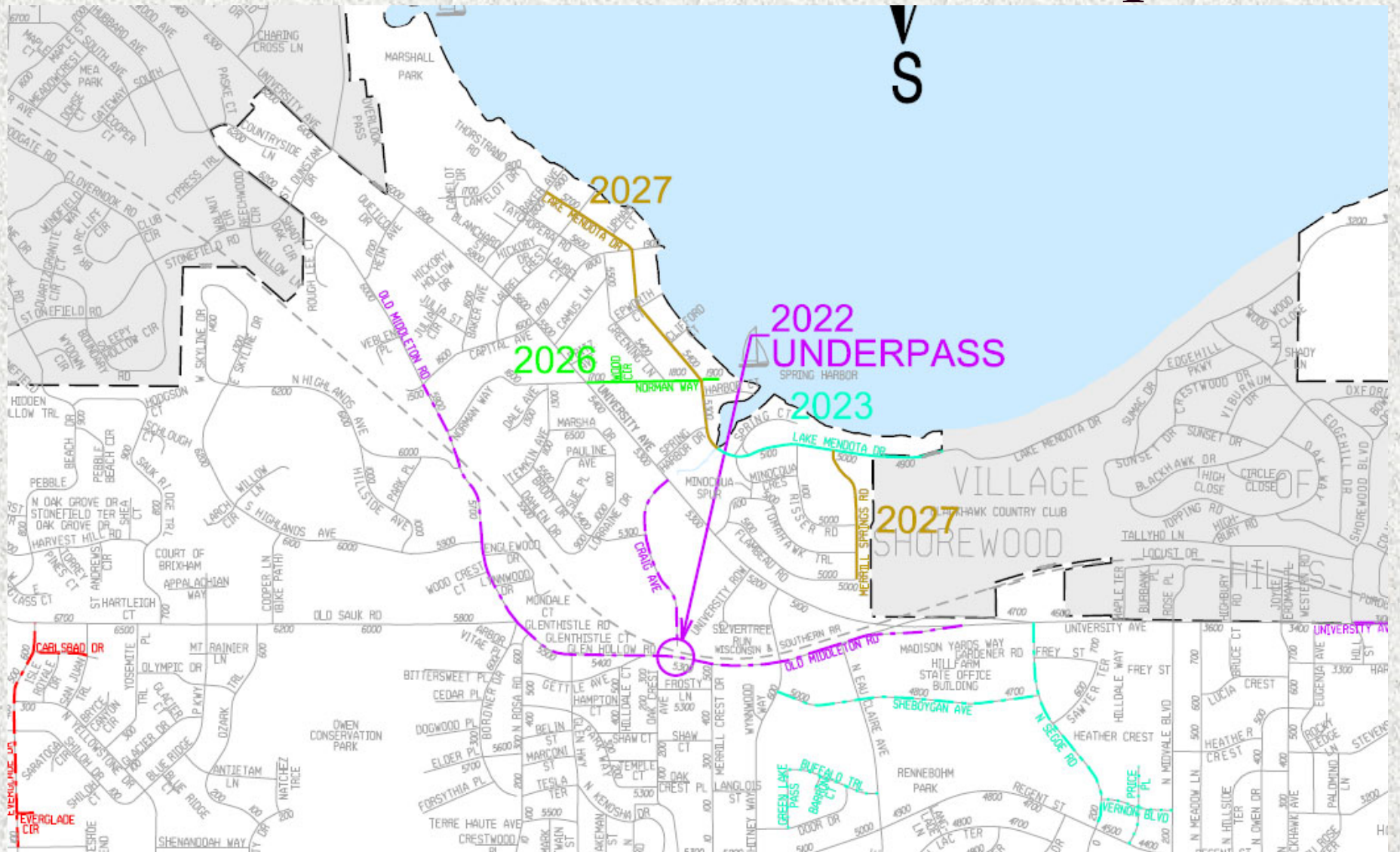

City of Madison Engineering

Old Sauk Path

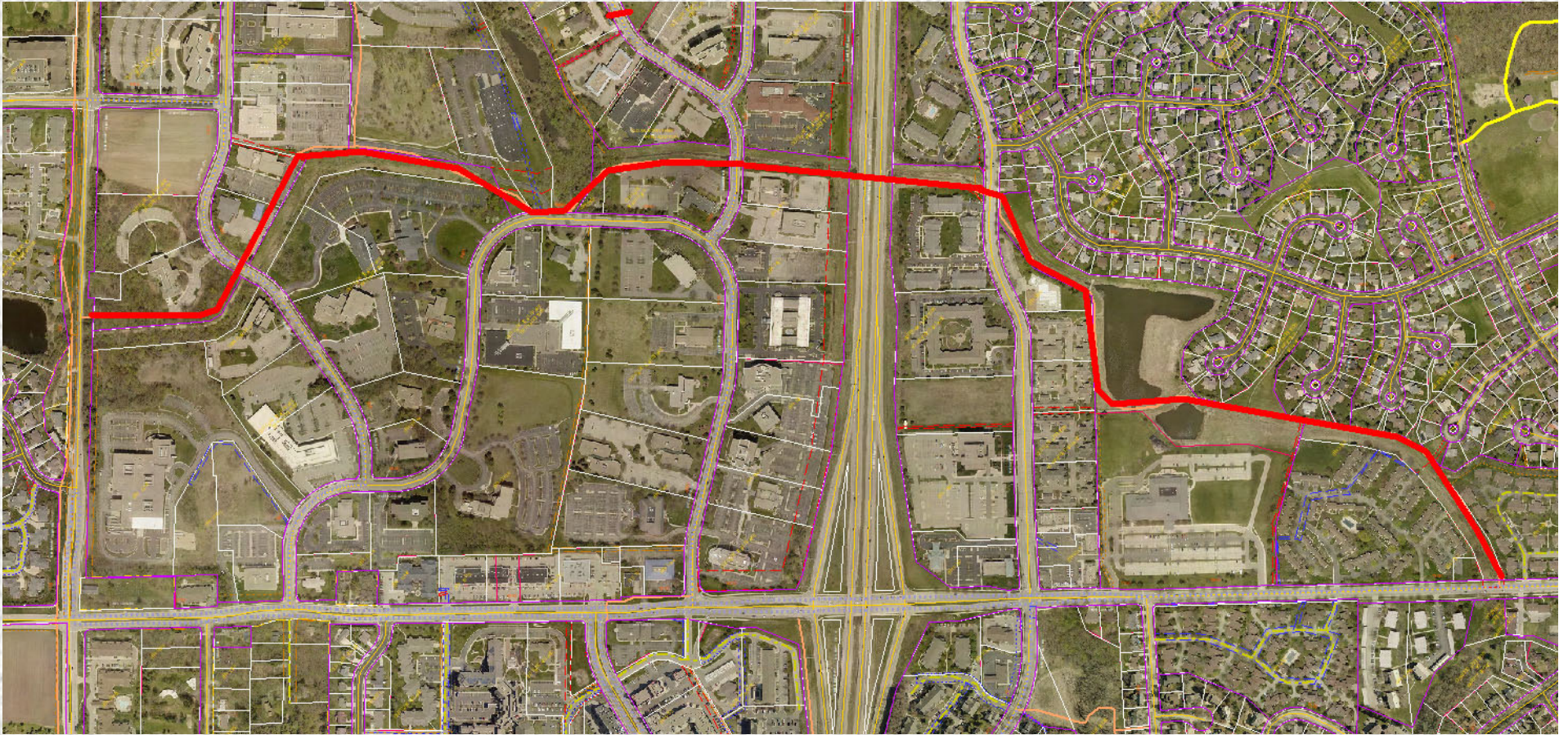

- Construct Portions of Path with Greenway Construction in Bikeways (East portion 2022/23)
- New Beltline Bridge?



City of Madison Engineering

Pleasant View Rd

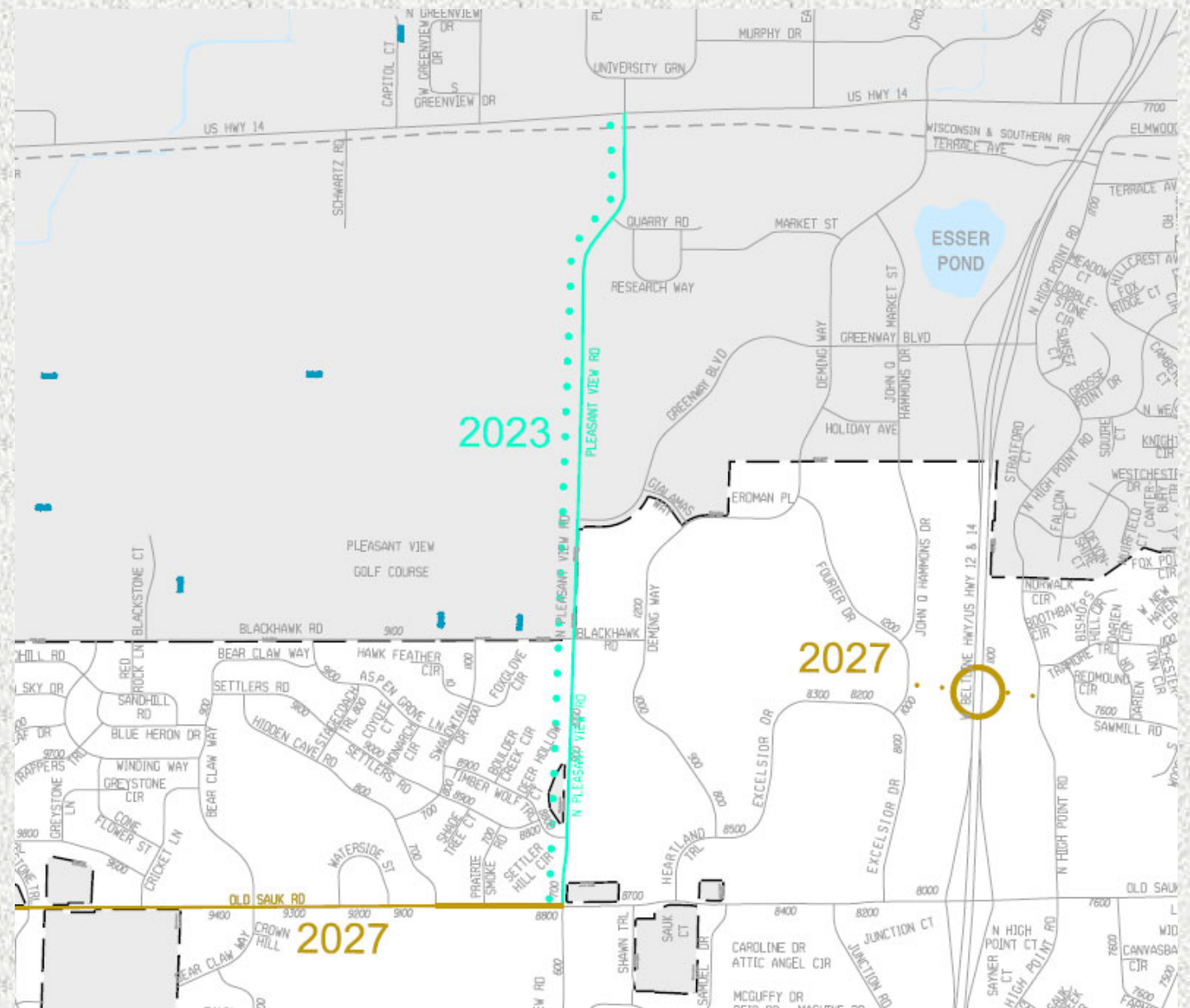

- STBG Federal Fund Awarded
City of Madison Engineering

West Towne Path

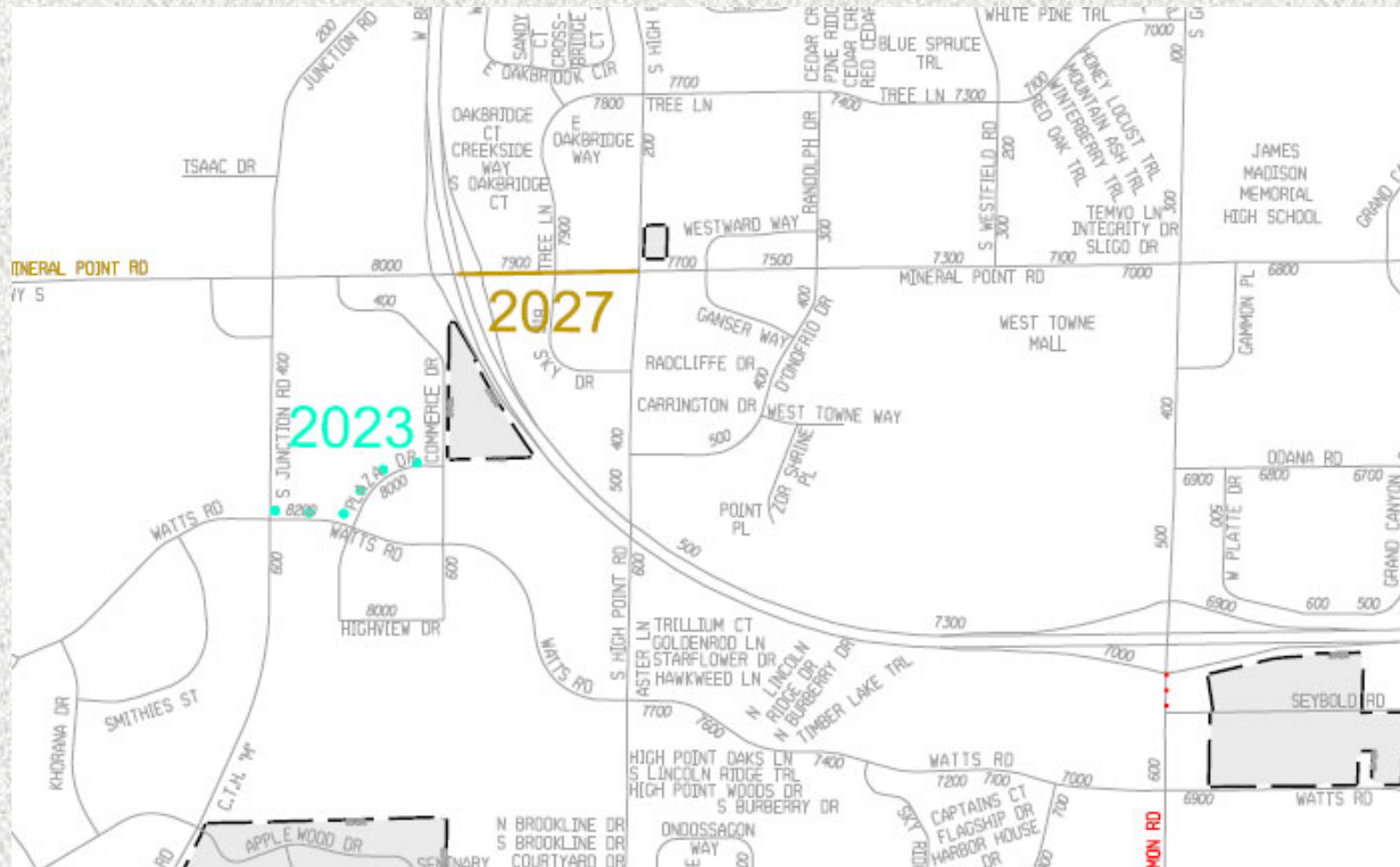

- TAP Federal Fund Awarded



City of Madison Engineering

Mineral Point Rd

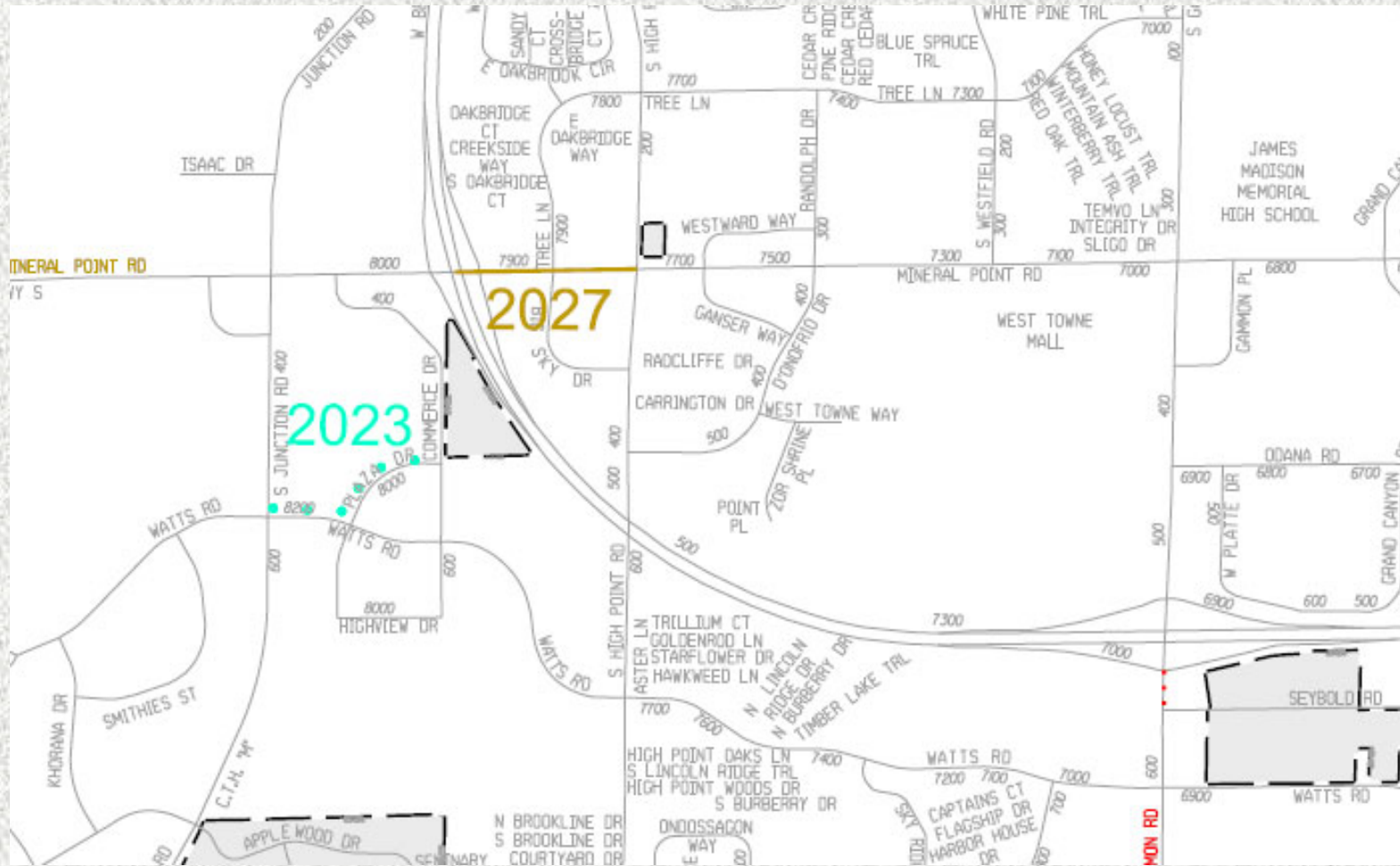

- STBG Federal Fund Request



City of Madison Engineering

South Park Street

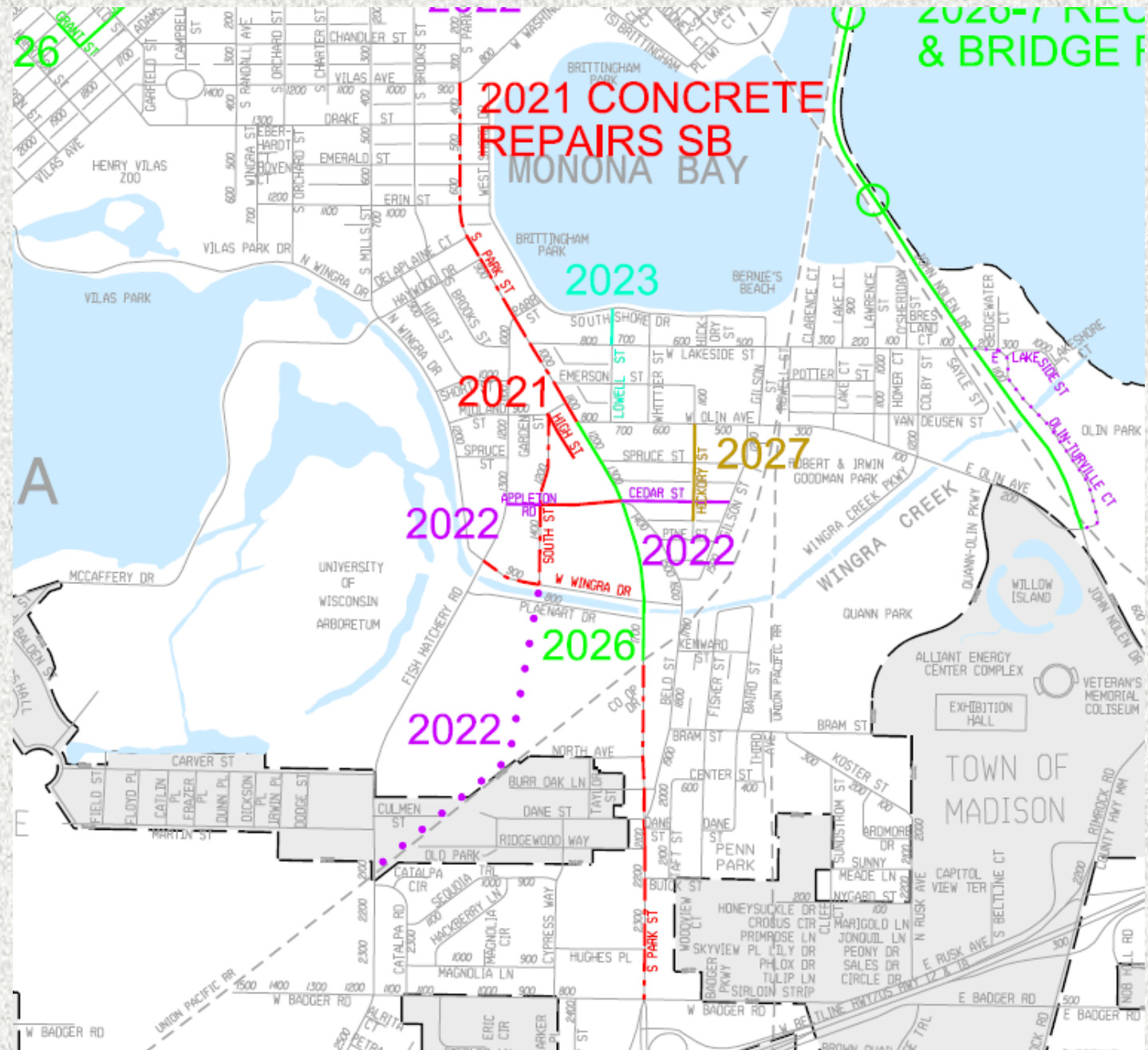

●

2021 CONCRETE REPAIRS SB

2023

2021

2022

2026

2022

2027

2020-27 RECONSTRUCTION & BRIDGE REPAIRS

CTH AB

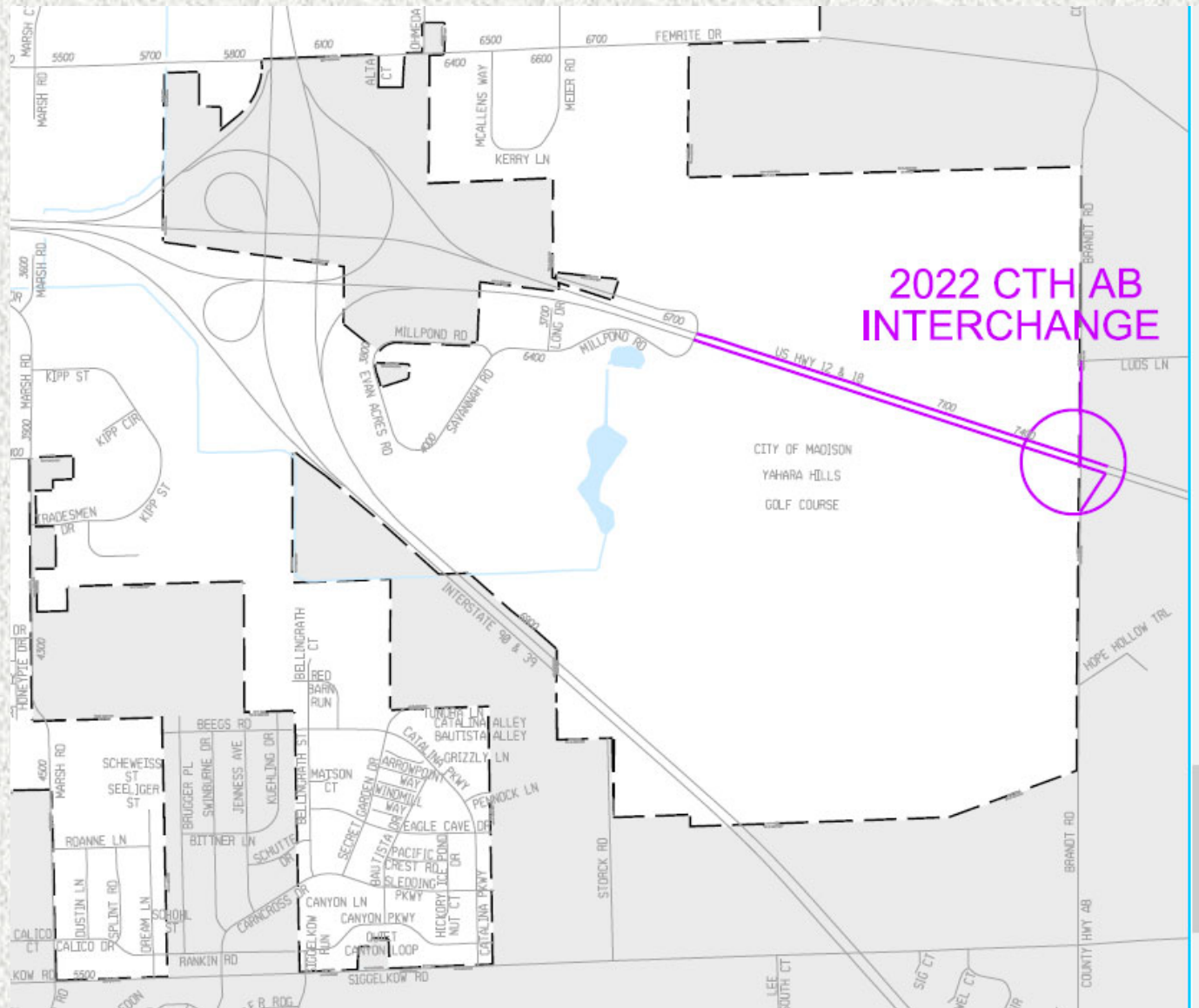

Autumn Ridge Path

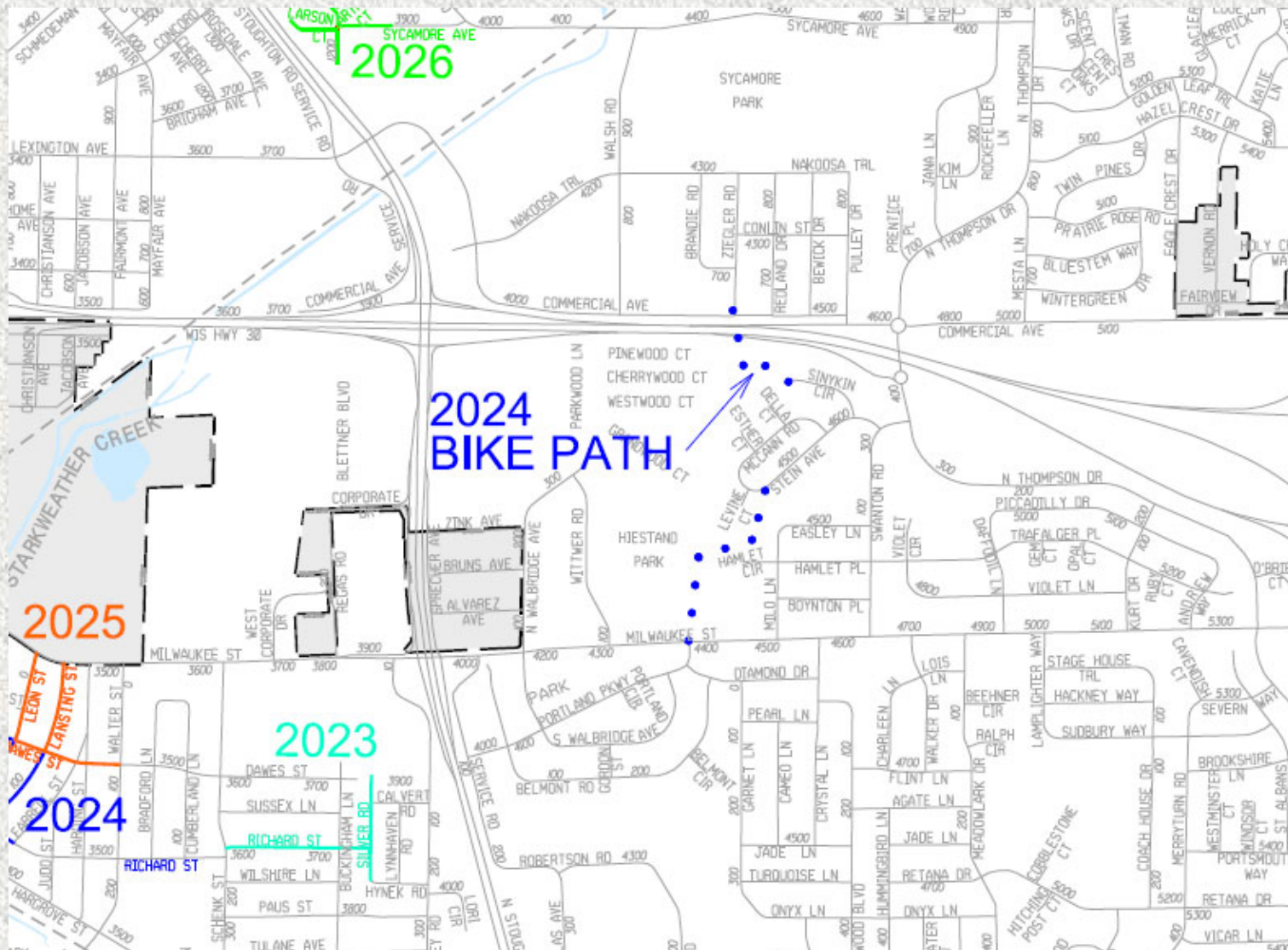

- STBG Federal Fund Request



City of Madison Engineering

This is a detailed street map of Olbrich Park in Madison, Wisconsin. The map features numerous streets, including Thorpe St, Tames St, Wayne St, Leon St, Laning St, Daves St, Starkweather Dr, Harwood St, Judson St, Hargrove St, Walter St, Bradford Ln, Cumberland Ln, Dawes St, Sussex Ln, Wilshire Ln, Paus St, Tulane Ave, Dennett Dr, Margaret St, Anchor Dr, Rockwell Dr, Steines Dr, Dempsey Rd, Maher Ave, Davidon St, Park Ct, Lake Edge Blvd, Ferchland Pl, Atwood Ave, Olbrich Ave, Sugar Ave, Buena Vista St, Fairview St, Gateway Pl, Union Pacific Rd, Olbrich Gardens, Olbrich Park, and Olbrich Park. The map also shows the Mississippi River and the Olbrich Park area. Various streets are highlighted with colored lines and labels, indicating different zones or projects. The years 2022, 2023, 2024, and 2026 are prominently displayed in large, colorful letters across the map, suggesting a timeline or schedule for development or events.

-

City of Madison Engineering

Troy Dr Bridge



- WisDOT Freight Rail Grant Request



City of Madison Engineering

Reconstruct Streets 2022

- Reconstruct 3.0 mi
- Bayview new street/path
- Davies, Major, Dempsey, Maher
- Pontiac, Nokomis, Rosewood, Boston
- Lafollette, Ohio, Talmadge, St. Paul, Jackson
- Cedar
- Russell
- Treetops/Feather Edge new street/path



Pavement Management 2022

- Chip Seal 50-70 mi
- Crack Seal 50-100 mi
- Patching
- Resurface 6.2 mi
- Old Middleton
- Kroncke, Lanett, Tanager
- Anderson
- Commercial
- Hammersley
- Mineral Point Rd, Owen, Keating, Caromar
- Tokay
- Medical Cir
- Lakeside, Olin Turville Ct



Bikeways Program

- Path Resurfacing
 - Quann Park
 - Sheryl Park
 - Struck Canyon underpass path
 - Sycamore Bike Path
 - Wingra Creek Bike Path
- Odana Cycle Track along Golf Course
- Wexford Greenways (bid 2022, build 2023)
 - Propose increase in program funds to keep up with stormwater greenway reconstruction
- Goodman Park Connection
- Candidate Future Projects:
 - Tancho Dr
 - Dawes St Greenway Ped Crossing
 - Glenwood Park Connection



Sidewalk Program

Ordered Repairs

- 2021 District 13 - Evers
 District 14 – Carter
- 2022 District 5 – Vidaver
- 2023 District 12 - Abbas
 District 18 - Myadze



Sidewalk Program

New Sidewalks

- Wright St & Carpenter intersection
- N Fair Oaks (10 block)
- Walter Street (300-500 blocks), east side
- Council Crest (4000 block), fill in 2 gaps
- Odana Road (3900 block), south side
- Harvey Street (3200-3400 blocks) & Hill Street (700 block)
- Nakoma Road (3900 block), south side
- Seminole Highway @ Arboretum entrance
- Portage Road (3700-3800 blocks), north side
- Busse Street (3700 block), fill in gap
- Tompkins Drive (1100-1200 blocks), north side
- Royster Avenue (3600 block), fill in gap
- Johns Street (3500-3600 blocks)
- Judd Street (100 block), west side & Farrell Street (100 block), fill in gap
- Badger Rock Area



State of Our Local Streets

	Local	2001	2010	2015	2016	2017	2018	2019	2020
	% Miles at or below Cond State 10	100.0%	100.0%	100.0%	100.0%	100.0%	100.0%	100.0%	100.0%
	% Miles at or below Cond State 9	93.9%	98.6%	98.1%	98.1%	96.6%	94.6%	96.1%	97.4%
	% Miles at or below Cond State 8	88.3%	92.6%	94.9%	95.2%	94.3%	92.2%	92.9%	93.4%
	% Miles at or below Cond State 7	68.2%	56.0%	64.1%	61.6%	61.8%	53.2%	78.5%	62.9%
	% Miles at or below Cond State 6	61.8%	40.7%	41.8%	43.7%	45.9%	44.3%	44.3%	41.1%
Goal 30%	% Miles at or below Cond State 5	34.9%	28.5%	27.6%	28.4%	27.8%	25.9%	25.7%	23.5%
	% Miles at or below Cond State 4	11.6%	6.7%	17.5%	18.8%	18.2%	16.2%	15.4%	14.3%
	% Miles at or below Cond State 3	2.4%	0.6%	2.7%	2.9%	3.5%	3.1%	2.9%	2.6%
	% Miles at or below Cond State 2	0.9%	0.0%	0.1%	0.2%	0.2%	0.2%	0.1%	0.3%
	% Miles at or below Cond State 1	0.8%	0.0%	0.0%	0.0%	0.0%	0.0%	0.0%	0.0%
	% Miles at or below Cond State 0	0.4%	0.0%	0.0%	0.0%	0.0%	0.0%	0.0%	0.0%

Goal: less than 30% of total miles of local streets at or below 5



State of Our Collector Streets

	Collector	2001	2010	2015	2016	2017	2018	2019	2020
	% Miles at or below Cond State 10	100.0%	100.0%	100.0%	100.0%	100.0%	100.0%	100.0%	100.0%
	% Miles at or below Cond State 9	94.2%	96.9%	96.4%	97.1%	96.7%	95.1%	96.1%	97.0%
	% Miles at or below Cond State 8	86.1%	89.0%	90.8%	93.1%	93.0%	91.5%	92.8%	95.0%
	% Miles at or below Cond State 7	58.3%	48.5%	58.8%	51.7%	61.5%	53.1%	78.0%	64.4%
	% Miles at or below Cond State 6	48.6%	32.4%	39.0%	41.4%	44.3%	43.1%	46.5%	43.9%
Goal 20%	% Miles at or below Cond State 5	27.8%	19.3%	18.9%	22.7%	23.1%	21.3%	25.0%	22.6%
	% Miles at or below Cond State 4	6.0%	4.7%	9.1%	9.5%	10.2%	9.5%	8.4%	8.1%
	% Miles at or below Cond State 3	0.3%	0.8%	2.9%	2.8%	3.2%	3.0%	1.8%	1.6%
	% Miles at or below Cond State 2	0.0%	0.0%	0.0%	0.0%	0.0%	0.2%	0.2%	0.0%
	% Miles at or below Cond State 1	0.0%	0.0%	0.0%	0.0%	0.0%	0.2%	0.2%	0.0%
	% Miles at or below Cond State 0	0.0%	0.0%	0.0%	0.0%	0.0%	0.2%	0.2%	0.0%

Goal: less than 20% of total miles of collector streets at or below 5



State of Our Arterial Streets

	Arterial	2001	2010	2015	2016	2017	2018	2019	2020	
	% Miles at or below Cond State 10	100.0%	100.0%	100.0%	100.0%	100.0%	100.0%	100.0%	100.0%	
	% Miles at or below Cond State 9	98.3%	92.0%	98.0%	97.9%	97.8%	95.1%	95.1%	97.4%	
	% Miles at or below Cond State 8	87.0%	76.6%	89.8%	89.7%	93.6%	90.7%	92.9%	91.8%	
	% Miles at or below Cond State 7	58.4%	47.0%	56.4%	46.1%	53.8%	42.5%	78.9%	57.9%	
	% Miles at or below Cond State 6	46.3%	28.2%	37.8%	38.9%	37.8%	36.5%	40.6%	39.9%	
Goal 15%	% Miles at or below Cond State 5	23.3%	15.8%	18.4%	23.0%	26.3%	24.6%	25.6%	25.8%	
	% Miles at or below Cond State 4	2.0%	8.1%	7.1%	7.5%	8.8%	6.9%	8.6%	8.2%	
	% Miles at or below Cond State 3	0.5%	0.8%	2.4%	2.3%	2.5%	1.6%	1.1%	1.2%	
	% Miles at or below Cond State 2	0.5%	0.0%	0.0%	0.0%	0.0%	0.0%	0.0%	0.1%	
	% Miles at or below Cond State 1	0.5%	0.0%	0.0%	0.0%	0.0%	0.0%	0.0%	0.0%	
	% Miles at or below Cond State 0	0.5%	0.0%	0.0%	0.0%	0.0%	0.0%	0.0%	0.0%	

Goal: less than 15% of total miles of arterial streets at or below 5



State of Our Paths

All Paths	2006	2010	2015	2016	2017	2018	2019	2020
% Miles at or below Cond State 10	100.0%	100.0%	100.0%	100.0%	100.0%	100.0%	100.0%	100.0%
% Miles at or below Cond State 9	92.8%	97.0%	92.7%	90.9%	89.0%	94.7%	91.9%	90.1%
% Miles at or below Cond State 8	77.8%	73.3%	69.8%	68.3%	67.5%	76.4%	73.9%	70.4%
% Miles at or below Cond State 7	39.6%	36.8%	46.3%	45.1%	44.7%	57.6%	55.5%	53.0%
% Miles at or below Cond State 6	31.9%	20.3%	20.0%	19.0%	18.4%	25.7%	24.0%	18.8%
% Miles at or below Cond State 5	15.1%	9.9%	4.7%	4.3%	4.3%	11.1%	10.0%	6.8%
% Miles at or below Cond State 4	2.9%	0.5%	1.1%	1.1%	1.1%	1.5%	1.5%	0.6%
% Miles at or below Cond State 3	0.5%	0.0%	0.3%	0.3%	0.3%	0.0%	0.1%	0.0%
% Miles at or below Cond State 2	0.0%	0.0%	0.3%	0.3%	0.3%	0.0%	0.1%	0.0%
% Miles at or below Cond State 1	0.0%	0.0%	0.3%	0.3%	0.3%	0.0%	0.1%	0.0%
% Miles at or below Cond State 0	0.0%	0.0%	0.3%	0.3%	0.3%	0.0%	0.1%	0.0%

Goal: 0% of total miles of arterial streets at or below 5



How to get info

- <http://www.cityofmadison.com/engineering/projects>
- Chris Petykowski 267-8678
cpetykowski@cityofmadison.com



Comments or Project Suggestions

