



CITY OF MADISON  
 DEPT. OF PUBLIC WORKS  
 ENGINEERING DIVISION  
 CITY COUNTY BLDG RM. 115  
 210 MARTIN LUTHER KING JR BLVD  
 MADISON, WI 53703  
 PHONE: 608-266-4751

MADISON FIRE STATION 10 ROOF REPLACEMENT  
 1517 TROY DRIVE  
 MADISON, WI

CONTRACT  
 8243  
 MUNIS  
 13278  
 DRWN BY: MRG  
 DATE 3/14/21  
 REV:

SHT  
**A2**

**ROOF INSTALLATION NOTES**  
 EXISTING CURBING  
 IT IS UNCERTAIN IF EXISTING CURBING SET ON THE CONCRETE DECK OR THE LIGHTWEIGHT ASPHALTIC FILL MATERIAL. MODIFY CURBING TO ENSURE IT ATTACHES TO THE PRESTRESSED CONCRETE DECK & HAS A FINAL HEIGHT THAT EXTENDS A MINIMUM OF 8" ABOVE THE TOP OF THE ROOFING MEMBRANE.

**ROOF DRAINS:**  
 REUSE EXISTING DRAINS  
 NEW DRAINS SHALL BE SET IN 8" & 10" THICK PRE-CAST CONCRETE PLANKS. THE CONTRACTOR SHALL UTILIZE CONCRETE RADAR SCANNING TO DETECT AND AVOID CUTTING THE REINFORCING STEEL (TENDONS).

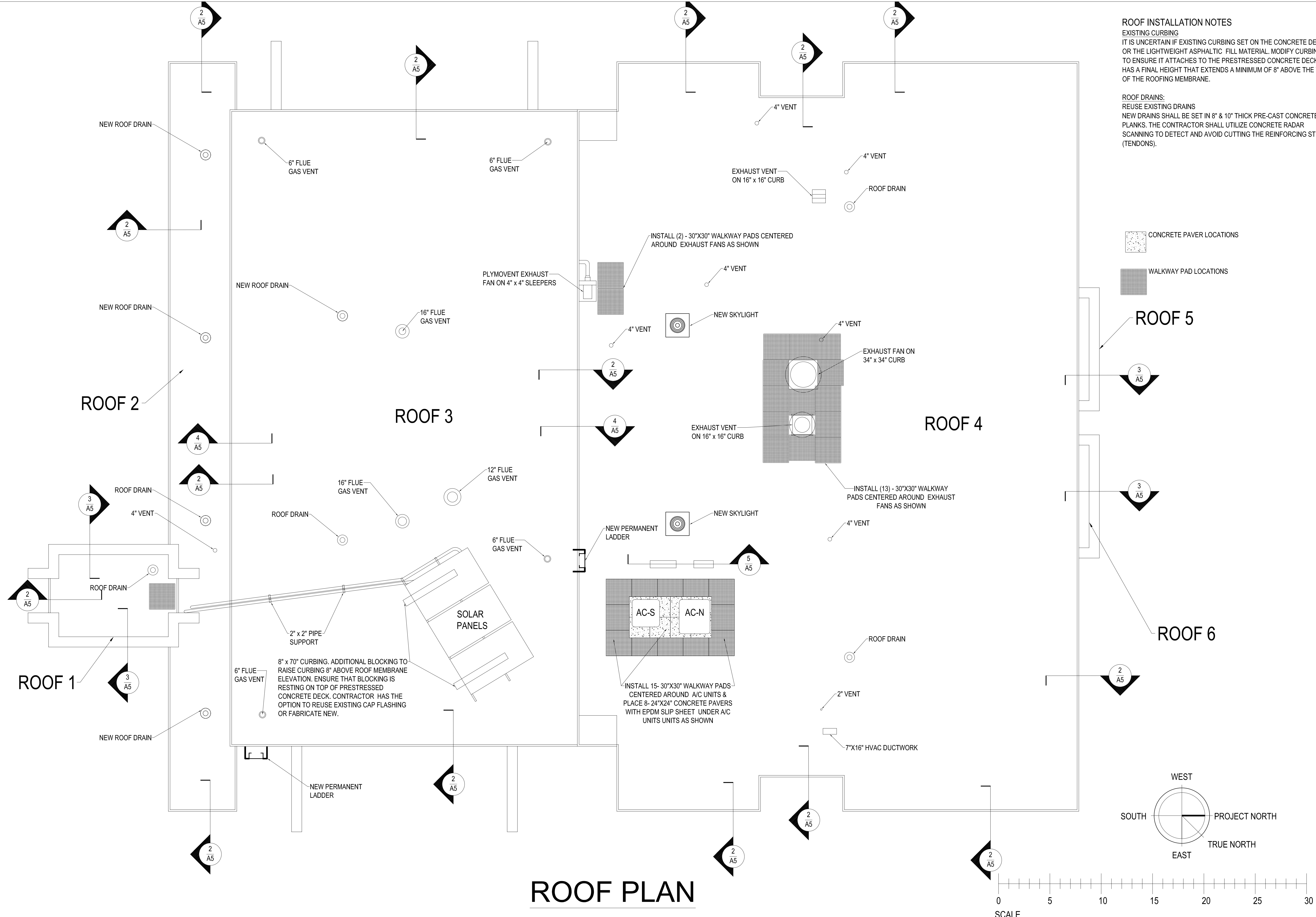
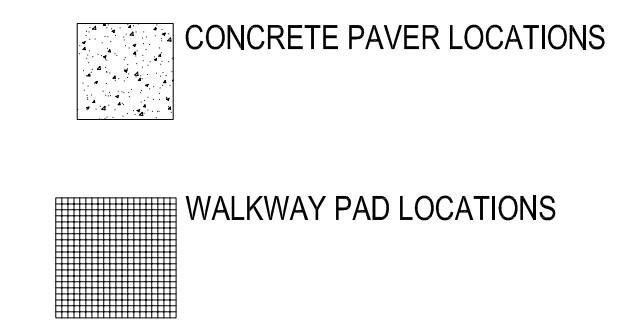

8" x 70" CURBING. ADDITIONAL BLOCKING TO RAISE CURBING 8" ABOVE ROOF MEMBRANE ELEVATION. ENSURE THAT BLOCKING IS RESTING ON TOP OF PRESTRESSED CONCRETE DECK. CONTRACTOR HAS THE OPTION TO REUSE EXISTING CAP FLASHING OR FABRICATE NEW.

INSTALL 15- 30"X30" WALKWAY PADS CENTERED AROUND A/C UNITS & PLACE 8-24"X24" CONCRETE PAVERS WITH EPDM SLIP SHEET UNDER A/C UNITS AS SHOWN

INSTALL (2) - 30"X30" WALKWAY PADS CENTERED AROUND EXHAUST FANS AS SHOWN

INSTALL (13) - 30"X30" WALKWAY PADS CENTERED AROUND EXHAUST FANS AS SHOWN

