



1241 John Q. Hammons Dr., Ste. 503
Madison, WI 53717

608.829.3701
bwbr.com

August 20, 2019

LETTER OF INTENT
Supplemental #2

Chris Wells
City of Madison

Re: Mendota Mental Health Institute, Juvenile Treatment Center Expansion (MJTC)
Letter of Intent
BWBR Commission No. 3.2018319.00

Dear Mr. Wells:

Attached is the verification of the number of existing parking stalls, the # of proposed stalls, and the projected number of users for the MJTC facility.

Attachments:

- Google map indicating current building with proposed expansion and revised parking and user quantities.
- Current site plan indicating current parking stall count
- Proposed site plan indicating proposed parking stall count

Sincerely,

BWBR

Laura M. Davis
Sr. Project Architect

LMD

For professional licensure, visit bwbr.com/licenses-registrations



- EXISTING MJTC AND FMU
- PROPOSED MJTC EXPANSION
- PROPOSED MJTC PARKING LOT

<u>BUILDING AREA</u>		
Current (remodel)	Proposed (new)	Total
24,608 SF	78,063 SF	102,671 SF
<u>OCCUPANCY</u>		
Current Total	Proposed Total	Difference
Beds: 43	Beds: 93	Beds: 50
Users:	Users:	Users:
AM shift: 44	AM shift: 125	AM shift: 81
PM shift: 19	PM shift: 73	PM shift: 54
Daily visitors: 10	Daily visitors: 25	Daily visitors: 15
<u>PARKING</u>		
Current Total	Proposed Total	Difference
107 stalls	194 stalls	87 stalls

MENDOTA JUVENILE TREATMENT CENTER EXPANSION EXISTING PARKING SERVING BOTH MJTC AND BUILDING 14

ASPHALT
FOOD SERVICE
EXISTING PARKING -
UNCHANGED

BUILDING
NO. 14
DISTRICT
OFFICE

BUILDING NO. 184
MJTC

23 PARKING
STALLS

84 EXISTING
PARKING STALLS

107 TOTAL EXISTING
PARKING STALLS

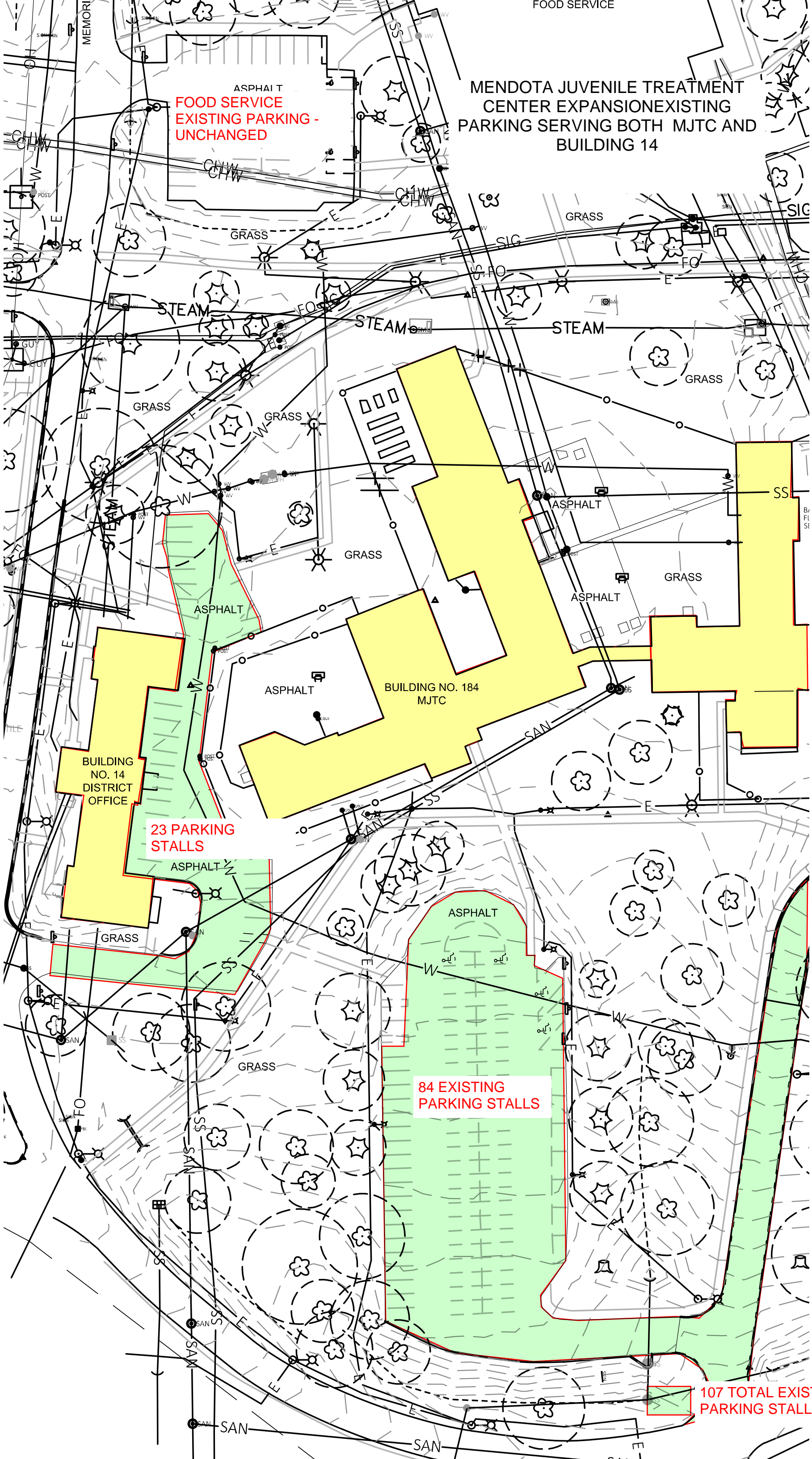

MENDOTA JUVENILE TREATMENT CENTER EXPANSION

PROPOSED PARKING SERVING BOTH MJTC AND BUILDING 14

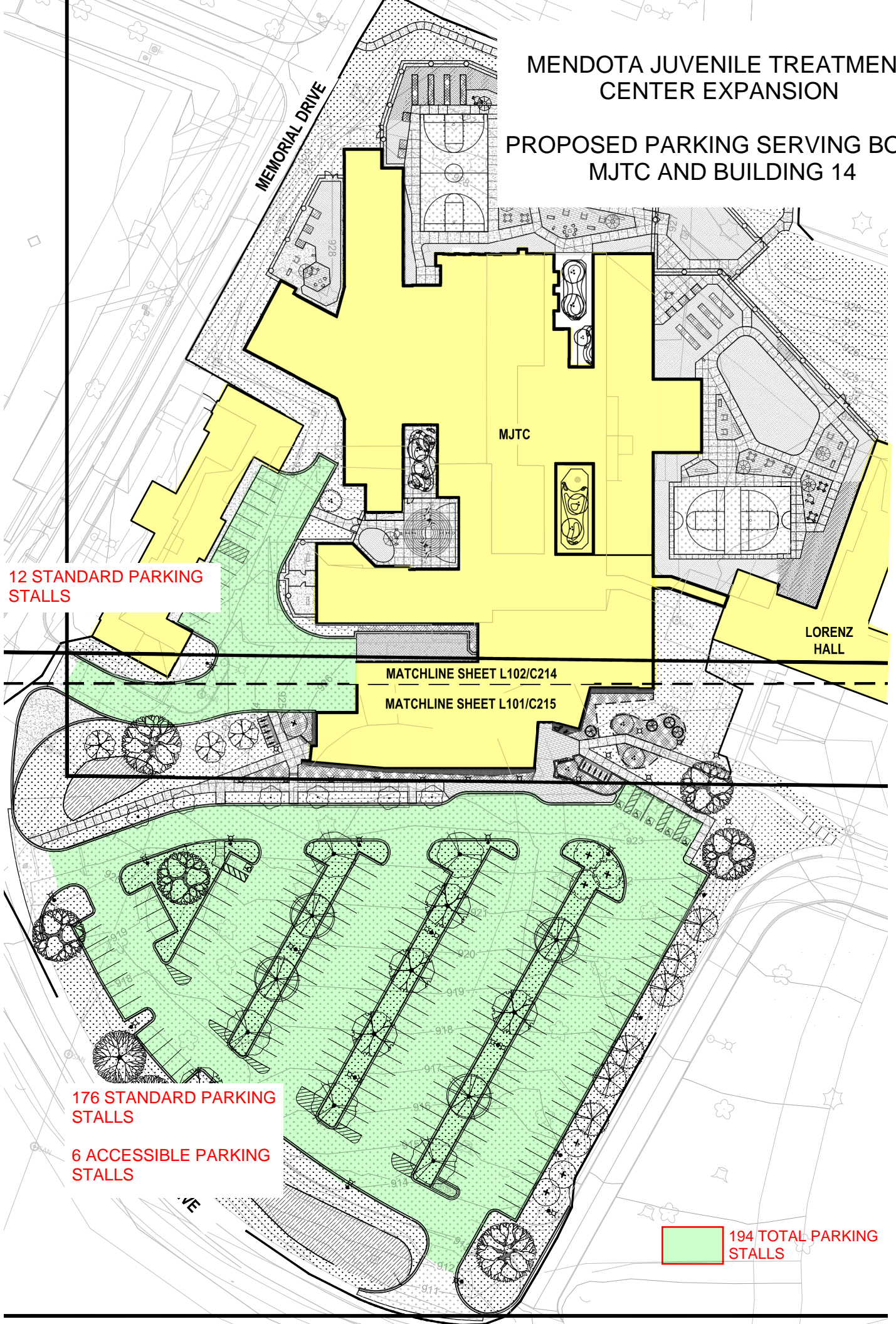

12 STANDARD PARKING STALLS

MATCHLINE SHEET L102/C214

MATCHLINE SHEET L101/C215

176 STANDARD PARKING STALLS

6 ACCESSIBLE PARKING STALLS

194 TOTAL PARKING STALLS