

Milwaukee St

North Sprecher Road

Installation of a bus pullout on west bound Milwaukee Street at N Sprecher Rd. Shift existing sidewalk to the north to accommodate the bus pullout. Detail attached.

LEGEND

- PROPERTY LINE
- 18" CONCRETE CURB & GUTTER
- PROPOSED BUILDING
- PROPOSED RETAINING WALL
- PROPOSED STORM SEWER
- PROPOSED SANITARY SEWER
- PROPOSED WATER MAIN/LATERAL

- SITE UTILITY NOTES
1. THE LOCATION OF EXISTING UTILITIES SHOWN ON THE PLANS ARE APPROXIMATE. PROTECTION OF EXISTING UTILITIES IS THE CONTRACTOR'S RESPONSIBILITY.
 2. ALL SITE UTILITY WORK SHALL BE CONSTRUCTED PER THE CITY OF MADISON STANDARD SPECIFICATIONS.
 3. CONTRACTOR TO COORDINATE ELECTRIC, GAS, PHONE & CABLE INSTALLATION WITH THE RESPECTIVE UTILITY COMPANIES.
 4. UTILITY CONTRACTOR SHALL VERIFY EXISTING UNDERGROUND UTILITY GRADES AND NOTIFY THE PROJECT SUPERINTENDENT IF A CONFLICT ARISES WITH THE INSTALLATION OF NEW UTILITIES.
 5. ALL PIPE AND INLET TYPES SHALL MEET CITY OF MADISON SPECIFICATIONS FOR SEWER CONSTRUCTION
 6. ALL INLETS ACCEPTING STORMWATER RUNOFF FROM PARKING AREAS SHALL HAVE CATCHALL HR-1 PERMANENT INLET INSERTS INSTALLED
 7. PRIVATE WATER MAIN IS IN ACCORDANCE WITH MGO SECTION 34.507 FOR MINIMUM SIZE.

D'ONOFRIO KOTTHE AND ASSOCIATES, INC.
7550 Westward Way, Madison, WI 53717
Phone: 608.833.7550 • Fax: 608.833.1039
YOUR NATURAL RESOURCE FOR LAND DEVELOPMENT

UTILITY PLAN
METROTECH
CITY OF MADISON, WISCONSIN

SCALE: 1" = 30'
(PAGE SIZE: 24x36)

DATE: 03/08/19
REVISED: 05/08/19

DRAWN BY: KWB

FN: 18-03-101

Sheet Number:
C - 1.8

PLOT SCALE:

PLOT NAME:

REV. DATE:

ORIGINATOR: CITY OF MADISON, TRAFFIC ENG. DIV.

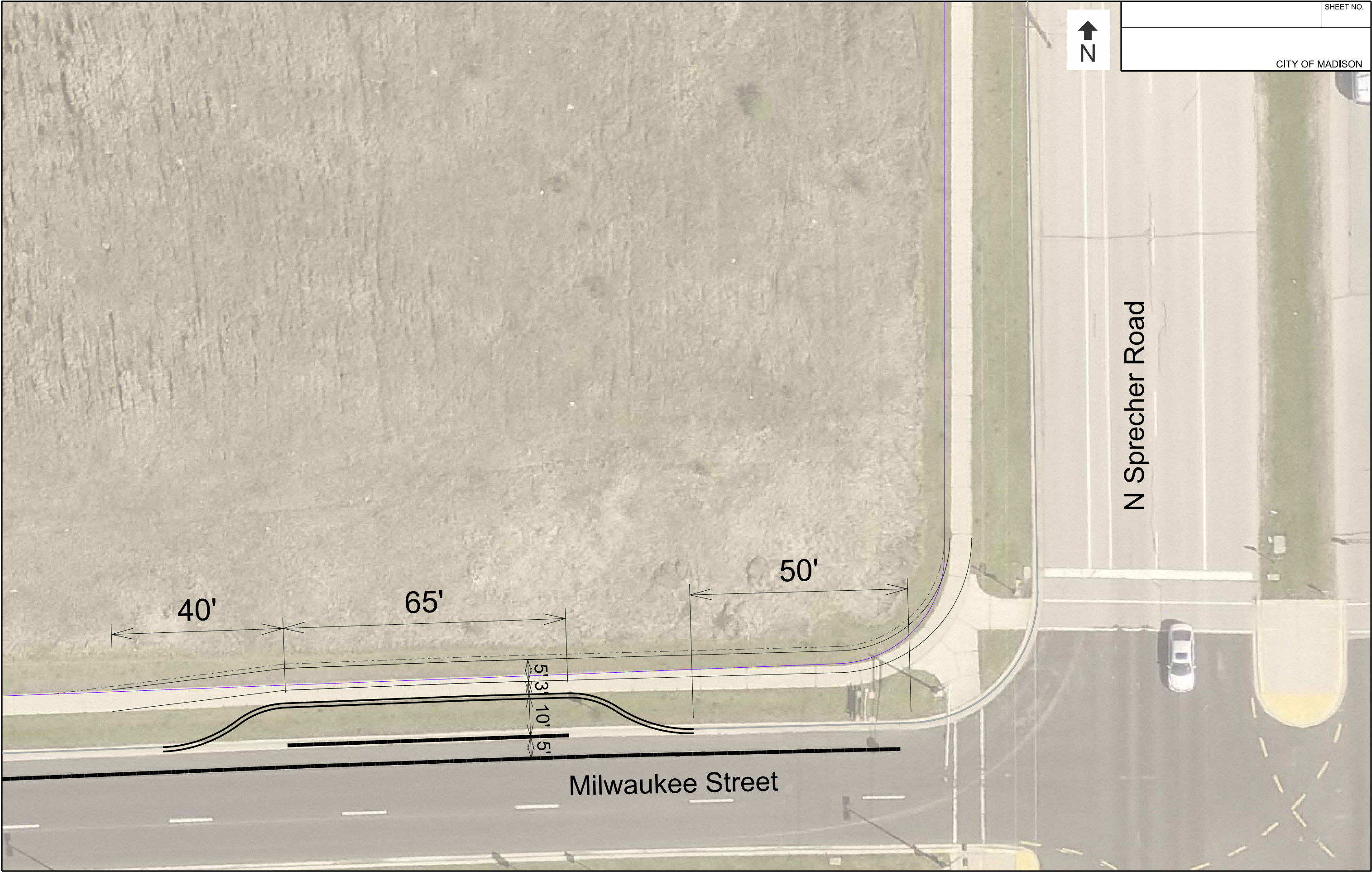

SHEET NO.

CITY OF MADISON