

REZONING EXHIBIT "A"

ALL THAT PART OF THE NORTHWEST 1/4 AND NORTHEAST 1/4 OF THE SOUTHWEST 1/4 OF SECTION 21,
TOWN 7 NORTH, RANGE 8 EAST, IN THE CITY OF MADISON, DANE COUNTY, WISCONSIN.

CENTER,
SEC. 21-7-8

ELDERBERRY

ROAD

N. LINE, S.W. 1/4, SEC. 21-7-8

LANDS TO
REMAIN "SR-V2"

LANDS TO
REMAIN "TR-U1"

LANDS TO
REMAIN "TR-V2"

LANDS TO
REMAIN "SR-V2"

LANDS TO BE
ZONED "SR-V2"
295,407 S.F.
6.7816 Ac.
(SEE LEGAL "A")

WOODSTONE REPLAT

SPIRIT
STREET

WOODSTONE

E. LINE, S.W. 1/4, SEC. 21-7-8

COBALT
STREET

WOODSTONE

BEAR CLAW WAY

WILRICH
STREET

UNPLATTED LANDS

WILRICH STREET

BLACKHAWK CHURCH TOWN CENTER PLAT

VERITAS DRIVE

BEAR CLAW WAY



NORTH
SCALE: 1" = 200'

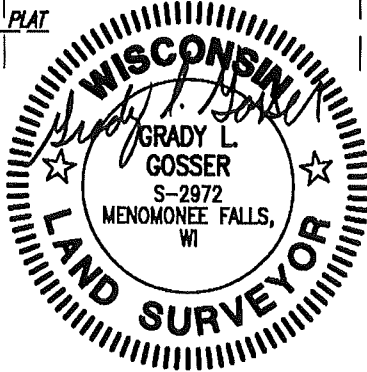

S. 1/4 CORNER,
SEC. 21-7-8

H:\c300\311\12041-01\Survey\ESMT-EXHIBITS\885DEX-REZONING-2.dwg

THIS EXHIBIT WAS PREPARED BY GRADY L. GOSSER, P.L.S. (S-2972)

DATE: 2-22-19

11-12