

**PHASING PLAN GENERAL NOTES:**

- BUILDING SHALL BE OWNER OCCUPIED THROUGHOUT THE ENTIRE CONSTRUCTION PERIOD. OWNER OPERATES 24 HOURS A DAY, 7 DAYS A WEEK. BUS STORAGE AND TRAVEL LANES ARE REQUIRED TO REMAIN CLEAR FOR CONTINUOUS ACCESS.
- WORK AREAS 1 & 2 SHALL BE FULLY ABANDONED. PROVIDE TEMPORARY PARTITIONS AND/OR SAFETY BARRIERS TO PREVENT ACCESS INTO CONSTRUCTION ZONES AND CAUTION ONGOING BUS TRAFFIC.
- WORK AREAS 3, 5, & 6 WILL REQUIRE COORDINATION WITH OWNER OPERATION DOWN TIME. WORK SHALL BE CONDUCTED IN AN EXPEDITIOUS WAY TO LIMIT DOWN TIME.
- WORK AREA 4 - WASH LANE DECONSTRUCTION MAY ONLY BEGIN ONCE WORK AREA 1 - NEW SERVICE LANE IS COMMISSIONED AND OPERATIONAL. PROVIDE TEMPORARY PARTITIONS AND/OR SAFETY BARRIERS TO PREVENT ACCESS INTO CONSTRUCTION ZONES AND CAUTION ONGOING BUS TRAFFIC.
- A NEGOTIATED CONSTRUCTION EASEMENT WITH THE ADJACENT SOUTH-WEST PROPERTY OWNER IS IN PLACE FOR CONSTRUCTION ACCESS TO THE ADDITION PORTION OF WORK IN WORK AREA 1. CONTRACTOR IS RESPONSIBLE FOR MAINTAINING A SECURE SITE ON THE ADJACENT PROPERTY. A TEMPORARY 6'0" CONSTRUCTION SECURITY FENCE IS REQUIRED. SITE RESTORATION REQUIREMENTS ARE NOTED ON THE CIVIL DRAWINGS.
- CONSTRUCTION EMPLOYEE PARKING IS NOT PERMITTED IN METRO EMPLOYEE PARKING.
- CONSTRUCTION ACCESS SHALL BE LIMITED AT THE PRIMARY BUS DRIVE ACCESS AND FIRE LANE ACCESS.
- WORK AREA NUMBERING IS NOT INTENDED TO DICTATE ORDER.



metro transit



**CITY OF MADISON  
METRO TRANSIT - SERVICE LANE ADDITION - PHASE 1**

1101 EAST WASHINGTON AVE.  
MADISON, WI 53703

ISSUED  
01/17/19 BID SET

CONTRACT NO.: 8238  
JOB NO.: 4503500-170148.02  
DATE: January 17, 2019  
DESIGNED BY: SZK  
DRAWN BY: NJD  
CHECKED BY: RCL

DO NOT SCALE DRAWINGS  
SHEET CONTENTS  
PHASING PLANS

SHEET NO.:

**G-101**

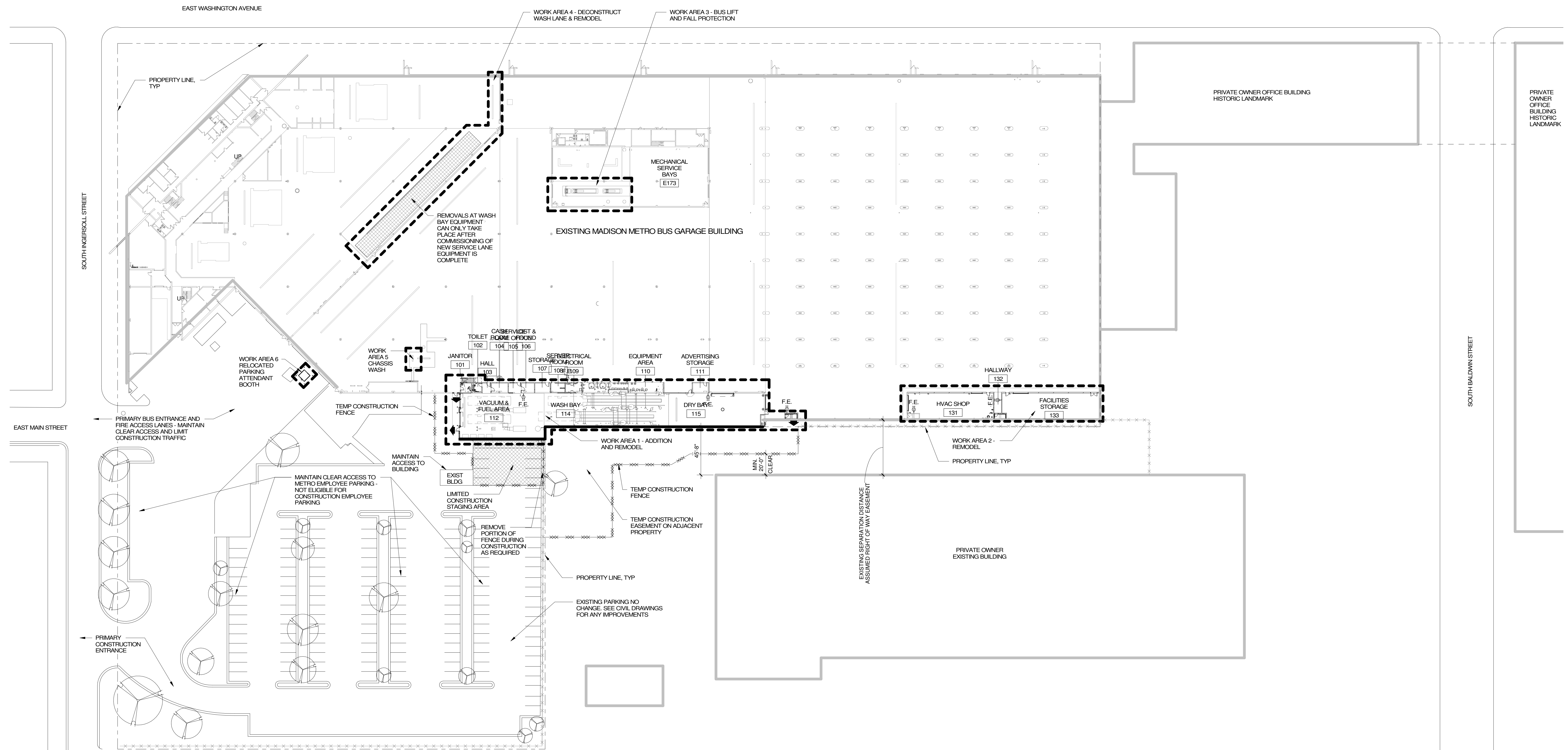

TRUE PLAN  
NORTH NORTH  
**1**  
OVERALL FIRST FLOOR PHASING PLAN  
1" = 40'-0"