

EAGLE TRACE

LOCATED IN ALL 1/4'S OF THE NE 1/4 OF SECTION 20, T7N, R8E,
 CITY OF MADISON, DANE COUNTY, WISCONSIN

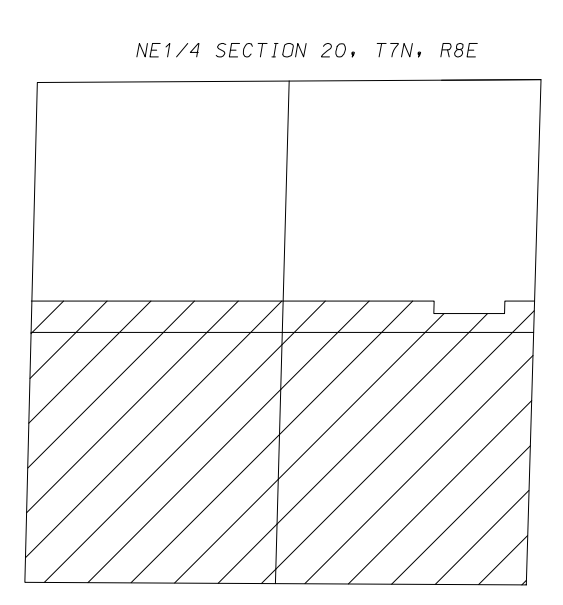
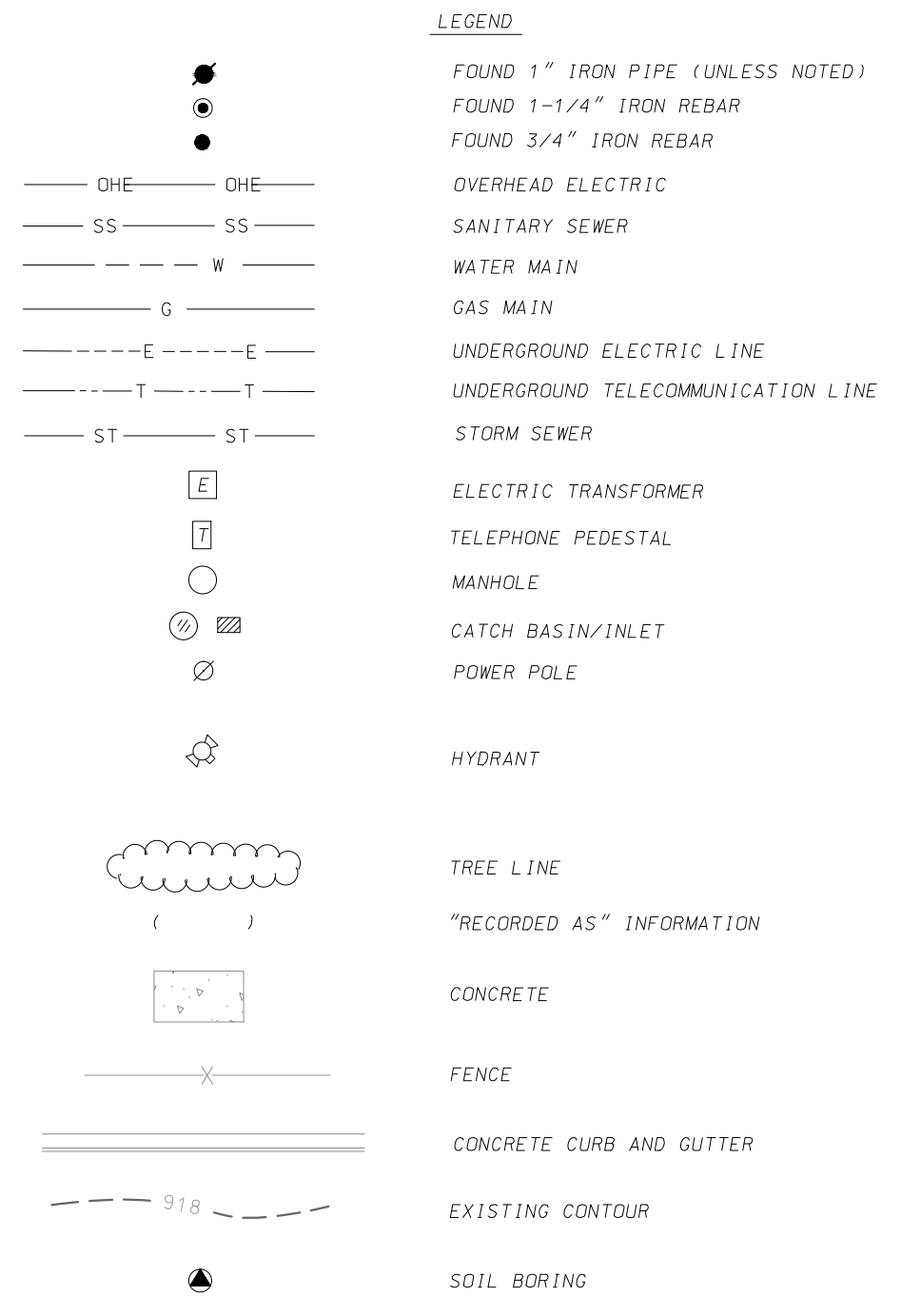

LEGAL DESCRIPTION
 The South 1/2 of the Northeast 1/4 and the South 1/2 of the North 1/2 of the Northeast 1/4 of Section 20, Town 7 North, Range 8 East, in the City of Madison, Dane County, Wisconsin.
 Including Lot 1, Certified Survey Map No. 7671, recorded in Vol. 40 of Certified Survey Maps, page 96, as #2649094, in the City of Madison, Dane County, Wisconsin.
 EXCEPT 119' of way dedicated by Certified Survey Map No. 7671, EXCEPT Certified Survey Map No. 2519.

Surveyor:
 Vn Acquisitions, LLC
 6801 South Town Drive
 Madison, WI 53713
Blasius:
 Vonderweile & Assoc
 120 E. Lakeside St.
 Madison, WI 53715
OWNER:
 Scheve Limited Partnership
 10918 Cave of the Mounds Road
 Blue Mounds, WI 53517

SURVEYOR'S CERTIFICATE
 I, Brett T. Staffregan, Professional Land Surveyor S-2742, hereby certify that this preliminary plat is a true representation of all the adjacent existing land divisions and of the boundary of the preliminary plat and features and that I have fully complied with the City of Madison Subdivision Ordinance.
 Dated this 7th day of November, 2017.
Brett T. Staffregan
 Brett T. Staffregan, Professional Land Surveyor S-2742

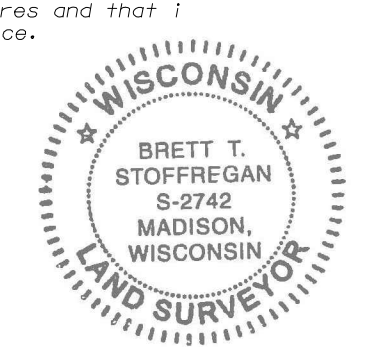

- NOTES**
- All streets are dedicated to the public.
 - All intersection radii are 15' unless noted.
 - Proposed Zoning TR-C3 Existing Zoning: A
 - Outlot Dedication:**
 - 2 - Dedicated to the Public for Stormwater Management and Drainage purposes.
 - Public Steward Bike Path Easement.
 - 3 - Dedicated to the Public for Park purposes. Public Bike Path Easement.
 - 4 - Dedicated to the Public for Stormwater Management and Drainage purposes.
 - Public Bike Path Easement.
 - 5 - Dedicated to the Public for Stormwater Management and Drainage purposes.
 - 6 - Dedicated to the Public for Stormwater Management and Drainage purposes.

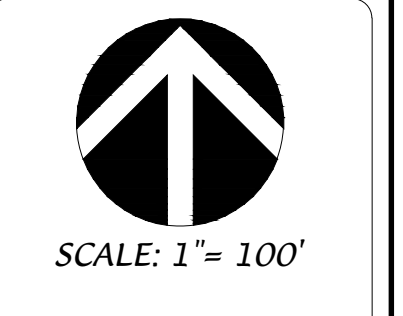

DATE: 11-7-17
 REVISED: