

THE NORTH PLAN NORTH

1 FLOOR PLAN
1/4" = 1'-0"

BARCEL PATTERNS KEY:

NEW CONSTRUCTION

EXISTING CONSTRUCTION

FLOOR PLAN KEY NOTES:

- 1) STAIRS: THE NEW STAIRS, CORRIDOR, 2'-0" x 1'-0" x 1'-0" TO EXISTING STAIRS. THE NEW STAIRS ARE 2'-0" x 1'-0" x 1'-0" TO EXISTING STAIRS. THE NEW STAIRS ARE 2'-0" x 1'-0" x 1'-0" TO EXISTING STAIRS.
- 2) 2'-0" x 1'-0" COORD.
- 3) STAIRS ON PLAN TO BE LOCATED AT EXISTING POSITION.
- 4) NEW STAIR CORRIDOR (NEW) 10' x 10' STAIRS AREA.
- 5) EXISTING STAIR CORRIDOR (EXIST) 10' x 10' STAIRS AREA.
- 6) NEW STAIR CORRIDOR (NEW) 10' x 10' STAIRS AREA.
- 7) EXISTING STAIR CORRIDOR (EXIST) 10' x 10' STAIRS AREA.
- 8) NEW STAIR CORRIDOR (NEW) 10' x 10' STAIRS AREA.
- 9) EXISTING STAIR CORRIDOR (EXIST) 10' x 10' STAIRS AREA.
- 10) NEW STAIR CORRIDOR (NEW) 10' x 10' STAIRS AREA.
- 11) EXISTING STAIR CORRIDOR (EXIST) 10' x 10' STAIRS AREA.
- 12) NEW STAIR CORRIDOR (NEW) 10' x 10' STAIRS AREA.
- 13) EXISTING STAIR CORRIDOR (EXIST) 10' x 10' STAIRS AREA.
- 14) NEW STAIR CORRIDOR (NEW) 10' x 10' STAIRS AREA.
- 15) EXISTING STAIR CORRIDOR (EXIST) 10' x 10' STAIRS AREA.
- 16) NEW STAIR CORRIDOR (NEW) 10' x 10' STAIRS AREA.
- 17) EXISTING STAIR CORRIDOR (EXIST) 10' x 10' STAIRS AREA.
- 18) NEW STAIR CORRIDOR (NEW) 10' x 10' STAIRS AREA.
- 19) EXISTING STAIR CORRIDOR (EXIST) 10' x 10' STAIRS AREA.
- 20) NEW STAIR CORRIDOR (NEW) 10' x 10' STAIRS AREA.
- 21) EXISTING STAIR CORRIDOR (EXIST) 10' x 10' STAIRS AREA.
- 22) NEW STAIR CORRIDOR (NEW) 10' x 10' STAIRS AREA.
- 23) EXISTING STAIR CORRIDOR (EXIST) 10' x 10' STAIRS AREA.
- 24) NEW STAIR CORRIDOR (NEW) 10' x 10' STAIRS AREA.
- 25) EXISTING STAIR CORRIDOR (EXIST) 10' x 10' STAIRS AREA.
- 26) NEW STAIR CORRIDOR (NEW) 10' x 10' STAIRS AREA.
- 27) EXISTING STAIR CORRIDOR (EXIST) 10' x 10' STAIRS AREA.
- 28) NEW STAIR CORRIDOR (NEW) 10' x 10' STAIRS AREA.
- 29) EXISTING STAIR CORRIDOR (EXIST) 10' x 10' STAIRS AREA.
- 30) NEW STAIR CORRIDOR (NEW) 10' x 10' STAIRS AREA.

TABLE ACQUISITION SCHEDULE

NO.	QTY.	ITEM	MANUF. AND MODEL	FURNISHED BY	INSTALLED BY
01	1	1" ROUND, ONE END	ROBBER 666	C.C.	C.C.
02	2	4" ROUND BAR	ROBBER 666	C.C.	C.C.
03	2	4" ROUND BAR	ROBBER 666	C.C.	C.C.
04	2	4" ROUND BAR	ROBBER 666	C.C.	C.C.
05	4	STAINLESS STEEL TUBES	ROBBER 666	C.C.	C.C.
06	1	4" ROUND BAR	ROBBER 666	C.C.	C.C.
07	1	4" ROUND BAR	ROBBER 666	C.C.	C.C.
08	1	4" ROUND BAR	ROBBER 666	C.C.	C.C.
09	1	4" ROUND BAR	ROBBER 666	C.C.	C.C.
10	1	4" ROUND BAR	ROBBER 666	C.C.	C.C.
11	1	4" ROUND BAR	ROBBER 666	C.C.	C.C.
12	1	4" ROUND BAR	ROBBER 666	C.C.	C.C.
13	1	4" ROUND BAR	ROBBER 666	C.C.	C.C.
14	1	4" ROUND BAR	ROBBER 666	C.C.	C.C.
15	1	4" ROUND BAR	ROBBER 666	C.C.	C.C.
16	1	4" ROUND BAR	ROBBER 666	C.C.	C.C.
17	1	4" ROUND BAR	ROBBER 666	C.C.	C.C.
18	1	4" ROUND BAR	ROBBER 666	C.C.	C.C.
19	1	4" ROUND BAR	ROBBER 666	C.C.	C.C.
20	1	4" ROUND BAR	ROBBER 666	C.C.	C.C.
21	1	4" ROUND BAR	ROBBER 666	C.C.	C.C.
22	1	4" ROUND BAR	ROBBER 666	C.C.	C.C.
23	1	4" ROUND BAR	ROBBER 666	C.C.	C.C.
24	1	4" ROUND BAR	ROBBER 666	C.C.	C.C.
25	1	4" ROUND BAR	ROBBER 666	C.C.	C.C.
26	1	4" ROUND BAR	ROBBER 666	C.C.	C.C.
27	1	4" ROUND BAR	ROBBER 666	C.C.	C.C.
28	1	4" ROUND BAR	ROBBER 666	C.C.	C.C.
29	1	4" ROUND BAR	ROBBER 666	C.C.	C.C.
30	1	4" ROUND BAR	ROBBER 666	C.C.	C.C.

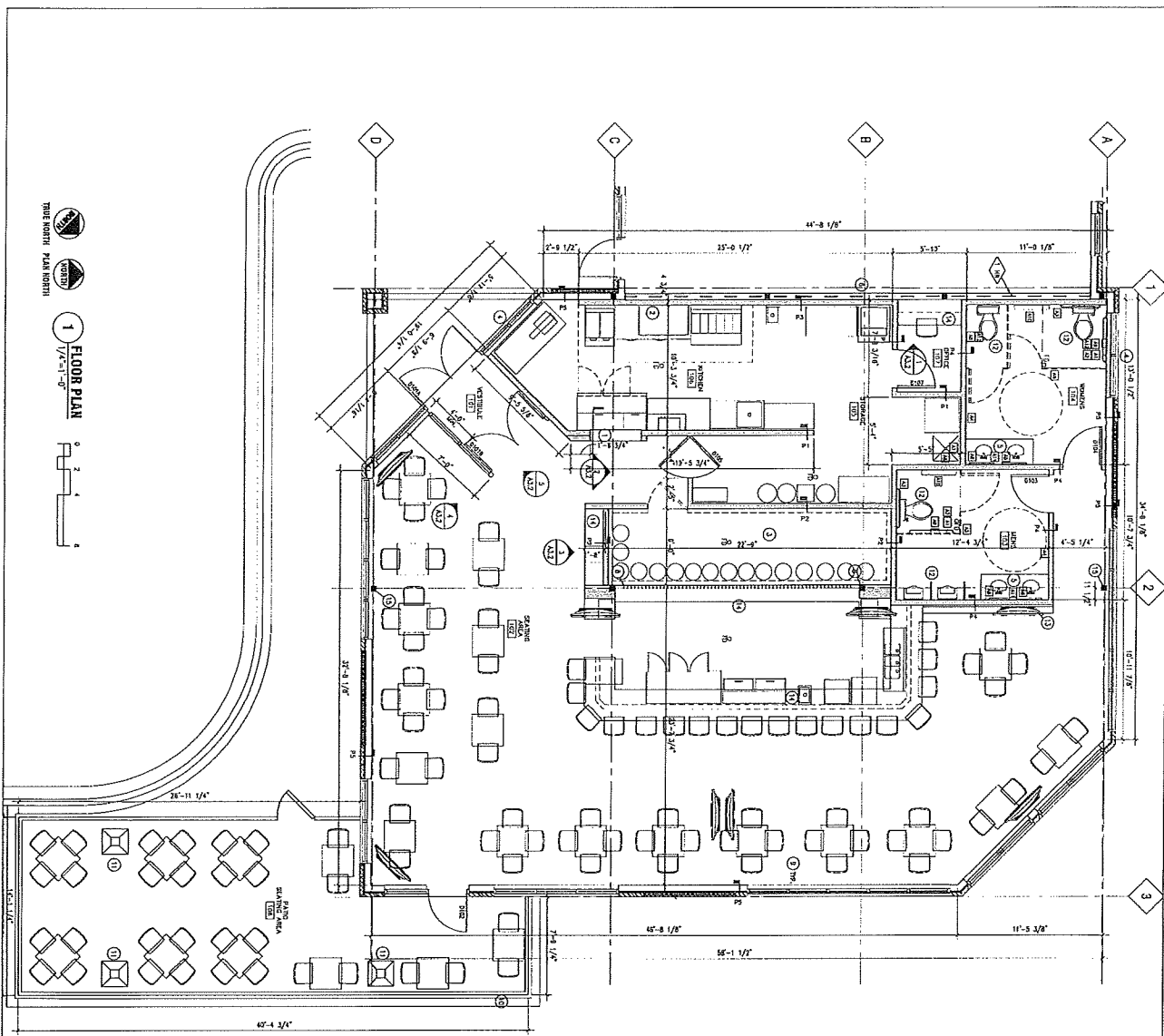

THE NORTH PLAN NORTH

1 FLOOR PLAN
1/4" = 1'-0"

GENERAL NOTES:

- 1. FINISHES: SEE FINISH SCHEDULE
- 2. ALL WORK SHALL BE IN ACCORDANCE WITH THE 2018 INTERNATIONAL RESIDENTIAL CODE BOOK (IRC) AND THE 2018 INTERNATIONAL MECHANICAL AND PLUMBING CODE (IMC).
- 3. ALL WORK SHALL BE IN ACCORDANCE WITH THE 2018 INTERNATIONAL ELECTRICAL CODE (IEC).
- 4. ALL WORK SHALL BE IN ACCORDANCE WITH THE 2018 INTERNATIONAL FIRE AND SAFETY CODE (IFSC).
- 5. ALL WORK SHALL BE IN ACCORDANCE WITH THE 2018 INTERNATIONAL ENERGY EFFICIENCY CODE (IEEC).
- 6. ALL WORK SHALL BE IN ACCORDANCE WITH THE 2018 INTERNATIONAL BUILDING DEPARTMENT (IBD).
- 7. ALL WORK SHALL BE IN ACCORDANCE WITH THE 2018 INTERNATIONAL CONSTRUCTION CODE (ICC).
- 8. ALL WORK SHALL BE IN ACCORDANCE WITH THE 2018 INTERNATIONAL PLUMBING AND MECHANICAL CODE (IPMC).
- 9. ALL WORK SHALL BE IN ACCORDANCE WITH THE 2018 INTERNATIONAL ELECTRICAL AND MECHANICAL CODE (IEMC).
- 10. ALL WORK SHALL BE IN ACCORDANCE WITH THE 2018 INTERNATIONAL FIRE AND SAFETY CODE (IFSC).
- 11. ALL WORK SHALL BE IN ACCORDANCE WITH THE 2018 INTERNATIONAL ENERGY EFFICIENCY CODE (IEEC).
- 12. ALL WORK SHALL BE IN ACCORDANCE WITH THE 2018 INTERNATIONAL BUILDING DEPARTMENT (IBD).
- 13. ALL WORK SHALL BE IN ACCORDANCE WITH THE 2018 INTERNATIONAL CONSTRUCTION CODE (ICC).
- 14. ALL WORK SHALL BE IN ACCORDANCE WITH THE 2018 INTERNATIONAL PLUMBING AND MECHANICAL CODE (IPMC).
- 15. ALL WORK SHALL BE IN ACCORDANCE WITH THE 2018 INTERNATIONAL ELECTRICAL AND MECHANICAL CODE (IEMC).

- FLOOR PLAN NOTES:**
1. FINISHES: SEE FINISH SCHEDULE
 2. ALL WORK SHALL BE IN ACCORDANCE WITH THE 2018 INTERNATIONAL RESIDENTIAL CODE BOOK (IRC) AND THE 2018 INTERNATIONAL MECHANICAL AND PLUMBING CODE (IMC).
 3. ALL WORK SHALL BE IN ACCORDANCE WITH THE 2018 INTERNATIONAL ELECTRICAL CODE (IEC).
 4. ALL WORK SHALL BE IN ACCORDANCE WITH THE 2018 INTERNATIONAL FIRE AND SAFETY CODE (IFSC).
 5. ALL WORK SHALL BE IN ACCORDANCE WITH THE 2018 INTERNATIONAL ENERGY EFFICIENCY CODE (IEEC).
 6. ALL WORK SHALL BE IN ACCORDANCE WITH THE 2018 INTERNATIONAL BUILDING DEPARTMENT (IBD).
 7. ALL WORK SHALL BE IN ACCORDANCE WITH THE 2018 INTERNATIONAL CONSTRUCTION CODE (ICC).
 8. ALL WORK SHALL BE IN ACCORDANCE WITH THE 2018 INTERNATIONAL PLUMBING AND MECHANICAL CODE (IPMC).
 9. ALL WORK SHALL BE IN ACCORDANCE WITH THE 2018 INTERNATIONAL ELECTRICAL AND MECHANICAL CODE (IEMC).
 10. ALL WORK SHALL BE IN ACCORDANCE WITH THE 2018 INTERNATIONAL FIRE AND SAFETY CODE (IFSC).
 11. ALL WORK SHALL BE IN ACCORDANCE WITH THE 2018 INTERNATIONAL ENERGY EFFICIENCY CODE (IEEC).
 12. ALL WORK SHALL BE IN ACCORDANCE WITH THE 2018 INTERNATIONAL BUILDING DEPARTMENT (IBD).
 13. ALL WORK SHALL BE IN ACCORDANCE WITH THE 2018 INTERNATIONAL CONSTRUCTION CODE (ICC).
 14. ALL WORK SHALL BE IN ACCORDANCE WITH THE 2018 INTERNATIONAL PLUMBING AND MECHANICAL CODE (IPMC).
 15. ALL WORK SHALL BE IN ACCORDANCE WITH THE 2018 INTERNATIONAL ELECTRICAL AND MECHANICAL CODE (IEMC).

NO.	QTY.	ITEM	MANUF. AND MODEL	FINISHED BY	INSTALLED BY
01	2	1" VERTICAL CURTAIN BAR	ROBICOR	CL	CL
02	2	3" VERTICAL CURTAIN BAR	ROBICOR	CL	CL
03	2	3" VERTICAL CURTAIN BAR	ROBICOR	CL	CL
04	2	3" VERTICAL CURTAIN BAR	ROBICOR	CL	CL
05	2	3" VERTICAL CURTAIN BAR	ROBICOR	CL	CL
06	2	3" VERTICAL CURTAIN BAR	ROBICOR	CL	CL
07	2	3" VERTICAL CURTAIN BAR	ROBICOR	CL	CL
08	2	3" VERTICAL CURTAIN BAR	ROBICOR	CL	CL
09	2	3" VERTICAL CURTAIN BAR	ROBICOR	CL	CL
10	2	3" VERTICAL CURTAIN BAR	ROBICOR	CL	CL
11	2	3" VERTICAL CURTAIN BAR	ROBICOR	CL	CL
12	2	3" VERTICAL CURTAIN BAR	ROBICOR	CL	CL
13	2	3" VERTICAL CURTAIN BAR	ROBICOR	CL	CL
14	2	3" VERTICAL CURTAIN BAR	ROBICOR	CL	CL
15	2	3" VERTICAL CURTAIN BAR	ROBICOR	CL	CL
16	2	3" VERTICAL CURTAIN BAR	ROBICOR	CL	CL
17	2	3" VERTICAL CURTAIN BAR	ROBICOR	CL	CL
18	2	3" VERTICAL CURTAIN BAR	ROBICOR	CL	CL
19	2	3" VERTICAL CURTAIN BAR	ROBICOR	CL	CL
20	2	3" VERTICAL CURTAIN BAR	ROBICOR	CL	CL
21	2	3" VERTICAL CURTAIN BAR	ROBICOR	CL	CL
22	2	3" VERTICAL CURTAIN BAR	ROBICOR	CL	CL
23	2	3" VERTICAL CURTAIN BAR	ROBICOR	CL	CL
24	2	3" VERTICAL CURTAIN BAR	ROBICOR	CL	CL
25	2	3" VERTICAL CURTAIN BAR	ROBICOR	CL	CL
26	2	3" VERTICAL CURTAIN BAR	ROBICOR	CL	CL
27	2	3" VERTICAL CURTAIN BAR	ROBICOR	CL	CL
28	2	3" VERTICAL CURTAIN BAR	ROBICOR	CL	CL
29	2	3" VERTICAL CURTAIN BAR	ROBICOR	CL	CL
30	2	3" VERTICAL CURTAIN BAR	ROBICOR	CL	CL
31	2	3" VERTICAL CURTAIN BAR	ROBICOR	CL	CL
32	2	3" VERTICAL CURTAIN BAR	ROBICOR	CL	CL
33	2	3" VERTICAL CURTAIN BAR	ROBICOR	CL	CL
34	2	3" VERTICAL CURTAIN BAR	ROBICOR	CL	CL
35	2	3" VERTICAL CURTAIN BAR	ROBICOR	CL	CL
36	2	3" VERTICAL CURTAIN BAR	ROBICOR	CL	CL
37	2	3" VERTICAL CURTAIN BAR	ROBICOR	CL	CL
38	2	3" VERTICAL CURTAIN BAR	ROBICOR	CL	CL
39	2	3" VERTICAL CURTAIN BAR	ROBICOR	CL	CL
40	2	3" VERTICAL CURTAIN BAR	ROBICOR	CL	CL
41	2	3" VERTICAL CURTAIN BAR	ROBICOR	CL	CL
42	2	3" VERTICAL CURTAIN BAR	ROBICOR	CL	CL
43	2	3" VERTICAL CURTAIN BAR	ROBICOR	CL	CL
44	2	3" VERTICAL CURTAIN BAR	ROBICOR	CL	CL
45	2	3" VERTICAL CURTAIN BAR	ROBICOR	CL	CL
46	2	3" VERTICAL CURTAIN BAR	ROBICOR	CL	CL
47	2	3" VERTICAL CURTAIN BAR	ROBICOR	CL	CL
48	2	3" VERTICAL CURTAIN BAR	ROBICOR	CL	CL
49	2	3" VERTICAL CURTAIN BAR	ROBICOR	CL	CL
50	2	3" VERTICAL CURTAIN BAR	ROBICOR	CL	CL

