

City of Madison, Wisconsin

REPORT OF: FAÇADE IMPROVEMENT GRANT STAFF TEAM

TO: URBAN DESIGN COMMISSION

Façade Improvement Grant Application:
1: 1402 Williamson Street

AUTHOR: Craig Wilson
Office of Economic Revitalization
Economic Development Division

DATED: May 3, 2017

SUMMARY:

On October 3, 2000, the Common Council adopted Resolution No. 61179, approving the Objectives and Criteria for the Façade Improvement Grant Program. The resolution specifies that all Façade Improvement proposals be referred to the Urban Design Commission for comments and recommendations.

Attached for your review is the following Facade Improvement proposal:

- 1. 1402 Williamson Street**
Grantee: FPB Enterprise LLC.

The scope of the exterior work will include:

- a. Replace all storefront glass and frames. Windows will have a horizontal break to create a upper transom of patterned translucent glass.**
- b. Installation of lit projecting sign.**
- c. Installation of light fixture over the entry.**
- d. Paint the metal coping atop masonry wall.**

See Attachments for Specifications

Total project cost for 1402 Williamson Street exterior work is estimated at \$19,829. Façade Improvement Grant not to exceed \$9,914

RECOMMENDATION:

1402 Williamson Street is located within the Third Lake Ridge Historic District. The Madison Landmarks Commission, at its meeting of May 1, 2017 reviewed and issued a Certificate of Appropriateness for the scope of work covered in this Façade Grant project.

The above Façade Improvement Grant proposal has been reviewed by the Façade Improvement Grant Program staff team and meets the requirements of the program. The Staff Team recommends approval of the above Facade Improvement Grant proposal.



CITY OF MADISON
FAÇADE IMPROVEMENT GRANT PROGRAM
Building and beautifying Madison, one storefront at a time



Department of Planning & Community & Economic Development
Economic Development Division
215 Martin Luther King Jr., Boulevard
Craig Wilson, 266-6557
cwilson@cityofmadison.com

PROGRAM APPLICATION

Applicant: FRB ENTERPRISE, LLC Phone: 608-235-2844
Business Name: % STEVE SILVERBERG
Building Name: 1402 WILLIAMSON STREET
Business Address: _____ Zip Code 53704
E-mail Address: ssilver2020@gmail.com
Property Owner: SAME AS ABOVE
Address: 448 W. WASHINGTON AVE, STE. 100 MADISON, WI. 53703
Name of Grantee: WA
Lease Terms: WA
Definition of Project Scope: REPLACEMENT OF STOREFRONT GLASS + DOORS, SIGNAGE, PAINTING, ETC.

ATTACHMENT

✓ Please provide photographs and copy of lease, land contract, or deed. Tenants must provide owner's written authorization.

PROJECT BUDGET

List Individual Project Elements (Awning, sign, painting of trim, etc.)	Total Cost	Grant \$	Private \$
<u>SEE ATTACHED SPREADSHEET</u>			
Total:			



CITY OF MADISON
FAÇADE IMPROVEMENT GRANT PROGRAM
Building and beautifying Madison, one storefront at a time

Department of Planning & Community & Economic Development
Economic Development Division
215 Martin Luther King Jr., Boulevard
Craig Wilson, 266-6557
cwilson@cityofmadison.com



Contractor/Supplier: OWNER WILL ACT AS GENERAL CONTRACTOR
Address: _____

ATTACHMENT

* Bids, estimates, and/or contracts, product brochures, locator map and design drawings, if appropriate.

REMARKS _____

APPLICANT'S CERTIFICATION

The Applicant certifies that all information in this application and all information furnished in support of this application is given for the purpose of obtaining a grant under the City of Madison Façade Grant Program and is true and complete to the best of the applicant's knowledge and belief.

Signature: Sh D. Silby, managing member Date: 4/12/2017
Signature: _____ Date: _____

Please send this completed application, accompanying materials, and application fee of \$100 to:

Economic Development Division
Attn: Craig Wilson
215 Martin Luther King Jr. Boulevard, Room 312
P.O. Box 2983
Madison, WI 53701-2983





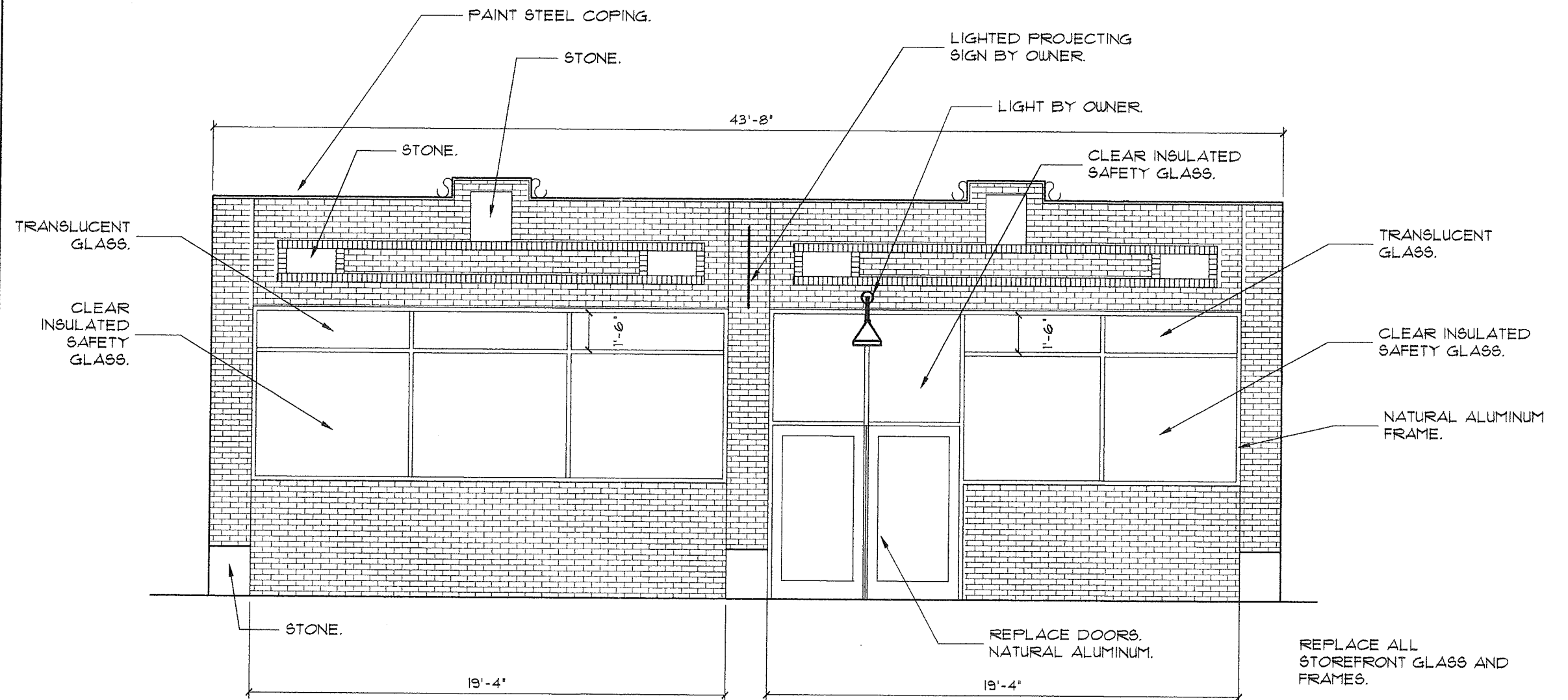

PROPOSED WILLIAMSON STREET FACADE

0 2 4 6 8 feet

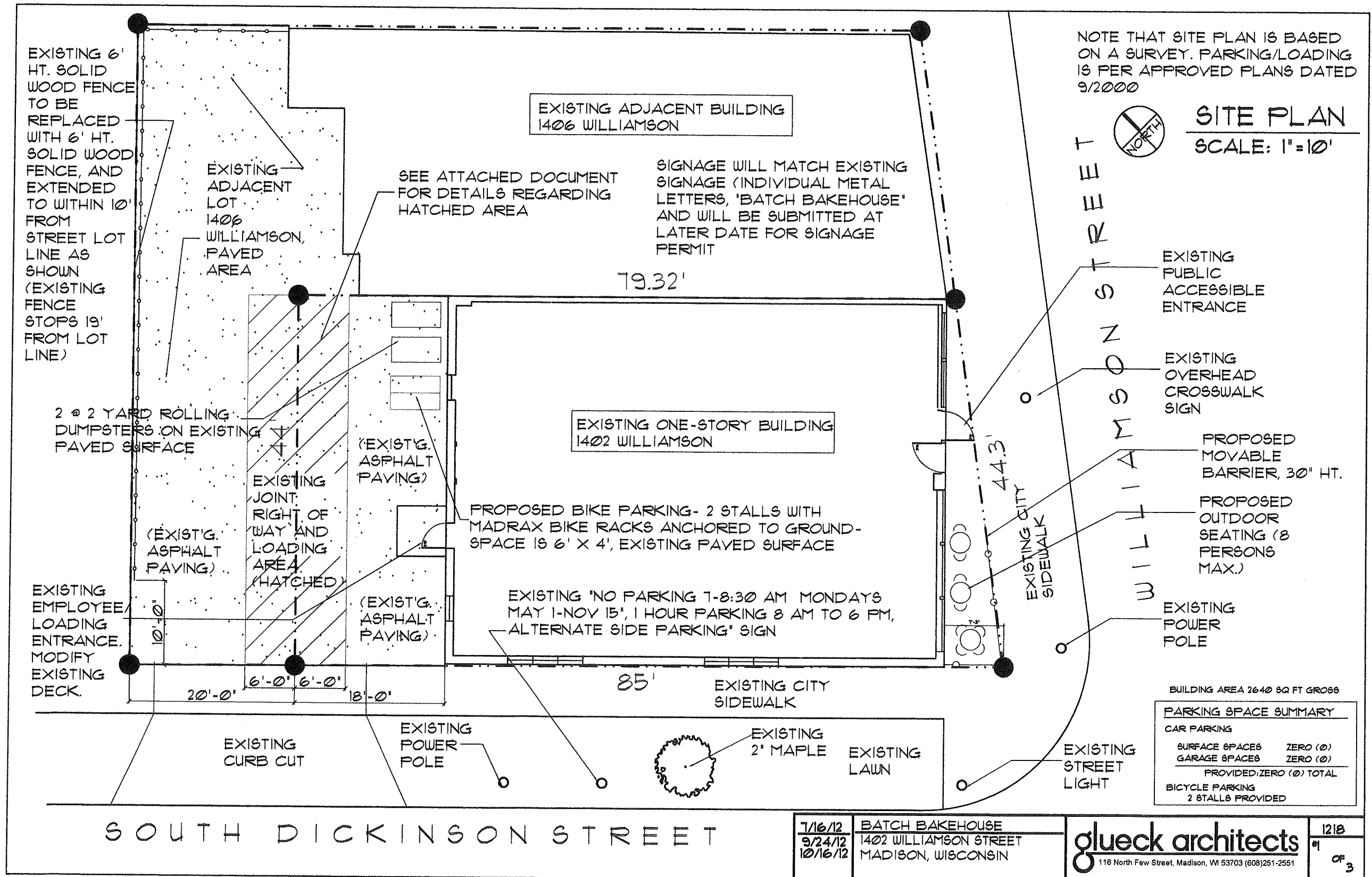

City Of Madison Facade Improvement Grant
1402 Williamson Street
FPB Enterprises LLC- Building Owner
Batch Bakehouse- Tenant

4/17/2017

Vendor	Description	Total Cost	Grant	Private
Martin Glass	Storefront/Doors/Custom Transom	\$14,573	\$7,286	\$7,286
TBD-Allowance	Storefront/Carpentry	\$1,000	\$500	\$500
Sign Bracket Store	Sign Bracket	\$1,003	\$502	\$502
Budget Signs	Sign Bracket	\$155	\$78	\$78
Braun Painting	Metal Coping Painting	\$1,640	\$820	\$820
Glueck Architects	Facade Plan	\$500	\$250	\$250
Keil Electric	Electrical	\$660	\$330	\$330
Exterior Entrance Fixture		\$298	\$149	\$149
Total		\$19,829	\$9,914	\$9,914

Batch Bakehouse Sign Permit Application - April 2017



2x2 inch tubular steel welded to a heavy duty mounting plate using universal straight arm bracket with 6 steel waterjet cut 1/4" thick bread shapes welded to top of main arm (french bread to be welded to top & bottom). Mounting bracket 6x6" with 4 - 3/8" thru holes for mounting. Color/Finish: textured black powder coat. Two 1.5" OD steel bracket rings mounted to bottom of arm for hanging name sign. 2 Guy wire rings for added support.

Two light bullets with galvanized steel arms are integrated into sign. Light bullets are PAR20 for precision lighting of Batch Bakehouse sign. Wire chase location TBD per electrical plan. 1/2" NPT female coupling attachment. Wire chase either bottom or right side, TBD by electrician.

Batch Bakehouse name sign will be 36x 12 inches, digitally printed on Alupanel. Blue color will be matched to cobalt lighting fixture installed above door. Hung from bracket with chain by sign installer.

Property line is 66" from sidewalk at install location. No projection into right-of-way.



ARCHITECTURAL SIGN BRACKETS

[Architectural Sign Brackets - All](#)
[Wall Mount Sign Brackets](#)
[Fixed Mount Sign Brackets](#)
[Lighted Wall Mount Sign Brackets](#)
[Single Post Sign Brackets](#)
[Ceiling Mount Sign Brackets](#)
[Street Sign Frames & Brackets](#)
[Sign Hanging Hardware](#)
[Real Estate Sign Products and Promotional Sign Supplies](#)

SIGN HARDWARE & SIGN MOUNTS

[Sign Hardware - All](#)
[Direct Sign Mounts | Corridor Sign Holders](#)
[Cheat Hangers & French Cleats](#)
[Sign Standoffs](#)
[Wall Mount Sign Hardware, Hardware For Signs](#)
[Post Mount Sign Hardware](#)
[Ceiling Mount Sign Hardware](#)
[Interior Displays & Brackets](#)
[Street Sign Mounting Brackets](#)
[Strap Banding Sign Hardware](#)
[Sign Hanging Hardware](#)
[Sign Security Hardware](#)

BANNER BRACKETS

[Banner Brackets- All](#)
[Wall Mounted Banner Brackets](#)
[Post Mount Banner Brackets](#)
[Banner Bracket Hardware](#)
[Lighted Banner Brackets](#)

SIGN & BUSINESS LIGHTING

[Lighting - All](#)
[Gooseneck Lighting - Aluminum - With Quickship Option](#)
[Flood/Spot Lights](#)
[Flood/Spot Lighting](#)
[Installation Accessories](#)
[Sign Lighting - Bullet Lights](#)
[Barn Lights, Barn Sconces & Barn Style Lighting](#)
[Street Lights, Street Lamps and Lighted Post Fixtures](#)
[Outdoor Wall Lighting Fixtures](#)

POST AND PANEL

[Post and Panel Signs - All](#)
[Architectural Post & Panel](#)
[Contemporary Post and Panel](#)
[Aluminum Posts](#)
[Post Finials](#)

Home > Architectural Sign Brackets > Lighted Wall Mount Sign Brackets > Lighted 50in. Universal Straight Arm Bracket for Hanging Signs

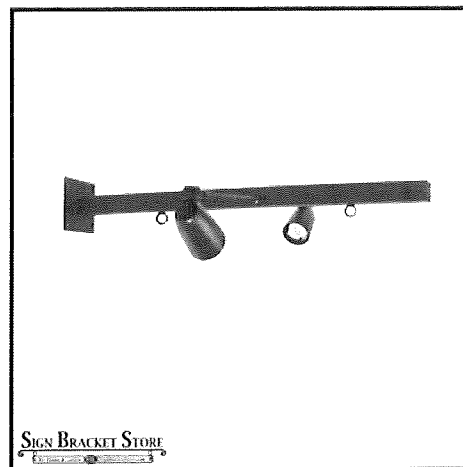

[Click to enlarge](#)

Code: 379B-WL-50-LKIT

Price: \$409.85

Availability: Usually ships in 2-3 weeks

Product Description:
 Main Arm: 50"L
 Backplate: 6"Sq.
 Ext. Arms: 24"L
Installation Hardware Not Included

Qty: 1

ADD TO CART

[Product Specifications PDF](#)

Description Dimensions

Make sure your business signage doesn't become invisible after sundown. Hanging sign brackets with lights ensure your storefront, office or building can be easily found by pedestrians and clients. This 50in. long straight arm bracket is manufactured with weather resistance in mind. Two by two inch tubular steel is welded to a heavy duty mounting plate; the arm extensions are galvanized steel and the light bullets are PAR20 for precision lighting. Highlight seasonal item changes or special events where foot traffic will be sure to see these. Customizable, so adapting this bracket to individual requirements is not a problem. Call or email us for a no obligations quote.

You May Also Like

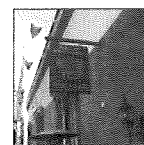

50" Straight Arm Sign Bracket with Rings
Price: \$199.85

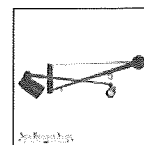

50" Triangle Ball Lighted Sign Bracket Kit
Price: \$339.85

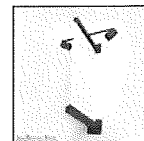

24" Montemar Lighted Pair Kit
Price: \$399.85

Customer Product Reviews

» [Click Here to Share Your Thoughts!](#)

WEIGHT: ~11-lbs

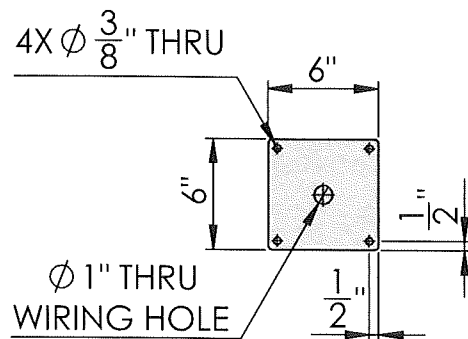
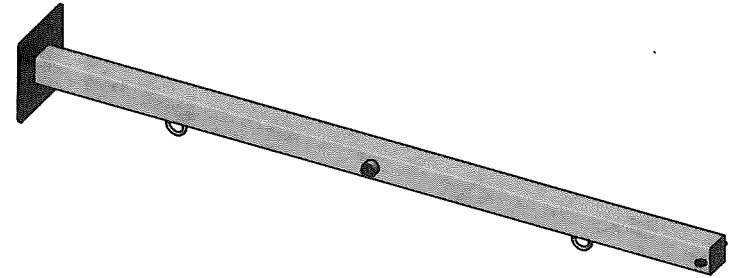

SIDE VIEW

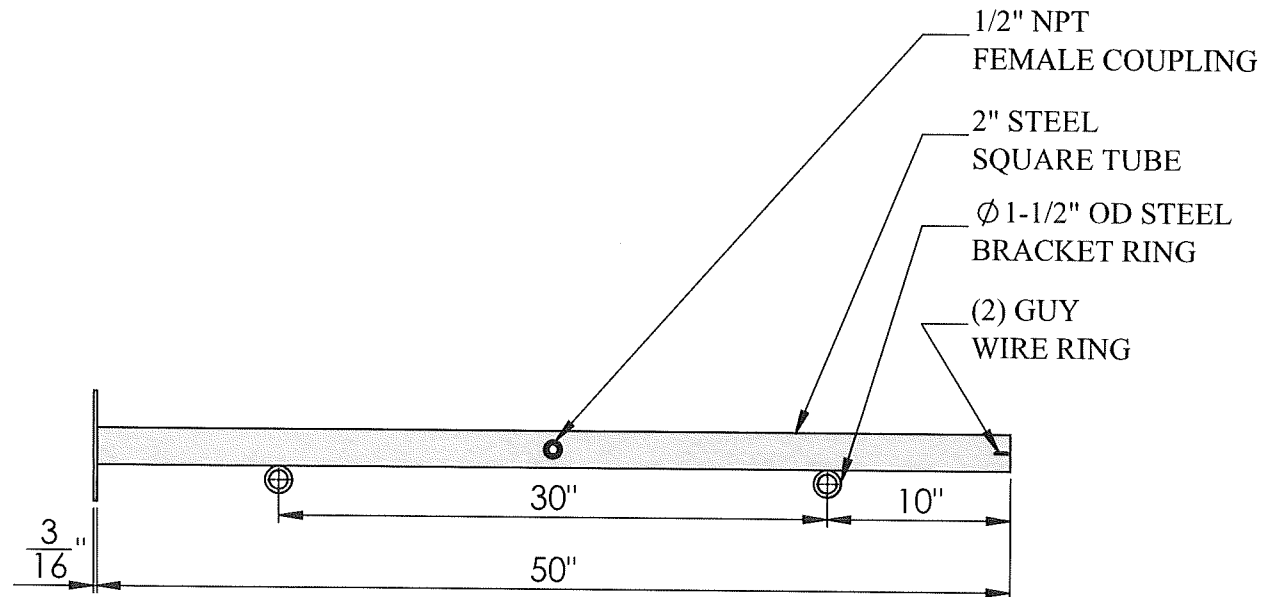

FRONT VIEW

Date: 06/2015
Scale: NTS
CB:
Order#:

Content: Lighted 50" Straight Arm Sign Bracket with Rings
PN: 379B-50-WL-RINGS
Color/Finish: Textured Black Powder Coat
Customer Approval: _____

Design by Sign Bracket Store. All visual representations and designs are the intellectual property of Sign Bracket Store and protected under copyright law. Any duplication of this design is in direct violation of the law and will result in legal action.
© Copyright 2008-2015



T: 888-919-7446

F: 760-603-0812

[Home](#) > [Commercial Lighting](#) > [Sign Lighting](#) > [Sign Lights](#) : The Goodrich® Fire Chief Porcelain Sign Light

The Goodrich® Fire Chief Porcelain Sign Light

CODE: BLE-G-ASFC

★★★★★

\$298.00



(hover over images to learn more)

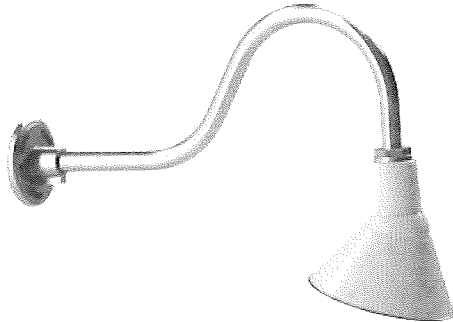

Click to enlarge

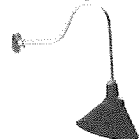

Shade Size:	14" Shade (+\$45.00)	▲▼
Finishes (?): *	750-Cobalt Blue (+\$15.00)	▲▼
Gooseneck Arms (?): *	G22 Gooseneck Arm (+\$99.00)	▲▼
Gooseneck Arm Finish: *	980-Brushed Aluminum	▲▼
Swivel Knuckle (?): *	None	▲▼
Wire Cage: *	None	▲▼
Guard & Glass (?):	None	▲▼
Cage or Guard Finish: *	N/A-Not Applicable	▲▼
Dusk-to-Dawn Photocell (?): *	None	▲▼
Socket Type (?): *	Standard Medium Base E26 Socket	▲▼

Qty: 1

ADD TO SHOPPING CART



Martin Glass

2323 Atwood Avenue
MADISON, WI 53704

PROPOSAL

Name / Address

Steve Silverberg
1147 Rutledge St.
Madison, WI 53703-3825

Date

4/6/2017

Estimate #

2017162042

Terms

Net 30

P.O. # or Location

1402 Williamson St

Description	Qty	Total
<p>We propose to remove existing storefront framing and glass at Batch Bakehouse, 1402 Williamson St, Madison, WI, for the Williamson St. side of the building only. We will replace doors with two new 42" x 84" clear anodized aluminum commercial doors and framing. We will use clear tempered insulated glass units in the doors. The doors will also have 10" bottoms for ADA compliance, continuous geared hinges, dead bolt locks, standard push/pull handles or push handle with custom pull provided by customer.</p> <p>Doors to have ramps made from threshold material in front to compensate for a 1" rise. Transom frames to have horizontal dividers to match window dividers.</p> <p>All windows to be divided like existing windows except with horizontal dividers approximately 2' down from the top. Glass for lower part of windows will be clear tempered. Glass for transoms will be clear annealed unless you approve one of the optional pattern glasses.</p> <p>This project will require approximately three days to complete.</p> <p>Installed Price Including Materials, Applicable Taxes and Labor.</p> <p>Should you wish to proceed, please sign and return a copy of this proposal.</p> <p>Options for pattern glass for the transoms are available. Please indicate your approval for any of these options:</p> <p><input type="checkbox"/> Master Carre insulated units--Add \$1998.36</p> <p><input checked="" type="checkbox"/> Autumn insulated units--Add \$1871.21</p> <p><input type="checkbox"/> Pattern 62 units--Add \$510.55</p> <p><input type="checkbox"/> Narrow Reeded--Add 1135.10</p> <p>Thank you.</p> <p>Sales Tax</p>		<p>12,701.43</p> <p>0.00</p>

TOTAL \$12,701.43

All material is guaranteed to be as specified, and the above work to be performed in accordance with the drawings and/or specifications submitted for above work, and completed in a substantial workmanlike manner.	
Any alteration or deviation from above specifications involving extra costs will be executed only upon written order and will become an extra charge over and above the estimate. All oversized units (exceeding 50 sq. ft.) tempered lites and IG units will be sold "as is" for any and all visual characteristics. Window washing is not part of the service provided by Martin Glass and is not included in installed prices.	
The proposed work is a Special Order. Once ordered, it cannot be cancelled. The party ordering the work is responsible for payment.	This proposal may be withdrawn by us if not accepted within 30 days. Respectfully submitted Martin Glass Date _____
The above prices, specifications and conditions are satisfactory and are hereby accepted. You are authorized to do the work as specified. Payments will be made as outlined above.	
Signature _____ Date _____	

Phone # (608) 249-0438

Fax # (608) 249-5433

martinglassmadison@gmail.com

www.martinglassmadison.com



EXAMPLE OF "AUTUMN" TRANSBOM GLASS

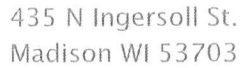

Name/Address
Batch Bakehouse 1402 Williamson St Madison WI 53703

Item	Description	Quantity	Cost	Total
2gcab	Cast Alum Box, 2 Gang	2	12.00	24.00
12emtta	1/2" EMT Conduit, Terminal Adapter	9	0.35	3.15
12emt	1/2" EMT Conduit	30	0.30	9.00
tap2	Tapcon Concrete Screw, 2"	30	0.28	8.40
2gcab	Cast Alum Box, 2 Gang cover	1	3.00	3.00
lbcabcover	Light Box, Cast Alum, Cover	4	6.00	24.00
lbcab	Light Box, Cast Alum.	4	8.00	32.00
st12oh	1/2" Strap, One Hole Type	10	0.25	2.50
12awg	Wire, 12 awg, Thhn Type	90	0.20	18.00
gndtail	Grounding Screw / Tail / Tap	5	0.15	0.75
s1time	Switch, Timer	1	50.00	50.00
Permisc	Electrical Permit	1	30.00	30.00
sdk	Master Electrician, Labor	7	65.00	455.00

Wire (3) Customer Supplied Light Fixtures on Exterior of Building	Total	\$659.80
---	--------------	-----------------

Braun Painting LLC

1 Black Stone Circle
Madison, WI 53719
608-770-1070
mike@braunpainting.com
braunpainting.com
www.facebook.com/braunpainting



Painting Proposal/Contract

Steve Silverberg

1402 Williamson St., Madison, WI

ssilver2020@gmail.com

I/We, the owner/s of the property above authorize and accept this proposal from Braun Painting to furnish all materials and labor necessary to paint the above property in a good, workmanlike and substantial manner according to the following terms and specifications:

Description of the work to be completed: Painting as described below:

BATCH Bakery Building

Exterior	Labor	Materials
Top steel cap, Dickerson St. side	\$2,052.00	\$123.12
Top steel cap, Williamson St. side	\$1,548.00	\$92.88
1. Scrape, sand steel cap to remove loose, failing paint and oxidation		
2. Prime surfaces with oil-based rust-inhibiting primer		
3. Apply two coats Sherwin Williams exterior "Super Paint" in satin finish for optimal UV/moisture durability		
Subtotals:	\$3,600.00	\$216.00
Grand total	\$3,816.00	

Notes:

Contractor to provide proof of insurance upon request.
Customer understands that exterior work is weather dependent.

Thank you for the opportunity to earn your business!

Payment:

Braun Painting proposes to perform the above work, (plus any additions/minus any deductions mutually agreed to during the process of completion), for the

Total Sum of \$3,816.00 | **Down payment (if any): 0.00**

Payment to be made as follows: upon completion

Approximate Start Date: TBD

Approximate Completion Date: TBD

Acceptance:

This proposal is approved and accepted. These written terms represent the entire agreement between parties. Changes to this agreement will be completed in writing. Changes may incur additional charges. Customer acknowledges that all work has been completed in an acceptable fashion by providing payment.

Approved and Accepted (Owner)

Date

Michael Braun

4/12/2017

Approved (Contractor)

Date

Michael Braun-Braun Painting



Sign Bracket Store
6056 Corte Del Cedro
Carlsbad, CA, 92011
Phone: 888-919-7446
www.signbracketstore.com

Quote

Quote #: QT1001208
Quote Date: 4/6/2017
Quote Expire Date: 5/6/2017
Customer ID: 1027839

BILL TO:			SHIP TO:		
FPB Enterprises 1402 Williamson St Madison WI 53703 UNITED STATES			Batch Bakehouse 1402 Williamson St Madison WI 53703 UNITED STATES 608-257-1652 x101 Attn: Susan Detering		
CUSTOMER P.O. NO.		TERMS			
		Prepaid			
FOB POINT		SHIPPING TERMS		SHIP VIA	
		Standard		UPS Ground	
NO.	QTY.	ITEM	PRICE	UOM	EXTENDED PRICE
1	1.0000	CUSTOM ITEM: 54" Lighted Universal Straight Arm bracket with (6) steel waterjet cut 1/4" thick bread shapes welded to top of main arm (french bread shape to be 2 pieces with bottom/ top part). Guy wire rings added for support. Lights/ arms included.	1,003.4100	EA	1,003.41

NOTE: Lead time is 3-4 weeks + transit

Sales Total: 1,003.41
Freight & Misc.: 51.49
Tax Total: 0.00
Total (USD): 1,054.90

Quotes are valid for 30 days. Lead times are approximate and may be extended due to unforeseen circumstances. Production begins when we receive deposit and approved shop drawings. Once order is in production, it may not be cancelled. All sales are final. Thank you for your interest in our products.