

2016 GARNER PARK TENNIS TO PICKLEBALL-COURT CONVERSION
CONTRACT 7660

GARNER PARK
333 S ROSA ROAD
MADISON, WI 53705

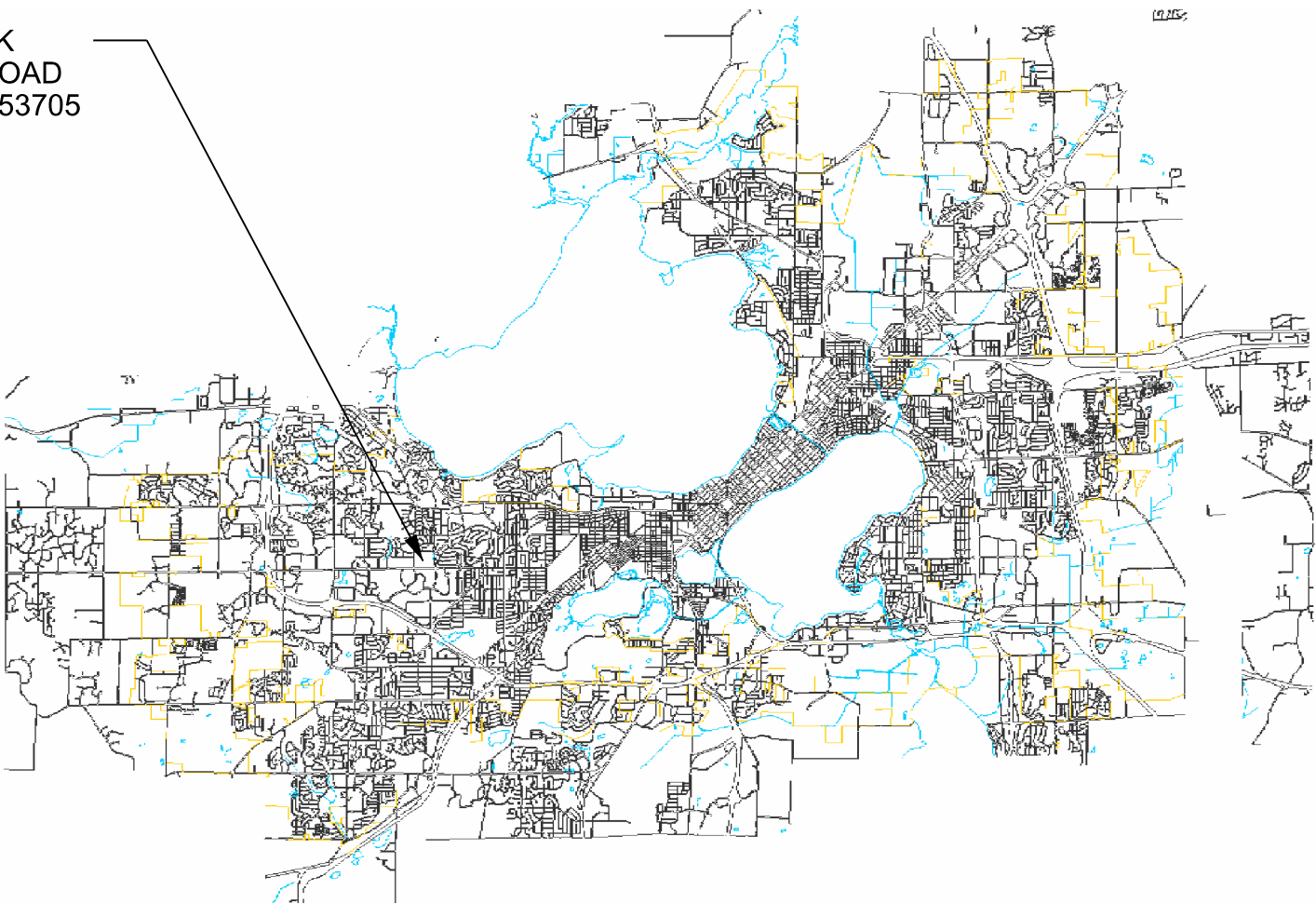

City of Madison
Department of Public Works
PARKS DIVISION

City-County Building, Suite 104
210 Martin Luther King, Jr. Blvd.
PO Box 2987
Madison, WI 53701-2987

play
**MADISON
PARKS**



PROJECT: **2016 GARNER
PARK TENNIS TO
PICKLEBALL
COURT
CONVERSION**

Although every effort has been made in preparing these plans and checking them for accuracy, the contractor and subcontractors must check all details and dimensions of their trade and be responsible for the same.

ITEM	DATE
Revised: KK	02-24-2016
Drawn by: KK	02-05-2016

PUBLIC WORKS PROJECT #:
7660

SHEET TITLE:

SHEET NUMBER:



City of Madison
Department of Public Works
PARKS DIVISION

City-County Building, Suite 104
210 Martin Luther King, Jr. Blvd.
PO Box 2987
Madison, WI 53701-2987

play
**MADISON
PARKS**

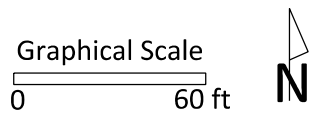

PROJECT:
**2016 GARNER
PARK TENNIS TO
PICKLEBALL-COURT
CONVERSION**

**GARNER PARK
333 S ROSA ROAD
MADISON, WI 53705**

Although every effort has been made in preparing these plans and checking them for accuracy, the contractor and subcontractors must check all details and dimensions of their trade and be responsible for the same.

ITEM	DATE
For bid:	
Revised: KK	02-24-2016
Drawn by: KK	01-15-2016

PUBLIC WORKS PROJECT #:
7660

SHEET TITLE:
**PROJECT LOCATION
AND SITE ACCESS**

SHEET NUMBER:
1.1

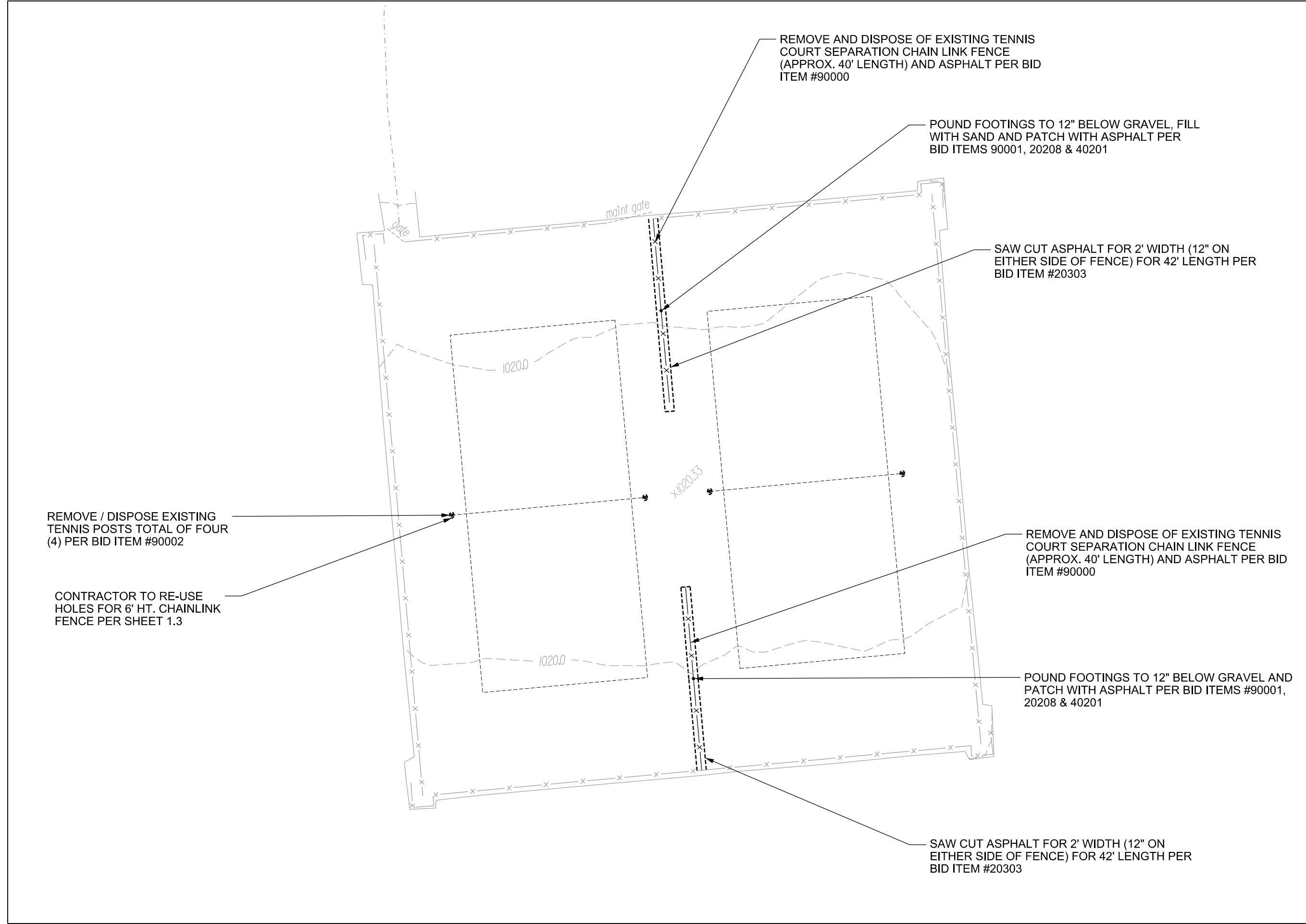

City of Madison
Department of Public Works
PARKS DIVISION
*City-County Building, Suite 104
210 Martin Luther King, Jr. Blvd.
PO Box 2987
Madison, WI 53701-2987*
**play
MADISON
PARKS**

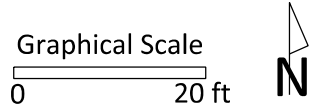

PROJECT:
**2016 GARNER
PARK TENNIS TO
PICKLEBALL-COURT
CONVERSION**

**GARNER PARK
333 S ROSA ROAD
MADISON, WI 53705**

Although every effort has been made in preparing these plans and checking them for accuracy, the contractor and subcontractors must check all details and dimensions of their trade and be responsible for the same.

ITEM	DATE
For bid:	
Revised: KK	02-24-2016
Drawn by: KK	01-15-2016

PUBLIC WORKS PROJECT #:
7660

SHEET TITLE:
**DEMOLITION AND
SITE PROTECTION PLAN**

SHEET NUMBER:
1.2

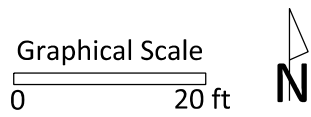

PROJECT:
**2016 GARNER
PARK TENNIS TO
PICKLEBALL-COURT
CONVERSION**

**GARNER PARK
333 S ROSA ROAD
MADISON, WI 53705**

Although every effort has been made in preparing these plans and checking them for accuracy, the contractor and subcontractors must check all details and dimensions of their trade and be responsible for the same.

ITEM	DATE
For bid:	
Revised: KK	02-24-2016
Drawn by: KK	01-15-2016

PUBLIC WORKS PROJECT #:
7660

SHEET TITLE:
SITE PLAN

SHEET NUMBER:
1.3

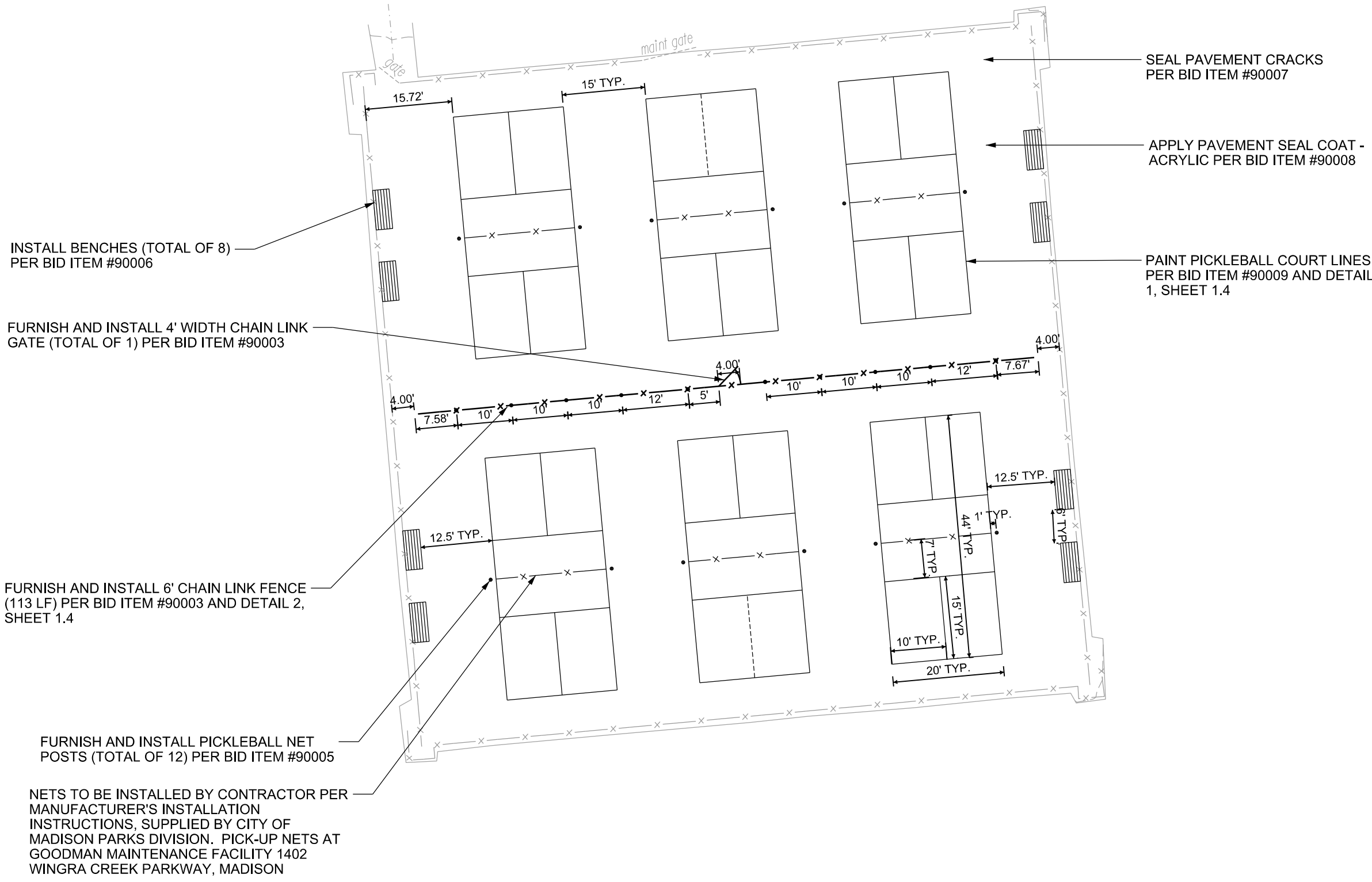

3.) WIDTH FOR ALL COURT LINES IS TWO INCHES (2")



Notes:
For existing blacktop, core a hole no bigger than the post and drive the post 6' deep.

2 6' CHAIN LINK FENCE
NTS

play
**MADISON
PARKS**

*GARNER PARK
333 S ROSA ROAD
MADISON, WI 53705*

1.4