

AFFIDAVIT OF MAILING

STATE OF WISCONSIN)
) ss.
COUNTY OF DANE)

 JOHANNA JOHNSON, being first duly sworn on oath, deposes and says that:

1. She is a Program Assistant 3 with the Office of the City Engineer, City of Madison, Dane County, Wisconsin, and did on the 4 day of DECEMBER, 2015 placed in envelopes addressed to each interested owner of respective addresses as indicated by attached assessment list, a true and correct copy of the notice of assessments for the project titled **COTTAGE GROVE ROAD AND DEMPSEY ROAD STREET ASSESSMENT DISTRICT - 2016** attached hereto.
2. She did and delivered the envelopes to the Mail Room of the Dane County Printing and Services Division, 210 Martin Luther King, Jr. Blvd., in the city of Madison, Dane County Wisconsin, for postage and depositing in the United States Mail.

Johanna L. Johnson

Johanna L. Johnson

Subscribed and sworn to before me
this 4 day of DECEMBER, 2015

Jean K. Phelps

Jean K. Phelps

Notary Public, State of Wisconsin
My Commission expires: *6/02/2018*

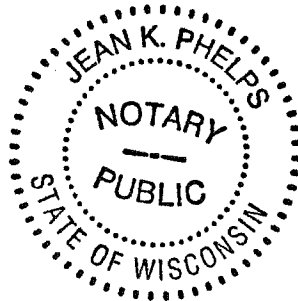



Department of Public Works
Engineering Division
Robert F. Phillips, P.E., City Engineer

Parcel Number: 0710-091-0401-0
Situs Address: 705 Dempsey Rd
KREITER, BRYAN D
DONALD C KREITER
705 DEMPSEY RD
MADISON, WI 53714-3021

Assistant City Engineer
Michael R. Dailey, P.E.
Principal Engineer2
Gregory T. Fries, P.E.
Christopher J. Petykowski, P.E.
Principal Engineer1
Christina M. Bachmann, P.E.
Eric L. Dundee, P.E.
John S. Fahrney, P.E.
Facilities & Sustainability
Jeanne E. Hoffman, Manager
Operations Manager
Kathleen M. Cryan
Mapping Section Manager
Eric T. Pederson P.S.
Financial Manager
Steven B. Danner-Rivers

December 4, 2015

To: Property Owners along Cottage Grove Road and Dempsey Road
Re: Project No. 53W1681 Proposed Street Reconstruction Project & Public Hearing

The City of Madison is proposing reconstruct the above referenced streets in 2016. Enclosed with this letter is a fact sheet with some details on the proposed project along with a notification for the Public Hearing before the Board of Public Works. The date, time and location of the public hearing can be found on the notification.

This project will involve special assessments to the owners of property adjacent to the project. The property owners will be assessed for various items included with this proposed project. The costs of some items are shared between the property owner and the City, while other costs are assessed entirely to the property owner. A table detailing the City's standard assessment policy for these items is included in the fact sheet.

Also enclosed is a Schedule of Assessments, which shows the property owner's share of estimated costs for each property adjacent to the project. After the work is complete, a final assessment will be calculated based on bid prices and work actually performed. The final assessment, which will be billed after the completion of the project, is payable in one lump sum or over a period of 8 years, with 3.0% interest charged on the unpaid balance.

To request accommodations for special needs or disabilities, or if you have any other questions regarding this project, please contact the Project Engineer. This includes requests relating to the Public Hearing and also requests relating to the actual operations of construction. A list of contacts for this project can be found on the enclosed fact sheet.

Sincerely,

Robert F. Phillips, P.E.
City Engineer

RFP:lrc
Cc by email:

Alder David Ahrens	Scott Langer, Traffic Engineering
Corey Stelljes, City Engineering	Chris Petykowski, City Engineering
Chris Kelley, Streets Division	Christy Bachmann, City Engineering
Dane County 911	Peter Holmgren, Water Utility
Yang Tao, Traffic Engineering	Tim Sobota, Madison Metro Transit
Marla Eddy, City Forestry	Dane County 911
Ed Ruckriegel, Fire Department	
Cindy Mierow, Police Department	
Michael LaCount, MMSD mlacount@madison.k12.wi.us	
Mick Howan, Madison School District Transportation, mjhowan@madison.k12.wi.us	
De'Kendrea Stamps, Madison School District Transportation, dbstamps@madison.k12.wi.us	
Jeff Fedler, Madison School District Transportation Coordinator, jfedler@madison.k12.wi.us	

Bob Byington, Madison School District Transportation, rbyington@madison.k12.wi.us
Sandra Mell, Madison School District Transportation, smell@madison.k12.wi.us
Jason Fenske, Badger Bus Lines, jasonf@badgerbus.com
Matt Beisser, Principal St. Dennis School, principal@st-dennisschool.org
Father Randy Timmerman, Pastor St. Dennis Parish, pastor@stdennisparish.org
Paul VanderVelde, YMCA paul.vandervelde@ymcadanecounty.org
Kathy Soukup, Eastmorland Community Association kathys@gmail.com

Fact and Details Sheet

Proposed 2016 Cottage Grove Road and Dempsey Road Project

Project Details – Proposed Work

Street: Existing street ratings (out of 10) – Cottage Grove: Pavement 6 & Curb 7.
Dempsey: Pavement 4-5 & Curb 7-8 (no existing curb south of Cottage Grove).

Scope of Work Cottage Grove: New pavement, curb & drive aprons. Sidewalk replace as necessary. Widen road to add bike lanes both directions, add medians/islands, improve cross walks and add turn lanes. Add parking lane north side between Royster Oaks and Dempsey (*curb, drive aprons & sidewalk assessable*).

Scope of Work Dempsey: New pavement, curb & drive aprons (North of railroad tracks, only limited curb and driveway replacement). Save most of ex. curb on the east side of the road south of railroad tracks and north of Cottage Grove. Add curb south of Cottage Grove. Spot repairs of the sidewalk. Add off-street bike path west side of street between Capital City Trail and Cottage Grove (*curb, drive aprons & sidewalk assessable*).

Sanitary Sewer: Replace existing mains (installed in 1950's), and replace laterals from the main to the property line. Some of the existing sanitary sewer main on Dempsey south of railroad tracks will not be replaced (*laterals assessable*).

Water Main: Replace the existing water mains (installed in 1950's), and reconnect services to the new main. Water replace continues to the east past project limits, to approx. 175' east of Claire Street. Existing water main will not be replaced on Cottage Grove between Johns and Dempsey (installed in 1980's).

Storm Sewer: Replace and extend storm sewer (installed in 1950's & 1960's), connect to private storm (typically from private parking lots, sump pumps or downspouts). If you are aware of any existing private storm sewer or private connections (either to the curb or to a structure) from your property please contact the storm engineer, Corey Stelljes (*private connections assessable*).

Street Lights: Update street lighting w/ area lights.

Terrace Areas: Existing concrete terrace walkways will be replaced with the project, unless the property owner requests that they are removed. The entire terrace area will likely be disturbed during the project, so owners should remove any plantings or special landscaping features from the terrace area, prior to the start of construction.

Trees: Cottage Grove - 5 tree removals on Cottage Grove due to geometric changes. Affected addresses: 109 Cott Gr, 208 Cott Gr, 209 Cott Gr, (2 trees), 216 Cott Gr.
Dempsey- 8 tree removals due to preemptive ash removal or poor condition. Affected addresses: 702 Dempsey, 709 Dempsey, 713 Dempsey (3 trees), 727 Dempsey, 734 Dempsey, and 718 Cottage Ct. Terrace areas will be evaluated by Forestry for new trees or replacements following the project.

Project Website:
<http://www.cityofmadison.com/engineering/projects/cottage-grove-road-monona-dr-to-dempsey-rd>

Construction Schedule & Impacts

Tentative Schedule: Mid-April into Autumn 2016

Traffic Impacts: Two lanes (one lane in each direction) will be maintained on Cottage Grove throughout construction. Dempsey will be closed to through traffic (open to local traffic only) within the project limits. Busses will be detoured during construction. Parking will be removed for the project duration. Residential driveways may be closed for up to 2 weeks; access to commercial driveways will be maintained throughout construction.

Water Shut-offs: An average of two water shut-offs are expected for each property within the project limits. A minimum of 48 hours of notice will be provided prior to the shut-offs. Each shut-off may last up to 8 hours, but typically last about 4 hours. At the start of construction, the existing main will remain in service until the new main is installed and connected to; emergency shut-offs may occur if the old, brittle main is damaged during construction.

Refuse Collection: The Contractor will allow for refuse collection to continue during construction. Please mark your address on your residential cart and have it out before 7AM.

Project Location Map

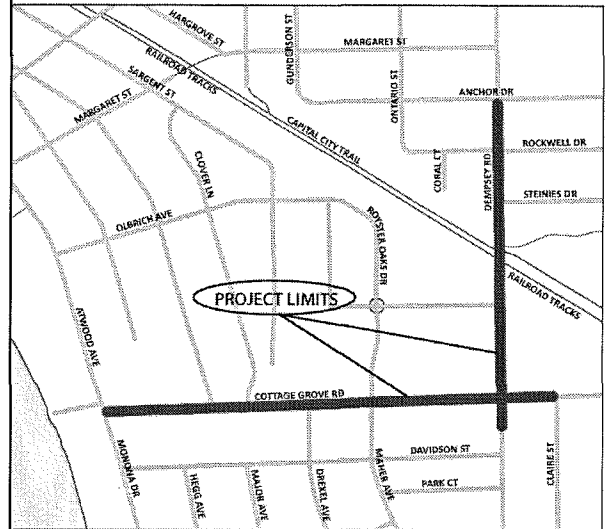

Project Contacts

Project Manager: Lisa Coleman – 266-4093,
lcoleman@cityofmadison.com

Traffic: Tom Mohr – 267-8725,
tmohr@cityofmadison.com

Storm Sewer and Sanitary Sewer:
Corey Stelljes 267-9721,
cstelljes@cityofmadison.com

Water: Peter Holmgren – 261-5530,
pholmgren@madisonwater.org

Construction: John Fahrney – 266-9091,
jfahrney@cityofmadison.com

Forestry: Dean Kahl – 266-4891,
dkahl@cityofmadison.com

Businesses: Peggy Yessa, Economic Devel.
267-8721, pyessa@cityofmadison.com

Assessment Policy Breakdown

Item	City Share	Owner Share
Existing Curb, Sidewalk,		
Drive aprons	50%	50%
Sanitary Laterals	75%	25%
Where no ex. curb: Curb + 4' Pavement	0%	100%
Private Storm Connection	0%	100%
Street Lighting	0%	100%
Sidewalk Ramps	100%	0%
Sanitary & Storm Mains	100%	0%
Water Main	100%	0%

Assessments are payable as a lump sum or over 8 years with 3% interest.

**NOTICE OF PUBLIC HEARING
BEFORE THE BOARD OF PUBLIC WORKS
FOR
PLANS, SPECIFICATIONS, AND SPECIAL ASSESSMENTS
FOR
PUBLIC WORKS IMPROVEMENTS
MADISON, WISCONSIN**

PART I

The Common Council of the City of Madison, Wisconsin, having heretofore decided that it is expedient and necessary that the improvements as listed in Part II hereof be improved at the expense of the property thereby on which would be conferred some special benefit.

NOW, THEREFORE, NOTICE IS HEREBY GIVEN:

That the City Engineer has prepared plans, specifications, a proposed schedule of assessments, and an estimate of the entire costs of the improvement for each of the districts listed in Part II hereof, and;

That the plans, specifications, a proposed schedule of assessments, and an estimate of the entire cost of the improvements listed hereto are available and open to inspection by all interested persons in the office of the City Engineer, Room 115, City-County Building, 210 Martin Luther King Jr. Blvd., between the hours of 7:30 a.m. and 4:00 p.m., Monday through Friday, and will so continue to be for ten (10) working days from the first published date of this notice, and;

That on WEDNESDAY, DECEMBER 16, 2015 AT 5:30 P.M., the Board of Public Works will hold a public hearing in ROOM 108 (PARKS CONFERENCE ROOM) OF THE CITY COUNTY BUILDING and will consider any objections that may be filed in writing or in person and hear all persons desiring to be heard, and;

That special assessments may be paid over an eight (8) year period, with the owner paying 1/8 of the principal each year plus three (3%) percent interest on the unpaid balance, as determined by the Board of Public Works.

That if the total assessment is paid in full before October 31st in the year that the billing is made, irrespective of project completion, then no interest shall be charged.

If you require an interpreter, materials in alternate formats, or other accommodations to access this public hearing, please contact the Engineering Division at phone (608) 266-4751 or email us at engineering@cityofmadison.com. Please make contact at least 24 hours prior to the date of this public hearing so that we can make proper accommodations.

PART II

RESURFACING 2016 – ASSESSMENT DISTRICT
HILLCREST DRIVE AND HILLCREST CIRCLE ASSESSMENT DISTRICT – 2016
COTTAGE GROVE ROAD AND DEMPSEY ROAD STREET ASSESSMENT DISTRICT – 2016
UTILITY REPLACEMENT WITH RESURFACING 2016 ASSESSMENT DISTRICT
2016 SOUTH PARK STREET SANITARY ASSESSMENT DISTRICT

By Order of the Board of Public Works
Madison, Wisconsin

PUB: WSJ DECEMBER 4, 2015

City of Madison Engineering Division - Schedule of Assessments

12/4/2015

Project ID: Project Name: Cottage Grove Road and Dempsey Road Street Assessment District - 2016

53W1681 Project Limits: Monona Drive to Claire Street; CG Road to Anchor Drive

NOTE: A factor has been applied for sidewalk and curb and gutter work adjacent to lots that abut more than one street and are single-family or two-family residential dwellings.

* Street lighting assessments for corner parcels are adjusted for previous lighting assessments on Monona Dr, Royster Oaks Dr, Dempsey Rd and Pinney St.

Parcel No.	Owner's Name / Mailing Address	Site Address	Frontage (Assessor's) Linear feet	Street Reconstruction Items												Sanitary Sewer Items		Storm Sewer Items		Street Lighting*				Total Assm't							
				Remove Drive Apron @ \$1.50 per SF		Replace Drive Apron @ \$4.00 per SF		Remove Sidewalk @ \$1.50 per Square Ft (SF)		Replace Sidewalk @ \$3.00 per Square Ft (SF)		Remove & Replace Curb & Gutter @ \$18.00 per Linear Foot (LF)		Remove & Replace Asphalt Drive Apron @ \$27.00 per SF		New Curb Pavement & Curb \$52.00 per LF		Sanitary Sewer Reconnect @ \$410.00 Each		Remove & Replace Sanitary Lateral @ \$21.11 per LF		Private Storm Sewer Connection @ \$2,000.00 Each			Assessed Frontage	Zone Factor	Factored Frontage	Street Lighting @ \$13.98 per Factored LF			
				SF	Cost	SF	Cost	Factor	SF	Cost	Factor	SF	Cost	Factor	LF	Cost	LF	Cost	Each	Cost	LF	Cost	Each		Cost	LF	LF	LF	per Factored LF		
0710-092-2701-0	RDC DEVELOPMENT LLC 4605 DOVETAIL DR MADISON WI	551 Pinney St.	125.28 L.F. Dempsey	0.00	\$0.00	0.00	\$0.00	1.0	626.40	\$939.60	1.0	626.40	\$1,879.20	1.0	35.00	\$630.00	0.00	\$0.00	0.00	\$0.00	0.00	\$0.00	0.00	\$0.00	125.28	2.00	250.56	\$3,502.29	\$6,951.09		
0710-092-2520-4	RDC DEVELOPMENT LLC 4605 DOVETAIL DR MADISON WI	526 Pinney St	196.76 L.F. Dempsey	0.00	\$0.00	0.00	\$0.00	1.0	0.00	\$0.00	1.0	0.00	\$0.00	1.0	0.00	\$0.00	0.00	\$0.00	0.00	\$0.00	0.00	\$0.00	0.00	\$0.00	98.38	2.00	196.76	\$2,750.28	\$2,750.28		
0710-092-1727-7	RDC DEVELOPMENT LLC 4605 DOVETAIL DR MADISON WI	926 Royster Oaks Drive	212.8 L.F. Cott Gr	0.00	\$0.00	0.00	\$0.00	1.0	0.00	\$0.00	1.0	0.00	\$0.00	1.0	50.00	\$900.00	0.00	\$0.00	0.00	\$0.00	0.00	\$0.00	0.00	\$0.00	212.80	2.00	425.60	\$5,948.98	\$6,848.98		
0710-091-0825-2	AMERICAN FAMILY INSURANCE CORP REAL ESTATE 6000 AMERICAN PKY MADISON WI	718 Cottage Ct	114.7 L.F. Dempsey	141.00	\$211.50	141.00	\$564.00	1.0	25.00	\$37.50	1.0	25.00	\$75.00	1.0	62.00	\$1,116.00	0.00	\$0.00	0.00	\$0.00	53.00	\$1,118.83	0.00	\$0.00	114.70	0.00	0.00	\$0.00	\$3,532.83		
0710-092-2410-7	COTTAGE GROVE INV LLC ETAL SWALGREEN STR 03393 PO BOX 1159 DEERFIELD IL	104 Cottage Grove Rd	269.10 L.F.	211.00	\$316.50	211.00	\$844.00	1.0	25.00	\$37.50	1.0	25.00	\$75.00	1.0	45.00	\$810.00	0.00	\$0.00	0.00	\$0.00	0.00	\$0.00	1.00	\$2,000.00	134.55	2.00	269.10	\$3,761.44	\$7,844.44		
0710-093-0313-3	MALCHESKI, JAMES E 3900 MONONA DR MADISON WI	109 Cottage Grove Rd	92.10 L.F.	0.00	\$0.00	0.00	\$0.00	1.0	100.00	\$150.00	1.0	100.00	\$300.00	1.0	35.00	\$630.00	0.00	\$0.00	0.00	\$0.00	1.00	\$410.00	29.00	\$612.19	1.00	\$2,000.00	92.10	2.00	184.20	\$2,574.72	\$6,676.91
0710-092-2314-1	RICE, MADELINE J PO BOX 8685 MADISON WI	208 Cottage Grove Rd	300.50 L.F.	3.00	\$4.50	3.00	\$12.00	1.0	0.00	\$0.00	1.0	0.00	\$0.00	1.0	110.00	\$1,980.00	0.00	\$0.00	0.00	\$0.00	0.00	\$0.00	1.00	\$2,000.00	300.50	2.00	601.00	\$8,400.69	\$12,397.19		
0710-093-0312-5	CP STERN LLC & STAR INVESTMENTS LLC 8908 DOMINI RD MT HOREB WI	209 Cottage Grove Rd	540.00 L.F.	330.00	\$495.00	243.00	\$972.00	1.0	273.00	\$409.50	1.0	259.00	\$777.00	1.0	170.00	\$3,060.00	0.00	\$0.00	0.00	\$0.00	2.00	\$820.00	56.00	\$1,182.16	2.00	\$4,000.00	540.00	2.00	1080.00	\$15,096.08	\$26,811.74
0710-092-2315-9	SMITH, MADELINE J PO BOX 8685 MADISON WI	216 Cottage Grove Rd	140.00 L.F.	0.00	\$0.00	0.00	\$0.00	1.0	100.00	\$150.00	1.0	100.00	\$300.00	1.0	85.00	\$1,530.00	0.00	\$0.00	0.00	\$0.00	1.00	\$410.00	53.00	\$1,118.83	0.00	\$0.00	140.00	2.00	280.00	\$3,913.80	\$7,422.63
0710-093-0314-1	HOEY PROPERTIES-MADISON LLC 217 COTTAGE GROVE RD MADISON WI	217 Cottage Grove Rd	82.30 L.F.	0.00	\$0.00	0.00	\$0.00	1.0	100.00	\$150.00	1.0	100.00	\$300.00	1.0	25.00	\$450.00	0.00	\$0.00	0.00	\$0.00	1.00	\$410.00	30.00	\$633.30	1.00	\$2,000.00	82.30	2.00	164.60	\$2,300.75	\$6,244.05
0710-092-1801-9	SCHMIEDLN, WAYNE & KATHY 220 COTTAGE GROVE RD MADISON WI	220 Cottage Grove Rd	148.90 L.F.	0.00	\$0.00	0.00	\$0.00	1.0	225.00	\$337.50	1.0	225.00	\$675.00	1.0	90.00	\$1,620.00	0.00	\$0.00	0.00	\$0.00	2.00	\$820.00	100.00	\$2,111.00	0.00	\$0.00	148.90	2.00	297.80	\$4,162.61	\$9,726.11
0710-092-1725-1	MASON REAL ESTATE HOLDINGS LLC 300 COTTAGE GROVE RD MADISON WI	300 Cottage Grove Rd	118.70 L.F.	0.00	\$0.00	0.00	\$0.00	1.0	100.00	\$150.00	1.0	100.00	\$300.00	1.0	50.00	\$900.00	0.00	\$0.00	0.00	\$0.00	1.00	\$410.00	47.00	\$992.17	0.00	\$0.00	118.70	2.00	237.40	\$3,318.34	\$6,070.51
0710-093-0307-6	VEW POST 7591 DONALD & GALEN DAY 301 COTTAGE GROVE RD MADISON WI	301 Cottage Grove Rd	237.72 L.F.	0.00	\$0.00	0.00	\$0.00	1.0	100.00	\$150.00	1.0	100.00	\$300.00	1.0	25.00	\$450.00	0.00	\$0.00	0.00	\$0.00	1.00	\$410.00	32.00	\$675.52	1.00	\$2,000.00	237.72	2.00	475.44	\$6,645.63	\$10,631.15
0710-092-1728-5	MADISON GAS & ELECTRIC CO PO BOX 1231 MADISON WI	310 Cottage Grove Rd	292.62 L.F.	0.00	\$0.00	0.00	\$0.00	1.0	200.00	\$300.00	1.0	200.00	\$600.00	1.0	120.00	\$2,160.00	33.84	\$913.56	0.00	\$0.00	2.00	\$410.00	110.00	\$1,161.05	0.00	\$0.00	292.62	1.00	292.62	\$4,090.20	\$9,634.81

City of Madison Engineering Division - Schedule of Assessments

12/4/2015

Project ID: Project Name: Cottage Grove Road and Dempsey Road Street Assessment District - 2016

53W1681 Project Limits: Monona Drive to Claire Street; CG Road to Anchor Drive

NOTE: A factor has been applied for sidewalk and curb and gutter work adjacent to lots that abut more than one street and are single-family or two-family residential dwellings.

* Street lighting assessments for corner parcels are adjusted for previous lighting assessments on Monona Dr, Royster Oaks Dr, Dempsey Rd and Pinney St.

Parcel No.	Owner's Name / Mailing Address	Situation Address	Frontage (Assessor's) Linear feet	Street Reconstruction Items												Sanitary Sewer Items				Storm Sewer Items		Street Lighting*				Total Assmt					
				Remove Drive Apron @ \$1.50 per SF		Replace Drive Apron @ \$4.00 per SF		Remove Sidewalk @ \$1.50 per Square Ft (SF)		Replace Sidewalk @ \$3.00 per Square Ft (SF)		Remove & Replace Curb & Gutter @ \$18.00 per Linear Foot (LF)		Remove & Replace Asphalt Drive Apron @ \$27.00 per SF		New Curb Pavement & Curb \$52.00 per LF		Sanitary Sewer Reconnect @ \$410.00 Each		Remove & Replace Sanitary Lateral @ \$21.11 per LF		Private Storm Sewer Connection @ \$2,000.00 Each		Assessed Frontage	Zone		Factored Frontage	Street Lighting @ \$13.98			
				Factor	Cost	Factor	Cost	Factor	Cost	Factor	Cost	Factor	LF	Cost	Factor	LF	Cost	Factor	Cost	Factor	Cost	Factor	Cost	Factor	Cost		Factor	Cost	Factor	Cost	per Factored LF
0710-093-0208-6	RIFFLE FAMILY LIMITED PARTNERSHIP 5454 WHALEN RD FITCHBURG WI	401 Cottage Grove Rd	76.00 L.F.	0.00	\$0.00	0.00	\$0.00	1.0	100.00	\$150.00	1.0	100.00	\$300.00	1.0	64.00	\$1,152.00	0.00	\$0.00	0.00	\$0.00	1.00	\$410.00	36.00	\$759.96	0.00	\$0.00	76.00	1.50	114.00	\$1,593.48	\$4,365.44
0710-093-0207-8	NOTARGIOVANNI, PATRICK & T MARGARET NOTARGIOVANNI 1015 JUNIPER PKY LIBERTYVILLE IL	405 Cottage Grove Rd	76.50 L.F.	0.00	\$0.00	0.00	\$0.00	1.0	100.00	\$150.00	1.0	100.00	\$300.00	1.0	25.00	\$450.00	0.00	\$0.00	0.00	\$0.00	1.00	\$410.00	36.00	\$759.96	0.00	\$0.00	76.50	1.50	114.75	\$1,603.96	\$3,673.92
0710-093-0206-0	MARONI LLC 3920 S ADELL AVE NEW BERLIN WI	409 Cottage Grove Rd	76.50 L.F.	0.00	\$0.00	0.00	\$0.00	1.0	100.00	\$150.00	1.0	100.00	\$300.00	1.0	25.00	\$450.00	17.89	\$483.00	0.00	\$0.00	1.00	\$410.00	37.00	\$781.07	0.00	\$0.00	76.50	1.50	114.75	\$1,603.96	\$4,178.03
0710-092-2704-6	RDC DEVELOPMENT LLC 4605 DOVETAIL DR MADISON WI	502 Cottage Grove Rd	219.49 L.F.	0.00	\$0.00	0.00	\$0.00	1.0	1097.45	\$1,646.18	1.0	1755.92	\$5,267.76	1.0	10.00	\$180.00	0.00	\$0.00	0.00	\$0.00	0.00	\$0.00	0.00	\$0.00	0.00	\$0.00	219.49	2.00	438.98	\$6,136.00	\$13,229.93
0710-093-0118-7	BOWERS, KENNETH & JANE 505 COTTAGE GROVE RD MADISON WI	505 Cottage Grove Rd	78.90 L.F.	0.00	\$0.00	0.00	\$0.00	1.0	125.00	\$187.50	1.0	125.00	\$375.00	1.0	25.00	\$450.00	0.00	\$0.00	0.00	\$0.00	1.00	\$410.00	36.00	\$759.96	0.00	\$0.00	78.90	2.00	157.80	\$2,205.71	\$4,388.17
0710-093-0117-9	KY INVESTMENTS LLC ATTN KEN BOWERS 509 COTTAGE GROVE RD MADISON WI	509 Cottage Grove Rd	69.00 L.F.	179.00	\$268.50	229.00	\$880.00	1.0	175.00	\$262.50	1.0	175.00	\$525.00	1.0	25.00	\$450.00	0.00	\$0.00	0.00	\$0.00	1.00	\$410.00	35.00	\$738.85	0.00	\$0.00	69.00	2.00	138.00	\$1,928.94	\$5,463.79
0710-093-0116-1	ROEMING, STEPHANIE F PO BOX 2229 ST PETERSBURG FL	513 Cottage Grove Rd	104.10 L.F.	0.00	\$0.00	0.00	\$0.00	1.0	100.00	\$150.00	1.0	100.00	\$300.00	1.0	65.00	\$1,170.00	0.00	\$0.00	0.00	\$0.00	1.00	\$410.00	33.00	\$696.63	0.00	\$0.00	104.10	2.00	208.20	\$2,910.19	\$5,636.82
0710-093-0115-3	ROEMING, STEPHANIE F PO BOX 2229 ST PETERSBURG FL	515 Cottage Grove Rd	63.00 L.F.	0.00	\$0.00	0.00	\$0.00	1.0	125.00	\$187.50	1.0	125.00	\$375.00	1.0	25.00	\$450.00	0.00	\$0.00	0.00	\$0.00	1.00	\$410.00	32.00	\$675.52	0.00	\$0.00	63.00	2.00	126.00	\$1,761.21	\$3,859.23
0710-092-2703-6	RDC DEVELOPMENT LLC 4605 DOVETAIL DR MADISON WI	516 Cottage Grove Rd	240.03 L.F.	0.00	\$0.00	0.00	\$0.00	1.0	1200.15	\$1,800.23	1.0	1920.24	\$5,760.72	1.0	20.00	\$360.00	0.00	\$0.00	0.00	\$0.00	0.00	\$0.00	0.00	\$0.00	0.00	\$0.00	240.03	2.00	480.06	\$6,710.21	\$14,631.15
0710-093-0114-5	STOLTENBERG, BECKY LARRY RING % P MALONEY 3056 SHAW CT MADISON WI	517 Cottage Grove Rd	78.70 L.F.	296.00	\$444.00	229.00	\$916.00	1.0	100.00	\$150.00	1.0	100.00	\$300.00	1.0	65.00	\$1,170.00	0.00	\$0.00	0.00	\$0.00	1.00	\$410.00	33.00	\$696.63	0.00	\$0.00	78.70	2.00	157.40	\$2,200.11	\$6,286.14
0710-093-0113-7	STOLTENBERG, BECKY LARRY RING % P MALONEY 3056 SHAW CT MADISON WI	521 Cottage Grove Rd	58.20 L.F.	306.37	\$459.56	184.00	\$736.00	1.0	100.00	\$150.00	1.0	100.00	\$300.00	1.0	25.00	\$450.00	0.00	\$0.00	0.00	\$0.00	1.00	\$410.00	33.00	\$696.63	0.00	\$0.00	58.20	2.00	116.40	\$1,627.02	\$4,829.21
0710-093-0112-9	HUTCHINSON, CHAD D TRINA L WARNER-HUTCHINSON 5909 HAMMERSLEY RD MADISON WI	523 Cottage Grove Rd	61.00 L.F.	243.00	\$364.50	153.00	\$612.00	1.0	100.00	\$150.00	1.0	100.00	\$300.00	1.0	25.00	\$450.00	0.00	\$0.00	0.00	\$0.00	1.00	\$410.00	33.00	\$696.63	0.00	\$0.00	61.00	2.00	122.00	\$1,705.30	\$4,688.43
0710-092-2702-8	RDC DEVELOPMENT LLC 4605 DOVETAIL DR MADISON WI	530 Cottage Grove Rd	213.76 Cott Gr 301.78 Demp	0.00	\$0.00	0.00	\$0.00	1.0	2577.70	\$3,866.55	1.0	3218.98	\$9,656.94	1.0	56.00	\$1,008.00	0.00	\$0.00	0.00	\$0.00	0.00	\$0.00	0.00	\$0.00	0.00	\$0.00	408.66	2.00	817.32	\$11,424.38	\$25,955.87
0710-091-0902-8	H & K PARTNERS LLC 7840 W HICKS ST MILWAUKEE WI	604 Cottage Grove Rd	197.00 Cott Gr 177.0 Demp	121.00	\$181.50	121.00	\$484.00	1.0	100.00	\$150.00	1.0	100.00	\$300.00	1.0	75.00	\$1,350.00	0.00	\$0.00	0.00	\$0.00	1.00	\$410.00	56.00	\$1,182.16	1.00	\$2,000.00	285.50	2.00	571.00	\$7,981.36	\$14,039.02

City of Madison Engineering Division - Schedule of Assessments

12/4/2015

Project ID: Project Name: Cottage Grove Road and Dempsey Road Street Assessment District - 2016

53W1681 Project Limits: Monona Drive to Claire Street; CG Road to Anchor Drive

NOTE: A factor has been applied for sidewalk and curb and gutter work adjacent to lots that abut more than one street and are single-family or two-family residential dwellings.

* Street lighting assessments for corner parcels are adjusted for previous lighting assessments on Monona Dr, Royster Oaks Dr, Dempsey Rd and Pinney St.

Parcel No.	Owner's Name / Mailing Address	Situation Address	Frontage (Assessor's) Linear feet	Street Reconstruction Items												Sanitary Sewer Items				Storm Sewer Items		Street Lighting*				Total Assmt					
				Remove Drive Apron @ \$1.50 per SF		Replace Drive Apron @ \$4.00 per SF		Remove Sidewalk @ \$1.50 per Square Ft (SF)		Replace Sidewalk @ \$3.00 per Square Ft (SF)		Remove & Replace Curb & Gutter @ \$18.00 per Linear Foot (LF)		Remove & Replace Asphalt Drive Apron @ \$27.00 per SY		New Curb Pavement & Curb @ \$52.00 per LF		Sanitary Sewer Reconnect @ \$410.00 Each		Remove & Replace Sanitary Lateral @ \$21.11 per LF		Private Storm Sewer Connection @ \$2,000.00 Each		Assessed Frontage	Zone Factor		Factored Frontage	Street Lighting @ \$13.98 per Factored LF			
				SF	Cost	SF	Cost	Factor	SF	Cost	Factor	SF	Cost	Factor	LF	Cost	SY	Cost	LF	Cost	Each	Cost	LF	Cost	Each		Cost	LF	LF	LF	per Factored LF
0710-094-0318-1	CAPITOL ONE REAL ESTATE LLC 2570 RIMROCK RD MADISON WI	605 Cottage Grove Rd	142.00 L.F.	0.00	\$0.00	0.00	\$0.00	1.0	100.00	\$150.00	1.0	100.00	\$300.00	1.0	25.00	\$450.00	0.00	\$0.00	0.00	\$0.00	1.00	\$410.00	42.00	\$886.62	0.00	\$0.00	142.00	2.00	284.00	\$3,969.71	\$6,166.33
0710-091-0903-6	THM PROPERTIES LLC 509 WOODWARD DR MADISON WI	700 Cottage Grove Rd	150.00 L.F.	0.00	\$0.00	0.00	\$0.00	1.0	150.00	\$225.00	1.0	150.00	\$450.00	1.0	25.00	\$450.00	0.00	\$0.00	0.00	\$0.00	1.00	\$410.00	50.00	\$1,055.50	0.00	\$0.00	105.00	2.00	210.00	\$2,935.35	\$5,525.85
0710-091-0904-4	OLSON, L KENT 910 COTTAGE CT MADISON WI	710 Cottage Grove Rd	198.40 L.F.	0.00	\$0.00	0.00	\$0.00	1.0	0.00	\$0.00	1.0	0.00	\$0.00	1.0	0.00	\$0.00	0.00	\$0.00	0.00	\$0.00	1.00	\$410.00	50.00	\$1,055.50	0.00	\$0.00	198.40	0.00	0.00	\$0.00	\$1,465.50
0710-091-0423-4	ACKER JR EST, ANTHONY H 701 DEMPSEY ROAD MADISON WI	701 Dempsey Rd CORNER LOT	120.00 L.F.	0.00	\$0.00	0.00	\$0.00	0.5	0.00	\$0.00	0.5	0.00	\$0.00	0.5	0.00	\$0.00	7.89	\$213.00	0.00	\$0.00	0.00	\$0.00	0.00	\$0.00	0.00	\$0.00	120.00	0.00	0.00	\$0.00	\$213.00
0710-092-1311-8	SNOVER, ROSS E MEGAN A SNOVER 702 DEMPSEY RD MADISON WI	702 Dempsey Rd CORNER LOT	120.00 L.F.	0.00	\$0.00	0.00	\$0.00	0.5	0.00	\$0.00	0.5	0.00	\$0.00	0.5	25.00	\$225.00	0.00	\$0.00	0.00	\$0.00	0.00	\$0.00	0.00	\$0.00	0.00	\$0.00	120.00	0.00	0.00	\$0.00	\$225.00
0710-091-0401-0	KREITER, BRYAN D DONALD C KREITER 705 DEMPSEY RD MADISON WI	705 Dempsey Rd CORNER LOT	120.00 L.F.	0.00	\$0.00	0.00	\$0.00	0.5	100.00	\$75.00	0.5	100.00	\$150.00	0.5	45.00	\$405.00	0.00	\$0.00	0.00	\$0.00	1.00	\$410.00	30.00	\$633.30	0.00	\$0.00	120.00	0.00	0.00	\$0.00	\$1,673.30
0710-092-1310-0	MOORE LIV TR, THOMAS J 706 DEMPSEY RD MADISON WI	706 Dempsey Rd CORNER LOT	120.00 L.F.	0.00	\$0.00	0.00	\$0.00	0.5	150.00	\$112.50	0.5	150.00	\$225.00	0.5	0.00	\$0.00	0.00	\$0.00	0.00	\$0.00	0.00	\$0.00	0.00	\$0.00	0.00	\$0.00	120.00	0.00	0.00	\$0.00	\$337.50
0710-091-0725-4	STUBBUD-JOHNSON, KAREN A 709 DEMPSEY RD MADISON WI	709 Dempsey Rd CORNER LOT	120.00 L.F.	0.00	\$0.00	0.00	\$0.00	0.5	100.00	\$75.00	0.5	100.00	\$150.00	0.5	25.00	\$225.00	14.11	\$381.00	0.00	\$0.00	1.00	\$410.00	28.00	\$591.08	0.00	\$0.00	120.00	0.00	0.00	\$0.00	\$1,832.08
0710-092-1407-5	OLUND, SCHAYNNA B 710 DEMPSEY RD MADISON WI	710 Dempsey Rd CORNER LOT	120.00 L.F.	70.00	\$105.00	70.00	\$280.00	0.5	0.00	\$0.00	0.5	0.00	\$0.00	0.5	0.00	\$0.00	0.00	\$0.00	0.00	\$0.00	0.00	\$0.00	0.00	\$0.00	0.00	\$0.00	120.00	0.00	0.00	\$0.00	\$385.00
0710-091-0701-4	MAY, JENNIFER 713 DEMPSEY RD MADISON WI	713 Dempsey Rd CORNER LOT	120.00 L.F.	0.00	\$0.00	0.00	\$0.00	0.5	150.00	\$112.50	0.5	150.00	\$225.00	0.5	55.00	\$495.00	0.00	\$0.00	0.00	\$0.00	1.00	\$410.00	0.00	\$29.00	0.00	\$0.00	120.00	0.00	0.00	\$0.00	\$1,271.50
0710-092-1406-7	ANUNDSON, JASLEND J & JOETTE L ANUNDSON 714 DEMPSEY RD MADISON WI	714 Dempsey Rd	50.00 L.F.	0.00	\$0.00	0.00	\$0.00	1.0	100.00	\$150.00	1.0	100.00	\$300.00	1.0	25.00	\$450.00	0.00	\$0.00	0.00	\$0.00	1.00	\$410.00	20.00	\$422.20	0.00	\$0.00	50.00	0.00	0.00	\$0.00	\$1,732.20
0710-092-1405-9	BINA, MICKI 718 DEMPSEY RD MADISON WI	718 Dempsey Rd	50.00 L.F.	0.00	\$0.00	0.00	\$0.00	1.0	100.00	\$150.00	1.0	100.00	\$300.00	1.0	50.00	\$900.00	0.00	\$0.00	0.00	\$0.00	1.00	\$410.00	20.00	\$422.20	0.00	\$0.00	50.00	0.00	0.00	\$0.00	\$2,182.20
0710-092-1404-1	LEU, COLLEEN A 722 DEMPSEY RD MADISON WI	722 Dempsey Rd	50.00 L.F.	0.00	\$0.00	0.00	\$0.00	1.0	100.00	\$150.00	1.0	100.00	\$300.00	1.0	50.00	\$900.00	6.56	\$177.00	0.00	\$0.00	1.00	\$410.00	20.00	\$422.20	0.00	\$0.00	50.00	0.00	0.00	\$0.00	\$2,359.20
0710-092-1403-3	DECKER, MEGAN A 726 DEMPSEY RD MADISON WI	726 Dempsey Rd	60.00 L.F.	0.00	\$0.00	0.00	\$0.00	1.0	100.00	\$150.00	1.0	100.00	\$300.00	1.0	45.00	\$810.00	0.00	\$0.00	0.00	\$0.00	1.00	\$410.00	20.00	\$422.20	0.00	\$0.00	60.00	0.00	0.00	\$0.00	\$2,092.20
0710-091-0824-4	CHAPMAN, JERRY & SANDRA 727 DEMPSEY RD MADISON WI	727 Dempsey Rd CORNER LOT	130.00 L.F.	0.00	\$0.00	0.00	\$0.00	0.5	100.00	\$75.00	0.5	100.00	\$150.00	0.5	65.00	\$585.00	0.00	\$0.00	0.00	\$0.00	1.00	\$410.00	30.00	\$633.30	0.00	\$0.00	130.00	0.00	0.00	\$0.00	\$1,853.30

City of Madison Engineering Division - Schedule of Assessments

12/4/2015

Project ID: Project Name: Cottage Grove Road and Dempsey Road Street Assessment District - 2016

53W1681 Project Limits: Monona Drive to Claire Street; CG Road to Anchor Drive

NOTE: A factor has been applied for sidewalk and curb and gutter work adjacent to lots that abut more than one street and are single-family or two-family residential dwellings.

* Street lighting assessments for corner parcels are adjusted for previous lighting assessments on Monona Dr, Royster Oaks Dr, Dempsey Rd and Pinney St.

Parcel No.	Owner's Name / Mailing Address	Situation Address	Frontage (Assessor's) Linear feet	Street Reconstruction Items												Sanitary Sewer Items				Storm Sewer Items		Street Lighting*				Total Assmt					
				Remove Drive Apron @ \$1.50 per SF		Replace Drive Apron @ \$4.00 per SF		Remove Sidewalk @ \$1.50 per Square Ft (SF)		Replace Sidewalk @ \$3.00 per Square Ft (SF)		Remove & Replace Curb & Gutter @ \$18.00 per Linear Foot (LF)		Remove & Replace Asphalt Drive Apron @ \$27.00 per SY		New Curb Pavement & Curb \$52.00 per LF		Sanitary Sewer Reconnect @ \$410.00 Each		Remove & Replace Sanitary Lateral @ \$21.11 per LF		Private Storm Sewer Connection @ \$2,000.00 Each		Assessed Frontage	Zone		Factored Frontage	Street Lighting @ \$13.98			
				Factor	Cost	Factor	Cost	Factor	Cost	Factor	Cost	Factor	LF	Cost	SY	Cost	LF	Cost	Each	Cost	LF	Cost	Each	Cost	LF		LF	LF	per Factored LF		
0710-092-1402-5	MELAHN, EBBY L 611 N MAIN ST COTTAGE GROVE WI	730 Dempsey Rd	55.00 L.F.	0.00	\$0.00	0.00	\$0.00	1.0	100.00	\$150.00	1.0	100.00	\$300.00	1.0	45.00	\$810.00	7.26	\$196.08	0.00	\$0.00	1.00	\$410.00	20.00	\$422.20	0.00	\$0.00	55.00	0.00	0.00	\$0.00	\$2,288.28
0710-092-1401-7	SOLODIN, TATYANA 734 DEMPSEY RD MADISON WI	734 Dempsey Rd	140.20 L.F.	0.00	\$0.00	0.00	\$0.00	1.0	100.00	\$150.00	1.0	100.00	\$300.00	1.0	75.00	\$1,350.00	6.67	\$180.00	0.00	\$0.00	1.00	\$410.00	20.00	\$422.20	0.00	\$0.00	140.20	0.00	0.00	\$0.00	\$2,812.20
0710-091-0910-1	THM PROPERTIES LLC 509 WOODWARD DR MADISON WI	801 Dempsey Rd	154.83 L.F.	0.00	\$0.00	0.00	\$0.00	1.0	100.00	\$150.00	1.0	100.00	\$300.00	1.0	33.00	\$594.00	0.00	\$0.00	0.00	\$0.00	1.00	\$410.00	54.00	\$1,139.94	1.00	\$2,000.00	154.83	2.00	309.66	\$4,328.38	\$8,922.32
0710-091-0911-9	GREIFHEIM, PETER PO BOX 8521 MADISON WI	901 Dempsey Rd	135.00 L.F.	0.00	\$0.00	0.00	\$0.00	1.0	225.00	\$337.50	1.0	225.00	\$675.00	1.0	25.00	\$450.00	0.00	\$0.00	0.00	\$0.00	1.00	\$410.00	55.00	\$1,161.05	1.00	\$2,000.00	135.00	2.00	270.00	\$3,774.02	\$8,807.57
0710-091-0901-0	AUSTAD FAMILY LLC 905 DEMPSEY RD MADISON WI	905 Dempsey Rd	216.00 L.F.	0.00	\$0.00	0.00	\$0.00	1.0	375.00	\$562.50	1.0	375.00	\$1,125.00	1.0	95.00	\$1,710.00	0.00	\$0.00	0.00	\$0.00	2.00	\$410.00	118.00	\$1,245.49	4.00	\$8,000.00	216.00	2.00	432.00	\$6,038.43	\$19,091.42
0710-094-0301-6	IBRAHIM, MITAT 410 WYALUSING DR MADISON WI	3900 Dempsey Rd	124.20 Demp 120.2 Cott Gr	0.00	\$0.00	347.00	\$1,388.00	1.0	250.00	\$375.00	1.0	250.00	\$750.00	1.0	0.00	\$0.00	0.00	\$0.00	124.20	\$6,458.40	1.00	\$410.00	30.00	\$633.30	1.00	\$2,000.00	120.20	2.00	240.40	\$3,360.28	\$15,374.98
0710-093-0111-1	3901 ASSOCIATES LLC PO BOX 620434 MIDDLETON WI	3901 Dempsey Rd	130.08 Demp 108.38 Cott Gr	568.00	\$852.00	462.00	\$1,848.00	1.0	125.00	\$187.50	1.0	775.00	\$2,325.00	1.0	0.00	\$0.00	0.00	\$0.00	130.00	\$6,760.00	1.00	\$410.00	48.00	\$1,913.28	1.00	\$2,000.00	108.38	2.00	216.76	\$3,029.84	\$18,425.62
0710-094-0302-4	IBRAHIM, MITAT 410 WYALUSING DR MADISON WI	3902 Dempsey Rd	60.00 L.F.	210.00	\$315.00	210.00	\$840.00	1.0	0.00	\$0.00	1.0	0.00	\$0.00	1.0	0.00	\$0.00	0.00	\$0.00	28.00	\$1,456.00	1.00	\$410.00	30.00	\$633.30	0.00	\$0.00	60.00	0.00	0.00	\$0.00	\$3,654.30
0710-093-0310-9	KREHL, ESTHER CORNER LOT 3902 DREXEL AVE MADISON WI	3902 Drexel Ave CORNER LOT	80.5 Cott Gr 133.80 Drex	0.00	\$0.00	0.00	\$0.00	0.5	100.00	\$75.00	0.5	100.00	\$150.00	0.5	64.50	\$580.50	0.00	\$0.00	0.00	\$0.00	1.00	\$410.00	35.00	\$738.85	0.00	\$0.00	80.50	1.00	80.50	\$1,125.22	\$3,079.57
0710-093-0205-2	MEIER, BRIAN CORNER LOT MEKEL WIEDERHOLT MEIER 3901 MAHER AVE MADISON WI	3901 Maher Ave CORNER LOT	76.5 Cott Gr 141.20 Maher	0.00	\$0.00	0.00	\$0.00	0.5	100.00	\$75.00	0.5	100.00	\$150.00	0.5	84.00	\$756.00	0.00	\$0.00	0.00	\$0.00	1.00	\$410.00	35.00	\$738.85	0.00	\$0.00	76.50	1.00	76.50	\$1,069.31	\$3,199.16
0710-093-0119-5	SMITH, CHARLENE CORNER LOT 3902 MAHER AVE MADISON WI	3902 Maher Ave CORNER LOT	79.2 Cott Gr 135.30 Maher	0.00	\$0.00	0.00	\$0.00	0.5	0.00	\$0.00	0.5	0.00	\$0.00	0.5	0.00	\$0.00	0.00	\$0.00	0.00	\$0.00	1.00	\$410.00	33.00	\$696.63	0.00	\$0.00	79.20	1.00	79.20	\$1,107.05	\$2,213.68
0710-093-0301-8	MALCHESKI, JAMES E 3900 MONONA DR MADISON WI	3900 Monona Dr	100.5 Cott Gr 139.10 Mono	0.00	\$0.00	0.00	\$0.00	1.0	100.00	\$150.00	1.0	100.00	\$300.00	1.0	25.00	\$450.00	0.00	\$0.00	0.00	\$0.00	1.00	\$410.00	39.00	\$823.29	1.00	\$2,000.00	50.25	2.00	100.50	\$1,404.77	\$5,538.06
0710-091-0702-2	MACLEOD, JESS D BESS L MACLEOD 4006 STEINIES DR MADISON WI	4006 Steinies Dr		0.00	\$0.00	0.00	\$0.00	1.0	100.00	\$150.00	1.0	100.00	\$300.00	1.0	25.00	\$450.00	0.00	\$0.00	0.00	\$0.00	1.00	\$410.00	30.00	\$633.30	0.00	\$0.00	0.00	0.00	0.00	\$0.00	\$1,943.30
0710-091-0823-6	LEVERENZ, BRANDON J JENNIFER A LEVERENZ 4005 STEINIES DR MADISON WI	4005 Steinies Dr		0.00	\$0.00	0.00	\$0.00	1.0	100.00	\$150.00	1.0	100.00	\$300.00	1.0	25.00	\$450.00	0.00	\$0.00	0.00	\$0.00	1.00	\$410.00	30.00	\$633.30	0.00	\$0.00	0.00	0.00	0.00	\$0.00	\$1,943.30
Totals				2678.37	\$4,017.55	2594.00	\$10,376.00	10999.70	\$15,899.55	13655.54	\$39,766.62	2363.50	\$39,271.50	94.21	\$2,543.64	282.20	\$14,674.40	49.00	\$19,270.00	1797.00	\$35,557.13	17.00	\$34,000.00	10731.26	\$150,000.00			10731.26	\$150,000.00	\$365,376.40	