

BLOCK PARTY STREET USE PERMIT APPLICATION

FOR OFFICE USE ONLY: Permit # _____ Date Submitted _____

APPLICANT INFORMATION

Contact Name WAYNE PLANT
Address 921 Lawrence St
City/State/Zip MADISON, WISC 53715
Home Phone (608) 256-0614 Cell Phone _____
E-mail wbplant@gmail.com

EVENT INFORMATION

Event Category

☒ Neighborhood Block Party ☐ Other _____

Location Requested

☒ Residential Street(s) Street Names and Block #'s 900 block of Lawrence St.

Date(s) of Event Sept. 5, 2015 Rain Date _____

Annual Event? ☐ No ☒ Yes

Estimated Attendance 75 (CERTIFICATE OF INSURANCE MAY BE REQUIRED)

Time of Event

Set-Up 1pm Event Starts 3pm

Take-Down 12AM Event Ends 12AM

☒ I/We waive the 21-day decision requirement.

wp (PLEASE INITIAL)

Your signature below indicates that you have read and understand the instructions and guidelines for a neighborhood block party. Further, the person/group named in this application will be responsible for the conduct of the group and for the condition of the reserved area. Falsification of information on the application will result in forfeiture of up to \$200 per falsified item.

In addition to the rules and regulations detailed in the permit application instructions and guidelines, Street Use Permits are subject to all applicable ordinances, statutes and laws.

Signature Wayne Plant Date 7/9/15



Map of:

940 Lawrence St

Madison, WI 53715-2039

Notes

900 Lawrence Street
Saturday September 5th
1pm-Sunset

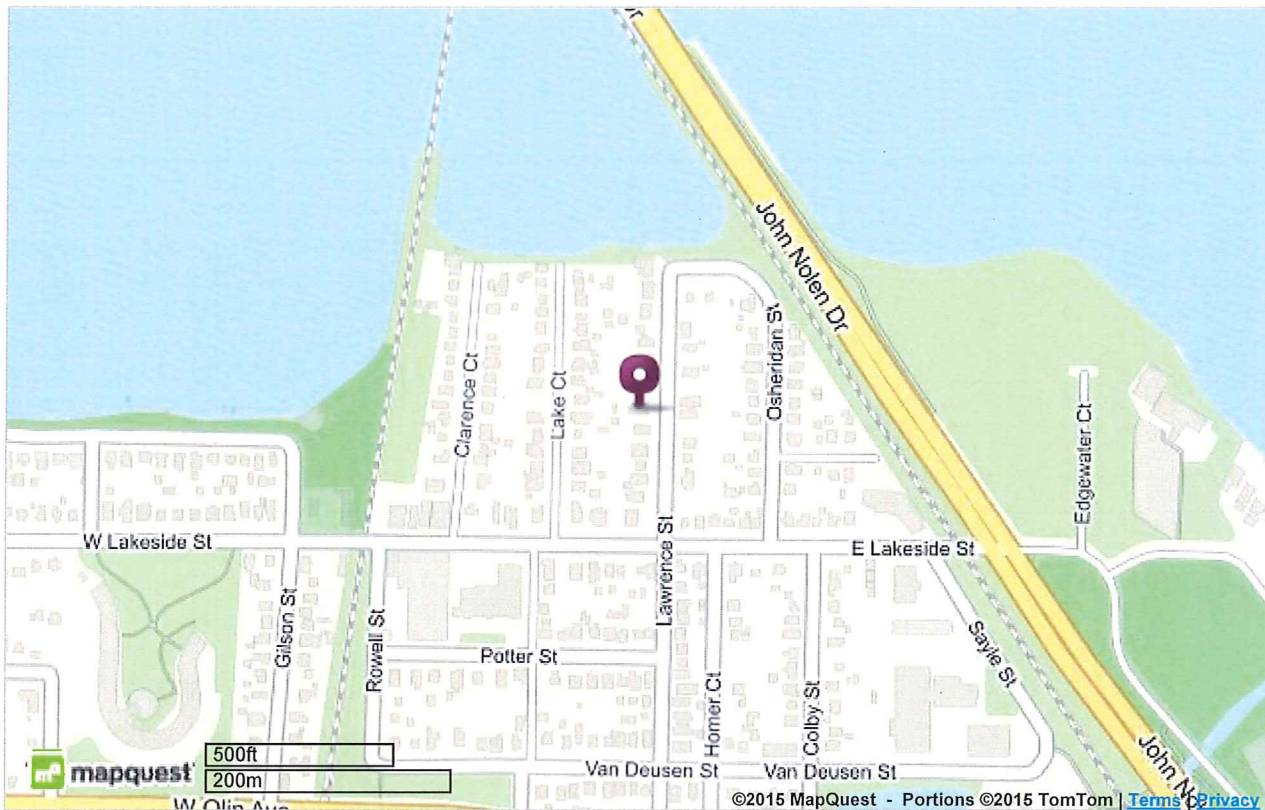

©2015 MapQuest, Inc. Use of directions and maps is subject to the MapQuest Terms of Use. We make no guarantee of the accuracy of their content, road conditions or route usability. You assume all risk of use. [View Terms of Use](#)