

**APPLICATION FOR
URBAN DESIGN COMMISSION
REVIEW AND APPROVAL**

AGENDA ITEM # _____

Project # _____

DATE SUBMITTED: <u>April 16, 2014</u>	Action Requested
UDC MEETING DATE: <u>April 23, 2014</u>	<input type="checkbox"/> Informational Presentation
	<input type="checkbox"/> Initial Approval and/or Recommendation
	<input checked="" type="checkbox"/> Final Approval and/or Recommendation

PROJECT ADDRESS: 210 Langdon Street

ALDERMANIC DISTRICT: Ledell Zellers - District #2

OWNER/DEVELOPER (Partners and/or Principals)

ARCHITECT/DESIGNER/OR AGENT:

Theta Chi - Jon Grann (President RBC)

Knothe & Bruce Architects, LLC

7601 University Avenue, Suite 201

Middleton, Wisconsin 53562

CONTACT PERSON: J. Randy Bruce/Knothe & Bruce Architects, LLC

Address: 7601 University Avenue, Suite 201

Middleton, Wisconsin 53562

Phone: 608-836-3690

Fax: 608-836-6934

E-mail address: rbruce@knothebruce.com

TYPE OF PROJECT:

(See Section A For:)

- Planned Unit Development (PUD)
 - General Development Plan (GDP)
 - Specific Implementation Plan (SIP)
- Planned Community Development (PCD)
 - General Development Plan (GDP)
 - Specific Implementation Plan (SIP)
- Planned Residential Development (PRD)
- New Construction or Exterior Remodeling in an Urban Design District* (A public hearing is required as well as a fee)
- School, Public Building or Space (Fee may be required)
- New Construction or Addition to or Remodeling of a Retail, Hotel, or Motel Building Exceeding 50,000 Sq.Ft.
- Planned Commercial Site

(See Section B for:)

- New Construction or Exterior Remodeling in C4 District (Fee required)

(See Section C for:)

- R.P.S.M. Parking Variance (Fee required)

(See Section D for:)

- Comprehensive Design Review* (Fee required)
- Street Graphics Variance* (Fee Required)
- Other _____

*Public Hearing Required (Submission Deadline 3 Weeks in Advance of Meeting Date)



April 15, 2014

Al Martin
Urban Design Committee
Planning & Development
City of Madison
215 Martin Luther King Jr. Blvd
PO Box 2985
Madison, Wisconsin 53701

Re: Minor Alteration to an Approved and Recorded SIP
210 Langdon St. – Theta Chi Fraternity
Madison, WI

KBA Project # 1231

Dear Mr. Martin,

The following changes have been made to the approved and recorded SIP plans for Theta Chi Fraternity and are presented for your review and approval. Please see the attached drawings for further information.

A-1.4:

- An equipment well has been added on the roof.

A-2.1:

- A railing has been added on the north side elevation in front of the equipment well on the roof.
- Greek lettering has been added on the gable of the Langdon Street elevation.
- The door style on the Langdon Street elevation has changed.
- Lettering reading "Theta Chi Fraternity" has been added in the archway above the door on the Langdon Street elevation.

Thank you for your time in reviewing our proposal.

Sincerely,

A handwritten signature in black ink, appearing to read 'J. Randy Bruce', with a long, sweeping horizontal line extending to the right.

J. Randy Bruce, AIA
Managing Member

Consultant

Notes



LANGDON ST. ELEVATION
1/8" = 1'-0"

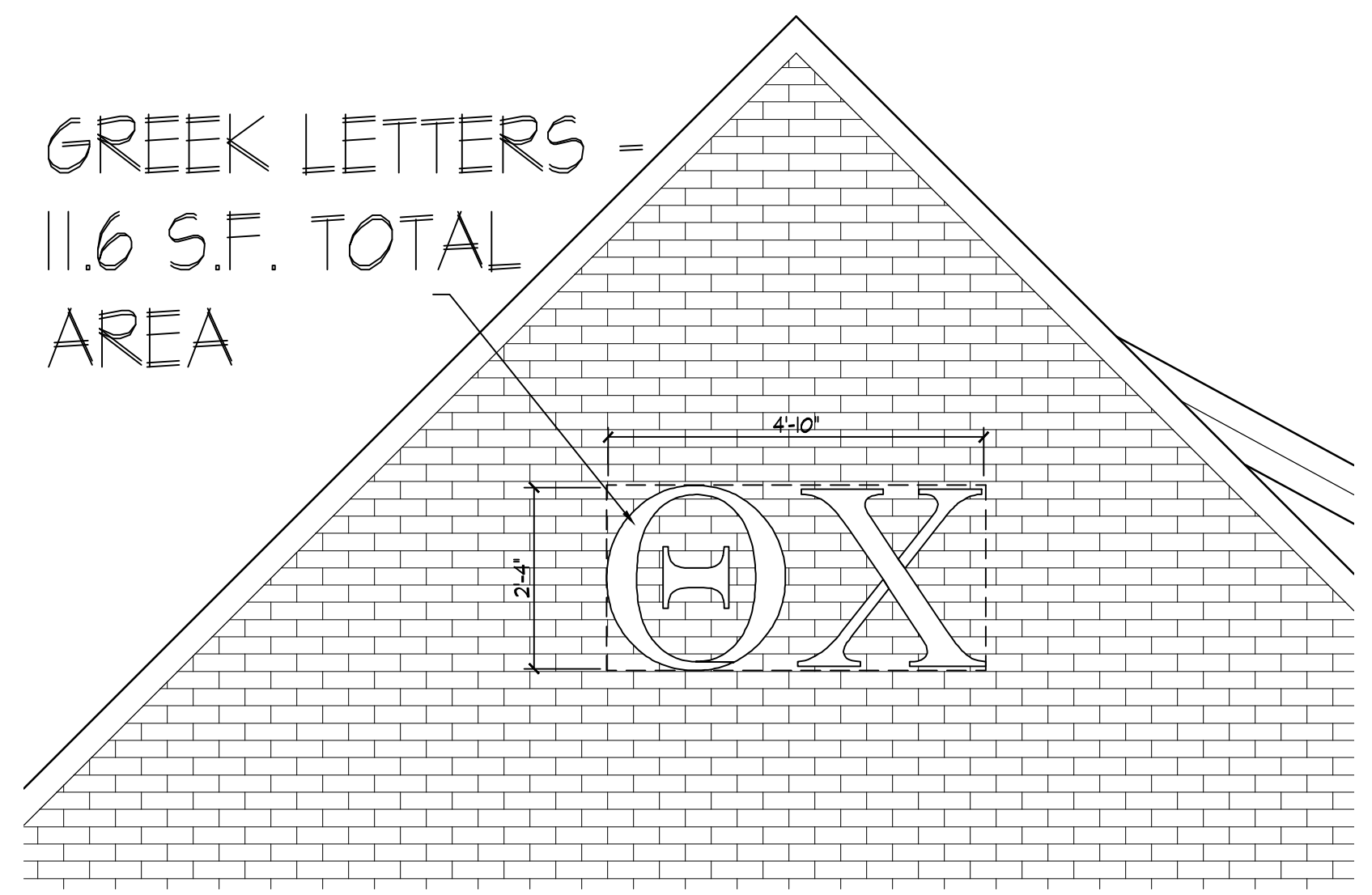

LANGDON ST. ELEVATION - DETAIL
1/2" = 1'-0"



LANGDON ST. ELEVATION - DETAIL
1/2" = 1'-0"



NORTH (SIDE) ELEVATION
1/8" = 1'-0"

- Revisions
- ISSUED FOR BID - FEBRUARY 1, 2013
 - SITE PLAN APPROVAL - APRIL 22, 2013
 - SITE PLAN RESUBMITTAL - JUNE 5, 2013
 - ISSUED FOR PLAN REVIEW - JUNE 7, 2013
 - SITE PLAN RESUBMITTAL - JUNE 18, 2013
 - ISSUED FOR CONSTRUCTION - JULY 19, 2013
 - MINOR ALTERATION - OCTOBER 11, 2013
 - ISSUED - OCTOBER 23, 2013
 - ISSUED - DECEMBER 6, 2013
 - ISSUED - DECEMBER 20, 2013
 - REVISED DOOR 101 PER SELECTION - FEBRUARY 14, 2014

Project Title
Theta Chi

210 Langdon St., Madison WI
Drawing Title
Elevations

Project No. Drawing No.

1231 A-2.1

This document contains confidential or proprietary information of Knothe & Bruce Architects. Neither the document nor the information herein is to be reproduced, distributed, used, or included, either in whole or in part, except as specifically authorized by Knothe & Bruce Architects. Knothe & Bruce Architects is a Limited Liability Company of Wisconsin.