

ONFRID KOTTKE AN ASSOCIATES, INC.
 7550 Westward Way, Madison, WI 53717
 Phone: 608.833.7350 • Fax: 608.833.1089
 YOUR NATURAL RESOURCE FOR LAW • FIELD • MEET

PRELIMINARY PLAT
SUGAR MAPLE
 LOT 1, CERTIFIED SURVEY MAP NO. 1364 AND LOTS 1 & 2, CERTIFIED SURVEY MAP NO. 2351
 LOCATED IN THE NW 1/4 OF THE NW 1/4 OF SECTION 33, T7N, R8E,
 CITY OF MADISON, DANE COUNTY, WISCONSIN

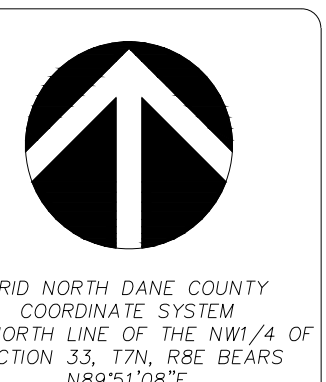

SCALE: 1" = 100'
 0 100

DATE: 12-12-13
 REVISED:
 X

DRAWN BY: KJP

FN: 13-07-103

Sheet Number:
 1 of 1

- LEGEND**
- FOUND 1" IRON PIPE
 - FOUND 3/4" IRON REBAR
 - PLACE 1-1/4" X 18" IRON REBAR (WT=4.3LB/FT)
 - ELECTRIC BOX
 - ⊗ POWER POLE
 - TELEPHONE BOX
 - OHE — OVERHEAD ELECTRIC
 - X — FENCE

- NOTES:**
1. All existing buildings to be removed
 2. Current Zoning: A - Agricultural
 3. Proposed Zoning: Lots 1-44 = SR-C1
 Lots 45-46 = TR-UT

CURVE DATA

CURVE NUMBER	RADIUS (FEET)	CHORD (FEET)	ARC (FEET)	CHORD BEARING	CENTRAL ANGLE	TANGENT BEARING
1-2	15.00	20.53	22.61	N45°15'25"E	86°20'56"	1- N02°04'57"E 2- N88°25'53"E

OWNER & SUBDIVIDER
 Sugar Maple Lane, LLC
 1910 Hawks Ridge Drive, Suite 322
 Verona, WI 53593

SURVEYOR'S CERTIFICATE
 I, Kevin J. Pape, Registered Land Surveyor, S-2568, hereby certify that this preliminary plat is a true and correct representation of all the adjacent existing land divisions and of the boundary of the preliminary plat and features and that I have fully complied with the City of Madison Subdivision Ordinance.

Dated this 16th day of SEPTEMBER, 2013.

Kevin J. Pape, Registered Land Surveyor, S-2568

