

**APPLICATION FOR  
URBAN DESIGN COMMISSION  
REVIEW AND APPROVAL**

**AGENDA ITEM #** 9  
**Project #** 8-101-13  
31340

DATE SUBMITTED: <u>August 21, 2013</u>	<b>Action Requested</b>
UDC MEETING DATE: <u>August 28, 2012</u>	<input checked="" type="checkbox"/> Informational Presentation
	<input type="checkbox"/> Initial Approval and/or Recommendation
	<input type="checkbox"/> Final Approval and/or Recommendation

PROJECT ADDRESS: 1220, 1226, 1234 and 1236 Mound Stree

ALDERMANIC DISTRICT: Sue Elingson - District #3

OWNER/DEVELOPER (Partners and/or Principals)	ARCHITECT/DESIGNER/OR AGENT:
<u>Mike Fisher</u>	<u>Knothe &amp; Bruce Architects, LLC</u>
<u>2249 Pinehurst Dr</u>	<u>7601 University Avenue, Suite 201</u>
<u>Middleton WI 53562</u>	<u>Middleton, Wisconsin 53562</u>

CONTACT PERSON: J. Randy Bruce/Knothe & Bruce Architects, LLC

Address: 7601 University Avenue, Suite 201  
Middleton, Wisconsin 53562

Phone: 608-836-3690

Fax: 608-836-6934

E-mail address: [rbruce@knothebruce.com](mailto:rbruce@knothebruce.com)

**TYPE OF PROJECT:**

(See Section A For:)

- Planned Unit Development (PUD)
  - General Development Plan (GDP)
  - Specific Implementation Plan (SIP)
- Planned Community Development (PCD)
  - General Development Plan (GDP)
  - Specific Implementation Plan (SIP)
- Planned Residential Development (PRD)
- New Construction or Exterior Remodeling in an Urban Design District\* (A public hearing is required as well as a fee)
- School, Public Building or Space (Fee may be required)
- New Construction or Addition to or Remodeling of a Retail, Hotel, or Motel Building Exceeding 50,000 Sq.Ft.
- Planned Commercial Site

(See Section B for:)

- New Construction or Exterior Remodeling in C4 District (Fee required)

(See Section C for:)

- R.P.S.M. Parking Variance (Fee required)

(See Section D for:)

- Comprehensive Design Review\* (Fee required)
- Street Graphics Variance\* (Fee Required)

Other \_\_\_\_\_

\*Public Hearing Required (Submission Deadline 3 Weeks in Advance of Meeting Date)



July 17, 2013

Ms. Katherine Cornwell  
Department of Planning & Development  
City of Madison  
215 Martin Luther King Jr. Blvd.  
PO Box 2985  
Madison, Wisconsin 53701

Re: Letter of Intent  
PD-GDP-SIP Submittal  
St. James Cottage Homes  
1220, 1226, 1234, 1236 Mound Street  
Madison, WI

Dear Ms. Cornwell,

The following is submitted together with the plans, application and zoning text for staff, Plan Commission and Common Council consideration of approval.

**Organizational structure:**

Owner:	Mike Fisher 2249 Pinehurst Dr. Middleton, WI 53562 608-836-2940 Contact: Mike Fisher <a href="mailto:fisherco@chorus.net">fisherco@chorus.net</a>	Architect:	Knothe & Bruce Architects, LLC 7601 University Ave, Suite 201 Middleton, WI 53562 (608)836-3690 Contact: Randy Bruce <a href="mailto:rbruce@knothebruce.com">rbruce@knothebruce.com</a>
--------	--	------------	--

Engineer:	Vierbicher 999 Fourier Drive, Suite 201 Madison, WI 53717 (608) 826-0532 Contact: Tim Schleeper <a href="mailto:tsch@vierbicher.com">tsch@vierbicher.com</a>	Landscape Architect:	Vierbicher
-----------	---	----------------------	------------

**Introduction:**

The half-acre site for this project is located between St. James Court and Mound Street on the east side of S. Orchard Street. The site currently consists of four through-lots at 1220, 1226, 1234 and 1236 Mound Street, each occupied with a single-family home or two-flat. Backyard parking dominates the St. James Court frontage. This project proposes that these four lots be re-platted to create 3 additional lots fronting St. James Court, making a total of 7 lots. The four

7601 University Ave, Ste 201  
Middleton, Wisconsin 53562  
p (608) 836-3690  
f (608) 836-6934  
[www.knothebruce.com](http://www.knothebruce.com)



Aerial  
**St. James Court**

March 11, 2013

SAINT JAMES COURT

S. ORCHARD STREET

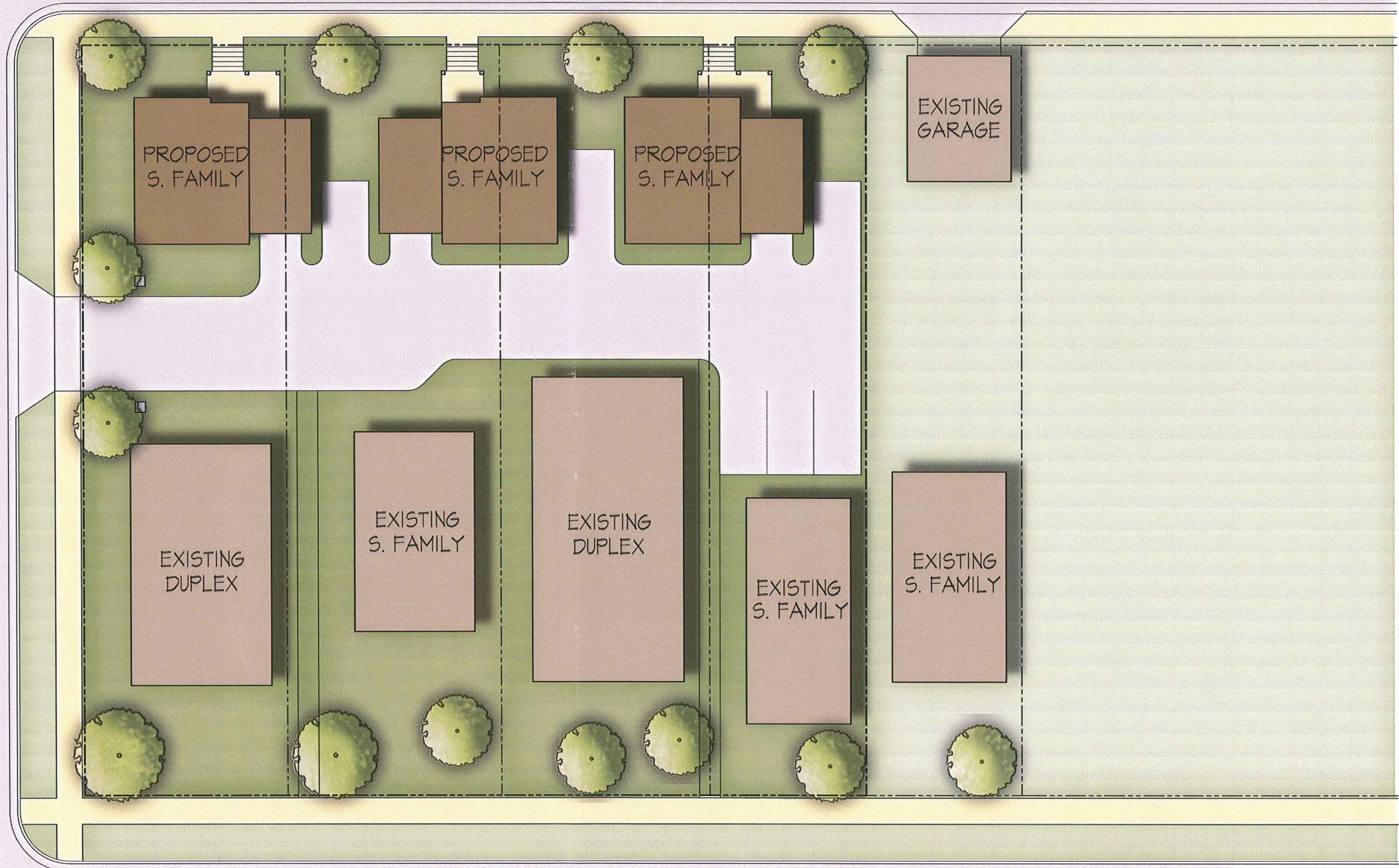

MOUND STREET

Site Plan  
**St. James Court**

March 11, 2013

**KNOTHE  
& BRUCE**  
*architects*



Elevations  
**St. James Court**

March 11, 2013

**KNOTHE  
& BRUCE**  
*architects*