

JURISDICTIONAL LIMITS ALONG MID TOWN RD

DEPARTMENT OF PUBLIC WORKS
CITY ENGINEERING DIVISION
MADISON, WISCONSIN

CURRENT CITY OF MADISON LIMITS ALONG MID TOWN RD

LANDS TO BE ATTACHED TO THE CITY OF MADISON
FROM THE TOWN OF VERONA PER THE TERMS OF
A BOUNDARY ADJUSTMENT AGREEMENT
PART "A" & PART "B"

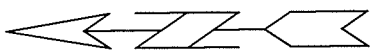
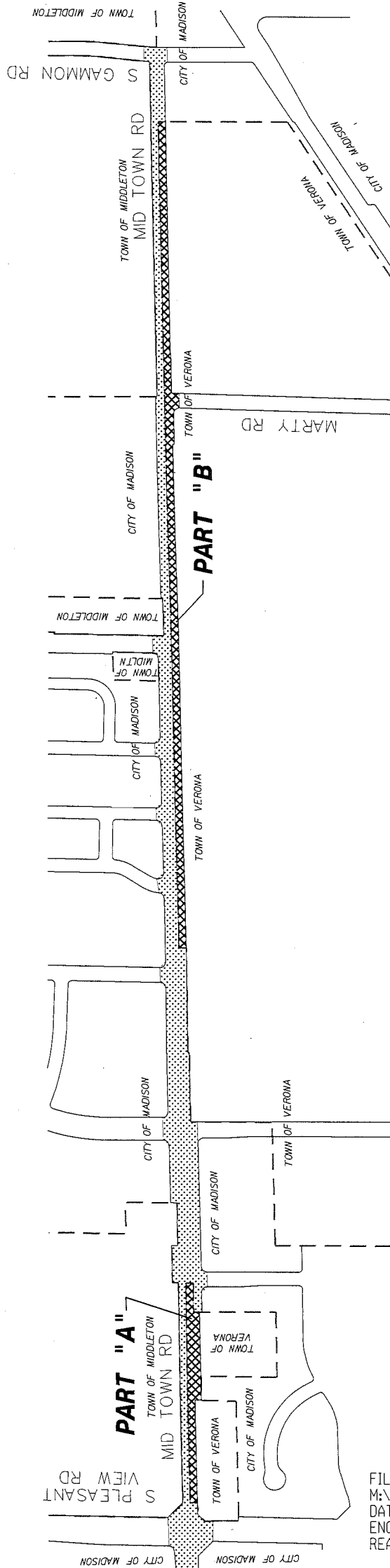
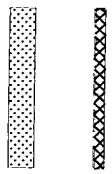

SCALE: 1"=600 FEET

FILENAME:
M:\Mapping\Annexations\ 53W1275\City Limits.dgn
DATE: 05/18/2011
ENGR. PROJ. NO. 53W1275
REAL ESTATE PROJ. NO.

TOWN OF VERONA PARCELS SUBJECT TO INTERGOVERNMENTAL AGREEMENT

DEPARTMENT OF PUBLIC WORKS
CITY ENGINEERING DIVISION
MADISON, WISCONSIN

AFFECTED TOWN OF VERONA PARCELS PER THE TERMS OF A BOUNDARY ADJUSTMENT AGREEMENT WITH THE CITY OF MADISON

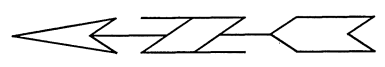
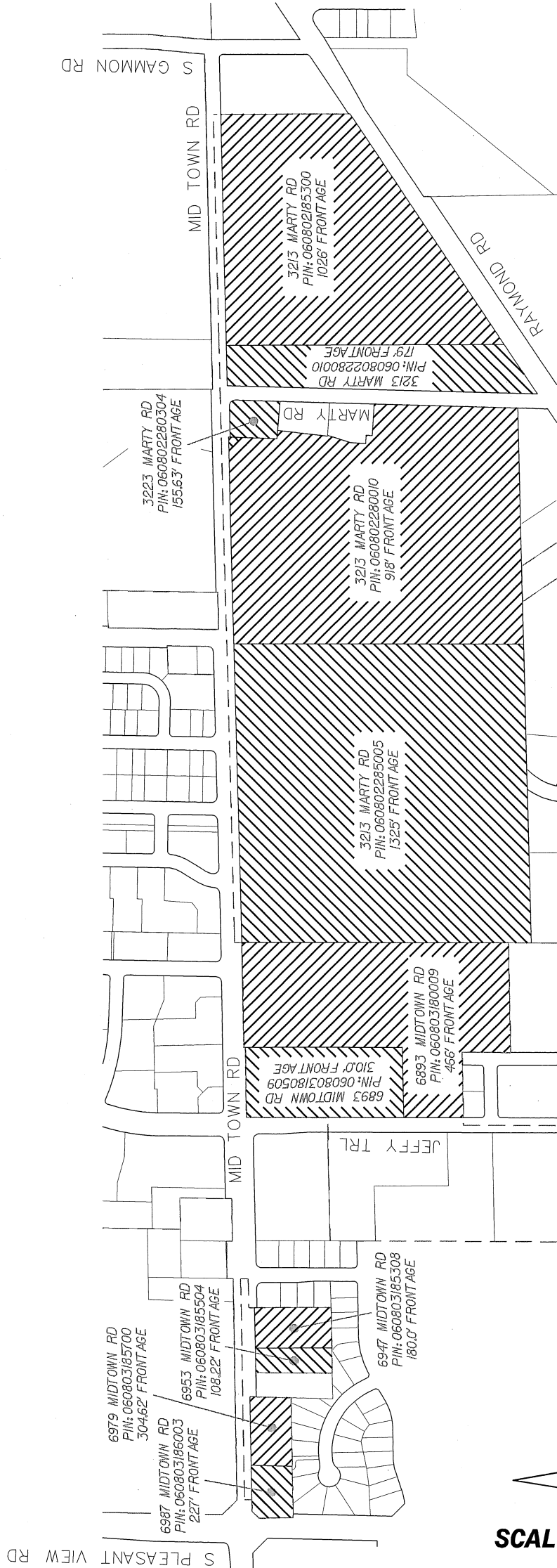

SCALE: 1"=600 FEET

FILENAME:
M:\Mapping\Annexations\ 53W1275\
Bound_Adj-Agmt_MidTownRd.dgn
DATE: 05/20/2011
ENGR. PROJ. NO. 53W1275