

PETITION FOR DETACHMENT

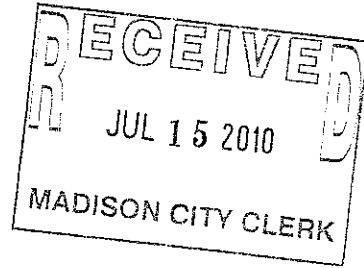

TO: Ms Maribeth Witzel-Behl
City Clerk
City of Madison, Room 103
210 Martin Luther King, Jr. Blvd
Madison, WI 53703

THIS PETITION is filed pursuant to Wis. Stats. § 66.0227, and is signed by all owners of all of the real property described on Exhibit A, which is attached hereto and incorporated herein ("the Property").

1. The property is currently located within the corporate limits of the City of Madison, and it is requested that the property be detached from the City of Madison and annexed to the Village of McFarland.

2. Attached hereto as Exhibit B is a scale map reasonably showing the boundaries of the property and the relation of the property to the municipalities involved.

3. The current population of the property is one.

WHEREFORE, Petitioner requests that the City of Madison enact an Ordinance detaching the property from the City of Madison and that the Village Board of the Village Board of the Village of McFarland accept such terms pursuant to Wis. Stats. § 66.0227(2)

PETITIONER:

Dated: July 6, 2010

By: Amy J. Alsmo
Amy J. Alsmo

EXHIBIT A

**Legal Description of Lands to be Detached From the
City of Madison and Attached to the Village of McFarland**

Part of the SE 1/4 of the NE 1/4 of Section 34, T7N, R10E,
more particularly described as follows:

Beginning at a point on the South quarter line of said NE 1/4,
664.57 feet West of the Southeast corner thereof; thence North
0° 40' East, 178.0 feet; thence West parallel to the said South
quarter line 19.5 feet; thence South 0° 40' West 178.0 feet;
thence East along said South quarter line 19.5 feet to the point
of beginning.

4849-5202-5862 v 1

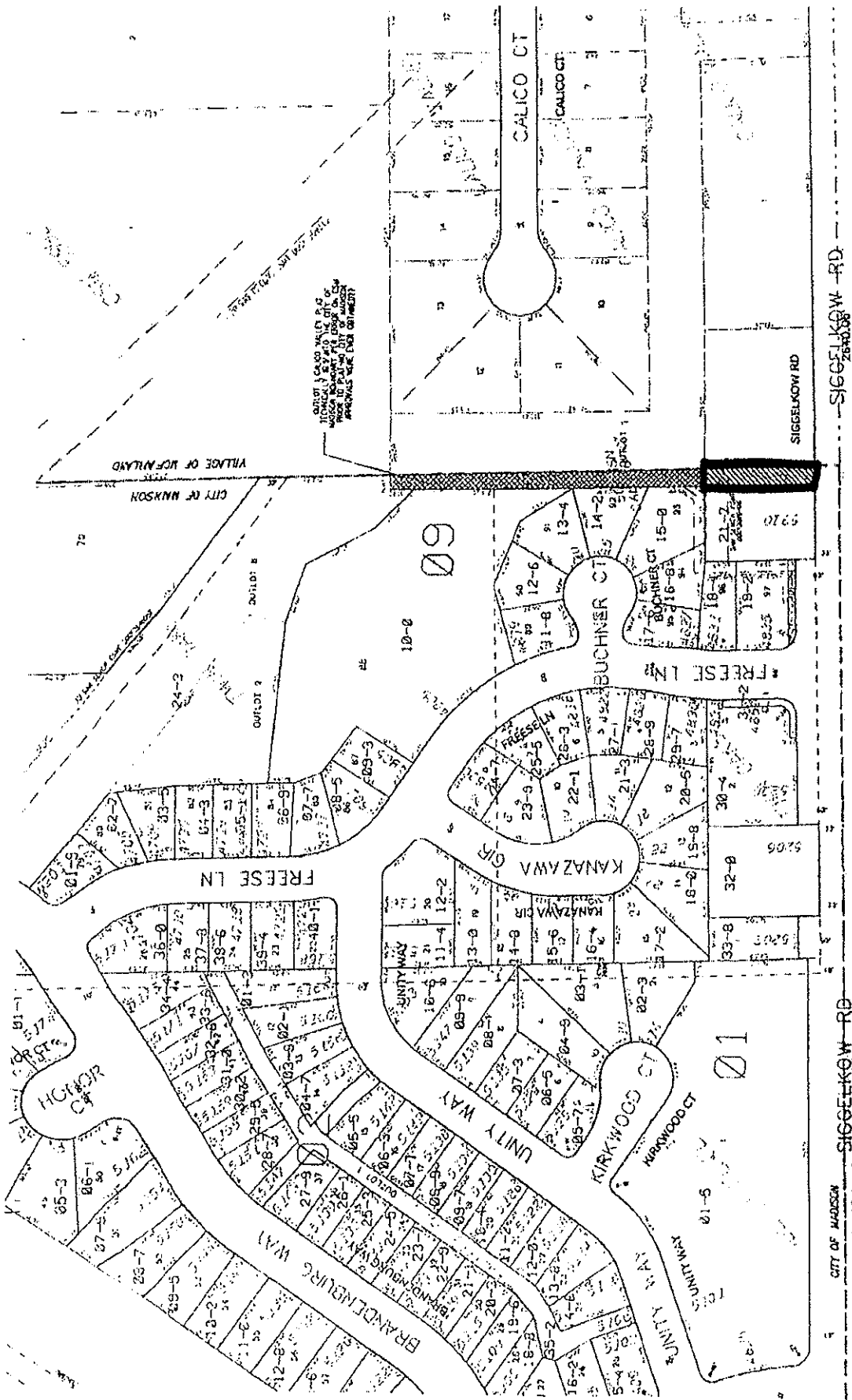

07103

CITY OF MADISON PART OF ALSMO PROPERTY
 CITY TO DETACH TO VILLAGE OF MC FARLAND
 AFTER QUIT CLAIM OF OUTLOT 1 IS RECORDED



VILLAGE OF MC FARLAND QUIT CLAIM TO
 CITY OF MADISON AND LANDS REMAIN
 WITHIN CITY OF MADISON CORPORATE
 LIMITS



EXHIBIT

B

**NOTICE OF INTENTION TO
CIRCULATE A PETITION OF DETACHMENT**

PLEASE TAKE NOTICE, that within one hundred twenty (120) days after the date of publication of this notice, the undersigned, the owner of lands within the area referred to herein, will cause a Petition to be circulated for the purpose of detaching from the City of Madison, Dane County, Wisconsin, and annexing to the Village of McFarland, Dane County, Wisconsin, the following described parcel of land:

Part of the SE 1/4 of the NE 1/4 of Section 34, T7N, R10E,
more particularly described as follows:

Beginning at a point on the South quarter line of said NE 1/4,
664.57 feet West of the Southeast corner thereof; thence North
0° 40' East, 178.0 feet; thence West parallel to the said South
quarter line 19.5 feet; thence South 0° 40' West 178.0 feet;
thence East along said South quarter line 19.5 feet to the point
of beginning

A scale map of the territory proposed to be detached from the City of Madison and annexed to the Village of McFarland is attached as Exhibit "A."

Dated this 24 day of June, 2010.

PETITIONER:

Dated: June 24, 2010

By: Amy J. Alsmo
Amy J. Alsmo

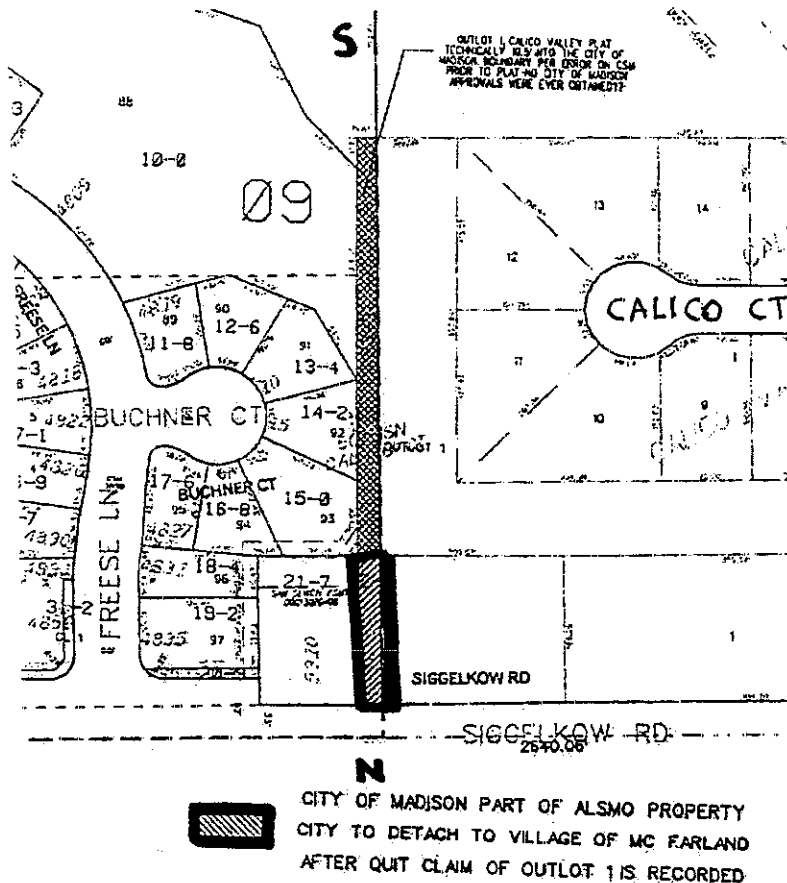

Capital Newspapers Proof of Publication Affidavit

Ad #: 1611286 Price: \$183 52 Ad ID: Alsmo Detachment Notice

Retain this portion for your records.

Please do not remit payment until you receive your advertising invoice.

Mail to:

McFarland, Village of
Dawn Graham
P.O. Box 110
McFarland, WI 53558-0110

STATE OF WISCONSIN

Dane County

SS.

Arlene Staff

being duly sworn, doth depose and say that
he (she) is an authorized representative of
Capital Newspapers, publishers of

Wisconsin State Journal

newspaper, at Madison, the seat of government of said State,
and that an advertisement of which the annexed is a true
copy, taken from said paper, was published therein on
June 30th, 2010

NOTICE OF INTENTION TO CIRCULATE A PETITION OF DETACHMENT

PLEASE TAKE NOTICE, that within one hundred twenty (120) days after the date of publication of this notice, the undersigned, the owner of lands within the area referred to herein, will cause a Petition to be circulated for the purpose of detaching from the City of Madison, Dane County, Wisconsin, and annexing to the Village of McFarland, Dane County, Wisconsin, the following described parcel of land:

Part of the SE 1/4 of the NE 1/4 of Section 34, T7N, R10E
more particularly described as follows:

Beginning at a point on the South quarter line of said NE 1/4, 684.57 feet West of the Southeast corner thereof; thence North 0 degrees 40' East, 178.0 feet; thence West parallel to the said South quarter line 19.5 feet; thence South 0 degrees 40' West 178.0 feet; thence East along said South quarter line 19.5 feet to the point of beginning.

A scale map of the territory proposed to be detached from the City of Madison and annexed to the Village of McFarland is attached as Exhibit "A"

Dated this 24th day of June, 2010.

PETITIONER:

Dated: June 24, 2010

/s/ Amy J. Alsmo

igned)

tle)

Arlene Staff
Principal Clerk

Subscribed and sworn to before me on

6-30-10

Ellen M. Moran
Notary Public, Dane County, Wisconsin

My Commission expires May 24th, 2013

