

# THE UNIVERSITY OF WISCONSIN

JOINT CAMPUS AREA COMMITTEE - MADISON

22D5A CAMP RANDALL SPORTS CENTER REPLACEMENT

December 12, 2023  
INFORMATIONAL





# AGENDA

---

- PROJECT SCOPE
- LOCATING THE PROJECT SITE
- SITE CONTEXT & PHOTOS
- BLOCKING ADJACENCIES & MASSING



## PROJECT DESCRIPTION

- Replace the existing McClain & Shell buildings with a new athletics training facility & indoor practice field. This facility will be the home of the football, men's & women's soccer, and men's & women's track programs .
- The new facilities helps meet critical space needs for each athletic personnel department in the building.
- Increase available parking on site for building occupants and public to utilize.
- Designed to promote natural lighting and views to the outdoor.
- Includes opportunities for revenue generation and interaction with the public.
- Enables potential future expansion projects to build vertically.

**PROJECT BUDGET:**  
**\$285,163,000**

**PROJECT SQUARE FOOTAGE:**  
**440,000 - 450,000**

## PROJECT GOALS

- Design & construct an athletics training facility that allows the program to remain relevant with other program facilities.
- Consolidate all day-to-day operations for each team into a 3 level facility.
- Create direct adjacencies for key departments for efficiency of personnel.
- Deliver a full 100 yard indoor practice facility with adequate runoff space around the perimeter of the field.
- Incorporate sustainable building initiatives that align with University of Wisconsin's Campus Goals.
- Engage the public through the Hall of Fame and evolving story of Camp Randall.



PROJECT SCOPE

MAJOR PROGRAM SPACES:	EST SQ. FT.
- INDOOR PRACTICE FACILITY	90,000
- PARKING	90,000
- WEIGHT ROOM	22,400
- ATHLETIC TRAINING	14,200
- PLAYER LOCKER ROOM	15,000
- EQUIPMENT ROOM	8,400
- DINING HALL	10,200
- MEETING ROOMS	12,100
- FOOTBALL OFFICES	29,100





CAMPUS MAP

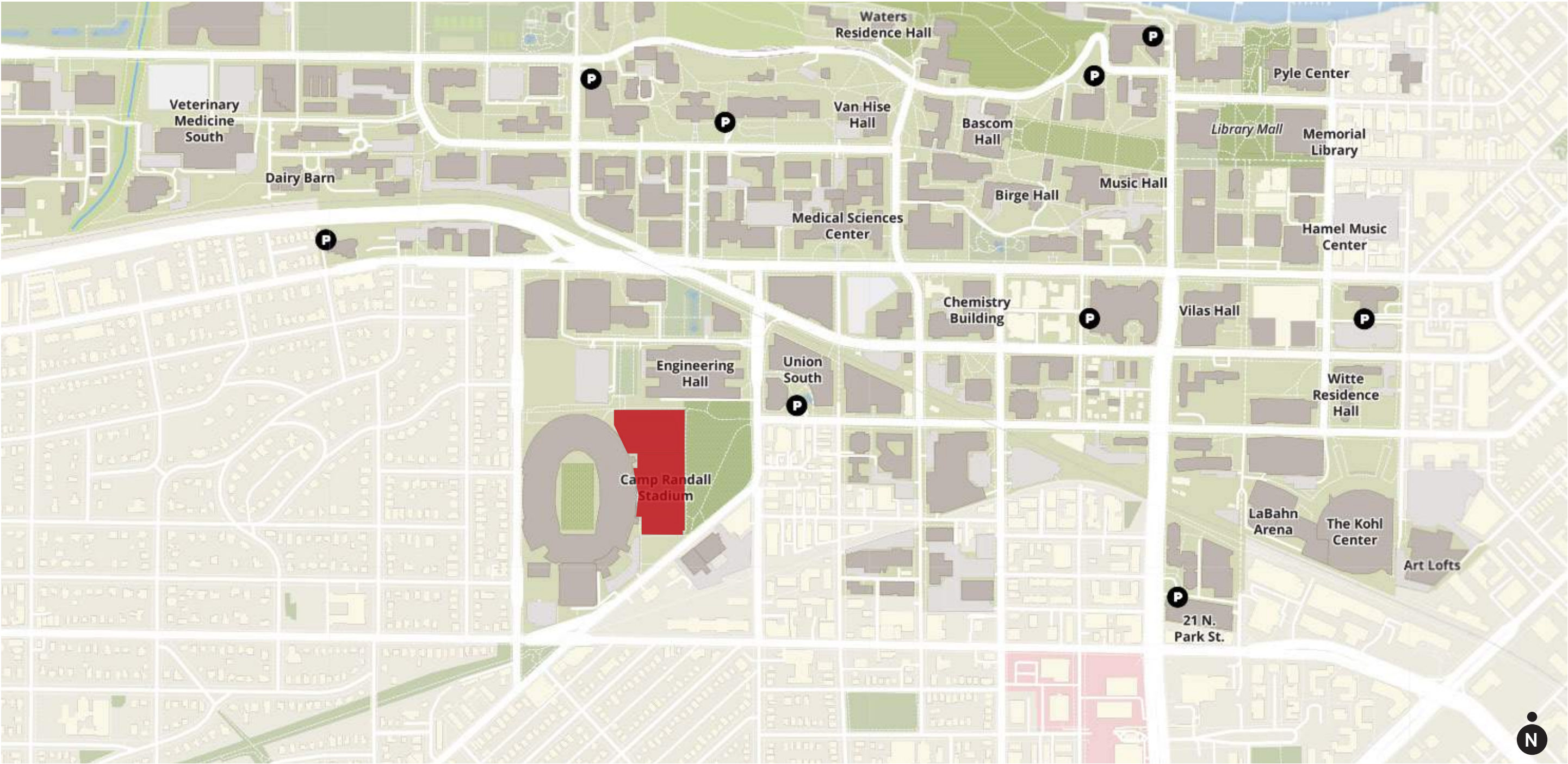



## CAMPUS MASTER PLAN





## SITE AERIAL





## SITE AERIAL





## SITE AERIAL





## SITE AERIAL

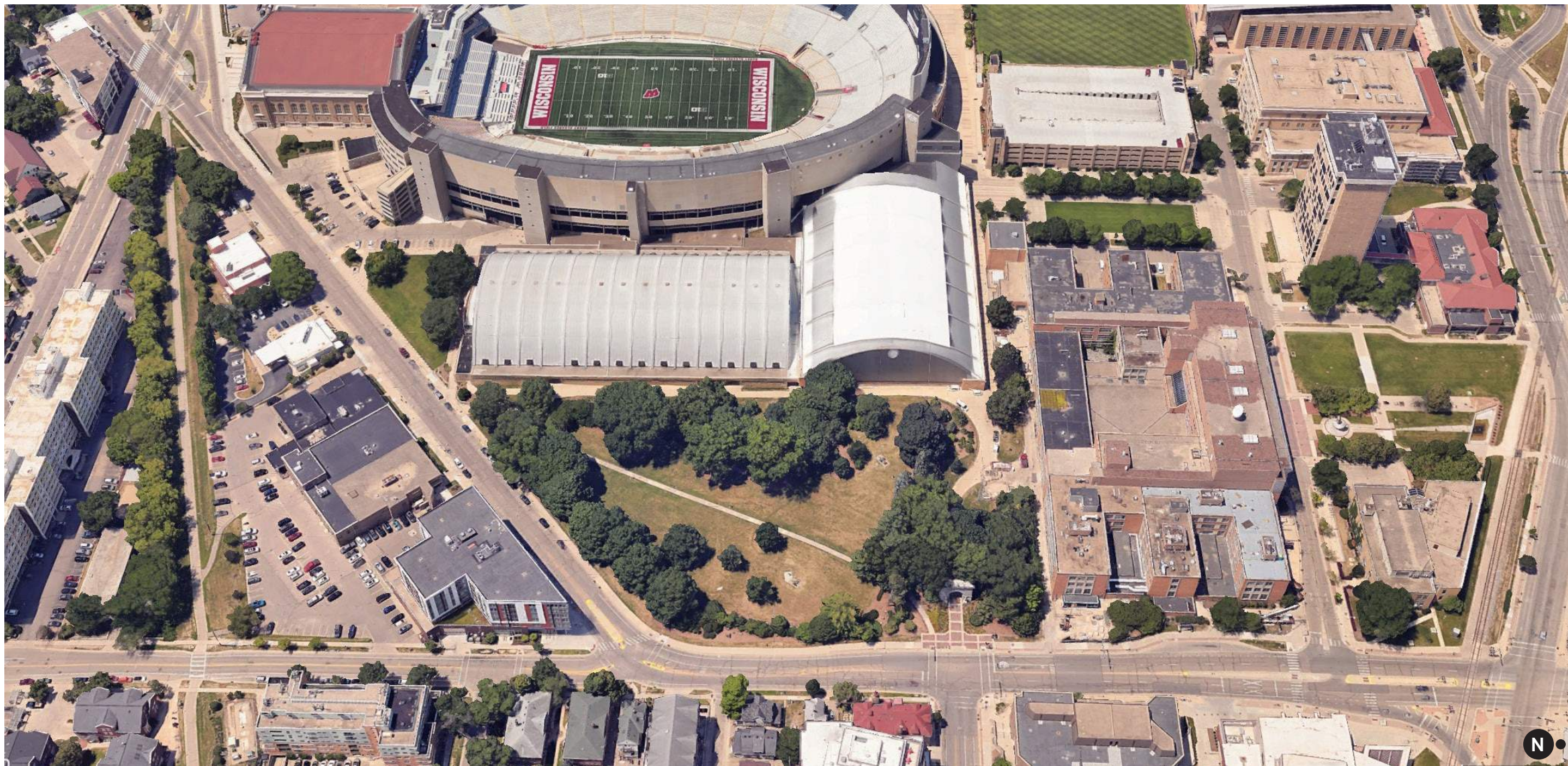



## CAMP RANDALL GROUNDS

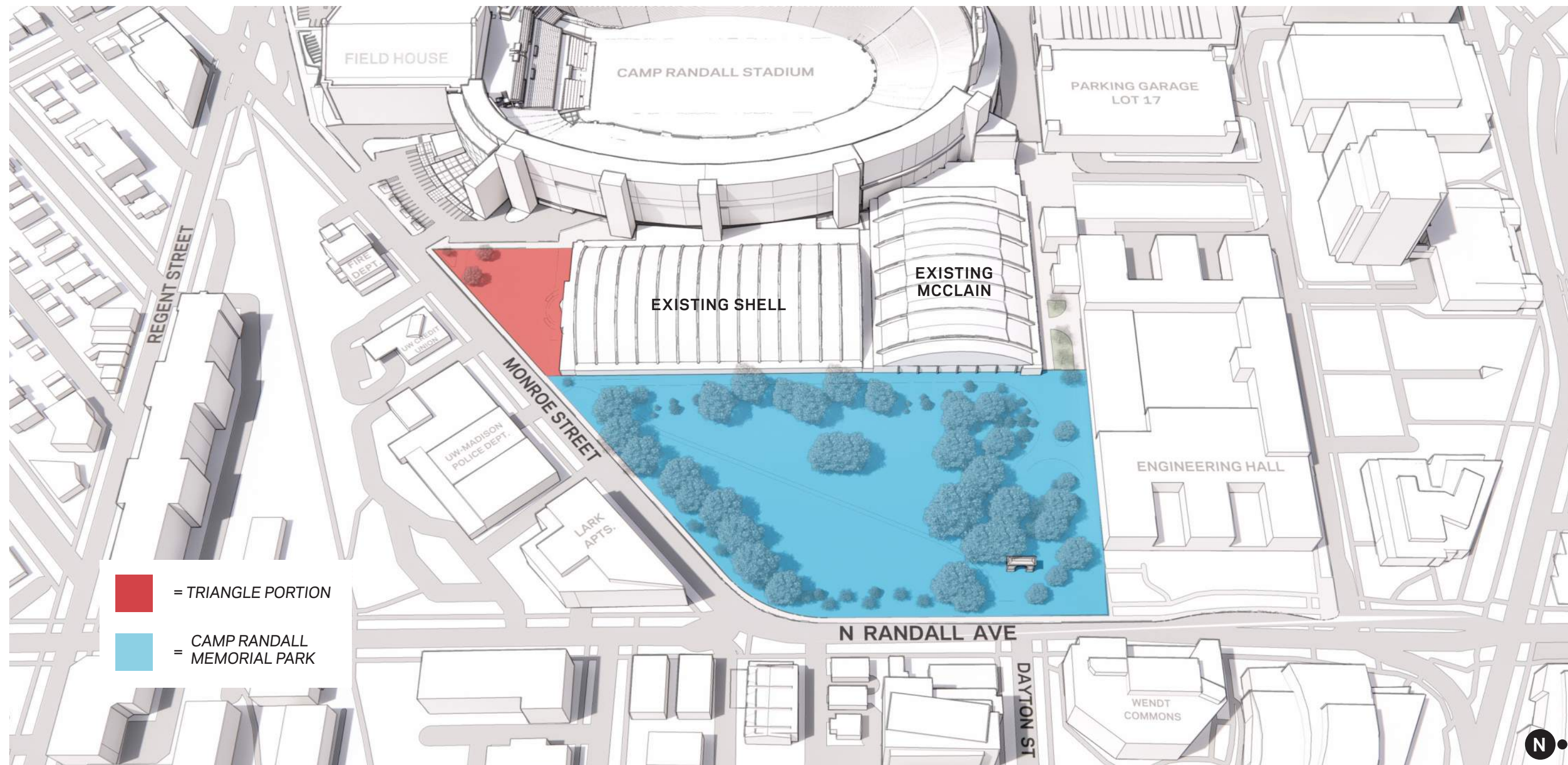



## CAMP RANDALL MEMORIAL PARK





EXISTING CONDITIONS - DEMOLITION

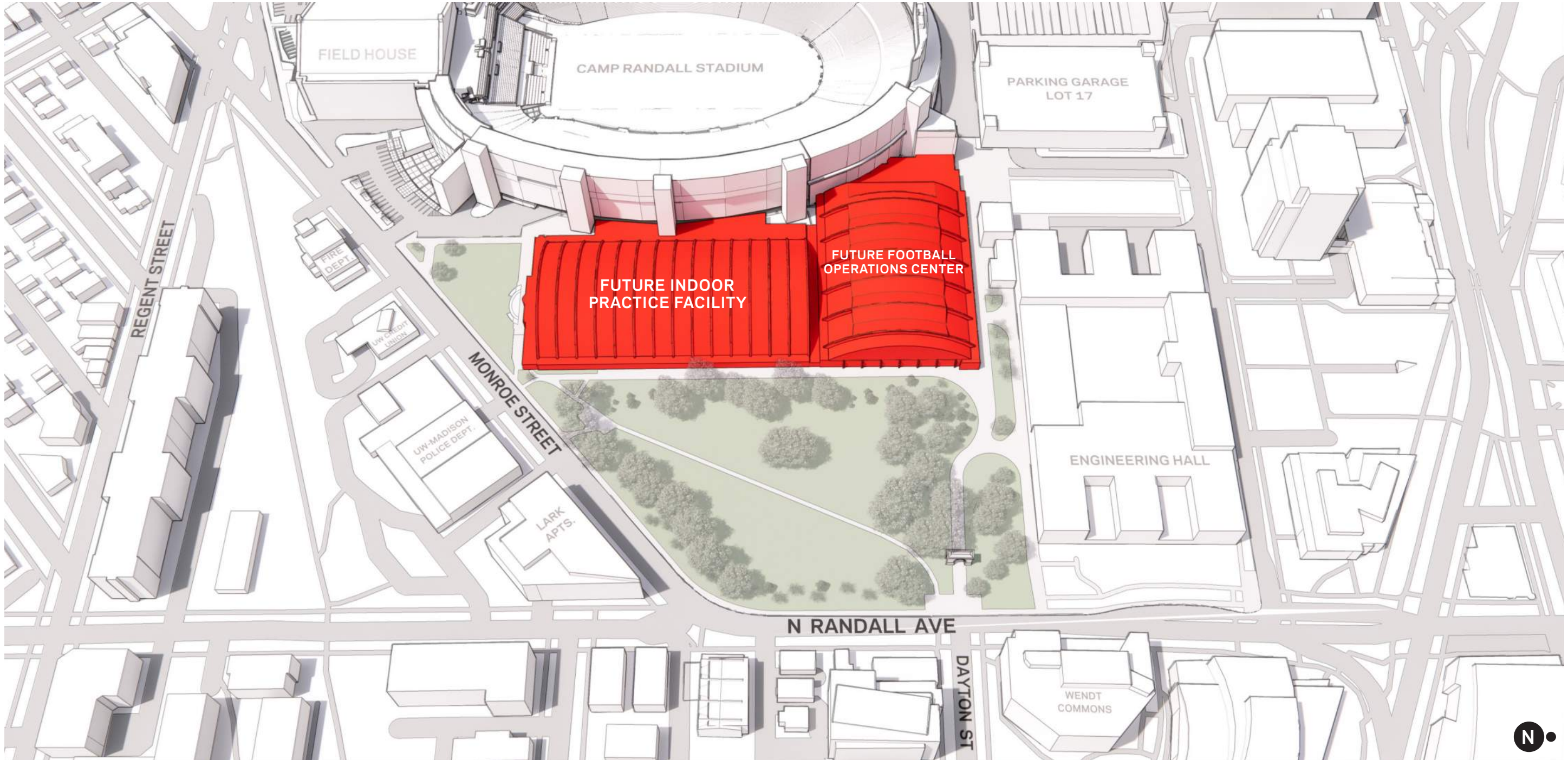



## SITE ACCESS

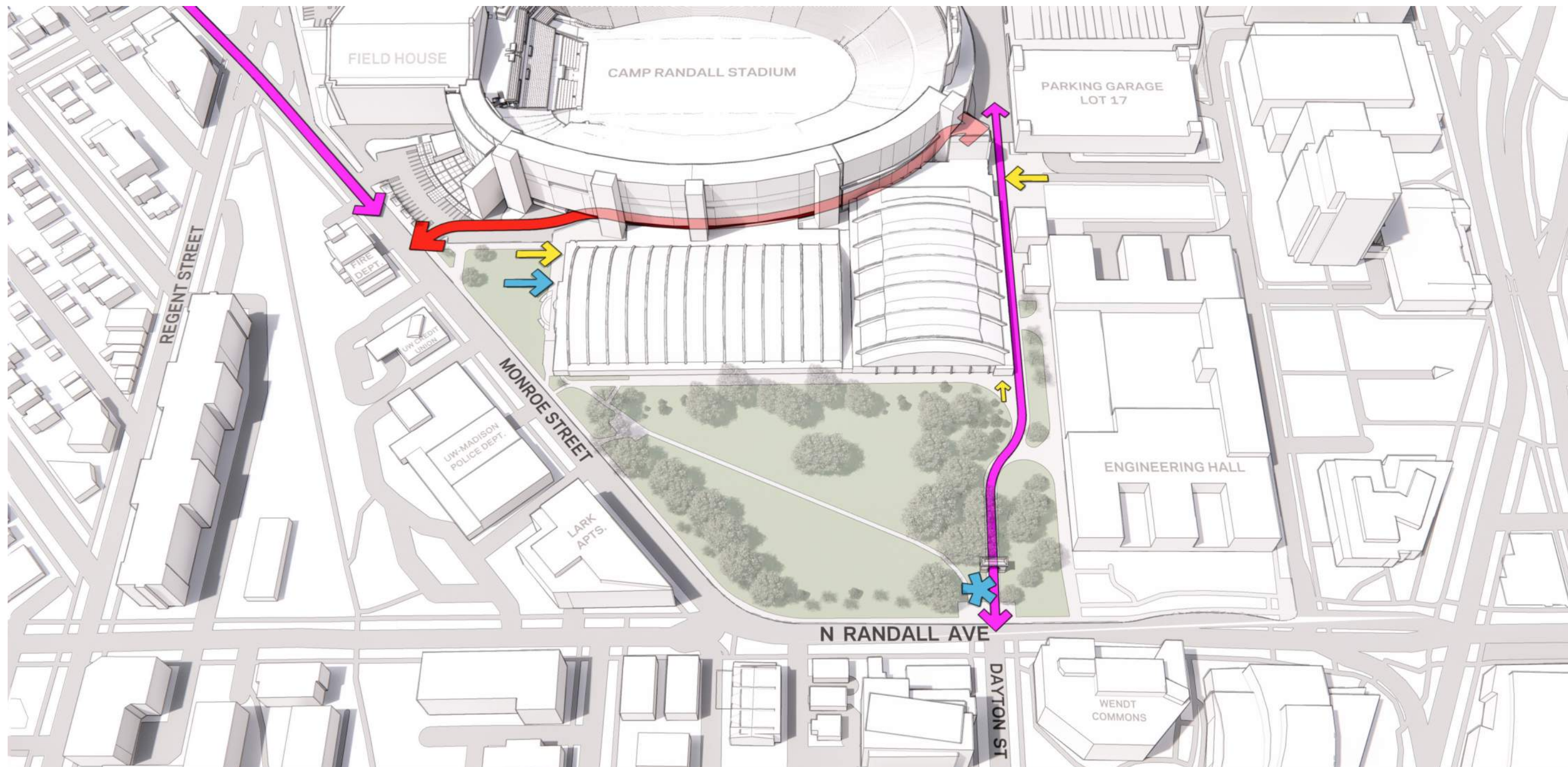



SITE TOPOGRAPHY

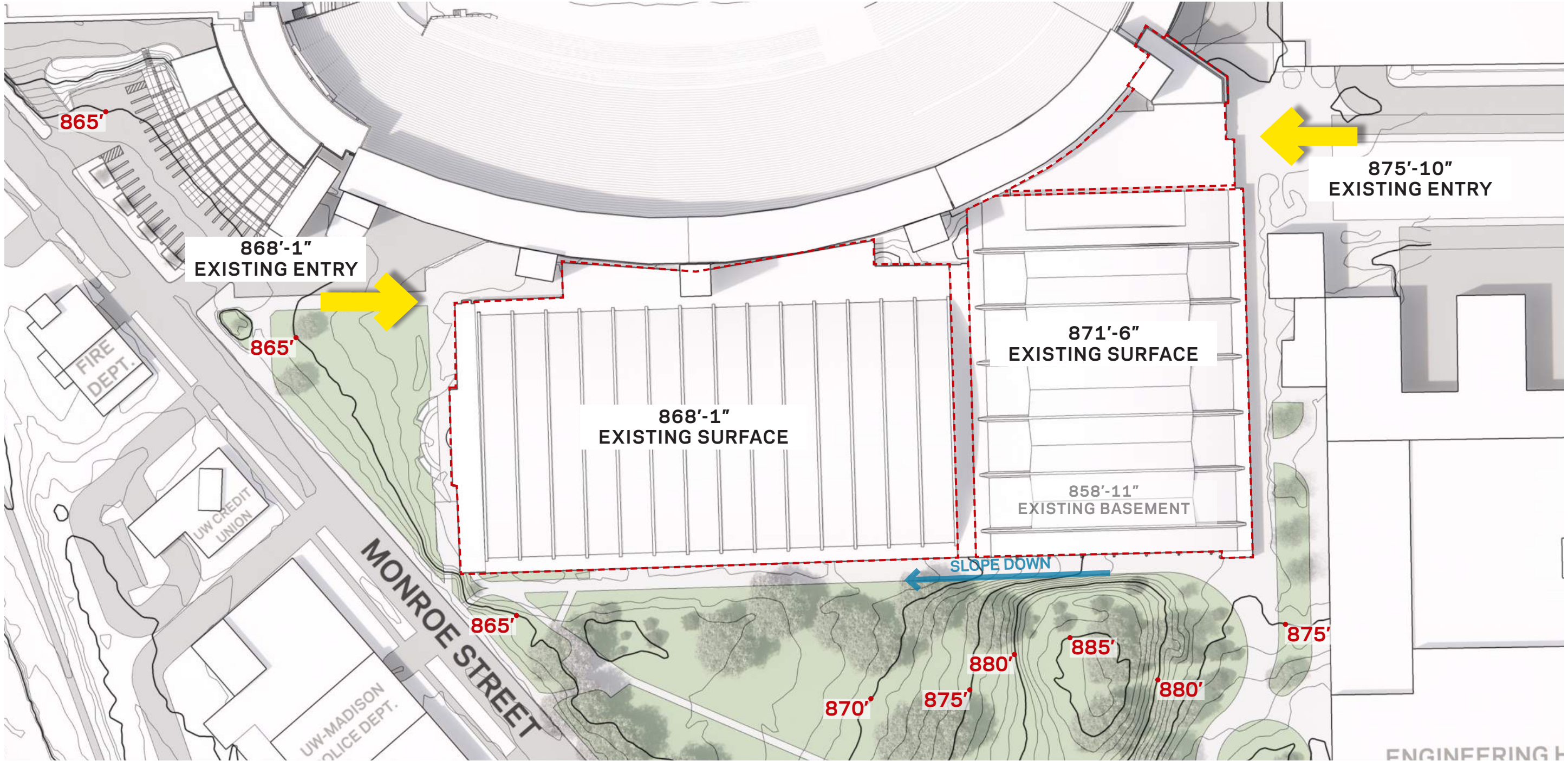



BUILDING EDGES

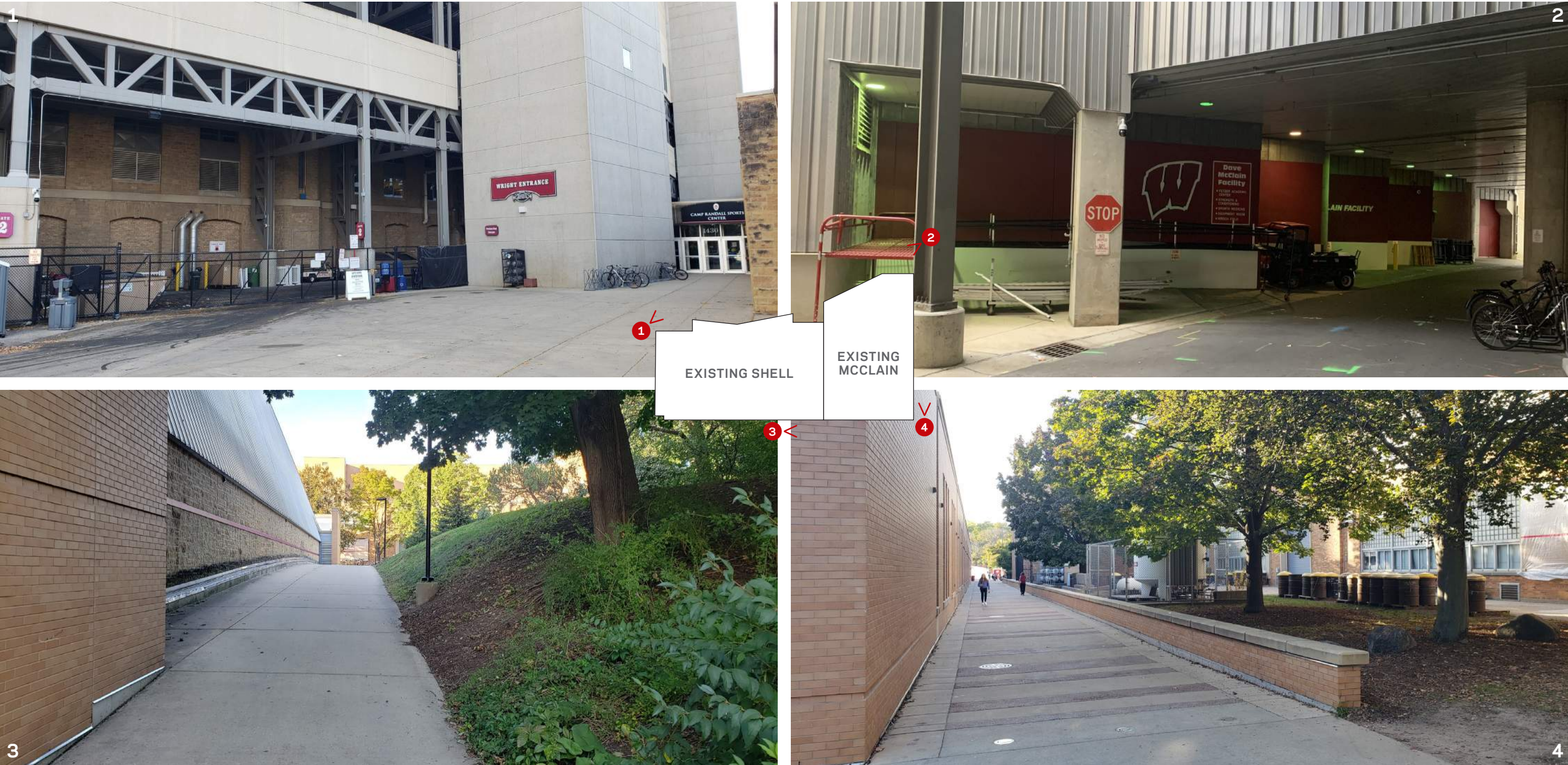



## NORTH SIDE OF CAMP RANDALL

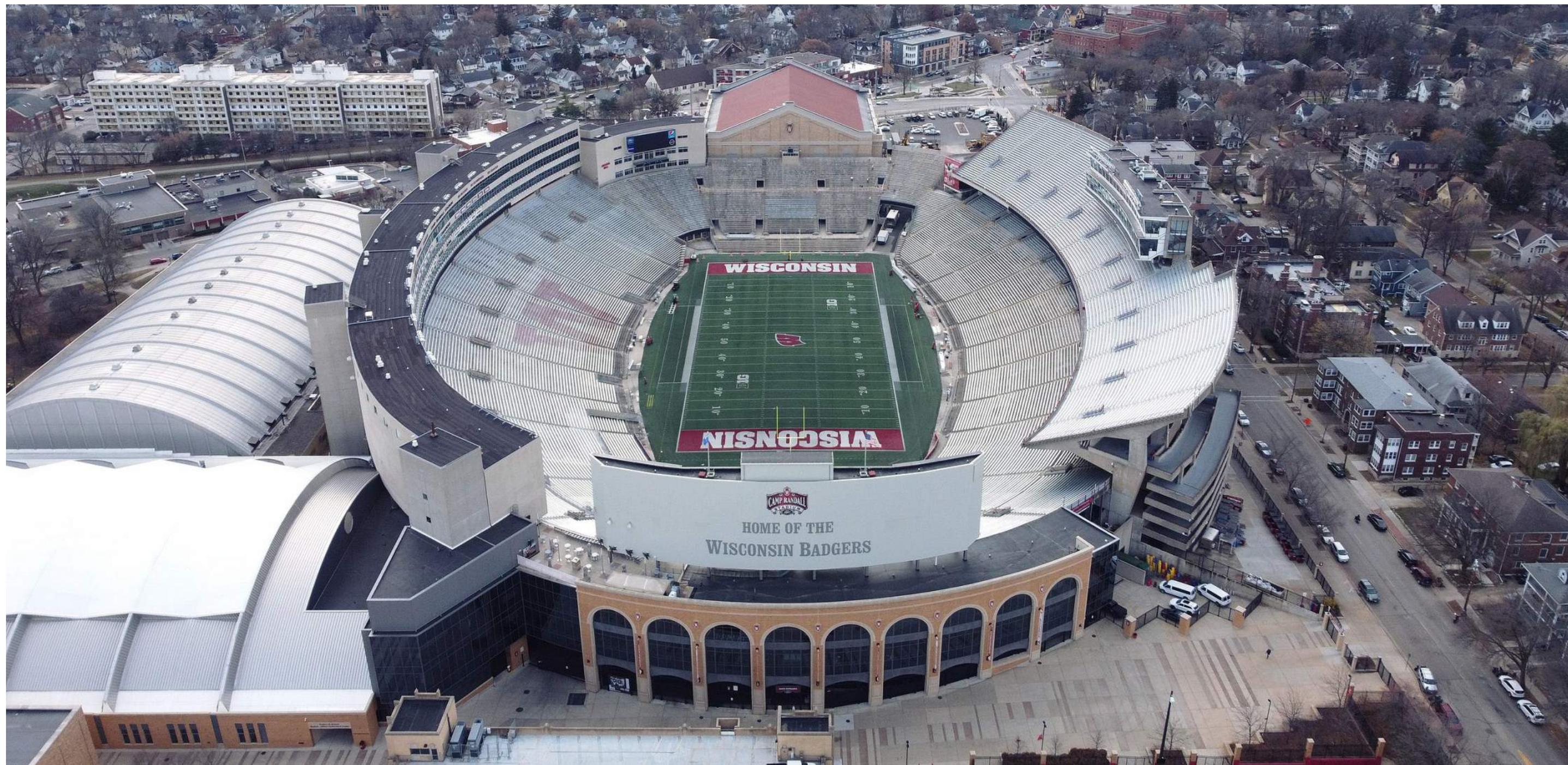



## SAPC STEPHEN M. BENNETT ENTRANCE

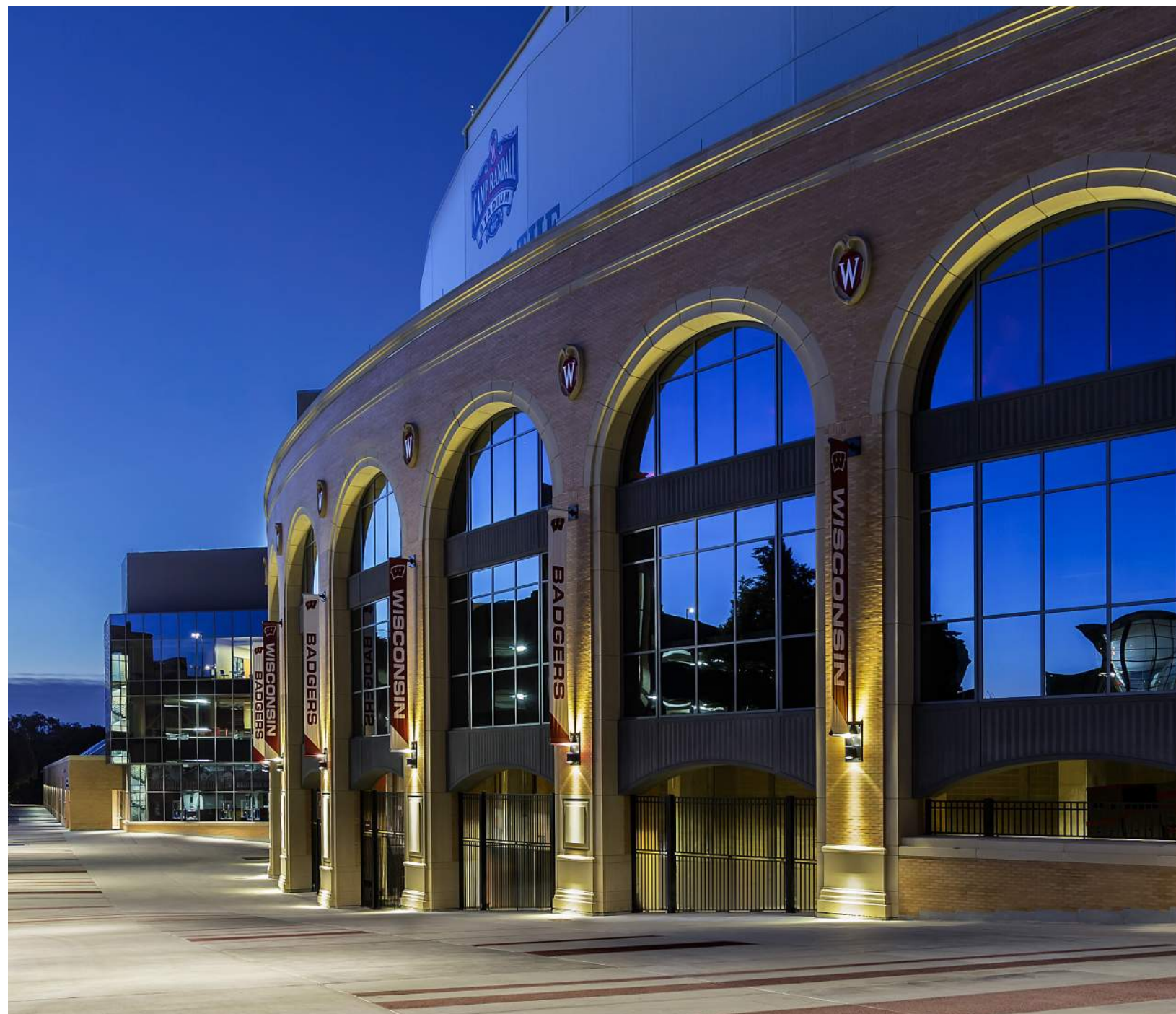



**KELLNER HALL**



WISCONSIN FIELD HOUSE





## ENGINEERING HALL





**PARKING LOT 17**



# BLOCKING ADJACENCIES

---

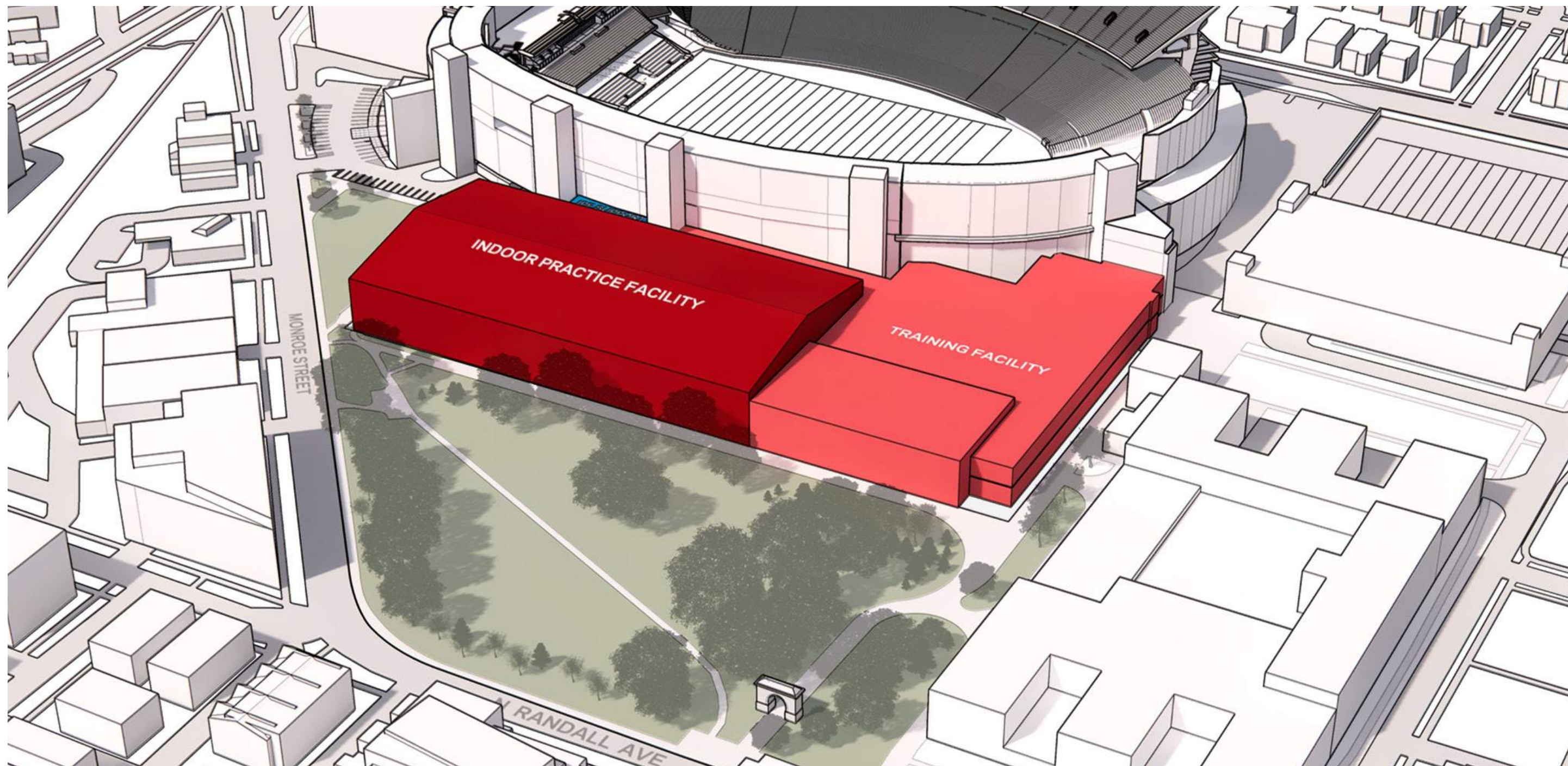

**PREFERRED CONCEPT MASSING**

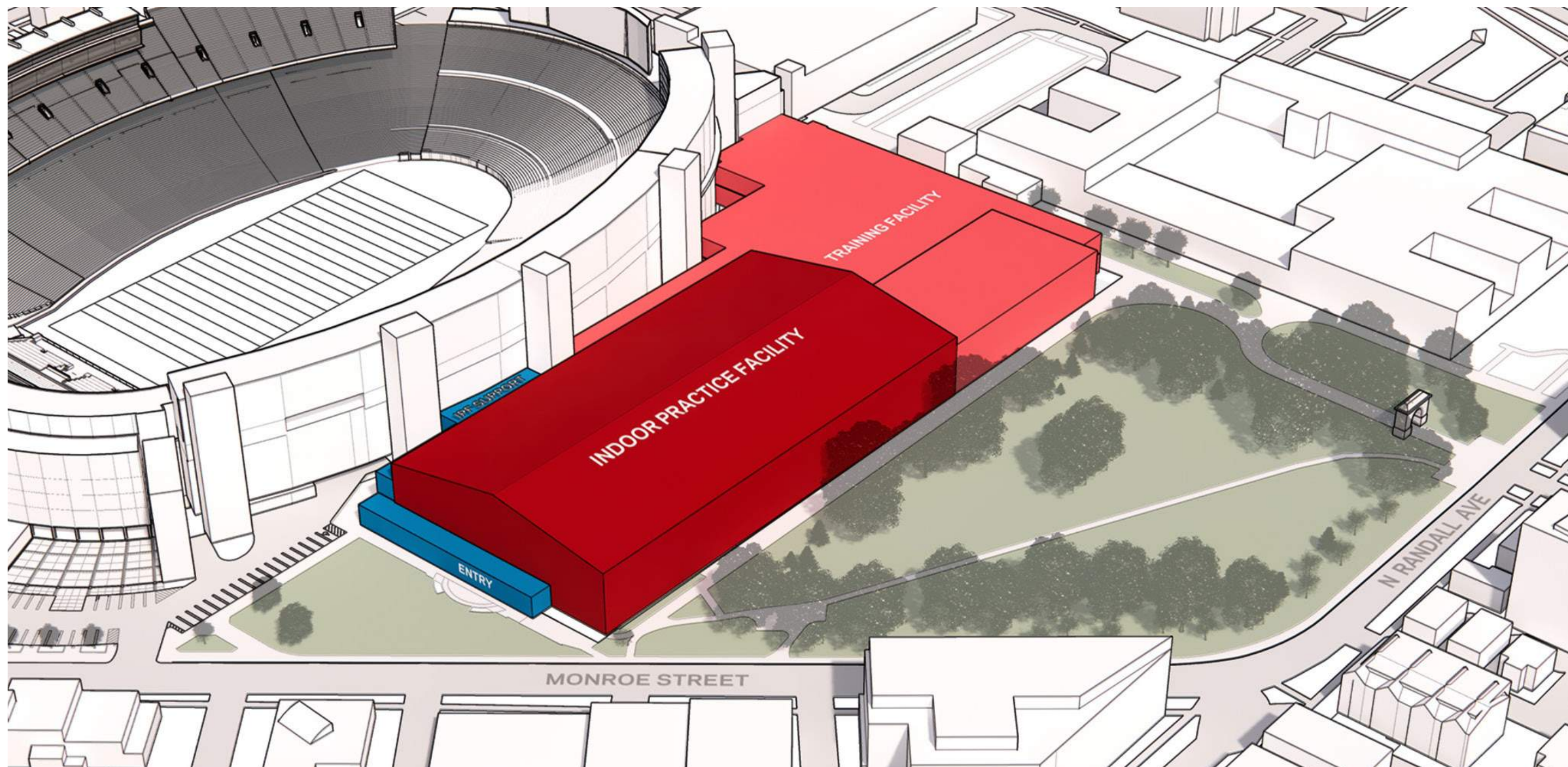

**PREFERRED CONCEPT MASSING**



**PREFERRED CONCEPT - BASEMENT LEVEL**



PREFERRED CONCEPT - 1ST LEVEL

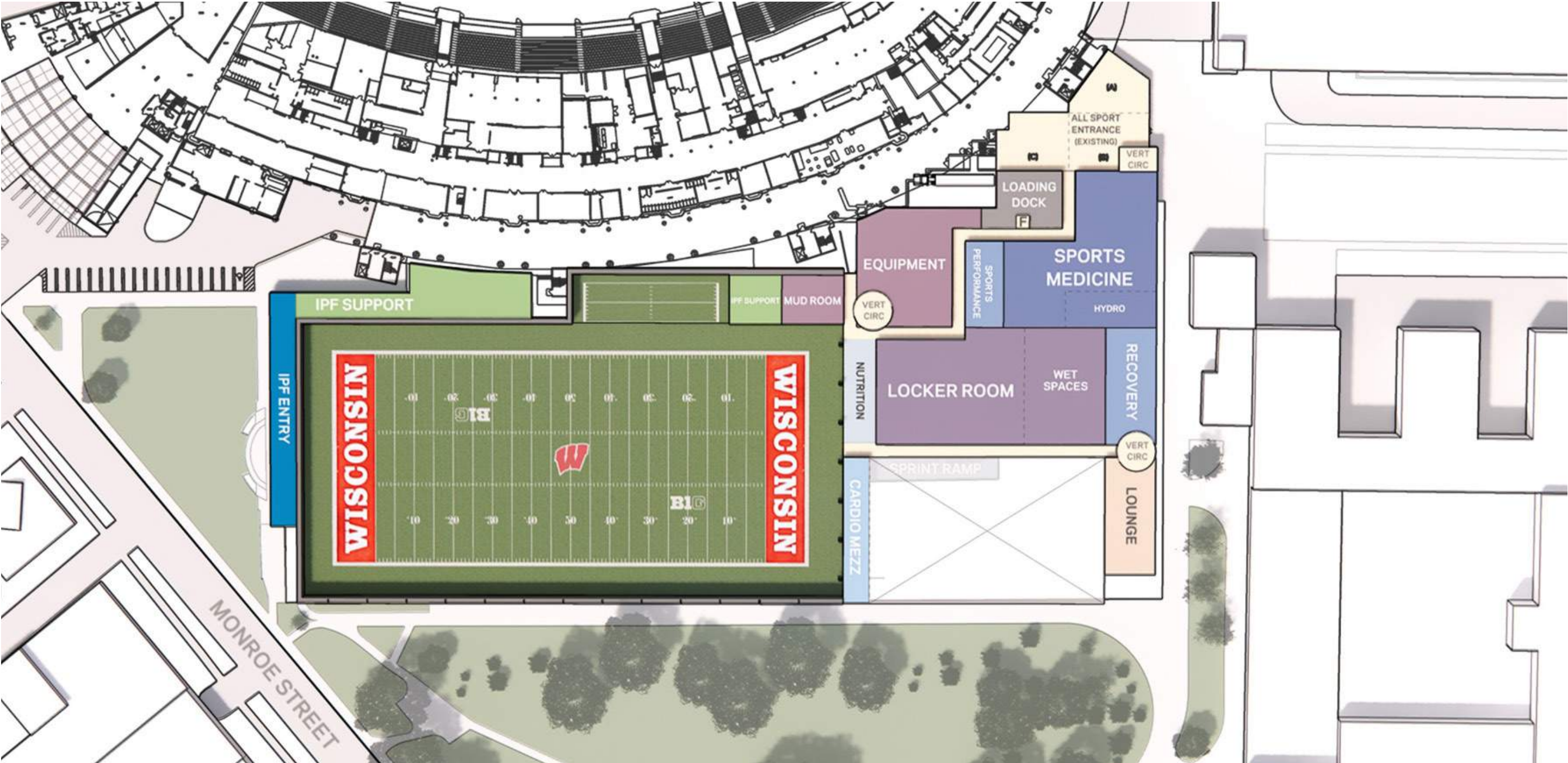

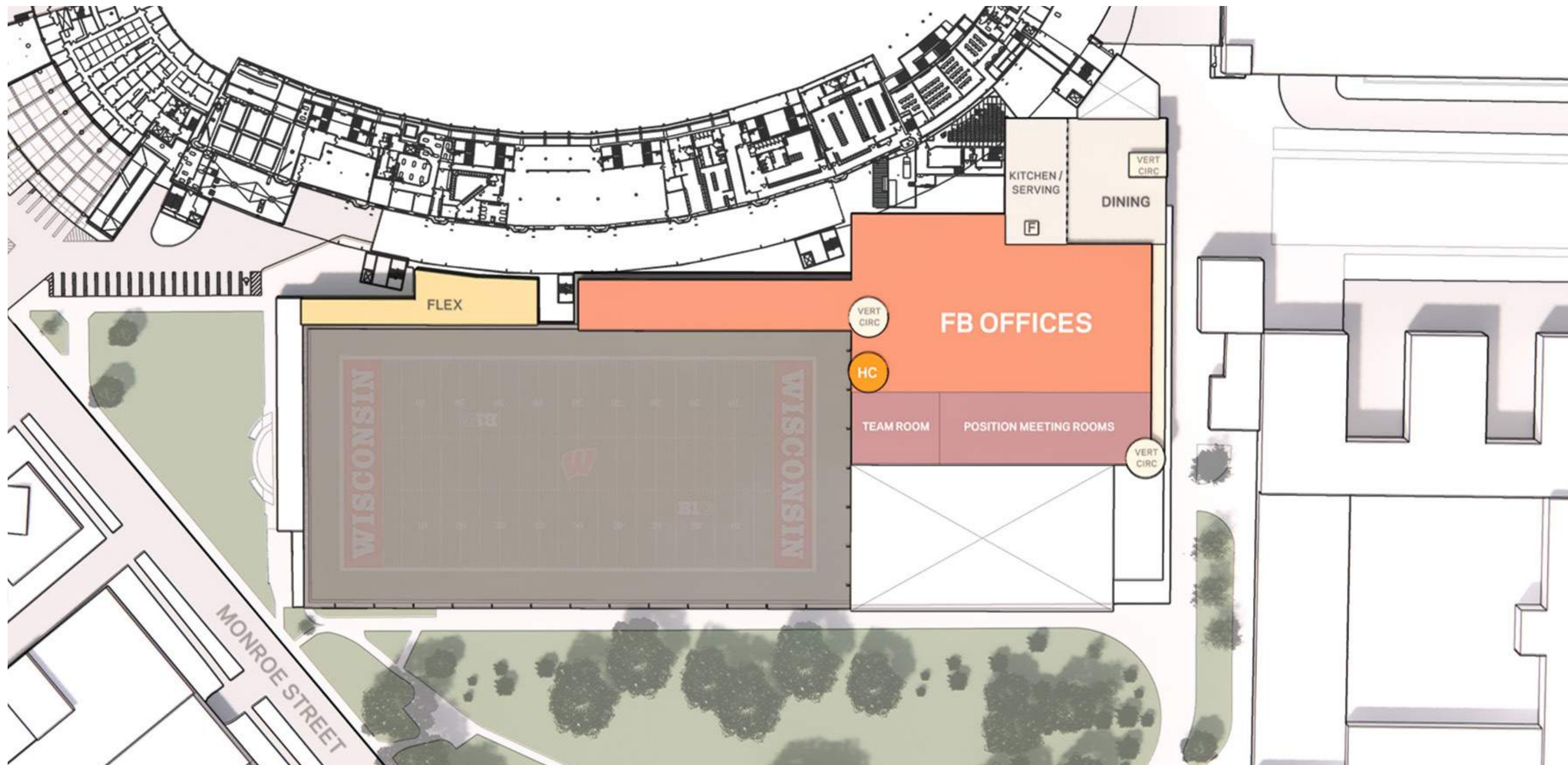

**PREFERRED CONCEPT - 2ND LEVEL**







## EXISTING CAMP RANDALL MEMORIAL PARK

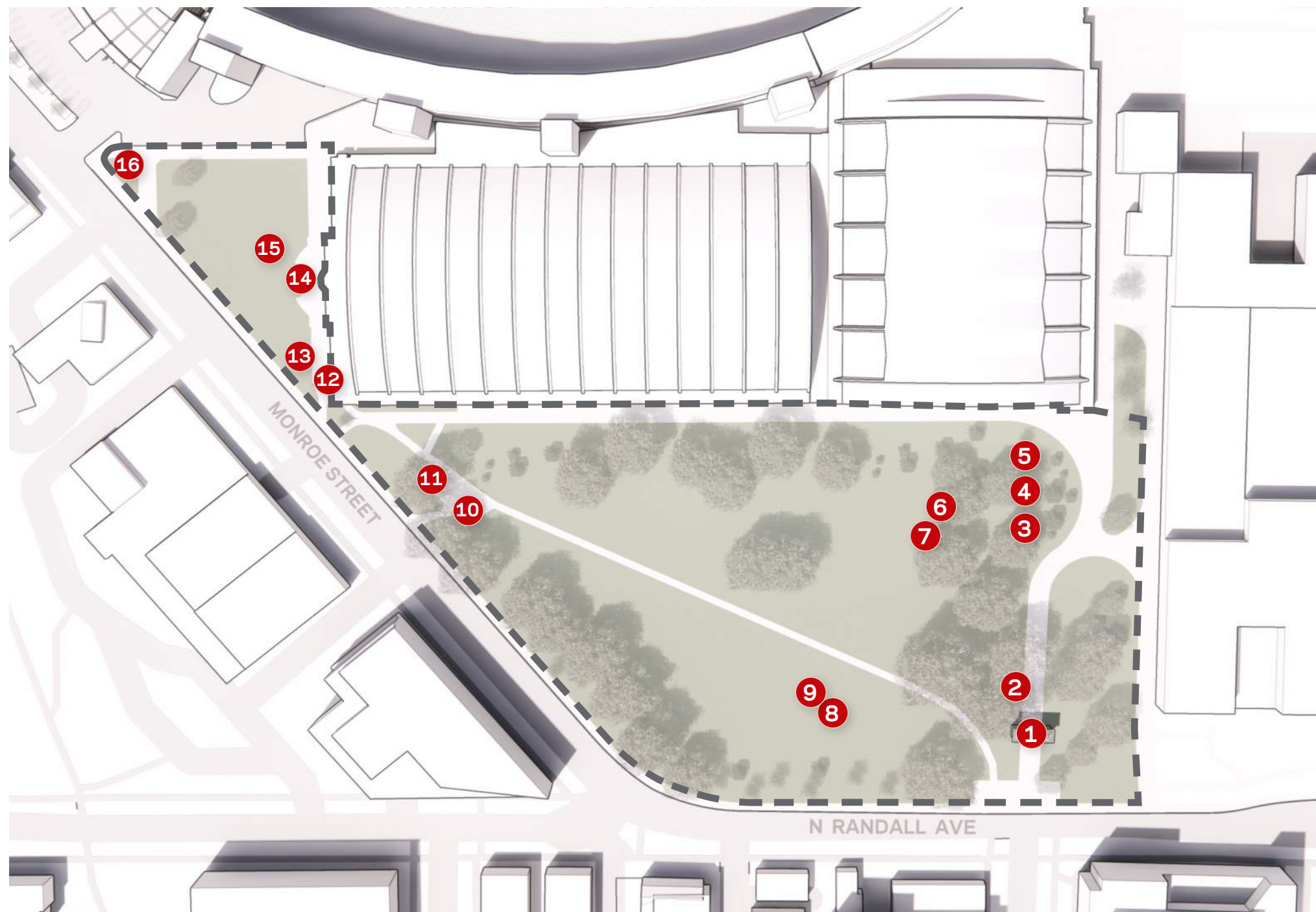

1. MEMORIAL ARCH
2. LINCOLN BICENTENNIAL SIGN
3. 14TH WISCONSIN VOLUNTEER INFANTRY PLAQUE
4. US NO. 332 CANNON
5. FLAG POLE
6. 23 WISCONSIN INFANTRY GRANITE MARKER
7. DAUGHTERS OF UNION VETERANS OF THE CIVIL WAR
8. MG GREENWOOD CANNON
9. WISCONSIN CIVIL WAR SESQUICENTENNIAL MEMORIAL
10. CAMP RANDALL HISTORICAL MARKER BY CIVIL WAR  
CENTENNIAL COMMISSION
11. GUARDHOUSE
12. CAMP RANDALL MEMORIAL PLAQUE
13. LOWE MEMORIAL STONE BENCH
14. ATHLETIC HALL OF FAME TERRACE PLAQUES AND  
PAVERS
15. MG & CO. CANNON
16. THE FIGHTING WISCONSIN BADGER