

LOT TYPE	UNITS	%
CC-T	147	20%
MF	134	18%
MF TOTAL	281	38%
TWINS	40	5%
GARDEN - 31	51	7%
COTTAGE - 37	99	13%
VILLAGE - 45	74	10%
MEADOW - 51	7	1%
TERRACE - 59	111	15%
MANOR - 65	49	7%
ESTATE - 69	29	4%
SF TOTAL	460	62%
TOTAL	741	100%

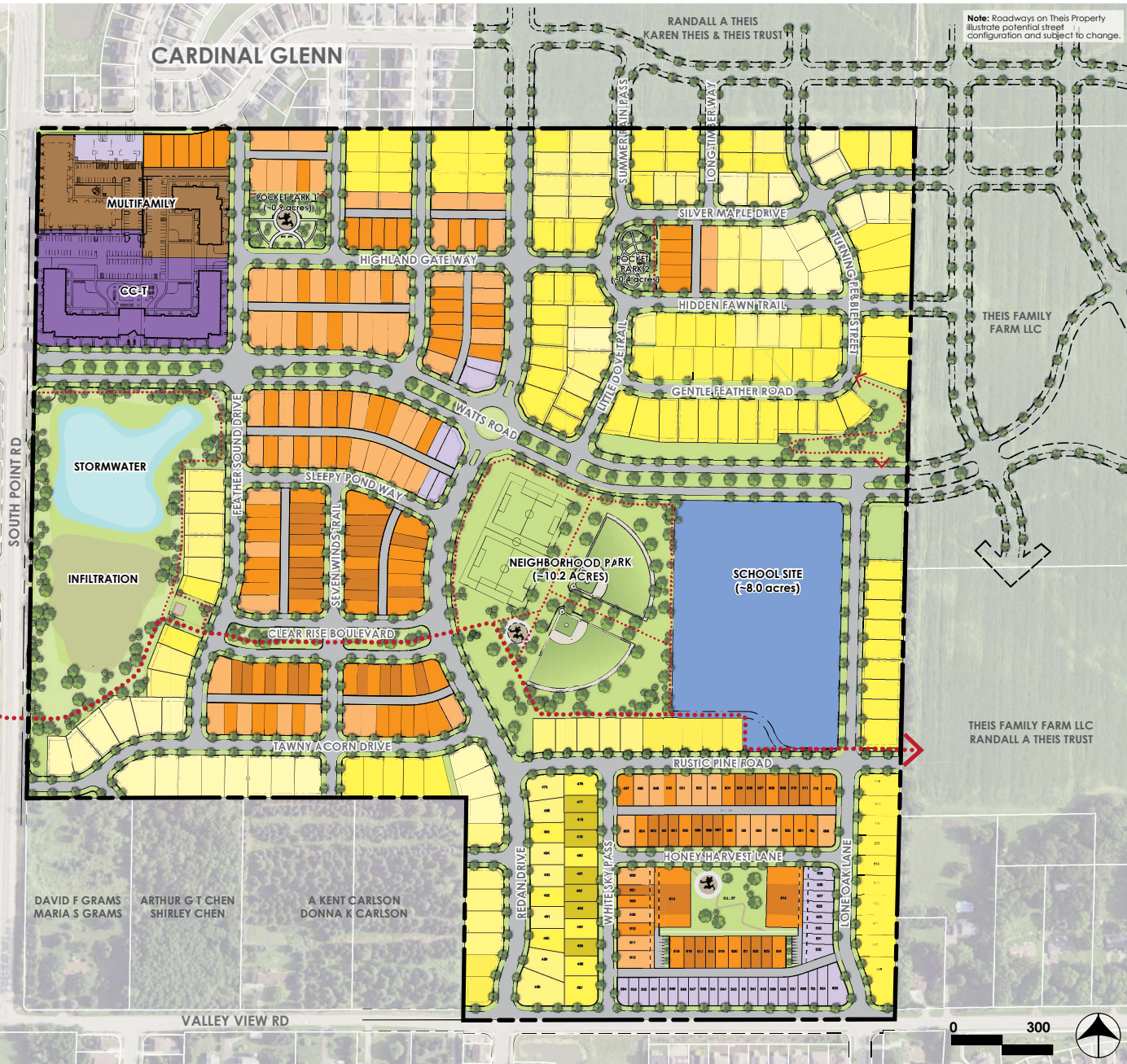

Note: Roadways on Theis Property illustrate potential street configuration and subject to change.



ACACIA RIDGE NEIGHBORHOOD

MADISON, WISCONSIN

REVISED : 3.1.23
SCALE : 1" = 300'

ADOPTED:
NEIGHBORHOOD
MASTER PLAN



LOT TYPE	UNITS	%
CC-T	147	19%
MF	134	17%
MF TOTAL	281	36%
HAVEN FRONT	20	3%
HAVEN ALLEY	24	3%
TUCK TWINS	34	4%
TWINS	40	5%
GARDEN - 31	52	7%
COTTAGE - 37	96	12%
VILLAGE - 45	75	10%
MEADOW - 51	13	2%
TERRACE - 59	79	10%
MANOR - 65	39	5%
ESTATE - 69	22	3%
SF TOTAL	494	64%
TOTAL	775	100%

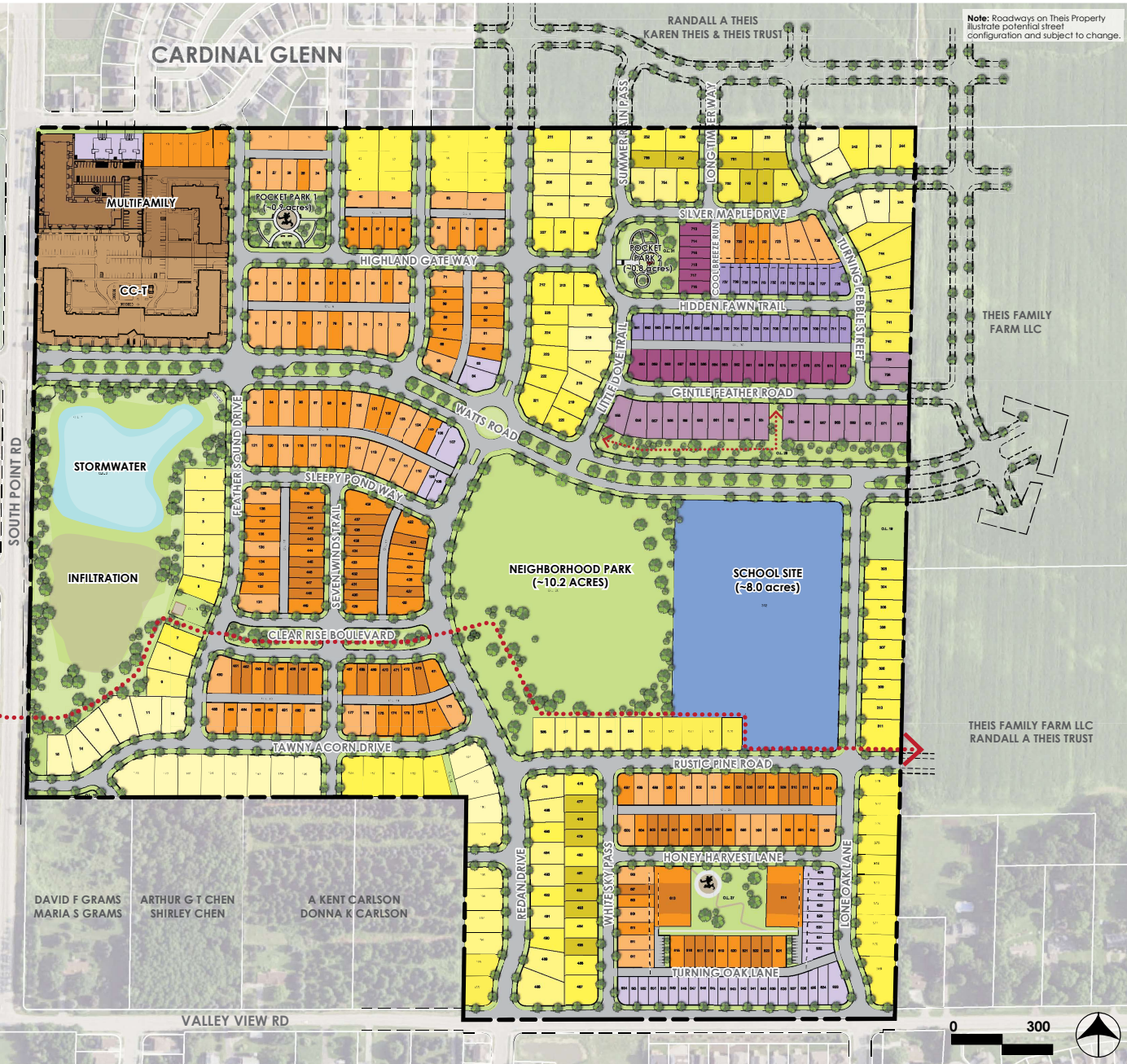

Note: Roadways on This Property illustrate potential street configuration and subject to change.



ACACIA RIDGE NEIGHBORHOOD

MADISON, WISCONSIN

REVISED : 2.28.23

SCALE : 1"= 300'

PROPOSED:
NEIGHBORHOOD
MASTER PLAN





ACACIA RIDGE NEIGHBORHOOD
MADISON, WISCONSIN

REVISED : 3.1.23

SCALE : 1" = 100'

**ADOPTED
REPLAT #5
MASTER PLAN**

LOT TYPE	APPROVED PLAT	PROPOSED PLAT
HAVEN FRONT	0	20
HAVEN ALLEY	0	24
TUCK TWINS	0	34
TWINS	0	0
GARDEN - 31	0	1
COTTAGE - 37	5	2
VILLAGE - 45	2	4
MEADOW - 51	0	7
TERRACE - 59	41	11
MANOR - 65	14	4
ESTATE - 69	7	0
TOTAL	69	106

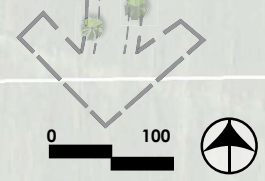
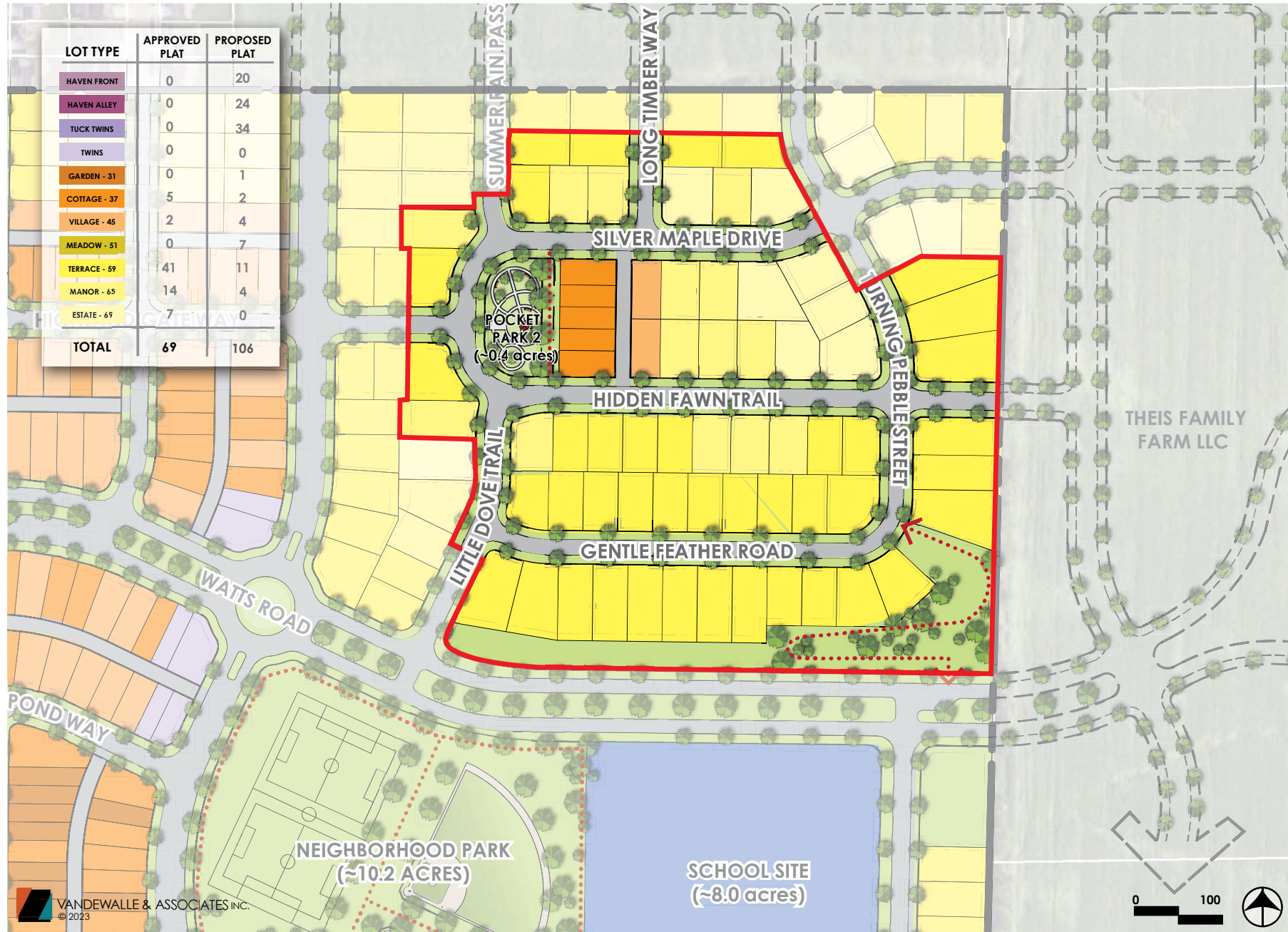



ACACIA RIDGE NEIGHBORHOOD
MADISON, WISCONSIN

REVISED : 2.28.23

SCALE : 1"= 150'

**PROPOSED
REPLAT #5
MASTER PLAN**

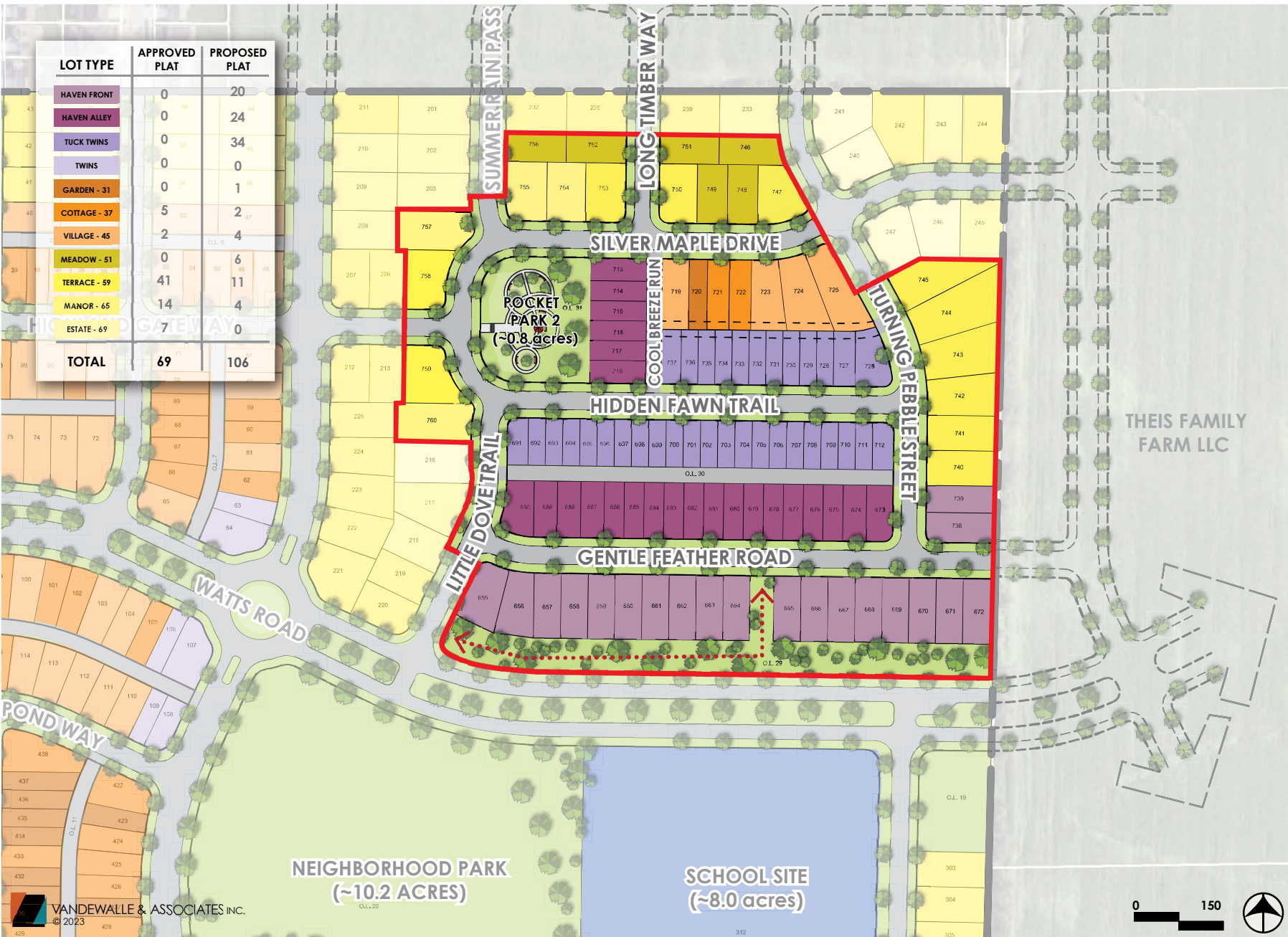

LOT TYPE	APPROVED PLAT	PROPOSED PLAT
HAVEN FRONT	0	20
HAVEN ALLEY	0	24
TUCK TWINS	0	34
TWINS	0	0
GARDEN - 31	0	1
COTTAGE - 37	5	2
VILLAGE - 45	2	4
MEADOW - 51	0	6
TERRACE - 59	41	11
MANOR - 65	14	4
ESTATE - 69	7	0
TOTAL	69	106

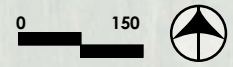

LOT TYPE	UNITS	%
CC-T	147	20%
ME	134	18%
MF TOTAL	281	38%
TWINS	40	5%
GARDEN - 31	51	7%
COTTAGE - 37	99	13%
VILLAGE - 45	74	10%
MEADOW - 51	7	1%
TERRACE - 59	111	15%
MANOR - 65	49	7%
ESTATE - 69	29	4%
SF TOTAL	460	62%
TOTAL	741	100%

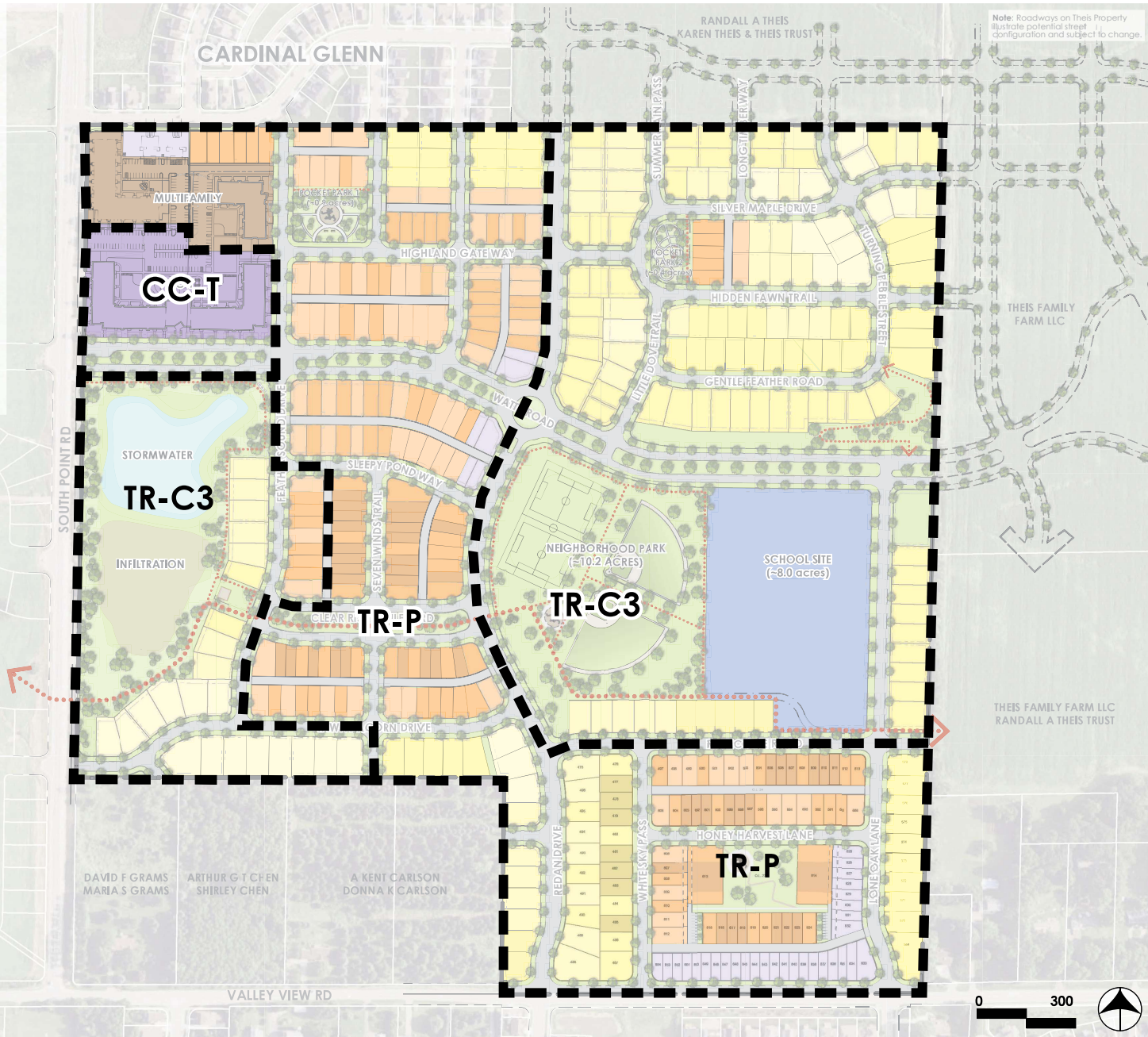

Note: Roadways on This Property illustrate potential street configuration and subject to change.



ACACIA RIDGE NEIGHBORHOOD

MADISON, WISCONSIN

REVISED : 3.1.23
SCALE : 1" = 300'

ADOPTED:
ZONING PLAN



LOT TYPE	UNITS	%
CC-T	147	19%
MF	134	17%
MF TOTAL	281	36%
HAVEN FRONT	20	3%
HAVEN ALLEY	24	3%
TUCK TWINS	34	4%
TWINS	40	5%
GARDEN - 31	52	7%
COTTAGE - 37	96	12%
VILLAGE - 45	75	10%
MEADOW - 51	13	2%
TERRACE - 59	79	10%
MANOR - 65	39	5%
ESTATE - 69	22	3%
SF TOTAL	494	64%
TOTAL	775	100%

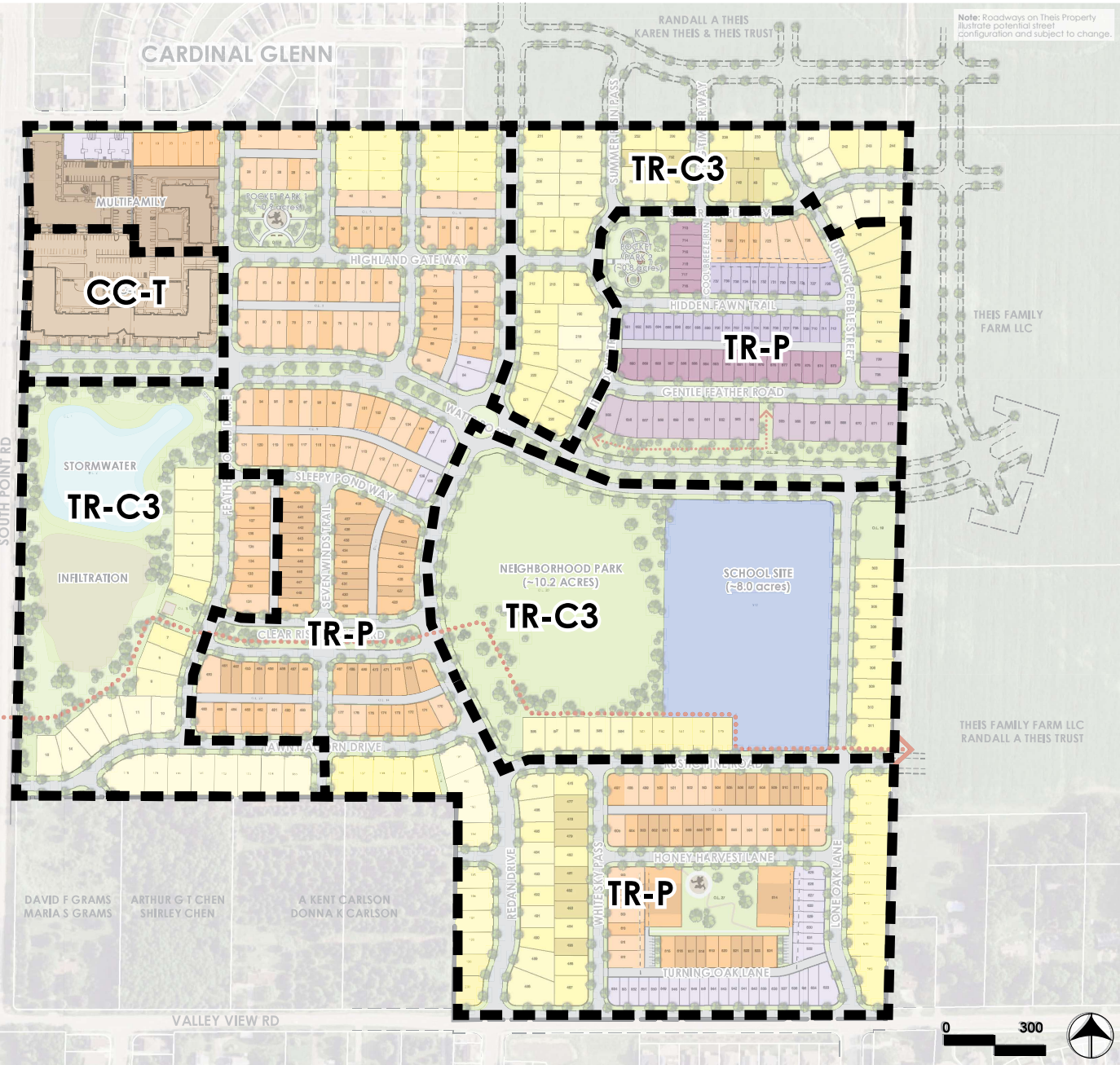

Note: Roadways on This Property illustrate potential street configuration and subject to change.



ACACIA RIDGE NEIGHBORHOOD

MADISON, WISCONSIN

REVISED : 2.28.23

SCALE : 1" = 300'

PROPOSED:
ZONING PLAN

