

# VAQUERO

*Mexican grill*

## Appetizer Antojitos

Esquites \$7 🔥



Taquitos \$12

Chips & Salsa 🔥



\$9

Chips & Guacamole 🔥 \$8

Chips & Queso



\$13

Loaded Fries

\$7

Nachos

🔥 \$18



## Sides

Sour Cream \$5

Shredded Cheese \$5

Beans \$5

Rice 🔥 \$5

Fries 🔥 \$5

Guacamole 🔥

## BURRITOS, TACOS & SALADS

BURRITO \$11

TACOS \$3

SALAD \$10

BOWL \$10

### 🔥 Protein Choices

Steak

Chicken

Ground Beef

Carnitas

Pastor

Barbacua

Birria

Grilled chicken

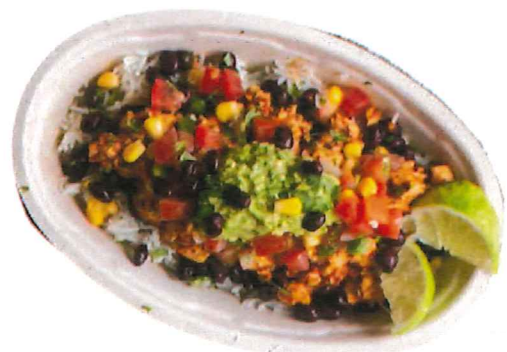



FLOORING LEGEND	
01	Carpet
02	Hardwood
03	Polished Concrete
04	Grout
05	Tile
06	Stair Carpet
07	Stair Tile
08	Stair Carpet
09	Stair Tile
10	Stair Carpet
11	Stair Tile
12	Stair Carpet
13	Stair Tile
14	Stair Carpet
15	Stair Tile
16	Stair Carpet
17	Stair Tile
18	Stair Carpet
19	Stair Tile
20	Stair Carpet
21	Stair Tile
22	Stair Carpet
23	Stair Tile
24	Stair Carpet
25	Stair Tile
26	Stair Carpet
27	Stair Tile
28	Stair Carpet
29	Stair Tile
30	Stair Carpet
31	Stair Tile
32	Stair Carpet
33	Stair Tile
34	Stair Carpet
35	Stair Tile
36	Stair Carpet
37	Stair Tile
38	Stair Carpet
39	Stair Tile
40	Stair Carpet
41	Stair Tile
42	Stair Carpet
43	Stair Tile
44	Stair Carpet
45	Stair Tile
46	Stair Carpet
47	Stair Tile
48	Stair Carpet
49	Stair Tile
50	Stair Carpet
51	Stair Tile
52	Stair Carpet
53	Stair Tile
54	Stair Carpet
55	Stair Tile
56	Stair Carpet
57	Stair Tile
58	Stair Carpet
59	Stair Tile
60	Stair Carpet
61	Stair Tile
62	Stair Carpet
63	Stair Tile
64	Stair Carpet
65	Stair Tile
66	Stair Carpet
67	Stair Tile
68	Stair Carpet
69	Stair Tile
70	Stair Carpet
71	Stair Tile
72	Stair Carpet
73	Stair Tile
74	Stair Carpet
75	Stair Tile
76	Stair Carpet
77	Stair Tile
78	Stair Carpet
79	Stair Tile
80	Stair Carpet
81	Stair Tile
82	Stair Carpet
83	Stair Tile
84	Stair Carpet
85	Stair Tile
86	Stair Carpet
87	Stair Tile
88	Stair Carpet
89	Stair Tile
90	Stair Carpet
91	Stair Tile
92	Stair Carpet
93	Stair Tile
94	Stair Carpet
95	Stair Tile
96	Stair Carpet
97	Stair Tile
98	Stair Carpet
99	Stair Tile
100	Stair Carpet

## 02 Carpet Pattern

SCALE: 1/8" = 1'-0"

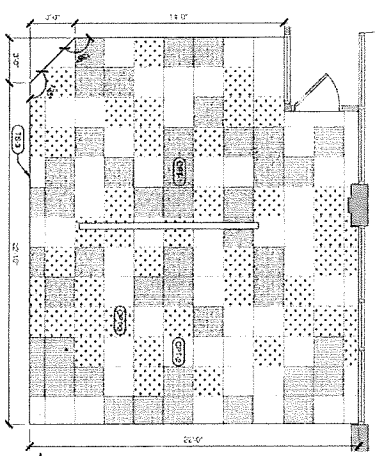

## 01 Floor & Equip. Plan

SCALE: 1/8" = 1'-0"

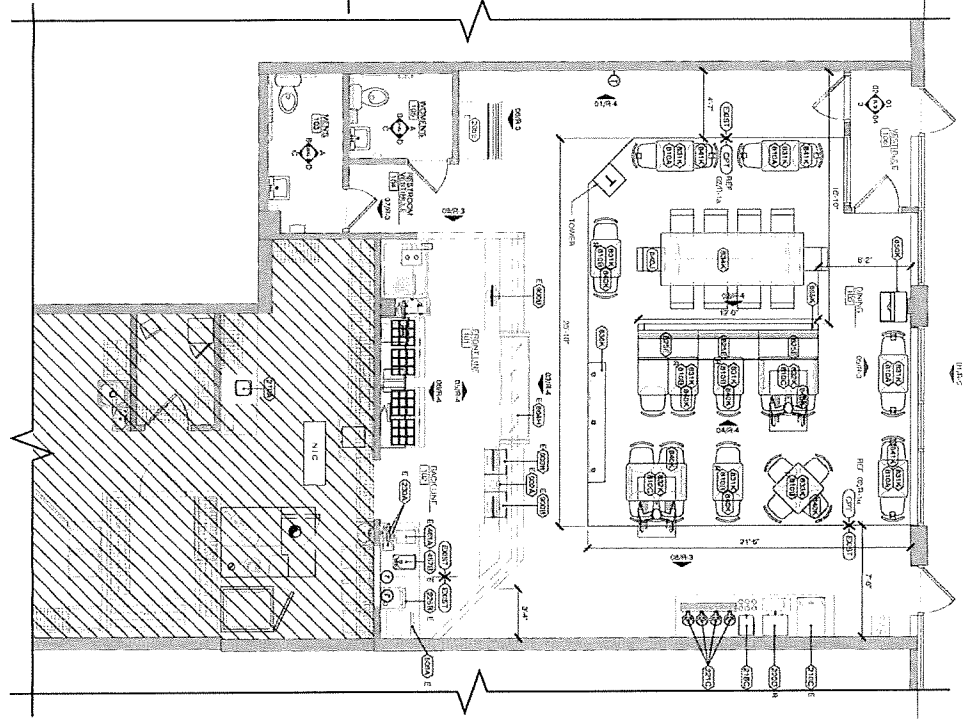

### CONSTRUCTION SCOPE OF WORK

1. DEMOLITION WORK
2. EXISTING CARPET TO BE REMOVED AND DISPOSED
3. EXISTING TILE TO BE REMOVED AND DISPOSED
4. EXISTING PAINT TO BE REMOVED AND DISPOSED
5. EXISTING PLASTER TO BE REMOVED AND DISPOSED
6. EXISTING GYPSUM BOARD TO BE REMOVED AND DISPOSED
7. EXISTING CEILING TO BE REMOVED AND DISPOSED
8. EXISTING LIGHT FIXTURES TO BE REMOVED AND DISPOSED
9. EXISTING ELECTRICAL PANELS TO BE REMOVED AND DISPOSED
10. EXISTING MECHANICAL EQUIPMENT TO BE REMOVED AND DISPOSED
11. EXISTING STRUCTURAL MEMBERS TO BE REPAIRED OR REPLACED AS NECESSARY
12. EXISTING PARTITIONS TO BE REPAIRED OR REPLACED AS NECESSARY
13. EXISTING DOORS AND WINDOWS TO BE REPAIRED OR REPLACED AS NECESSARY
14. EXISTING ROOFING TO BE REPAIRED OR REPLACED AS NECESSARY
15. EXISTING EXTERIOR FINISHES TO BE REPAIRED OR REPLACED AS NECESSARY
16. EXISTING LANDSCAPING TO BE REPAIRED OR REPLACED AS NECESSARY
17. EXISTING SIGNAGE TO BE REPAIRED OR REPLACED AS NECESSARY
18. EXISTING FURNITURE AND FIXTURES TO BE REPAIRED OR REPLACED AS NECESSARY
19. EXISTING EQUIPMENT TO BE REPAIRED OR REPLACED AS NECESSARY
20. EXISTING UTILITIES TO BE REPAIRED OR REPLACED AS NECESSARY
21. EXISTING VENTILATION SYSTEMS TO BE REPAIRED OR REPLACED AS NECESSARY
22. EXISTING SOUNDING SYSTEMS TO BE REPAIRED OR REPLACED AS NECESSARY
23. EXISTING SECURITY SYSTEMS TO BE REPAIRED OR REPLACED AS NECESSARY
24. EXISTING ACCESSIBILITY FEATURES TO BE REPAIRED OR REPLACED AS NECESSARY
25. EXISTING ENERGY EFFICIENCY MEASURES TO BE REPAIRED OR REPLACED AS NECESSARY
26. EXISTING SUSTAINABILITY FEATURES TO BE REPAIRED OR REPLACED AS NECESSARY
27. EXISTING HISTORIC FEATURES TO BE REPAIRED OR REPLACED AS NECESSARY
28. EXISTING MONUMENTAL FEATURES TO BE REPAIRED OR REPLACED AS NECESSARY
29. EXISTING ARTWORK TO BE REPAIRED OR REPLACED AS NECESSARY
30. EXISTING SPECIAL FEATURES TO BE REPAIRED OR REPLACED AS NECESSARY
31. EXISTING FINISHES TO BE REPAIRED OR REPLACED AS NECESSARY
32. EXISTING MATERIALS TO BE REPAIRED OR REPLACED AS NECESSARY
33. EXISTING LABOR TO BE REPAIRED OR REPLACED AS NECESSARY
34. EXISTING EQUIPMENT TO BE REPAIRED OR REPLACED AS NECESSARY
35. EXISTING UTILITIES TO BE REPAIRED OR REPLACED AS NECESSARY
36. EXISTING VENTILATION SYSTEMS TO BE REPAIRED OR REPLACED AS NECESSARY
37. EXISTING SOUNDING SYSTEMS TO BE REPAIRED OR REPLACED AS NECESSARY
38. EXISTING SECURITY SYSTEMS TO BE REPAIRED OR REPLACED AS NECESSARY
39. EXISTING ACCESSIBILITY FEATURES TO BE REPAIRED OR REPLACED AS NECESSARY
40. EXISTING ENERGY EFFICIENCY MEASURES TO BE REPAIRED OR REPLACED AS NECESSARY
41. EXISTING SUSTAINABILITY FEATURES TO BE REPAIRED OR REPLACED AS NECESSARY
42. EXISTING HISTORIC FEATURES TO BE REPAIRED OR REPLACED AS NECESSARY
43. EXISTING MONUMENTAL FEATURES TO BE REPAIRED OR REPLACED AS NECESSARY
44. EXISTING ARTWORK TO BE REPAIRED OR REPLACED AS NECESSARY
45. EXISTING SPECIAL FEATURES TO BE REPAIRED OR REPLACED AS NECESSARY
46. EXISTING FINISHES TO BE REPAIRED OR REPLACED AS NECESSARY
47. EXISTING MATERIALS TO BE REPAIRED OR REPLACED AS NECESSARY
48. EXISTING LABOR TO BE REPAIRED OR REPLACED AS NECESSARY
49. EXISTING EQUIPMENT TO BE REPAIRED OR REPLACED AS NECESSARY
50. EXISTING UTILITIES TO BE REPAIRED OR REPLACED AS NECESSARY
51. EXISTING VENTILATION SYSTEMS TO BE REPAIRED OR REPLACED AS NECESSARY
52. EXISTING SOUNDING SYSTEMS TO BE REPAIRED OR REPLACED AS NECESSARY
53. EXISTING SECURITY SYSTEMS TO BE REPAIRED OR REPLACED AS NECESSARY
54. EXISTING ACCESSIBILITY FEATURES TO BE REPAIRED OR REPLACED AS NECESSARY
55. EXISTING ENERGY EFFICIENCY MEASURES TO BE REPAIRED OR REPLACED AS NECESSARY
56. EXISTING SUSTAINABILITY FEATURES TO BE REPAIRED OR REPLACED AS NECESSARY
57. EXISTING HISTORIC FEATURES TO BE REPAIRED OR REPLACED AS NECESSARY
58. EXISTING MONUMENTAL FEATURES TO BE REPAIRED OR REPLACED AS NECESSARY
59. EXISTING ARTWORK TO BE REPAIRED OR REPLACED AS NECESSARY
60. EXISTING SPECIAL FEATURES TO BE REPAIRED OR REPLACED AS NECESSARY
61. EXISTING FINISHES TO BE REPAIRED OR REPLACED AS NECESSARY
62. EXISTING MATERIALS TO BE REPAIRED OR REPLACED AS NECESSARY
63. EXISTING LABOR TO BE REPAIRED OR REPLACED AS NECESSARY
64. EXISTING EQUIPMENT TO BE REPAIRED OR REPLACED AS NECESSARY
65. EXISTING UTILITIES TO BE REPAIRED OR REPLACED AS NECESSARY
66. EXISTING VENTILATION SYSTEMS TO BE REPAIRED OR REPLACED AS NECESSARY
67. EXISTING SOUNDING SYSTEMS TO BE REPAIRED OR REPLACED AS NECESSARY
68. EXISTING SECURITY SYSTEMS TO BE REPAIRED OR REPLACED AS NECESSARY
69. EXISTING ACCESSIBILITY FEATURES TO BE REPAIRED OR REPLACED AS NECESSARY
70. EXISTING ENERGY EFFICIENCY MEASURES TO BE REPAIRED OR REPLACED AS NECESSARY
71. EXISTING SUSTAINABILITY FEATURES TO BE REPAIRED OR REPLACED AS NECESSARY
72. EXISTING HISTORIC FEATURES TO BE REPAIRED OR REPLACED AS NECESSARY
73. EXISTING MONUMENTAL FEATURES TO BE REPAIRED OR REPLACED AS NECESSARY
74. EXISTING ARTWORK TO BE REPAIRED OR REPLACED AS NECESSARY
75. EXISTING SPECIAL FEATURES TO BE REPAIRED OR REPLACED AS NECESSARY
76. EXISTING FINISHES TO BE REPAIRED OR REPLACED AS NECESSARY
77. EXISTING MATERIALS TO BE REPAIRED OR REPLACED AS NECESSARY
78. EXISTING LABOR TO BE REPAIRED OR REPLACED AS NECESSARY
79. EXISTING EQUIPMENT TO BE REPAIRED OR REPLACED AS NECESSARY
80. EXISTING UTILITIES TO BE REPAIRED OR REPLACED AS NECESSARY
81. EXISTING VENTILATION SYSTEMS TO BE REPAIRED OR REPLACED AS NECESSARY
82. EXISTING SOUNDING SYSTEMS TO BE REPAIRED OR REPLACED AS NECESSARY
83. EXISTING SECURITY SYSTEMS TO BE REPAIRED OR REPLACED AS NECESSARY
84. EXISTING ACCESSIBILITY FEATURES TO BE REPAIRED OR REPLACED AS NECESSARY
85. EXISTING ENERGY EFFICIENCY MEASURES TO BE REPAIRED OR REPLACED AS NECESSARY
86. EXISTING SUSTAINABILITY FEATURES TO BE REPAIRED OR REPLACED AS NECESSARY
87. EXISTING HISTORIC FEATURES TO BE REPAIRED OR REPLACED AS NECESSARY
88. EXISTING MONUMENTAL FEATURES TO BE REPAIRED OR REPLACED AS NECESSARY
89. EXISTING ARTWORK TO BE REPAIRED OR REPLACED AS NECESSARY
90. EXISTING SPECIAL FEATURES TO BE REPAIRED OR REPLACED AS NECESSARY
91. EXISTING FINISHES TO BE REPAIRED OR REPLACED AS NECESSARY
92. EXISTING MATERIALS TO BE REPAIRED OR REPLACED AS NECESSARY
93. EXISTING LABOR TO BE REPAIRED OR REPLACED AS NECESSARY
94. EXISTING EQUIPMENT TO BE REPAIRED OR REPLACED AS NECESSARY
95. EXISTING UTILITIES TO BE REPAIRED OR REPLACED AS NECESSARY
96. EXISTING VENTILATION SYSTEMS TO BE REPAIRED OR REPLACED AS NECESSARY
97. EXISTING SOUNDING SYSTEMS TO BE REPAIRED OR REPLACED AS NECESSARY
98. EXISTING SECURITY SYSTEMS TO BE REPAIRED OR REPLACED AS NECESSARY
99. EXISTING ACCESSIBILITY FEATURES TO BE REPAIRED OR REPLACED AS NECESSARY
100. EXISTING ENERGY EFFICIENCY MEASURES TO BE REPAIRED OR REPLACED AS NECESSARY



**EINSTEIN BROS. BAGELS**  
 3904 E. WASHINGTON AVE.  
 MADISON, WI 53704  
 STORE #2902

**idcgroup**  
 201 N. RING BLVD.  
 MADISON, WI 53703  
 TEL: 264.639.8800 FAX: 264.639.8700  
 www.idcgroup.com  
 IDC GROUP  
 201 N. RING BLVD.  
 MADISON, WI 53703  
 TEL: 264.639.8800 FAX: 264.639.8700  
 www.idcgroup.com

**R-1a**  
 FLOOR & EQUIP.  
 PLAN  
 © 2017 ID Group







