



Change of Premises

Fee: \$25.00

City of Madison Clerk
210 MLK Jr Blvd, Room 103
Madison, WI 53703
licensing@cityofmadison.com
608-266-4601

- Class A: Beer, Liquor, Cider
 Class B: Beer, Liquor,
 Class C Wine

(Agenda Item Number)

(Legistar file number)

LICPCIT

(License number)

(Alder District #)

(Police Sector)

Office Use Only

Licensed Premises Information

This application modifies existing alcohol license number: LICLIB-2022-00737

Business dba Name: ~~Sun~~ Sunny Pho

Licensed Address: 602 S. Park St, Madison WI 53715

Liquor/Beer Agent Name: Khouch Kim

35 % Alcohol, 65 % Food, ___ % Other Alder, District #: _____ Police Sector: _____

Corporate Information

Business Legal Name (as on WI State Sellers Permit): 456-1030320226-02

Business Mailing Address: 602 S. Park St, Madison WI 53715

Business Contact Name, Position: Khouch Kim

Business Phone: 608-513-1786

Business Email: sunnyphon@yahoo.com

Current Capacity (indoor): 57

Current Capacity (outdoor): 0

Proposed Capacity (indoor): 95

Proposed Capacity (outdoor): 0

If your capacity is increasing, contact Building Inspection: (608) 266-4551, binspection@cityofmadison.com

Change is: Permanent Temporary (from _____ until _____)
Date Date

Is this change related to a Roadway Café Expansion License/Roadway Permit: Yes or No

Description of Changes (include approximate measurements, and fencing, if necessary):

create open dining from private party rooms.
Expanding room to total of 95 capacity.

Detailed Floor Plans included (required)

Khouch Kim
Authorized Signature

12/05/2022
Date

- Orange sign and business card issued
 - "License Renewals & Changes" brochure with next steps issued
- Office Use Only

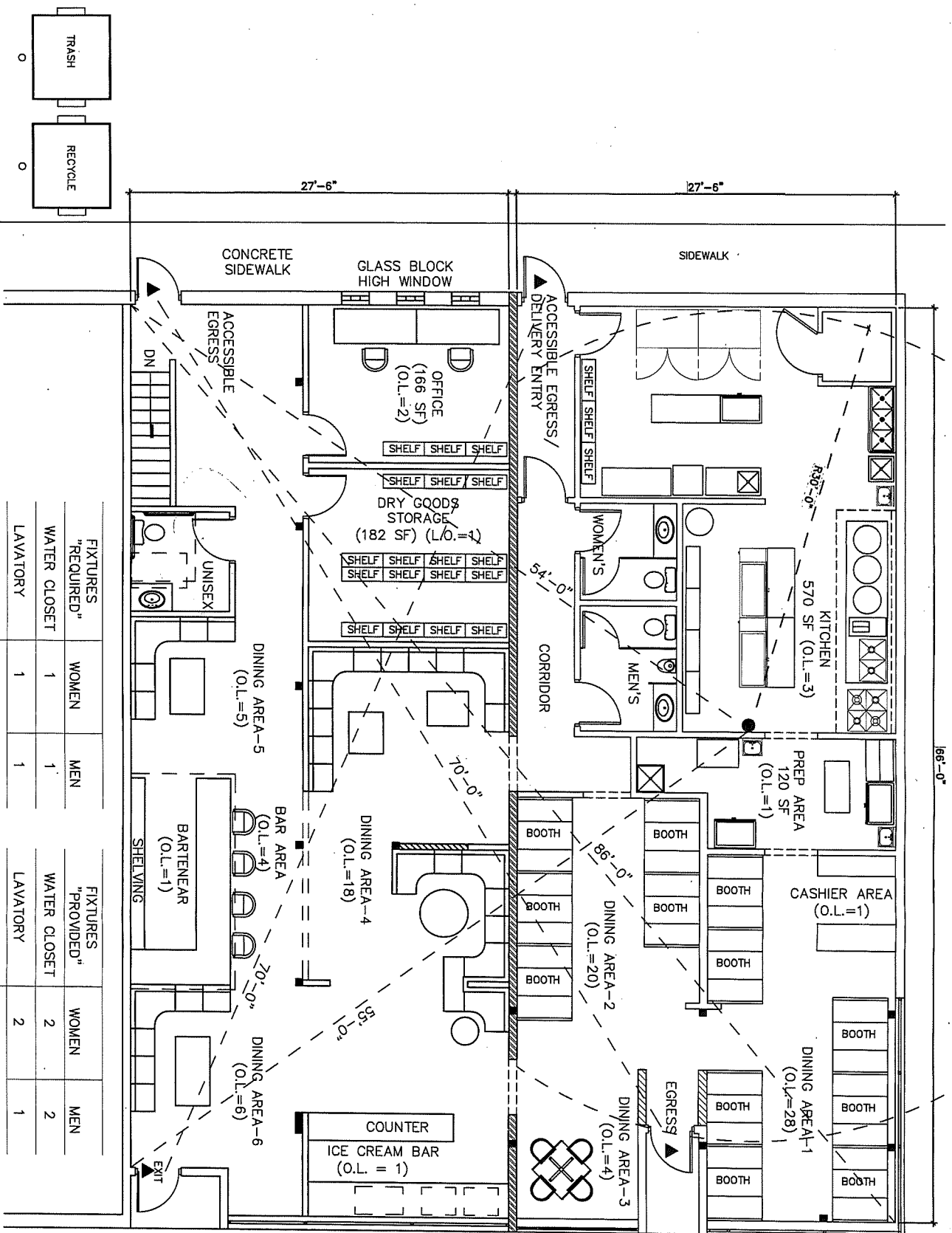

FIXTURES "REQUIRED"	WOMEN	MEN	FIXTURES "PROVIDED"	WOMEN	MEN
WATER CLOSET	1	1	WATER CLOSET	2	2
LAVATORY	1	1	LAVATORY	2	1
SERVICE SINK	1		SERVICE SINK		1
DRINKING FOUNTAIN	1		DRINKING FOUNTAIN		0*

*WATER WILL BE SERVED IN RESTAURANT

- ▨ HALF WALL
- ▨ FIRE-RATED PARTITION
- STRUCTURAL COLUMN
- PORTABLE FIRE EXTINGUISHER (MOUNTED @ 4'-3"-6" AFF MAX)
- ▲ EXIT SIGN (TO BE LIGHTED)

NO. OF EGRESS PROVIDED:
 ACCESSIBLE MEANS OF EGRESS PROVIDED: 2 @ REAR EXIT
 MAX. EXIT ACCESS TRAVEL DISTANCE: 150'-0"
 EXIT ACCESS TRAVEL DISTANCE: 150'-0"

AUTOMATIC SPRINKLER SYSTEM
 OCCUPANCY TYPE: A2 (RESTAURANT)
 CONSTRUCTION TYPE: III
 TOTAL FIRE AREA: 3,577 SF
 TOTAL OCCUPANT LOAD: 38

TOTAL OCCUPANT LOAD:
 OCCUPANT LOAD=57 @ 602 S PARK STREET
 OCCUPANT LOAD=38 @ 604 S PARK STREET

NOTE:
 OCCUPANT LOADS (O.L.) IN DINING AREAS ARE CALCULATED BASED ON FIXED SEATS OR TABLE/ARRANGEMENT @ DINING AREA-3

SOUTH PARK STREET