

# REINDAHL PARK MASTER PLANNING UPDATE EFFORT



Board of Park  
Commissioners  
01/11/2023



# VISION



# GOALS

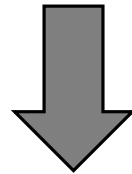

# MANAGEMENT OBJECTIVES

A description of the desired end-state or ideal long-term accomplishment that a project would like to see occur.

*(This is the big idea)*

Formal statements of the impacts you hope to achieve.

*(This is specifically what we're going to do)*

Activities or actions that help achieve specific goals.

*(This is how we're going to do it)*

# REINDAHL PARK VISION

*"Reindahl Park will be a resilient park for active recreation, cultural enrichment and opportunities to enjoy the natural environment"*



# REINDAHL PARK GOALS



Protect and enhance the natural and cultural resources of Reindahl Park

Foster intentional and diverse outdoor recreation opportunities at Reindahl Park

Develop community partnerships and promote equitable access





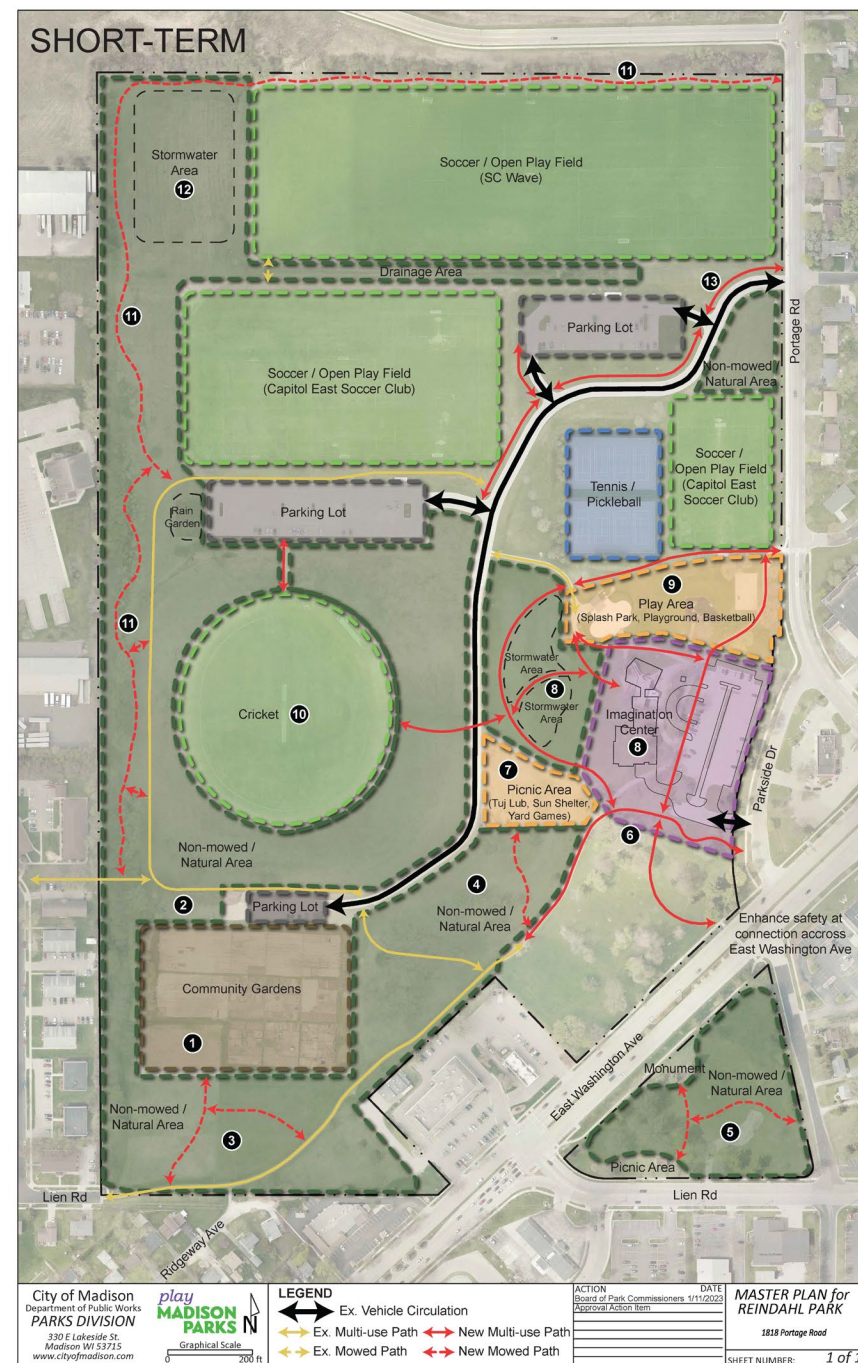

## A 0-10 year view



# DRAFT MASTER PLAN (SOUTH)

- 1 Expand community gardens and add raised accessible plots.
- 2 Remove portion of existing gravel parking lot and naturalize area with native grasses and wildflowers.
- 3 Naturalize existing mowed area with native grasses and forbs.
- 4 Establish native understory in existing woodlands. Naturalize non-wooded area with native grasses and forbs.
- 5 Naturalize triangle parcel with native grasses, forbs and trees. Include mowed paths as tree walk element within naturalized area and around existing monument. Maintain mowed area along Lien Rd for picnicking.
- 6 Construct access to second story of Barn Building and minor improvements to aesthetics of building.
- 7 Construct Picnic Area. Potential amenities include sun shelter, tuj lub, and yard games.

## LEGEND

-  Ex. Vehicle Circulation  
 Ex. Multi-use Path     New Multi-use Path  
 Ex. Mowed Path     New Mowed Path

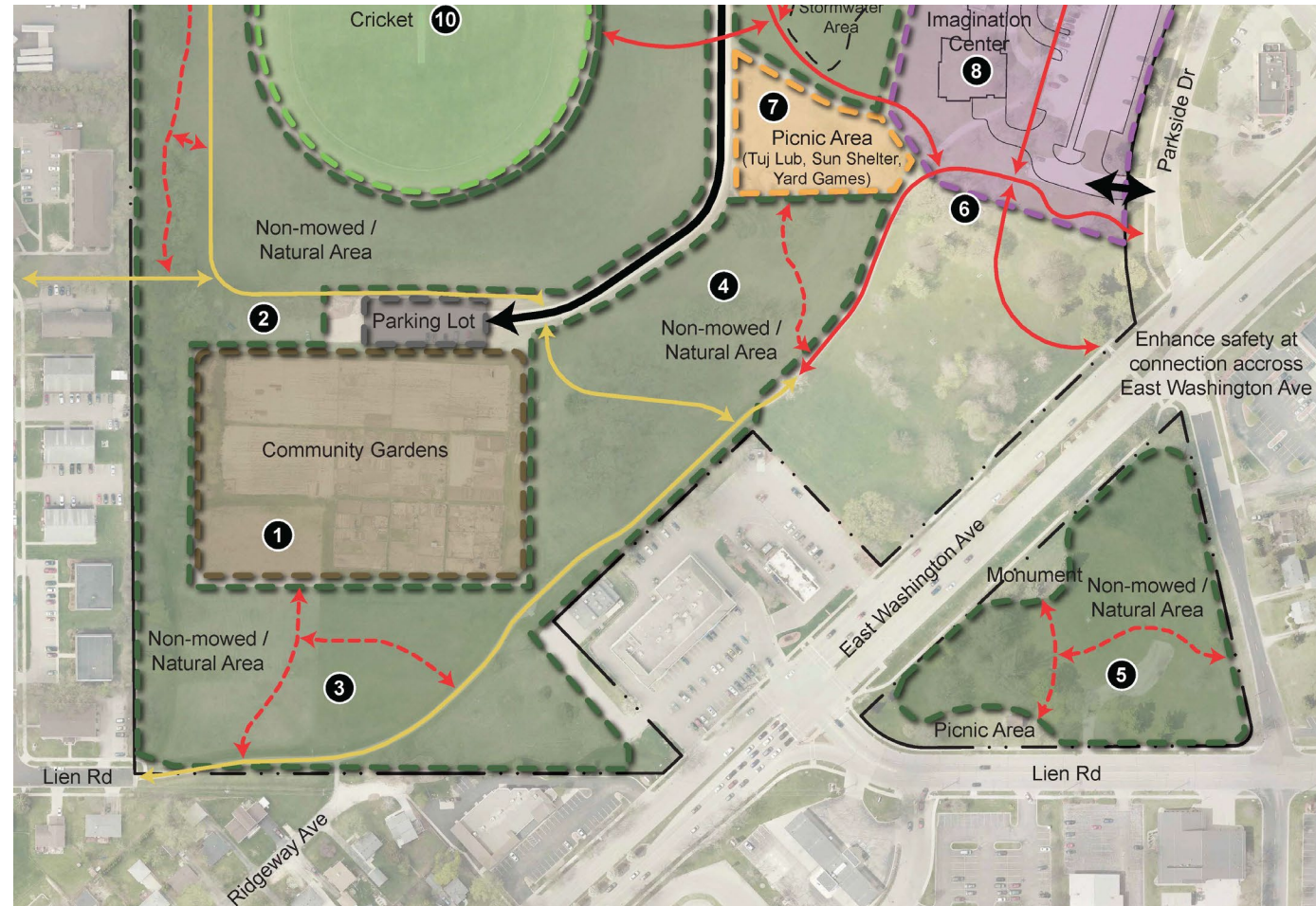







# DRAFT MASTER PLAN (NORTH)

- 8** Construct Imagination Center. Imagination Center to include library, all-season reservable parks pavillion, public restrooms, BCycle station, bike parking, and stormwater management (Madison Public Library led project). In the event the project does not move forward or an alternative site is chosen, the existing shelter building should be considered for replacement.
- 9** Construct all-inclusive playground.
- 10** Re-grade field to enhance safety for cricket players. Construct accessible path to field from parking lot and Imagination Center
- 11** Construct nature trail around stormwater area and north of soccer fields.
- 12** Improve stormwater area with native planting and enhanced functionality.
- 13** Construct multi-use path on north side of driveway.

## LEGEND

-  Ex. Vehicle Circulation
-  Ex. Multi-use Path
-  New Multi-use Path
-  Ex. Mowed Path
-  New Mowed Path





# DRAFT MASTER PLAN (LONG-TERM)

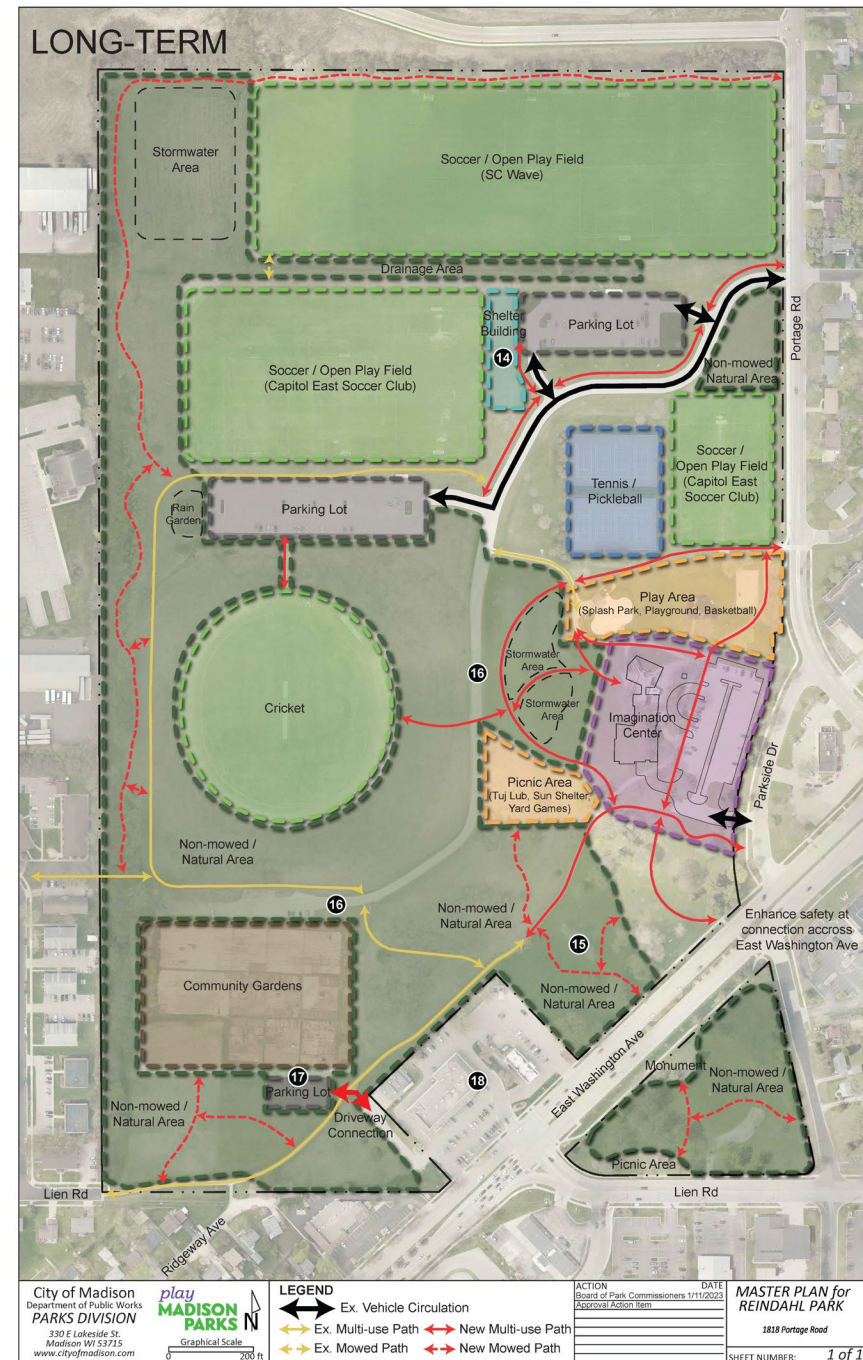



# DRAFT MASTER PLAN (NORTH)

- 14 Construct prototype reservable shelter including bathrooms, outdoor covered area, and some storage.
- 15 Naturalize area with native grasses and forbs.
- 16 Remove existing gravel driveway and parking lot for community gardens.
- 17 Construct new paved parking lot for community gardens.
- 18 Potential future expansion area. Acquisition to be evaluated in the future if parcels become available.

## LEGEND

- ↔ Ex. Vehicle Circulation
- ↔ Ex. Multi-use Path ↔ New Multi-use Path
- ↔ Ex. Mowed Path ↔ New Mowed Path









# DRAFT MASTER PLAN (SOUTH)

- 14** Construct prototype reservable shelter including bathrooms, outdoor covered area, and some storage.
- 15** Naturalize area with native grasses and forbs.
- 16** Remove existing gravel driveway and parking lot for community gardens.
- 17** Construct new paved parking lot for community gardens.
- 18** Potential future expansion area. Acquisition to be evaluated in the future if parcels become available.

## LEGEND

-  Ex. Vehicle Circulation
-  Ex. Multi-use Path
-  New Multi-use Path
-  Ex. Mowed Path
-  New Mowed Path

