

Southern Wisconsin Huts LLC

Business Plan

Southern Wisconsin Huts LLC intends to operate the Pizza Hut located at 7440 Mineral Point Rd Madison WI 53719.

This will be a typically run Pizza Hut selling made to order pizza, chicken wings, pasta, sandwiches, breadsticks and desserts for dine-in as well as carryout and delivery.

Beer will also be offered for dine-in guests only.

Orders for beer will occur at either the order counter or from a table server where ID checking will also take place.



CREATE YOUR OWN PIZZA

CHEESE PIZZA

SMALL (S) \$7.99 8 SLICES PER PIZZA Small Pan Crust not available	MEDIUM (M) \$10.99 8 SLICES PER PIZZA	LARGE (L) \$12.99 8 SLICES PER PIZZA
-------------------------------------------------------------------------	------------------------------------------	-----------------------------------------

PERSONAL PAN (P)
4 SLICES PER PIZZA
Up to 3 toppings **140-200 Cal/Slice \$4.99**
Specialty **150-210 Cal/Slice \$5.99**
Extra Cheese or Toppings **75¢ each**

CHOOSE A CRUST

(CAL/SLICE)

HAND TOSSED S60 CAL M120 CAL L 173 CAL	ORIGINAL STUFFED CRUST™ L233 CAL Large only - \$2 additional charge	THIN 'N CRISPY® S60CAL M100 CAL L130 CAL
		ORIGINAL PAN™ S90 CAL M160 CAL L230 CAL Add \$1 for Medium or Large Pan Pizzas

CHOOSE A SAUCE

Calorie range varies depending on pizza size (CAL/SLICE)

CLASSIC MARINARA ADD 5-10 CAL · CREAMY GARLIC PARMESAN ADD 20-30 CAL
BUFFALO ADD 0-10 CAL · BARBEQUE ADD 5-20 CAL

ADD CHEESE

Calorie range varies depending on pizza size (CAL/SLICE)

CHEESE WITH TOPPINGS ADD 30-80 CAL ·
CHEESE ONLY ADD 50-130 CAL

ADD INGREDIENTS

For each Ingredient or Extra Cheese Add \$1.25 for SMALL, \$1.50 for MEDIUM and \$1.75 for LARGE
Calories are based on 1-Topping amount. Range varies depending on pizza size (CAL/SLICE)

PEPPERONI ADD 25-60 CAL
ITALIAN SAUSAGE ADD 50-90 CAL
MEATBALL ADD 35-60 CAL
HAM ADD 5-15 CAL
BACON ADD 15-40 CAL
GRILLED CHICKEN ADD 15-30 CAL

BEEF ADD 50-80 CAL
AMERICAN SAUSAGE ADD 45-80 CAL
SLICED BANANA PEPPERS ADD 0 CAL
BLACK OLIVES ADD 5-20 CAL
MUSHROOMS ADD 0 CAL
EXTRA CHEESE ADD 15-50 CAL

RED ONIONS ADD 0-10 CAL
GREEN OLIVES ADD 10-30 CAL
GREEN BELL PEPPERS ADD 0 CAL
PINEAPPLE ADD 0-15 CAL
DICED TOMATOES ADD 0 CAL
JALAPEÑOS ADD 0 CAL

FLAVOR RECIPES

Calorie range is based on crust types (CAL/SLICE)

SMALL (S) \$10.99 - MEDIUM (M) \$14.99 - LARGE (L) \$17.99 · Add \$1 for Medium or Large Pan Pizzas
8 SLICES 8 SLICES 8 SLICES

MEAT RECIPES

SUPREME

S120-160 CAL | M220-270 CAL | L300-400 CAL
Classic marinara topped with pepperoni, American sausage, beef, mushrooms, green bell peppers and red onions.

MEAT LOVERS®

S150-190 CAL | M260-320 CAL | L370-470 CAL
Classic marinara stacked with pepperoni, beef, Italian and American sausage, ham and bacon.

PEPPERONI LOVERS®

S140-170 CAL | M260-300 CAL | L350-440 CAL
Classic marinara piled high with an extra heaping portion of cheese and extra pepperoni.

Original HAWAIIAN

S110-140 CAL | M180-240 CAL | L250-350 CAL
Pineapple, ham, bacon and your choice of barbecue sauce or classic marinara.

SUPER SUPREME

S150-180 CAL | M260-310 CAL | L360-460 CAL
Classic marinara sauce topped with pepperoni, beef, ham, Italian sausage, American sausage, fresh red onions, mushrooms, green bell peppers and black olives.

CHICKEN RECIPES

AMERICAN CHICKEN CLUB

S150-180 CAL | M260-310 CAL | L350-440 CAL
Grilled chicken, mayo, red onions, tomatoes and bacon.

Original BARBEQUE CHICKEN

S110-180 CAL | M180-240 CAL | L260-400 CAL
Grilled chicken, Honey BBQ sauce, topped with cheese.

BACKYARD BBQ CHICKEN

S130-160 CAL | M210-270 CAL | L280-380
BBQ sauce topped with grilled chicken, bacon and red onions.

HAWAIIAN CHICKEN

S110-140 CAL | M180-240 CAL | L250-350 CAL
Marinara sauce with grilled chicken, ham, pineapple and green bell peppers.

VEGGIE RECIPES

VEGGIE LOVER'S® S100-130 CAL | M180-230 CAL | L240-330 CAL

Classic marinara topped with fresh mushrooms, fresh red onions, diced tomatoes, fresh green bell peppers and black olives.

SPICY RECIPE

BUFFALO CHICKEN S110-140 CAL | M190-240 CAL | L250-350 CAL

Buffalo sauce topped with grilled chicken, sliced banana peppers and fresh red onions.

OUR SIGNATURE TACO PIZZA S150-180 CAL | M260-310 CAL | L340-440

SMALL \$11.99 · MEDIUM \$15.99 · LARGE \$18.99 Add \$1 for Medium or Large Pan Pizzas

Refried beans, beef and Cheddar cheese. Topped with lettuce, red onions, tomatoes, taco chips and Cheddar cheese. Served with mild taco sauce and sour cream. Ranch dressing .79 (Adds 210-250 CAL)

Ask About our UDI'S® Gluten-Free Pizza

2000 calories a day is used for general nutrition advice, but calorie needs vary. Additional nutritional information available.

WINGS

STYLES

TRADITIONAL 80 Cal/Wing

6 12 18 36
9⁹⁹ 18⁹⁹ 26⁹⁹ 51⁹⁹

BONE-OUT 80 Cal/Wing

8 16 24 48
7⁹⁹ 14⁹⁹ 21⁹⁹ 41⁹⁹

Served with Blue Cheese or Ranch dipping sauce.
Extra sauce 79¢.

FLAVORS SAUCES

Calories depend on wing style (BONE OUT | TRADITIONAL)

GARLIC PARM add 45 | 60 Cal/Wing SPICY GARLIC add 30 | 40 Cal/Wing
HONEY BBQ add 30 | 40 Cal/Wing BUFFALO MEDIUM add 15 | 20 Cal/Wing
SWEET CHILI add 15 Cal/Wing BUFFALO BURNIN' HOT add 15 | 20 Cal/Wing
BUFFALO MILD add 15 | 20 Cal/Wing LIMITED TIME SAUCE ask for details

RUBS

CAJUN STYLE add 0 Cal/Wing LEMON PEPPER add 0 Cal/Wing

OR GO NAKED

NO SAUCE, NO RUB add 0 Cal/Wing

APPETIZERS & SALADS

CLASSIC BREADSTICKS (5) 5.79 (10) 10.79 GARLIC BREAD (4) 2.99
140 CAL/STICK 140 CAL/SLICE

Served with Marinara sauce.

BAKERY-STYLE BREADSTICK (4) 5.79

150 CAL/STICK

Served with Marinara or Cheese Sauce

CHEESE STICKS (5) 6.99 (10) 11.99

170 CAL/STICK

Served with marinara sauce.

GARLIC BREAD WITH CHEESE (4) 5.49
210 CAL/SLICE

STRAIGHT-CUT FRIES 2.99

Plain or Seasoned 500-510 CAL

DIPPING SAUCES

Ranch (210 CAL) Marinara (45 CAL) or Garlic Butter (100 CAL) 79¢ ea. Cheese Sauce (130 CAL) 1.25

SALAD BAR

With Your Meal
4.99

As Your Meal
8.99

CRISPY CHICKEN CAESAR SALAD 1390 CAL 8.99

Garlic Parmesan Bone-Out Wings, lettuce, cheese, seasoned croutons and Caesar dressing.

BUFFALO CHICKEN SALAD 740 (w/o Dressing)

980 - 1200 CAL (w/dressing) 8.99

Buffalo Medium Bone-Out Wings, diced tomatoes, cheese, seasoned croutons with Blue Cheese or Ranch dressing.

ZESTY ITALIAN SALAD 720 CAL 8.99

Lettuce, pepperoni, ham, cheese, tomatoes, black olives, sliced banana peppers, red onions, seasoned croutons and Italian dressing.

GRILLED CHICKEN CAESAR SALAD 830 CAL 8.99

Lettuce, grilled chicken, Parmesan, seasoned croutons, and Caesar dressing.

CHICKEN GARDEN SALAD 550 CAL 8.99

Sliced seasoned grilled chicken on a blend of crunchy iceberg and green leaf lettuce. Topped with sliced Roma tomatoes, red onions, cucumbers, shredded Cheddar, crispy croutons and your choice of dressing.

BLT SALAD 420 CAL 8.99

This blend of crunchy iceberg and green leaf lettuce is topped with smoky bacon, sliced Roma tomatoes, shredded Parmesan and seasoned croutons.

PASTA

INDIVIDUAL PASTA SERVED WITH 2 SLICES OF GARLIC BREAD. FOR GARLIC CHEESE BREAD (ADDS 70 CAL/SLICE) ADD 99¢

MEATY MARINARA Individual Pan 8⁴⁹ 720 CAL

Italian-seasoned meat sauce and rotini topped with cheese, then oven-baked.

Make it Supreme (add mushrooms, onions, bell peppers and pepperoni) for 50¢ additional (adds 30 CAL)

CREAMY CHICKEN ALFREDO Individual Pan 8⁴⁹ 850 CAL

Grilled chicken and rotini pasta baked in Alfredo sauce, topped with cheese.

FAMILY-SIZE (TWO PANS) \$14.99 One recipe or one pan of each of the above. Served with 5 Breadsticks

SANDWICHES

SANDWICHES SERVED WITH CHIPS & A PICKLE. SUBSTITUTE STRAIGHT-CUT FRIES FOR 1.49 (Adds 260-270 Cal)

BLACK FOREST HAM & CHEESE 1170 CAL 7⁹⁹

Black Forest ham, provolone, lettuce, tomatoes and Italian dressing on a Cheddar-toasted bun.

SUPREMO (BISTRO HOAGIE) 1290 CAL 7⁹⁹

A Parmesan crusted toasted hoagie with Black Forest ham, pepperoni, salami, provolone, topped with tomatoes, lettuce and our special Italian dressing.

BUFFALO CHICKEN 1550 CAL 7⁹⁹

Buffalo Medium Bone-Out Wings, lettuce and blue cheese dressing on a toasted bun.

CHICKEN PARMESAN 1790 CAL 7⁹⁹

Garlic Parm bone-out wings, provolone, Parmesan and marinara sauce on a Parmesan toasted bun and served with a side of Marinara.

HONEY BBQ CHICKEN 1720 CAL 7⁹⁹

Honey BBQ Bone-Out Wings, lettuce, cheddar sauce & ranch dressing on a Cheddar-toasted bun.

SOFT DRINKS (by the glass)

Free refills • Children 5 and under FREE SOFT DRINK

DIET PEPSI (0 CAL); OTHER PEPSI PRODUCTS (150-230 CAL)

LEMONADE (280 CAL); ICED TEA (6 CAL); SWEET TEA (180 CAL)

Your choice \$2.59

COFFEE OR HOT TEA (UNSWEETENED 5 CAL) \$1.59

DESSERTS

THE ULTIMATE CHOCOLATE CHIP COOKIE
200 Cal/ 1/8th Portion 6.99

TRIPLE CHOCOLATE BROWNIE
260 Cal/ 1/9th Portion 6.99

CINNAMON STICKS 10 Sticks 80 Cal/Stick 5.99
White Icing Dipping Sauce 180 Cal

CINNABON® MINI ROLLS (10) 6.99 80 Cal/Roll
Topped with Signature Cream Cheese frosting.

ASK ABOUT OUR BEER AND WINE SELECTIONS

2000 calories a day is used for general nutrition advice, but calorie needs vary. Additional nutritional information available.

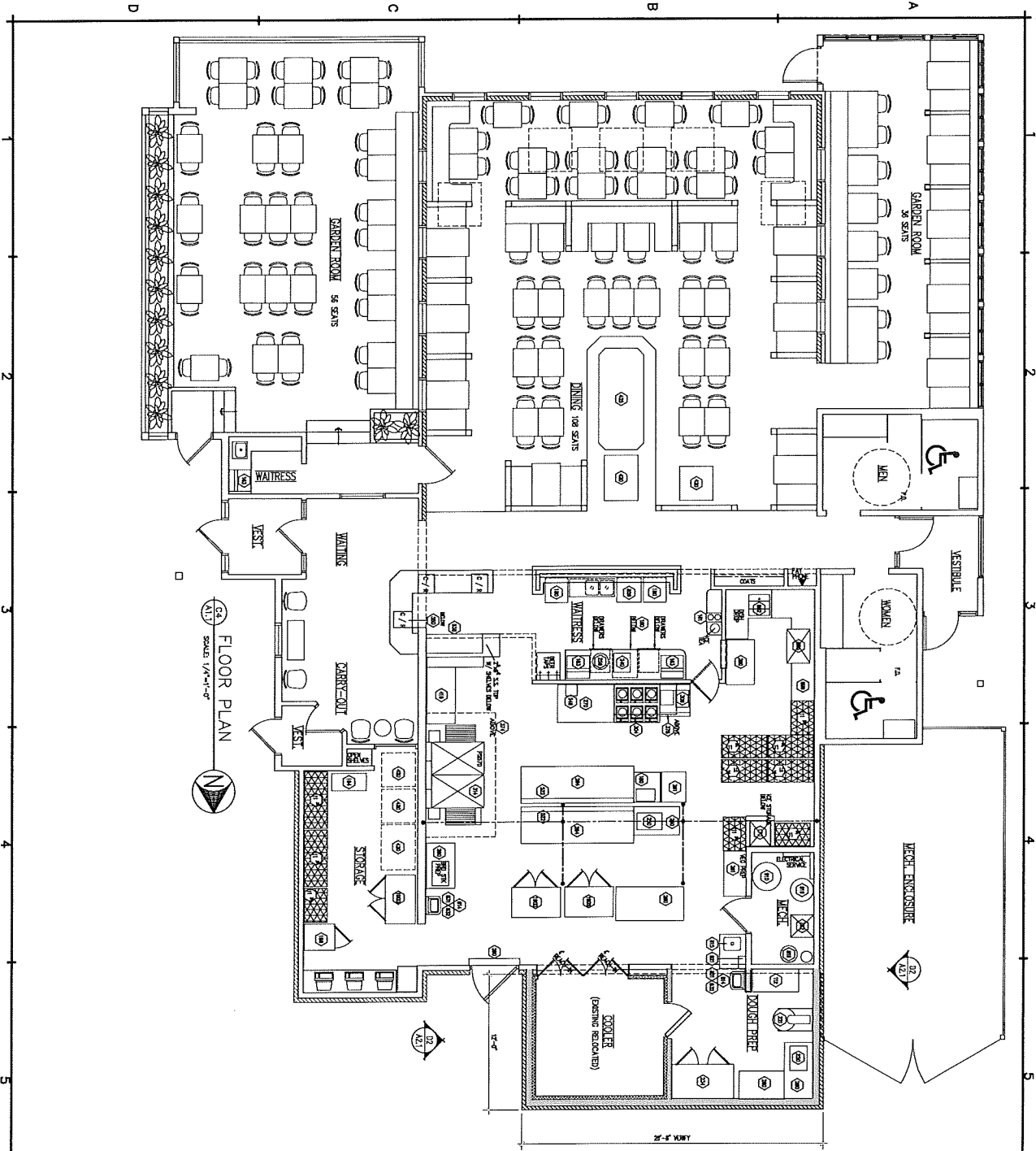

EQUIPMENT SUMMARY

NO.	DESCRIPTION	QTY	UNIT	NOTE
001	RECEPTION COUNTER	1	LINEAR	
002	THE CASH REGISTER	1	TABLE	
003	THE CASH DRAWER	1	TABLE	
004	MANAGER'S DESK	1	TABLE	
005	FILE CABINET	1	TABLE	
006	COFFEE MAKER	1	TABLE	
007	COFFEE THERMOS	1	TABLE	
008	COFFEE MAKER	1	TABLE	
009	COFFEE THERMOS	1	TABLE	
010	COFFEE MAKER	1	TABLE	
011	COFFEE THERMOS	1	TABLE	
012	COFFEE MAKER	1	TABLE	
013	COFFEE THERMOS	1	TABLE	
014	COFFEE MAKER	1	TABLE	
015	COFFEE THERMOS	1	TABLE	
016	COFFEE MAKER	1	TABLE	
017	COFFEE THERMOS	1	TABLE	
018	COFFEE MAKER	1	TABLE	
019	COFFEE THERMOS	1	TABLE	
020	COFFEE MAKER	1	TABLE	
021	COFFEE THERMOS	1	TABLE	
022	COFFEE MAKER	1	TABLE	
023	COFFEE THERMOS	1	TABLE	
024	COFFEE MAKER	1	TABLE	
025	COFFEE THERMOS	1	TABLE	
026	COFFEE MAKER	1	TABLE	
027	COFFEE THERMOS	1	TABLE	
028	COFFEE MAKER	1	TABLE	
029	COFFEE THERMOS	1	TABLE	
030	COFFEE MAKER	1	TABLE	
031	COFFEE THERMOS	1	TABLE	
032	COFFEE MAKER	1	TABLE	
033	COFFEE THERMOS	1	TABLE	
034	COFFEE MAKER	1	TABLE	
035	COFFEE THERMOS	1	TABLE	
036	COFFEE MAKER	1	TABLE	
037	COFFEE THERMOS	1	TABLE	
038	COFFEE MAKER	1	TABLE	
039	COFFEE THERMOS	1	TABLE	
040	COFFEE MAKER	1	TABLE	
041	COFFEE THERMOS	1	TABLE	
042	COFFEE MAKER	1	TABLE	
043	COFFEE THERMOS	1	TABLE	
044	COFFEE MAKER	1	TABLE	
045	COFFEE THERMOS	1	TABLE	
046	COFFEE MAKER	1	TABLE	
047	COFFEE THERMOS	1	TABLE	
048	COFFEE MAKER	1	TABLE	
049	COFFEE THERMOS	1	TABLE	
050	COFFEE MAKER	1	TABLE	
051	COFFEE THERMOS	1	TABLE	
052	COFFEE MAKER	1	TABLE	
053	COFFEE THERMOS	1	TABLE	
054	COFFEE MAKER	1	TABLE	
055	COFFEE THERMOS	1	TABLE	
056	COFFEE MAKER	1	TABLE	
057	COFFEE THERMOS	1	TABLE	
058	COFFEE MAKER	1	TABLE	
059	COFFEE THERMOS	1	TABLE	
060	COFFEE MAKER	1	TABLE	
061	COFFEE THERMOS	1	TABLE	
062	COFFEE MAKER	1	TABLE	
063	COFFEE THERMOS	1	TABLE	
064	COFFEE MAKER	1	TABLE	
065	COFFEE THERMOS	1	TABLE	
066	COFFEE MAKER	1	TABLE	
067	COFFEE THERMOS	1	TABLE	
068	COFFEE MAKER	1	TABLE	
069	COFFEE THERMOS	1	TABLE	
070	COFFEE MAKER	1	TABLE	
071	COFFEE THERMOS	1	TABLE	
072	COFFEE MAKER	1	TABLE	
073	COFFEE THERMOS	1	TABLE	
074	COFFEE MAKER	1	TABLE	
075	COFFEE THERMOS	1	TABLE	
076	COFFEE MAKER	1	TABLE	
077	COFFEE THERMOS	1	TABLE	
078	COFFEE MAKER	1	TABLE	
079	COFFEE THERMOS	1	TABLE	
080	COFFEE MAKER	1	TABLE	
081	COFFEE THERMOS	1	TABLE	
082	COFFEE MAKER	1	TABLE	
083	COFFEE THERMOS	1	TABLE	
084	COFFEE MAKER	1	TABLE	
085	COFFEE THERMOS	1	TABLE	
086	COFFEE MAKER	1	TABLE	
087	COFFEE THERMOS	1	TABLE	
088	COFFEE MAKER	1	TABLE	
089	COFFEE THERMOS	1	TABLE	
090	COFFEE MAKER	1	TABLE	
091	COFFEE THERMOS	1	TABLE	
092	COFFEE MAKER	1	TABLE	
093	COFFEE THERMOS	1	TABLE	
094	COFFEE MAKER	1	TABLE	
095	COFFEE THERMOS	1	TABLE	
096	COFFEE MAKER	1	TABLE	
097	COFFEE THERMOS	1	TABLE	
098	COFFEE MAKER	1	TABLE	
099	COFFEE THERMOS	1	TABLE	
100	COFFEE MAKER	1	TABLE	

FLOOR PLAN
A1.1

Contin. No. K0818
REVISION 09/22/08
AS BUILT 01/23/07
AS BUILT 12/27/07

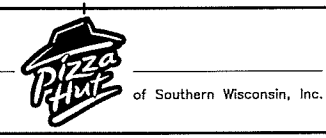

7440 MINERAL POINT ROAD
MADISON, WISCONSIN 53717

GK ARCHITECTURE, inc.
718 Post Road Madison, WI 53713
(608) 277 0585 www.gkarch.com