



Change of Premises

Fee: \$25.00

City of Madison Clerk

210 MLK Jr Blvd, Room 103
Madison, WI 53703

licensing@cityofmadison.com
608-266-4601

Class A: Beer, Liquor, Cider
Class B: Beer, Liquor,
 Class C Wine

(Agenda Item Number)

(Legistar file number)

LICPCN-2022-00328

(License number)

15
(Alder District #)

604
(Police Sector)

Office Use Only

Licensed Premises Information

This application modifies existing alcohol license number: LICLIB-2017-00353

Business dba Name: CRUCIBLE

Licensed Address: 3116 COMMERCIAL AVE

Liquor/Beer Agent Name: GREG KUEBERG

90 % Alcohol, 5 % Food, 5 % Other Alder, District #: 15 Police Sector: EAST

Corporate Information

Business Legal Name (as on WI State Sellers Permit): ALABASTER ENTERTAINMENT LLC

Business Mailing Address: 3116 COMMERCIAL AVE

Business Contact Name, Position: JASON SOLMAN, OWNER

Business Phone: 640-4441

Business Email: JASON@CRUCIBLEMADISON.COM

Current Capacity (indoor): 395

Current Capacity (outdoor): 50

Proposed Capacity (indoor): 395

Proposed Capacity (outdoor): 50

If your capacity is increasing, contact Building Inspection: (608) 266-4551, binspection@cityofmadison.com

Change is: Permanent Temporary (from _____ until _____)
Date Date

Is this change related to a Roadway Café Expansion License/Roadway Permit: Yes or No

Description of Changes (include approximate measurements, and fencing, if necessary):

CONTINUE STREETERY - PARKING LOT SERVICE - SEE DRAWING

Detailed Floor Plans included (required)

[Signature], 2022-05-13
Authorized Signature Date

- Orange sign and business card issued
- "License Renewals & Changes" brochure with next steps issued

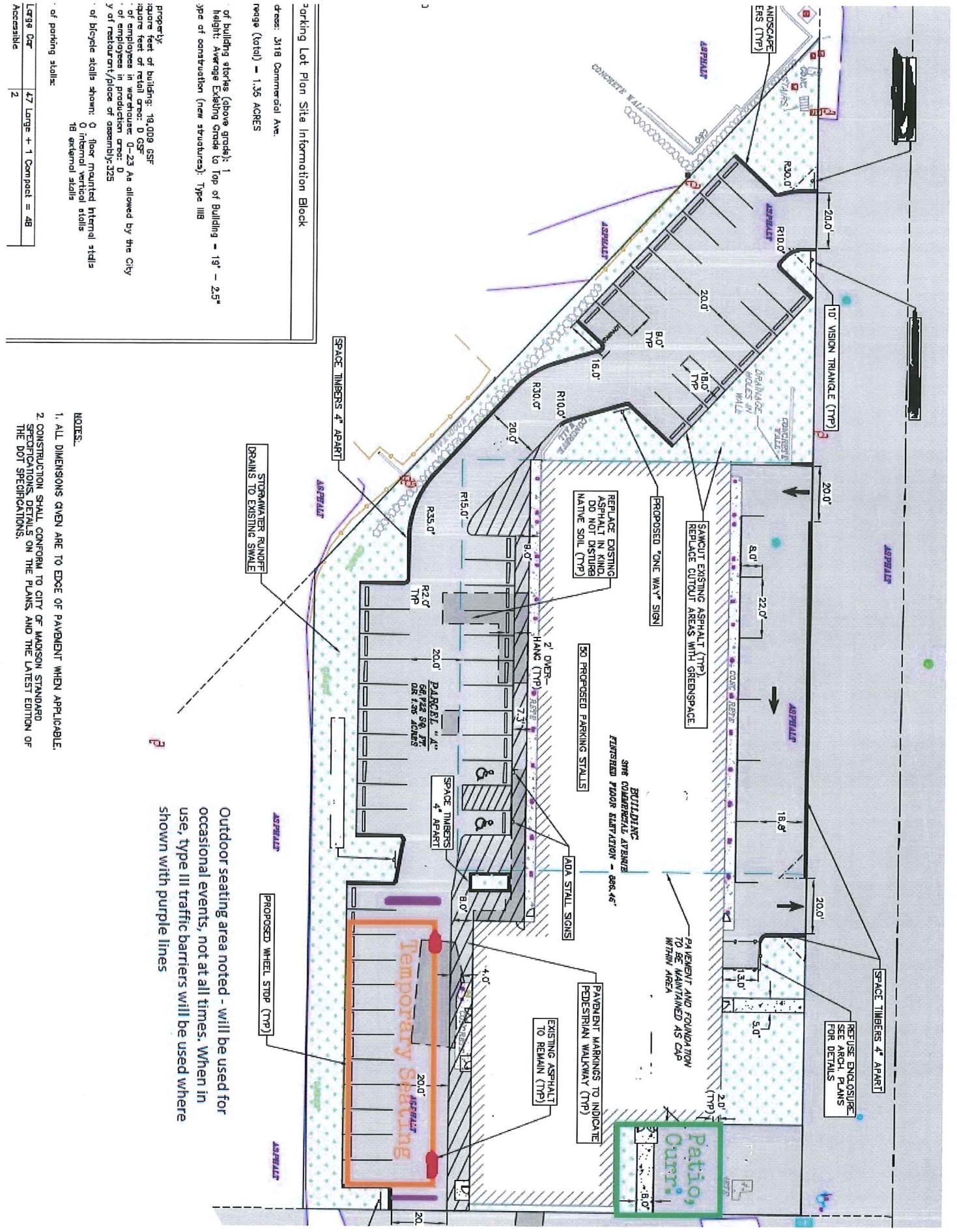

Parking Lot Plan Site Information Block

Address: 3118 Commercial Ave.
 Acreage (Total) = 1.35 ACRES

of building stories (above grade): 1
 Height: Average Existing Grade to Top of Building = 19' - 25'
 Type of construction (new structures): Type III B

Property:
 Square feet of building: 19,009 GSF
 Square feet of retail area: 0 GSF
 Number of employees in warehouse: 0-23 Are allowed by the City
 Number of employees in production area: 0
 Type of restaurant/office of assembly: 225
 Number of bicycle stalls shown: 0 floor mounted internal stalls
 18 external stalls

Number of parking stalls:	
Large Car	47 Large + 1 Compact = 48
Accessible	2

NOTES:

1. ALL DIMENSIONS GIVEN ARE TO EDGE OF PAVEMENT WHEN APPLICABLE.
2. CONSTRUCTION SHALL CONFORM TO CITY OF MADISON STANDARD SPECIFICATIONS, DETAILS ON THE PLANS, AND THE LATEST EDITION OF THE DOT SPECIFICATIONS.

Outdoor seating area noted - will be used for occasional events, not at all times. When in use, type III traffic barriers will be used where shown with purple lines