

EXISTING CONDITIONS

2.01 | SITE ASSESSMENT

PARKING

Parking comes at a premium around Camp Randall. Parking Lot 17 can be found to the North, however the Campus Master Plan calls for the Lot 17 site to be redeveloped. Lot 18 is located to the South West Corner of the project site, which currently provides 47 stalls; 18 stalls along the fire lane with another 29 in the surface lot in front of Kellner Hall, 30 of the total 47 are currently metered.

The Advanced Planning Project includes a subgrade parking concept, holding roughly 330 parking spaces, essentially adding 280 parking spaces to this side of the site.

SITE UTILITIES

The main steam line box conduit, chilled water supply and return, and gas main utilities run below the fire lane along the west boundary of the site. There are multiple manholes along this utility path, but there is one in particular that the design team needs to take into consideration as design progresses. There is a man hole that daylights at the southwest corner of the Camp Randall Memorial Park southern triangle that should be acknowledged by the design team and it is the design committees' initial recommendation to avoid if at all possible.

In 2020, the University of Wisconsin - Madison and DFDM conducted an Advanced Planning study to identify the scope and budget for replacing campus utilities in the Engineering Drive corridor. The study contemplated upsizing the chilled water, steam and condensate systems in Engineering Drive to accommodate future demand including the potential increase in floor space at the Sports Center.

Any future planning and design of the Sports Center should include a review of the *2020-Engineering Drive Utility Advanced Planning* report, and in coordination with campus, ensure there is sufficient utility capacity to serve the new vision of the Sports Center. Future planning and design of the Sports Center should also include the evaluation for the need to increase natural gas service to the facility.

SUSTAINABILITY

The new Sports Center project will be required to meet DFDM and University Sustainable Facilities Design Standards, be designed to the latest Energy Codes, and planned, designed, and constructed with environmentally responsible and sustainable concepts in mind.

BUILDING CODE

All new construction is to be designed and built to the latest IBC adopted by the state of Wisconsin. Any renovations must be brought up to the latest codes and local standards.



BADGER WAY



CAMP RANDALL MEMORIAL PARK - EAST SITE BOUNDARY



SAPC ENTRY



SPORTS CENTER HALL OF FAME TERRACE



MCCLAIN CENTER SOUTHEAST ENTRY



MONROE STREET - SOUTH SITE BOUNDARY

EXISTING CONDITIONS

2.01 | SITE ASSESSMENT

- STEAM LINE BOX CONDUIT
- UTILITY VAULT / TUNNEL
- CHILLED WATER SUPPLY
- CHILLED WATER RETURN
- GAS SUPPLY
- GAS RETURN
- CPD

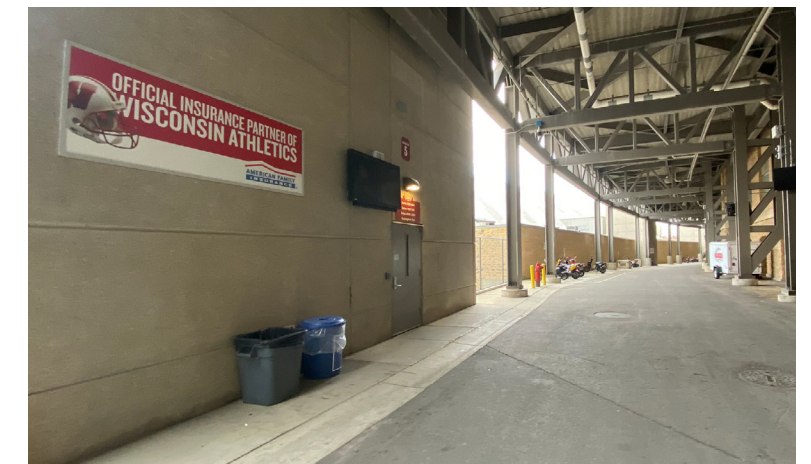
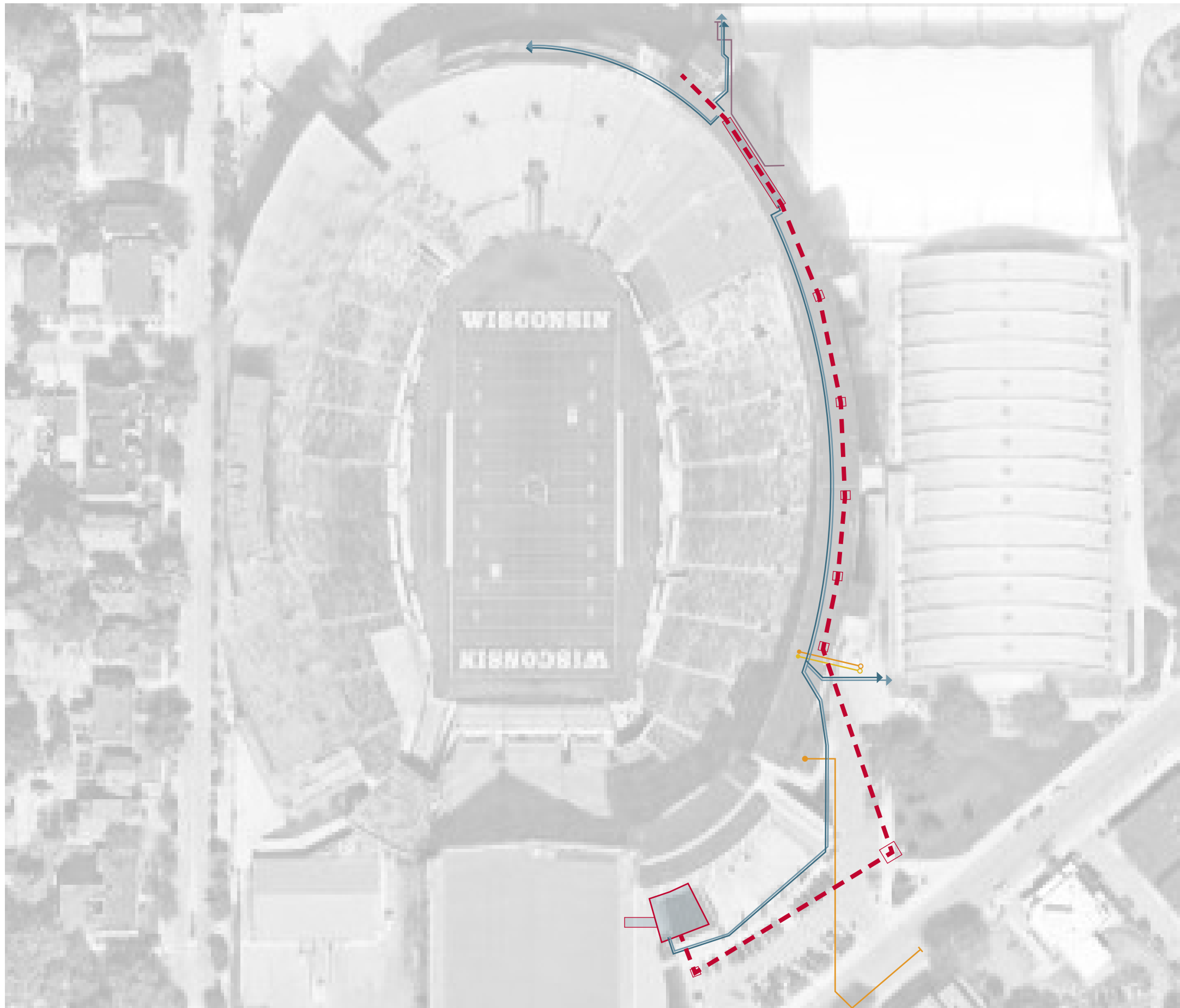

FIRE LANE - VIEW SOUTH

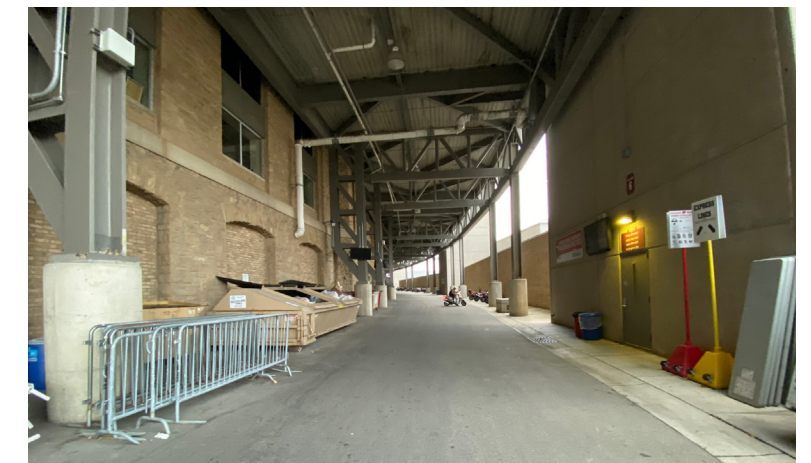

FIRE LANE - VIEW NORTH



CAMP RANDALL MEMORIAL PARK - SW - MANHOLE

Site Utilities - Site Plan

EXISTING CONDITIONS

2.01 | SITE ASSESSMENT

CAMP RANDALL MEMORIAL PARK STRUCTURE & SMALL FEATURES

The Camp Randall Memorial Park (CRMP) includes the land east of the McClain Center & Sports Center, along with the triangle to the south of the Sports Center (outlined in blue).

The Triangle is approximately .49 acres of designated land as a part of the CRMP that was provided as mitigation for the loss of land when the McClain Center was constructed.

During the Advanced Planning process, a majority of this .49 acre triangle was conceptualized to become a part of the new Sports Center Facility building footprint.

Any changes to the Camp Randall Memorial Park must be in accordance with Wisconsin State statutes. Any design concepts affecting the CRMP will need to be coordinated with UW-FP&M, UW-Athletics, and Veterans Affairs prior to going to legislature for review per:

Wis. Stat. 45.07(1b)(a) - CAMP RANDALL MEMORIAL The [Veterans Affairs] board may approve, recommend, and veto any proposed plans, modifications, and changes or policies with respect to established state memorials and any future veterans state memorials, and may recommend the creation and establishment of future veterans state memorials.

Wis. Stat. 45.07(2)(b) - CAMP RANDALL MEMORIAL - No structures, other than memorials approved by the board, and no walks, roads, or subterranean footings may be placed or erected upon Camp Randall Memorial Park, Madison, Wisconsin, as described in par. (c), unless authorized by the legislature; nor shall the park be used for any purpose other than a memorial park.

Our initial recommendation is to provide a new park amenity in the conversion of Parking Lot 18 (highlighted in red), which would include relocated existing and new historic elements that would continue to tell the story of the civil war campus and the Camp Randall Memorial Park.

All site and Memorial Park structures & small features affected by this new construction are to be accounted for, protected, and incorporated into the new design solution, being relocated on the site once approved by Veterans Affairs.

- A** Memorial Arch
- B** Lincoln Bicentennial sign
- C** MG Greenwood Cannon
- D** Directional sign
- E** Security Boulders, typ.
- F** Camp Randall historical marker By Civil War Centennial Commission
- G** Guardhouse
- H** Legal Boundary of Camp Randall Memorial Park
- I** Camp Randal Memorial plaque
- J** Lowe Memorial stone bench
- K** Athletic Hall of Fame Terrace plaque
- L** MG & Co. Cannon
- M** Camp Randall building sign
- N** Champion Pin Oak Trees
- O** Grand Army of the Republic stone bench by Daughters of Union Veterans of the Civil War
- P** 23 Wisconsin Infantry granite marker
- Q** Flag Pole
- R** US No. 332 Cannon
- S** 14th Wisconsin Volunteer Infantry plaque

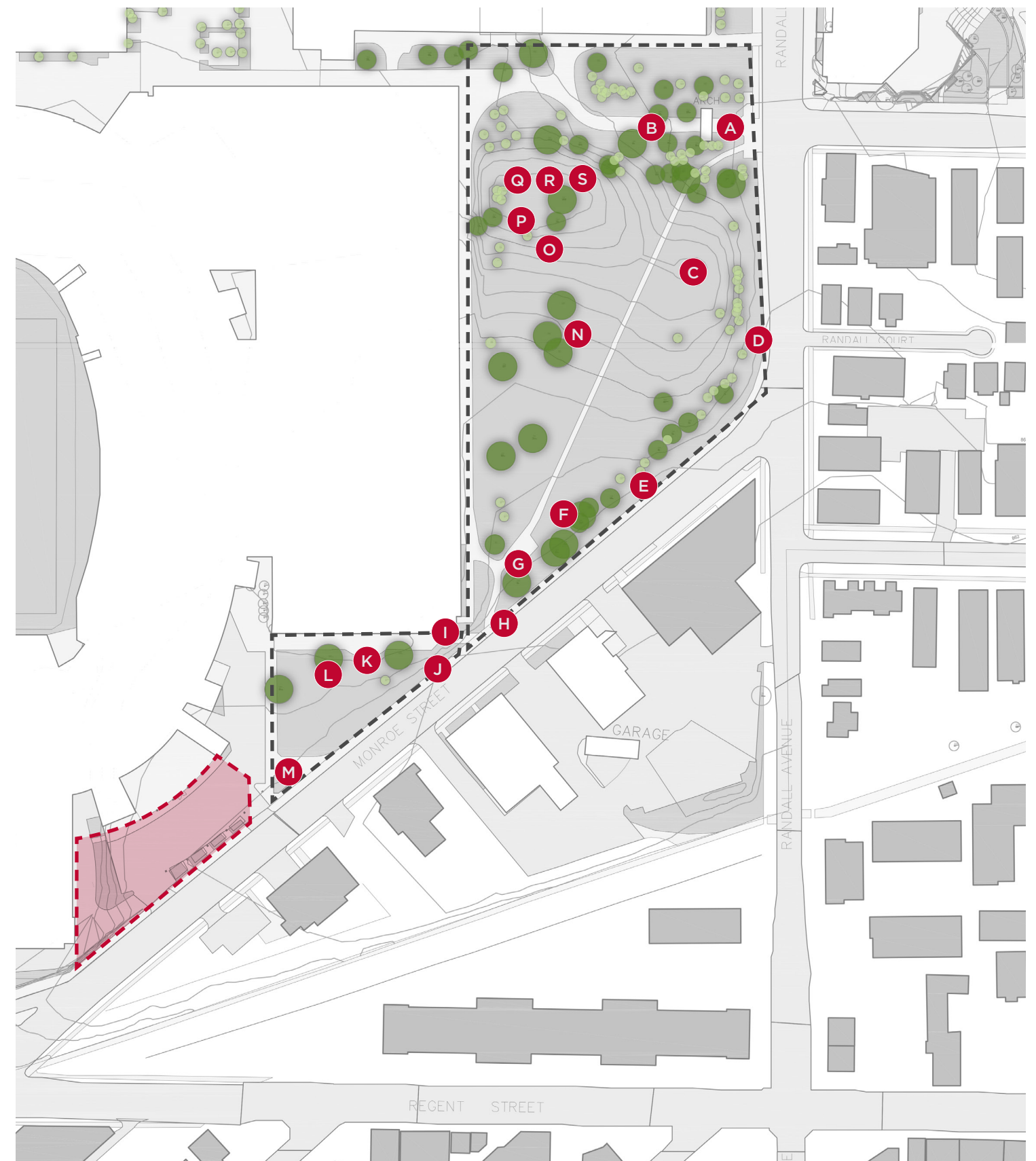

CAMP RANDALL MEMORIAL PARK TREE INVENTORY

With the Camp Randall Memorial Park to the east of the Sports Center site, there is minimal site offering for designated construction laydown area and the existing CRMP vegetation needs to be protected throughout the entirety of the construction process.

The area discussed during the Advanced Planning process is delineated in red, which shows a 30' wide minimum. Any compromised vegetation due to design or construction needs to be reviewed by FP&M and Veterans Affairs.

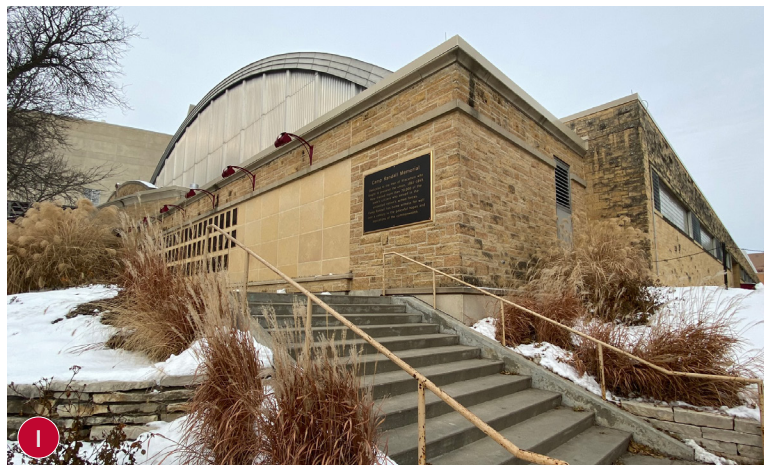







EXISTING CONDITIONS

2.02 | EXISTING FACILITIES ASSESSMENT

SCOPE ASSESSMENT DIAGRAM

- 1 THE SHELL
- 2 MCCLAIN CENTER
- 3 SAPC
- 4 CAMP RANDALL STADIUM
- 5 CAMP RANDALL MEMORIAL PARK
- 6 NORTH FOOTBALL PRACTICE FIELD
- 7 KELLNER HALL / PARKING LOT 18
- 8 PARKING LOT RAMP 17

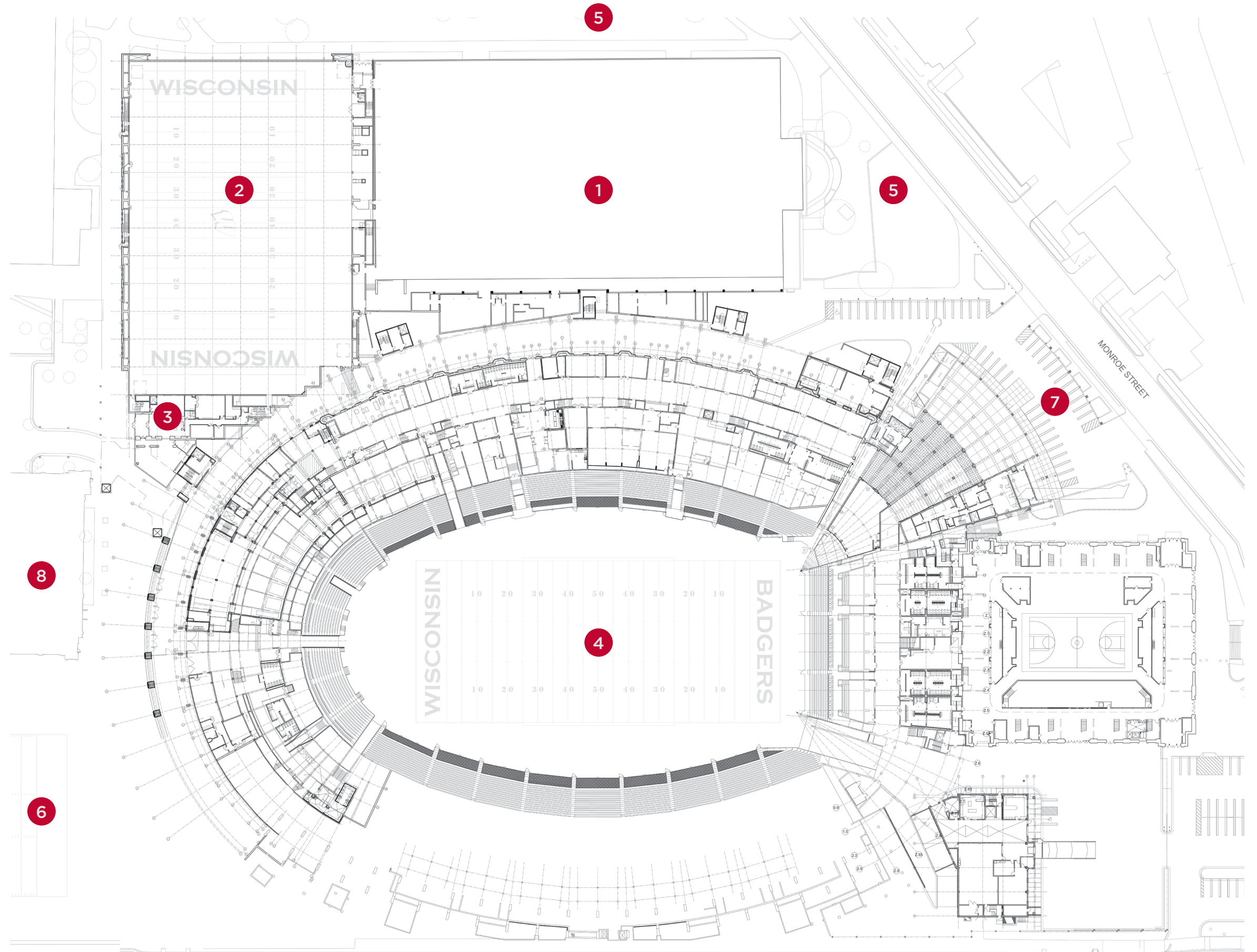

 0 25' 50' 100' Site Plan - Level One - Existing

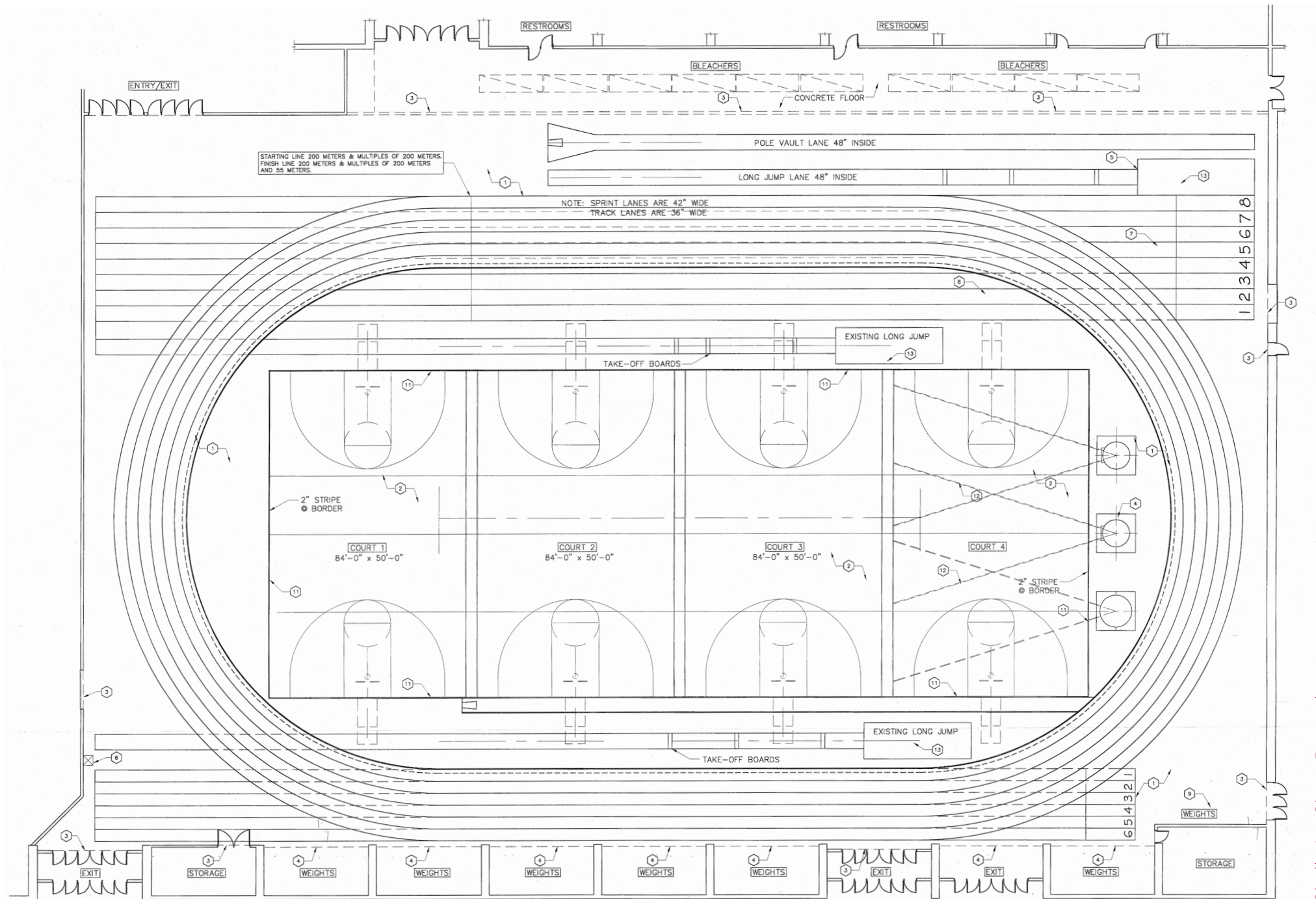

Shell - Ice Sheet Beyond

Shell Level One - Existing

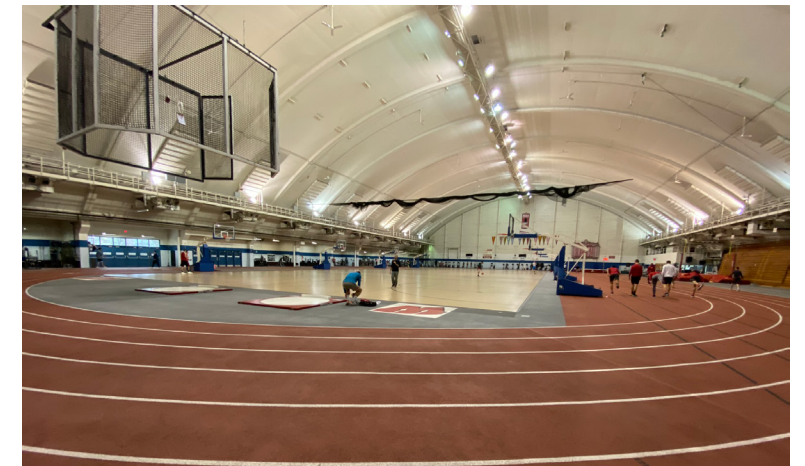

EXISTING CONDITIONS

2.02 | EXISTING FACILITIES ASSESSMENT

MCCLAIN CENTER



SPORTS MEDICINE CENTER



SPORTS PERFORMANCE CENTER



HYDROTHERAPY



FOOTBALL LOCKER ROOM



FOOTBALL LOUNGE



FOOTBALL TRAINING POOLS



MCCLAIN CENTER - LOWER LEVEL



MCCLAIN CENTER RAMP - LOOKING TO LOWER LEVEL



MCCLAIN CENTER RAMP - LOOKING TO FIELD LEVEL

MCCLAIN CENTER

- A** FOOTBALL LOCKER ROOM
10,700 SF
- B** FOOTBALL HYDROTHERAPY
2000 SF
- C** FOOTBALL LOUNGE
2300 SF
- D** OLYMPIC SPORT TRAINING
6000 SF
- E** MEETING ROOMS
1600 SF
-  EGRESS STAIRS

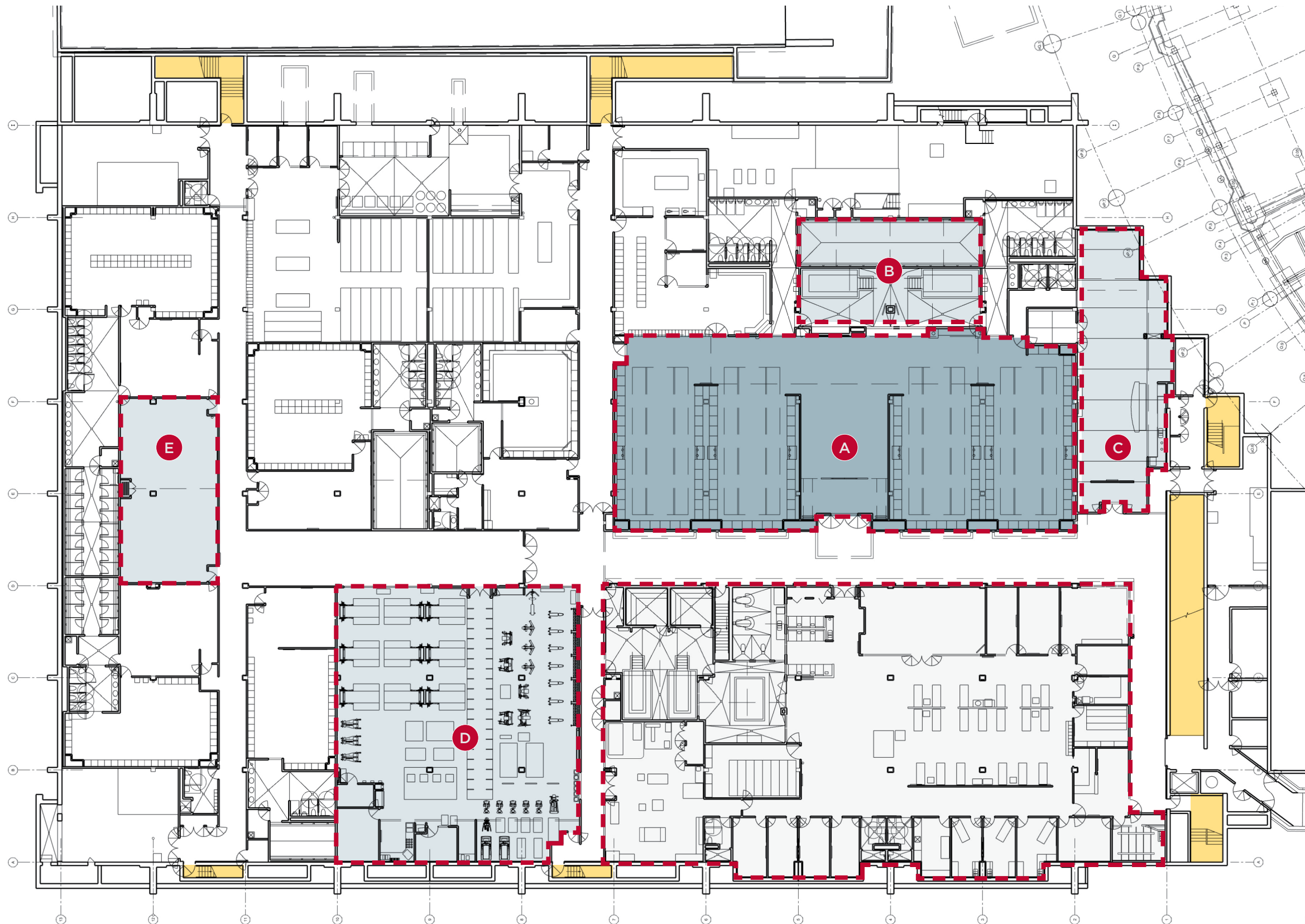

McClain Center - Existing Lower Level  

EXISTING CONDITIONS

2.02 | EXISTING FACILITIES ASSESSMENT

MCCLAIN CENTER



MCCLAIN CENTER IPF



FOOTBALL TEAM MEETING ROOM



MCCLAIN CENTER - RAMP CONNECTION TO SHELL



SMALL TEAM MEETING ROOM

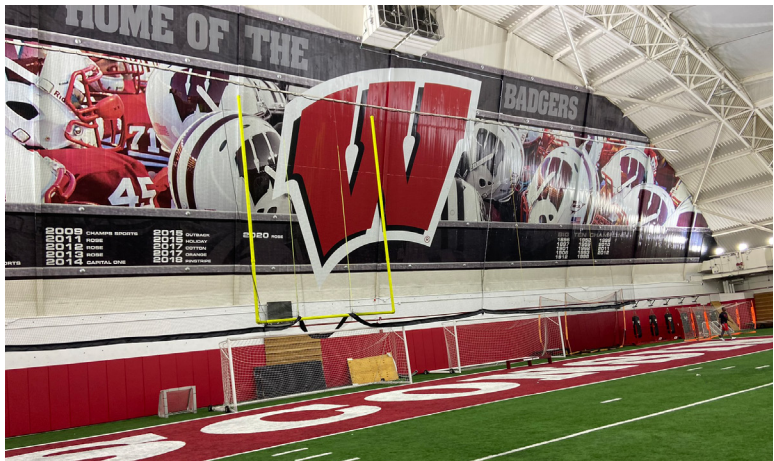

MCCLAIN CENTER IPF - MINIMAL RUNOFF



SAPC LOBBY - VIEW TO MCCLAIN CENTER IPF

MCCLAIN CENTER

EXISTING CAMP RANDALL SPORTS CENTER

- A** INDOOR PRACTICE TURF
72,000 SF
- B** TEAM MEETING ROOMS
7,260 SF
- C** SAPC
- EGRESS STAIR

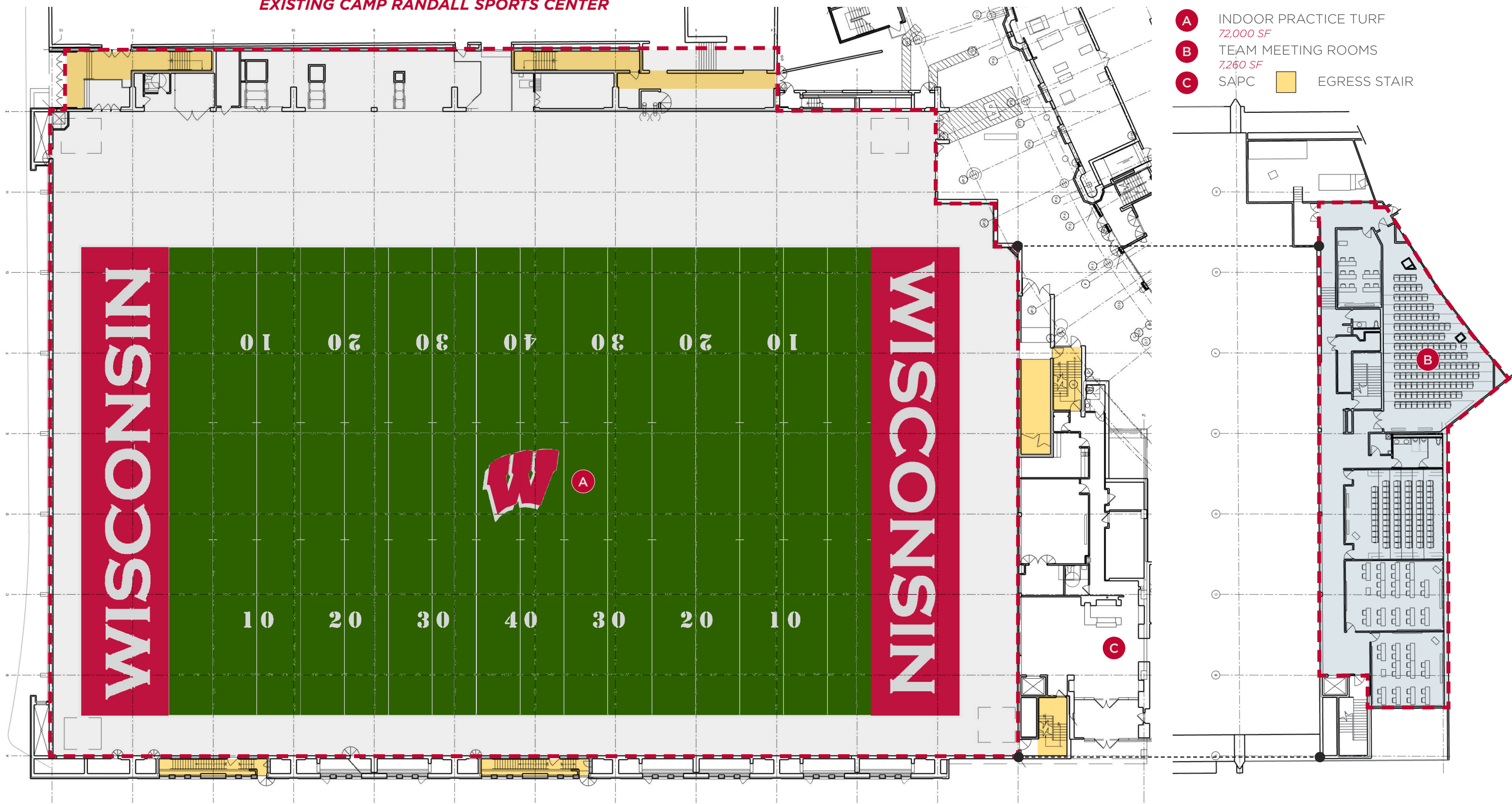

McClain Center - Existing Level One

McClain Center - Existing Level Two





