

Madison, Wisconsin

CITY OF MADISON

CITY ENGINEERING DIVISION
DEPARTMENT OF PUBLIC WORKS

PLAN OF PROPOSED IMPROVEMENT LIEN ROAD ROUNDABOUT AND BIO-RETENTION BASIN LANDSCAPE PLAN

PROJECT NO. 53W1156

PUBLIC IMPROVEMENT PROJECT APPROVED:
BY THE COMMON COUNCIL
OF MADISON, WISCONSIN
PROJECT DESIGN
APPROVED BY:

City Engineer _____ Date _____

- CONVENTIONAL SIGNS**
- COMBUSTIBLE FLUIDS
 - UNDERGROUND UTILITIES
 - GAS
 - ELECTRIC
 - TELEPHONE OR TELEGRAPH
 - STORM SEWER
 - SANITARY SEWER
 - WATER
 - FIBER OPTICS TELEPHONE
 - POWER POLE
 - RAILROAD

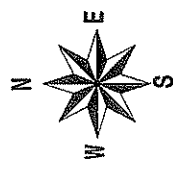

INDEX OF SHEETS

- SHEET NO. 1 TITLE
- SHEET NO. 2 POND LANDSCAPE PLAN
- SHEET NO. 3 REES AND SHRUBS PLANTING DETAILS
- SHEET NO. 4 PLANT SCHEDULE

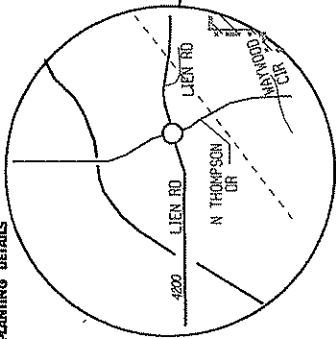

PROJECT LOCATION

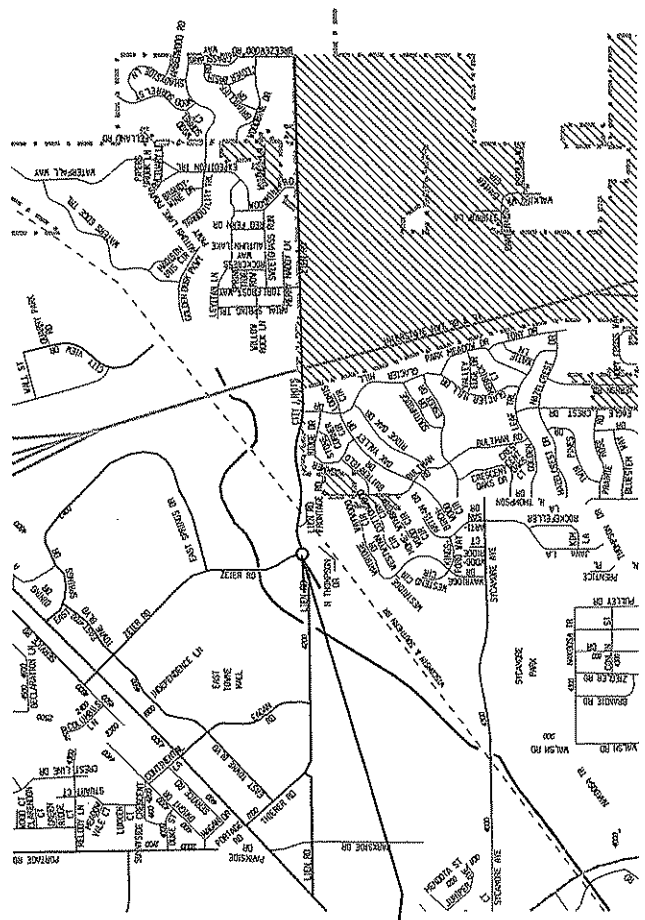

#16

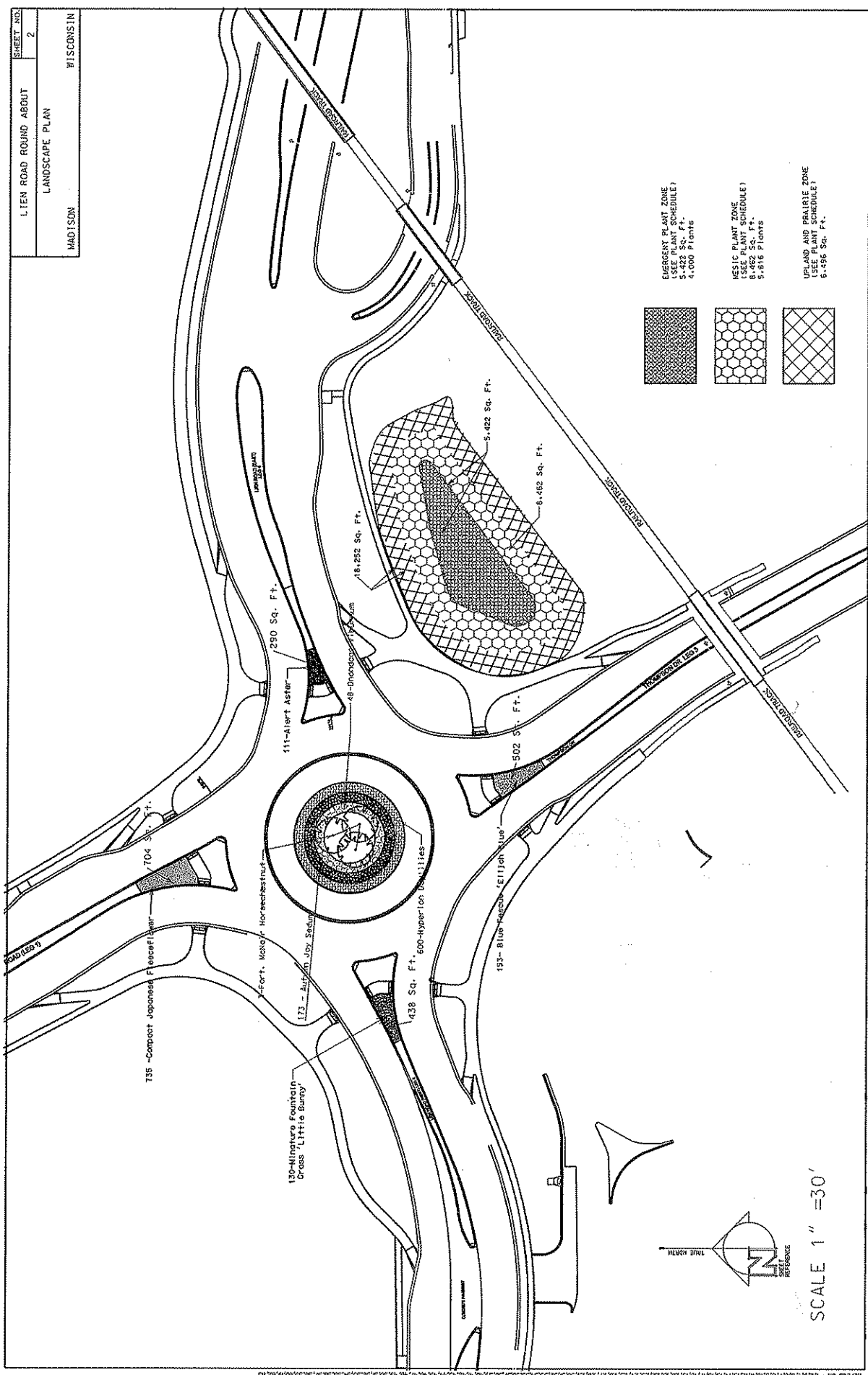

SHEET NO. 3
LIEN ROAD ROUND ABOUT
CIRCLE PLANTING LAYOUT
MADISON WISCONSIN

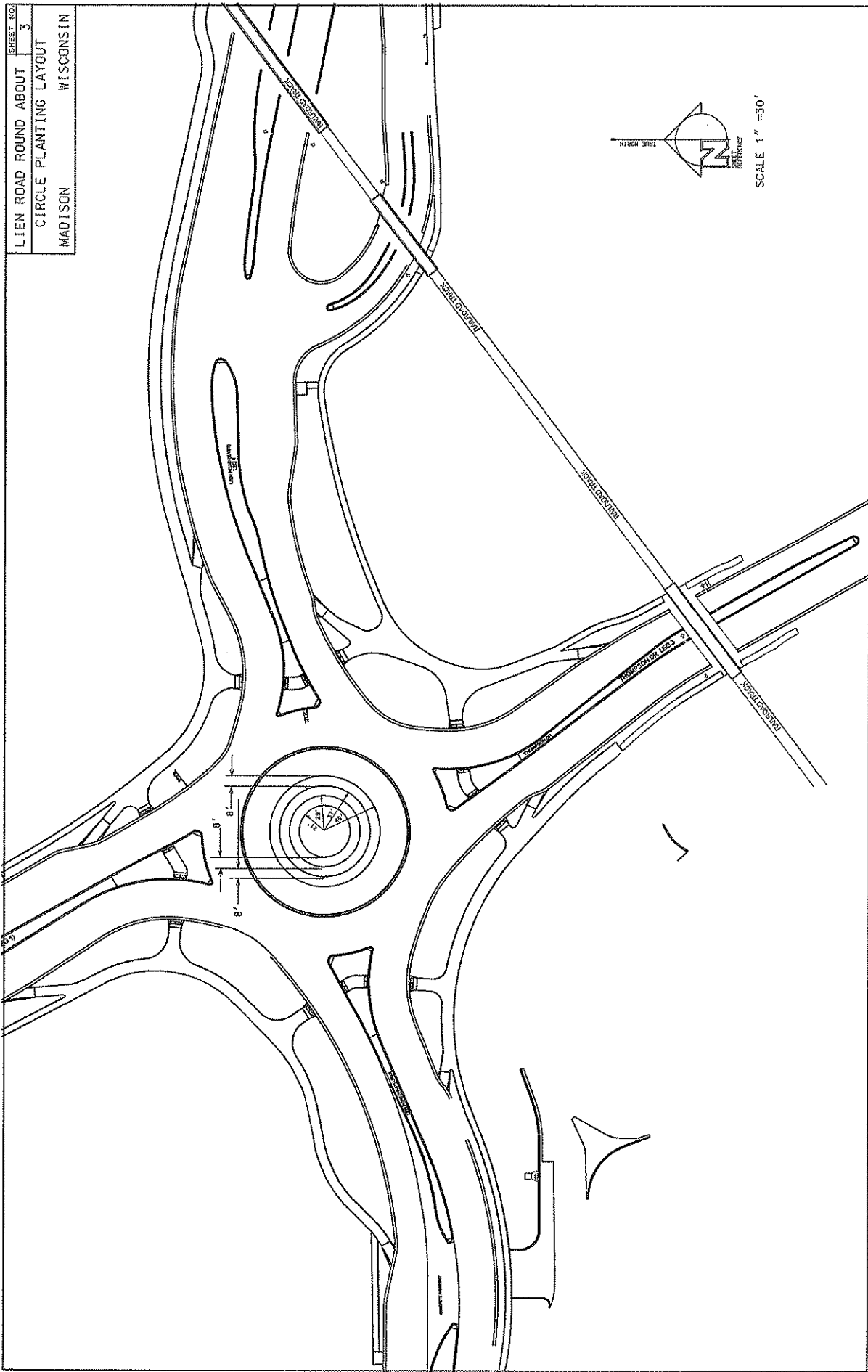

FILE NAME: _____ PLOT NAME: _____ PLOT SCALE: _____ CIRCUMFERENCE: _____ PLOT NO. 1: _____

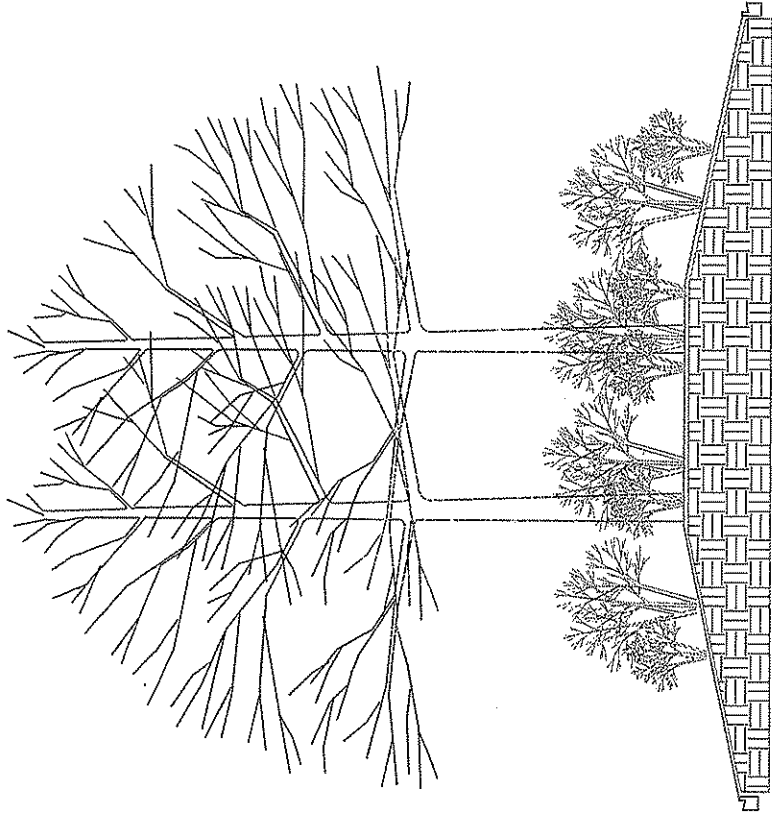

SECTION A-A
 NOT TO SCALE

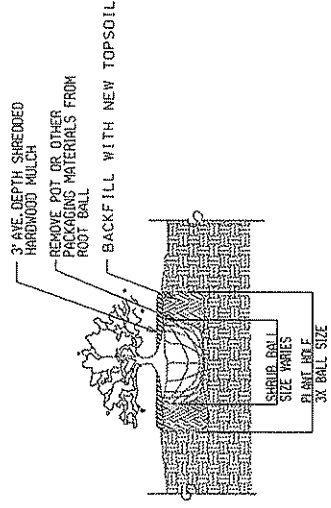

SHRUBS PLANTING DETAIL
 NOT TO SCALE

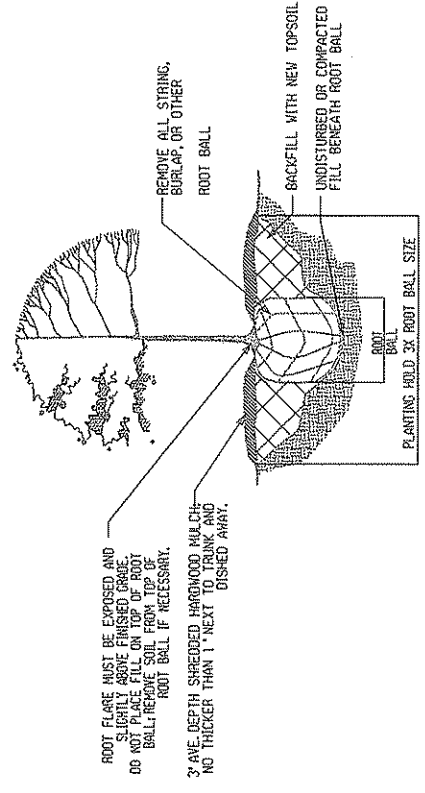

TREE PLANTING DETAIL
 NOT TO SCALE

ROOT FLARE MUST BE EXPOSED AND
 SLIGHTLY ABOVE FINISHED GRADE.
 DO NOT REMOVE SOIL FROM TOP OF
 ROOT BALL IF NECESSARY.
 3/4" AVE. DEPTH SHREDED HARDWOOD MULCH-
 NO THICKER THAN 1" NEXT TO TRUNK AND
 DISHED AWAY.

3/4" AVE. DEPTH SHREDED
 HARDWOOD MULCH
 REMOVE POT OR OTHER
 PACKAGING MATERIALS FROM
 ROOT BALL
 BACKFILL WITH NEW TOPSOIL

SHRUB BALL
 SIZE VARIES
 3/4" BALL SIZE

REMOVE ALL STRING,
 BURLAP, OR OTHER
 ROOT BALL

BACKFILL WITH NEW TOPSOIL
 UNDISTURBED OR COMPACTED
 FILL BENEATH ROOT BALL

ROOT BALL
 PLANTING HOLE 3/4" ROOT BALL SIZE

SHEET NO. 5
 LIEN ROAD ROUNDABOUT
 LIEN ROAD BIO-RETENTION
 SECTION B-B
 MADISON WISCONSIN

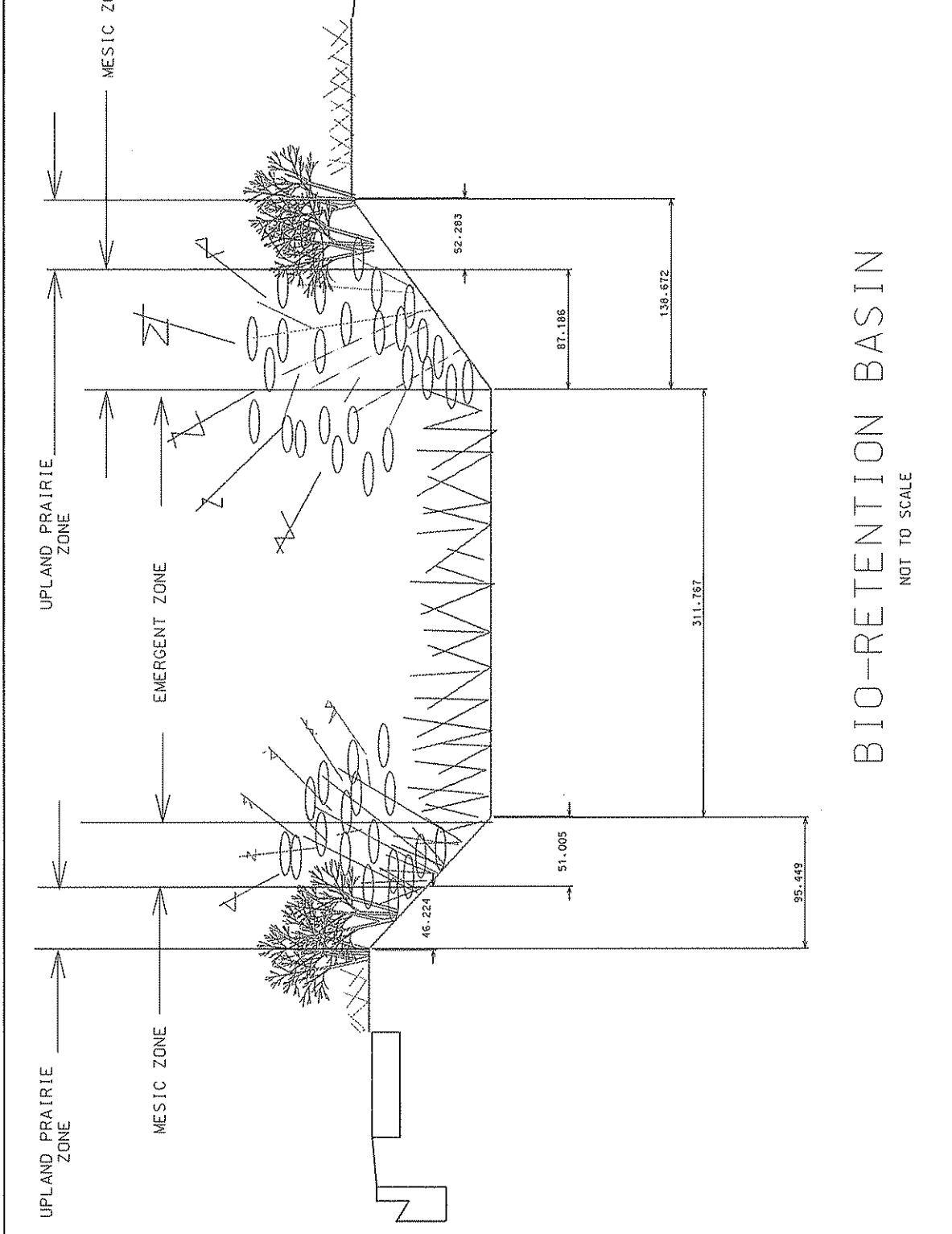

BIO-RETENTION BASIN
 NOT TO SCALE

LEVELS: 011 - 1
 01.00, 01.01, 01.02, 01.03, 01.04, 01.05, 01.06, 01.07, 01.08, 01.09, 01.10, 01.11, 01.12, 01.13, 01.14, 01.15, 01.16, 01.17, 01.18, 01.19, 01.20, 01.21, 01.22, 01.23, 01.24, 01.25, 01.26, 01.27, 01.28, 01.29, 01.30, 01.31, 01.32, 01.33, 01.34, 01.35, 01.36, 01.37, 01.38, 01.39, 01.40, 01.41, 01.42, 01.43, 01.44, 01.45, 01.46, 01.47, 01.48, 01.49, 01.50, 01.51, 01.52, 01.53, 01.54, 01.55, 01.56, 01.57, 01.58, 01.59, 01.60, 01.61, 01.62, 01.63

PLOT NAME: _____ PLOT SCALE: _____

WISDOT/CADDIS SHEET 42

PLANTING SCHEDULE - OLD MIDDLETON ROAD POND											PAGE 6
S Y M B L	PLANT NAME	Scientific Name	CALIPER, HGT, SPREAD, SIZE	PO B R D	ST T A K E	W R A P	R O D E N T P R O T E C T I O N	S P R I N G	F A L L	Q U A N T I T Y	
	Trees										
FM	Fort McNair Red Horsechestnut	Aesculusxcsmea	2" Cal	X	X	X	X	X	3		
	Deciduous Shrubs										
OV	Onondago Viburnum	Viburnum sargentii 'Onondaga'	3'-4' Ft.	X			X		48		
	Forbs										
AJS	Autumn Joy Sedum	Sedum spectabile 'Autumn Joy	1 Gal	X			X		173		
HD	Hyperion Daylilies	Hermerocallis 'Hyperion'	1 Gal	X			X		600		
BF	Blue Fescue	Festuca glauca 'Elijah Blue'	1 Gal	X			X		153		
AA	Alert New York Aster	Aster novi-belgii 'Alert'	1 Gal	X			X		111		
FG	Miniature Fountain Grass	Apennisetum alopecuroides 'Little Bunny'	1 Gal	X			X		130		
CJF	Compact Japanese Fleeceflower	Fallopia japonica var. 'Compacta'	1 Qt.	X			X		135		
	SUBTOTAL								1393		

PLANTING SCHEDULE- LIEN ROAD

S Y M B O L	PLANT NAME	Scientific Name	CALIPER, HGT., SPREAD, SIZE	B & B	P O T T E D	P O B R	S T A K E	W R A P	P R O T E C T	S P R I N G	F A L L	PAGE 7
EMERGENT PLANTS												
	Wool-grass	Scirpus cyperinus	2.5" PLUG		X					X		160
	Great Bulrush	Scirpus validus	2.5" PLUG		X					X		160
	Bebb's Sedge	Carex bebbii	2.5" PLUG		X					X		160
	Fringed Sedge	Carex crinita	2.5" PLUG		X					X		80
	Bottlebrush Sedge	Carex hystericina	2.5" PLUG		X					X		160
	Running Marsh Sedge	Carex sartwellii	2.5" PLUG		X					X		80
	Bristly Sedge	Carex Sedge	2.5" PLUG		X					X		160
	Fox Sedge	Carex stipitata	2.5" PLUG		X					X		160
	Brown Fox sedge	Carex vulpinoidea	2.5" PLUG		X					X		160
	Dudley's Rush	Juncus dudleyi	2.5" PLUG		X					X		160
	Dark Green Bulrush	Scirpus atrovirens	2.5" PLUG		X					X		160
	Marsh Milkweed	Asclepias incarnata	2.5" PLUG		X					X		160
	Spotted Joe Pye Weed	Eupatorium maculatum	2.5" PLUG		X					X		160
	Boneset	Eupatorium perfoliatum	2.5" PLUG		X					X		160
	Sneezeweed	Helenium autumnale	2.5" PLUG		X					X		160
	Wild Bergmont	Monarda fistulosa	2.5" PLUG		X					X		160
	Marsh Blazing Star	Liatris spicata	2.5" PLUG		X					X		160
	Yellow Coneflower	Rafibida pinnata	2.5" PLUG		X					X		80
	Sweet Black Eyed Susan	Rudbeckia subtomentosa	2.5" PLUG		X					X		80
	Cup Plant	Silphium perfoliatum	2.5" PLUG		X					X		160
	Prairie Dock	Silphium terebinthinaceum	2.5" PLUG		X					X		160
	Ohio Golden Rod	Solidago Ohioensis	2.5" PLUG		X					X		160
	Blue Verbain	Verbena hastata	2.5" PLUG		X					X		160
	Ironwood	Vernonia fasciculata	2.5" PLUG		X					X		160
	Culver Root	Veronicastrum virginicum	2.5" PLUG		X					X		96
SUBTOTAL												96

PLANTING SCHEDULE- LIEN ROAD

SYMBOL	PLANT NAME	Scientific Name	CALIPER, HGT, SPREAD SIZE	B & B	P O T T D	S T A K E	W R A P	P R O T E C T	S P R I N G	Page 8
	Bottle Gentian	<i>Gentiana andrewsii</i>	2.5" PLUG	X					X	64
	Golden Alexander	<i>Zizia aurea</i>	2.5" PLUG	X					X	80
	Wild Senna	<i>Cassia hercarrpa</i>	2.5" PLUG	X					X	80
	Blue Flag Iris	<i>Iris virginica</i>	2.5" PLUG	X					X	160
	Mesic Zone									
	Purple Hssop	<i>Agastache scrophulariaefolia</i>	2.5" PLUG	X					X	468
	Nodding Onion	<i>Allium cernuum</i>	2.5" PLUG	X					X	468
	Arrow-leaved Aster	<i>Aster sagittifolius</i>	2.5" PLUG	X					X	468
	Blue Wild Indigo	<i>Baptisia australis</i>	2.5" PLUG	X					X	468
	White Wild Indigo	<i>baptisia leucantha</i>	2.5" PLUG	X					X	468
	Prairie Coreopsis	<i>Coreopsis palmata</i>	2.5" PLUG	X					X	468
	Pale Purple Coneflower	<i>Echinacea pallida</i>	2.5" PLUG	X					X	468
	Woodland Sunflower	<i>Helianthus strumosus</i>	2.5" PLUG	X					X	468
	Early Sunflower	<i>Helianthus helianthoides</i>	2.5" PLUG	X					X	468
	Prairie Blazing Star	<i>Liatris pycnostachya</i>	2.5" PLUG	X					X	468
	Blackeyed Susan	<i>Rudbeckia hirta</i>	2.5" PLUG	X					X	468
	Spiderwort	<i>Tradescantia ohionis</i>	2.5" PLUG	X					X	468
	UPLAND AND PRAIRIE									
	Butterfly Weed	<i>Asclepias tuberosa</i>	2.5" PLUG	X					X	224
	Native Yarrow	<i>Achillea millefolium</i>	2.5" PLUG	X					X	224
	Silky Aster	<i>Aster sericeus</i>	2.5" PLUG	X					X	224
	Sky-blue Aster	<i>Aster azureus</i>	2.5" PLUG	X					X	224
	Health Aster	<i>Aster ericoides</i>	2.5" PLUG	X					X	224
	Smooth Blue Aster	<i>Aster laevis</i>	2.5" PLUG	X					X	224
	Shooting Star	<i>Dodecatheon meadia</i>	2.5" PLUG	X					X	224
	SUBTOTAL									7,568

PLANTING SCHEDULE- LIEN ROAD

PLANT NAME	Scientific Name	CALIPER HGT. SPREAD SIZE	P O T T E R	B & B	S T A K E	W R A P	P R O T E C T	S P R I N G	Page 9
Narrow-leaved Coneflower	Echinacea angustifolia	2.5" PLUG	X					X	224
Pale Purple Coneflower	Echinacea pallida	2.5" PLUG	X					X	224
Sand Coreopsis	Coreopsis lanceolata	2.5" PLUG	X					X	224
Flowering Spurge	Euphorbia corollata	2.5" PLUG	X					X	224
Rough Blazing Star	Liatris aspera	2.5" PLUG	X					X	224
False Boneset	Kuhnia eupatorioides	2.5" PLUG	X					X	224
Prairie Phlox	Phlox pilosa	2.5" PLUG	X					X	192
Wild Petunia	Ruellia humilis	2.5" PLUG	X					X	224
Royal Catchfly	Silene regia	2.5" PLUG	X					X	224
Prairie Cinquefoil	Potentilla arguta	2.5" PLUG	X					X	224
Stiff Goldenrod	Solidago rigida	2.5" PLUG	X					X	224
Rosin Weed	Silphium integrifolium	2.5" PLUG	X					X	224
Hoary Vervain	Verbena stricta	2.5" PLUG	X					X	224
Illinois Bundle Flower	Desmanthus illinoensis	2.5" PLUG	X					X	224
Round-headed Bush Clover	Lespedeza capitata	2.5" PLUG	X					X	224
Wild Lupine	Lupinus perennis	2.5" PLUG	X					X	224
Leadplant	Amorpha canescens	2.5" PLUG	X					X	224
Grasses									
Little Bluestem	Schizachyrium scoparium	2.5" PLUG	X					X	224
Prairie Brome	Bromus kalmii	2.5" PLUG	X					X	256
Prairie Dropseed	Sporobolus heterolepis	2.5" PLUG	X					X	224
June Grass	koeleria cristata	2.5" PLUG	X					X	224
Switch Grass	Panicum virgatum	2.5" PLUG	X					X	224
SUBTOTAL									4928
Grand Total									

