

PROJECT SCHEDULE CITY OF MADISON DEPARTMENT OF PUBLIC WORKS	PROPOSED DATE	REVISION	REVISION	PROJECT
ESTABLISH THE DISTRICT	3,13,14,15,16, 18			Contract Name: PARK PAVING-2008 Contract No.: 6160 Project No.: 53W0580 Established Cost: \$161,000.00 PROJECT/ACCOUNT NUMBERS: ALD DISTRICT 3 – CNARE <u>Dominion Park Basketball Court</u> \$5,000.00 Acct# CL60-58201-810437-00-0000000-60628N00 ALD DISTRICT 13 – KERR <u>Goodman Pk Maint Fac Resurfacing</u> \$125,000.00 Acct# CL60-58201-810403-00-0000000-60121S00 <u>Midland Park Basketball Court</u> \$1,500.00 Acct# CL60-54317-810403-00-0000000-60115N00 <u>Vilas Park Basketball Court</u> \$5,000.00 Acct# CL60-58201-810403-00-0000000-60113C00 ALD DISTRICT 14 – BRUER <u>Thut Park Basketball Court</u> \$3,500.00 Acct# CL60-58201-810437-00-0000000-60249A00 ALD DISTRICT 15— PALM <u>Eken Park Basketball Court</u> \$3,500.00 Acct# CL60-58201-810403-00-0000000-60232N00 <u>Lake Edge Park Basketball Court</u> \$3,500.00 Acct# CL60-58201-810403-00-0000000-60352N00 ALD DISCTICT 16 – COMPTON <u>Veterans Memorial Pk Basketball Court</u> \$3,500.00 Acct# CL60-58201-810437-00-0000000-60574N00 ALD DISTRICT 18 – SCHUMACHER <u>Cherokee Park Basketball Court</u> \$3,500.00 Acct# CL60-58201-810403-00-0000000-60582A00 <u>Wheeler Heights Basketball Court</u> \$3,500.00 Acct# CL60-58201-810403-00-0000000-60588N00 <u>Lakeview Heights Basketball Court</u> \$3,500.00 Acct# CL60-58201-810403-00-0000000-60490N00 Prequalification Categories: (201) (212) Project Manager: T. Maglio
NOTICE TO ALDERMAN AND FORESTER WHERE PROJECT IF PLANNED				
NOTICE OF HEARING BEFORE BOARD OF PUBLIC WORKS (PUBLISHED & MAILED)				
PARK COMMISSION				
LANDMARK COMMISSION				
APPROVAL BY BOARD OF PUBLIC WORKS ON PLANS, SPECS. & REPORT FILED WITH THE CLERK	1/09/08			
NOTICE OF HEARING BEFORE COMMON COUNCIL (PUBLISHED & MAILED)				
APPROVAL BY URBAN DESIGN COMMISSION				
APPROVAL BY COMMON COUNCIL ON PLANS & SPECS.	1/22/08			
RESOLUTION ADOPTED BY COMMON COUNCIL (MAILED)				
BOARD OF PUBLIC WORKS ADVERTIZES FOR BIDS	2/01/08 2/08/08 2/15/08			
BIDDER QUALIFICATIONS APPROVED BY BOARD OF PUBLIC WORKS				
BOARD OF PUBLIC WORKS RECEIVES BIDS	2/22/08			
AFFIRMATIVE ACTION REVIEWS BIDS	2/22/08 – 2/29/08			
BOARD OF PUBLIC WORKS OPENS BIDS	2/29/08			
BOARD OF PUBLIC WORKS APPROVES OR REJECTS BIDS	3/05/08			
COMMON COUNCIL AWARDS OR REJECTS BID	3/18/08			
START TO WORK	4/21/08			
COMPLETE WORK	11/21/08			
			COPIES TO: ALDERMANIC NOTIFICATION: Larry Nelson, Eng. 3-Cnare Kathy Rideout, Eng. 13-Kerr Marsha Hacker, Eng. 14-Bruer Peg Roessler, Eng. 15-Palm Johanna Johnson, Eng. 16-Compton Richard Grasmick 18-Schumacher Si Widstrand James Weinstock Donald Studesville Tom Maglio Bill Bauer Tom Skaife Colier McNair, A.A. Norman Davis, A.A.	

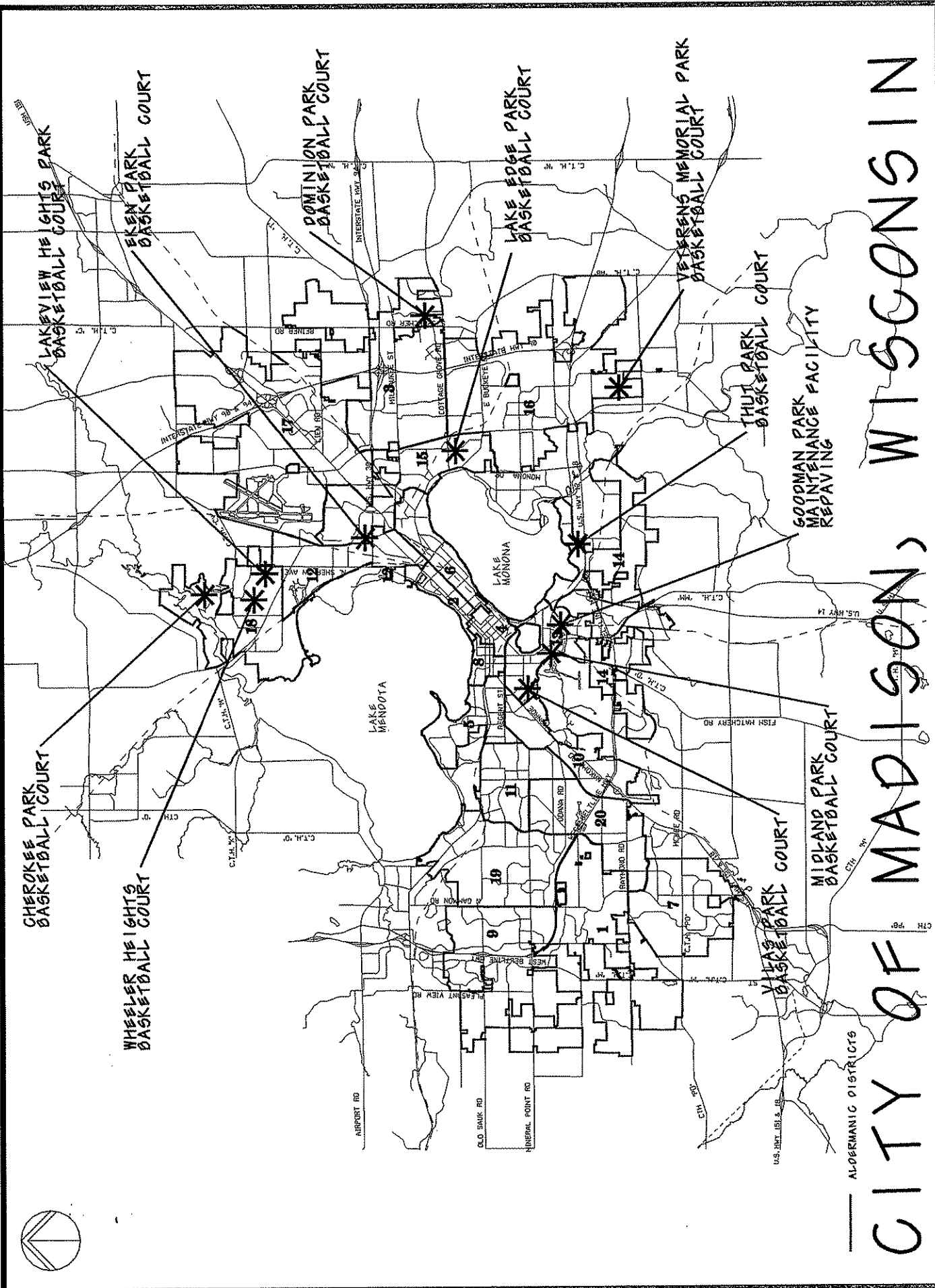

ALDERMANIC DISTRICTS

CITY OF MADISON, WISCONSIN

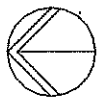
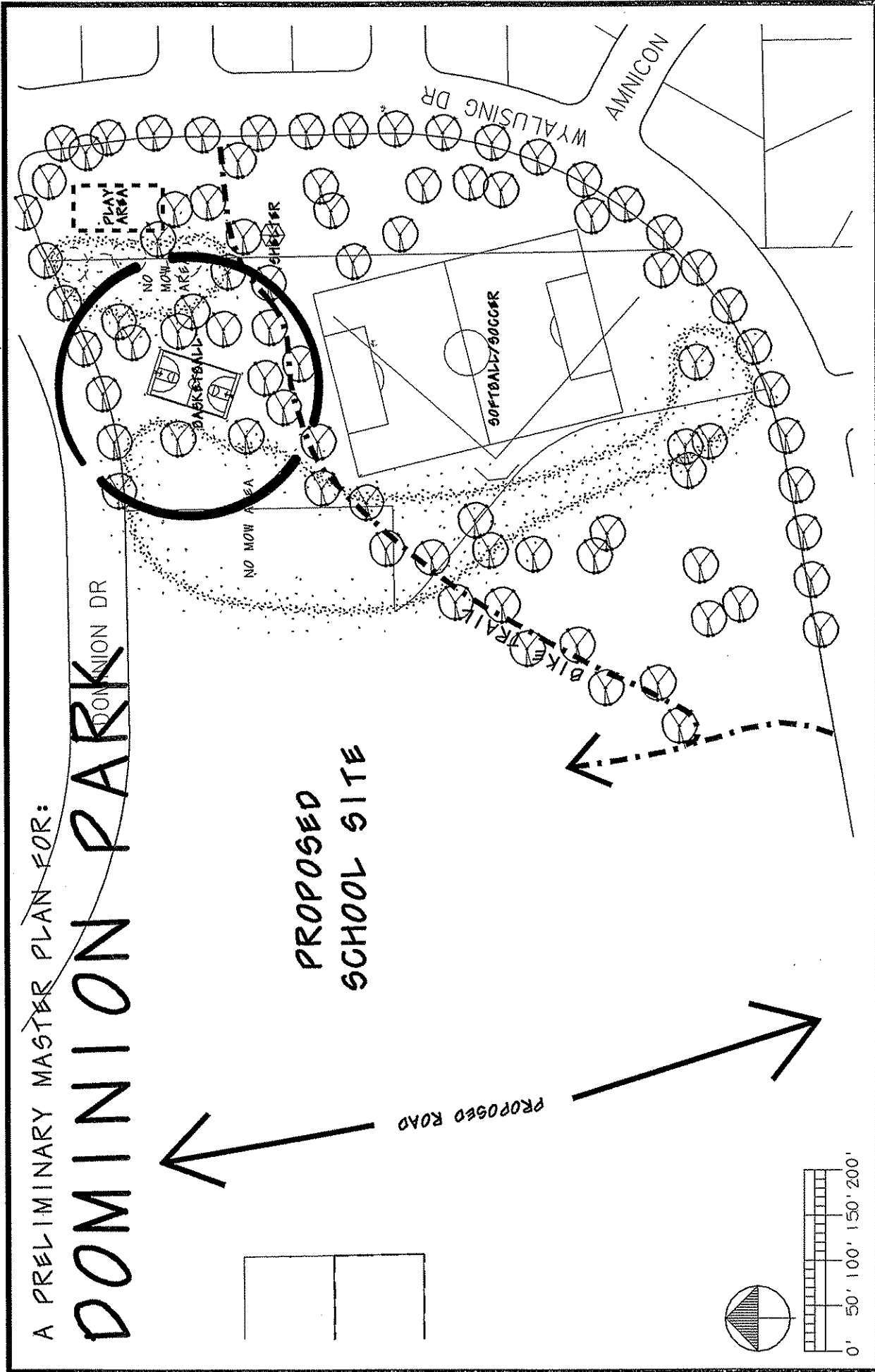

A PRELIMINARY MASTER PLAN FOR:

DOMINION PARK

DOMINION DR

PROPOSED SCHOOL SITE

PROPOSED ROAD

WYALUSING DR

AMNICON

PLAY AREA

BASKETBALL COURT

SOFTBALL/SOCCER

NO MOW AREA

BIKE TRAIL



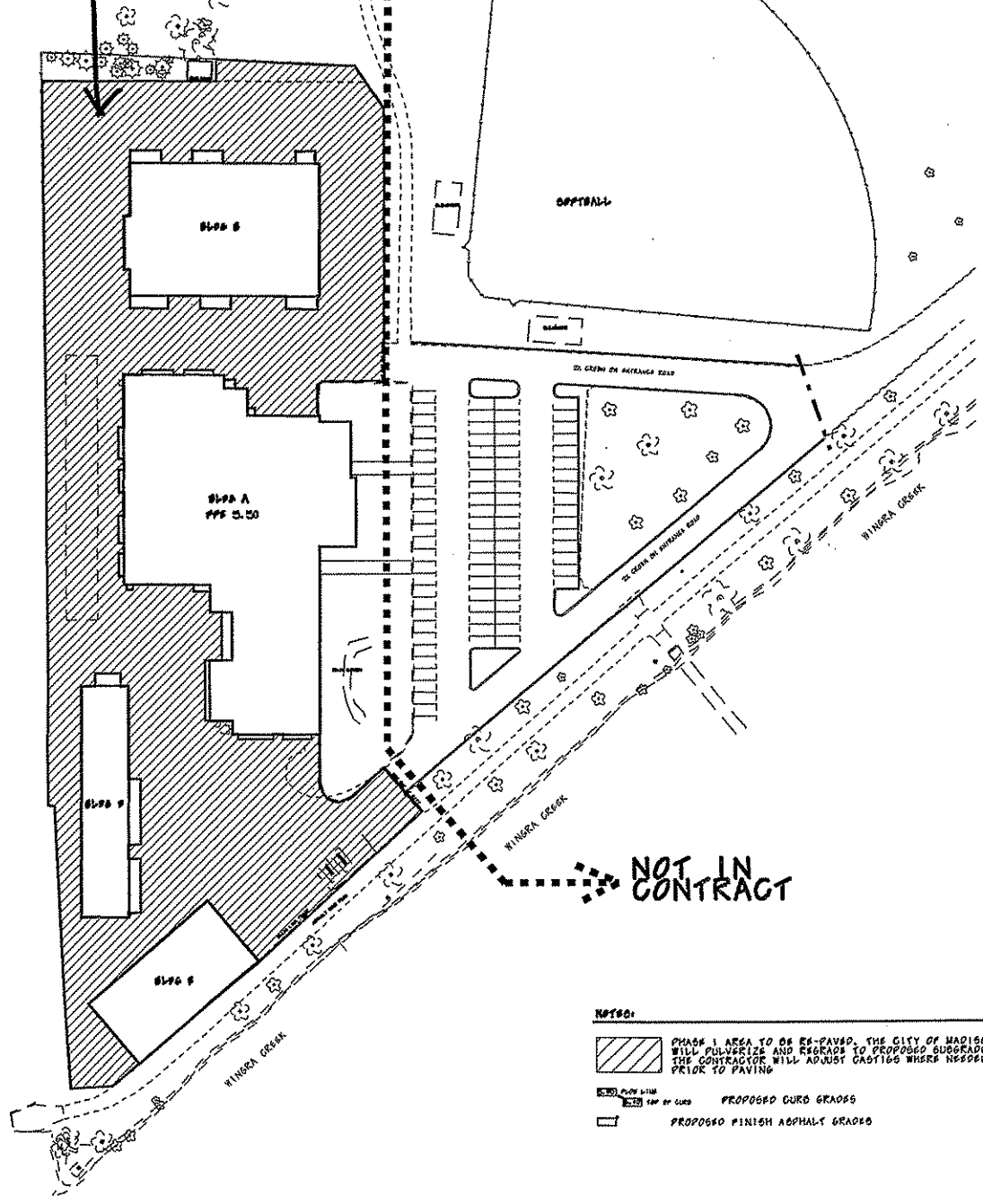

ALTERNATIVE MATERIALS
 SUBSTITUTIONS
 AUTHORIZED BY THE
 CITY ENGINEER

NOT IN CONTRACT
 AREA TO BE PAVED 99,716 #
 TYPE "C" PAVEMENT



NOTES:

 PHASE I AREA TO BE RE-PAVED. THE CITY OF MADISON WILL PULVERIZE AND REGRADE TO PROPOSED SUBGRADE. THE CONTRACTOR WILL ADJUST CASTINGS WHERE NEEDED PRIOR TO PAVING.

 PROPOSED CURB GRADES

 PROPOSED FINISH ASPHALT GRADES

**GOODMAN PARK -
 PARKS DIVISION
 MAINTENANCE FACILITY**

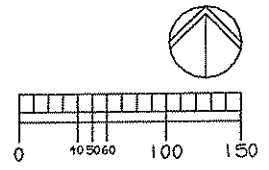

A MASTER PLAN FOR:

MIDLAND PARK



0' 50' 100' 150' 200'

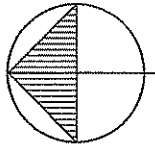

MIDLAND ST

FISH HATCHERY RD

SPRUCE ST

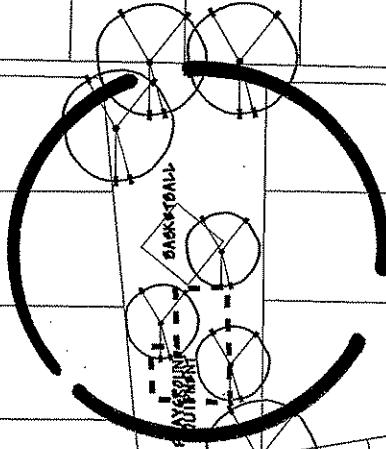

A MASTER PLAN FOR: VILAS PARK

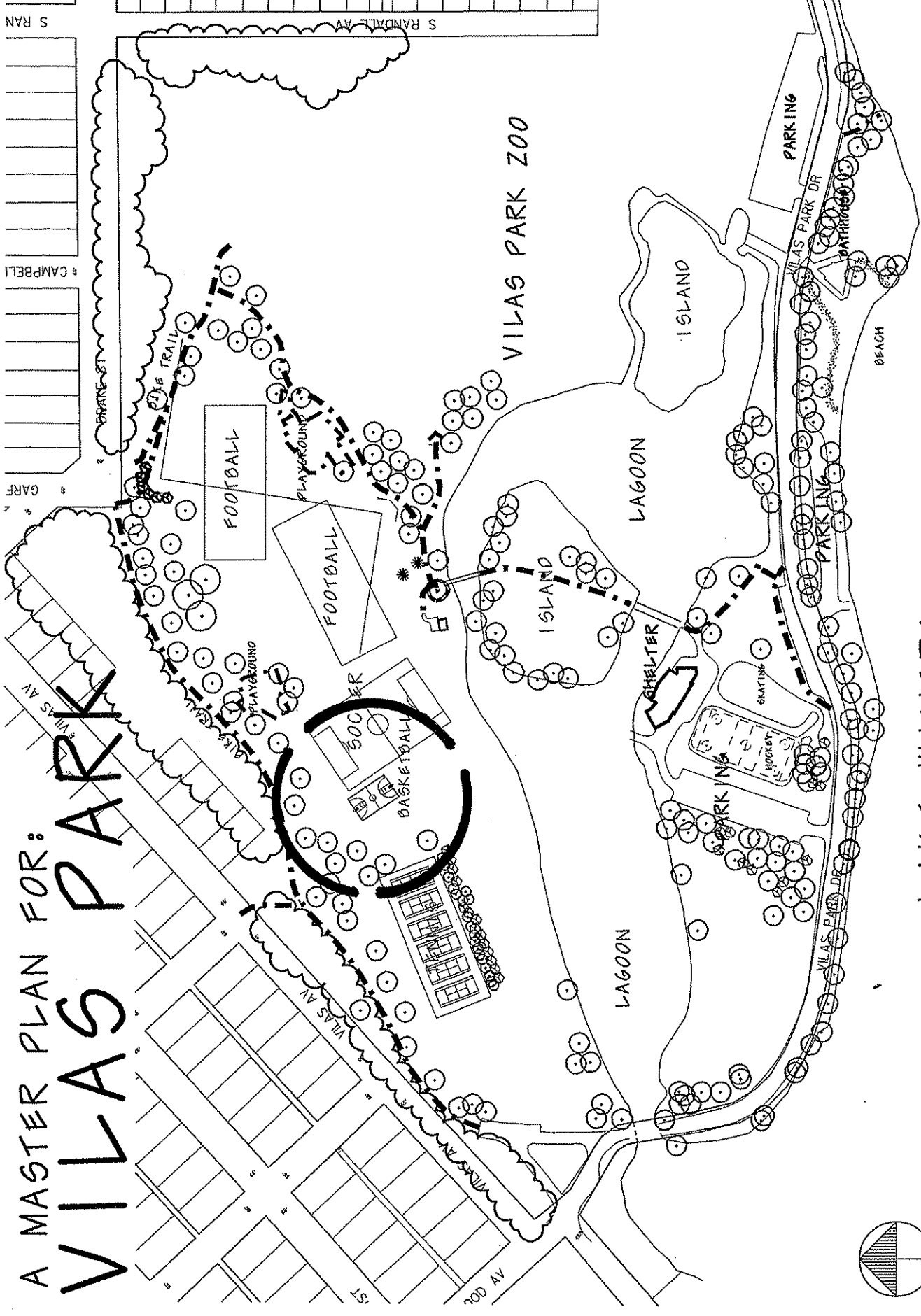

LAKE WINGRA

PRELIMINARY MASTER PLAN FOR: THUT PARK

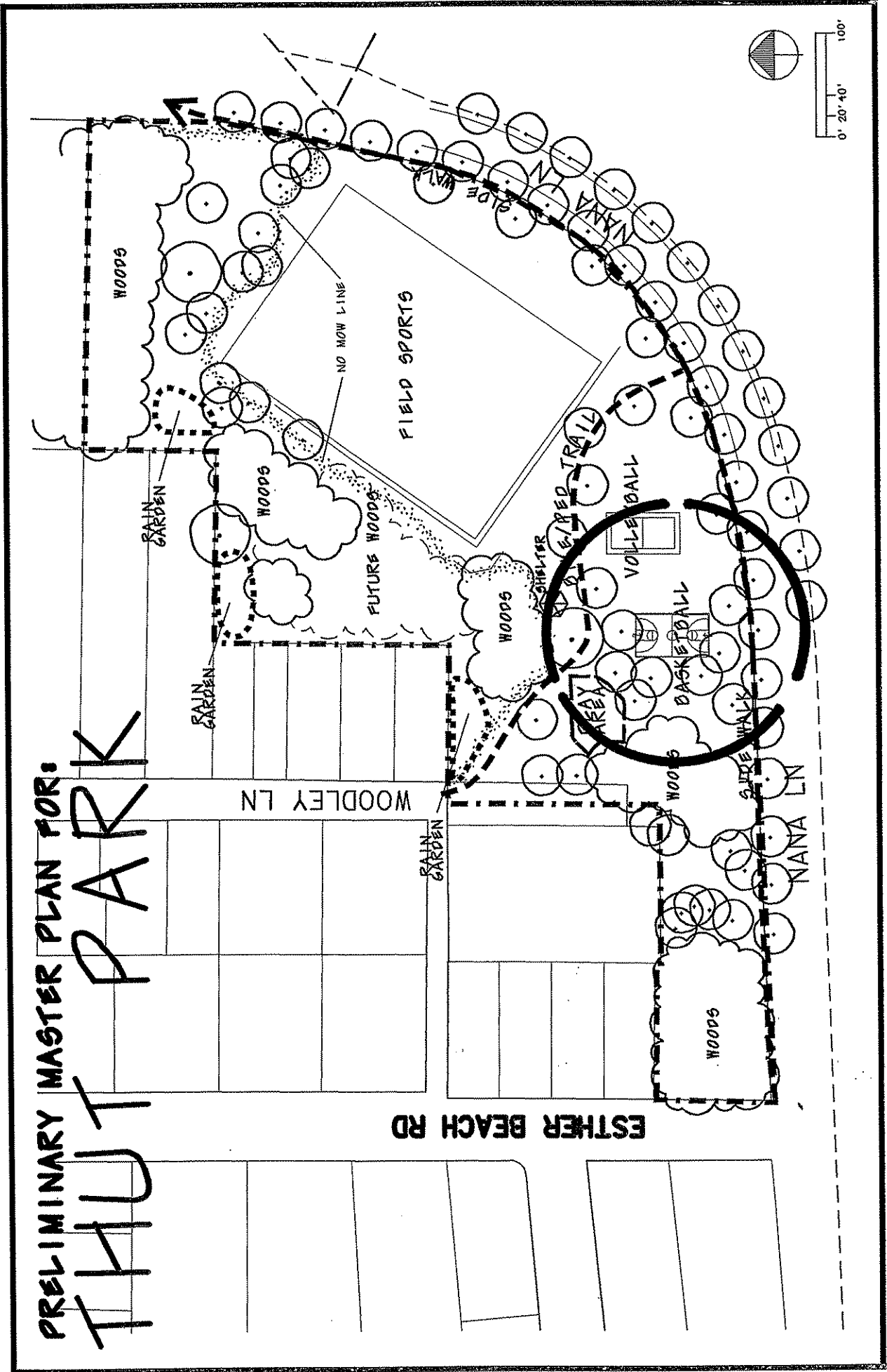

A MASTER PLAN FOR:

EKEN PARK

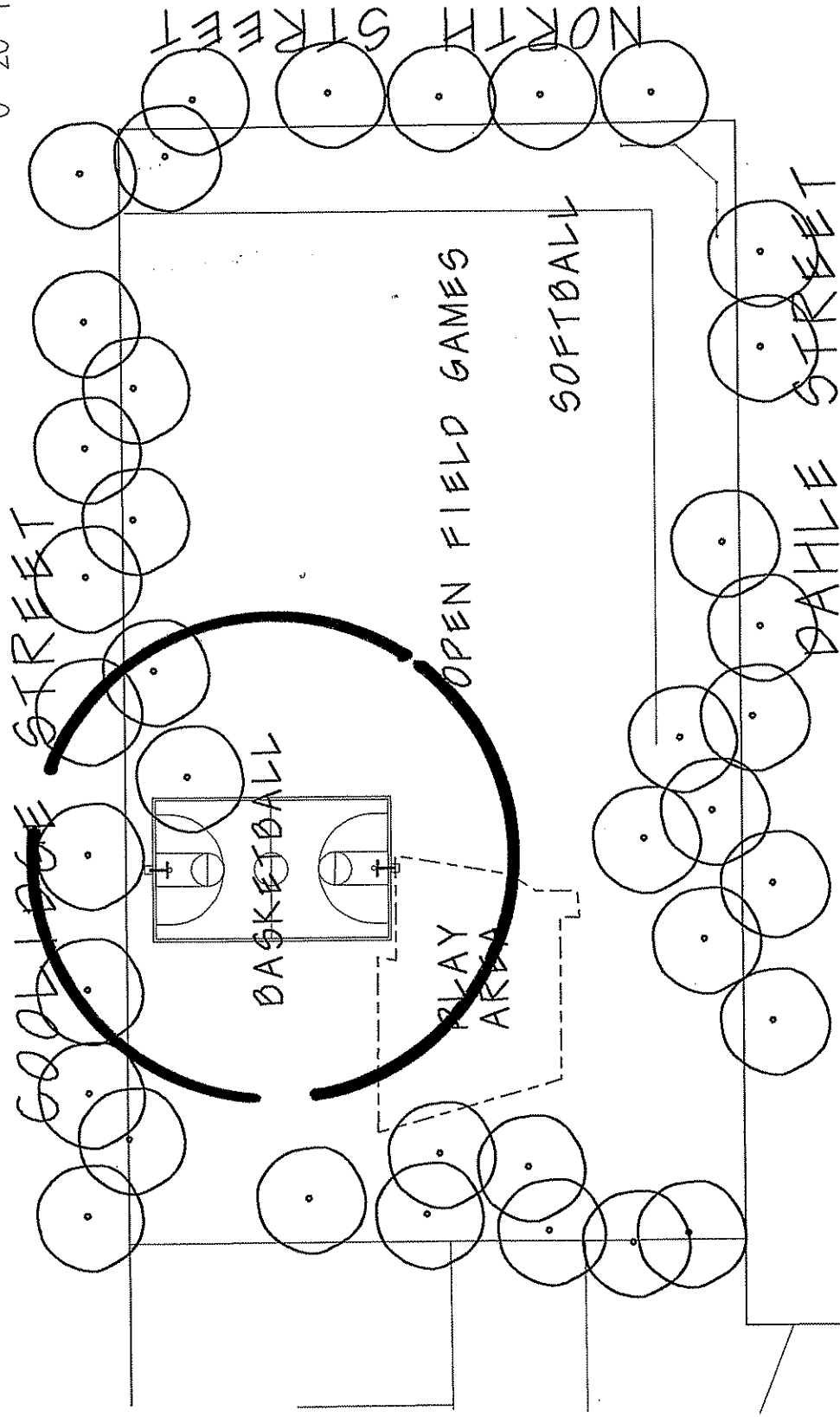
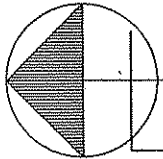

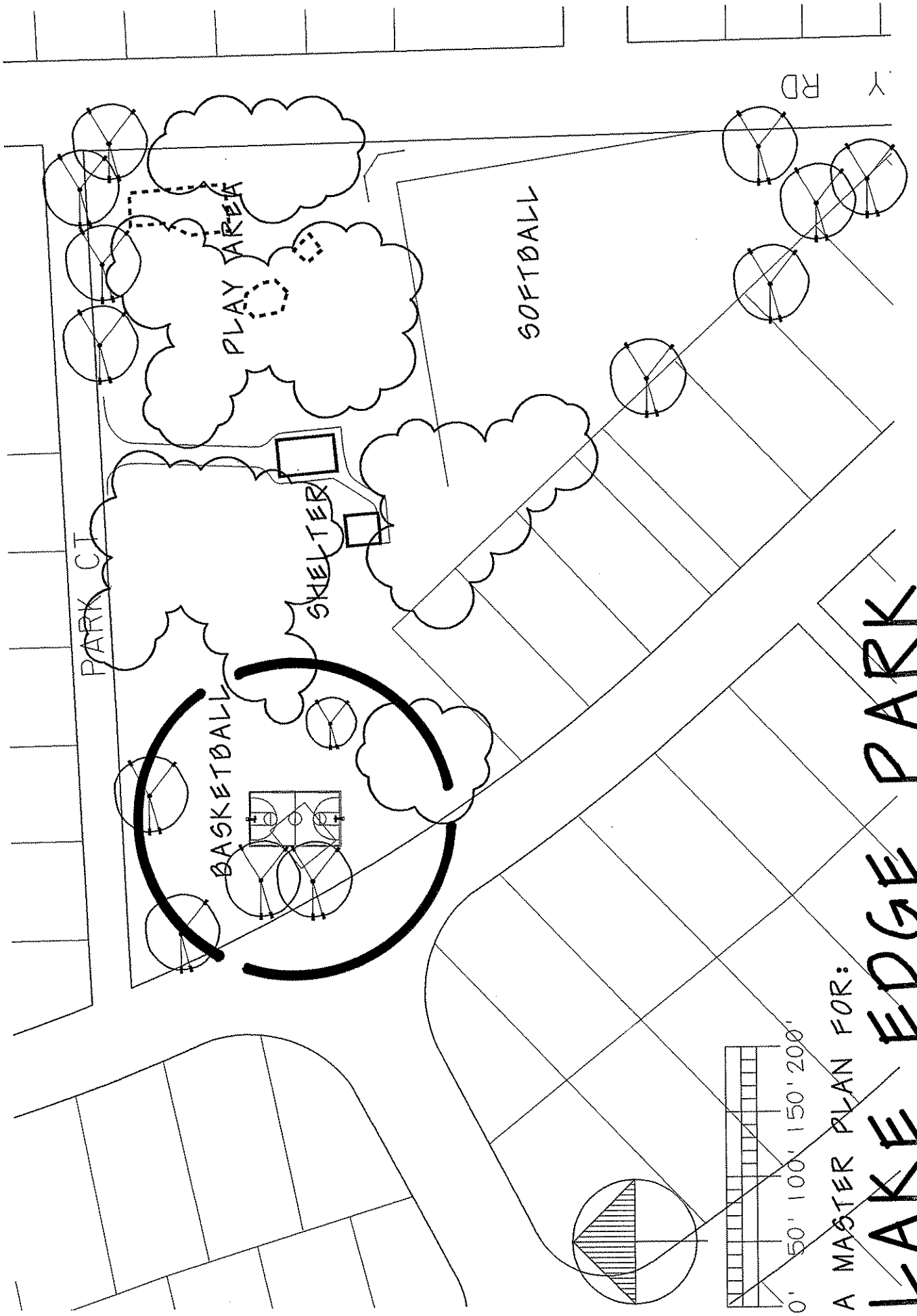

PARK CT

RD

PLAY AREA

SOFTBALL

SHELTER

BASKETBALL

A MASTER PLAN FOR:

LAKE EDGE PARK

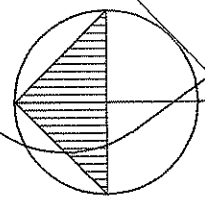
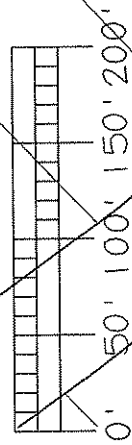

MASTER PLAN FOR: VETERANS MEMORIAL PARK

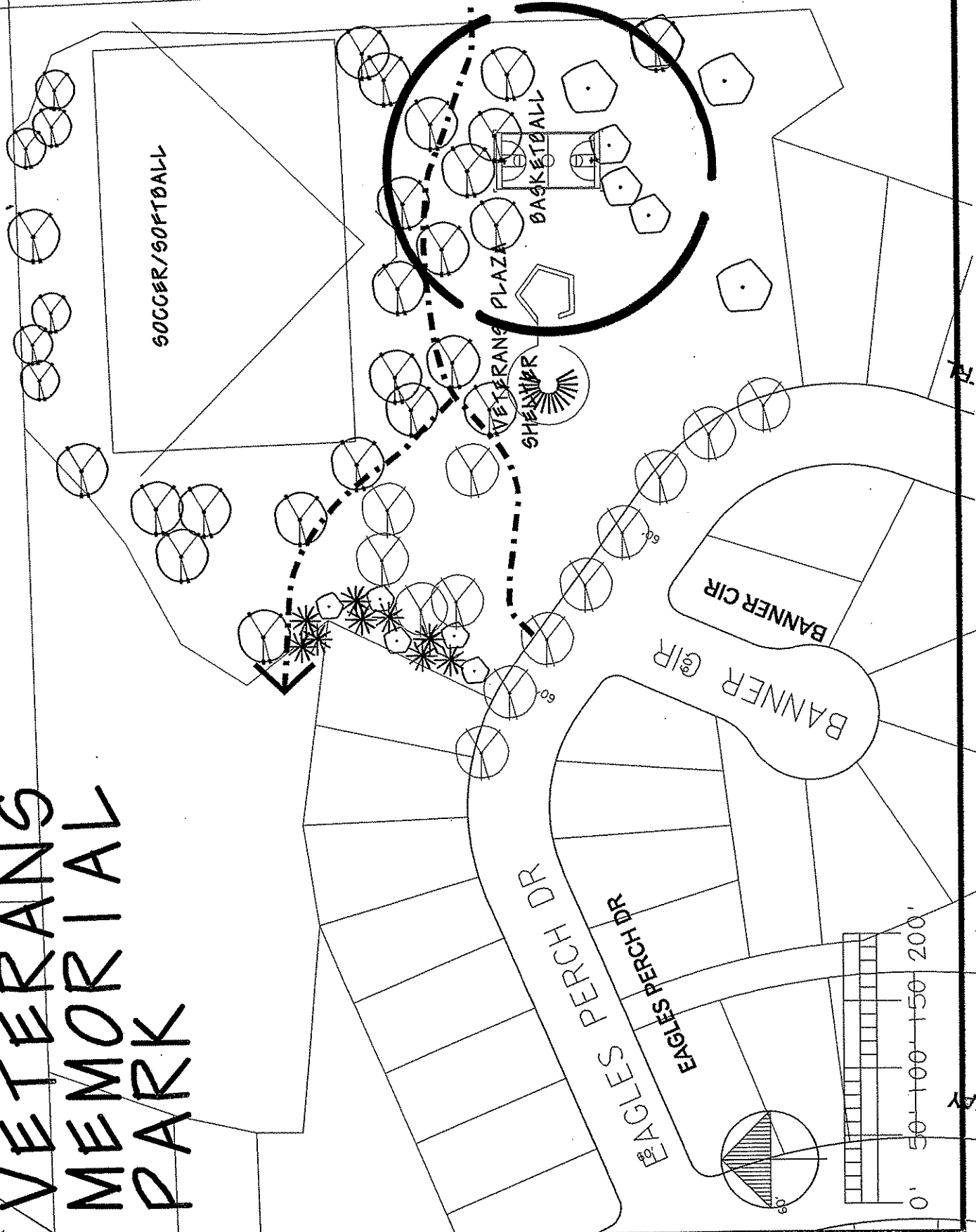

A MASTER PLAN FOR: CHEROKEE PARK

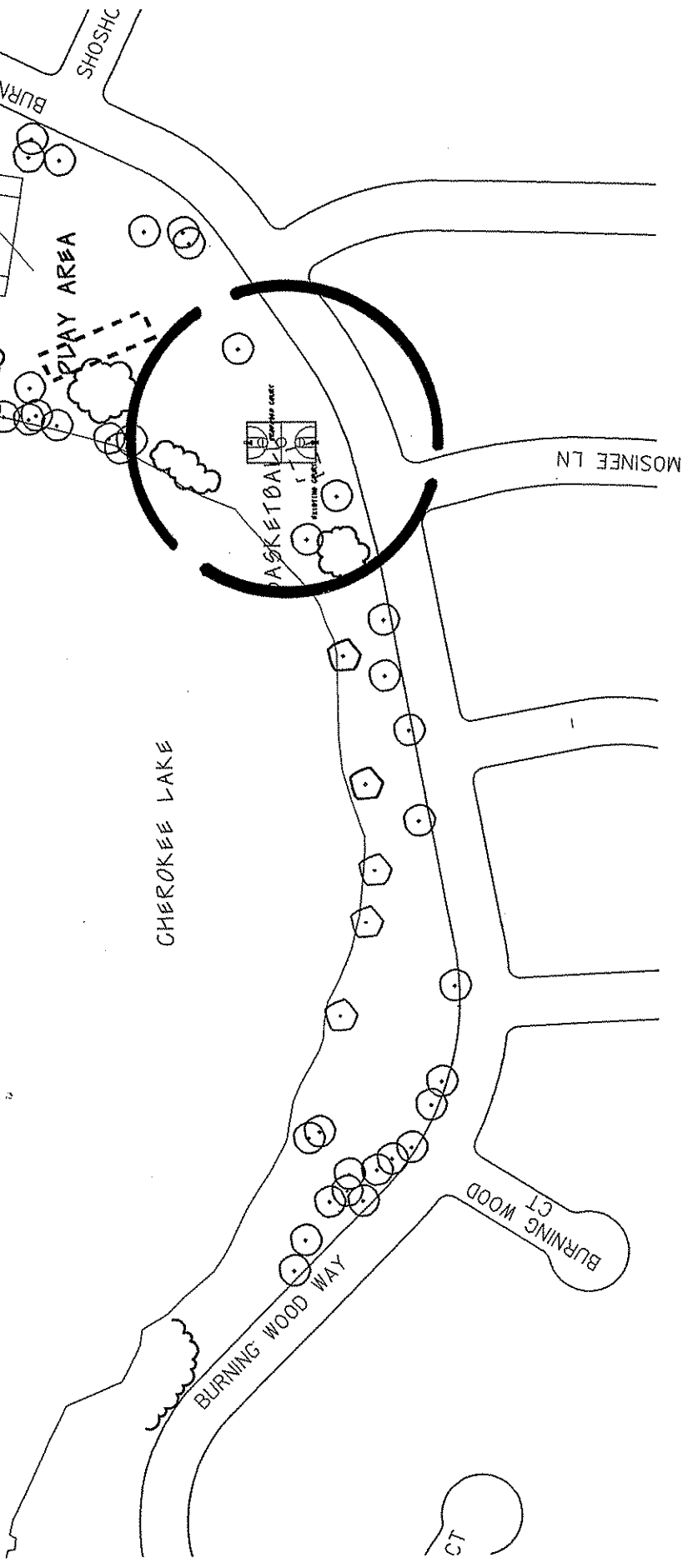
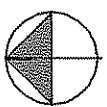
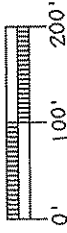

A MASTER PLAN FOR:

WHEELERS HEIGHTS NEVADA RD

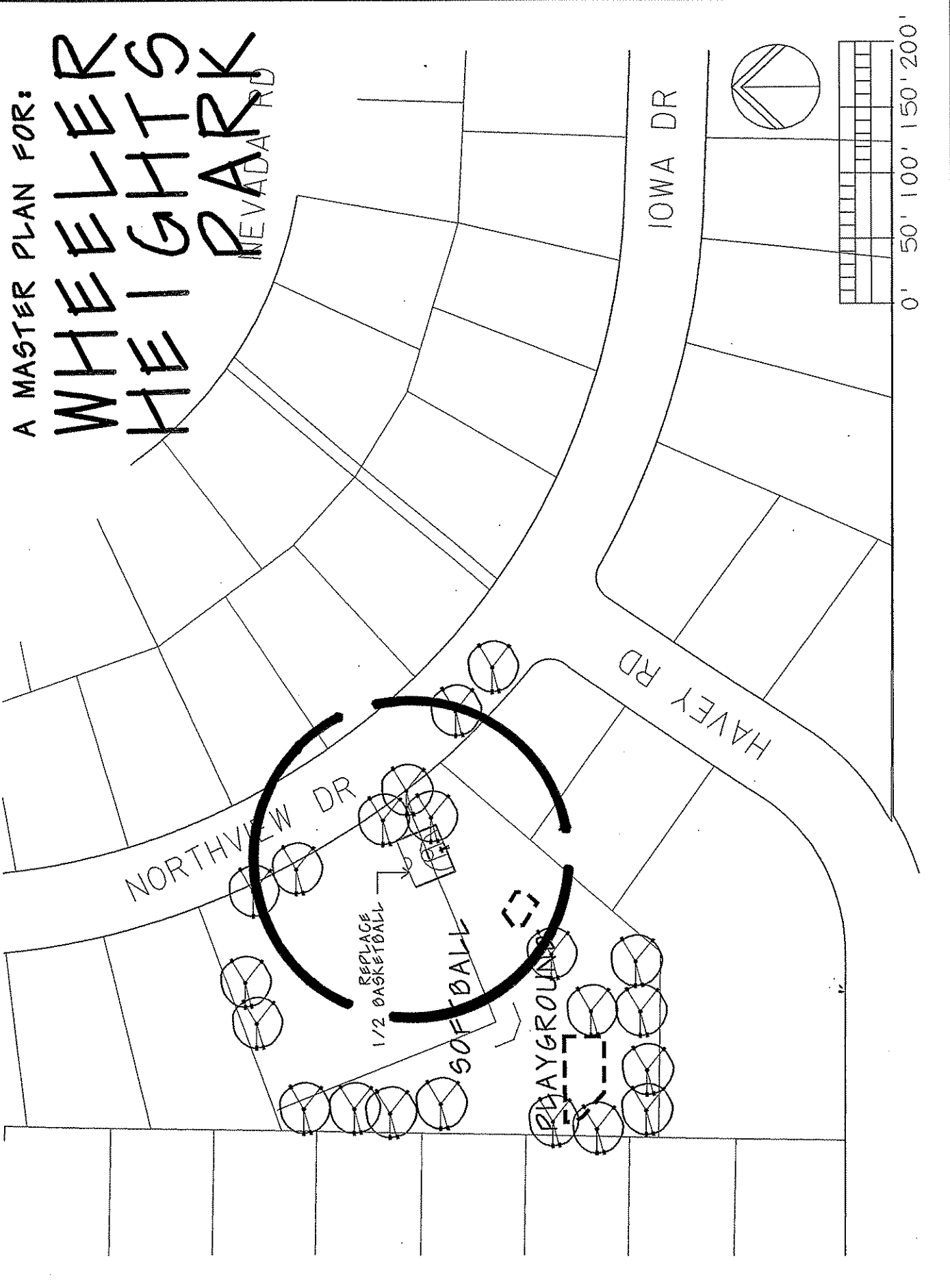

A MASTER PLAN FOR:

LAKE VIEW HEIGHTS PARK

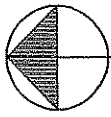
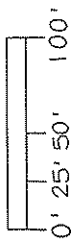

HANOVER ST

SUNFIELD ST

