

Change of Premises

48889-3235
(Number)

(scanned)

(Leg file number)

(Processing step)

City of Madison Clerk
210 MLK Jr Blvd, Room 103
Madison, WI 53703

licensing@cityofmadison.com
608-266-4601

(initials)

This application modifies existing alcohol license number: 48889-3235

- Class A Beer
- Class B Beer
- Class A Liquor
- Class B Liquor
- Class C Wine

Aldermanic District: 19 Alder Name: Mark Clear Police Sector: 100

Corporate Information

Business Legal Name: Woodman's Food Market, Inc.

Business Address: 711 S. Gammon Road

Corporate Contact Name & Position: _____

Debbie Arnold, Office Manager

Phone & Email: (608) 754-8382 debbie.arnold@woodmans-food.com

Licensed Premise Information

Business dba Name: Woodman's Food Market, Inc. #20

Licensed Address: 711 S. Gammon Road

Business Contact Name & Position: _____

Dale Martinson, Store Manager

Phone & Email: (608) 274-8944 dale.martinson@woodmans-food.com

Liquor Beer Agent Name: Dale Martinson % Alcohol: _____ % Food: _____

Current Capacity (indoor): 20,954 Square Feet Current Capacity (outdoor): _____

Proposed Capacity (indoor): 22,122 Square Feet Proposed Capacity (outdoor): _____

Description of Proposed Changes: An addillon of 1,168 square feet to the liquor store with revislons to the cash register area, security area, display area, and reconfiguration of the north and west entrances.

Detailed Floor Plans included (required)

Orange sign and "License Renewals & Changes" brochure issued

X [Signature]
Applicant signature Clinton Woodman, Vice President

Date: 4-3-14



Building Systems
General Corp.

5972 Executive Drive Suite 100
Madison, Wisconsin 53719
Phone: (608) 276-4400
Fax: (608) 276-4468

**WOODMAN'S
MARKETS**
EMPLOYEE OWNED

PROJECT NAME

WOODMAN'S
FOOD MARKET
REMODELING

725 SOUTH GAMMON ROAD
MADISON, WISCONSIN

CONSULTANTS

DRAWN: NSF
CHECKED: PAW
APPROVED: JRA

REVISION:
.....

DATE:

SCALE:

1/8" = 1'-0"

BSGC PROJECT NO.

2271E

BSGC DRAWING NO.

14-103

SHEET TITLE

EXISTING
PARTIAL
FLOOR PLAN

SHEET NO.

A1.2

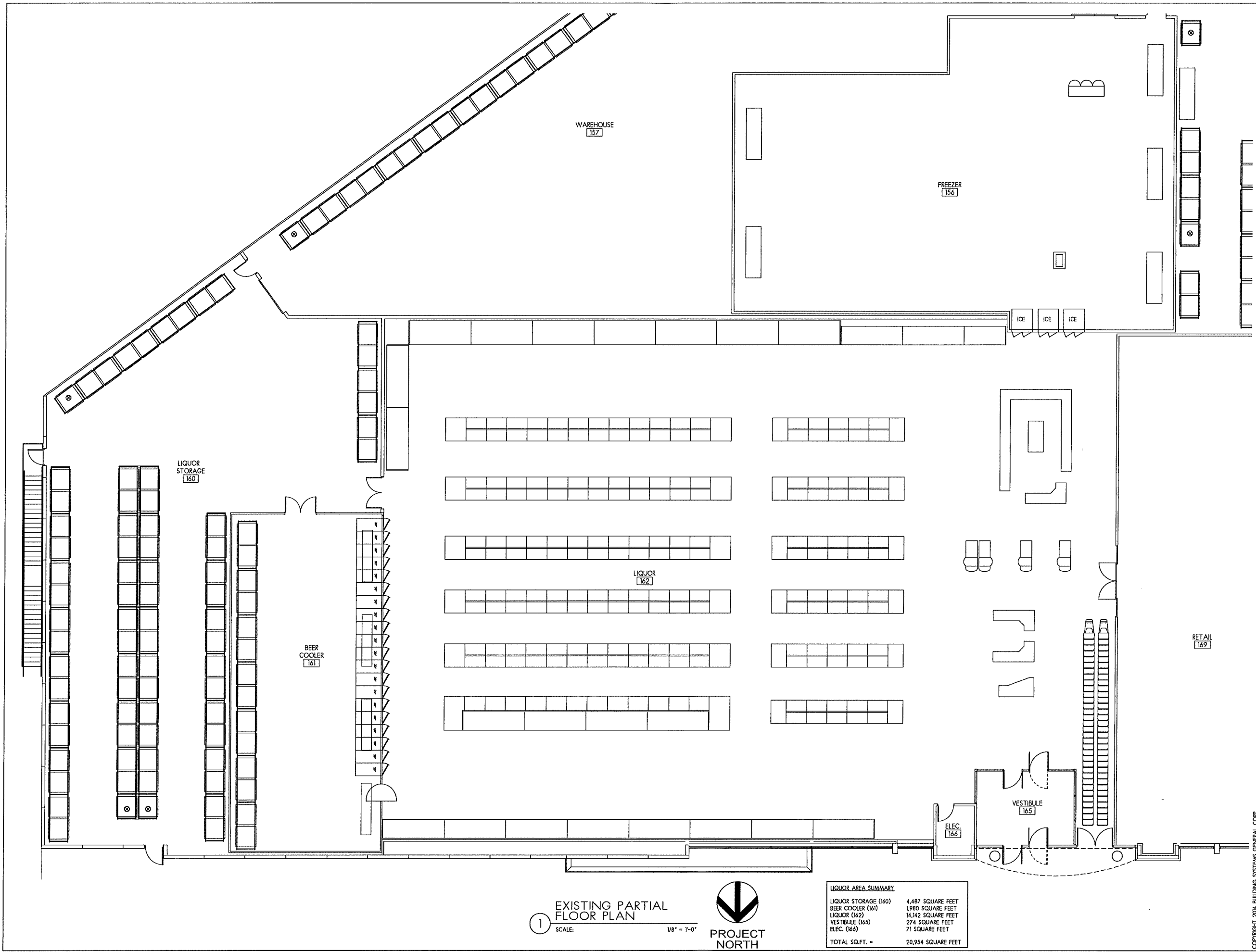

1 EXISTING PARTIAL
FLOOR PLAN
SCALE: 1/8" = 1'-0"



LIQUOR AREA SUMMARY	
LIQUOR STORAGE (160)	4,487 SQUARE FEET
BEER COOLER (161)	1,980 SQUARE FEET
LIQUOR (162)	14,142 SQUARE FEET
VESTIBULE (165)	274 SQUARE FEET
ELEC. (166)	71 SQUARE FEET
TOTAL SQ.FT. =	20,954 SQUARE FEET

COPYRIGHT 2014 BUILDING SYSTEMS GENERAL CORP.

