

#17561

Roundabout Installation Costs for the County Trunk M-Pleasant View Road-Valley View Road and the Pleasant View Road-Mineral Point Road Roundabout Assessment District	
Total Cost to install the Two Roundabouts:	\$885,349.80
Public Funding Provided toward Cost of the Roundabouts	\$461,797.29
Funding for these roundabouts provided from the Midtown Rd./ CTH M Areawide Traffic Signal & Intersection Improvements Assessment District & Transportation Improvement Impact Fee Zone	\$72,000.00
Remaining roundabout installation costs divided among assessment district properties	\$351,552.51

Exhibit C



City of Madison

Legislative File Number 17561 (version 1)

Title

Approving Schedule Of Assessments for the Installation of Roundabouts at the County Trunk M-Pleasant View Road-Valley View Road: and the Pleasant View Road-Mineral Point Road Traffic Roundabout Assessment Districts.

Body

WHEREAS, the Common Council of the City of Madison adopted a preliminary resolution, declaring its intention to exercise police powers and special assess costs for installation of roundabouts at the County Trunk M-Pleasant View Road-Valley View Road and the Pleasant View Road-Mineral Point Road intersections and all other statutory requirements, pursuant to sec. 66.0703(4), Wis. Stats ; and

WHEREAS, the Board of Public Works having reported on all the proceedings in relation to the installation of roundabouts at the County Trunk M-Pleasant View Road-Valley View Road and the Pleasant View Road-Mineral Point Road intersections in accordance with section 66.0701 of the Wisconsin Statutes and having in all things duly conformed to the order of the Common Council in relation thereto, and the provisions of the Madison General Ordinances and the Wisconsin Statutes in such case made and provided, and the Common Council being fully advised;

NOW, THEREFORE, BE IT RESOLVED:

1. That the City at large is justly chargeable with and shall pay the sum of \$4,229.10 of the entire cost of the said improvement, and that the sum assigned to each separate parcel (Exhibit A), as indicated on the attached schedule of assessment (Exhibit B), is hereby assessed upon each parcel.
2. That the Common Council determines such special assessment to be reasonable.
3. That the work or improvement shall be carried out in accordance with the plans and specifications as finally approved.
4. That such work or improvement represents an exercise of the police power of the City of Madison.
5. That after the roundabouts are installed, the Traffic Engineer shall prepare a revised assessment and bill the revised amount to each and every property owner. The property owner may elect to pay the assessment prior to October 31, 2011, or pay the assessment when the property tax bill becomes due.
6. That the due date by which all such special assessments shall be paid in full is October 31st of the year in which it is billed, or,
7. That such special assessments shall be collected in eight (8) equal installments, with interest thereon at 3.5 percent per annum, except those special

assessments paid in full on or before October 31st of that year.

INSTALLMENT ASSESSMENT NOTICE

Notice is hereby given that work is being scheduled for the project listed above and that the amount of the special assessment therefore has been determined as to each parcel of real estate affected thereby and a statement of the same is on file with the City Clerk; it is proposed to collect the same in eight (8) installments, as provided for by Section 66.0715 of the Wisconsin Statutes, with interest thereon at 3.5 percent per annum; that all assessments will be collected in installments as above provided except such assessments on property where the owner of the same has paid the assessment to the City Treasurer on or before the next succeeding November 1st.

NOTICE OF APPEAL RIGHTS

"Pursuant to Sec.4.09(14), Madison General Ordinances, as authorized by Sec. 66.0701(2), Wisconsin Statutes, any person against whose land a special assessment has been levied by this resolution has the right to appeal therefrom in the manner prescribed in Sec. 66.0703(12), Wisconsin Statutes, within forty (40) days of the day of the final determination of the Common Council, said date being the date of adoption of this resolution."

Fiscal Note

Funds for this project were approved under a prior resolution (Legistar File No. 15816).



City of Madison

Legislative File ID 16961

display
original
version

print

email

Type: Resolution Status: Passed

Enactment Date: 1/20/2010 Enactment No.: RES-10-00071

Title: Declaring the City of Madison's intention to exercise its police powers establishing the following two Traffic Roundabout Assessment Districts: Pleasant View Road & Mineral Point Road, and County Trunk M-Pleasant View Road-Valley View Road Traffic Roundabout Assessment Districts. (9th AD)

Controlling Body: BOARD OF PUBLIC WORKS

Introduced: 12/28/2009 Version: 1

Final Action: 1/19/2010 Contact: mhacker@cityofmadison.com

Name: Declaring the City of Madison's intention to exercise its police powers establishing the following two Traffic Roundabout Assessment Districts: Pleasant View Road & Mineral Point Road, and County Trunk M-Pleasant View Road-Valley View Road Traffic Roundab

Extra Date 1:

Requester: BOARD OF PUBLIC WORKS

Sponsors: BOARD OF PUBLIC WORKS

Attachments: Legislative File Text

Legislative History

Date	Acting Body	Action Taken	Motion
1/8/2010	BOARD OF PUBLIC WORKS	A motion was made by Rewey, seconded by Hewitt, to RECOMMEND TO COUNCIL TO ADOPT - REPORT OF OFFICER The motion passed by voice vote/other	Pass
1/19/2010	Notes: COMMON COUNCIL	A motion was made by Ald. Bruer, seconded by Ald. Clear to Adopt The motion passed by voice vote/other	Pass
	Notes:		

Approvals

Approver	Date	Approval Status
Craig Franklin	1/12/2010	Approved

powered by Daystar Computer Systems, Inc.



City of Madison

Legislative File Number 16961 (version 1)

Title

Declaring the City of Madison's intention to exercise its police powers establishing the following two Traffic Roundabout Assessment Districts: Pleasant View Road & Mineral Point Road, and County Trunk M-Pleasant View Road-Valley View Road Traffic Roundabout Assessment Districts. (9th AD)

Body

BE IT HEREBY RESOLVED:

1. That the Common Council of the City of Madison hereby establishes assessment districts known as the: Pleasant View Road & Mineral Point Road; and County Trunk M-Pleasant View Road-Valley View Road Traffic Roundabout Assessment Districts all in accordance with Section 66.0701 (formerly Section 66.62) of the Wisconsin State Statutes and Section 4.09 of the Madison General Ordinances.
2. That the contemplated purposes of these assessment district is to install/construct traffic roundabout improvements at the intersections of Pleasant View Road & Mineral Point Road, and County Trunk M-Pleasant View Road-Valley View Road.
3. That the benefitted properties shall have the opportunity to pay the special assessments which may be levied as a result of this assessment district in eight (8) annual installments, subject to the current interest rate in effect at the time of establishment of the special assessment.
4. That the City Engineer is hereby directed to prepare a report consisting of preliminary or final plans and specifications; an estimate of the entire cost of the proposed work or improvements within the assessment district; a schedule of proposed assessments, constituting an exercise of police power of the City of Madison; and a statement that the property against which the assessments are proposed is benefitted.
5. That upon completion of this aforesaid report, the City Engineer shall proceed in accordance with Section 4.09 of the Madison General Ordinances.

Fiscal Note

No Funds Required.



Traffic Engineering and Parking Divisions

David C. Dryer, P.E., City Traffic Engineer and Parking Manager

Madison Municipal Building, Suite 100
215 Martin Luther King, Jr. Boulevard
P.O. Box 2986
Madison, Wisconsin 53701-2986
PH 608 266 4761
TTY/Textnet 866 704 2315
FAX 608 267 1158

March 2, 2010

TO: Property owners within the County Trunk M-Pleasant View Road-Valley View Road and the Pleasant View Road-Mineral Point Road Roundabout Assessment District

In the next month, the Board of Public Works and the Madison Common Council will consider plans and assessment schedules to fund new roundabouts at the County Trunk M-Pleasant View Road-Valley View Road intersection and the Pleasant View Road-Mineral Point Road intersection. The estimated cost to install the roundabouts, after discounting the applied federal funding, is \$442,674.90.

The Common Council directed City staff to develop an assessment district such that the roundabout cost would be shared by the benefited area property owners. The estimated roundabout assessments were apportioned among all parcels within the assessment district based on estimated trips generated by each parcel using Institute of Transportation Engineers Trip Generation Handbook to calculate trips.

The "Midtown Road/County Trunk M Areawide Traffic Signals & Intersection Improvement Assessment District & Transportation Improvement Impact Fee Zone" has previously collected funds from property owners south of Valley View Road which will be used to partially pay for these roundabout improvements.

Assessments – General

A special assessment is a special charge for work that the City is planning to complete. The attached schedule of assessments shows an estimate of the property owners' share of the project based upon the City's assessment policy. When the project is bid, and work is complete, a final assessment will be calculated based on work actually performed. The final assessment is payable in one lump sum or over a period of 8 years, with 3.5% interest charged on the unpaid balance.

Payments assessed to residents of the Town of Middleton, will be deferred and interest shall not accrue thereon until the parcel is annexed to the City of Madison as stated in the Final City of Madison and Town of Middleton Cooperative Plan Under Section 66.0307, Wisconsin Statutes, Dated September 29, 2003 (see attached section 14 pages 17-18). However, the amount of each assessment shall be adjusted from the date of levy to the date of attachment based upon the Engineering News Record Construction Cost Index, or such equivalent index as may be available at the time. Construction Cost Index, or such equivalent index as may be available at the time.

If you need additional information or have questions on this project, please contact me at bsmith@cityofmadison.com or at 261-9625.

Sincerely,

A handwritten signature in black ink, appearing to read "Brian J. Smith". The signature is fluid and cursive, with the first name "Brian" and last name "Smith" clearly distinguishable.

Brian J. Smith, P.E.
Traffic Engineer III

cc: Ald Skidmore, District 9, City Clerk, City Engineering

**NOTICE OF PUBLIC HEARING BEFORE THE COMMON COUNCIL
FOR
PLANS, SPECIFICATIONS, AND SPECIAL ASSESSMENTS
FOR PUBLIC WORKS IMPROVEMENTS**

MADISON, WISCONSIN

PART I

Notice is hereby given that the reports of the Board of Public Works and the City Engineer of the City of Madison, Wisconsin, on the plans, specifications, and special assessment of benefits accruing to the various lots and parcels of land affected by the proposed improvements, as listed in Part II hereof, in the City of Madison, have been filed in the office of the City Clerk, in the City-County Building, Madison, Wisconsin, and that said reports will be presented to the Common Council (Room 201), City-County Building, at a regular meeting to be held **MARCH 16, 2010 at 6:30 P.M.**, in the Council Chambers and that the Common Council will then and there consider said reports and will hold a public hearing to hear all persons interested, or their agents or attorneys, concerning matters contained in said reports, and will determine what portion, if any, of the cost of said improvement shall be paid by the City at large, and other action as the Common Council may deem proper. **(YOU MUST REGISTER WITH THE COUNCIL'S SECRETARY BEFORE YOUR ITEM IS CONSIDERED BY THE COUNCIL).**

Notice is hereby given that a contract has been (or is about to be) let for below listed project(s) and that the amount of the special assessment therefore has been determined as to each parcel of real estate affected thereby and a statement of the same is on file with the City Clerk; it is proposed to collect the same in eight (8) installments or fifteen (15), as provided for by Section 66.0715 of the Wisconsin Statutes, with interest thereon at 3.5% percent per annum; that all assessments will be collected in installments as above provided except such assessments on property where the owner of the same has paid the assessment to the City Treasurer on or before the next succeeding November 1st.

If you require an interpreter, materials in alternate formats, or other accommodations to access this public hearing, please contact the Engineering Division at phone (608) 266-4751 or (866) 704-2315. Please make contact at least twenty-four (24) hours prior to the date of this public hearing so that we can make proper accommodations.

PART II

UNIVERSITY AVENUE & CAMPUS DRIVE INTERSECTION RECONSTRUCTION ASSESSMENT DISTRICT - 2010

COUNTY TRUNK M - PLEASANT VIEW ROAD - VALLEY VIEW ROAD TRAFFIC ROUNDABOUT ASSESSMENT DISTRICT

PLEASANT VIEW ROAD & MINERAL POINT ROAD TRAFFIC ROUNDABOUT ASSESSMENT DISTRICT

COMMERCIAL AVENUE, KEDZIE STREET, PAWLING STREET, SCOFIELD STREET AND EIGHTH STREET RECONSTRUCTION ASSESSMENT DISTRICT - 2010

COUNTY TRUNK HIGHWAY M, PRAIRIE HILL ROAD, VALLEY VIEW ROAD, PLEASANT VIEW ROAD & MINERAL POINT ROAD RECONSTRUCTION ASSESSMENT DISTRICT-2010

BY: 
MariBeth Witzel-Behl, City Clerk

PUB: WSJ MARCH 5, 2010

CITY OF MADISON, WISCONSIN

REPORT OF: City Traffic Engineer**Presented** March 16, 2010**Referred**

For Approving Plans and Specifications and
Assessing Improvement Cost for The Installation
of Roundabouts in

Reported Back**Adopt**

**County Trunk M-Pleasant View Road-Valley View
Road and the Pleasant View Road-Mineral Point Road
Roundabout Assessment Districts**

Rules Suspended

Filed in the Office of the City Traffic Engineer

Re-Referred**Placed on File**March 2, 2010**Placed on File****I.D. NUMBER**Filed in the City Clerk's Office: March 2, 2010**Date Council Action Required:** March 16, 2010**TO THE MAYOR AND COMMON COUNCIL:**

The Common Council having ordained that the full cost, including inspection and supervision, of the initial installation of roundabouts shall be assessed to the benefited properties and that assessment for roundabouts shall be in accordance with Section 66.0701 of the Wisconsin Statutes, has directed that when the City Traffic Engineer proposes the installation of roundabouts assessed to the benefited properties, he shall prepare a report listing roundabouts to be installed and schedule of assessments.

Now, therefore, in compliance with said instruction, the City Traffic Engineer reports as follows:

1. That roundabouts are proposed to be installed and assessed to benefiting properties listed on Exhibits A and B attached hereto, said listing including the locations of roundabouts to be installed, and a schedule of assessments.
2. That pursuant to such listing, the entire cost of the roundabout installation improvement, less applied federal funding, will be \$ 442,674.90.
3. After having carefully viewed and examined the entire territory and the said several parcels of land or real estate affected by said improvement, and having first viewed, examined and considered severally and separately each parcel of real estate in said territory, the City Traffic Engineer has found and determined and do hereby so find and determine that the City of Madison should pay the sum of \$ 4,229.10 as the cost properly chargeable to the City and covered by said improvement.

DATED: March 2nd, 2010David C. Dryer, P.E.

City Traffic Engineer

CTH "M"-PLEASANT VIEW RD-VALLEY VIEW RD
AND PLEASANT VIEW RD-MINERAL POINT RD
ROUNDBOUT ASSESSMENT DISTRICT

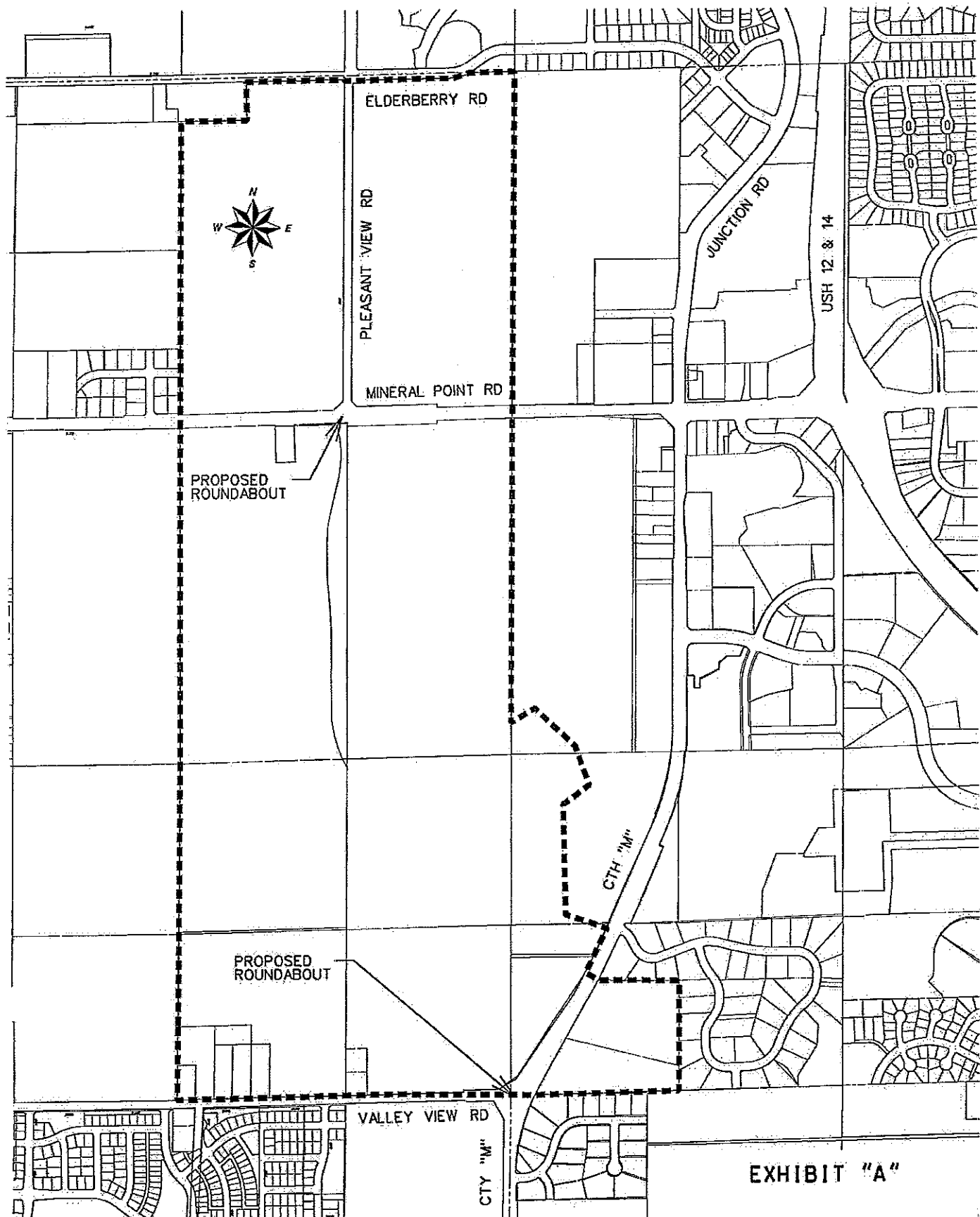

EXHIBIT "A"

Mean approx. value



Junction Neighborhood Development Plan

As Adopted September 1990, Amended July 1992
and *implemented through subdivision and zoning approvals

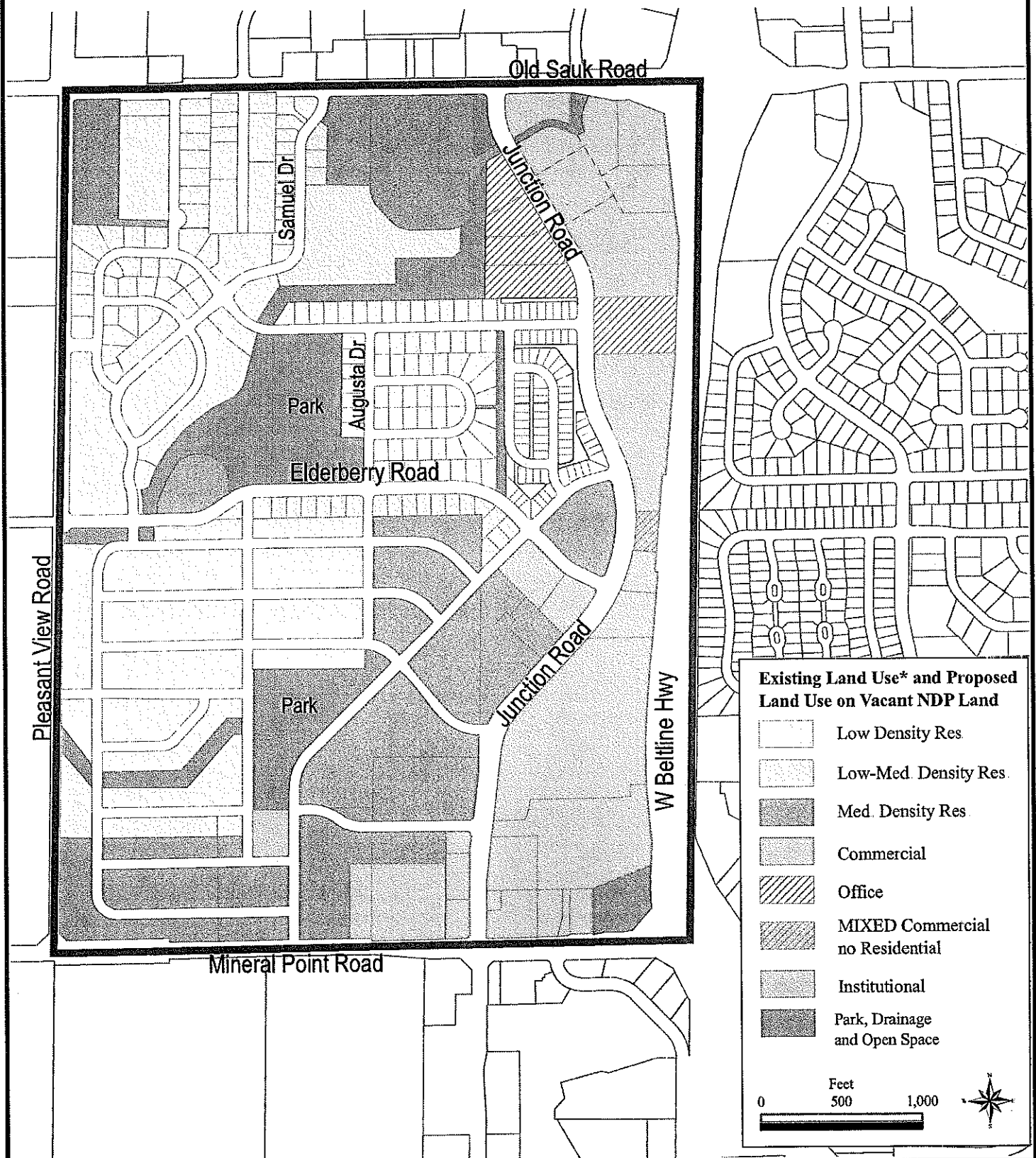

Elderberry Neighborhood Development Plan

Legend:

Low Density Res. (1-2 stories)	Neighborhood Commercial / Activity Center	Industrial
Low-Med. Density Res. (3-11 stories)	Office / Retail	Public, Downtown and Open Space
Med. Density Res. (12-14 stories)	Employment	Smart / Conventional

Scale: 0 to 1000 Feet

North Arrow

Map Labels: Pioneer Road, Elberberry Road, Old Sauk Road, Mineral Point Road, Church Site, Detention, Park, Office / Employment, Activity Center, Neighborhood Commercial, Smart / Conventional, Public, Downtown and Open Space.

Midtown Rd / CTH 'M' Area-wide Traffic Signals & Intersection Improvements Assessment District & Transportation Improvement Impact Fee Zone High Point-Raymond-Midtown Rd Neighborhood Development Plans and Adjacent Lands

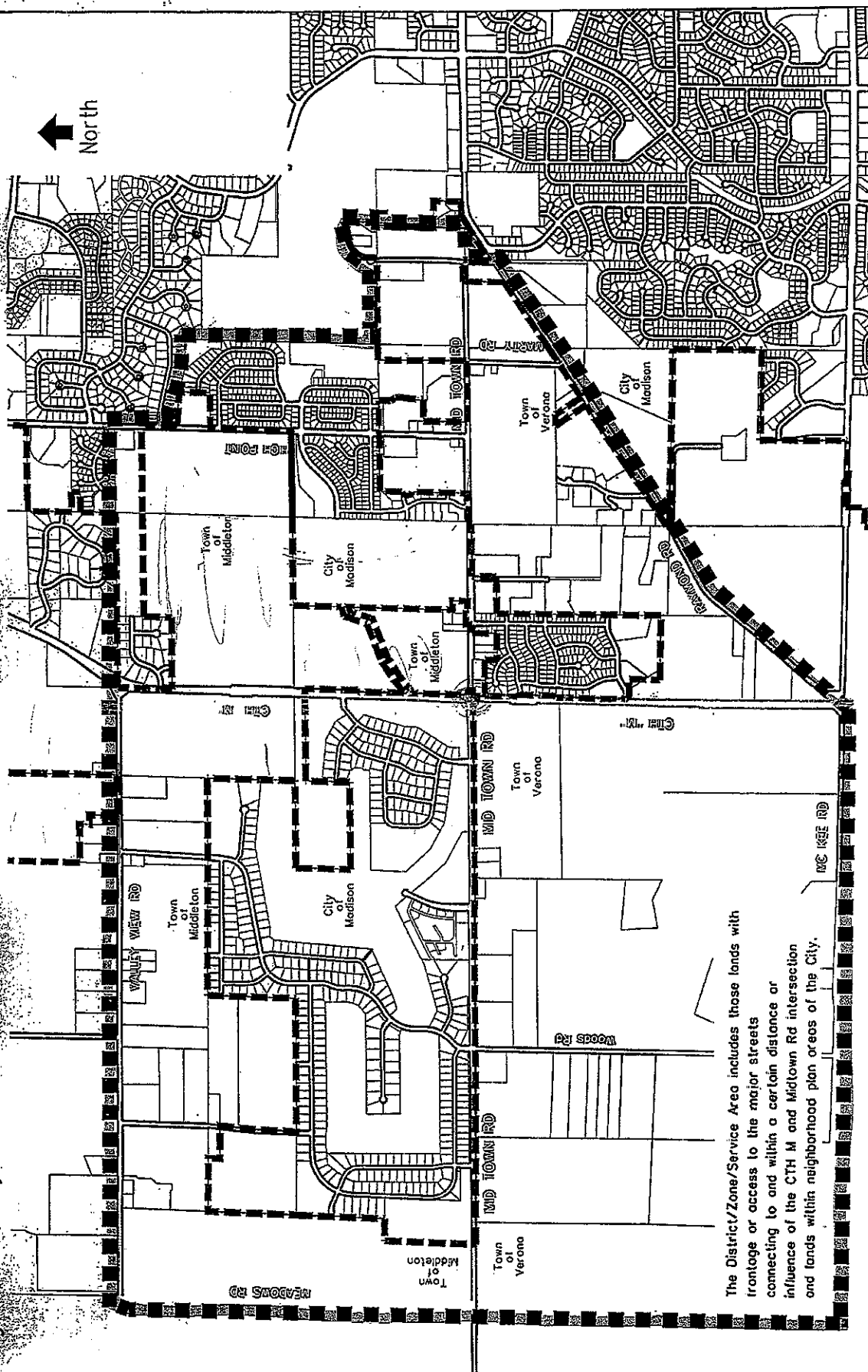

The District/Zone/Service Area includes those lands with frontage or access to the major streets connecting to and within a certain distance or influence of the CTH 'M' and Midtown Rd intersection and lands within neighborhood plan areas of the City.

