

Blount St - Livingston St

CITY OF MADISON

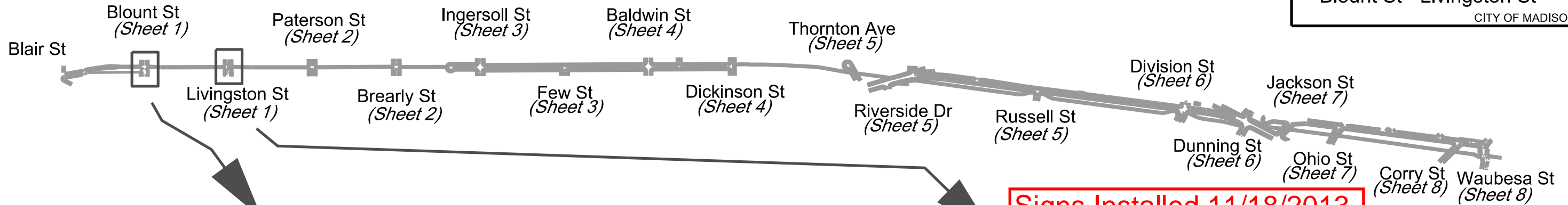

Signs Installed 11/18/2013

Signs Installed 11/18/2013

RR Order to Cul du Sac ????

- Proposed Improvements
1. Bump Out
 2. New Warning Sign
 3. Give path R-O-W stop Blount St

- Proposed improvements
1. New Warning Sign
 2. Give path R-O-W stop Livingston St

* Traffic Control To Be Enhanced (overhead, dbl-indcated, larger.....)

* Traffic Control To Be Enhanced (overhead, dbl-indcated, larger.....)

**Bump Outs 2017
Overhead Stop for
Blount St 2017-18**

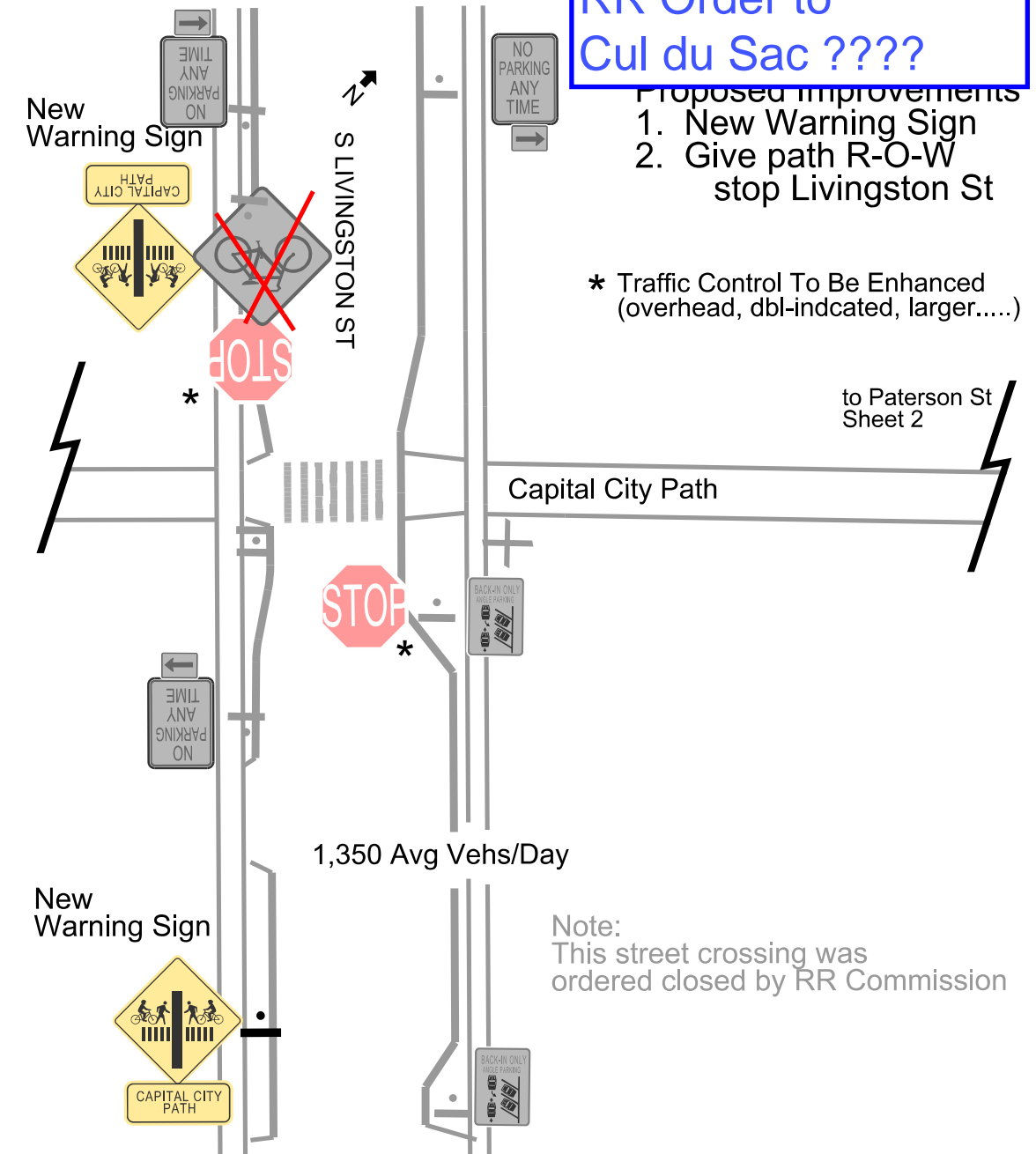
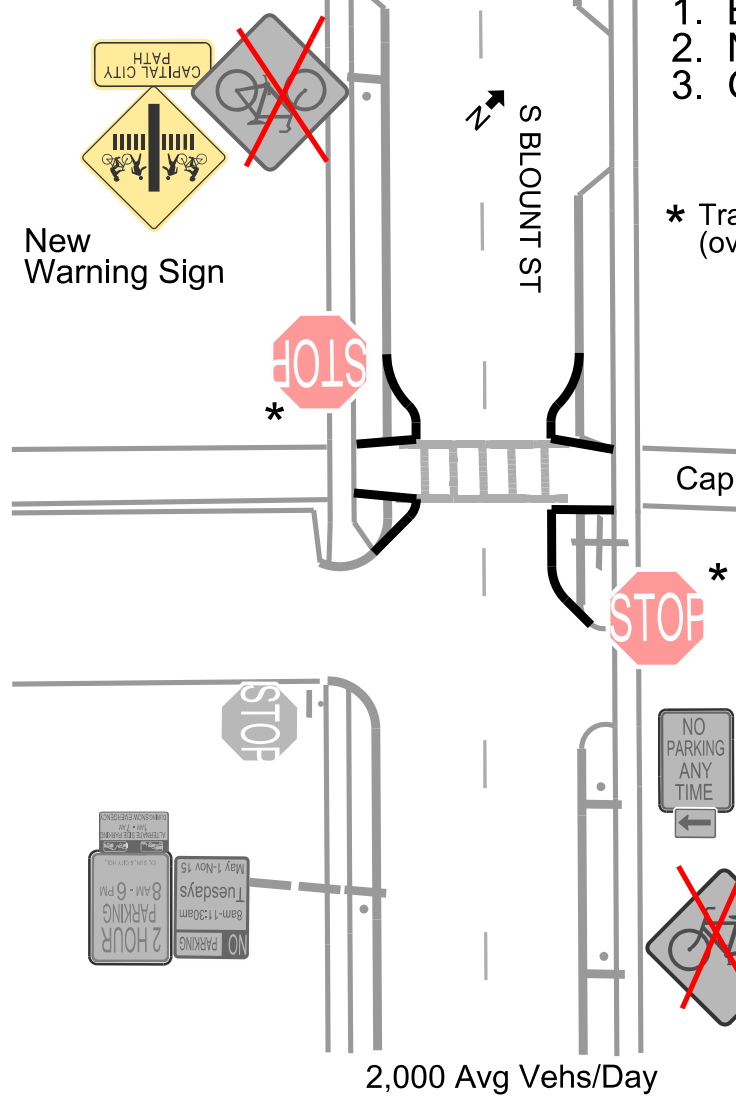

PLOT SCALE:
PLOT NAME:
REV. DATE:
ORIGINATOR: CITY OF MADISON, TRAFFIC ENG. DIV.

Paterson - Brearly St

CITY OF MADISON

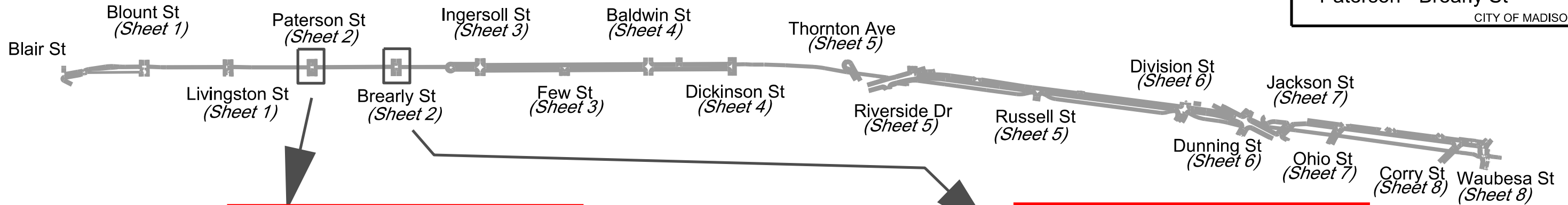

Signs Installed 11/18/2013

Signs Installed 11/18/2013

**Overhead Stop for Brearly St
Completed 10/16/2014**

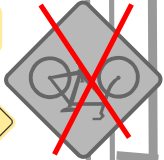

S PATERSON ST

Proposed Improvements
1. New Warning Sign
2. Add Yield to Path



Capital City Path

to Livingston St
Sheet 1



2,650 Avg Vehs/Day
Functional Class = Collector

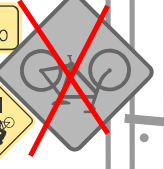

S BREARLY ST



1,150 Avg Vehs/Day



Proposed Improvements
1. New Warning Sign
2. Give path R-O-W stop Brearly St

* Traffic Control To Be Enhanced
(overhead, dbl-indicated, larger..)

to Ingersoll St
Sheet 3

Capital City Path

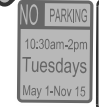

Note:
This street crossing was
ordered closed by RR Commission

PLOT SCALE:
PLOT NAME:
REV. DATE:
ORIGINATOR: CITY OF MADISON, TRAFFIC ENG. DIV.

Ingersoll St - Few St

CITY OF MADISON

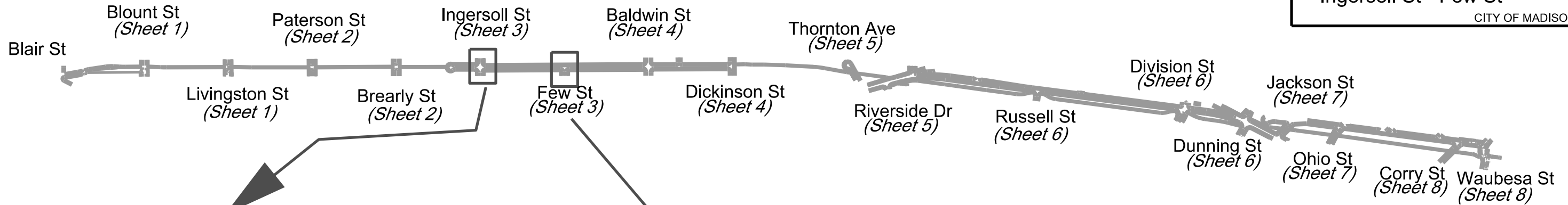

Signs Installed 11/18/2013

Proposed Improvements
1. Bump Out
2. New Warning Sign

Recon could be 20 yrs

Signs Installed 11/18/2013

Proposed Improvements
1. Bump Outs
2. Intersection Table

Recon could be 20 yrs

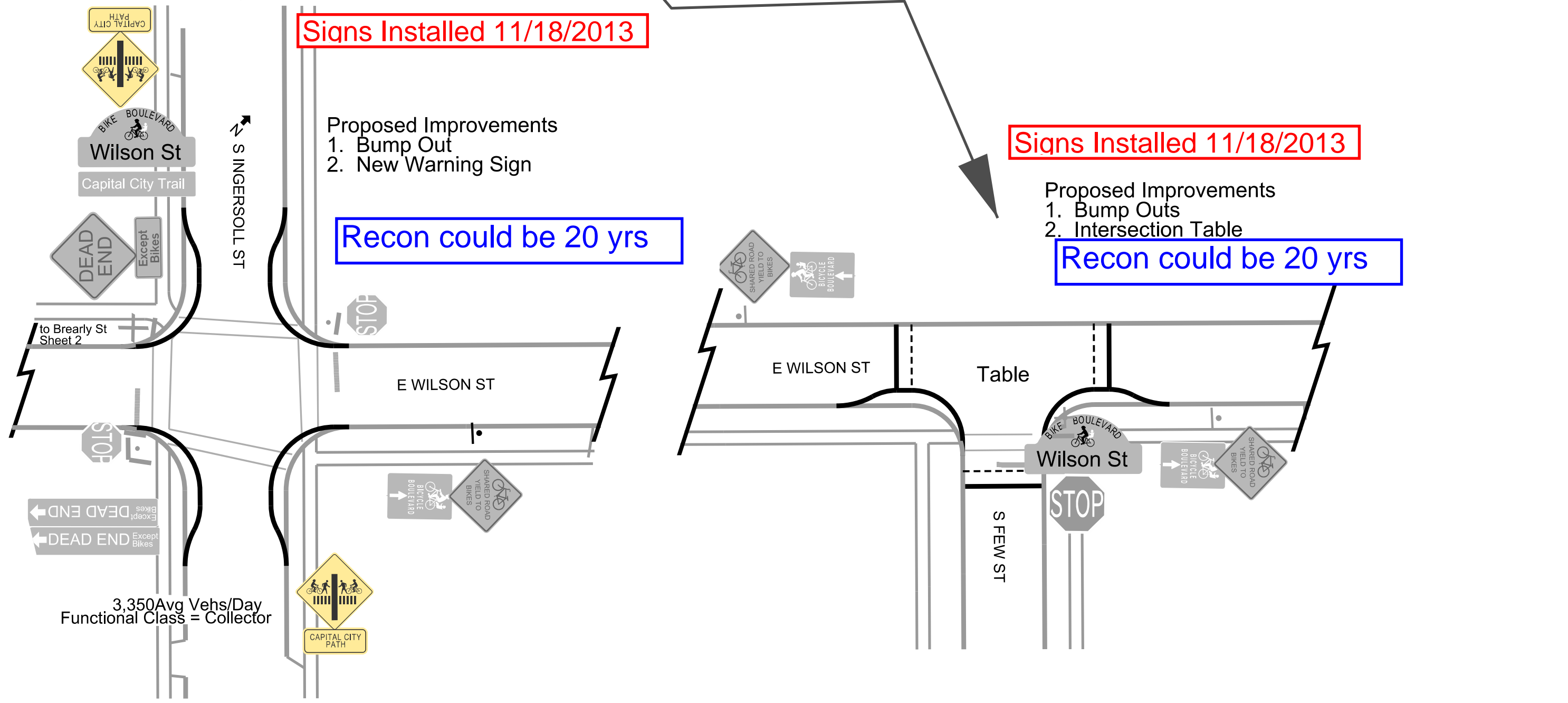

PLOT SCALE:
PLOT NAME:
REV. DATE:
ORIGINATOR: CITY OF MADISON, TRAFFIC ENG. DIV.

Baldwin St - Dickinson St

CITY OF MADISON

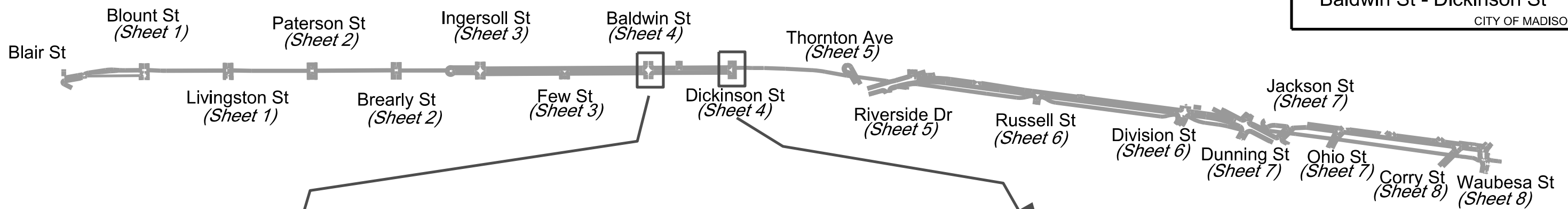

Signs Installed 11/18/2013

Signs Installed 11/18/2013

- Proposed Improvements
1. Bump Out
 2. Intersection Table
 3. New Warning Sign
 4. Give path R-O-W stop Dickinson St
 5. Widen Path from 10' to 12' between Thornton Ave & Dickinson St

- Proposed Improvements
1. Bump Out
 2. New Warning Sign

Recon could be 20 yrs

* Traffic Control To Be Enhanced (overhead, dbl-indcated, larger.....)

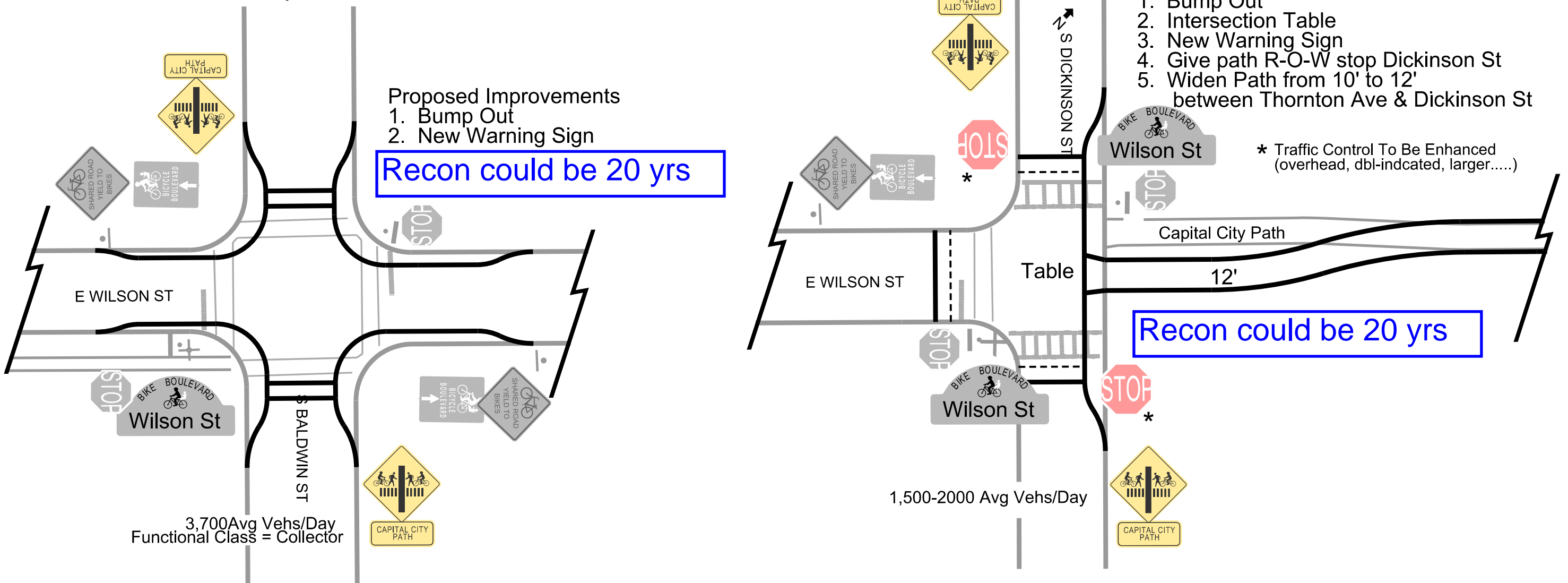

Recon could be 20 yrs

PLOT SCALE:

PLOT NAME:

REV. DATE:

ORIGINATOR: CITY OF MADISON, TRAFFIC ENG. DIV.

Warning Signs Installed 11/18/2013

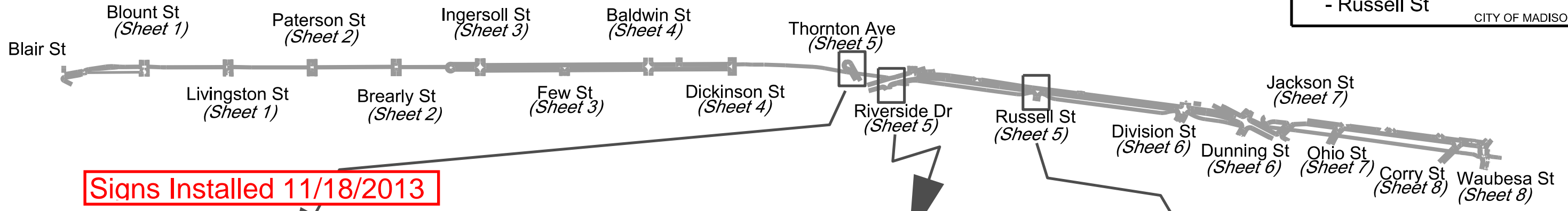

Signs Installed 11/18/2013

Signs Installed 11/18/2013

Signs Installed 11/18/2013

- Proposed Improvements
1. Bump Out
 2. Intersection Table
 3. Give path R-O-W stop Thornton St
 4. Widen Path from 10' to 12' between Thornton Ave & Dickinson St

Diagonal Signalized Crossing 2018?

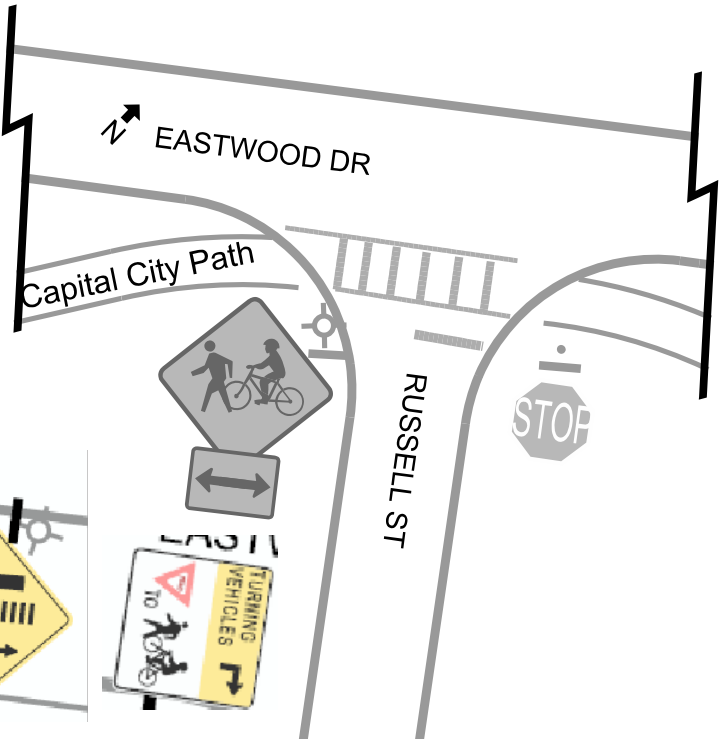
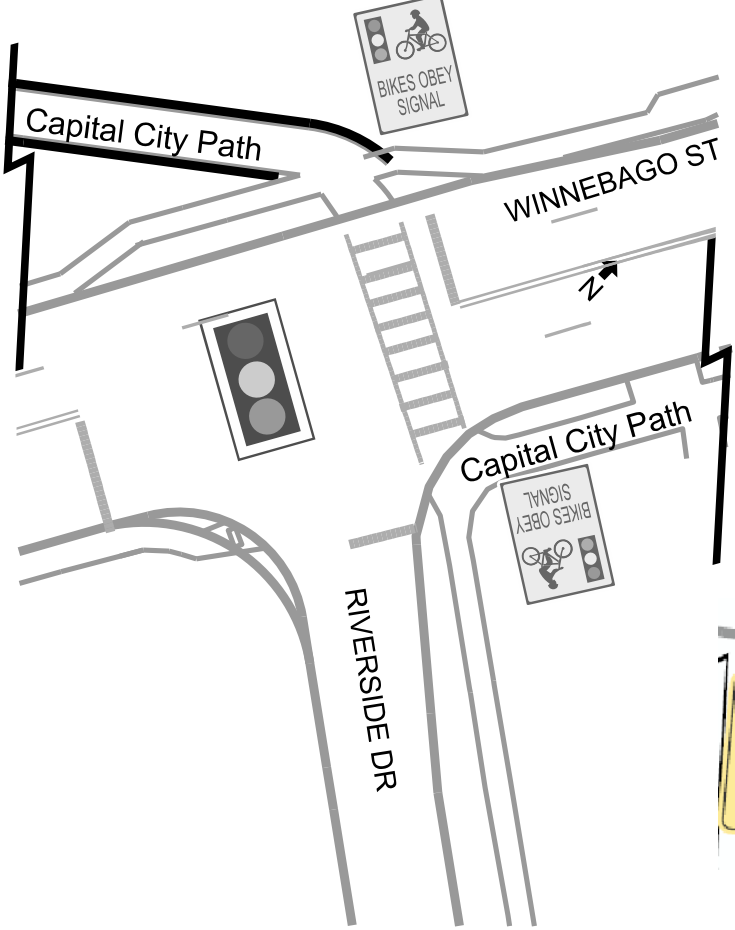

* Traffic Control To Be Enhanced (overhead, dbl-indicated, larger.....)

Recon could be 20 yrs

PLOT SCALE:
PLOT NAME:
REV. DATE:
ORIGINATOR: CITY OF MADISON, TRAFFIC ENG. DIV.

Division St - Dunning St

CITY OF MADISON

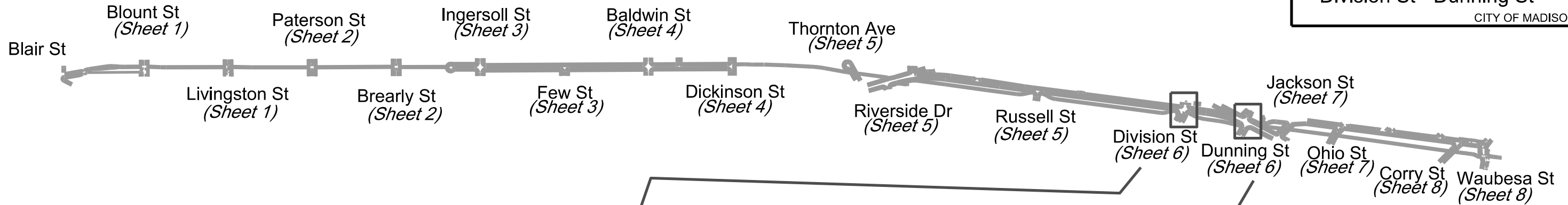

Diagonal Signalized Crossing
Completed 6/2013

Proposed Improvements
1
Installed Blank-Out NRT 5/8/2014

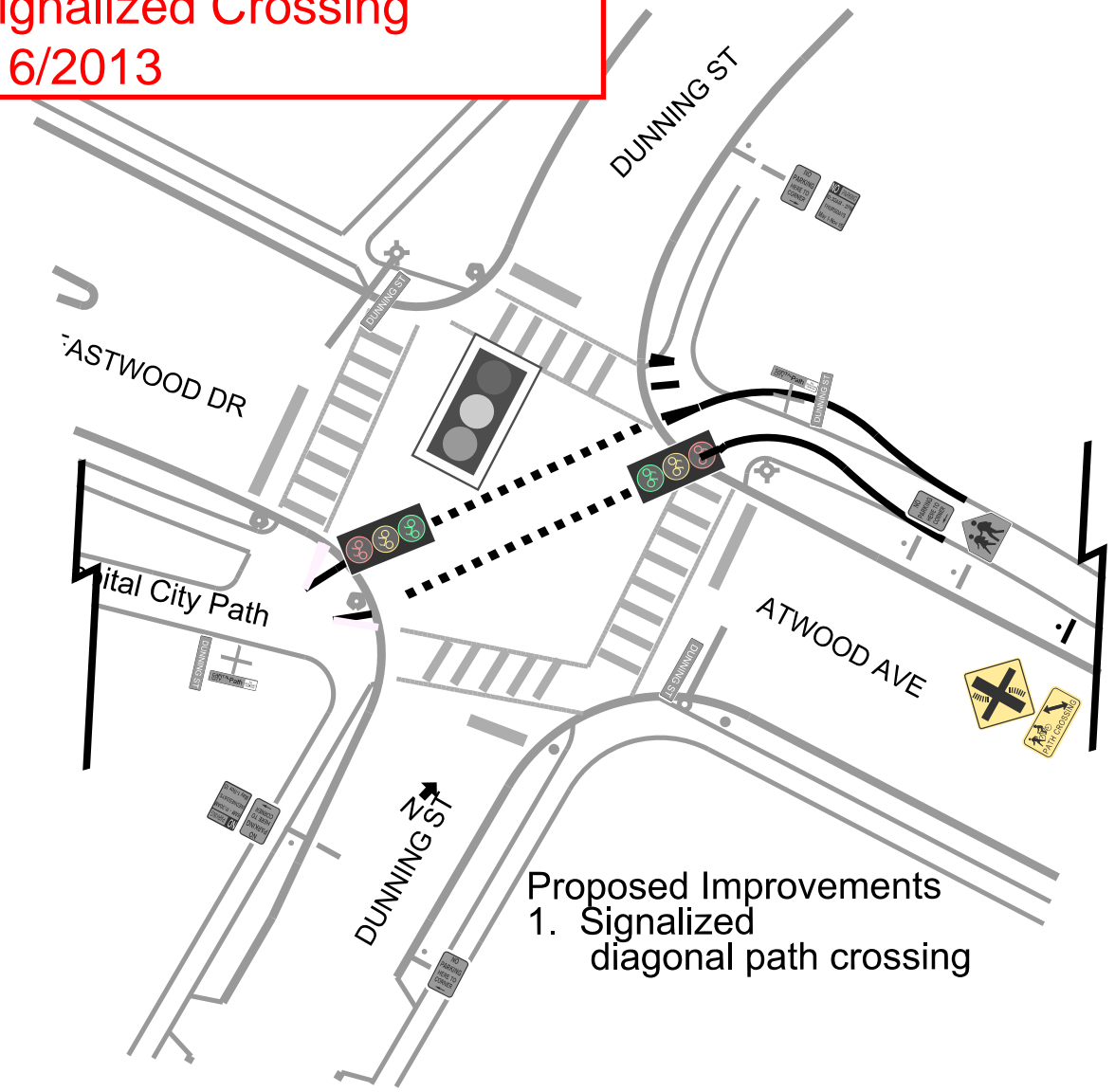
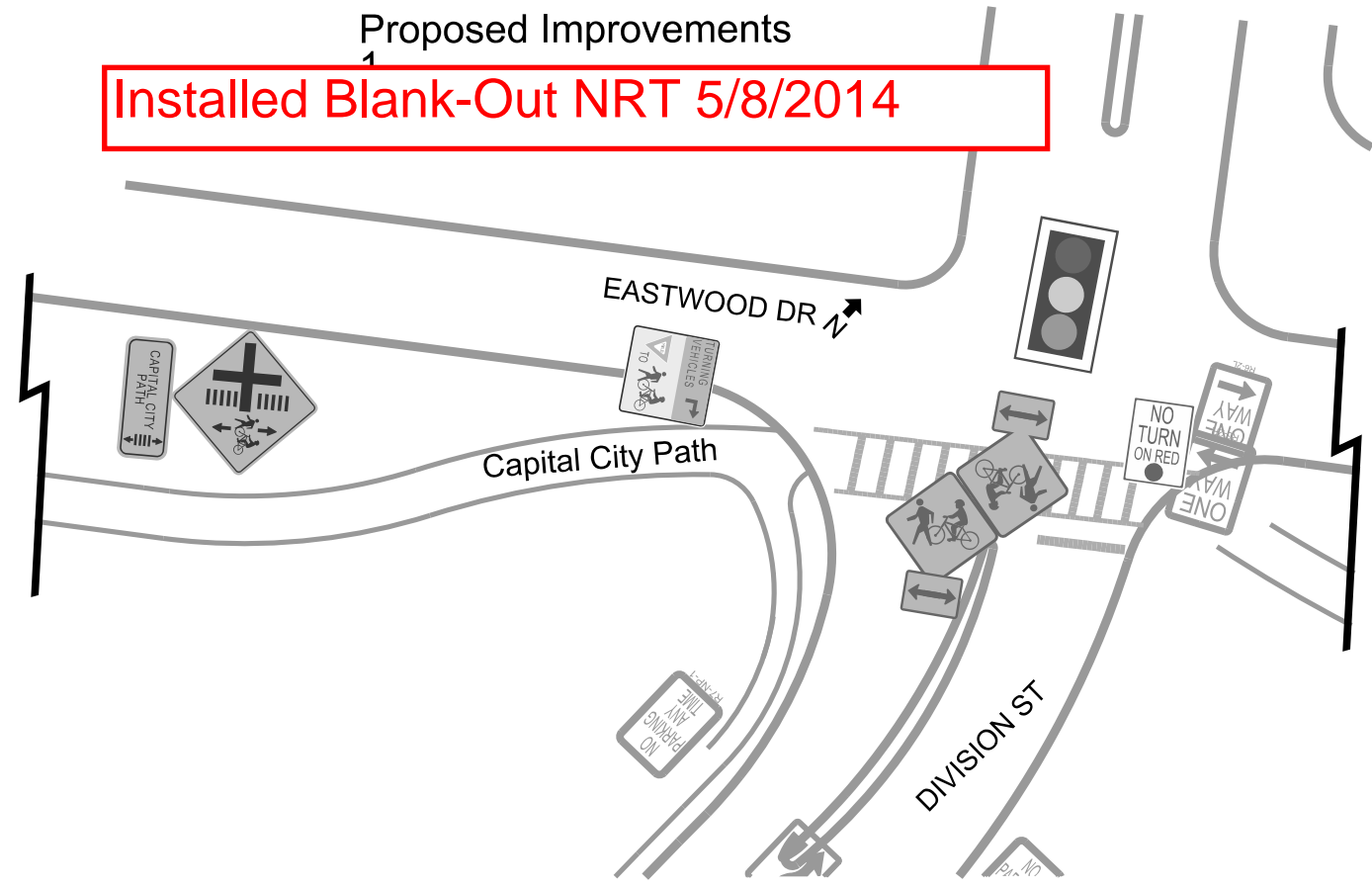

PLOT SCALE:
PLOT NAME:
REV. DATE:
ORIGINATOR: CITY OF MADISON, TRAFFIC ENG. DIV.

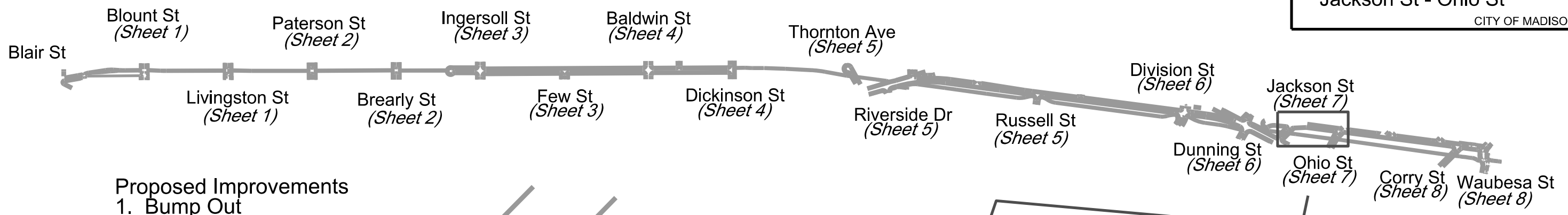

- Proposed Improvements
1. Bump Out
 2. Intersection Table
 3. New Warning Signs
 4. Add Yield to Path

Signs Installed 11/18/2013

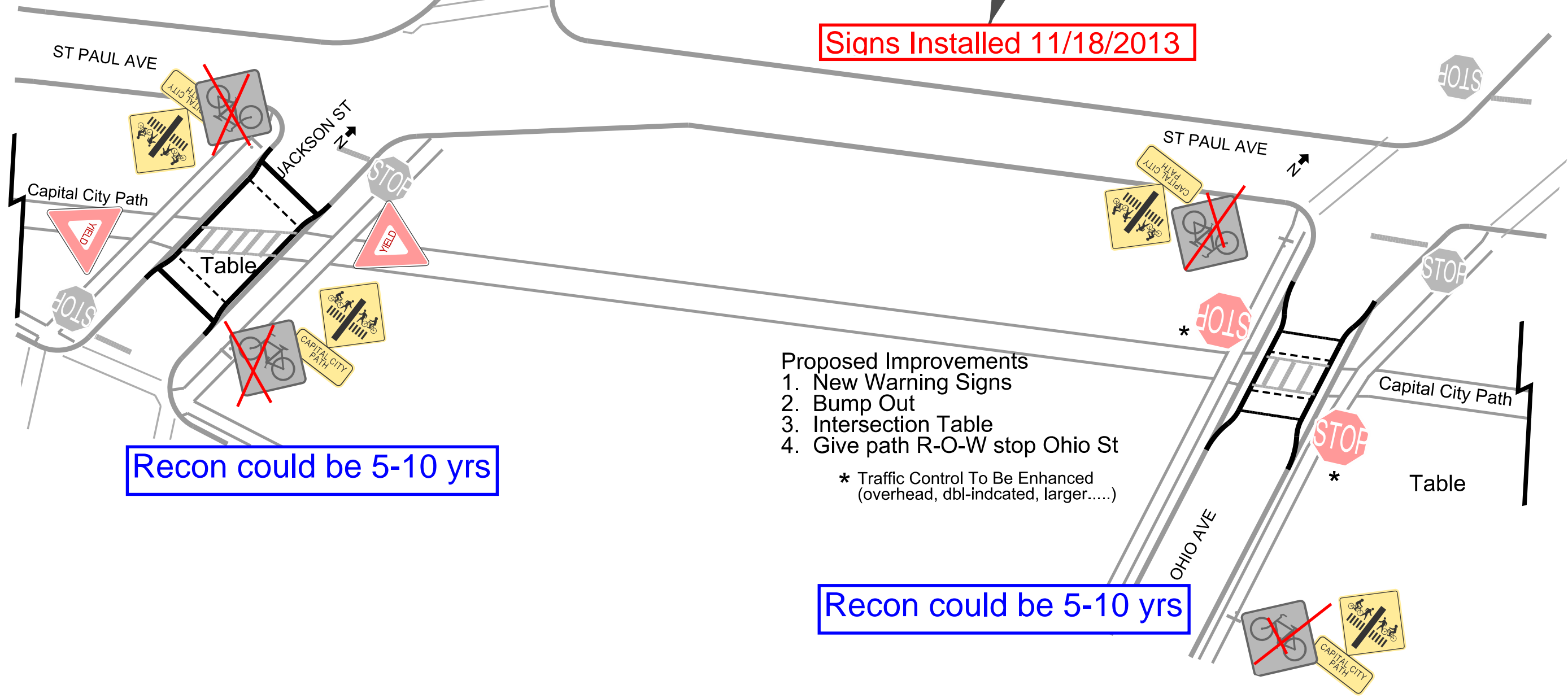

Recon could be 5-10 yrs

- Proposed Improvements
1. New Warning Signs
 2. Bump Out
 3. Intersection Table
 4. Give path R-O-W stop Ohio St

Recon could be 5-10 yrs

PLOT SCALE:
 PLOT NAME:
 REV. DATE:
 ORIGINATOR: CITY OF MADISON, TRAFFIC ENG. DIV.

Corry St - Waubesa St

CITY OF MADISON

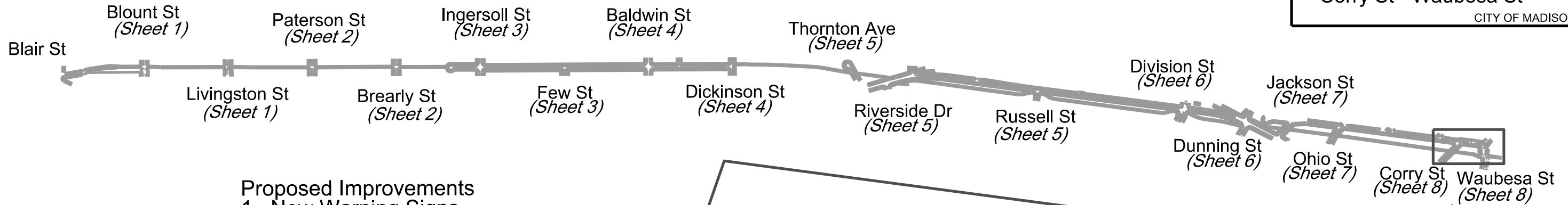

- Proposed Improvements
1. New Warning Signs
 2. Intersection Table
 3. Give path R-O-W stop Corry St

Signs Installed 11/18/2013

Proposed Improvements
1.
Installed Stop Control for Waubesa St on 8/15/2017

* Traffic Control To Be Enhanced (overhead, dbl-indicated, larger.....)

Recon could be 20 yrs

PLOT SCALE:
PLOT NAME:
REV. DATE:
ORIGINATOR: CITY OF MADISON, TRAFFIC ENG. DIV.