

070923108017
 FIORE COAL & OIL & 20TH CENT
 MAKTS & W WASH ASC LLC
 222 W WASHINGTON AVE

070923109015
 GRACE EPISCOPAL CHURCH
 6 N CARROLL ST

REM. EX. SAS
 #5050-015
 STA 406' F +69.95 RT18.88'
 RIM=899.54
 EI=885.29(SW)
 EI=886.32(N)

COMPRESSION
 COUPLING
 #15" - 18" @ 0.66%

REM. EX. SAS
 #5050-015

EX. SAS
 #5050-016
 RIM=904.76
 EI=889.44(SW)
 EI=889.66(NW) 4" PVC
 EI=890.26(SE)
 EI=889.48(NE)

EX. SAS#5050-019
 RIM=892.48
 EI=881.39
 EI=881.51

EX. SAS#5050-018
 RIM=896.32
 EI=884.27(SW)
 EI=884.32(NE)

EX. SAS#5050-030
 RIM=895.12
 EI=888.90
 EI=888.57

REM. EX. SAS
 #5050-042
 (CLEANOUT)

REM. EX. SAS
 #5050-017

070923110062
 THE LORRAINE CDM UNIT OWN
 ASSOC INC % THOMAS J GEIER
 123 W WASHINGTON AVE

070923111028
 WHEDA
 201 W WASHINGTON AVE

WATER DESIGN PER WATER UTILITY
 SEE WATER SHEETS FOR DETAILS

070923111028
 WHEDA
 201 W WASHINGTON AVE

070923110062
 THE LORRAINE CDM UNIT OWN
 ASSOC INC % THOMAS J GEIER
 123 W WASHINGTON AVE

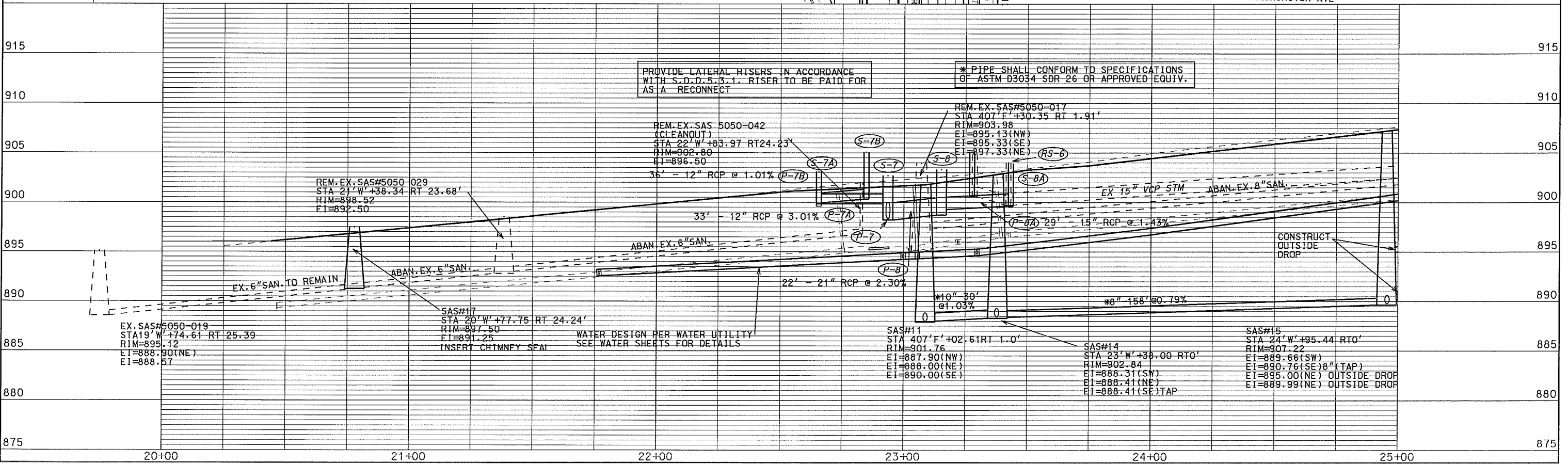

PLOT SCALE: _____
 PLOT NAME: _____
 REV. DATE: _____
 ORIGINATOR: CITY OF MADISON, STREETS DIVISION