

PARKING LOT EXPANSION PROJECT

**MADISON POLICE DEPARTMENT
TRAINING CENTER
5702 FEMRITE DRIVE**

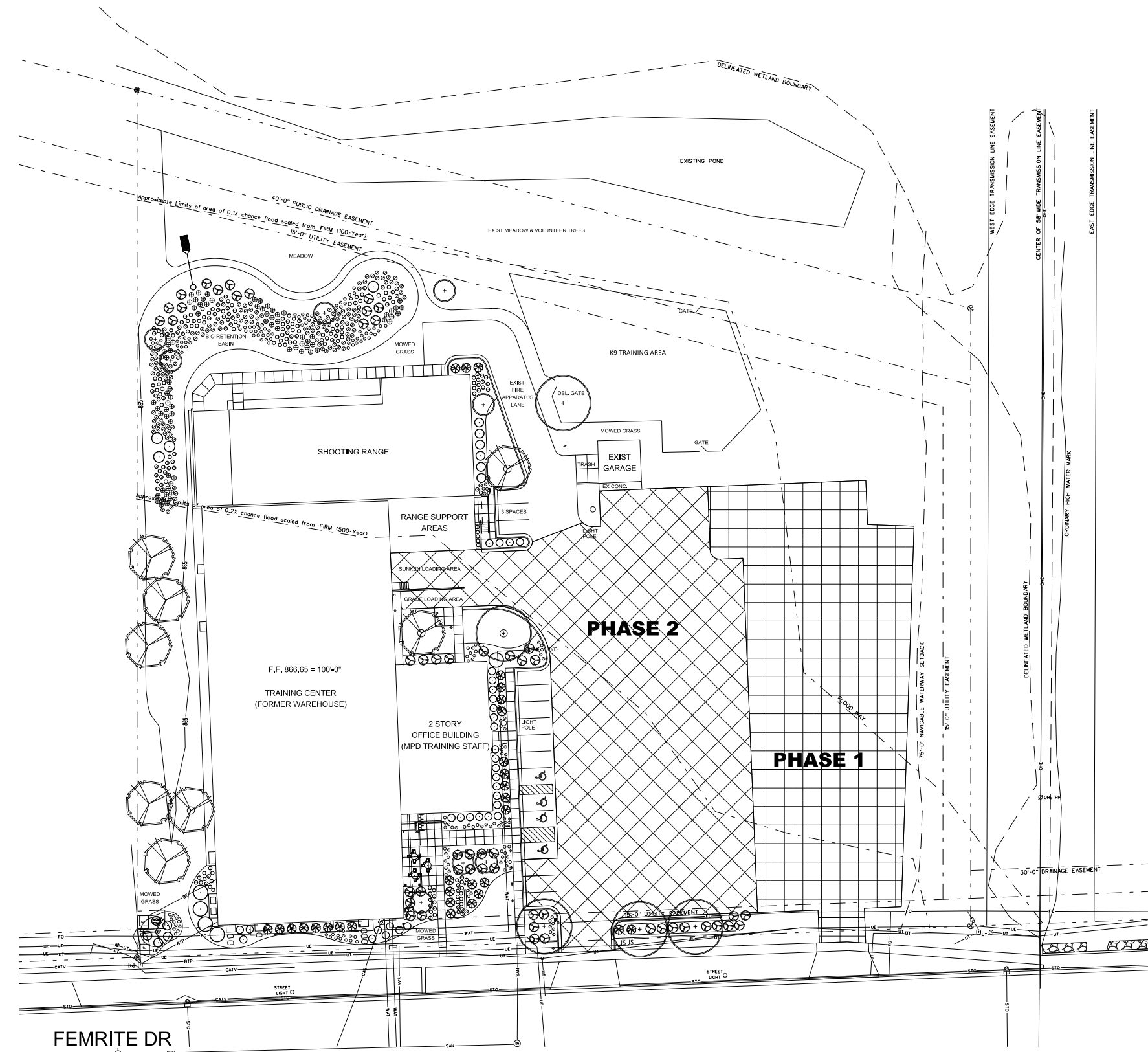

GENERAL SITE PLAN AND PHASING PLAN

**SCALE: 24x36: 1" = 30'
17x11: NOT TO SCALE**

SHEET INDEX

- 1 COVER SHEET**
- 2 AUTO-TURN DETAILS**
- D1 PHASE 1 DEMOLITION PLAN**
- G1 PHASE 1 GRADING PLAN**
- C1 PHASE 1 CONSTRUCTION PLAN**
- E1 PHASE 1 ELECTRICAL PLAN**
- D2 PHASE 2 DEMOLITION PLAN**
- G2 PHASE 2 GRADING PLAN**
- C2 PHASE 2 CONSTRUCTION PLAN**
- L2 PHASE 2 LANDSCAPING AND STRIPING PLAN**

GENERAL PROJECT DESCRIPTION

THIS PROJECT IS TO EXPAND THE EXISTING PARKING SURFACE AT THE MADISON POLICE TRAINING CENTER FROM 74 STALLS TO 135 STALLS. THE EXPANSION SHALL BE COMPLETED IN TWO PHASES:

**PHASE 1 IN FALL 2012:
IS BEING DONE BY CITY CREWS AND WILL PREPARE THE EXPANSION AREA.**

**PHASE 2 IN SPRING 2013
WILL BE DONE BY BPW CONTRACT AND WILL BE THE FINAL PREPARATION AND SURFACING OF THE NEW PARKING LOT.**

THIS PROJECT PASSED UDC REVIEW ON SEPTEMBER 19, 2012.

GENERAL PROJECT LOCATION

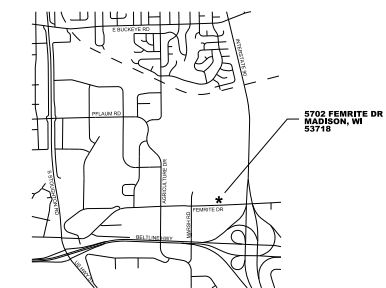

Parking Lot Plan Site Information Block

Site Address	5702 Femrite Dr.
Site acreage (total)	4.13 Ac.
Number of building stories (above grade)	Training Space - 1 story Range - 1 story Office - 2 story
Building Height	Varies by building 19'-24'
DILHR type of construction (new structures or additions)	N/A
Total square footage of building	39,186 Sq Ft
Use of property	Law Enforcement Training and Instruction
Gross square feet of office	39,186 Sq Ft
Gross square feet of retail area	N/A
Number of employees in warehouse	N/A
Number of employees in production area	N/A
Capacity of restaurant/place of assembly	Max. of 375 Including staff
Number of bicycle stalls shown	9 existng
Number of parking stalls shown	
Small car	0
Large car	130
Accessible	5
Total	135
Number of trees shown	11 required+800 points, see L2

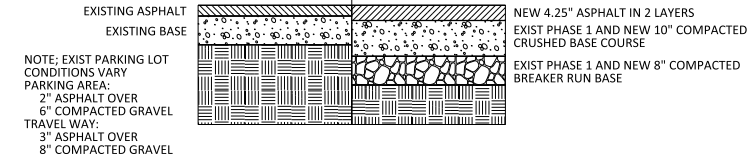

1. TYPICAL PARKING LOT CROSS SECTION
SCALE: NOT TO SCALE

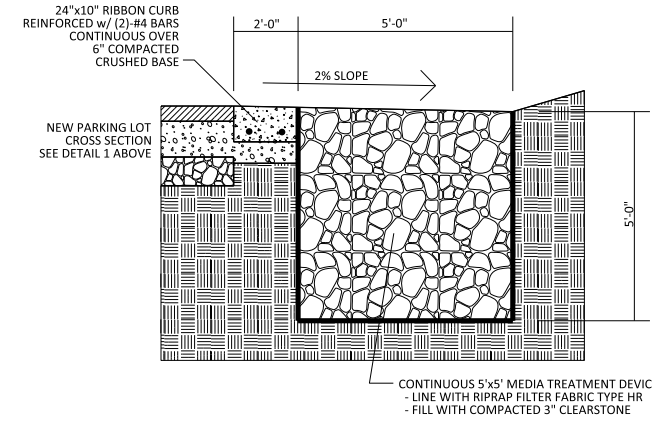

2. SECTION THRU RIBBON CURB AND SWM DEVICE
SCALE: NOT TO SCALE

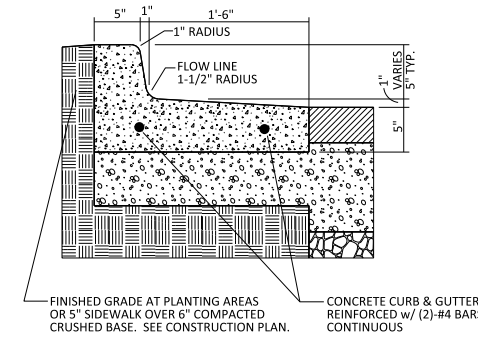

3. TYPICAL REJECT CURB AND GUTTER SECTION
SCALE: NOT TO SCALE

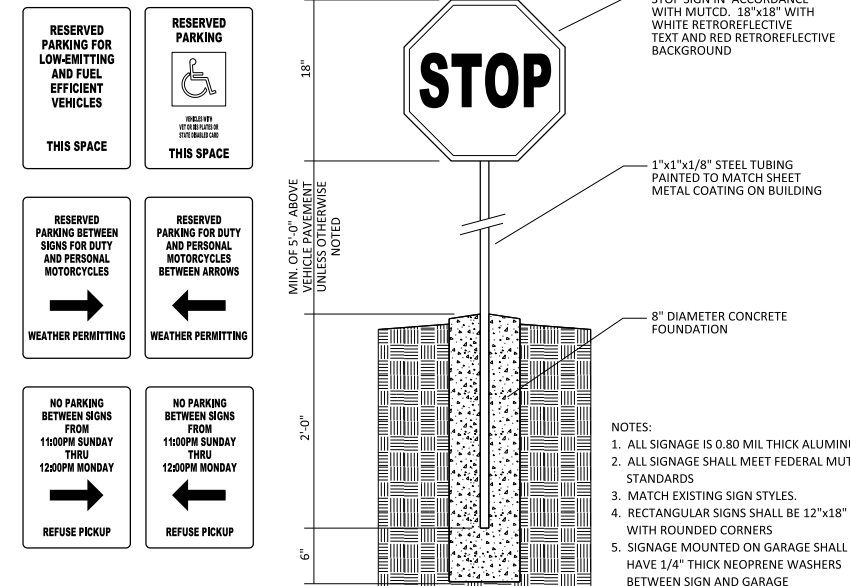

4. SIGNAGE DETAILS
SCALE: NOT TO SCALE

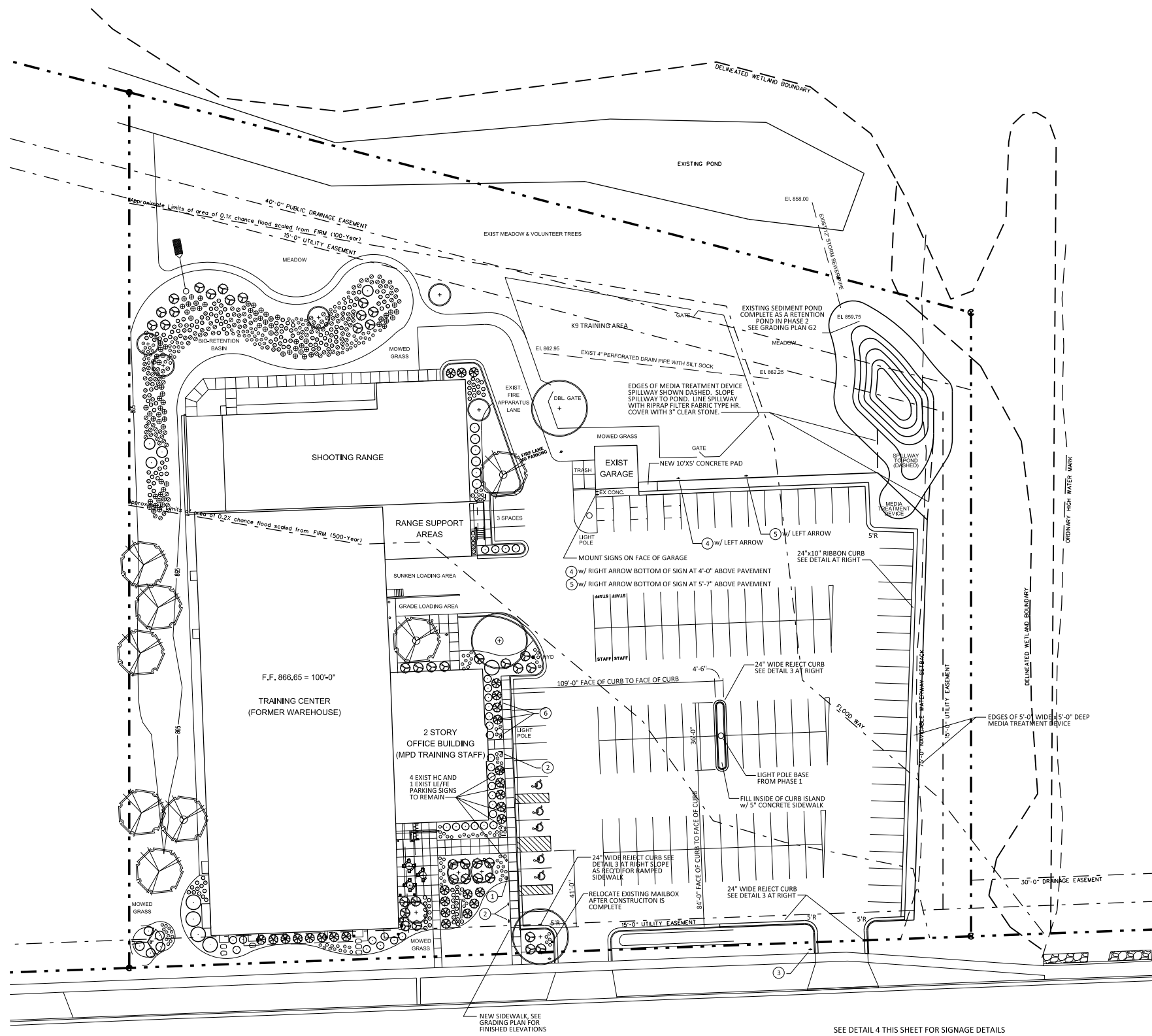

FEMRITE DR

PHASE 2 CONSTRUCTION PLAN
SCALE: 24x36: 1" = 30'
17x11: NOT TO SCALE

- SEE DETAIL 4 THIS SHEET FOR SIGNAGE DETAILS
- 1 PROVIDE AND INSTALL ONE (1) NEW BARRIER FREE SIGN
 - 2 RELOCATE LOW-EMITTING/FUEL EFFICIENT SIGNS
 - 3 PROVIDE AND INSTALL ONE (1) NEW STOP SIGN
 - 4 PROVIDE AND INSTALL RESERVED MOTORCYCLE PARKING SIGNS
 - 5 PROVIDE AND INSTALL RESTRICTED PARKING SIGNS, FOR REFUSE PICKUP
 - 6 PROVIDE AND INSTALL THREE (3) LOW-EMITTING/FUEL EFFICIENT SIGNS

PARKING LOT EXPANSION PROJECT

**MADISON POLICE DEPARTMENT
TRAINING CENTER
5702 FEMRITE DRIVE**

NOTES:

1. PLANTING DESIGNATORS IDENTIFIED WITH "***" ARE EXISTING AND BEING SHOWN FOR THE CITY OF MAISON LANDSCAPE WORKSHEET

PROPOSED LANDSCAPING SCHEDULE FOR MPD TRAINING CENTER PARKING LOT EXPANSION AT 5702 FEMRITE DRIVE

SYMBOL	BOTANICAL NAME	COMMON NAME	INSTALLED SIZE	ROOT	MATURE SIZE	TOTAL NEW FOR CONTRACT	QTY. USED FOR CREDIT TOWARDS REQMT'S			
							QTY. NEW	QTY. EXIST	POINTS	
TREES: LARGE AND SMALL WITHIN THE 20' AND 50' REQUIREMENTS PER Ch 28.04(12(b)) of MGO										
AF	<i>Acer x. Freemanii</i> 'Sienna'	Sienna Glen Freeman Maple	2" Cal.	B.B.	50' H x 35' W	2	2**	3**	0	0
AR	<i>Acer rubrum</i> 'Autumn Spire'	Autumn Spire Red Maple	2" Cal.	B.B.	50' H x 35' W		0	1**	0	0
CV	<i>Chionanthus</i>	White Fringetree	5' High Multistem	B.B.	12' H x 12' W		0	2	15	0
GT	<i>Gleditsia triacanthos</i> var. <i>inermis</i> 'Skyline'	Skyline Honeylocust	2" Cal.	B.B.	50' H x 35' W		0	1	35	0
QM	<i>Quercus rubra</i>	Northern Red Oak	2" Cal.	B.B.	50' H x 35' W	5	5**	0	0	0
X1		Pre phase 1 Maple relocated	2" Cal.				0	1	35	0
X2		Pre phase 1 Honey Locust relocated	3" Cal.				0	1	15	0
X3		Pre phase 1 Crabapple relocated					0	1	15	0
JL	<i>S. reticulata</i> 'Ivory Silk'	Ivory silk Japanese Tree Lilac				6	6	0	15	90
JB	<i>J. virginiana</i> 'Blue Arrow'	Blue Arrow Juniper	4-5' High	5 Gallon	10-12' H x 3-4' W	29	24	0	15	360
SHRUBS: WITHIN THE 20' REQUIREMENTS PER Ch 28.04(12(b)) of MGO										
AM	<i>Aronia melanocarpa</i> 'Elatea'	Glossy Black Choke Cherry	3' H	Container	5' H x 5' W		0	6	2	0
JC	<i>Juniperus chinensis</i> 'Kallay Compact'	Kallay Compact Juniper	4-5 Gallon	Container	4' H x 4' W		0	3	3	0
JS	<i>Juniperus sabinna</i> 'Buffalo'	Buffalo Savin Juniper	12-18" High	Container	18" H x 5' W	8	8	12	3	24
RA	<i>Rhus aromatica</i> 'Gro Low'	Gro Low Fragrant Sumac	18-24" High	2-4 Gallon	2-3' H x 5-6' W		0	12	2	0
RR	<i>Rosa rugosa</i> 'Purple Pavement'	Purple Pavement Rugosa Rose	2-3 Gallon	Container	3.5' H x 3' W		0	20	2	0
VD	<i>Viburnum dentatum</i> 'Ralph Senior'	Autumn Jazz Arrowwood Viburnum	3-4' High	5 Gallon	8' H x 8' W		0	1	2	0
GS	<i>S. japonica</i> 'Goldmound'	Goldmound Spirea	1' H	Container	2' H x 2' W	6	6	0	2	12
WS	<i>S. alba</i> 'Albiflora'	Japanese White Spirea	1' H	Container	2' H x 2' W	6	6	0	2	12
OTHER: WITHIN THE 20' REQUIREMENTS PER Ch 28.04(12(b)) of MGO										
Earth Berm						64 LF	6	6	2	12
Split Rail Fence						70 LF	5	0	5	25
							TOTALS	535	265	800
							GRAND TOTAL			

**NOTE: FULL POINTS NOT TAKEN FOR MANDATORY CANOPY TREE REQUIREMENT (11)

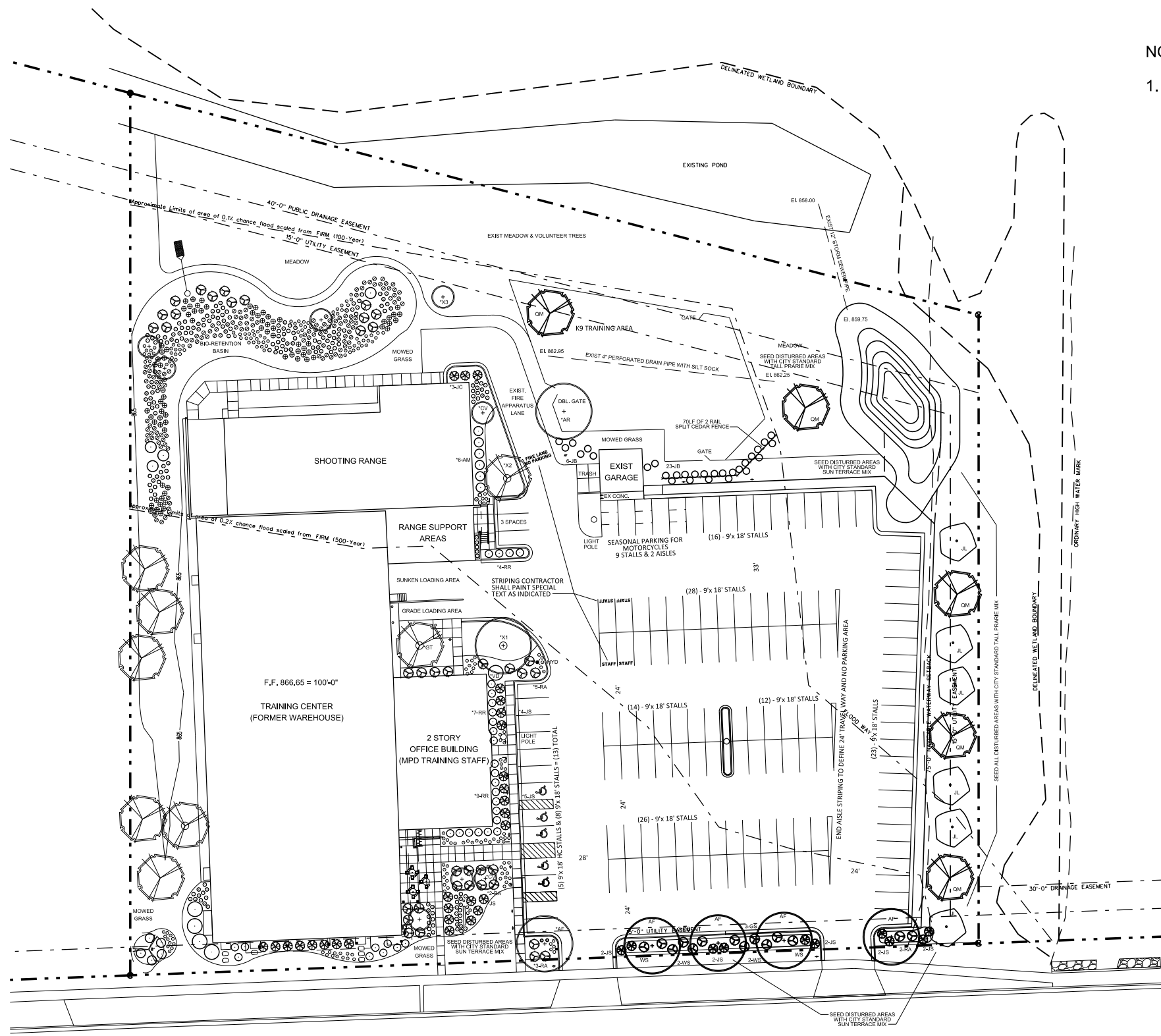

PHASE 2 LANDSCAPING AND PAINT STRIPING PLAN
SCALE: 24x36: 1" = 30'
17x11: NOT TO SCALE

FEMRITE DR