

Bulkhead Removal, Shore Stabilization and Canoe/Kayak Access in Yahara Place Park

City Engineering is proposing to remove the three rusty steel bulkheads at the Yahara Place Park. Each section is approximately 40 to 45 feet in length. Two bulkheads on either end of the park will be replaced with glacial field stone riprap and the middle bulkhead off Russell Street will be replaced with cut dolomite limestone steps. In total, 132 linear feet of shoreline will be impacted with the replacement. Currently, the park has no water access. The stone steps will be 20-feet in length and will be similar to the nearby launch on the Yahara River, upriver of the Rutledge Street and Riverside Drive intersection. They will provide access to the lake for canoes, kayaks and people.

The riprap and limestone steps are designed for an 846.78' storm wave height and an 845.0' target summer max lake level.

Prior to beginning any earthwork, the contractor will install stilt curtain per DNR Conservation Practice Standard 1070. All disturbed areas will be topsoiled, seeded with terrace seed mix, and stabilized with erosion control matting, Class I Urban Type A. Silt fence will be placed downstream of all stockpiles areas. Additional silt fence and temporary polymer stabilization will be used at the discretion of the project engineer.

The project will be completed in late July, or when appropriate based on weather and park use.



Photograph 1: Photograph taken on February 14, 2017, shows the sheet metal bulkhead in Yahara Place Park, near the Walton Place Street end, as well as the park and shoreline in general.



Photograph 2: Photograph taken on September 9, 2014, shows the general condition of the bulkheads. Although the metal is still sound, the caps have been displaced, exposing sharp metal edges. It is unknown when the bulkheads were installed, or what their original purpose was.

Bulkhead Removal, Shore Stabilization and Canoe/Kayak Access in Yahara Place Park



PLOT SCALE: _____

PLOT NAME: _____

REV. DATE: _____

ORIGINATOR: CITY OF MADISON, STREETS DIVISION

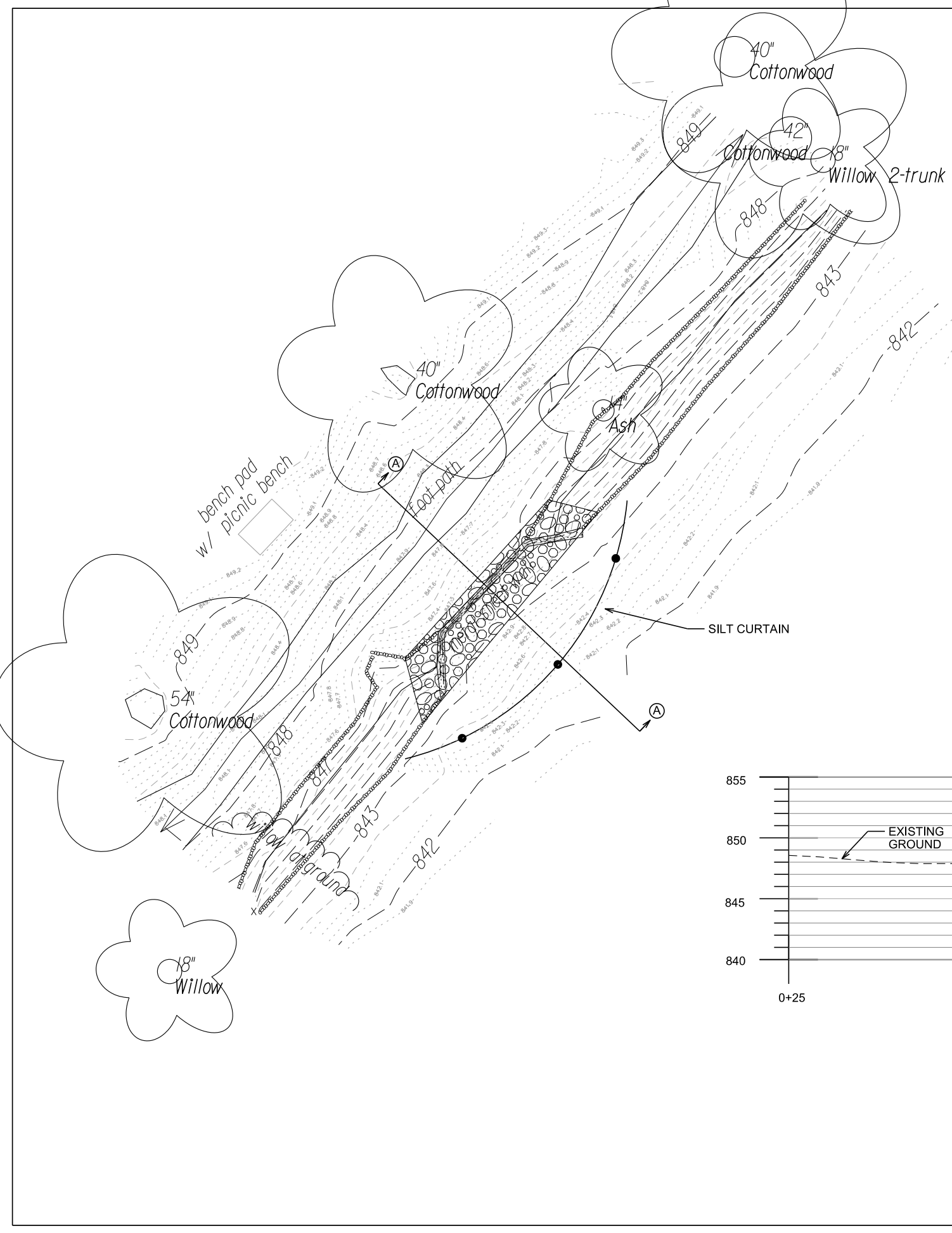

EROSION CONTROL NOTES:

- 1) PRIOR TO BEGINNING ANY EARTHWORK, THE CONTRACTOR SHALL INSTALL SILT CURTAIN PER WI DNR CONSERVATION PRACTICE STANDARD 1070.
- 2) ALL DISTURBED AREAS SHALL BE TOPSOILED, SEEDED WITH TERRACE SEED MIX, AND STABILIZED WITH EROSION CONTROL MATTING, CLASS I, URBAN TYPE A.
- 3) SILT FENCE OR SILT SOCK SHALL BE INSTALLED AS DIRECTED AND THAT THE DISCRETION OF THE CONSTRUCTION ENGINEER.
- 4) TEMPORARY POLYMER STABILIZATION SHALL BE PLACED AS DIRECTED BY THE CONSTRUCTION ENGINEER.
- 5) SILT FENCE SHALL BE PLACED DOWNSTREAM OF ALL STOCKPILE AREAS
- 6) THE PROJECT SITE SHALL BE INSPECTED WITHIN 24 HOURS OF A RAINFALL EXCEEDING 0.5" AND WEEKLY.

SECTION A-A: WALTON PLACE SHEET PILING

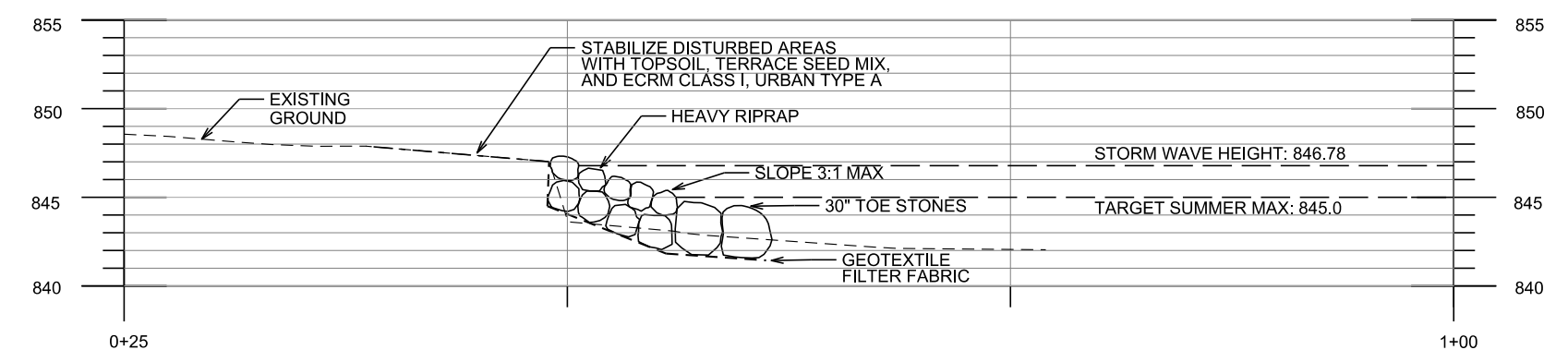

PLOT SCALE: _____

PLOT NAME: _____

REV. DATE: _____

ORIGINATOR: CITY OF MADISON, STREETS DIVISION

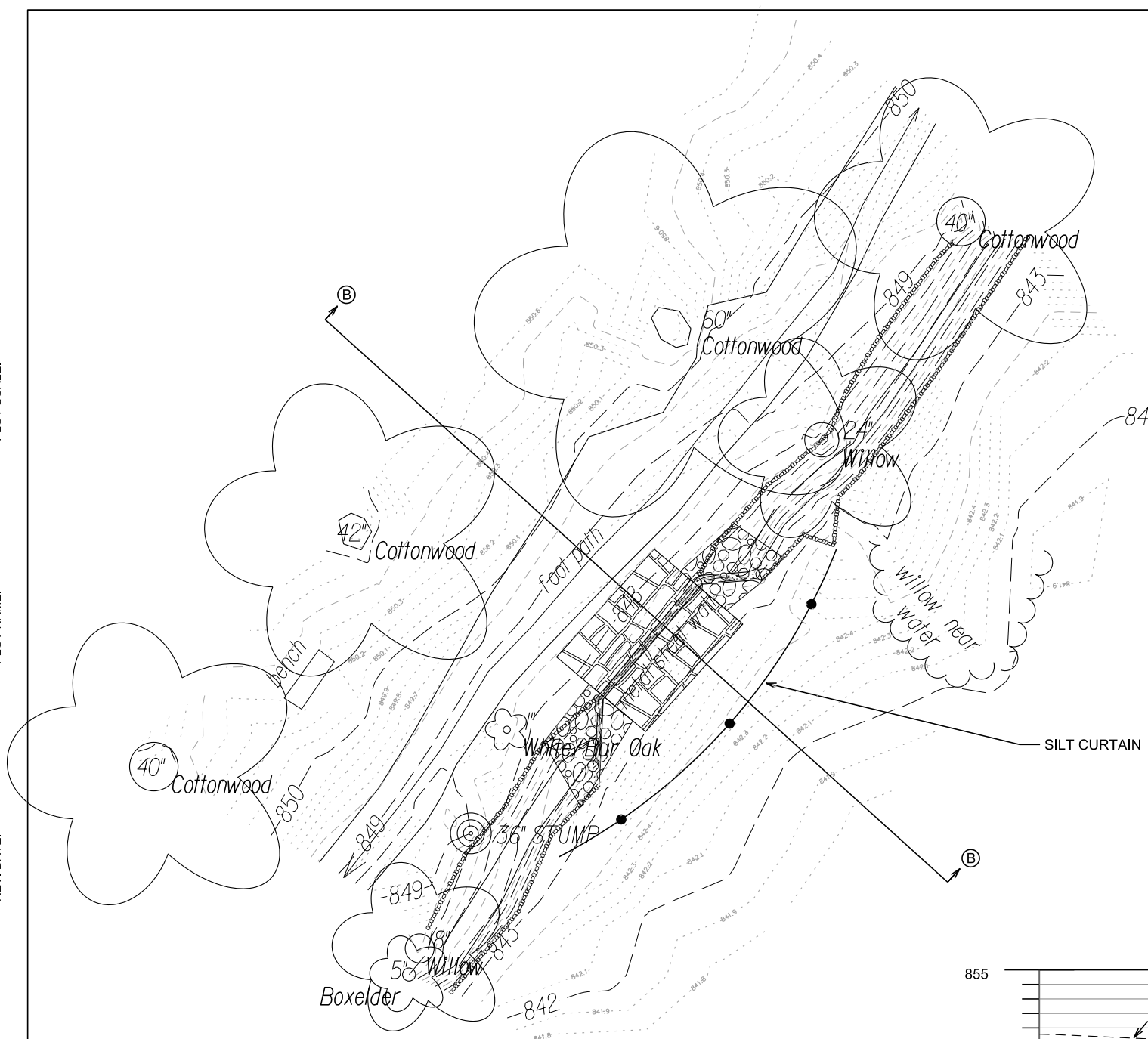

EROSION CONTROL NOTES:

- 1) PRIOR TO BEGINNING ANY EARTHWORK, THE CONTRACTOR SHALL INSTALL SILT CURTAIN PER WI DNR CONSERVATION PRACTICE STANDARD 1070.
- 2) ALL DISTURBED AREAS SHALL BE TOPSOILED, SEEDED WITH TERRACE SEED MIX, AND STABILIZED WITH EROSION CONTROL MATTING, CLASS I, URBAN TYPE A.
- 3) SILT FENCE OR SILT SOCK SHALL BE INSTALLED AS DIRECTED AND THAT THE DISCRETION OF THE CONSTRUCTION ENGINEER.
- 4) TEMPORARY POLYMER STABILIZATION SHALL BE PLACED AS DIRECTED BY THE CONSTRUCTION ENGINEER.
- 5) SILT FENCE SHALL BE PLACED DOWNSTREAM OF ALL STOCKPILE AREAS
- 6) THE PROJECT SITE SHALL BE INSPECTED WITHIN 24 HOURS OF A RAINFALL EXCEEDING 0.5" AND WEEKLY.

SECTION B-B: RUSSELL STREET SHEET PILING

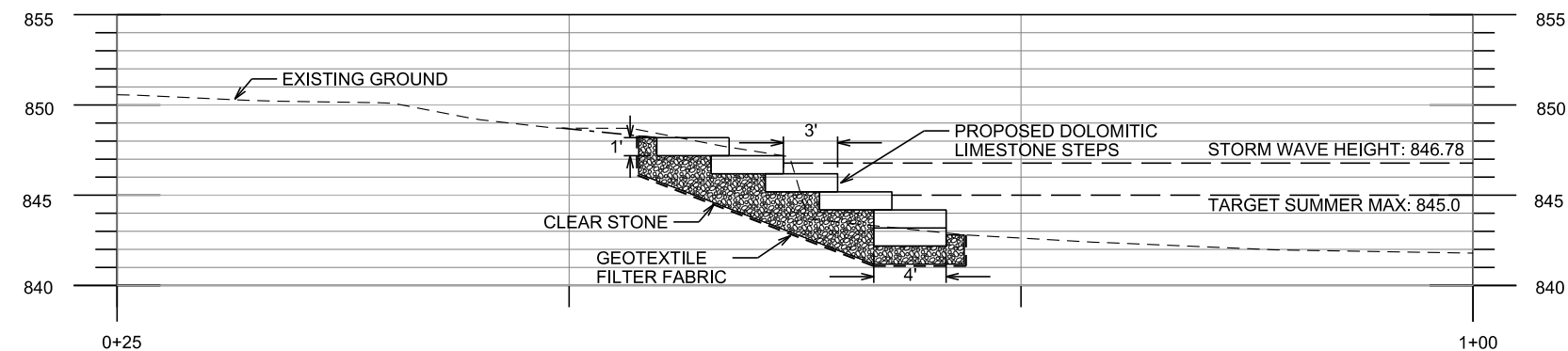

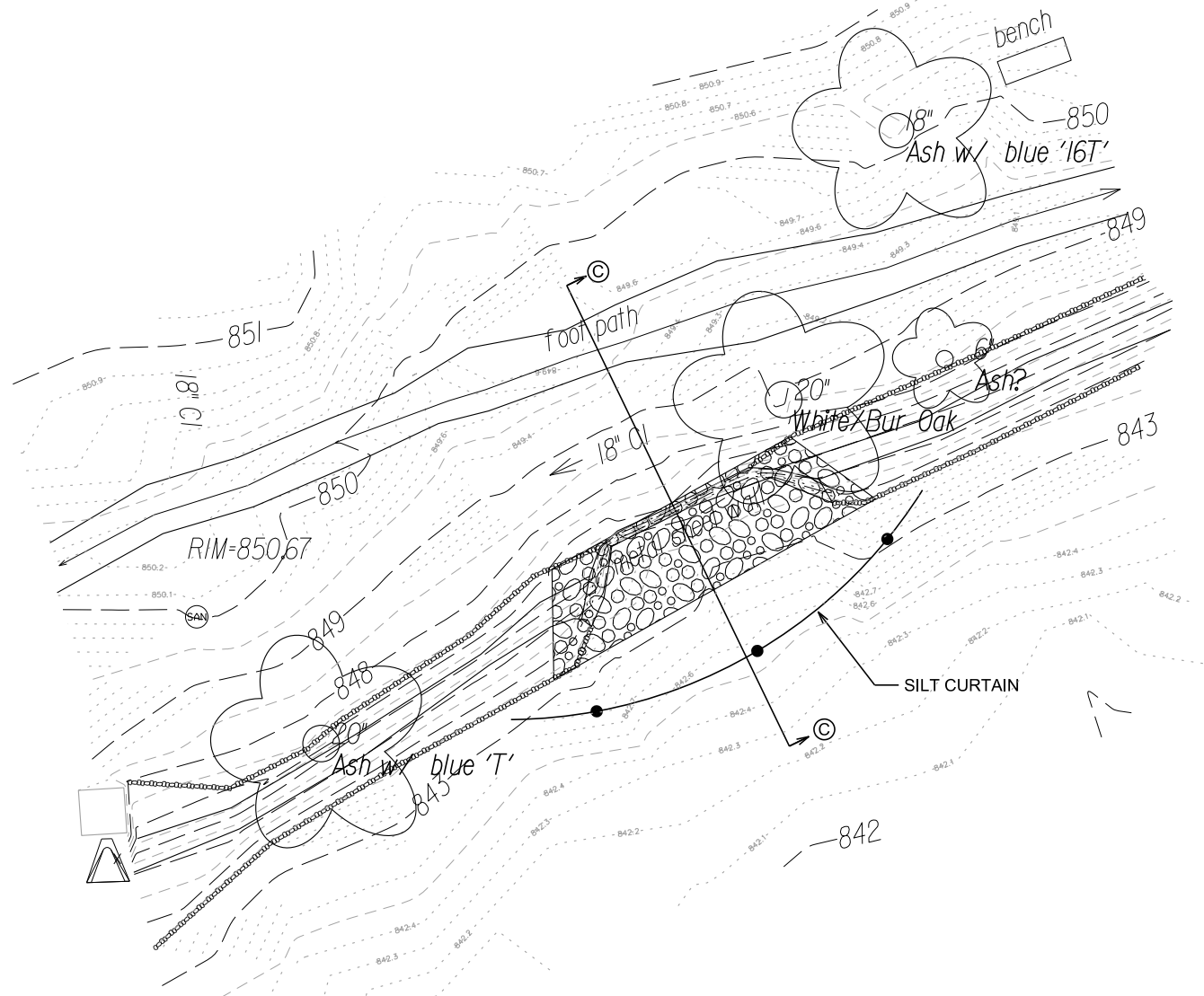

EROSION CONTROL NOTES:

- 1) PRIOR TO BEGINNING ANY EARTHWORK, THE CONTRACTOR SHALL INSTALL SILT CURTAIN PER WI DNR CONSERVATION PRACTICE STANDARD 1070.
- 2) ALL DISTURBED AREAS SHALL BE TOPSOILED, SEEDED WITH TERRACE SEED MIX, AND STABILIZED WITH EROSION CONTROL MATTING, CLASS I, URBAN TYPE A.
- 3) SILT FENCE OR SILT SOCK SHALL BE INSTALLED AS DIRECTED AND THAT THE DISCRETION OF THE CONSTRUCTION ENGINEER.
- 4) TEMPORARY POLYMER STABILIZATION SHALL BE PLACED AS DIRECTED BY THE CONSTRUCTION ENGINEER.
- 5) SILT FENCE SHALL BE PLACED DOWNSTREAM OF ALL STOCKPILE AREAS
- 6) THE PROJECT SITE SHALL BE INSPECTED WITHIN 24 HOURS OF A RAINFALL EXCEEDING 0.5" AND WEEKLY.

SECTION C-C: SCHURZ AVENUE SHEET PILING

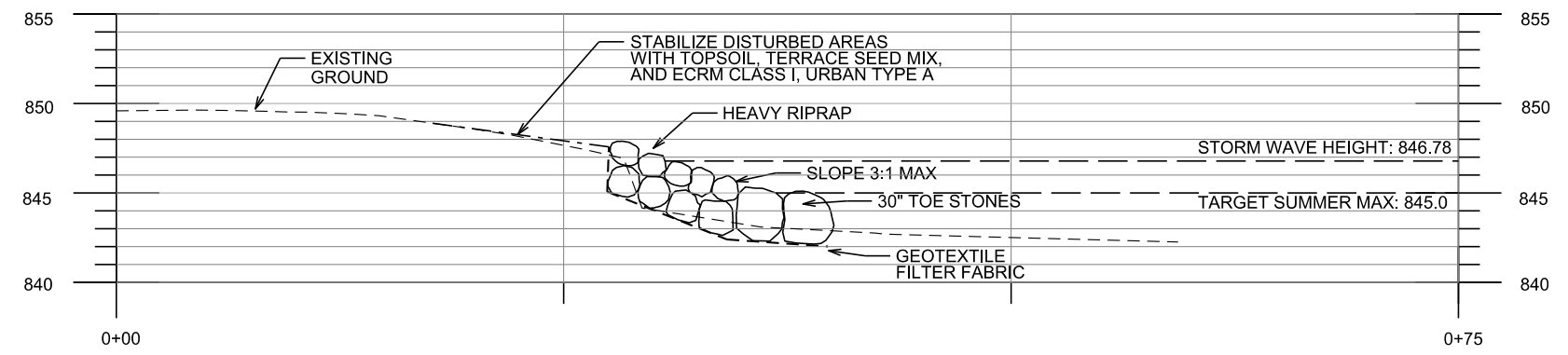

PLOT SCALE: _____

PLOT NAME: _____

REV. DATE: _____

ORIGINATOR: CITY OF MADISON, STREETS DIVISION