

DW-500 - VERTICAL INSTALLATION

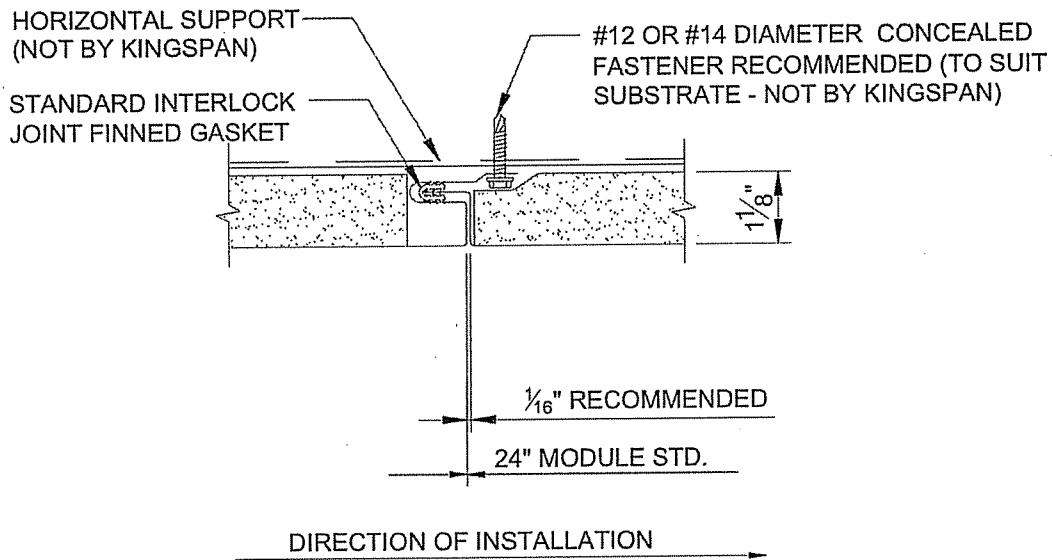
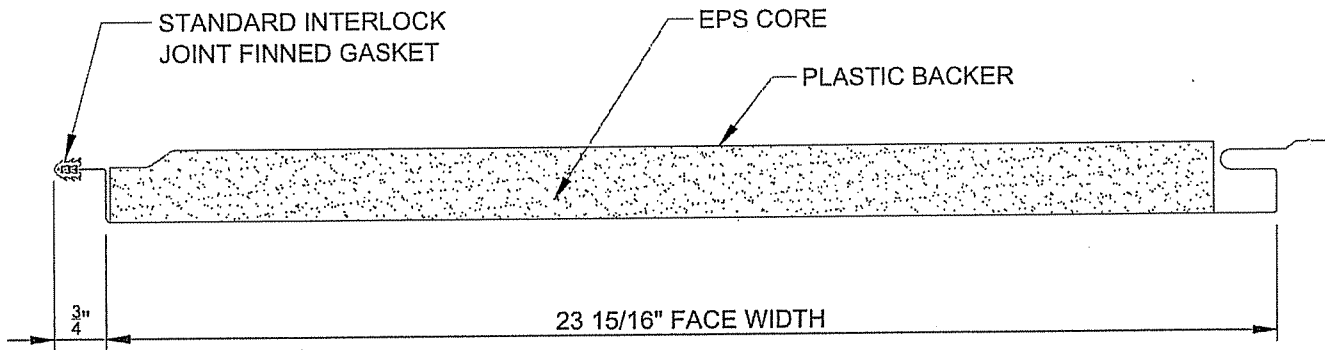

- NOTE:
1. MAXIMUM LENGTH OF PANEL IS 18'-0"
 2. MAXIMUM PANEL MODULE IS 24"
 3. THERMAL BARRIER (SUCH AS GYP. BOARD) SHALL BE PROVIDED AS REQUIRED BY BUILDING CODE. (NOT BY KINGSPAN)

CONTACT KINGSPAN TECHNICAL SERVICES
FOR SPECIFIC PROJECT FASTENING REQUIREMENTS

VERTICAL
PANEL JOINT

DETAIL #: AR-PJ-01-DW5V

DATE: 3/9/11

Kingspan
BENCHMARK
www.kingspanpanels.us
www.kingspanpanels.ca

UPL 4-4-12 No. A

DW-500 - VERTICAL INSTALLATION

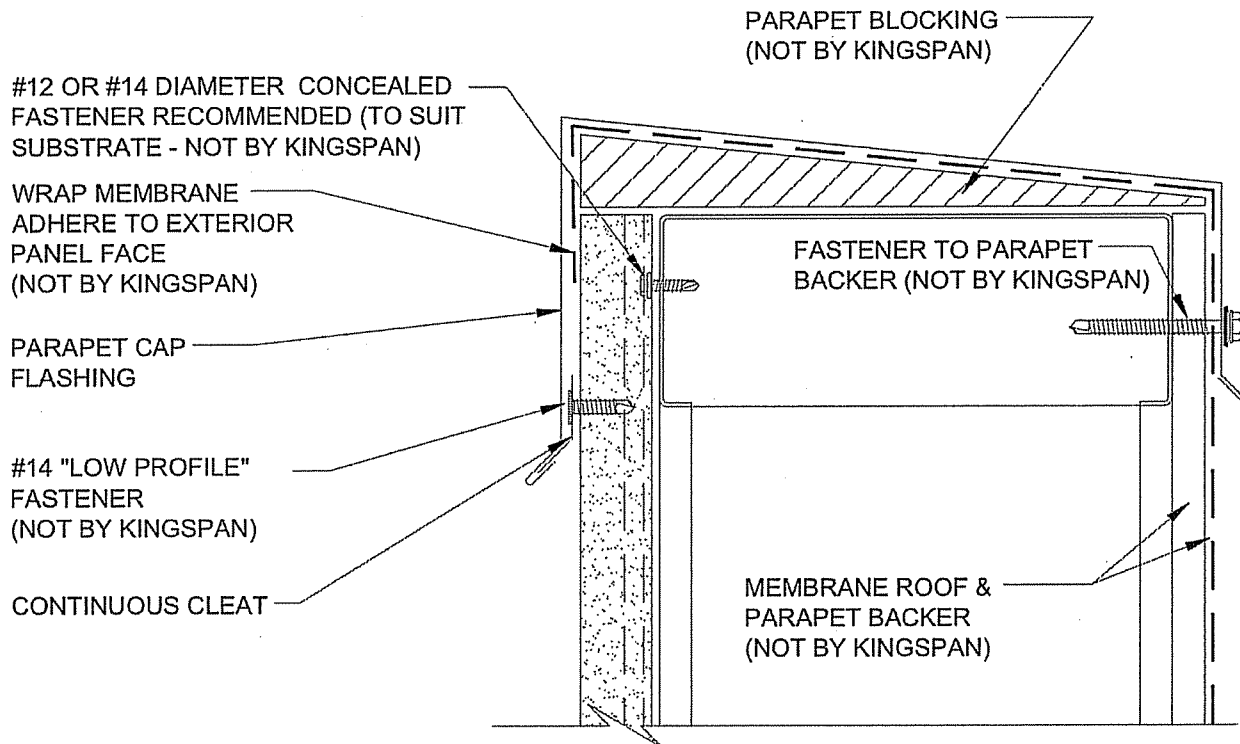

PARAPET W/ FLUSH
TRIM

DETAIL #: AR-PR-01-DW5V

DATE: 3/9/11

Kingspan.
BENCHMARK
www.kingspanpanels.us
www.kingspanpanels.ca

DW-500 - VERTICAL INSTALLATION

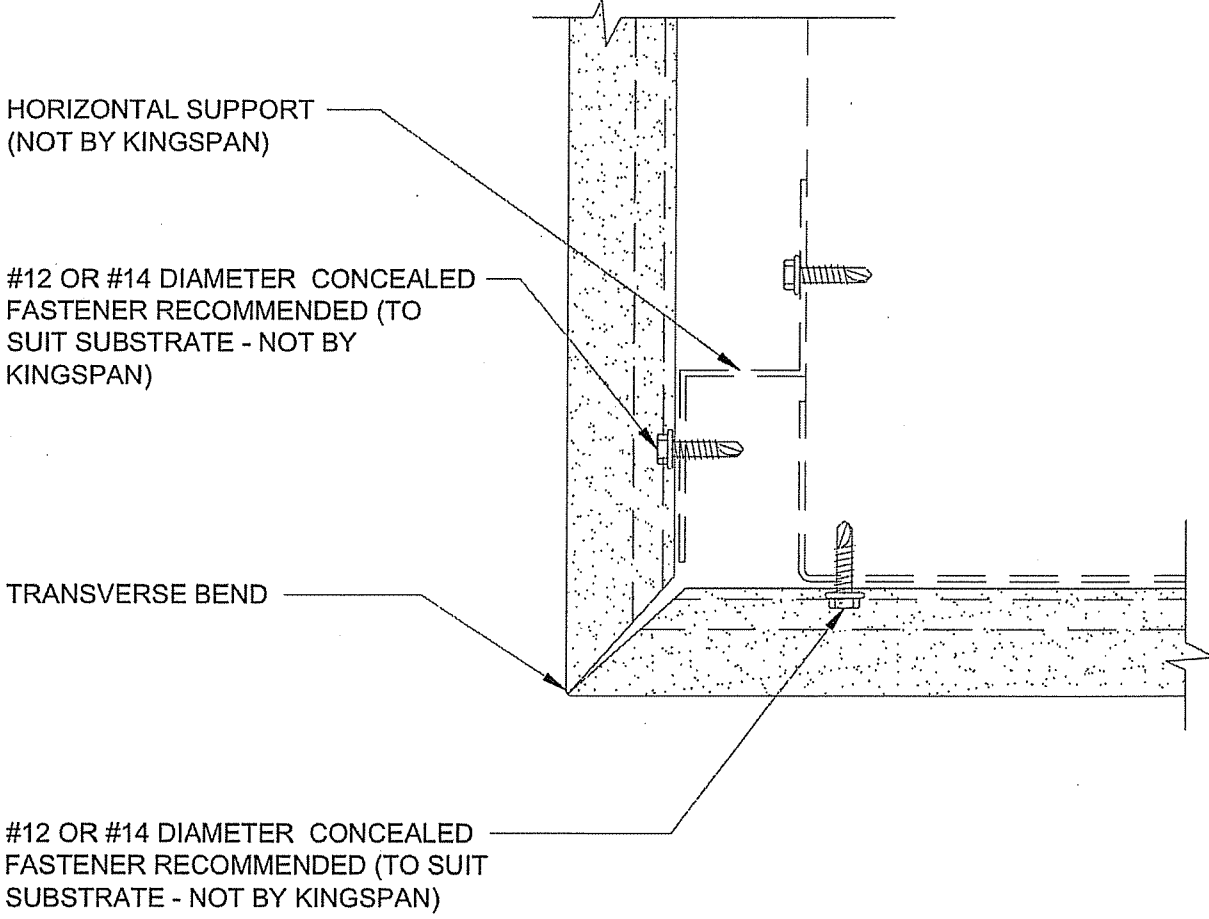

**TRANSVERSE BENT
SOFFIT**

DETAIL #: AR-SF-02-DW5V

DATE: 3/9/11



DW-500 - VERTICAL INSTALLATION

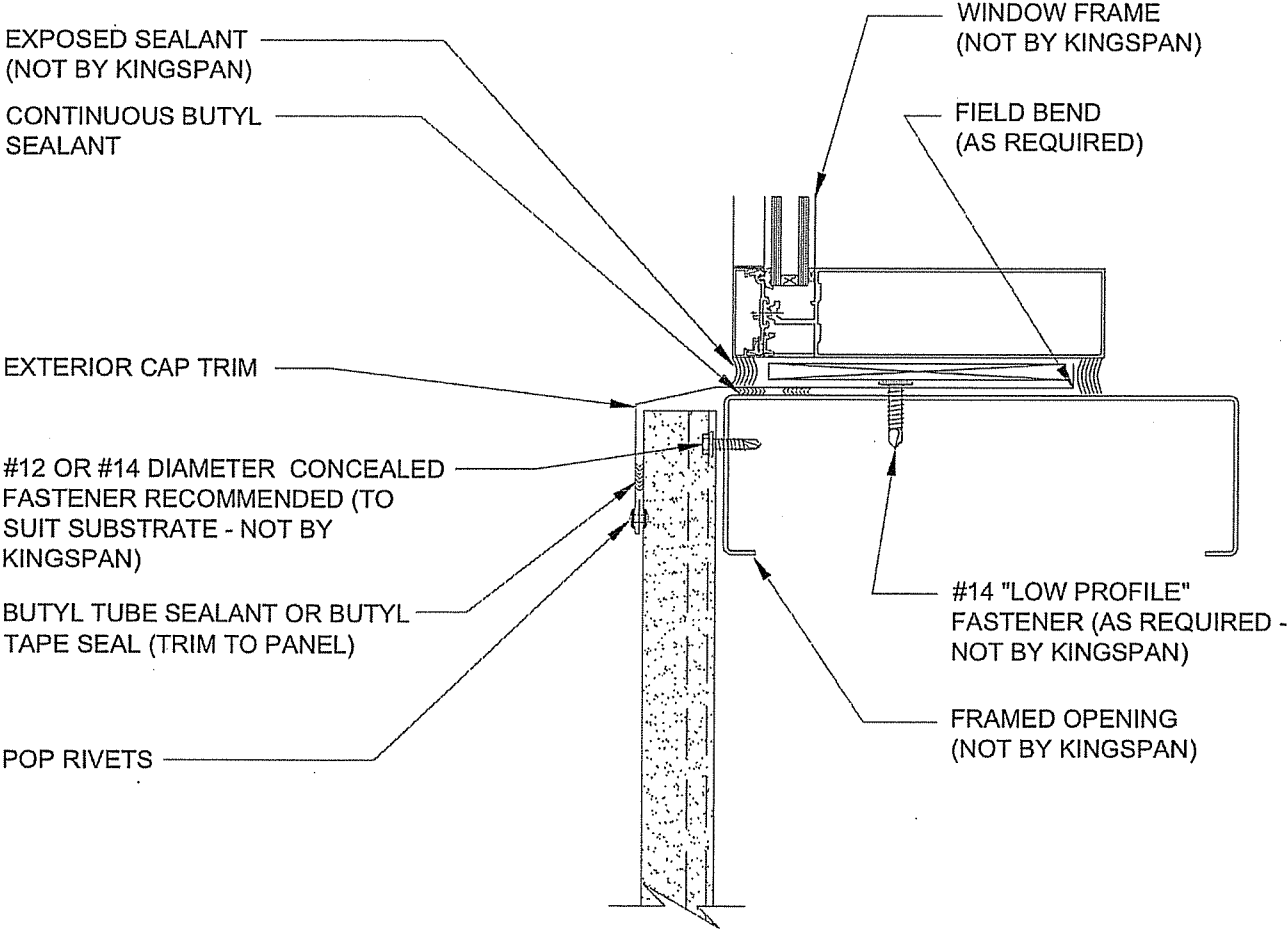

NOTE: SEE DETAIL AR-TL-01-DW5V, AR-TL-02-DW5V, AND AR-TL-03-DW5V FOR TYPICAL TRIM LAP INSTRUCTIONS

F.O. ONE PIECE SILL

DETAIL #: AR-FO-05-DW5V

DATE: 3/9/11

Kingspan.
 BENCHMARK
www.kingspanpanels.us
www.kingspanpanels.ca

DW-500 - VERTICAL INSTALLATION

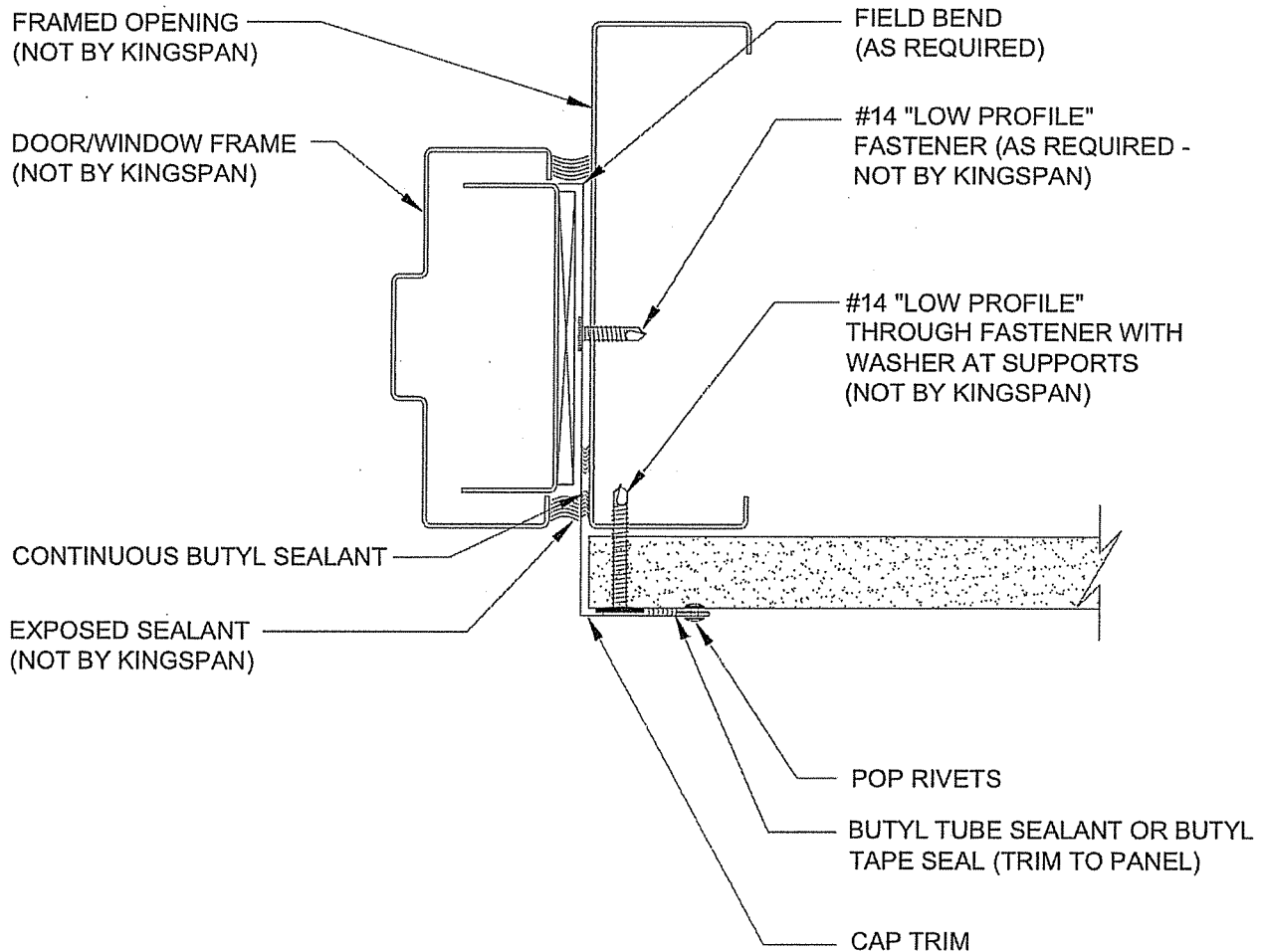

NOTE: SEE DETAIL AR-TL-01-DW5V, AR-TL-02-DW5V, AND AR-TL-03-DW5V
FOR TYPICAL TRIM LAP INSTRUCTIONS

F.O. ONE PIECE JAMB

DETAIL #: AR-FO-04-DW5V

DATE: 3/9/11

Kingspan
BENCHMARK
www.kingspanpanels.us
www.kingspanpanels.ca

DW-500 - VERTICAL INSTALLATION

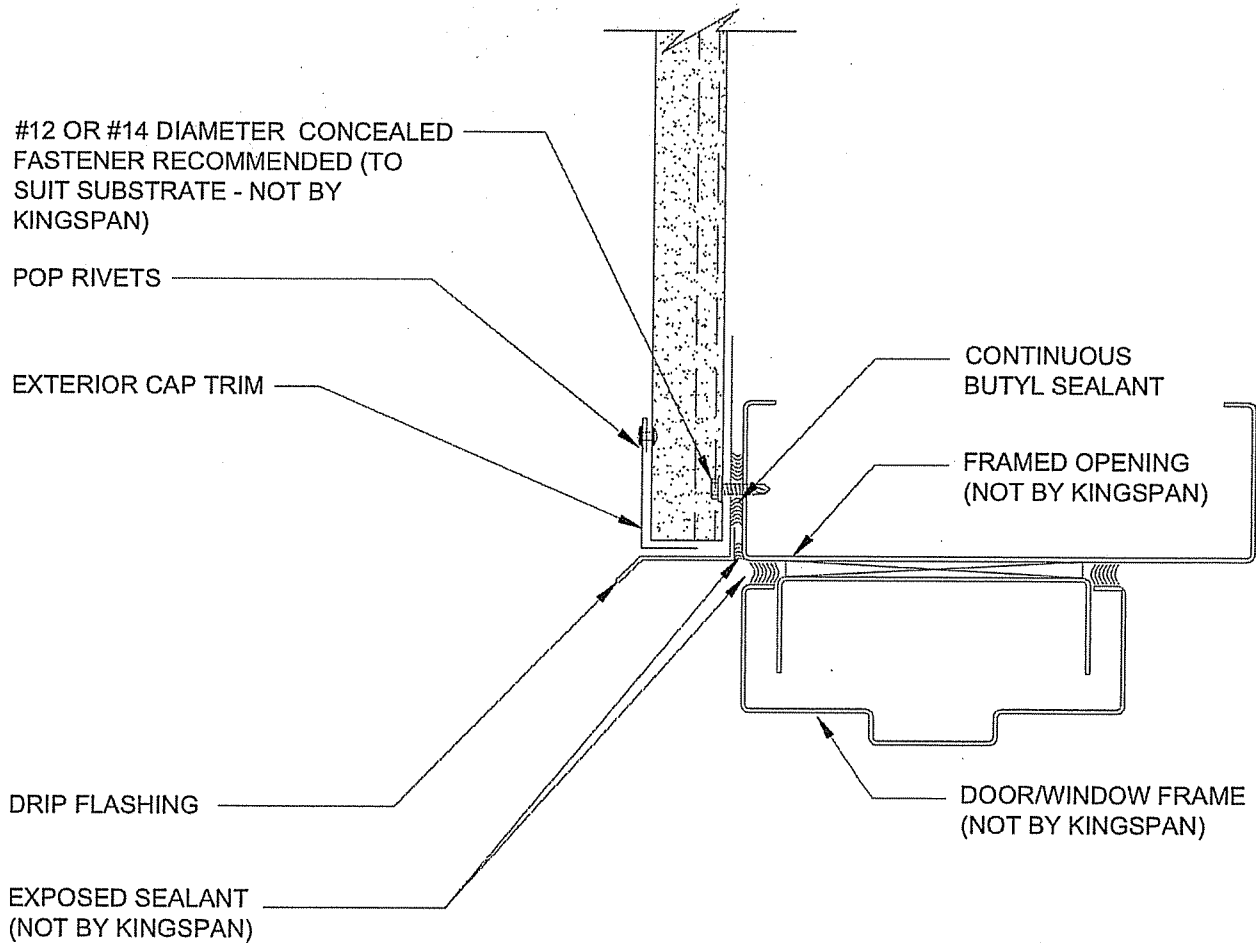

NOTE: SEE DETAIL AR-TL-01-DW5V, AR-TL-02-DW5V, AND AR-TL-03-DW5V FOR TYPICAL TRIM LAP INSTRUCTIONS

F.O. HEAD WITH DRIP
EDGE

DETAIL #: AR-FO-02-DW5V

DATE: 3/9/11

Kingspan
BENCHMARK
www.kingspanpanels.us
www.kingspanpanels.ca

DW-500 - VERTICAL INSTALLATION

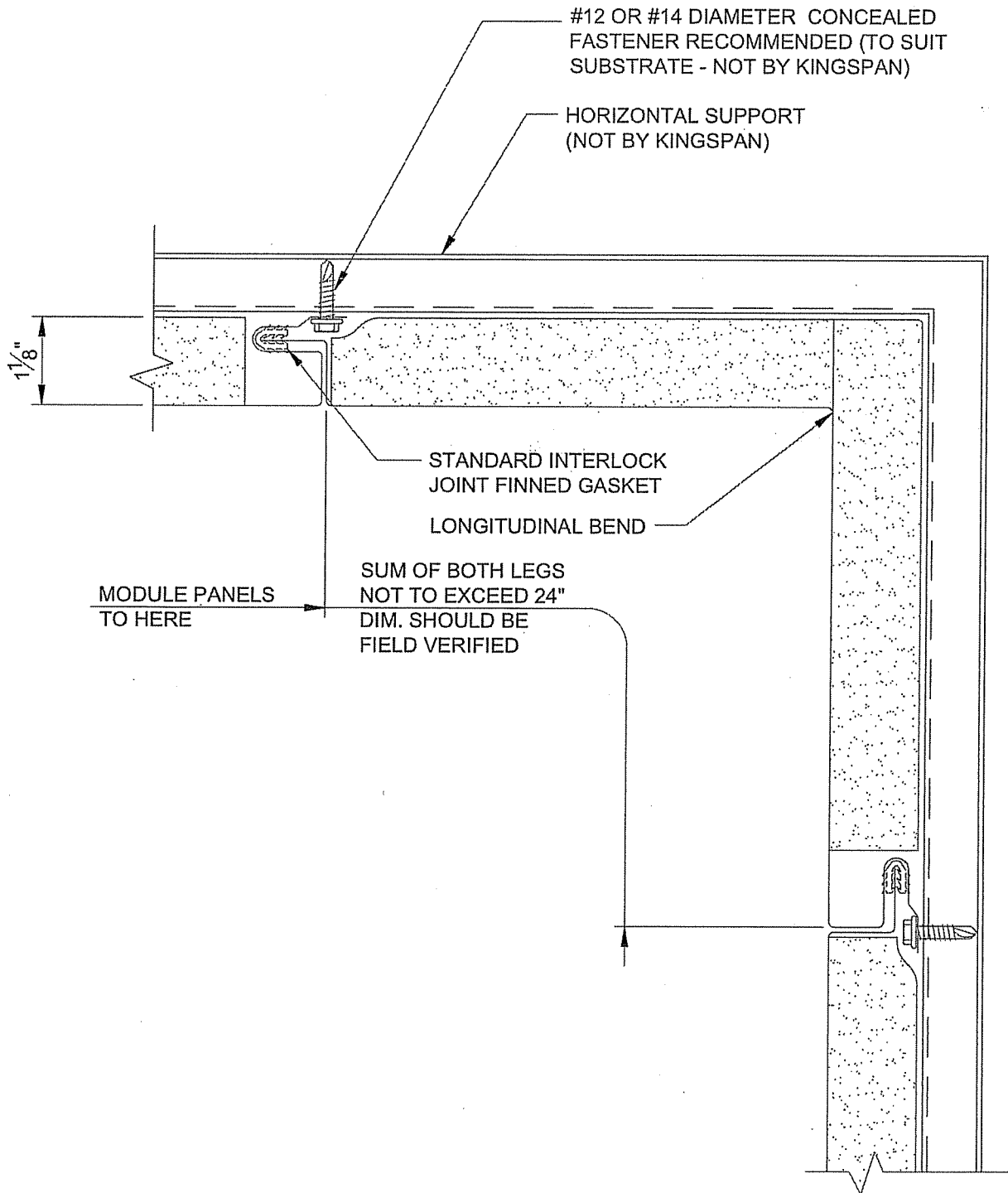

LONGITUDINAL BENT
INSIDE CORNER

DETAIL #: AR-IC-01-DW5V

DATE: 3/9/11

Kingspan
BENCHMARK
www.kingspanpanels.us
www.kingspanpanels.ca

DW-500 - VERTICAL INSTALLATION

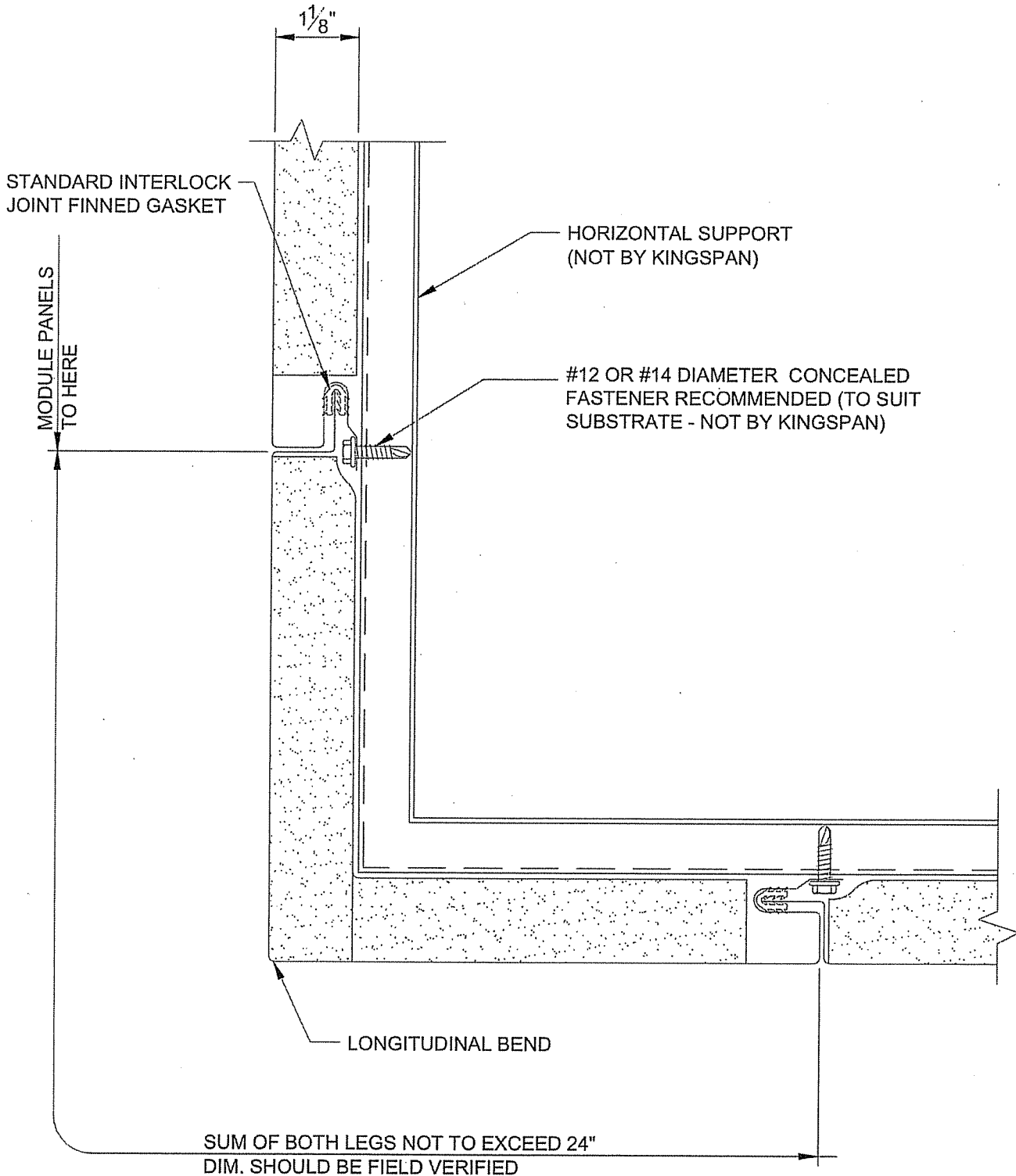

LONGITUDINAL BENT
OUTSIDE CORNER

DETAIL #: AR-OC-01-DW5V

DATE: 3/9/11

Kingspan.
BENCHMARK
www.kingspanpanels.us
www.kingspanpanels.ca

DW-500 - VERTICAL INSTALLATION

#12 OR #14 DIAMETER CONCEALED FASTENER RECOMMENDED (TO SUIT SUBSTRATE - NOT BY KINGSPAN)

BASE TRIM

1/4" DIA. WEEP HOLE
24" O.C. FIELD DRILLED

BASE FLASHING

BED SEAL TO CONCRETE

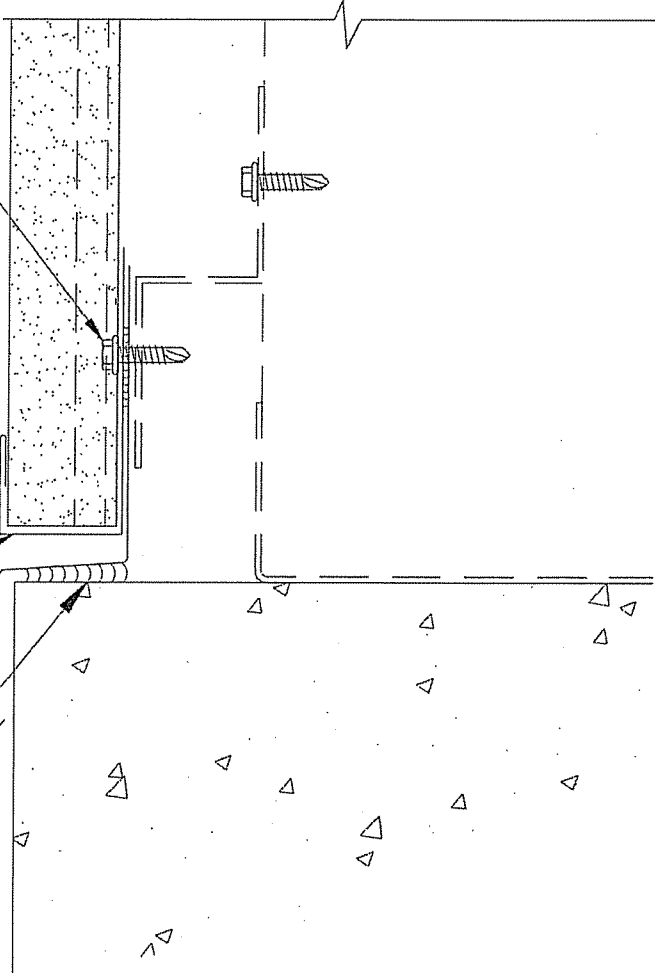

BASE DETAIL - FLUSH

DETAIL #: AR-BS-02-DW5V

DATE: 3/9/11

Kingspan.
BENCHMARK
www.kingspanpanels.us
www.kingspanpanels.ca

DW-500 - VERTICAL INSTALLATION

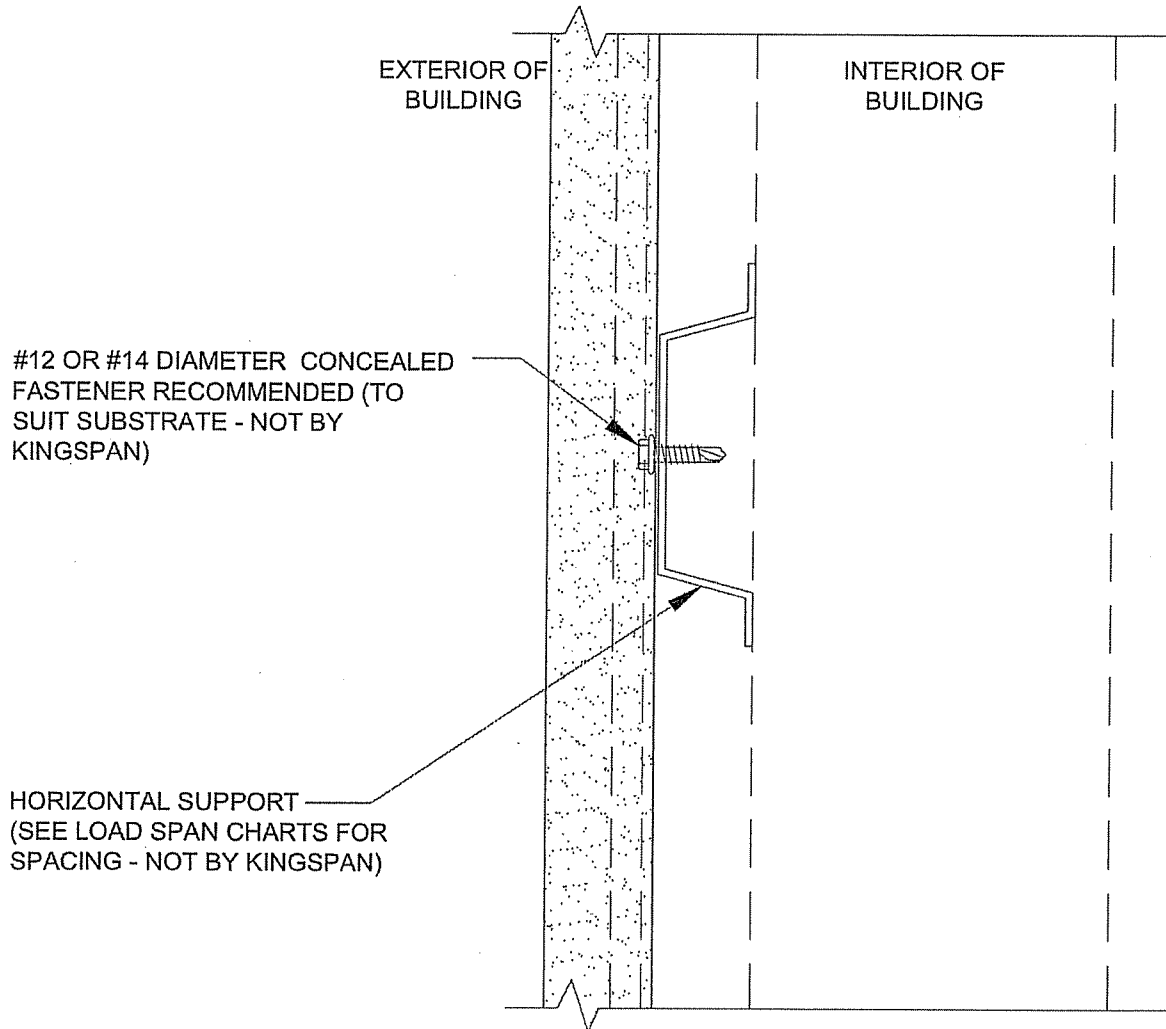

INTERMEDIATE
SUPPORT

DETAIL #: AR-PJ-04-DW5V

DATE: 3/9/11

Kingspan.
BENCHMARK
www.kingspanpanels.us
www.kingspanpanels.ca