



U.S. Department  
of Transportation  
**Federal Transit  
Administration**

REGION V  
Illinois, Indiana,  
Michigan, Minnesota,  
Ohio, Wisconsin

200 West Adams Street  
Suite 320  
Chicago, IL 60606-5253  
312-353-2789  
312-886-0351 (fax)

May 12, 2025

Heather Bailey  
City of Madison, Historic Preservation Planning  
215 Martin Luther King Jr. Blvd.  
PO Box 2985  
Madison, WI 53701

**RE: Section 106 Consulting Party Invitation – Kennedy Road Charging Station (GPS Lat/Long: 43.139938, -89.388253, S26 T8N R9E), On-Route Bus Electric Charger. City of Madison, Dane County, Wisconsin.**

Greetings, Preservation Planner Bailey.

The Federal Transit Administration (FTA), in cooperation with the City of Madison, is proposing the Kennedy Road Charging Station project in Madison, Wisconsin (Project). FTA and the City of Madison will be preparing a Categorical Exclusion document to evaluate the environmental impacts of the Project. As part of its responsibilities under 36 CFR Part 800 – Protection of Historic Properties and the National Historic Preservation Act (NHPA), the FTA is initiating a Section 106 Consultation Process for the Project. A map of the Project area is enclosed and additional information is available at

<https://madison.legistar.com/LegislationDetail.aspx?ID=7024416&GUID=287288CC-760F-4BE2-9E94-B4B12EAFB3ED>

As part of the Project, a station is proposed on the northeast side of Northport Drive immediately northwest of Kennedy Road (Figure 1). The Kennedy Road Charging Station will include a bus pull-out lane with a mountable median separating it from the street an overhead bus charger, electrical building and operator's restroom, and installation of underground utilities (Figure 2). Trees will also be removed with new trees planted in the Project area. Construction will occur between the existing sidewalk and the curb of Kennedy Road, with underground utility connections spanning to the southern terrace. The location does not require right-of-way acquisition.

Section 106 of the National Historic Preservation Act requires federal agencies to take into account the effects of their undertakings on historic properties. This process involves efforts to identify historic properties potentially affected by the undertaking, assess its effects, and seek ways to avoid, minimize or mitigate any adverse effects on historic properties. In accordance with 36 CFR § 800.2(c), you are invited to participate in the Section 106 process as a Consulting Party. As part of the process, the Project team will work through a three-step process with

consulting parties to:

1. Identify historic properties that could be potentially affected by the Project;
2. Assess Project effects on these resources; and
3. If there are adverse effects, develop ways to avoid, minimize, or mitigate adverse effects on historic properties.

Participation in this process is voluntary and open to anyone “*with a demonstrated interest in the effect of the undertaking on properties listed on or eligible for listing on the National Register of Historic Places.*” This may include property owners, business owners, historic preservation groups, neighborhood associations, or others who are interested in historic resources and preservation. Additional information about the consultation process is available online at <http://www.achp.gov/citizensguide.html>.

Your timely response to this invitation will greatly help us incorporate your concerns into Project development. For that purpose, we respectfully request that you respond with your interest to Dan DiGiuseppe *via* email to FTA within thirty (30)-days of receipt of this letter. If you have questions or comments related to the proposed Project, please contact Dan DiGiuseppe of the FTA Regional Office at the address above, by telephone at 312-705-1286 or by email at [Daniell.DiGiuseppe@dot.gov](mailto:Daniell.DiGiuseppe@dot.gov)

Sincerely,



Anthony W. Greep  
Director, Office of Planning and Program Development

cc: William Wheeler, FTA  
Dan DiGiuseppe, FTA  
Anshu Singh, FTA  
Justin Stuehrenberg, City of Madison

Sent by email to [hbailey@cityofmadison.com](mailto:hbailey@cityofmadison.com)

Enclosures: 1) Topographic map of Kennedy Road Project Location  
2) Aerial view map with schematic overlay of Kennedy Road Project Location  
3) APE map of Kennedy Road Project Location

Figure 1. Kennedy Road Proposed Project Location. Excerpted portion of USGS 1:24,000 Topographic Map Waunakee, WI, 2018.

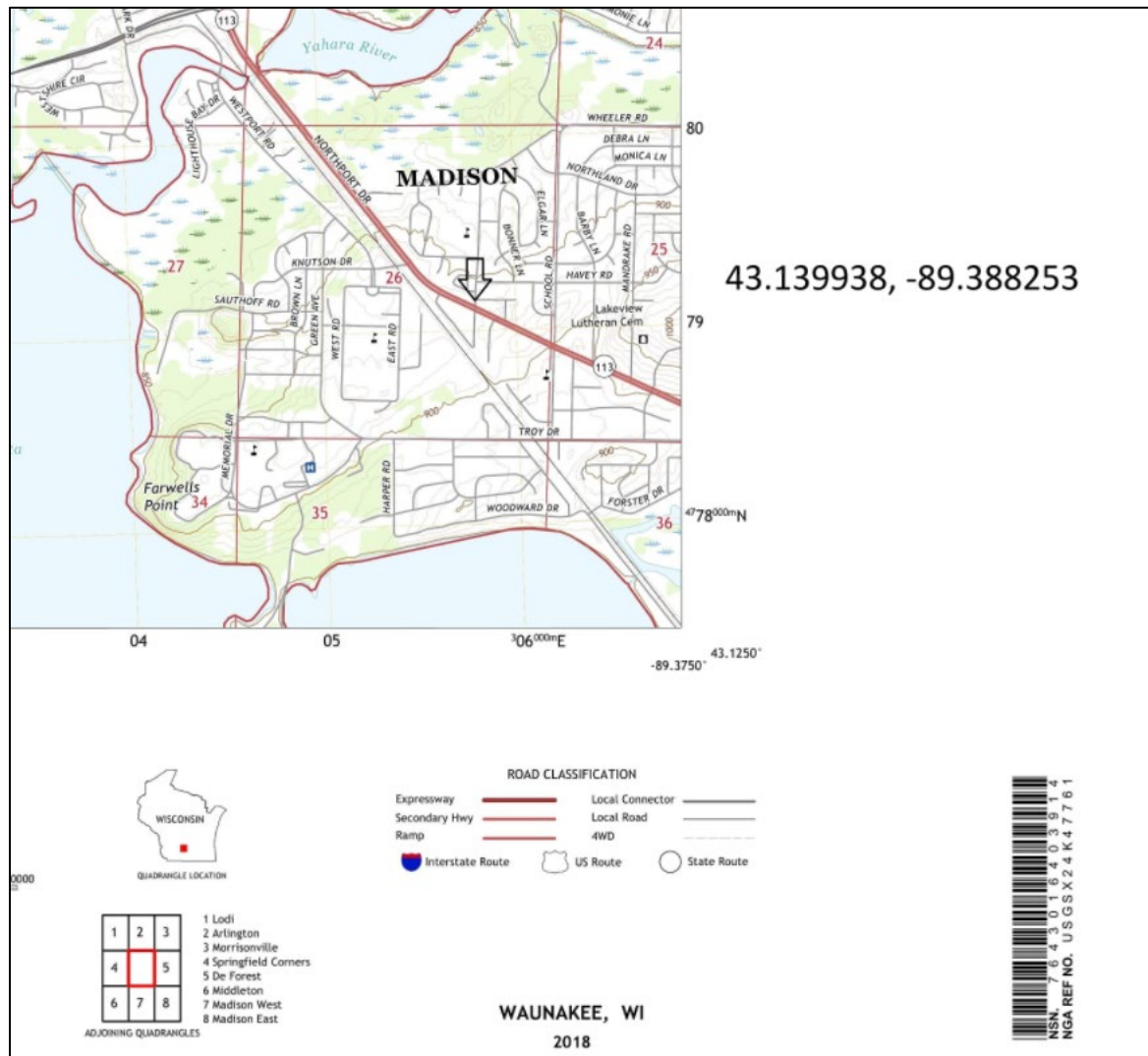

[illegible]



Figure 3. Aerial view location map displaying Kennedy Road and proposed Area of Potential Effects (APE).

