

HAMMERSLEY RD 2022 RESURFACING

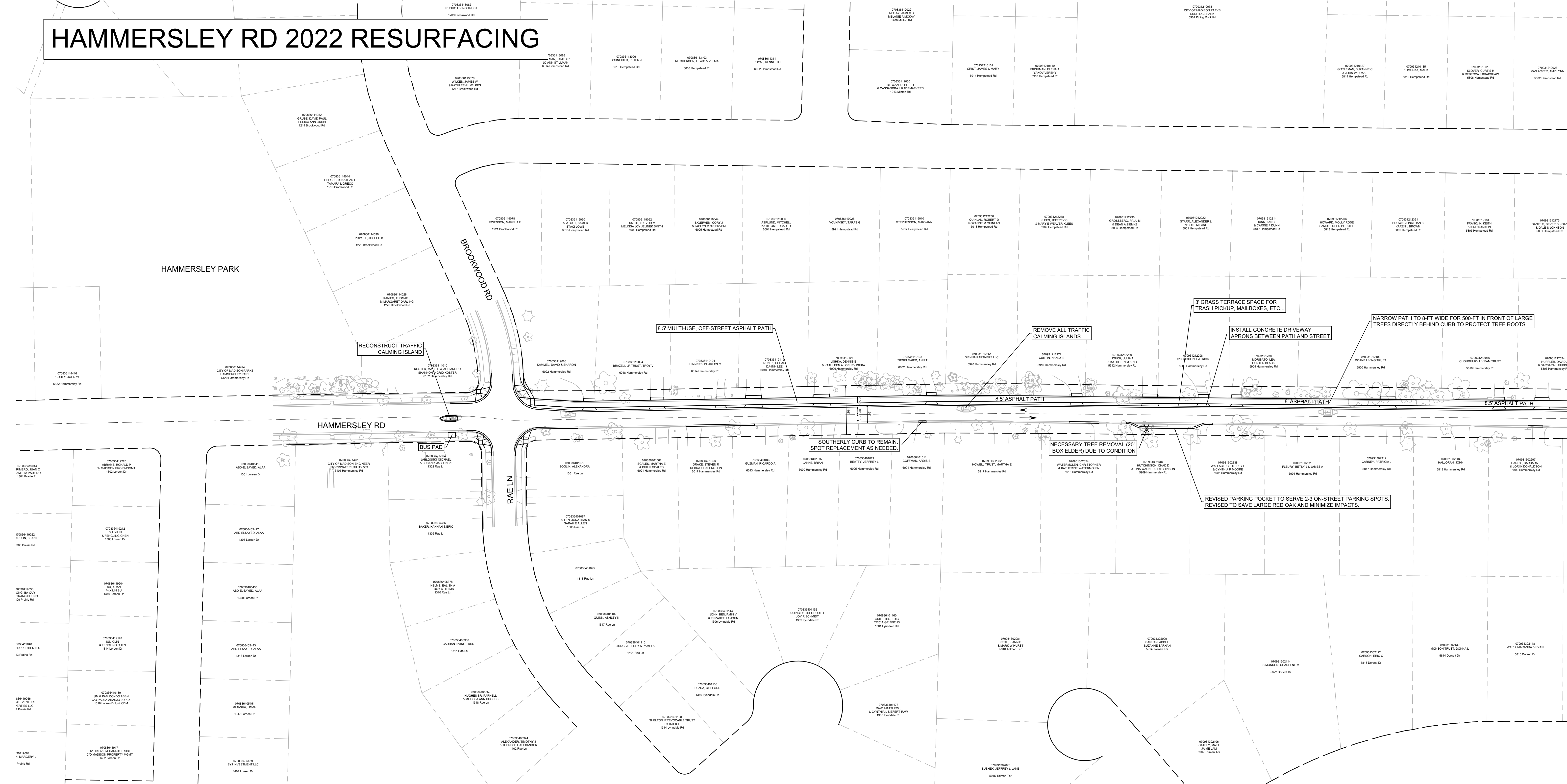

RECONSTRUCT TRAFFIC CALMING ISLAND

8.5' MULTI-USE, OFF-STREET ASPHALT PATH

REMOVE ALL TRAFFIC CALMING ISLANDS

3' GRASS TERRACE SPACE FOR TRASH PICKUP, MAILBOXES, ETC.

INSTALL CONCRETE DRIVEWAY APRONS BETWEEN PATH AND STREET

NARROW PATH TO 8-FT WIDE FOR 500-FT IN FRONT OF LARGE TREES DIRECTLY BEHIND CURB TO PROTECT TREE ROOTS.

8.5' ASPHALT PATH

8' ASPHALT PATH

8.5' ASPHALT PATH

SOUTHERLY CURB TO REMAIN SPOT REPLACEMENT AS NEEDED.

NECESSARY TREE REMOVAL (20' BOX ELDER) DUE TO CONDITION.

REVISED PARKING POCKET TO SERVE 2-3 ON-STREET PARKING SPOTS, REVISED TO SAVE LARGE RED OAK AND MINIMIZE IMPACTS.

HAMMERSLEY RD

BUS PAD

RAE LN

BROOKWOOD RD

HAMMERSLEY PARK

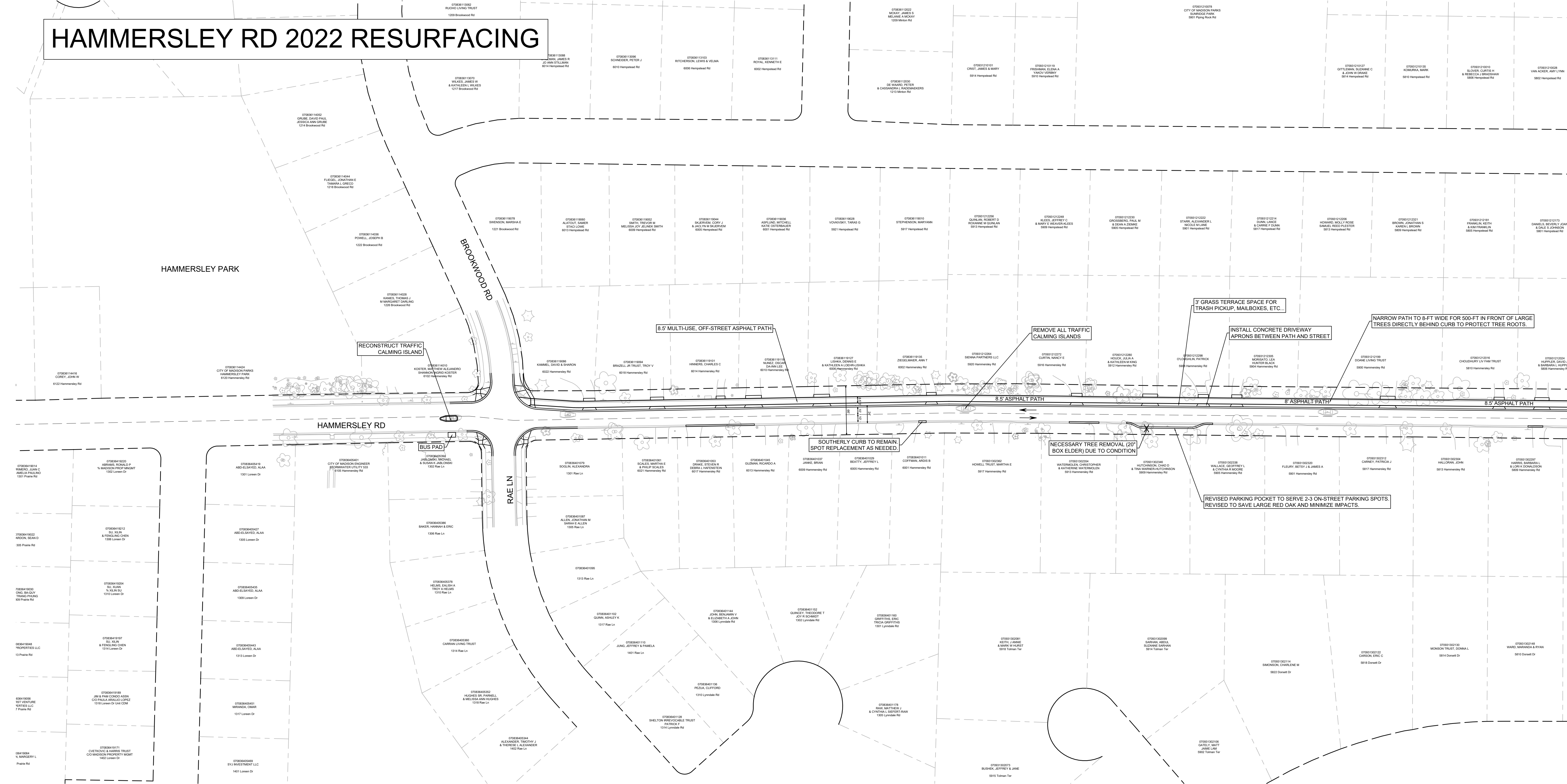

HAMMERSLEY RD 2022 RESURFACING

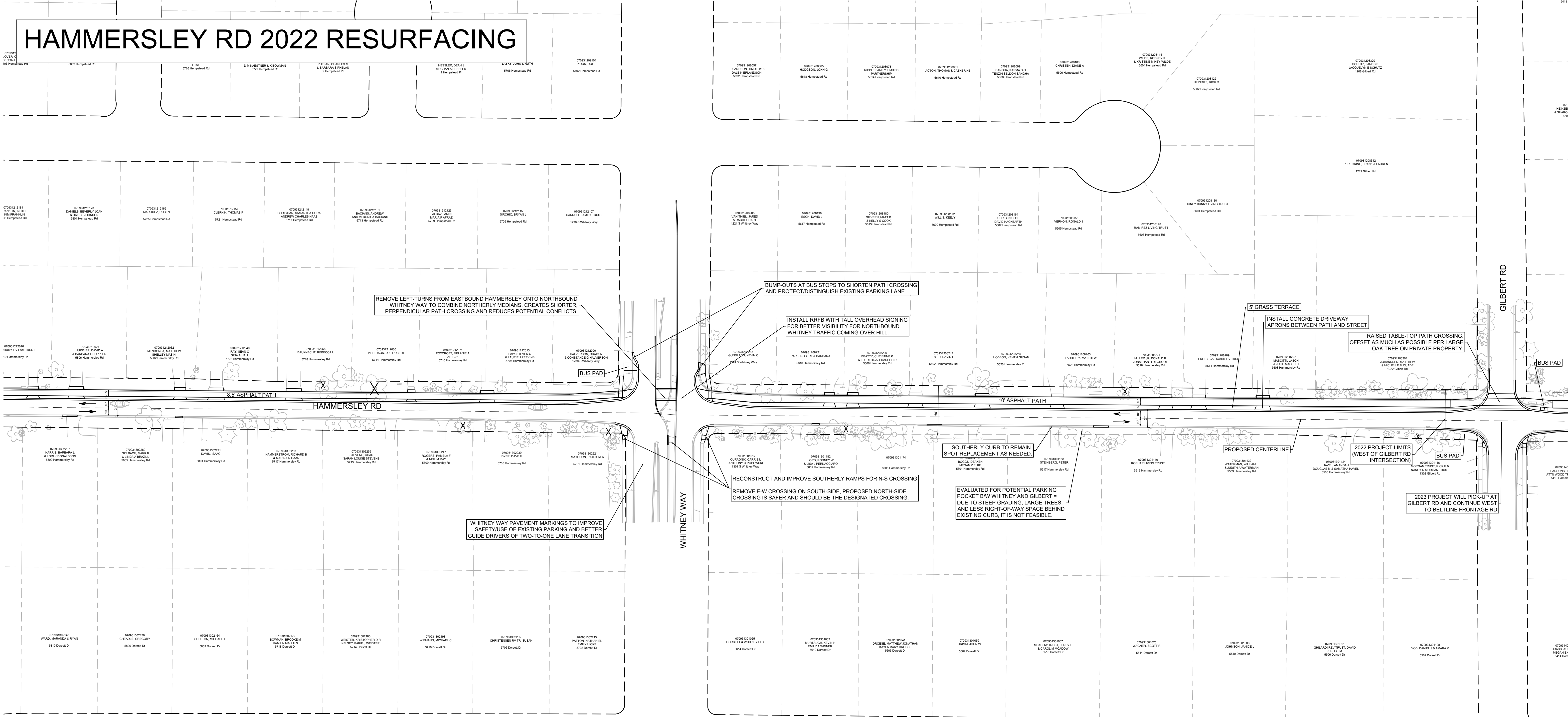

REMOVE LEFT-TURNS FROM EASTBOUND HAMMERSLEY ONTO NORTHBOUND WHITNEY WAY TO COMBINE NORTHERLY MEDIANS. CREATES SHORTER PERPENDICULAR PATH CROSSING AND REDUCES POTENTIAL CONFLICTS.

BUMP-OUTS AT BUS STOPS TO SHORTEN PATH CROSSING AND PROTECT/DISTINGUISH EXISTING PARKING LANE

INSTALL RFB WITH TALL OVERHEAD SIGNING FOR BETTER VISIBILITY FOR NORTHBOUND WHITNEY TRAFFIC COMING OVER HILL.

5' GRASS TERRACE

INSTALL CONCRETE DRIVEWAY APRONS BETWEEN PATH AND STREET

RAISED TABLE-TOP PATH CROSSING OFFSET AS MUCH AS POSSIBLE PER LARGE OAK TREE ON PRIVATE PROPERTY

WHITNEY WAY PAVEMENT MARKINGS TO IMPROVE SAFETY/USE OF EXISTING PARKING AND BETTER GUIDE DRIVERS OF TWO-TO-ONE LANE TRANSITION

RECONSTRUCT AND IMPROVE SOUTHERLY RAMP FOR N-S CROSSING REMOVE E-W CROSSING ON SOUTH-SIDE, PROPOSED NORTH-SIDE CROSSING IS SAFER AND SHOULD BE THE DESIGNATED CROSSING.

SOUTHERLY CURB TO REMAIN SPOT REPLACEMENT AS NEEDED

EVALUATED FOR POTENTIAL PARKING POCKET BY WHITNEY AND GILBERT - DUE TO STEEP GRADING, LARGE TREES, AND LESS RIGHT-OF-WAY SPACE BEHIND EXISTING CURB, IT IS NOT FEASIBLE.

PROPOSED CENTERLINE

2022 PROJECT LIMITS (WEST OF GILBERT RD INTERSECTION)

2023 PROJECT WILL PICK-UP AT GILBERT RD AND CONTINUE WEST TO BELTLINE FRONTAGE RD