

SCHEDULE OF LANDS & INTERESTS REQUIRED

OWNER'S NAMES ARE SHOWN FOR REFERENCE PURPOSES ONLY AND ARE SUBJECT TO CHANGE PRIOR TO THE TRANSFER OF LAND INTERESTS TO THE DEPARTMENT

PARCEL NUMBER	OWNER (S)	INTEREST REQUIRED	R/W S.F. REQUIRED			TLE S.F.	HE S.F.
			NEW	EXISTING	TOTAL		
2	RAYMOND C. ZEIER & LORAIN A. ZEIER	FEE, TLE	148,815	18,841	167,656	33,390	-
3	WISCONSIN AND SOUTHERN RAILROAD COMPANY	H.E.	-	-	-	-	21,730
5	J & M MADISON, LLC.	FEE, TLE	2,530	-	2,530	1,040	-
40	AMERICAN TRANSMISSION COMPANY, LLC	RELEASE OF RIGHTS	-	-	-	-	-

TRANSPORTATION PROJECT PLAT NO: 53B0790 - 4.01

THAT PART OF THE SE 1/4 OF THE SW 1/4 OF SECTION 27 TOWNSHIP 8 NORTH, RANGE 10 EAST, AND PART OF THE NE 1/4 OF THE NW 1/4 OF SECTION 34, TOWNSHIP 8 NORTH, RANGE 10 EAST, ALL IN THE CITY OF MADISON, DANE COUNTY, WISCONSIN.

RELOCATION ORDER LEIN ROAD ROUNDABOUT DANE, COUNTY

TO PROPERLY ESTABLISH, LAY OUT, WIDEN, ENLARGE, EXTEND, CONSTRUCT, RECONSTRUCT, IMPROVE, OR MAINTAIN A PORTION OF THE HIGHWAY DESIGNATED ABOVE, THE CITY OF MADISON DEEMS IT NECESSARY TO RELOCATE OR CHANGE SAID HIGHWAY AND ACQUIRE CERTAIN LANDS AND INTERESTS OR RIGHTS IN LANDS FOR THE ABOVE NAMED PROJECT.

TO EFFECT THIS CHANGE, PURSUANT TO AUTHORITY GRANTED UNDER SECTION 84.02 (3) AND 84.09, WISCONSIN STATUTES, THE CITY OF MADISON HEREBY ORDERS THAT:

1. THAT PORTION OF SAID HIGHWAY AS SHOWN ON THIS PLAT IS LAID OUT AND ESTABLISHED TO THE LINES AND WIDTHS AS SO SHOWN FOR THE ABOVE PROJECT.
2. THE LANDS OR INTERESTS OR RIGHTS IN LANDS AS SHOWN ON THIS PLAT ARE REQUIRED BY THE CITY FOR THE ABOVE PROJECT AND SHALL BE ACQUIRED IN THE NAME OF THE CITY OF MADISON, PURSUANT TO THE PROVISIONS OF SECTION 84.09 (1) OR (2), WISCONSIN STATUTES.

CONVENTIONAL UTILITY SYMBOLS

UTILITY POLE	COMPENSABLE	NON COMPENSABLE
TELEPHONE PEDESTAL	☒	☒
WATER	—	—
GAS	—	—
TELEPHONE	—	—
OVERHEAD TRANSMISSION LINES	—	—
ELECTRIC	—	—
CABLE TELEVISION	—	—
FIBER OPTIC	—	—
SANITARY SEWER	—	—

CONVENTIONAL ABBREVIATIONS

ACCESS POINT	AP	MONUMENT	MON
ACCESS RIGHTS	AR	PAGE	P
ACRES	AC	PERMANENT LIMITED EASEMENT	PLE
AND OTHERS	ET AL	PROPERTY LINE	PL
CENTER LINE	CL	RECORDED AS	(101)
CERTIFIED SURVEY MAP	CSM	REFERENCE LINE	R
CORNER	COR	REMAINING	REM
CONVEYANCE OF RIGHTS	CR	RIGHT-OF-WAY	R/W
DOCUMENT	DOC	SECTION	SEC
EASEMENT	EASE	SQUARE FEET	S.F.
HIGHWAY EASEMENT	H.E.	STATION	STA
LAND CONTRACT	LC	TEMPORARY LIMITED EASEMENT	TLE
		VOLUME	V

CONVENTIONAL SYMBOLS

IRON PIPE OR PIN	IP	LOT & TIE LINES	---
R/W MONUMENT	(IP)	SLOPE INTERCEPTS	---
OFF PREMISE SIGN	(IP)	SECTION LINE	---
SECTION CORNER SYMBOL	(IP)	QUARTER LINE	---
		SIXTEENTH LINE	---
		EXISTING CENTER LINE	---
FEE (HATCH VARIES)	▨	CORPORATE LIMITS	---
TEMPORARY LIMITED EASEMENT	▨	PROPERTY CONNECTOR/SAME OWNER	---
PERMANENT LIMITED EASEMENT	▨	PARALLEL OFFSET	---
R/W BOUNDARY POINT	(IP)	ACCESS RESTRICTED (BY PREVIOUS PROJECT/CONTROL)	---
BUILDING	B	NO ACCESS (BY ACQUISITION)	---
BUILDING TO BE RAZED	B	NO ACCESS (BY STATUTORY AUTHORITY)	---
PROPOSED R/W LINE	---		
EXISTING R/W OR H.E. LINE	---		
PROPERTY LINE	---		

NOTES:
ALL FIELD DATA PROVIDED BY THE CITY OF MADISON.

COORDINATES AND BEARINGS ON THE PLAT ARE REFERENCED TO THE WISCONSIN COUNTY COORDINATE SYSTEM, LANGLADE COUNTY, (ENGLISH), NAD 1983 (1991) ADJUSTMENT. DISTANCES ARE GROUND LENGTH.

RIGHT-OF-WAY MONUMENTS ARE TYPE 2 (3/4" REBAR) AND WILL BE PLACED PRIOR TO THE COMPLETION OF THE PROJECT.

RIGHT-OF-WAY BOUNDARIES ARE DEFINED WITH COURSES OF THE PERIMETER OF THE HIGHWAY LANDS REFERENCED TO THE U.S. PUBLIC LAND SURVEY OR OTHER SURVEYS OF RECORD.

PROPERTY LINES SHOWN ON THIS PLAT ARE DRAWN FROM MAPS AND DOCUMENTS OF PUBLIC RECORD AND/OR EXISTING OCCUPATIONAL LINES. EXCLUDING RIGHT-OF-WAY BOUNDARIES, THIS PLAT MAY NOT BE A TRUE REPRESENTATION OF EXISTING PROPERTY LINES AND SHOULD NOT BE USED AS A SUBSTITUTE FOR AN ACCURATE FIELD SURVEY.

A TEMPORARY LIMITED EASEMENT (TLE) IS A RIGHT FOR CONSTRUCTION PURPOSES, AS DEFINED HEREIN, INCLUDING THE RIGHT TO OPERATE NECESSARY EQUIPMENT THEREON AND THE RIGHT OF INGRESS AND EGRESS, AS LONG AS REQUIRED FOR SUCH PUBLIC PURPOSE, INCLUDING THE RIGHT TO PRESERVE, PROTECT, REMOVE, OR PLANT THEREON ANY VEGETATION THAT THE HIGHWAY AUTHORITIES MAY DEEM NECESSARY OR DESIRABLE. THIS EASEMENT IS TO TERMINATE ON DECEMBER 31, 2013 OR THE DATE THE CONSTRUCTION OF THE PROJECT IS COMPLETED, WHICHEVER OCCURS FIRST.

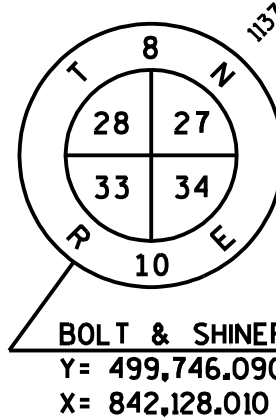
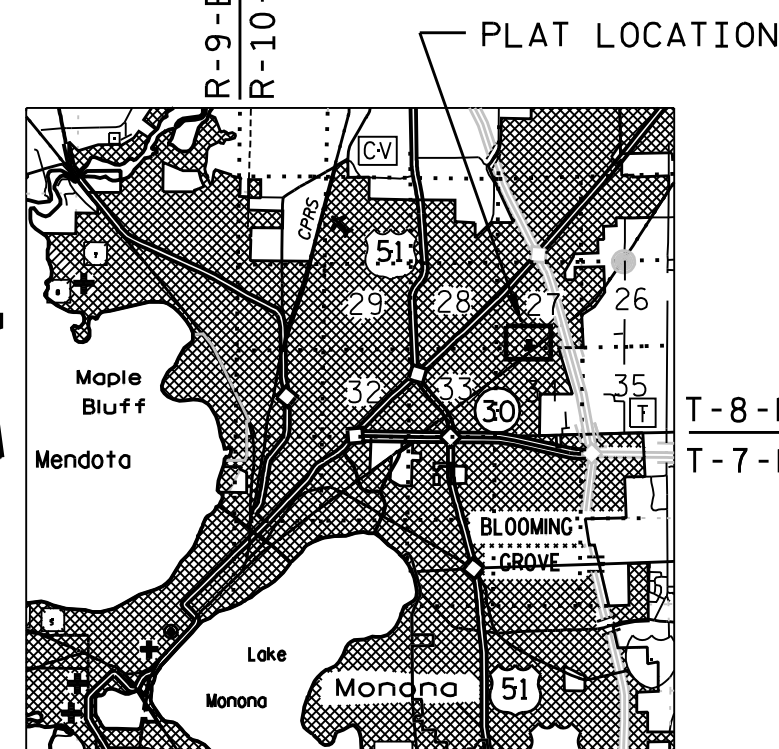

R/W COURSE TABLE

COURSE	BEARING	DISTANCE
522-607	N00°59'44"W	94.51'
607-542	S89°00'16"W	110.11'
542-541	N00°59'45"W	40.00'
539-610	N00°03'41"W	37.29'
610-611	N45°13'22"E	55.91'
612-613	N27°51'46"W	119.72'
613-615	N00°03'41"W	263.35'
616-617	S30°21'10"E	244.33'

STATION & OFFSET TABLE

POINT NUMBER	STATION	OFFSET
512	13+49.72	148.47'
600	397+97.46	39.00'
601	398+22.24	46.60'
602	398+49.69	51.09'
603	398+88.62	63.06'
629	399+08.85	71.90'

R/W BASIS OF EXISTING R/W

A	LAND TRANSFER TO CITY OF MADISON, DOC. *2246456
B	LANDS DEDICATED, CSM 9565, DOC *3183321
C	UNRECORDED HIGHWAY, STAT. 82.31 (2)
D	LANDS DEDICATED, PLAT OF REGIONAL EAST PHASE II, VOL. 56-31B, PLATS, P. 88
E	UNRECORDED HIGHWAY, STAT. 82.31 (2), ALSO CITY OF MADISON MAP RECORDS
F	LANDS DEDICATED, CSM 5324
G	LAND TRANSFER TO CITY OF MADISON, DOC. *4135700



APPROVED FOR CITY OF MADISON		
RELOCATION ORDER APPROVED BY THE COMMON COUNCIL	RELOCATION ORDER APPROVED BY THE PLAN COMMISSION	RELOCATION ORDER APPROVED BY THE BOARD OF PUBLIC WORKS
DATE: _____ CITY CLERK	DATE: _____ EXECUTIVE SECRETARY	DATE: _____ EXECUTIVE SECRETARY



DATE: 11-18-2008 (SIGNATURE) _____
DUANE A. HOLMAN
AGENT FOR SEH, INC.
REG. NUMBER S-1294

REGISTERED FOR REGISTER OF DEEDS PROJECT NUMBER 53B0790-4.01
ACCEPTED FOR RECORDING AND FILING IN THE OFFICE OF THE REGISTER OF DEEDS IN _____ COUNTY, WISCONSIN AT _____ M ON _____ AND FILED IN _____
SIGNATURE OF REGISTER OF DEEDS