

WILDE EAST TOWNE HONDA

5555 HIGH CROSSING BLVD. - MADISON, WI

- OWNER**
WILDE EAST TOWNE HONDA
1710 HWY 164
WAUKESHA, WI 53188
PHONE: (262) 542-3800
FAX: (262) 970-7388
- PROJECT COUNSEL**
KEVIN A. DELCOREY
QUARLES & BRADY LLP
33 EAST MAIN STREET
P.O. BOX 2111 EASTWISCONSIN
PHONE: (608) 283-4224
FAX: (608) 294-4808
- ARCHITECT**
ERIK L. MADSEN, AIA
828 N. BRADY AVE., SUITE 206
WAUKESHA, WI 53188
PHONE: (414) 277-8900
FAX: (414) 283-5559
WWW.MADSENARCHITECTS.COM
- DESIGN CONSULTANT**
COLLABORATIVE DESIGN
1601 HWY. 164 SOUTH
WAUKESHA, WI 53188
PHONE: (262) 547-1878
FAX: (262) 547-3472
STAFF@COLLABORATIVEDESIGN.COM
- CIVIL ENGINEER**
CAPITOL SURVEY & ENGINEERING, LLC
20875 CROSSROADS CIRCLE, SUITE 950
WAUKESHA, WI 53188
PHONE: (262) 439-4800
FAX: (262) 439-4810
WWW.CAPITOLSURVEY.COM
- LANDSCAPE ARCHITECT**
DURHAM HILL
599 W12707 LOOMIS RD
MUSKEGON, WI 53150
PHONE: (414) 528-5262
WWW.DURHAMHILLLANDSCAPE.COM
- LIGHTING DESIGNER**
PREFERRED ELECTRICAL CONTRACTORS
2450 S. 762ND STREET
NEW BERLIN, WI 53151
PHONE: (262) 784-8580
FAX: (262) 784-9339

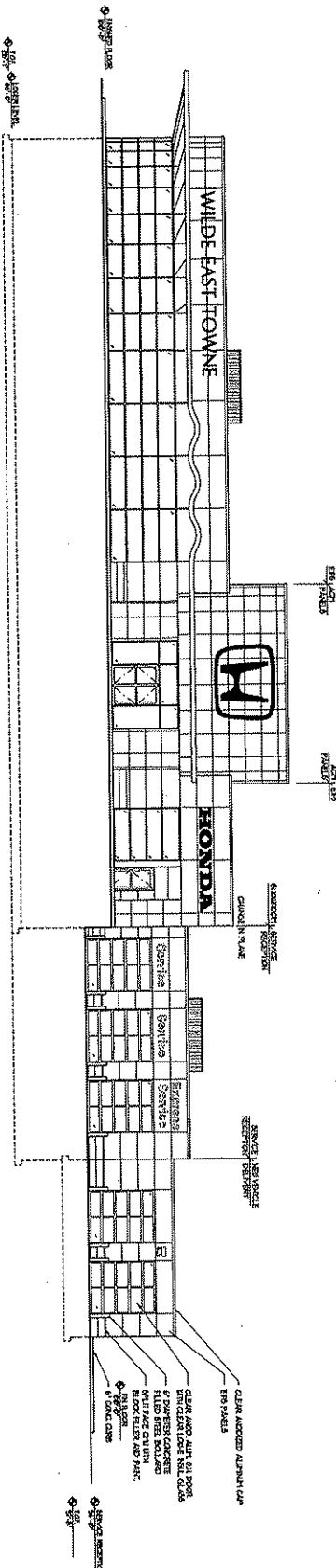

WEST ELEVATION
1/8" = 1'-0"

SHEET INDEX

1	TITLE EAST AND WEST ELEVATIONS
2	PLAN OF SITE
3	CONCEPTUAL GRADING PLAN (CONCEPTUAL)
4	CONCEPTUAL PAVING PLAN (CONCEPTUAL)
5	CONCEPTUAL SIGNAGE PLAN (CONCEPTUAL)
6	CONCEPTUAL LIGHTING PLAN (CONCEPTUAL)
7	CONCEPTUAL LANDSCAPE PLAN (CONCEPTUAL)
8	CONCEPTUAL SIGNAGE PLAN (CONCEPTUAL)
9	CONCEPTUAL LIGHTING PLAN (CONCEPTUAL)
10	CONCEPTUAL LANDSCAPE PLAN (CONCEPTUAL)
11	CONCEPTUAL SIGNAGE PLAN (CONCEPTUAL)
12	CONCEPTUAL LIGHTING PLAN (CONCEPTUAL)
13	CONCEPTUAL LANDSCAPE PLAN (CONCEPTUAL)
14	CONCEPTUAL SIGNAGE PLAN (CONCEPTUAL)
15	CONCEPTUAL LIGHTING PLAN (CONCEPTUAL)
16	CONCEPTUAL LANDSCAPE PLAN (CONCEPTUAL)
17	CONCEPTUAL SIGNAGE PLAN (CONCEPTUAL)
18	CONCEPTUAL LIGHTING PLAN (CONCEPTUAL)
19	CONCEPTUAL LANDSCAPE PLAN (CONCEPTUAL)
20	CONCEPTUAL SIGNAGE PLAN (CONCEPTUAL)
21	CONCEPTUAL LIGHTING PLAN (CONCEPTUAL)
22	CONCEPTUAL LANDSCAPE PLAN (CONCEPTUAL)
23	CONCEPTUAL SIGNAGE PLAN (CONCEPTUAL)
24	CONCEPTUAL LIGHTING PLAN (CONCEPTUAL)
25	CONCEPTUAL LANDSCAPE PLAN (CONCEPTUAL)
26	CONCEPTUAL SIGNAGE PLAN (CONCEPTUAL)
27	CONCEPTUAL LIGHTING PLAN (CONCEPTUAL)
28	CONCEPTUAL LANDSCAPE PLAN (CONCEPTUAL)
29	CONCEPTUAL SIGNAGE PLAN (CONCEPTUAL)
30	CONCEPTUAL LIGHTING PLAN (CONCEPTUAL)
31	CONCEPTUAL LANDSCAPE PLAN (CONCEPTUAL)
32	CONCEPTUAL SIGNAGE PLAN (CONCEPTUAL)
33	CONCEPTUAL LIGHTING PLAN (CONCEPTUAL)
34	CONCEPTUAL LANDSCAPE PLAN (CONCEPTUAL)
35	CONCEPTUAL SIGNAGE PLAN (CONCEPTUAL)
36	CONCEPTUAL LIGHTING PLAN (CONCEPTUAL)
37	CONCEPTUAL LANDSCAPE PLAN (CONCEPTUAL)
38	CONCEPTUAL SIGNAGE PLAN (CONCEPTUAL)
39	CONCEPTUAL LIGHTING PLAN (CONCEPTUAL)
40	CONCEPTUAL LANDSCAPE PLAN (CONCEPTUAL)
41	CONCEPTUAL SIGNAGE PLAN (CONCEPTUAL)
42	CONCEPTUAL LIGHTING PLAN (CONCEPTUAL)
43	CONCEPTUAL LANDSCAPE PLAN (CONCEPTUAL)
44	CONCEPTUAL SIGNAGE PLAN (CONCEPTUAL)
45	CONCEPTUAL LIGHTING PLAN (CONCEPTUAL)
46	CONCEPTUAL LANDSCAPE PLAN (CONCEPTUAL)
47	CONCEPTUAL SIGNAGE PLAN (CONCEPTUAL)
48	CONCEPTUAL LIGHTING PLAN (CONCEPTUAL)
49	CONCEPTUAL LANDSCAPE PLAN (CONCEPTUAL)
50	CONCEPTUAL SIGNAGE PLAN (CONCEPTUAL)
51	CONCEPTUAL LIGHTING PLAN (CONCEPTUAL)
52	CONCEPTUAL LANDSCAPE PLAN (CONCEPTUAL)
53	CONCEPTUAL SIGNAGE PLAN (CONCEPTUAL)
54	CONCEPTUAL LIGHTING PLAN (CONCEPTUAL)
55	CONCEPTUAL LANDSCAPE PLAN (CONCEPTUAL)
56	CONCEPTUAL SIGNAGE PLAN (CONCEPTUAL)
57	CONCEPTUAL LIGHTING PLAN (CONCEPTUAL)
58	CONCEPTUAL LANDSCAPE PLAN (CONCEPTUAL)
59	CONCEPTUAL SIGNAGE PLAN (CONCEPTUAL)
60	CONCEPTUAL LIGHTING PLAN (CONCEPTUAL)
61	CONCEPTUAL LANDSCAPE PLAN (CONCEPTUAL)
62	CONCEPTUAL SIGNAGE PLAN (CONCEPTUAL)
63	CONCEPTUAL LIGHTING PLAN (CONCEPTUAL)
64	CONCEPTUAL LANDSCAPE PLAN (CONCEPTUAL)
65	CONCEPTUAL SIGNAGE PLAN (CONCEPTUAL)
66	CONCEPTUAL LIGHTING PLAN (CONCEPTUAL)
67	CONCEPTUAL LANDSCAPE PLAN (CONCEPTUAL)
68	CONCEPTUAL SIGNAGE PLAN (CONCEPTUAL)
69	CONCEPTUAL LIGHTING PLAN (CONCEPTUAL)
70	CONCEPTUAL LANDSCAPE PLAN (CONCEPTUAL)
71	CONCEPTUAL SIGNAGE PLAN (CONCEPTUAL)
72	CONCEPTUAL LIGHTING PLAN (CONCEPTUAL)
73	CONCEPTUAL LANDSCAPE PLAN (CONCEPTUAL)
74	CONCEPTUAL SIGNAGE PLAN (CONCEPTUAL)
75	CONCEPTUAL LIGHTING PLAN (CONCEPTUAL)
76	CONCEPTUAL LANDSCAPE PLAN (CONCEPTUAL)
77	CONCEPTUAL SIGNAGE PLAN (CONCEPTUAL)
78	CONCEPTUAL LIGHTING PLAN (CONCEPTUAL)
79	CONCEPTUAL LANDSCAPE PLAN (CONCEPTUAL)
80	CONCEPTUAL SIGNAGE PLAN (CONCEPTUAL)
81	CONCEPTUAL LIGHTING PLAN (CONCEPTUAL)
82	CONCEPTUAL LANDSCAPE PLAN (CONCEPTUAL)
83	CONCEPTUAL SIGNAGE PLAN (CONCEPTUAL)
84	CONCEPTUAL LIGHTING PLAN (CONCEPTUAL)
85	CONCEPTUAL LANDSCAPE PLAN (CONCEPTUAL)
86	CONCEPTUAL SIGNAGE PLAN (CONCEPTUAL)
87	CONCEPTUAL LIGHTING PLAN (CONCEPTUAL)
88	CONCEPTUAL LANDSCAPE PLAN (CONCEPTUAL)
89	CONCEPTUAL SIGNAGE PLAN (CONCEPTUAL)
90	CONCEPTUAL LIGHTING PLAN (CONCEPTUAL)
91	CONCEPTUAL LANDSCAPE PLAN (CONCEPTUAL)
92	CONCEPTUAL SIGNAGE PLAN (CONCEPTUAL)
93	CONCEPTUAL LIGHTING PLAN (CONCEPTUAL)
94	CONCEPTUAL LANDSCAPE PLAN (CONCEPTUAL)
95	CONCEPTUAL SIGNAGE PLAN (CONCEPTUAL)
96	CONCEPTUAL LIGHTING PLAN (CONCEPTUAL)
97	CONCEPTUAL LANDSCAPE PLAN (CONCEPTUAL)
98	CONCEPTUAL SIGNAGE PLAN (CONCEPTUAL)
99	CONCEPTUAL LIGHTING PLAN (CONCEPTUAL)
100	CONCEPTUAL LANDSCAPE PLAN (CONCEPTUAL)

REVISED PLANS

APPROVED
AUTOMOBILE
DEalersHIP FOR:

**WILDE
EAST
TOWNE
HONDA**

5555 HIGH CROSSING
BLVD.
MADISON, WI

**Collaborative
Design
Architecture**

822 N. Broadway, Suite 206
Waukesha, WI 53188
Phone: (414) 277-8900
Fax: (414) 283-5559

PROJECT TITLE:

PROJECT NUMBER:

DATE:

DRAWN BY:

PROJECT NUMBER:

DATE:

PROJECT NUMBER:

DATE:

PROJECT NUMBER:

DATE:

PROJECT NUMBER:

DATE:

PROJECT NUMBER:

DATE:

PROJECT NUMBER:

DATE:

PROJECT NUMBER:

DATE:

PROJECT NUMBER:

DATE:

NO.	REVISION	DATE
1		
2		
3		
4		
5		
6		
7		
8		
9		
10		

SHEET MATCH C

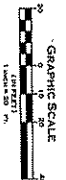
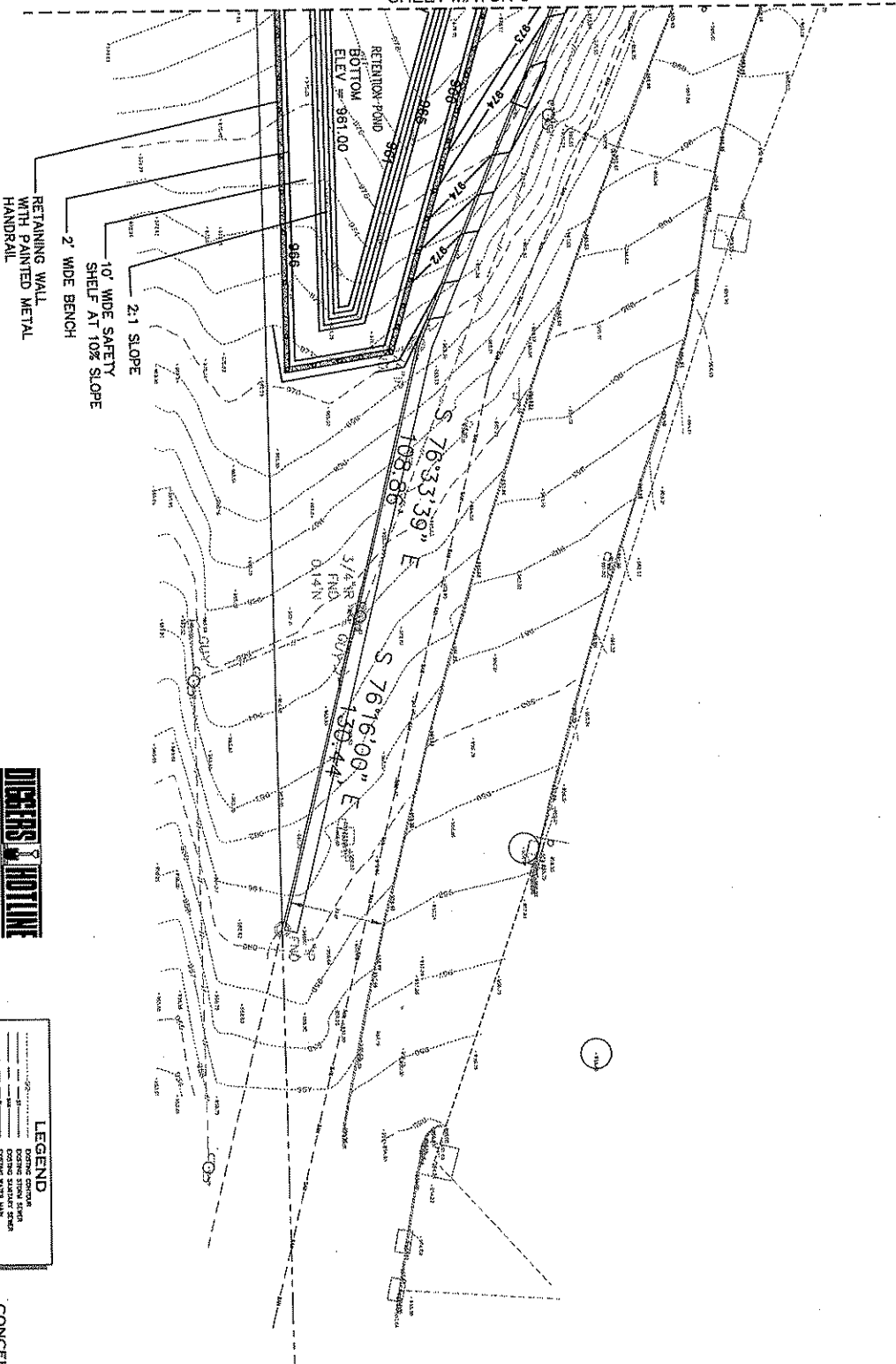

DISPATCH
NOTICE
 Toll Free (800) 242-8581
 Henry (1-800) 242-8581
 Fax (608) 785-8581
 E-mail: dispatch@dispatch.com
 Web: www.dispatch.com

LEGEND	
	EXISTING CENTERLINE
	EXISTING STONE DRAIN
	EXISTING WATER MAIN
	EXISTING GAS SERVICE
	EXISTING ELECTRIC SERVICE
	EXISTING UTILITY LINES
	WATER SERVICE LINE
	ELECTRIC SERVICE LINE
	48" PIPE
	36" PIPE
	24" PIPE
	18" PIPE
	12" PIPE
	8" PIPE
	6" PIPE
	4" PIPE
	3" PIPE
	2" PIPE
	1.5" PIPE
	1" PIPE
	0.75" PIPE
	0.5" PIPE
	0.375" PIPE
	0.25" PIPE
	0.1875" PIPE
	0.125" PIPE
	0.0625" PIPE
	0.03125" PIPE

CONCEPTUAL GRADING PLAN (EAST)

FOR
 WILDE FAMILY HONDA
 5535 HIGH CROSSING BLVD.
 MADISON, WI

DESIGNED BY	DATE
JR	10/14/08
CHECKED BY	DATE
PH	08-08-08
SCALE	AS SHOWN
C6	C13

SE CORNER
 NW 1/4
 SEC 23-8-10.

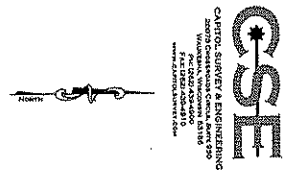

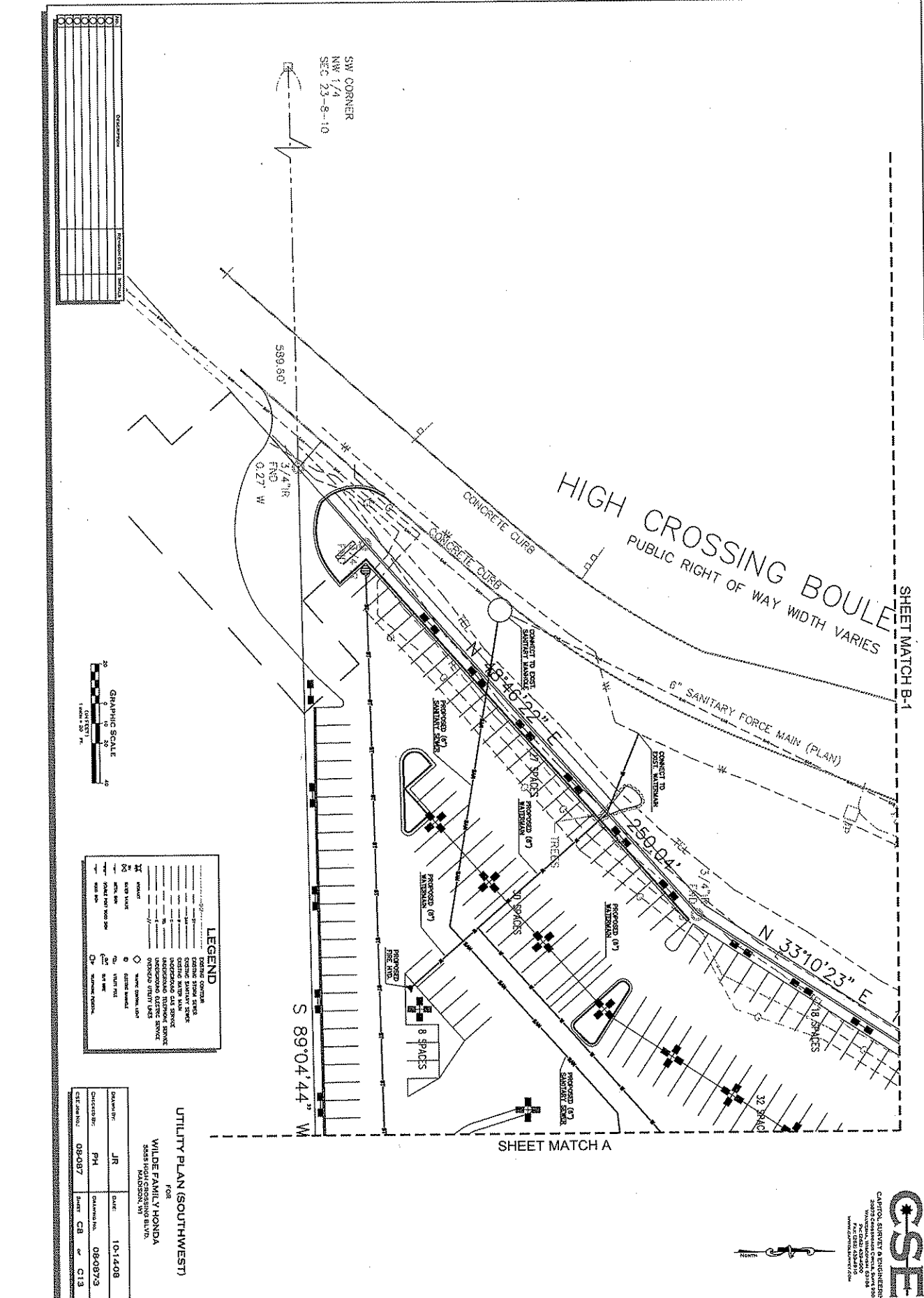

SHEET MATCH B-1

SHEET MATCH A

DATE	DESCRIPTION

SW CORNER
NW 1/4
SEC 23-8-10

HIGH CROSSING BOULEVARD
PUBLIC RIGHT OF WAY WIDTH VARIES

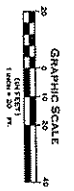

LEGEND
--- PROPOSED 12" SANITARY SERVICE LINE
--- PROPOSED 6" SANITARY SERVICE LINE
--- EXISTING 12" SANITARY SERVICE LINE
--- EXISTING 6" SANITARY SERVICE LINE
--- PROPOSED 24" SANITARY FORCE MAIN
--- EXISTING 24" SANITARY FORCE MAIN
--- PROPOSED 18" SANITARY FORCE MAIN
--- EXISTING 18" SANITARY FORCE MAIN
--- PROPOSED 15" SANITARY FORCE MAIN
--- EXISTING 15" SANITARY FORCE MAIN
--- PROPOSED 12" SANITARY FORCE MAIN
--- EXISTING 12" SANITARY FORCE MAIN
--- PROPOSED 8" SANITARY FORCE MAIN
--- EXISTING 8" SANITARY FORCE MAIN
--- PROPOSED 6" SANITARY FORCE MAIN
--- EXISTING 6" SANITARY FORCE MAIN
--- PROPOSED 4" SANITARY FORCE MAIN
--- EXISTING 4" SANITARY FORCE MAIN
--- PROPOSED 3" SANITARY FORCE MAIN
--- EXISTING 3" SANITARY FORCE MAIN
--- PROPOSED 2" SANITARY FORCE MAIN
--- EXISTING 2" SANITARY FORCE MAIN
--- PROPOSED 1" SANITARY FORCE MAIN
--- EXISTING 1" SANITARY FORCE MAIN
--- PROPOSED 1/2" SANITARY FORCE MAIN
--- EXISTING 1/2" SANITARY FORCE MAIN
--- PROPOSED 3/4" SANITARY FORCE MAIN
--- EXISTING 3/4" SANITARY FORCE MAIN
--- PROPOSED 1/4" SANITARY FORCE MAIN
--- EXISTING 1/4" SANITARY FORCE MAIN
--- PROPOSED 1/8" SANITARY FORCE MAIN
--- EXISTING 1/8" SANITARY FORCE MAIN

DRAWN BY:	JR	DATE:	10-14-08
CHECKED BY:	PH	DRAWING NO.:	08-087-3
DATE:	09-08-07	SHEET:	CB
			OF
			C13

UTILITY PLAN (SOUTHWEST)
FOR
WILDE FAMILY/HONDA
SOUTH CROSSING BLVD
MADISON, WI



CSE
CARROLL SURVEY & ENGINEERING
SURVEYING & ENGINEERING
WISCONSIN LICENSE NO. 1586
P.E. (E.C. ASHLEY)
WISCONSIN LICENSE NO. 1586



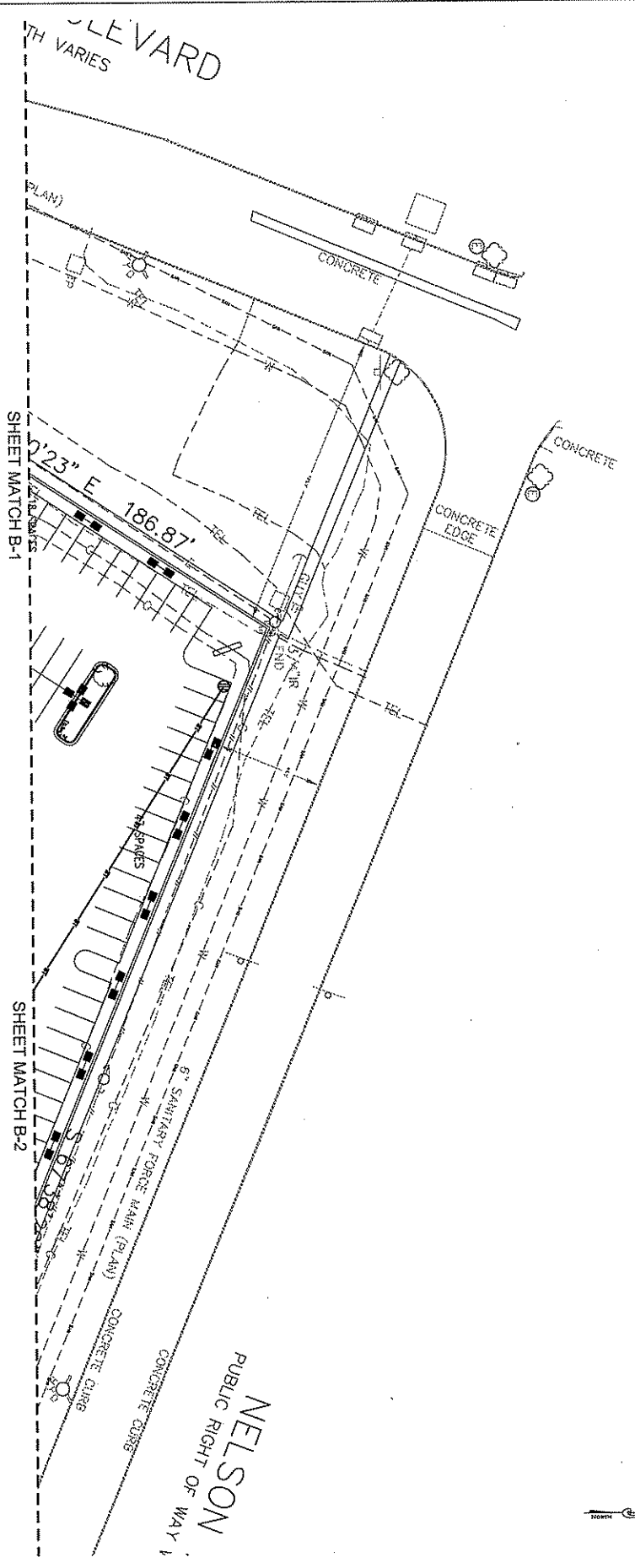



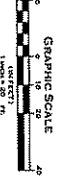















5



NO.	DESCRIPTION	REVISED DATE	BY



LEGEND

 MANHOLE
 VALVE
 PIPE
 CONCRETE CURB
 CONCRETE EDGE
 6" SANITARY FORCE MAIN (PLAN)
 EXISTING UTILITY
 UTILITY TO BE INSTALLED
 UTILITY TO BE REMOVED
 SPOT HEIGHT
 SPOT ELEVATION
 SPOT ELEVATION WITH PERCENTAGE
 SPOT ELEVATION WITH FEET AND INCHES
 SPOT ELEVATION WITH DECIMAL
 SPOT ELEVATION WITH DECIMAL, FEET AND INCHES
 SPOT ELEVATION WITH DECIMAL AND FEET
 SPOT ELEVATION WITH DECIMAL AND FEET AND INCHES
 SPOT ELEVATION WITH DECIMAL AND FEET
 SPOT ELEVATION WITH DECIMAL AND FEET AND INCHES
 SPOT ELEVATION WITH DECIMAL AND FEET
 SPOT ELEVATION WITH DECIMAL AND FEET AND INCHES
 SPOT ELEVATION WITH DECIMAL AND FEET
 SPOT ELEVATION WITH DECIMAL AND FEET AND INCHES

UTILITY PLAN (NORTHWEST)

FOR
WALDE FARM, VANDIA
 3550 WISCONSIN BLVD.
 MADISON, WI

DATE	10-14-08
DRAWN BY	JR
CHECKED BY	PH
DATE PLOTTED	09/08/09
SCALE	C9 OF C13
DRAWING NO.	508-0973

SHEET MATCH A

SHEET MATCH B-2

SHEET MATCH C

NO.	DESCRIPTION	DATE	BY

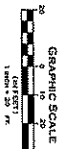
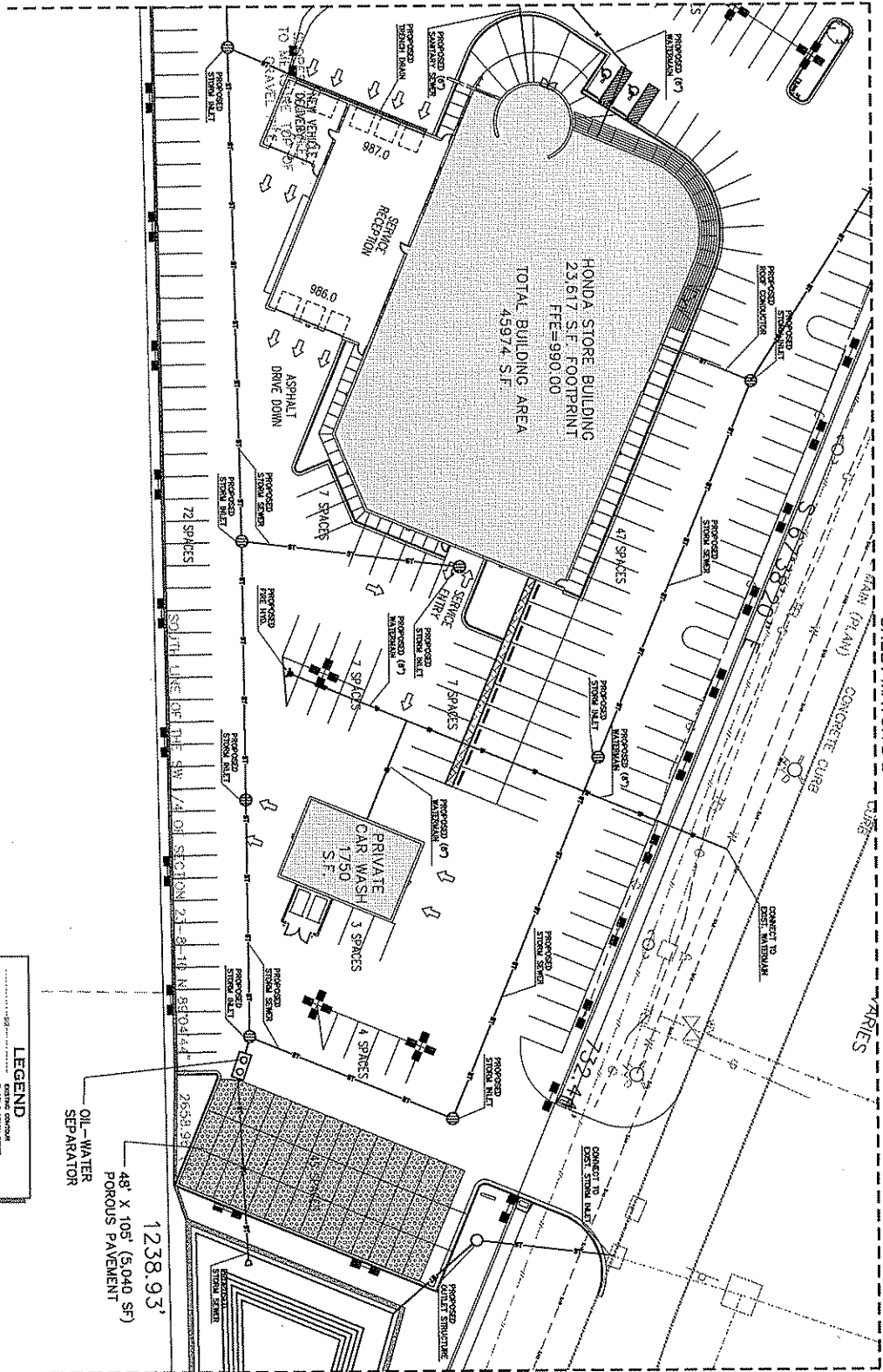

LEGEND

EXISTING STORM SEWER
 EXISTING SANITARY SEWER
 EXISTING SEWER OVERHEAD
 PROPOSED STORM SEWER
 PROPOSED SANITARY SEWER
 PROPOSED SEWER OVERHEAD

EXISTING WATER MAIN
 EXISTING GAS MAIN
 EXISTING UTILITIES (ELECTRIC, TELEPHONE, CABLE)
 PROPOSED WATER MAIN
 PROPOSED GAS MAIN
 PROPOSED UTILITIES (ELECTRIC, TELEPHONE, CABLE)

WALL OF EXISTING BUILDING
 WALL OF PROPOSED BUILDING
 DRIVE

PROPOSED SIGNAGE
 PROPOSED LIGHTING

PROPOSED ASPHALT DRIVE DOWN
 PROPOSED CONCRETE DRIVE DOWN
 PROPOSED ASPHALT DRIVE DOWN

UTILITY PLAN (CENTRAL)
FOR
WILDE FAMILY HONDA
3555 HIGHWAY 111
MARIETTA, GA 30067

DATE:	10-14-08
DRAWN BY:	JLR
CHECKED BY:	PH
SHEET NO.:	08-087
SHEET:	C10
OF:	C13
PROJECT NO.:	08-087

CSE
 CAPITOL SURVEY & ENGINEERING
 3000 WILSON AVENUE
 MARIETTA, GEORGIA 30067
 PHONE: 404.473.8888
 FAX: 404.473.8899
 WWW.CAPITOLSURVEY.COM

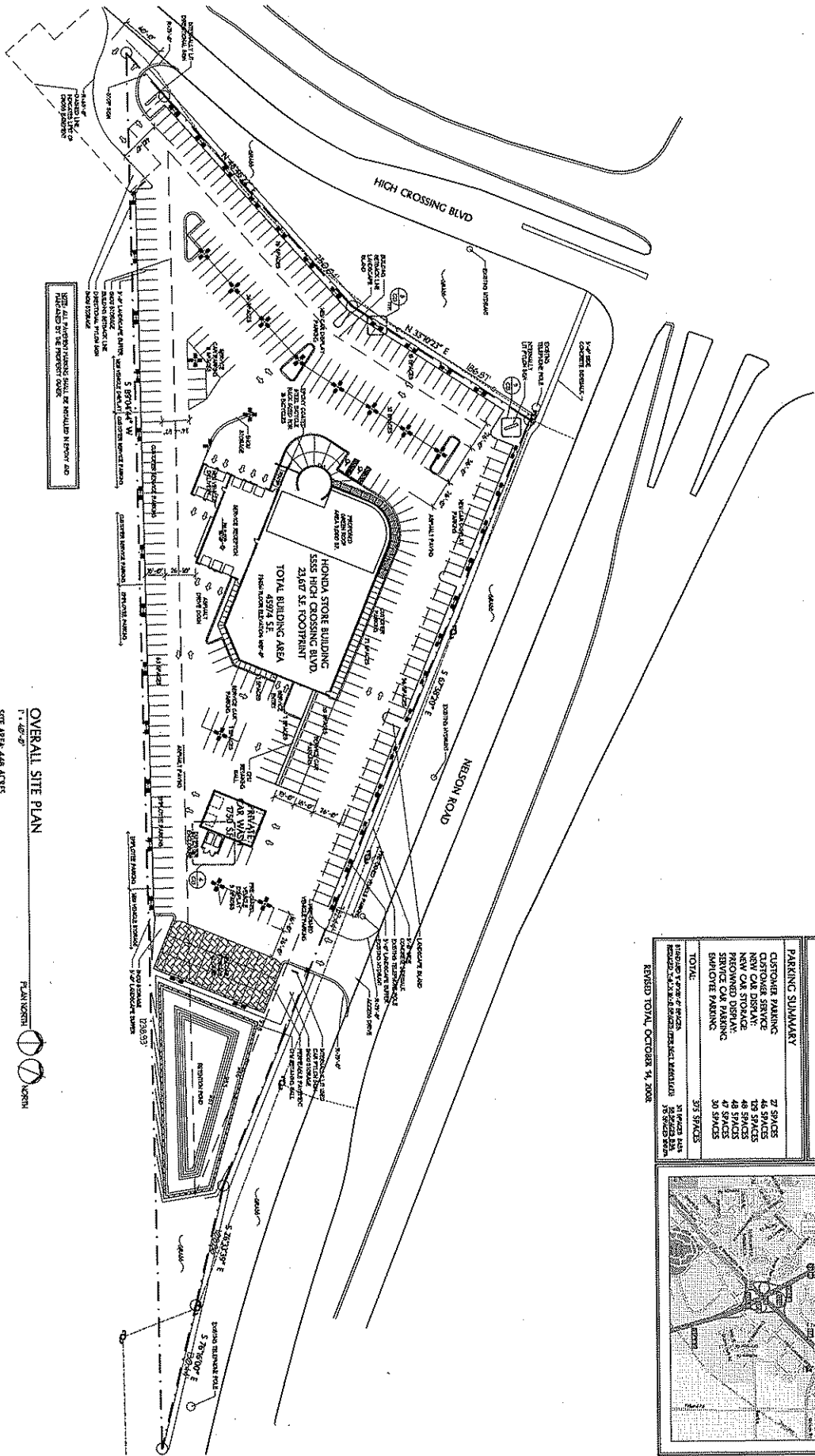

OVERALL SITE PLAN
 1" = 40'-0"
 SITE AREA: 448 ACRES
 APPROXIMATELY 193,268 SQUARE FEET

PROJECT INFORMATION	
PROJECT LOCATION: 3555 HIGH CROSSING BLVD	DATE: 10/20/08
OWNER: HONDA OF AMERICA	DESIGNER: COLLABORATIVE DESIGN
DESIGNER: COLLABORATIVE DESIGN	DATE: 10/20/08
PROJECT NO.: 08-001	SCALE: AS SHOWN
PROJECT NAME: HONDA STORE	DATE: 10/20/08
PROJECT ADDRESS: 3555 HIGH CROSSING BLVD	DATE: 10/20/08
PROJECT CITY: WILDE	DATE: 10/20/08
PROJECT STATE: MO	DATE: 10/20/08
PROJECT ZIP: 64689	DATE: 10/20/08
PROJECT TOTAL: OCTOBER 24, 2008	

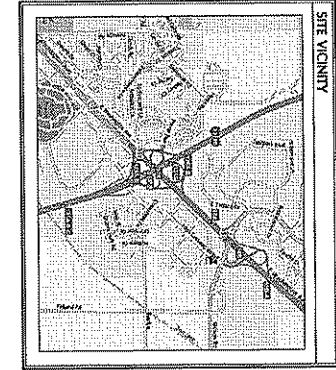

<p>Ethel Healden, AIA ARCHITECTURE CONSULTING</p> <p>225 N. Broadway, Suite 205 Milwaukee, WI 53202 Phone: (414) 277-0000 Fax: (414) 265-0100</p>	<p>Collaborative Design™</p> <p>1000 W. Wisconsin Ave., Suite 200 Milwaukee, WI 53233 Phone: (414) 277-0000 Fax: (414) 265-0100</p>	<p>PROJECT CHIEF: A. PROPOSED AUTOMOBILE DEALERSHIP FOR WILDE EAST TOWNE HONDA 3555 HIGH CROSSING BLVD. MADISON, WI</p>	<p>ARCHITECTURAL SITE PLAN</p>	<p>DATE: 10/20/08 DRAWN BY: DUMAYVIC FILE NAME: 200810</p>	<p>PROJECT NUMBER: 200810</p>	<p>SCALE: 1" = 40'-0"</p>	<p>C12</p>



East Madison Hill
ARCHITECTURE
CONSULTING

1233 W. Broadway, Suite 206
 Madison, WI 53707-8000
 608.443.2613-3500
 608.443.2613-3500

Collaborative
Design

1011 North Lake Street, Suite 200
 Madison, WI 53706
 608.443.2613-3500
 608.443.2613-3500

Project title:

A PROPOSED
 AUTOMOBILE
 DUMPSTER POD
 WILDE
 EAST
 TOWNE
 HONDA
 5555 HIGH CROSSING
 EVD
 MADISON, WI

SHEET TITLE:
 SITE
 DETAILS

DATE:
 3/20/2014

DRAWN BY:
 JENNIFER WILDE

1118 0001

PROJECT NUMBER:
 202014

15.01.01

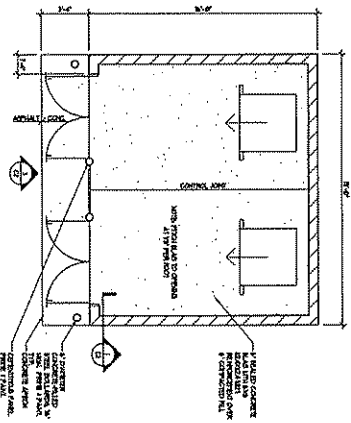

4 DUMPSTER ENCLOSURE PLAN

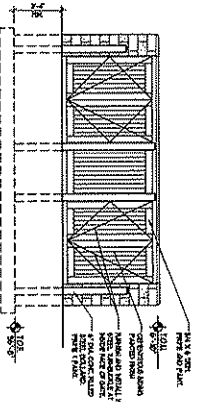

3 ELEVATION AT DUMPSTER ENCLOSURE

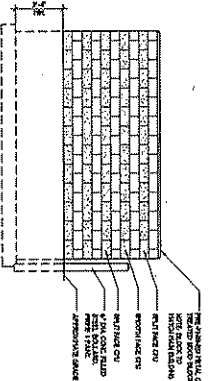

2 ELEVATION AT DUMPSTER ENCLOSURE

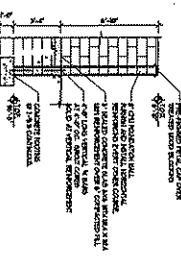

1 SECTION AT DUMPSTER ENCLOSURE

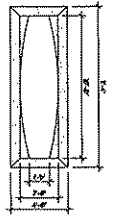

7 PLAN AT Pylon SIGN

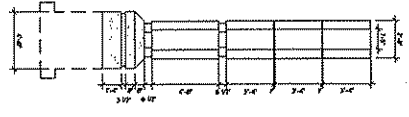

6 ELEVATION AT Pylon SIGN

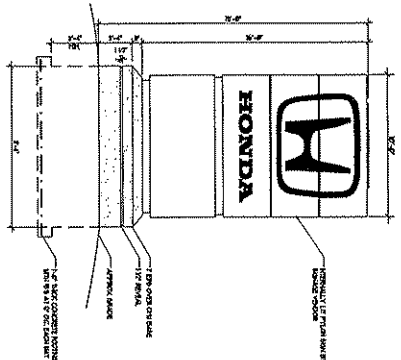

5 ELEVATION AT Pylon SIGN

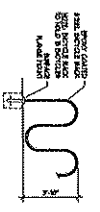

8 BICYCLE RACK DETAIL

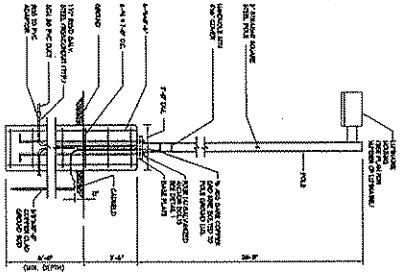

8 TYPICAL LIGHT POLE DETAIL



DRL L. Madison, MA
ARCHITECTURE
CONSULTING
 100 N. Broadway, Suite 210
 Middletown, VT 05750
 Phone: (802) 455-0599
 Fax: (802) 455-0599

PROJECT TITLE
 A PROPOSED
 AUTOMOBILE
 DEALERSHIP FOR
**WILDE
 EAST
 TOWNE
 HONDA**

5353 HIGH CROSSING
 B.V.O.
 MADISON, VT

DERRILL HILL
 100 N. BROADWAY
 MIDDLETOWN, VT 05750
 PHONE: (802) 455-0599
 FAX: (802) 455-0599

DATE: 10/10/2008
 DRAWN BY: ELM/ML/WAC
 TITLE: SCOPING
 PROJECT NUMBER: 2007/04

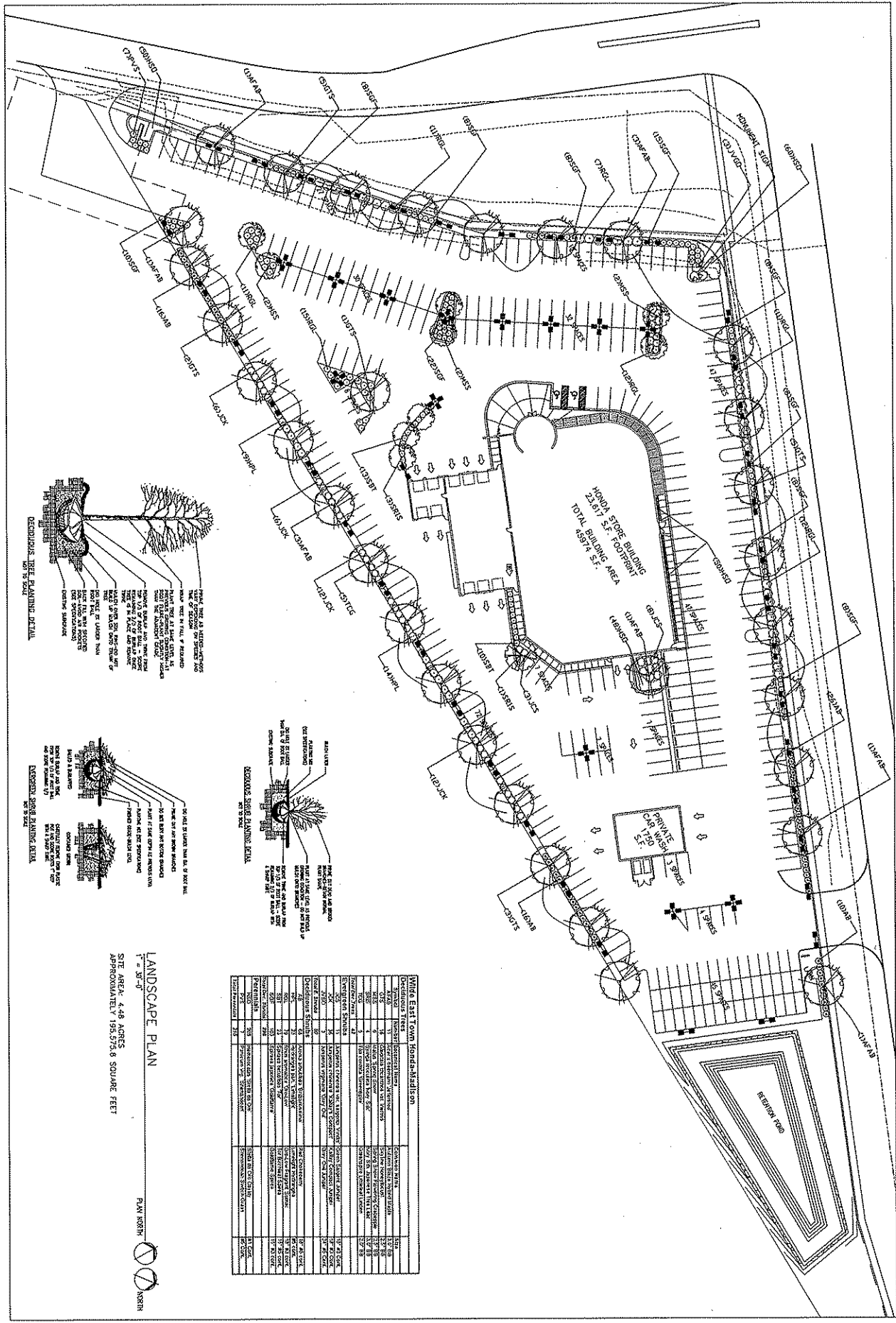
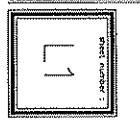

NO.	DESCRIPTION	QUANTITY	UNIT	PRICE	TOTAL
1	CONCRETE	1	CU YD	120.00	120.00
2	REINFORCING	1	TON	1,200.00	1,200.00
3	FORMWORK	1	SQ YD	1,000.00	1,000.00
4	PAVING	1	SQ YD	1,000.00	1,000.00
5	GRASS	1	SQ YD	1,000.00	1,000.00
6	PLANTING	1	PLANT	1,000.00	1,000.00
7	IRRIGATION	1	SYSTEM	1,000.00	1,000.00
8	LANDSCAPING	1	AREA	1,000.00	1,000.00
9	CONCRETE	1	CU YD	120.00	120.00
10	REINFORCING	1	TON	1,200.00	1,200.00
11	FORMWORK	1	SQ YD	1,000.00	1,000.00
12	PAVING	1	SQ YD	1,000.00	1,000.00
13	GRASS	1	SQ YD	1,000.00	1,000.00
14	PLANTING	1	PLANT	1,000.00	1,000.00
15	IRRIGATION	1	SYSTEM	1,000.00	1,000.00
16	LANDSCAPING	1	AREA	1,000.00	1,000.00
17	CONCRETE	1	CU YD	120.00	120.00
18	REINFORCING	1	TON	1,200.00	1,200.00
19	FORMWORK	1	SQ YD	1,000.00	1,000.00
20	PAVING	1	SQ YD	1,000.00	1,000.00
21	GRASS	1	SQ YD	1,000.00	1,000.00
22	PLANTING	1	PLANT	1,000.00	1,000.00
23	IRRIGATION	1	SYSTEM	1,000.00	1,000.00
24	LANDSCAPING	1	AREA	1,000.00	1,000.00
25	CONCRETE	1	CU YD	120.00	120.00
26	REINFORCING	1	TON	1,200.00	1,200.00
27	FORMWORK	1	SQ YD	1,000.00	1,000.00
28	PAVING	1	SQ YD	1,000.00	1,000.00
29	GRASS	1	SQ YD	1,000.00	1,000.00
30	PLANTING	1	PLANT	1,000.00	1,000.00
31	IRRIGATION	1	SYSTEM	1,000.00	1,000.00
32	LANDSCAPING	1	AREA	1,000.00	1,000.00
33	CONCRETE	1	CU YD	120.00	120.00
34	REINFORCING	1	TON	1,200.00	1,200.00
35	FORMWORK	1	SQ YD	1,000.00	1,000.00
36	PAVING	1	SQ YD	1,000.00	1,000.00
37	GRASS	1	SQ YD	1,000.00	1,000.00
38	PLANTING	1	PLANT	1,000.00	1,000.00
39	IRRIGATION	1	SYSTEM	1,000.00	1,000.00
40	LANDSCAPING	1	AREA	1,000.00	1,000.00
41	CONCRETE	1	CU YD	120.00	120.00
42	REINFORCING	1	TON	1,200.00	1,200.00
43	FORMWORK	1	SQ YD	1,000.00	1,000.00
44	PAVING	1	SQ YD	1,000.00	1,000.00
45	GRASS	1	SQ YD	1,000.00	1,000.00
46	PLANTING	1	PLANT	1,000.00	1,000.00
47	IRRIGATION	1	SYSTEM	1,000.00	1,000.00
48	LANDSCAPING	1	AREA	1,000.00	1,000.00
49	CONCRETE	1	CU YD	120.00	120.00
50	REINFORCING	1	TON	1,200.00	1,200.00
51	FORMWORK	1	SQ YD	1,000.00	1,000.00
52	PAVING	1	SQ YD	1,000.00	1,000.00
53	GRASS	1	SQ YD	1,000.00	1,000.00
54	PLANTING	1	PLANT	1,000.00	1,000.00
55	IRRIGATION	1	SYSTEM	1,000.00	1,000.00
56	LANDSCAPING	1	AREA	1,000.00	1,000.00
57	CONCRETE	1	CU YD	120.00	120.00
58	REINFORCING	1	TON	1,200.00	1,200.00
59	FORMWORK	1	SQ YD	1,000.00	1,000.00
60	PAVING	1	SQ YD	1,000.00	1,000.00
61	GRASS	1	SQ YD	1,000.00	1,000.00
62	PLANTING	1	PLANT	1,000.00	1,000.00
63	IRRIGATION	1	SYSTEM	1,000.00	1,000.00
64	LANDSCAPING	1	AREA	1,000.00	1,000.00
65	CONCRETE	1	CU YD	120.00	120.00
66	REINFORCING	1	TON	1,200.00	1,200.00
67	FORMWORK	1	SQ YD	1,000.00	1,000.00
68	PAVING	1	SQ YD	1,000.00	1,000.00
69	GRASS	1	SQ YD	1,000.00	1,000.00
70	PLANTING	1	PLANT	1,000.00	1,000.00
71	IRRIGATION	1	SYSTEM	1,000.00	1,000.00
72	LANDSCAPING	1	AREA	1,000.00	1,000.00
73	CONCRETE	1	CU YD	120.00	120.00
74	REINFORCING	1	TON	1,200.00	1,200.00
75	FORMWORK	1	SQ YD	1,000.00	1,000.00
76	PAVING	1	SQ YD	1,000.00	1,000.00
77	GRASS	1	SQ YD	1,000.00	1,000.00
78	PLANTING	1	PLANT	1,000.00	1,000.00
79	IRRIGATION	1	SYSTEM	1,000.00	1,000.00
80	LANDSCAPING	1	AREA	1,000.00	1,000.00
81	CONCRETE	1	CU YD	120.00	120.00
82	REINFORCING	1	TON	1,200.00	1,200.00
83	FORMWORK	1	SQ YD	1,000.00	1,000.00
84	PAVING	1	SQ YD	1,000.00	1,000.00
85	GRASS	1	SQ YD	1,000.00	1,000.00
86	PLANTING	1	PLANT	1,000.00	1,000.00
87	IRRIGATION	1	SYSTEM	1,000.00	1,000.00
88	LANDSCAPING	1	AREA	1,000.00	1,000.00
89	CONCRETE	1	CU YD	120.00	120.00
90	REINFORCING	1	TON	1,200.00	1,200.00
91	FORMWORK	1	SQ YD	1,000.00	1,000.00
92	PAVING	1	SQ YD	1,000.00	1,000.00
93	GRASS	1	SQ YD	1,000.00	1,000.00
94	PLANTING	1	PLANT	1,000.00	1,000.00
95	IRRIGATION	1	SYSTEM	1,000.00	1,000.00
96	LANDSCAPING	1	AREA	1,000.00	1,000.00
97	CONCRETE	1	CU YD	120.00	120.00
98	REINFORCING	1	TON	1,200.00	1,200.00
99	FORMWORK	1	SQ YD	1,000.00	1,000.00
100	PAVING	1	SQ YD	1,000.00	1,000.00

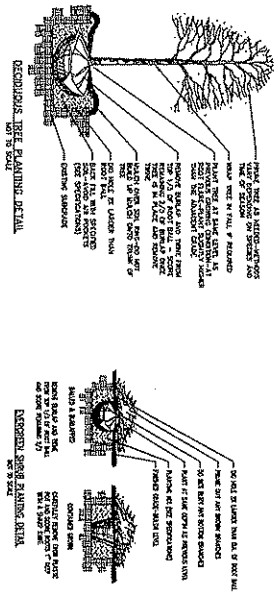

LANDSCAPE PLAN
 SITE AREA: 4.48 ACRES
 APPROXIMATELY 195,575.8 SQUARE FEET

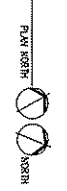

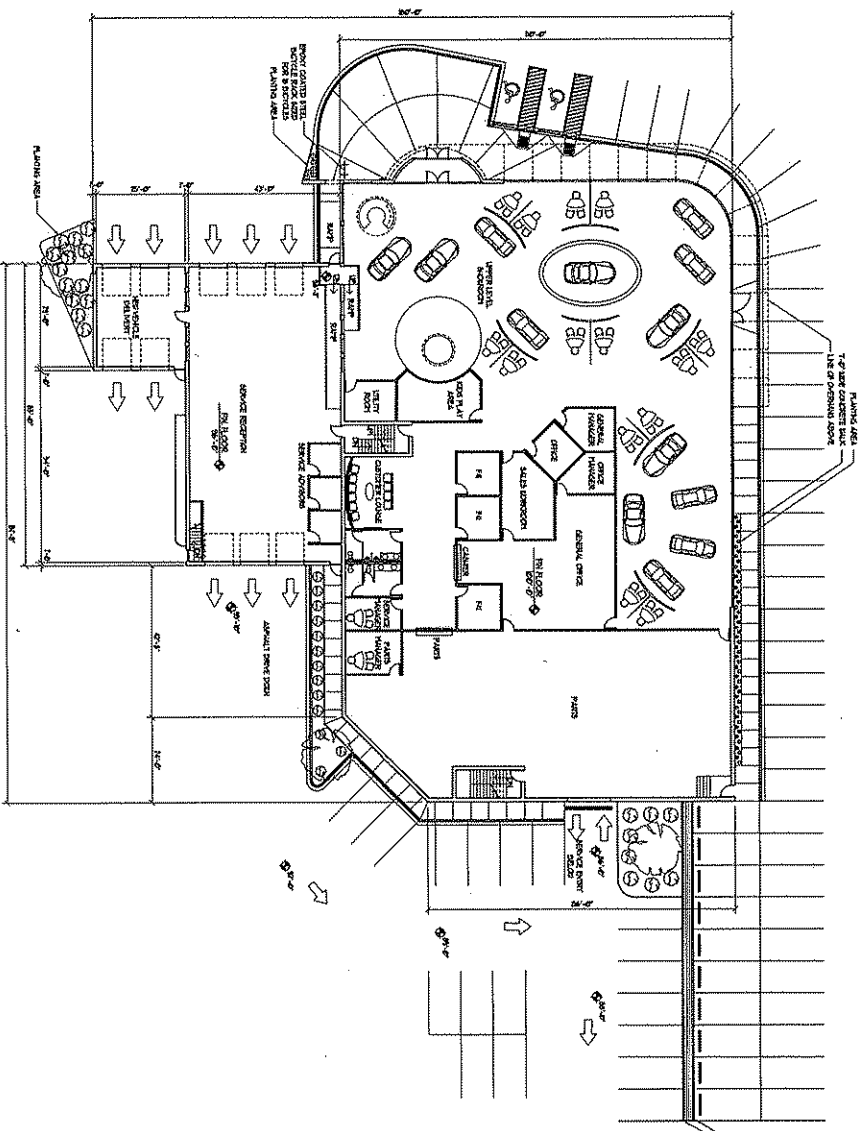

UPPER LEVEL FLOOR PLAN
 PLAN NORTH
 1/8" = 1'-0"

AREA SUMMARY	
SHOWROOM	7400 SQ. FEET
ADMINISTRATION	2750 SQ. FEET
F & ISLES OFFICES	3000 SQ. FEET
CUST. LOUNGE/BOUNIQUE	2750 SQ. FEET
SERVICE RECEPTION	3960 SQ. FEET
NEW VEHICLE DELIVERY	800 SQ. FEET
TOTAL GROSS AREA	23,670 SQ. FEET

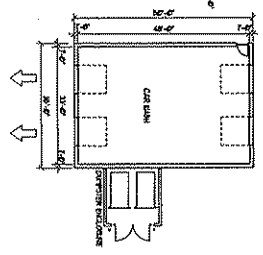

	E.H. L. Medtgen, AIA ARCHITECTURE CONSULTING 5033 N. Boulevard, Suite 206 Milwaukee, WI 53202 Phone (414) 277-8890 Fax (414) 233-5589
	Collaborative Design™ A PROPOSED CHALLENGER FOR WILDE EAST TOWNE HONDA 400 HIGH CROSSING MADISON, WI
PROJECT TITLE: PROPOSED FLOOR PLAN	SHEET TITLE: REVISIONS: DATE: DRAWN BY: CHECKED BY: TITLE:
PROJECT NUMBER: 2008N	DATE: 10/10/08 DRAWN BY: BAWA/AVC CHECKED BY: ELM
SCALE: 1/8" = 1'-0"	PROJECT NUMBER: 2008N
SHEET NUMBER: A1	

5



Erin L. Madson, AIA
 ARCHITECTURE
 CONSULTING

1037 N. Broadway, 5th Fl., 206
 Madison, WI 53703
 Phone: (608) 277-8900
 Fax: (608) 283-9359

Collaborative
 Design

Project title:

A PROPOSED
 AUTOMOBILE
 DEALERSHIP FOR

WILDE
 EAST
 TOWNE
 HONDA

3535 HIGH CROSSING
 MADISON, WI

SHEET TITLE:
 PROPOSED
 LOWER
 LEVEL
 FLOOR
 PLAN

PROVIDED BY:

DATE:

DRAWN BY:

DATE:

PROJECT NUMBER:

SCALE:

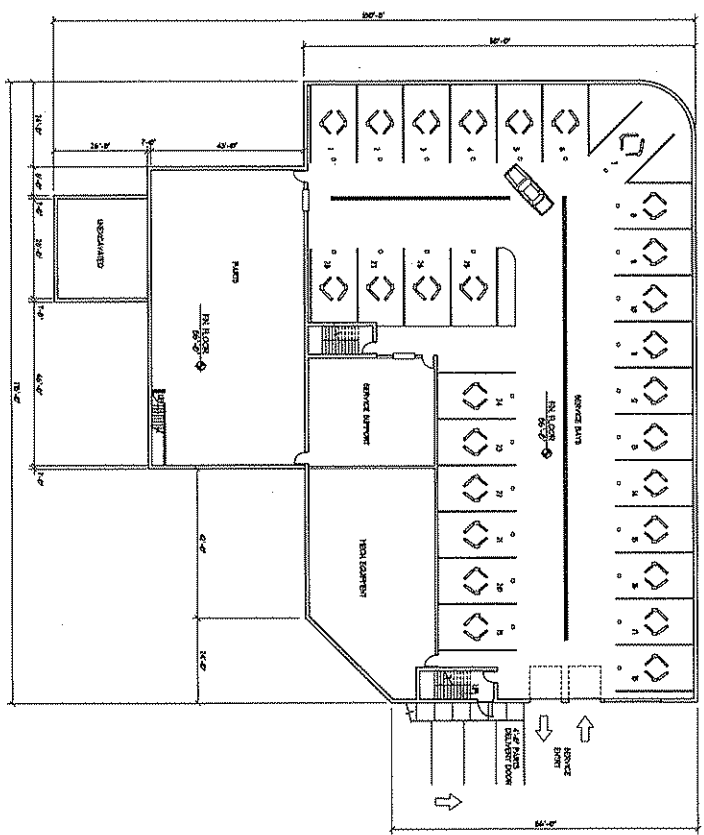

LOWER LEVEL FLOOR PLAN
 PLAN NORTH

AREA SUMMARY	
SERVICE AREA	14,566 SQ. FEET
PAVING	3,776 SQ. FEET
MOTOR EQUIPMENT	17,900 SQ. FEET
SERVICE SUPPORT	14,282 SQ. FEET
TOTAL CROSS AREA	22,687 SQ. FEET

5

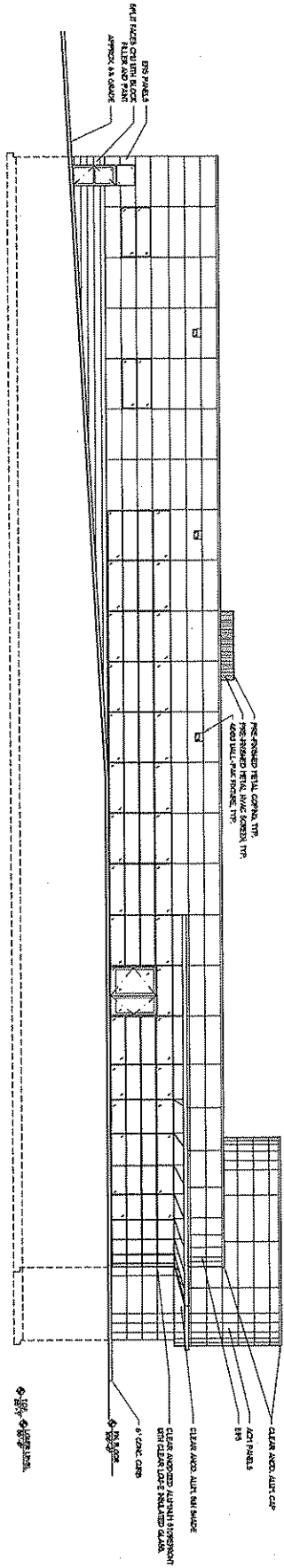

NORTH ELEVATION

1/8" = 1'-0"

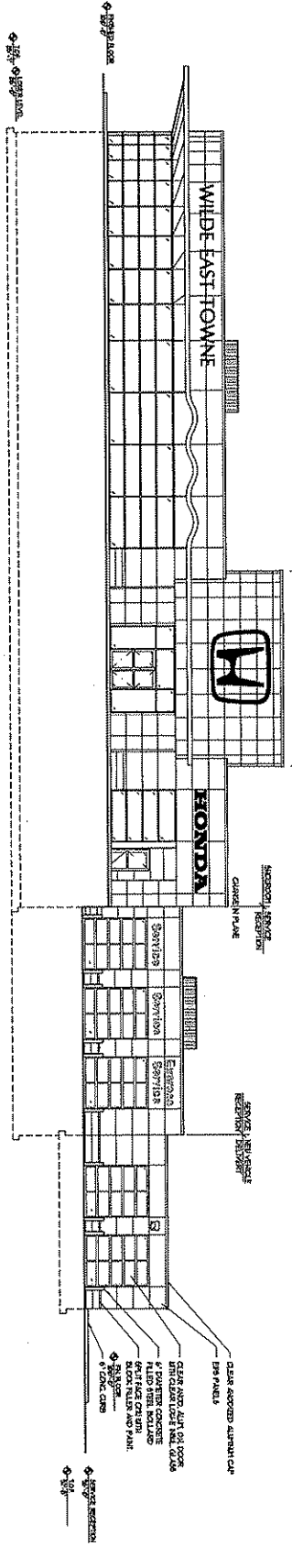

WEST ELEVATION

1/8" = 1'-0"



Erik L. Medinen, AIA
 ARCHITECTURE
 CONSULTING
 233 N. Broadway, Ste. 200
 Madison, WI 53702
 Phone: (608) 277-8200
 Fax: (608) 277-8200
 Cell: (608) 277-8200

Collaborative
 Design
 1001 East Washington Ave.
 Madison, WI 53703
 Phone: (608) 277-8200
 Fax: (608) 277-8200

PROJECT 111111

A PROPOSED
 AUTOMOBILE
 DEALERSHIP FOR
 WILDE
 EAST
 TOWNE
 HONDA
 3333 HIGH CROSSING
 MADISON, WI

PROPOSED
 ELEVATIONS

DATE:	3/20/2008
DRAWN BY:	EM/DAW/KAC
DATE:	3/20/2008
PROJECT NUMBER:	111111
SHEET:	01





Eric L. Madison, AIA
**ARCHITECTURE
 CONSULTING**

203 N. Goodwin, 5th Fl., 206
 Madison, WI 53702
 Phone (608) 277-5888
 Fax (608) 283-5588

**Collaborative
 Design™**
107 West 16th Street, Suite 100
 Madison, WI 53703
 Phone (608) 255-5555
 Fax (608) 255-5555

Project title:

A PROPOSED
 400,000 SF
 OFFICE FOR
**WILDE
 EAST
 TOWNE
 HONDA**
 5555 HIGH CROSSING
 MADISON, WI

Sheet title:
ELEVATIONS

DATE:
 DRAWN BY:
 CHECKED BY:
 TITLE:
 PROJECT NUMBER:
 SHEET NUMBER:

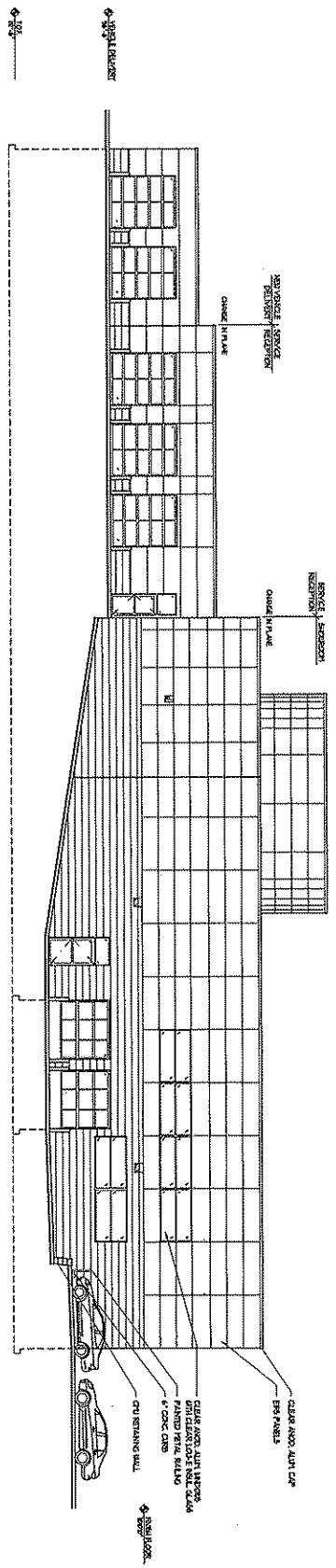

SOUTH ELEVATION
 1/8" = 1'-0"

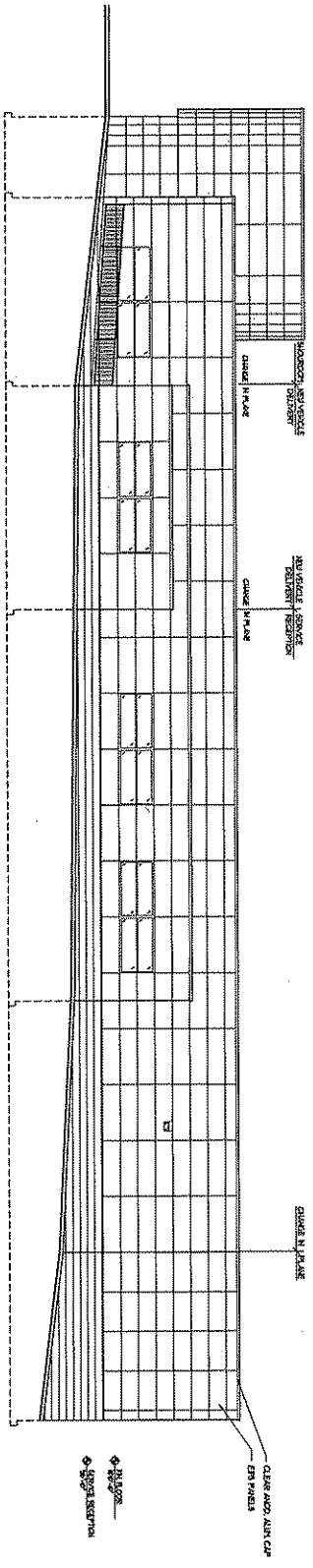

EAST ELEVATION
 1/8" = 1'-0"

5



Erli L. Kaufman, AIA
ARCHITECTURE
CONSULTING

428 N. Broadway, Suite 206
Baltimore, MD 21202
Phone: 410.528.2509
Fax: 410.528.2509

Collaborative
Design
1011 York, 14th Fl., York, Pennsylvania 17403
Tel: 717.853.8222
Fax: 717.853.8209

Project title:

A PROPOSED
AUTOMOBILE
DEALERSHIP FOR

WILDE
EAST
TOWNE
HONDA

5555 HIGH CROSSING
BLVD.
MADISON, WI

SHEET TITLE:
**CAR WASH/
DUMPSTER
ENCLOSURE
ELEVATIONS**

DATE:

DRAWN BY:

1118 NAME:

PROJECT NUMBER:
202004

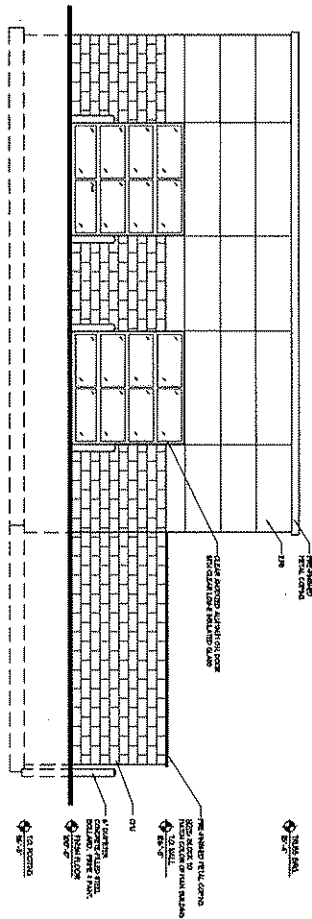

SOUTH ELEVATION
1/4\"/>

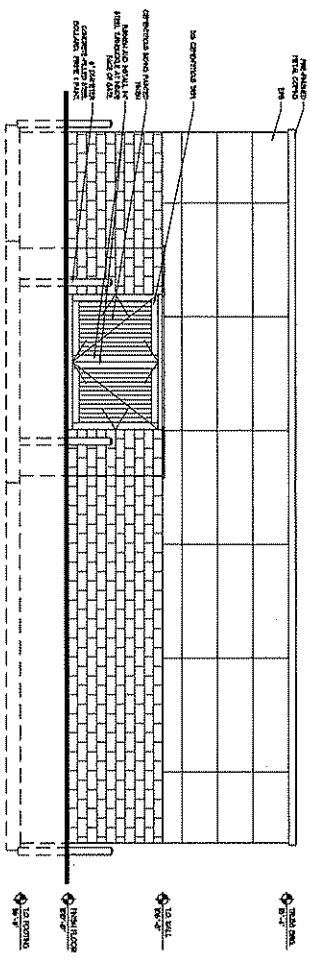

EAST ELEVATION
1/4\"/>