

AFFIDAVIT OF MAILING

STATE OF WISCONSIN)
) ss.
COUNTY OF DANE)

JOHANNA JOHNSON, being first duly sworn on oath, deposes and says that:

1. She is a Program Assistant 3 with the Office of the City Engineer, City of Madison, Dane County, Wisconsin, and did on the day of DECEMBER 2, 2016 placed in envelopes addressed to each interested owner of respective addresses as indicated by attached assessment list, a true and correct copy of the notice of assessments for the project titled GRAND AVENUE, VAN HISE AVENUE, PARK PLACE AND MASON STREET ASSESSMENT DISTRICT - 2017 attached hereto.
2. She did and delivered the envelopes to the Mail Room of the Dane County Printing and Services Division, 210 Martin Luther King, Jr. Blvd., in the city of Madison, Dane County Wisconsin, for postage and depositing in the United States Mail.

Johanna L. Johnson

Johanna L. Johnson

Subscribed and sworn to before me
this 2 day of DECEMBER, 2016

Eric A. Christianson

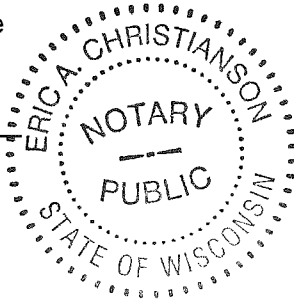

Notary Public, State of Wisconsin
My Commission expires:



Department of Public Works
Engineering Division
Robert F. Phillips, P.E., City Engineer

Parcel Number: 0709-211-0511-4
Situs Address: 421 Grand Ave
SHILLINGBURG, RALPH D
ELIZABETH M SHILLINGBURG
2559 RICHARDSON ST
FITCHBURG, WI 53711-0000

December 2, 2016

To: Property Owners along Grand Ave., Mason St., Park Place and Van Hise Ave.
Re: Proposed Street Reconstruction Project & Public Hearing

The City of Madison is proposing reconstruct the above referenced streets in 2017. Enclosed with this letter is a fact sheet with some details on the proposed project along with a notification for the Public Hearing before the Board of Public Works. The date, time and location of the public hearing can be found on the notification.

This project will involve special assessments to the owners of property adjacent to the project. The property owners will be assessed for various items included with this proposed project. The costs of some items are shared between the property owner and the City, while other costs are assessed entirely to the property owner. A table detailing the City's standard assessment policy for these items is included in the fact sheet.

Also enclosed is a Schedule of Assessments, which shows the property owner's share of estimated costs for each property adjacent to the project. After the work is complete, a final assessment will be calculated based on bid prices and work actually performed. The final assessment, which will be billed after the completion of the project, is payable in one lump sum or over a period of 8 years, with 3.0% interest charged on the unpaid balance.

To request accommodations for special needs or disabilities, or if you have any other questions regarding this project, please contact the Project Engineer. This includes requests relating to the Public Hearing and also requests relating to the actual operations of construction. A list of contacts for this project can be found on the enclosed fact sheet.

Sincerely,

Robert F. Phillips, P.E.
City Engineer

RFP:LKH
Cc by email:

Alder Shiva Bidar-Sielaff	Jeremy Nash, Traffic Engineering
Daniel Olivares, City Engineering	Chris Petykowski, City Engineering
Adam Wiederhoeft, Water Utility	
Chris Kelley, Streets Division	Christy Bachmann, City Engineering
Dane County 911	
Marla Eddy, City Forestry	
Ed Ruckriegel, Fire Department	
Cindy Mierow, Police Department	
Michael LaCount, MMSD mlacount@madison.k12.wi.us	
Mick Howan, Madison School District Transportation, mjhowan@madison.k12.wi.us	
De'Kendra Stamps, Madison School District Transportation, dbstamps@madison.k12.wi.us	
Jeff Fedler, Madison School District Transportation Coordinator, jfedler@madison.k12.wi.us	
Bob Byington, Madison School District Transportation, rlbyington@madison.k12.wi.us	
Sandra Mell, Madison School District Transportation, smell@madison.k12.wi.us	
Jason Fenske, Badger Bus Lines, jasonf@badgerbus.com	

NOTICE OF PUBLIC HEARING
BEFORE THE BOARD OF PUBLIC WORKS
FOR
PLANS, SPECIFICATIONS, AND SPECIAL ASSESSMENTS
FOR
PUBLIC WORKS IMPROVEMENTS
MADISON, WISCONSIN

PART I

The Common Council of the City of Madison, Wisconsin, having heretofore decided that it is expedient and necessary that the improvements as listed in Part II hereof be improved at the expense of the property thereby on which would be conferred some special benefit.

NOW, THEREFORE, NOTICE IS HEREBY GIVEN:

That the City Engineer has prepared plans, specifications, a proposed schedule of assessments, and an estimate of the entire costs of the improvement for each of the districts listed in Part II hereof, and;

That the plans, specifications, a proposed schedule of assessments, and an estimate of the entire cost of the improvements listed hereto are available and open to inspection by all interested persons in the office of the City Engineer, Room 115, City-County Building, 210 Martin Luther King Jr. Blvd., between the hours of 7:30 a.m. and 4:00 p.m., Monday through Friday, and will so continue to be for ten (10) working days from the first published date of this notice, and;

That on WEDNESDAY, DECEMBER 14, 2016 AT 5:30 P.M., the Board of Public Works will hold a public hearing in ROOM 108 (PARKS CONFERENCE ROOM) OF THE CITY COUNTY BUILDING and will consider any objections that may be filed in writing or in person and hear all persons desiring to be heard, and;

That special assessments may be paid over an eight (8) year period, with the owner paying 1/8 of the principal each year plus three (3%) percent interest on the unpaid balance, as determined by the Board of Public Works.

That if the total assessment is paid in full before October 31st in the year that the billing is made, irrespective of project completion, then no interest shall be charged.

If you require an interpreter, materials in alternate formats, or other accommodations to access this public hearing, please contact the Engineering Division at phone (608) 266-4751 or email us at engineering@cityofmadison.com. Please make contact at least 24 hours prior to the date of this public hearing so that we can make proper accommodations.

PART II

GRAND AVENUE, VAN HISE AVENUE, PARK PLACE AND MASON STREET ASSESSMENT DISTRICT - 2017
RESURFACING 2017 - ASSESSMENT DISTRICT
GREGORY STREET, KNICKERBOCKER STREET, SPRAGUE STREET AND SHELDON STREET RECONSTRUCTION ASSESSMENT DISTRICT - 2017

By Order of the Board of Public Works
Madison, Wisconsin

PUB: WSJ DECEMBER 2, 2016

Fact and Details Sheet

Proposed 2017 Grand Ave, Mason St, Park Place and Van Hise Ave Reconstruction

Project Details – Proposed Work

Sanitary Sewer: Replace existing main (installed in 1919 & 1923) and replace laterals to the property line (*assessable*).

Water Main: Replace the existing water main (installed in 1914-19) and reconnect services to the new main.

Street: Replace the pavement and the existing curb, driveway aprons. (*assessable*). Drive aprons will be constructed to match the width of the driveway on private property, but will not exceed the widths allowed by ordinance. Sidewalk will be replaced on an “as-needed” basis or to facilitate the sanitary sewer lateral replacement. (*assessable*). The street widths will remain the same as the existing.

Trees: The City Forester had determined that the following trees need to be removed, during construction, either to combat the Emerald Ash Borer or because of the declining health or condition. The trees within the project limits that will remain will be pruned by City Forestry prior to the start of construction.

2550 Van Hise (3 trees)	2557 Chamberlain	10 Grand Ave
411 Grand Ave	402 Grand Ave	2626 Park Pl
2602 Chamberlain	2650 Mason St	2606 Van Hise
413 Grand Ave	417 Grand Ave	106 Grand Ave
10 Grand Ave	2551 Van Hise	105 Grand Ave

Rain Gardens: This project is a good candidate for terrace rain gardens, a map showing parcels that are eligible for rain garden installation is available on the project web page at <http://www.cityofmadison.com/engineering/projects/road-construction>

Construction Schedule & Impacts

Tentative Schedule: April until September, 2017

Traffic Impacts: Grand Ave., Mason St., Park Place and Van Hise Ave. will be closed to thru traffic during construction. Staff is considering options for phasing the project to minimize the impact on parking; but no decisions have been made at this time. Access will be maintained to properties within the project limits, but driveway access may be prohibited for up to a total of 20 days to accommodate the removal and replacement of the curb and drive apron.

Pedestrian access will be maintained on at least one side of each of the streets at all times.

Parking: On-street parking is prohibited between 7am and 7 pm within the project limits. Temporary residential parking permits will be made available, at no cost, to eligible residents within the project limits.

Water & Sewer Shut-offs: Water and sanitary sewer service will be disrupted when the old lateral is taken out of service and the new lateral is connected. A minimum of 48 hours of notice will be provided prior to the shut-offs. Each shut-off should last a few hours.

At the start of construction, the existing main will remain in service until the new main is installed and connected to; emergency shut-offs may occur if the existing main is damaged during construction.

Refuse Collection: Residents should have their trash and recycling carts at the curb by 6 a.m. If necessary, the contractor will move the carts to the closest intersection to facilitate pick-up. It will be the residents’ responsibility to return the carts to their property. It is recommended that you put your address on the cart.

Project Location Map

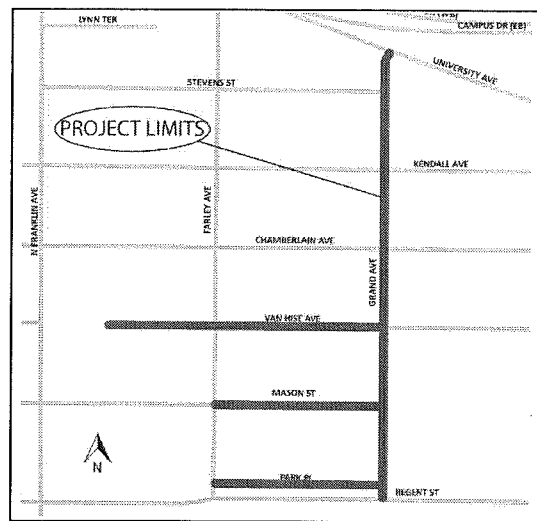

Project Contacts

Project Manager: LeAnne Hannan – 266-4057, lhannan@cityofmadison.com

Sanitary Sewer: Daniel Olivares – 261-9285 dolivares@cityofmadison.com

Storm Sewer: Daniel Olivares – 261-9285 dolivares@cityofmadison.com

Water: Adam Wiederhoeft – 266-9121 awiederhoeft@madisonwater.org

Construction: John Fahrney – 266-9091, jfahrney@cityofmadison.com

Forestry: Dean Kahl – 266-4891, dkahl@cityofmadison.com

Assessment Policy Breakdown

Item	City Share	Owner Share
Conc. curb, sidewalk, aprons	50%	50%
Sanitary Laterals	75%	25%
Private Storm Connection	0%	100%
Asphalt Pavement	100%	0%
Sanitary & Storm Mains	100%	0%
Water Main	100%	0%
Sidewalk Ramps	100%	0%

Parcel Number	Owner's Name/Mailing Address	Situs Address	Frontage	Remove Concrete Drive Apron @ \$1.50 per SF		Replace Concrete Drive Apron @ \$4.00 per SF		Street Reconstruction Items		Sanitary Sewer Items		TOTAL ASSWT						
				SF	Cost	SF	Cost	Factor	SF	Cost	Factor		LF	Cost	Each	Cost	LF	Cost
0709-211-1218-5 TR-C3	GALLONI, PHILIP A 2350 CHAMBERLAIN AVE MADISON WI	2350 Chamberlain Ave	80.00 L.F.	162.0	\$243.00	146.0	\$584.00	0.5	279.0	\$627.75	0.5	129.0	\$1,161.00	1.0	\$450.00	42.0	\$866.62	\$3,952.37
0709-211-1318-9 TR-C3	SEIDEL, RUTHANNA S 2357 CHAMBERLAIN AVE MADISON WI	2357 Chamberlain Ave	80.00 L.F.	143.0	\$214.50	147.0	\$588.00	0.5	130.0	\$292.50	0.5	127.0	\$1,143.00	1.0	\$450.00	36.0	\$759.96	\$3,447.96
0709-211-1325-8 TR-C2	HEASLETT, PETER J & LESLIE A EVERSOLE 2602 CHAMBERLAIN AVE MADISON WI	2602 Chamberlain Ave	120.00 L.F.	179.0	\$268.50	155.0	\$620.00	0.5	126.0	\$283.50	1.0	120.0	\$2,160.00	1.0	\$450.00	42.0	\$866.62	\$4,668.62
0709-212-2143-1 TR-C2	NATHAN, ROBIN SCINITZLER 202 FARLEY AVE MADISON WI	202 Farley Ave	80.00 L.F.	0.0	\$0.00	0.0	\$0.00	0.5	100.0	\$225.00	0.5	0.0	\$0.00	1.0	\$450.00	42.0	\$866.62	\$1,561.62
0709-211-2623-1 TR-C2	FORTER, KATHERINE RENE AARON JON FERIS 10 GRAND AVE MADISON WI	10 Grand Ave	148.00 L.F.	263.0	\$394.50	245.0	\$980.00	0.5	231.0	\$519.75	0.5	148.0	\$1,352.00	1.0	\$450.00	34.0	\$717.74	\$4,393.99
0709-211-2626-9 TR-C2	BOARK, TRUST, EUGENE & JEN 16 GRAND AVE MADISON WI	16 Grand Ave	60.00 L.F.	130.0	\$308.50	166.0	\$664.00	1.0	260.0	\$900.00	1.0	60.0	\$1,080.00	2.0	\$900.00	72.0	\$1,519.92	\$5,272.42
0709-211-2627-7 TR-C2	ONEILL, CHRISTOPHER A & HEDIM, ONEILL 20 GRAND AVE MADISON WI	20 Grand Ave	60.00 L.F.	147.0	\$220.50	170.0	\$680.00	1.0	100.0	\$450.00	1.0	60.0	\$1,080.00	1.0	\$450.00	49.0	\$1,034.39	\$3,214.89
0709-211-2628-5 TR-C2	METR, PETER 24 GRAND AVE MADISON WI	24 Grand Ave	148.00 L.F.	208.0	\$312.00	198.0	\$792.00	0.5	100.0	\$225.00	0.5	148.0	\$1,332.00	1.0	\$450.00	49.0	\$1,034.39	\$4,145.39
0709-211-2523-3 TR-C2	VANDALL, IVY TR, SHERLEY B 102 GRAND AVE MADISON WI	102 Grand Ave	148.00 L.F.	100.0	\$150.00	105.0	\$420.00	0.5	275.0	\$618.75	0.5	148.0	\$1,332.00	2.0	\$900.00	78.0	\$1,646.58	\$5,067.33
0709-211-2413-0 CI	MADISON METRO SCHOOL DIST WEST HIGH SCHOOL 345 W DAYTON ST MADISON WI	105 Grand Ave	480.00 L.F.	0.0	\$0.00	0.0	\$0.00	1.0	150.0	\$675.00	1.0	480.0	\$8,640.00	2.0	\$900.00	80.0	\$1,688.80	\$11,903.80
0709-211-2526-1 TR-C2	CLYCK, JOHN 106 GRAND AVE MADISON WI	106 Grand Ave	60.00 L.F.	117.0	\$175.50	135.0	\$540.00	1.0	100.0	\$450.00	1.0	60.0	\$1,080.00	1.0	\$450.00	37.0	\$781.07	\$3,376.57
0709-211-1423-6 TR-C3	GILJECK, M BRIGHOUSE & L 206 GRAND AVE MADISON WI	206 Grand Ave	40.00 L.F.	162.0	\$243.00	163.0	\$652.00	1.0	125.0	\$562.50	1.0	40.0	\$720.00	1.0	\$450.00	36.0	\$759.96	\$3,387.46
0709-211-1319-7 TR-C3	MALIK, MATTHEW R HEATHER MALIK 213 GRAND AVE MADISON WI	213 Grand Ave	40.00 L.F.	150.0	\$228.50	176.0	\$704.00	1.0	125.0	\$562.50	1.0	40.0	\$720.00	1.0	\$450.00	39.0	\$823.29	\$3,498.29
0709-211-1426-4 TR-C3	ZOETEEMAN, ANTHONY 214 GRAND AVE MADISON WI	214 Grand Ave	60.00 L.F.	136.0	\$204.00	125.0	\$500.00	1.0	180.0	\$810.00	1.0	60.0	\$1,080.00	1.0	\$450.00	45.0	\$949.95	\$3,293.95
0709-211-1427-2 TR-C3	HACKEL, SCOTT P & JENNIFER HACKEL 220 GRAND AVE MADISON WI	220 Grand Ave	60.00 L.F.	0.0	\$0.00	0.0	\$0.00	0.5	182.0	\$409.50	0.5	60.0	\$340.00	1.0	\$450.00	36.0	\$759.96	\$2,159.46
0709-211-1217-7 TR-C3	STATHAS, LYNN M 309 GRAND AVE MADISON WI	309 Grand Ave	40.00 L.F.	168.0	\$252.00	173.0	\$692.00	1.0	100.0	\$450.00	1.0	40.0	\$720.00	1.0	\$450.00	36.0	\$759.96	\$3,323.96
0709-211-1236-6 TR-C3	VON RUTENBERG, ROBERT K 312 GRAND AVE MADISON WI	312 Grand Ave	40.00 L.F.	84.0	\$126.00	78.0	\$312.00	1.0	100.0	\$450.00	1.0	40.0	\$720.00	1.0	\$450.00	40.0	\$844.40	\$2,202.40
0709-211-1216-9 TR-C3	HEASLETT, ANN M 315 GRAND AVE MADISON WI	315 Grand Ave	40.00 L.F.	0.0	\$0.00	169.0	\$676.00	1.0	100.0	\$450.00	1.0	40.0	\$720.00	1.0	\$450.00	40.0	\$844.40	\$3,140.40
0709-211-1327-4 TR-C3	HAYES, RICHARD A 316 GRAND AVE MADISON WI	316 Grand Ave	40.00 L.F.	74.0	\$111.00	74.0	\$296.00	1.0	125.0	\$562.50	1.0	40.0	\$720.00	1.0	\$450.00	36.0	\$759.96	\$2,899.46

Parcel Number	Owner's Name/Address	Site Address	Frontage	Street Reconstruction Items				Sanitary Sewer Items				TOTAL ASSMT								
				Remove Concrete Drive Apron @ \$1.50 per SF	Replace Concrete Drive Apron @ \$4.00 per SF	Remove & Replace Sidewalk @ \$4.50 per Square Foot (SF)	Factor	Remove & Replace Curb & Gutter @ \$18.00 per Linear Foot (LF)	Factor	Sanitary Sewer Reconnection	Rem. & Repl Sanitary Lateral @ \$71.11 per LF									
0709-211-0527-3	LOUETTE REYTR, ANTOUR F ATIN FAIRCREST MNGMT 1741 COMMERCIAL AVE MADISON WI	402 Grand Ave	120.00 L.F.	\$12.00	\$680.00	\$1,520.00	0.5	386.0	\$450.00	200.0	\$450.00	0.5	104.0	\$356.00	2.0	\$900.00	73.0	\$1,541.03	\$6,115.03	
0709-211-0514-8	WADLINGTON, TIA/OTHY D 2134 KENDALL AVE MADISON WI	411 Grand Ave	44.00 L.F.	152.0	\$228.00	152.0	1.0	100.0	\$450.00	1.0	44.0	\$792.00	1.0	39.0	\$823.29	1.0	\$450.00	39.0	\$823.29	\$3,351.29
0709-211-0513-0	BERSECH, ANDREW J & TACHEL M BERSECH 413 GRAND AVE MADISON WI	413 Grand Ave	44.00 L.F.	174.0	\$261.00	163.0	1.0	100.0	\$450.00	1.0	44.0	\$792.00	-1.0	36.0	\$759.96	1.0	\$450.00	36.0	\$759.96	\$3,364.96
0709-211-0512-2	PROVE III ROBERT D ASHLEY N J PPORE 417 GRAND AVE MADISON WI	417 Grand Ave	44.00 L.F.	181.0	\$271.50	155.0	1.0	151.0	\$679.50	1.0	44.0	\$792.00	1.0	36.0	\$759.96	1.0	\$450.00	36.0	\$759.96	\$3,372.96
0709-211-0511-4	SHILLINGBERG, KATHLEEN D ELIZABETH M SHILLINGBERG 2559 RICHARDSON ST FITZGERBERG WI	421 Grand Ave	44.00 L.F.	144.0	\$216.00	152.0	1.0	125.0	\$562.50	1.0	44.0	\$792.00	1.0	38.0	\$802.18	1.0	\$450.00	38.0	\$802.18	\$3,430.68
0709-211-1215-1	PRIBERENOW, MITCHEL & MONA GOODMAN 2551 KENDALL AVE MADISON WI	2551 Kendall Ave	80.00 L.F.	140.0	\$210.00	161.0	0.5	100.0	\$225.00	0.5	68.0	\$612.00	1.0	36.0	\$759.96	1.0	\$450.00	36.0	\$759.96	\$2,900.96
0709-211-0515-6	KENDALL TOWNHOUSE LLC % STEPHEN D BROWN 120 W GORHAM ST MADISON WI	2560 Kendall Ave	88.00 L.F.	262.0	\$393.00	293.0	0.5	125.0	\$281.25	0.5	72.0	\$648.00	2.0	71.0	\$1,498.81	2.0	\$900.00	71.0	\$1,498.81	\$4,893.06
0709-211-1301-8	FAIR, J RICHARD 2603 KENDALL AVE MADISON WI	2603 Kendall Ave	40.00 L.F.	0.0	\$0.00	0.0	0.5	0.0	\$0.00	0.5	27.0	\$243.00	0.0	0.0	\$0.00	0.0	\$0.00	0.0	\$0.00	\$243.00
0709-211-2601-1	SEIDLEY, THERESA A 2609 MASON ST MADISON WI	2609 Mason St	44.00 L.F.	208.0	\$312.00	198.0	1.0	100.0	\$450.00	1.0	44.0	\$792.00	1.0	31.0	\$654.41	1.0	\$450.00	31.0	\$654.41	\$3,450.41
0709-211-2524-5	HENDER, GORDON W DENISE L WENDER 2612 MASON ST MADISON WI	2612 Mason St	44.00 L.F.	109.0	\$163.50	147.0	1.0	100.0	\$450.00	1.0	44.0	\$792.00	1.0	30.0	\$633.30	1.0	\$450.00	30.0	\$633.30	\$3,076.80
0709-211-2602-9	WITKALSKAS, SANDRA J 2613 MASON ST MADISON WI	2613 Mason St	44.00 L.F.	86.0	\$129.00	95.0	1.0	100.0	\$450.00	1.0	44.0	\$792.00	1.0	33.0	\$696.63	1.0	\$450.00	33.0	\$696.63	\$2,897.63
0709-211-2523-7	BOYLE, OWEN ANNE REIS 2614 MASON ST MADISON WI	2614 Mason St	44.00 L.F.	143.0	\$214.50	108.0	1.0	100.0	\$450.00	1.0	44.0	\$792.00	1.0	36.0	\$759.96	1.0	\$450.00	36.0	\$759.96	\$3,098.46
0709-211-2603-7	ANNA, PETER ERIKA R ANNA 2615 MASON ST MADISON WI	2615 Mason St	44.00 L.F.	86.0	\$129.00	59.0	1.0	100.0	\$450.00	1.0	44.0	\$792.00	1.0	30.0	\$633.30	1.0	\$450.00	30.0	\$633.30	\$2,690.30
0709-211-2522-9	BRADBURY, EDWARD LIKE REBECCA J BRADBURY 2616 MASON ST MADISON WI	2616 Mason St	44.00 L.F.	102.0	\$153.00	108.0	1.0	100.0	\$450.00	1.0	44.0	\$792.00	1.0	30.0	\$633.30	1.0	\$450.00	30.0	\$633.30	\$2,970.30
0709-211-2604-5	METZES, GARY C 2619 MASON ST MADISON WI	2619 Mason St	44.00 L.F.	84.0	\$126.00	80.0	1.0	178.0	\$801.00	1.0	44.0	\$792.00	1.0	31.0	\$654.41	1.0	\$450.00	31.0	\$654.41	\$3,143.41
0709-211-2521-1	MASANA, PETER M DILL M MASANA 2622 MASON ST MADISON WI	2622 Mason St	44.00 L.F.	126.0	\$189.00	116.0	1.0	178.0	\$801.00	1.0	44.0	\$792.00	1.0	30.0	\$633.30	1.0	\$450.00	30.0	\$633.30	\$3,329.30
0709-211-2605-3	HEBER, THOMAS P SCOTT M HEBER 2625 MASON ST MADISON WI	2625 Mason St	44.00 L.F.	133.0	\$199.50	141.0	1.0	100.0	\$450.00	1.0	44.0	\$792.00	1.0	33.0	\$696.63	1.0	\$450.00	33.0	\$696.63	\$3,152.13
0709-211-2520-3	FORTNER, LYNN TONI & JAMES LEWIS FORTNER 2626 MASON ST MADISON WI	2626 Mason St	44.00 L.F.	115.0	\$172.50	120.0	1.0	100.0	\$450.00	1.0	44.0	\$792.00	1.0	30.0	\$633.30	1.0	\$450.00	30.0	\$633.30	\$2,977.80
0709-211-2606-1	MCCLEAN, MARGAN N 2629 MASON ST MADISON WI	2629 Mason St	44.00 L.F.	97.0	\$145.50	111.0	1.0	100.0	\$450.00	1.0	44.0	\$792.00	1.0	30.0	\$633.30	1.0	\$450.00	30.0	\$633.30	\$2,974.80

Parcel Number	Owner's Name/Marketing Address	Site Address	Frontage	Street Reconstruction Items				Sanitary Sewer Items				TOTAL ASSUMT					
				Remove Concrete Drive Apron @ \$1.50 per SF	Replace Concrete Drive Apron @ \$4.00 per SF	Remove & Replace Sloewalk @ \$4.50 per Square Foot (SFT)	Factor	Remove & Replace Curb & Gutter @ \$18.00 per Linear Foot (LF)	Factor	Sanitary Sewer Reconnection \$450.00 Each	Each		Rem. & Repl. Sanitary Lateral @ \$21.11 per LF	LF			
0709-211-2619-6 TR-C2	ANDERSEN, PHILIP J CAROL A ANDERSEN 2630 MASON ST MADISON WI	2630 Mason St	44.00 L.F.	141.0	\$211.50	105.0	\$420.00	1.0	100.0	\$450.00	1.0	\$450.00	1.0	\$450.00	30.0	\$633.30	\$2,956.80
0709-211-2618-8 TR-C2	JONES, DAVID E & HOLLY D 2632 MASON ST MADISON WI	2632 Mason St	44.00 L.F.	108.0	\$162.00	107.0	\$428.00	1.0	152.0	\$684.00	1.0	\$450.00	1.0	\$450.00	31.0	\$654.41	\$3,170.41
0709-211-2607-9 TR-C2	DAMER, JACK F 2631 MASON ST MADISON WI	2631 Mason St	44.00 L.F.	120.0	\$180.00	113.0	\$452.00	1.0	180.0	\$810.00	1.0	\$450.00	1.0	\$450.00	31.0	\$654.41	\$2,978.41
0709-211-2617-0 TR-C2	DAVIS, JAMES & ZHEN 2636 MASON ST MADISON WI	2636 Mason St	44.00 L.F.	127.0	\$190.50	127.0	\$508.00	1.0	100.0	\$450.00	1.0	\$450.00	1.0	\$450.00	30.0	\$633.30	\$3,023.80
0709-211-2608-7 TR-C2	KEILLER, LINDA M & CHARLES R MCDONALD 2657 MASON ST MADISON WI	2657 Mason St	44.00 L.F.	100.0	\$150.00	83.0	\$332.00	1.0	100.0	\$450.00	1.0	\$450.00	1.0	\$450.00	30.0	\$633.30	\$2,807.30
0709-211-2616-2 TR-C2	TAYLOR, MICHAEL R MELISSA S HUNTERLEY TAYLOR 2638 MASON ST MADISON WI	2638 Mason St	44.00 L.F.	184.0	\$276.00	196.0	\$784.00	1.0	157.0	\$706.50	1.0	\$450.00	1.0	\$450.00	30.0	\$633.30	\$3,641.80
0709-211-2609-5 TR-C2	WARGATT, CHRISTOPHER C SILVANA R WARGATT 2639 MASON ST MADISON WI	2639 Mason St	44.00 L.F.	99.0	\$148.50	116.0	\$464.00	1.0	100.0	\$450.00	1.0	\$450.00	1.0	\$450.00	32.0	\$675.52	\$2,980.02
0709-211-2610-2 TR-C3	AGARD, ELIZABETH 2645 MASON ST MADISON WI	2645 Mason St	44.00 L.F.	175.0	\$262.50	182.0	\$728.00	1.0	172.0	\$774.00	1.0	\$450.00	1.0	\$450.00	31.0	\$654.41	\$3,660.91
0709-211-2613-4 TR-C2	HUGHES, DAVID M & SUSAN M BROOK 2646 MASON ST MADISON WI	2646 Mason St	44.00 L.F.	72.0	\$108.00	75.0	\$300.00	1.0	180.0	\$810.00	1.0	\$450.00	1.0	\$450.00	32.0	\$675.52	\$2,775.52
0709-211-2611-0 TR-C3	PETERSON, THOMAS B 2649 MASON ST MADISON WI	2649 Mason St	44.00 L.F.	90.0	\$135.00	1104.0	\$4,416.00	0.5	100.0	\$225.00	0.5	\$450.00	1.0	\$450.00	30.0	\$633.30	\$6,255.30
0709-211-2614-6 TR-C2	MILLER, LORNA M 2650 MASON ST MADISON WI	2650 Mason St	44.00 L.F.	70.0	\$105.00	71.0	\$284.00	0.5	100.0	\$225.00	0.5	\$450.00	1.0	\$450.00	30.0	\$633.30	\$2,048.30
0709-211-2624-3 TR-C2	CHRISTIANSON, BRENT D & BEBECCA L CHRISTIANSON 2610 PARK PL MADISON WI	2610 Park Pl	44.00 L.F.	109.0	\$163.50	116.0	\$464.00	1.0	100.0	\$450.00	1.0	\$450.00	1.0	\$450.00	30.0	\$633.30	\$2,952.80
0709-211-2623-5 TR-C2	WAELTI, KARA J 2616 PARK PL MADISON WI	2616 Park Pl	44.00 L.F.	100.0	\$150.00	105.0	\$420.00	1.0	126.0	\$567.00	1.0	\$450.00	1.0	\$450.00	34.0	\$717.74	\$3,096.74
0709-211-2622-7 TR-C2	MARTIN, JOEL A KATHLEEN E MARTIN 2618 PARK PL MADISON WI	2618 Park Pl	44.00 L.F.	80.0	\$120.00	85.0	\$340.00	1.0	150.0	\$675.00	1.0	\$450.00	1.0	\$450.00	30.0	\$633.30	\$3,010.30
0709-211-2621-9 TR-C2	FOAGLAND, EVAN & JUDITH A GIUSTO 2622 PARK PL MADISON WI	2622 Park Pl	44.00 L.F.	64.0	\$96.00	72.0	\$288.00	1.0	100.0	\$450.00	1.0	\$450.00	1.0	\$450.00	30.0	\$633.30	\$2,709.30
0709-211-2620-1 TR-C2	FROR, TIMOTHY 2626 PARK PL MADISON WI	2626 Park Pl	44.00 L.F.	92.0	\$138.00	97.0	\$388.00	1.0	180.0	\$810.00	1.0	\$450.00	1.0	\$450.00	30.0	\$633.30	\$2,851.30
0709-211-2619-4 TR-C2	SICOTT, ROBERT MONAN R SICOTT 2630 PARK PL MADISON WI	2630 Park Pl	44.00 L.F.	110.0	\$165.00	115.0	\$462.00	1.0	100.0	\$450.00	1.0	\$450.00	1.0	\$450.00	31.0	\$654.41	\$2,971.41
0709-211-2618-6 TR-C2	PRESTON BURTON R & ELIZABETH L PRESTON 2634 PARK PL MADISON WI	2634 Park Pl	44.00 L.F.	94.0	\$141.00	107.0	\$428.00	1.0	125.0	\$562.50	1.0	\$450.00	1.0	\$450.00	32.0	\$675.52	\$3,049.02
0709-211-2617-8 TR-C2	PAVIA-DUNN, DANNA L 2638 PARK PL MADISON WI	2638 Park Pl	44.00 L.F.	139.0	\$208.50	135.0	\$540.00	1.0	100.0	\$450.00	1.0	\$450.00	1.0	\$450.00	31.0	\$654.41	\$3,094.91

Parcel Number	Owner's Name/Mailing Address	Site Address	Frontage	Street Reconstruction Items				Sanitary Sewer Items				TOTAL ASSUM			
				Remove Concrete Drive Apron @ \$1.50 per SF	Replace Concrete Drive Apron @ \$4.00 per SF	Remove & Replace Sidewalk @ \$4.50 per Square Foot (SF)	Factor	Remove & Replace Curb & Gutter @ \$18.00 per Linear Foot (LF)	Factor	Sanitary Sewer Reconstruction @ \$450.00 Each	Each		Rem. & Repl. Sanitary Lateral @ \$211.11 per LF	LF	
0709-211-2616-0 TR-C2	SIELE, ROBERT A & CHRISTINE G SIELK 2642 PARK PL MADISON WI	2642 Park Pl	44.00 L.F.	117.0	122.0	1.0	149.0	1.0	44.0	1.0	1.0	1.0	31.0	\$654.41	\$3,230.41
0709-211-2615-2 TR-C3	BDW LIVING TRUST 2644 PARK PL MADISON WI	2644 Park Pl	44.00 L.F.	100.0	100.0	1.0	231.0	1.0	44.0	1.0	1.0	1.0	31.0	\$654.41	\$3,485.91
0709-211-2614-4 TR-C3	NICHOLAS & JUDITH WAHBE NICHOLAS 2646 PARK PL MADISON WI	2646 Park Pl	44.00 L.F.	103.0	108.0	0.5	127.0	0.5	44.0	0.5	1.0	1.0	31.0	\$654.41	\$2,272.66
0709-211-0320-9 TR-C4, WP-66	BARHOLLOW, STEVEN D & LYDIA A ZIEBDA 2602 STEVENS ST MADISON WI	2602 Stevens St	44.00 L.F.	0.0	0.0	0.5	100.0	0.5	44.0	0.5	1.0	1.0	40.0	\$844.40	\$1,915.40
0709-211-0401-7 TR-C4	BEDNIAEZ, BRYAN P 2603 STEVENS ST MADISON WI	2603 Stevens St	120.00 L.F.	141.0	170.0	0.5	252.0	0.5	120.0	0.5	2.0	2.0	81.0	\$1,709.91	\$5,148.41
0709-211-0929-7 TR-C2	KINGSTON CORNER LLC 2379 UNIVERSITY AVE MADISON WI	2385 University Ave	129.00 L.F.	0.0	0.0	1.0	0.0	1.0	129.0	1.0	0.0	0.0	0.0	\$0.00	\$2,222.00
0709-211-0901-9 TR-C2	SCOTT, GARTH K & KAREN L 5025 OLD MADISON RD MADISON WI	2601 University Ave	164.00 L.F.	170.0	195.0	1.0	175.0	1.0	80.0	1.0	1.0	1.0	37.0	\$781.07	\$4,485.57
0709-211-1520-4 TR-C2	STUMPF, KYLE P KASINDA A STUMPF 2350 VAN HISE AVE MADISON WI	2350 Van Hise Ave	120.00 L.F.	142.0	154.0	0.5	152.0	0.5	120.0	0.5	1.0	1.0	37.0	\$781.07	\$3,482.07
0709-211-2412-2 TR-C2	CORCORAN, JAMES G 2351 VAN HISE AVE MADISON WI	2351 Van Hise Ave	120.00 L.F.	248.0	175.0	0.5	278.0	0.5	145.0	0.5	2.0	2.0	76.0	\$1,604.36	\$5,506.86
0709-211-2301-3 TR-C2	KIEHLER, JAMES 2601 VAN HISE AVE MADISON WI	2601 Van Hise Ave	164.00 L.F.	236.0	246.0	0.5	100.0	0.5	164.0	0.5	1.0	1.0	36.0	\$759.96	\$4,248.96
0709-211-1424-8 TR-C3	OLACKENBROSS, ROBERT F & DIANE OLACKENBROSS 2602 VAN HISE AVE MADISON WI	2602 Van Hise Ave	124.00 L.F.	147.0	172.0	0.5	166.0	0.5	124.0	0.5	1.0	1.0	42.0	\$866.62	\$3,714.62
0709-211-2502-1 TR-C2	LOERTSCHER, GARY E 2605 VAN HISE AVE MADISON WI	2605 Van Hise Ave	44.00 L.F.	117.0	143.0	1.0	100.0	1.0	44.0	1.0	1.0	1.0	35.0	\$738.85	\$3,178.35
0709-211-1423-0 TR-C3	MARTINEAU, SCOTT D 2606 VAN HISE AVE MADISON WI	2606 Van Hise Ave	44.00 L.F.	98.0	114.0	1.0	411.0	1.0	44.0	1.0	1.0	1.0	33.0	\$696.63	\$4,291.13
0709-211-1422-2 TR-C2	BETHKE, PAUL C & NATSUYO KOYAMA 2610 VAN HISE AVE MADISON WI	2610 Van Hise Ave	44.00 L.F.	113.0	96.0	1.0	220.0	1.0	44.0	1.0	1.0	1.0	30.0	\$633.30	\$3,418.80
0709-211-2503-9 TR-C2	STEDIL, THOMAS F & JANE B 2611 VAN HISE AVE MADISON WI	2611 Van Hise Ave	44.00 L.F.	113.0	117.0	1.0	100.0	1.0	44.0	1.0	1.0	1.0	31.0	\$654.41	\$2,983.91
0709-211-2504-7 TR-C2	REPPE, DAVID A & SARAH REPPE 2613 VAN HISE AVE MADISON WI	2613 Van Hise Ave	44.00 L.F.	100.0	100.0	1.0	100.0	1.0	44.0	1.0	1.0	1.0	31.0	\$654.41	\$2,896.41
0709-211-1421-4 TR-C2	FLARUP, TAMARA J 2614 VAN HISE AVE MADISON WI	2614 Van Hise Ave	44.00 L.F.	114.0	102.0	1.0	125.0	1.0	44.0	1.0	1.0	1.0	30.0	\$633.30	\$3,016.80
0709-211-1420-6 TR-C2	HALLZEM, FRANKS & NELL Y 2616 VAN HISE AVE MADISON WI	2616 Van Hise Ave	44.00 L.F.	106.0	107.0	1.0	100.0	1.0	44.0	1.0	1.0	1.0	30.0	\$633.30	\$2,912.30
0709-211-2503-5 TR-C2	HINKER, MARY JO 2617 VAN HISE AVE MADISON WI	2617 Van Hise Ave	44.00 L.F.	118.0	126.0	1.0	100.0	1.0	44.0	1.0	1.0	1.0	31.0	\$654.41	\$3,027.41
0709-211-1419-9 TR-C2	LINCK, JOHN M JILL P LINCK 2618 VAN HISE AVE MADISON WI	2618 Van Hise Ave	44.00 L.F.	93.0	93.0	1.0	125.0	1.0	44.0	1.0	1.0	1.0	30.0	\$633.30	\$2,949.30

Parcel Number	Owner's Name/Meeting Address	Site Address	Frontage	Street Reconstruction Items				Sanitary Sewer Items		Rem. & Repl. @ \$21.11 Per LF	Rem. & Repl. @ \$78.07	TOTAL ASSUMT
				Remove Concrete Drive Apron @ \$150 per SF	Replace Concrete Drive Apron @ \$4.00 per SF	Remove & Replace Sidewalk @ \$4.50 per Square Foot (SF)	Factor	Replace & Replace Curb & Gutter @ \$18.00 per Linear Foot (LF)	Sanitary Sewer Reconnection \$450.00 Each			
0709-211-2506-3 TR-C2	FRANCIS, LINDA R 2619 VAN HISE AVE MADISON WI	2619 Van Hise Ave	44.00 L.F.	134.0	129.0	100.0	1.0	44.0	1.0	1.0	37.0	\$3,190.07
0709-211-1418-1 TR-C2	BETTNER, HANNA J 2620 VAN HISE AVE MADISON WI	2620 Van Hise Ave	44.00 L.F.	110.0	87.0	132.0	1.0	44.0	1.0	1.0	30.0	\$3,072.30
0709-211-2507-1 TR-C2	ROSS, NICHOLAS A GOSTINO CHELSEA BARBA 2621 VAN HISE AVE MADISON WI	2621 Van Hise Ave	44.00 L.F.	124.0	123.0	100.0	1.0	44.0	1.0	1.0	31.0	\$3,032.41
0709-211-1417-3 TR-C2	HAMMEL, KENNETH E & KARETTI, CORINNE L 2622 VAN HISE AVE MADISON WI	2622 Van Hise Ave	44.00 L.F.	97.0	100.0	100.0	1.0	44.0	1.0	1.0	30.0	\$2,870.80
0709-211-2508-9 TR-C2	PITTSBERG, ANDREW R ALLISON J POLLOCK 2623 VAN HISE AVE MADISON WI	2623 Van Hise Ave	44.00 L.F.	102.0	103.0	100.0	1.0	44.0	1.0	1.0	33.0	\$2,952.63
0709-211-1416-5 TR-C2	JOHNSON, KEVIN M MEGREN C JOHNSON 2624 VAN HISE AVE MADISON WI	2624 Van Hise Ave	44.00 L.F.	84.0	97.0	100.0	1.0	44.0	1.0	1.0	30.0	\$2,839.30
0709-211-2509-7 TR-C2	STIELMACH, CHERYL A 2625 VAN HISE AVE MADISON WI	2625 Van Hise Ave	44.00 L.F.	86.0	83.0	100.0	1.0	44.0	1.0	1.0	31.0	\$2,812.41
0709-211-2510-4 TR-C2	ONDDAHL, WILLIAM M 2627 VAN HISE AVE MADISON WI	2627 Van Hise Ave	44.00 L.F.	86.0	85.0	100.0	1.0	44.0	1.0	1.0	32.0	\$2,856.52
0709-211-1415-7 TR-C2	NERDBERG, THOMAS & SARAH 2628 VAN HISE AVE MADISON WI	2628 Van Hise Ave	44.00 L.F.	111.0	109.0	100.0	1.0	44.0	1.0	2.0	63.0	\$4,074.43
0709-211-2511-2 TR-C2	HAVEY, MICHAEL J & OLGA BOKORWICZ-HAVEY 2641 VAN HISE AVE MADISON WI	2641 Van Hise Ave	44.00 L.F.	98.0	96.0	100.0	1.0	44.0	1.0	1.0	31.0	\$2,872.41
0709-211-1414-9 TR-C2	ARMSTRONG, MICHELLE L & JAMES L DENSKA 2642 VAN HISE AVE MADISON WI	2642 Van Hise Ave	44.00 L.F.	91.0	97.0	128.0	1.0	44.0	1.0	1.0	34.0	\$3,060.24
0709-211-2512-0 TR-C2	RYAN DANIEL M PAULAM RYAN 2643 VAN HISE AVE MADISON WI	2643 Van Hise Ave	44.00 L.F.	130.0	123.0	100.0	1.0	44.0	1.0	1.0	33.0	\$3,075.63
0709-211-1413-1 TR-C2	RIPP & ECKERMAN TRUST 2644 VAN HISE AVE MADISON WI	2644 Van Hise Ave	44.00 L.F.	119.0	127.0	126.0	1.0	44.0	1.0	1.0	31.0	\$3,149.91
0709-211-1412-3 TR-C2	DE LA ROSA, JEFFREY J LORA CERONE 2648 VAN HISE AVE MADISON WI	2648 Van Hise Ave	44.00 L.F.	0.0	0.0	100.0	0.5	39.0	0.5	1.0	30.0	\$1,659.30
0709-211-2513-8 TR-C2	DESCHERNES, ALEXANDER M JANET L DESCHERNES 2649 VAN HISE AVE MADISON WI	2649 Van Hise Ave	44.00 L.F.	109.0	116.0	100.0	0.5	39.0	0.5	1.0	31.0	\$2,307.91
0709-211-2513-4 TR-C2	DEAN, WILLIAM H HEATHER VON OESER-DEAN 2706 VAN HISE AVE MADISON WI	2706 Van Hise Ave	60.00 L.F.	75.0	75.0	100.0	1.0	17.0	1.0	1.0	31.0	\$2,272.91
0709-211-2514-5 TR-C2	SPRINGER, CATHERINE M 2710 VAN HISE AVE MADISON WI	2710 Van Hise Ave	50.00 L.F.	83.0	83.0	100.0	1.0	27.0	1.0	1.0	31.0	\$2,964.41
0709-211-2513-6 TR-C2	FRIEDSAM, DONNA A & TIMOTHY J ASTFAK 2711 VAN HISE AVE MADISON WI	2711 Van Hise Ave	50.00 L.F.	71.0	71.0	100.0	1.0	16.0	1.0	1.0	33.0	\$2,275.13

Parcel Number	Owner's Name/Mailing Address	Site Address	Frontage	Street Reconstruction Items				Sanitary Sewer Items				TOTAL ASSUMT						
				Remove Concrete Drive Apron @ \$1.50 per SF	Replace Concrete Drive Apron @ \$4.00 per SF	Remove & Replace Sidewalk @ \$4.50 per Square Foot (SF)	Factor	Remove & Replace Curb & Gutter @ \$18.00 per Linear Foot (LF)	Factor	Sanitary Sewer Reconnection \$450.00 Each	Each		Rem. & Repl. Sanitary Lateral @ \$271.11 per LF	LF				
0709-212-2140-7 TR-C2	LOCKER, REXX JULI LOCKER 2714 VAN HISE AVE MADISON WI	2714 Van Hise Ave	60.00 L.F.	63.0	\$94.50	63.0	\$352.00	1.0	100.0	\$450.00	1.0	36.0	\$648.00	1.0	\$450.00	31.0	\$854.41	\$2,548.91
0709-212-2132-4 TR-C2	CUMMINS, SHANNON M CLAY STEVENS 2715 VAN HISE AVE MADISON WI	2715 Van Hise Ave	60.00 L.F.	0.0	\$0.00	0.0	\$0.00	1.0	100.0	\$450.00	1.0	20.0	\$360.00	1.0	\$450.00	32.0	\$875.52	\$1,935.52
0709-212-2139-0 TR-C2	PFOND, JEFFERY A & CHRISTINE E PFOND 2718 VAN HISE AVE MADISON WI	2718 Van Hise Ave	60.00 L.F.	49.0	\$73.50	49.0	\$196.00	1.0	100.0	\$450.00	1.0	20.0	\$360.00	1.0	\$450.00	34.0	\$717.74	\$2,247.24
0709-212-2133-2 TR-C2	HERTZ LYDNE TRUST 2719 VAN HISE AVE MADISON WI	2719 Van Hise Ave	60.00 L.F.	90.0	\$135.00	90.0	\$360.00	1.0	100.0	\$450.00	1.0	49.0	\$882.00	1.0	\$450.00	32.0	\$675.52	\$2,292.52
0709-212-2138-2 TR-C2	SMALLE, WILLIAMS & KRIST A GELLEN 2722 VAN HISE AVE MADISON WI	2722 Van Hise Ave	47.60 L.F.	50.0	\$75.00	50.0	\$200.00	1.0	100.0	\$450.00	1.0	47.6	\$856.80	1.0	\$450.00	41.0	\$865.51	\$2,897.31
0709-212-2134-0 TR-C2	LIBBERTHAL, TRUST, MILPERD 2723 VAN HISE AVE MADISON WI	2723 Van Hise Ave	50.00 L.F.	135.0	\$202.50	135.0	\$540.00	1.0	100.0	\$450.00	1.0	50.0	\$900.00	1.0	\$450.00	41.0	\$865.51	\$3,408.01
0709-212-2137-4 TR-C2	HARRIS, EDWARD S & JUDIAN H SMITH 2726 VAN HISE AVE MADISON WI	2726 Van Hise Ave	30.00 L.F.	100.0	\$150.00	100.0	\$400.00	1.0	100.0	\$450.00	1.0	30.0	\$540.00	1.0	\$450.00	14.0	\$295.54	\$2,285.54
0709-212-2135-8 TR-C2	TOPPEL, SCOTTE & NORREN R OCONNOR-TOPEL 2727 VAN HISE AVE MADISON WI	2727 Van Hise Ave	30.00 L.F.	120.0	\$180.00	120.0	\$480.00	1.0	100.0	\$450.00	1.0	30.0	\$540.00	1.0	\$450.00	14.0	\$295.54	\$2,395.54
				11862.0	\$17,793.00	13028.0	\$52,112.00	13286.0	\$51,360.75	6080.6	\$91,405.80	110.0	\$49,500.00	3721.0	\$78,550.31		\$340,721.86	