

CITY OF MADISON

# MONONA TERRACE

COMMUNITY & CONVENTION CENTER

## Carpet Replacement Project

**ISTHMUS**  
ARCHITECTURE, INC.

613 Williamson Street  
Suite 203  
Madison, WI 53703  
Phone: 608.294.0206  
Fax: 608.294.0207

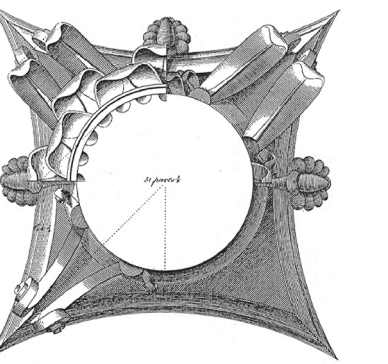

This work was prepared by me or under my supervision and construction of this project will be under my supervision. Supervision of construction is defined in Section 1420 of the State Statutes of the Board of Professional Engineers, Architects and Surveyors of the State of Wisconsin.

The Contractor shall verify all dimensions of the job site and confirm with the Architect before proceeding with the work.

© 2013 Isthmus Architecture, Inc.

**MONONA TERRACE  
CARPET REPLACEMENT PROJECT**  
Monona Terrace Community & Convention Center  
One John Nolen Drive, Madison, WI 53703

Proj. No.: 1301.01  
Scale: 1/16" = 1'-0"  
Drawn By: pr  
Date: 06-07-13  
Rebid Date:  
Rev. Date:

**TITLE SHEET**

Sheet Title

Sheet No:

**T1**

CUSTOM CARPET PATTERN

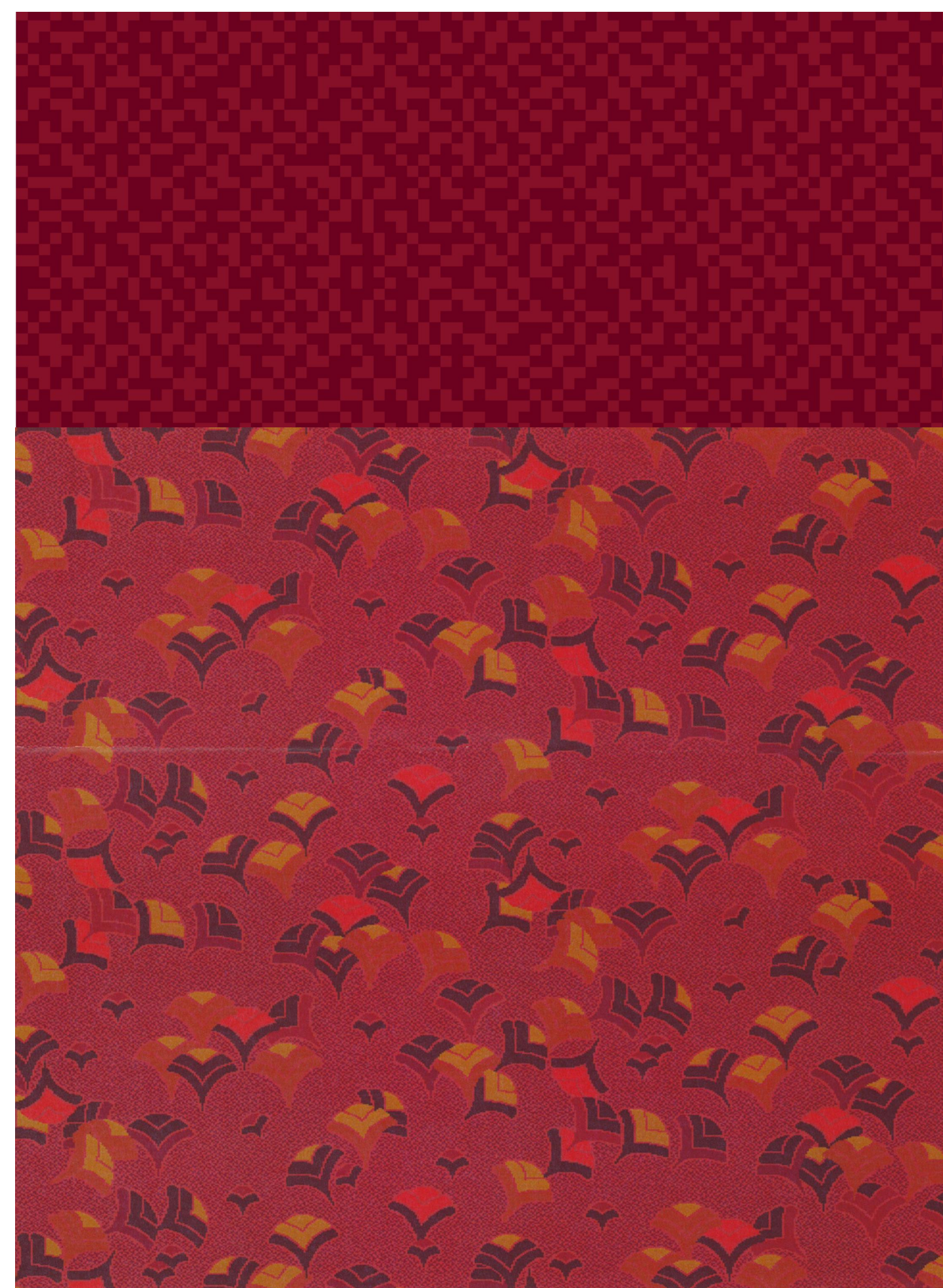

BORDER  
FIELD

1	2	3	4	5	6	7
5.017%	2.368%	2.263%	6.425%	39.378%	29.684%	14.866%

SHEET INDEX

- T1 TITLESHEET
- C1 FLOORS 1& 2 - CARPET PLANS
- C2 FLOORS 3,4,5 - CARPET PLANS & TERMINATION DETAILS

LOCATION MAP

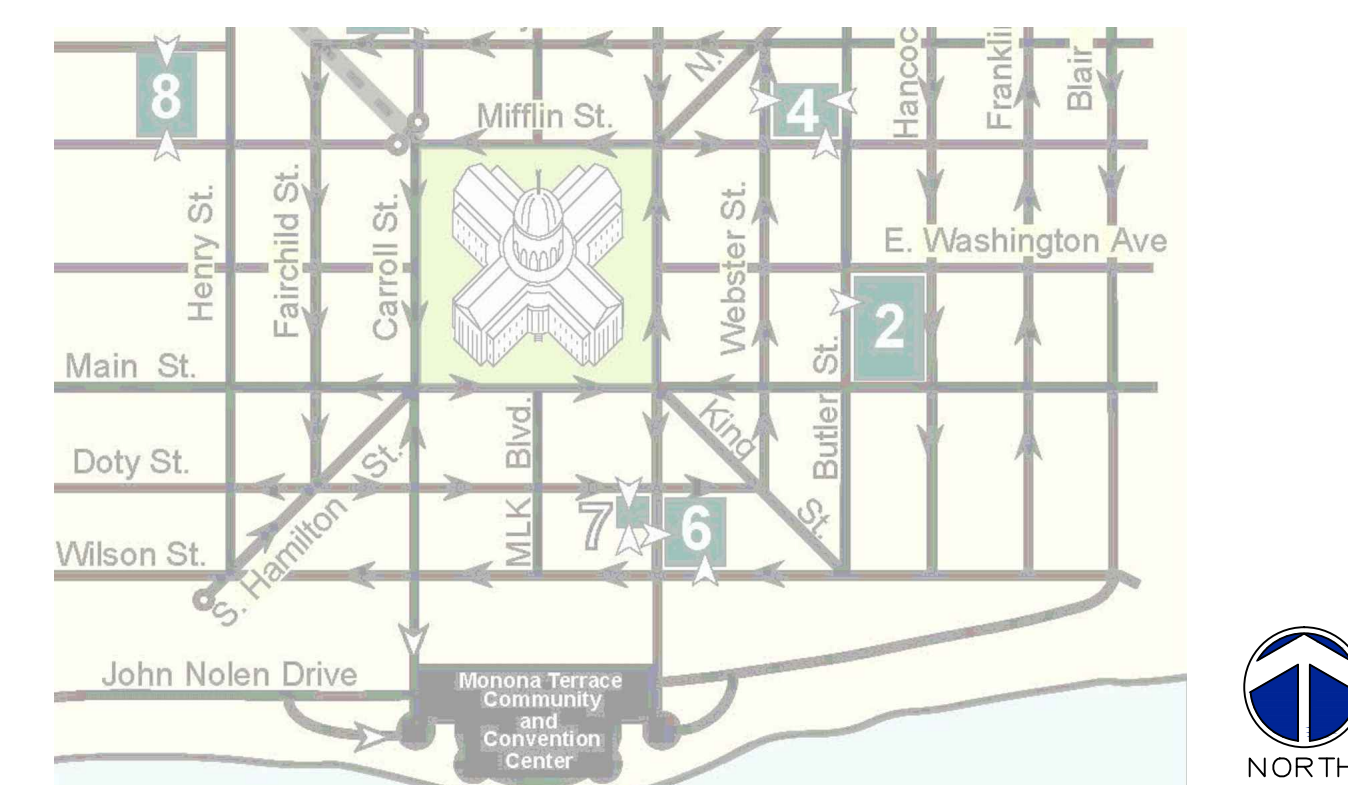

LOCATION MAP

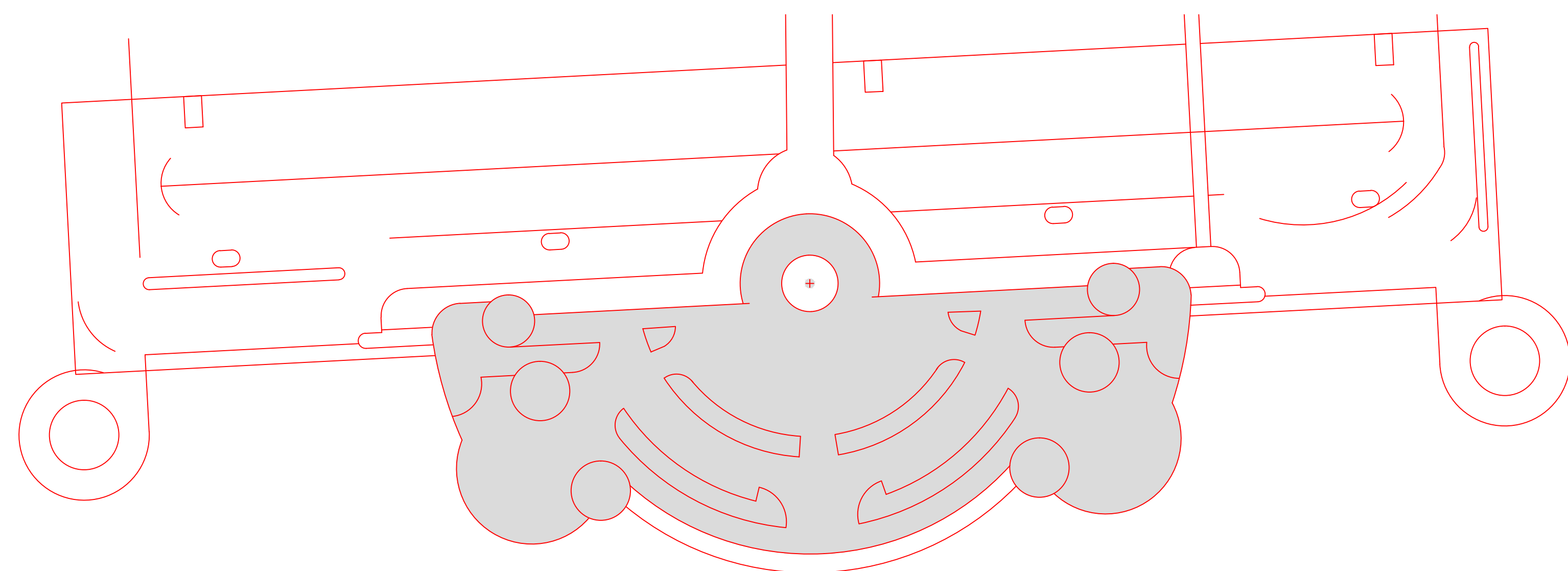



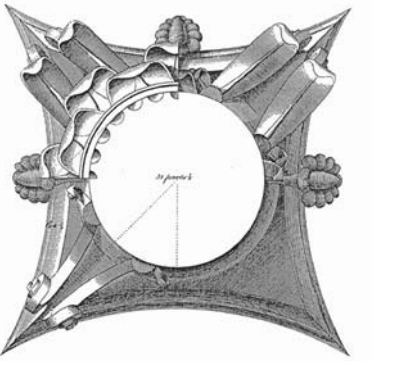

This work was prepared by me or under my supervision and certification as the Supervisor of construction as defined in Section 1.2(3) of the Rules & Regulations of the Board of Professional Engineers, Architects and Surveyors of the State of Wisconsin.  
The Contractor shall verify all dimensions at the job site and confirm with the Architect before proceeding with the work.

© 2013 Isthmus Architecture, Inc.

**MONONA TERRACE  
CARPET REPLACEMENT PROJECT**  
Monona Terrace Community & Convention Center  
One John Nolen Drive, Madison, WI 53703

Proj. No.: 1301.01  
Scale: 1/16" = 1'-0"  
Drawn By: pr  
Date: 06-07-13  
Rebid Date:  
Rev. Date:

**CARPET PLANS**

Sheet Title

Sheet No:

**C 1**

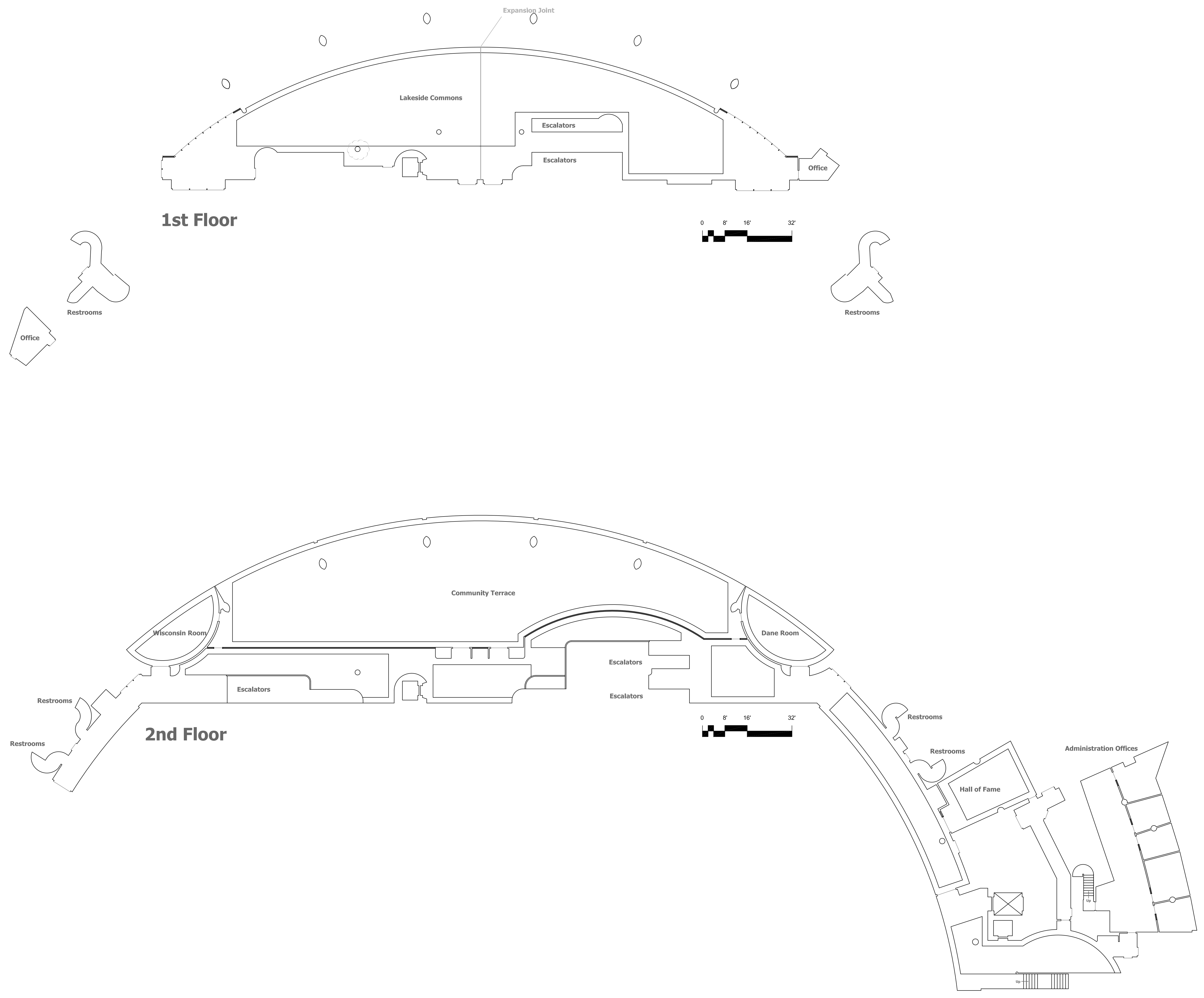

**1st Floor**

**2nd Floor**

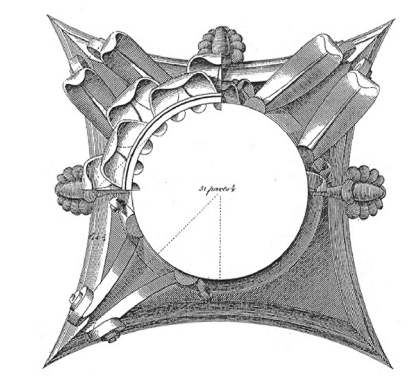

This work was prepared by me or under my supervision and, in preparation, supervision or construction is defined in Section 1.203 of the Rules & Regulations of the Board of Professional Engineers, Architects and Surveyors of the State of Wisconsin.

The Contractor shall verify all dimensions of the job site and confirm with the Architect before proceeding with the work.

© 2013 Isthmus Architecture, Inc.

**MONONA TERRACE  
CARPET REPLACEMENT PROJECT**

Monona Terrace Community & Convention Center  
One John Nolen Drive, Madison, WI 53703

Proj. No.:	1301.01
Scale:	1/16" = 1'-0"
Drawn By:	pr
Date:	06-07-13
Rebid Date:	
Rev. Date:	

**CARPET PLANS**

Sheet Title  
Sheet No:

**C 2**

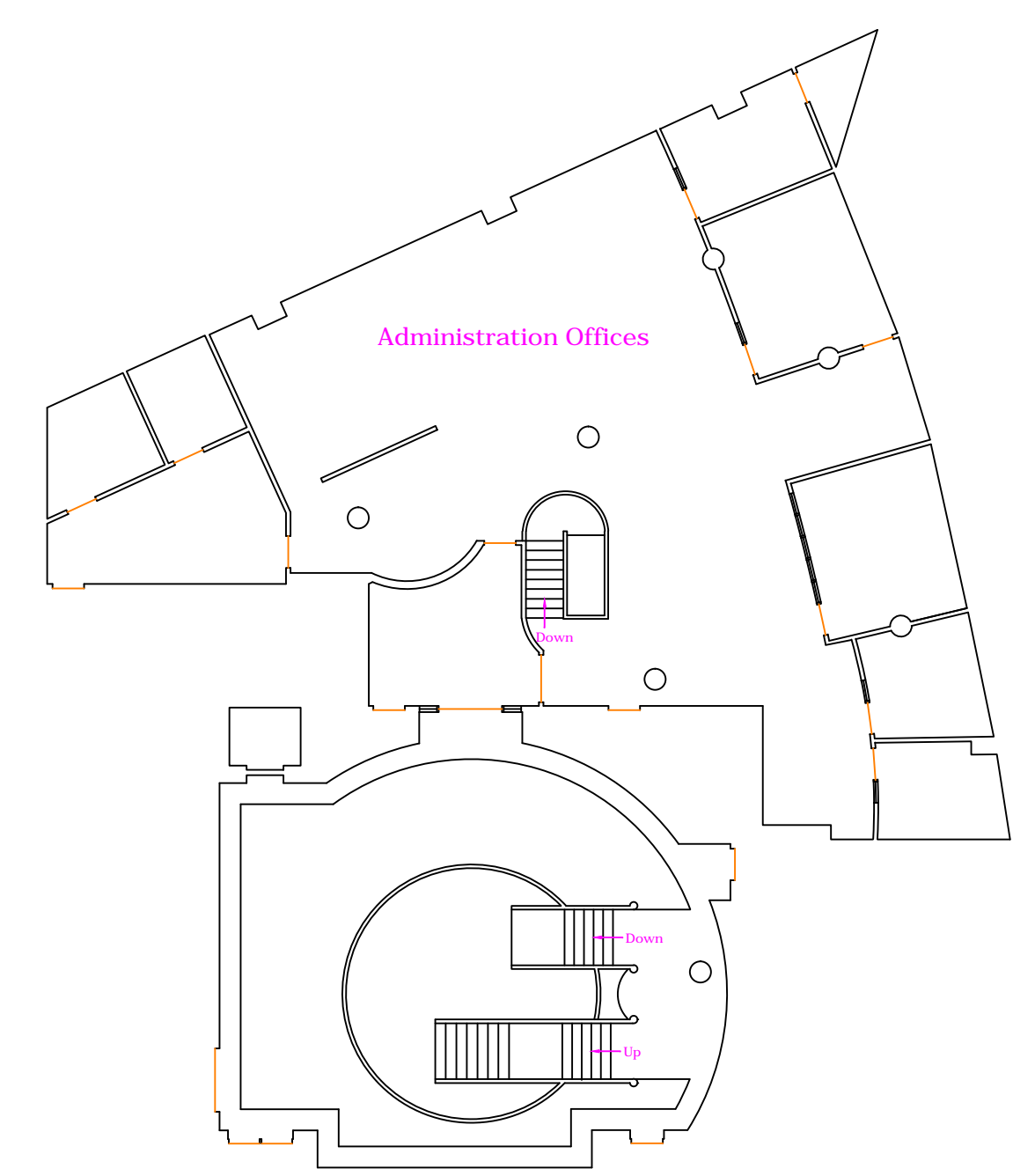
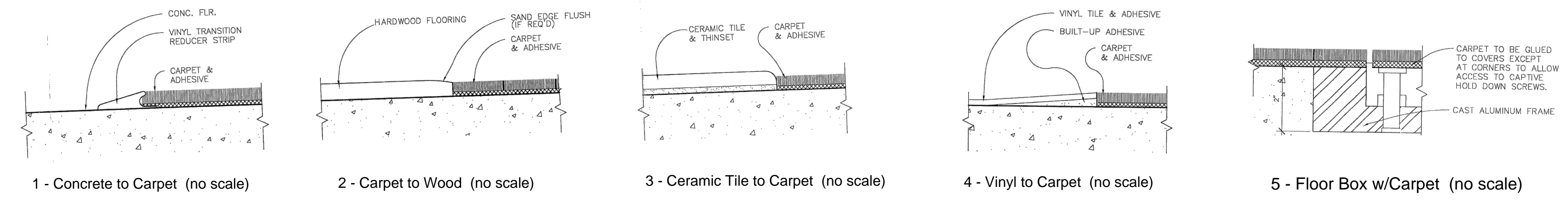

3rd Floor

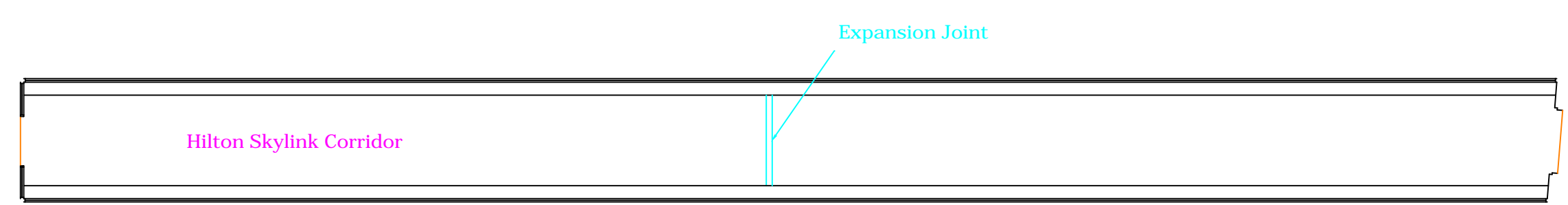

5th Floor

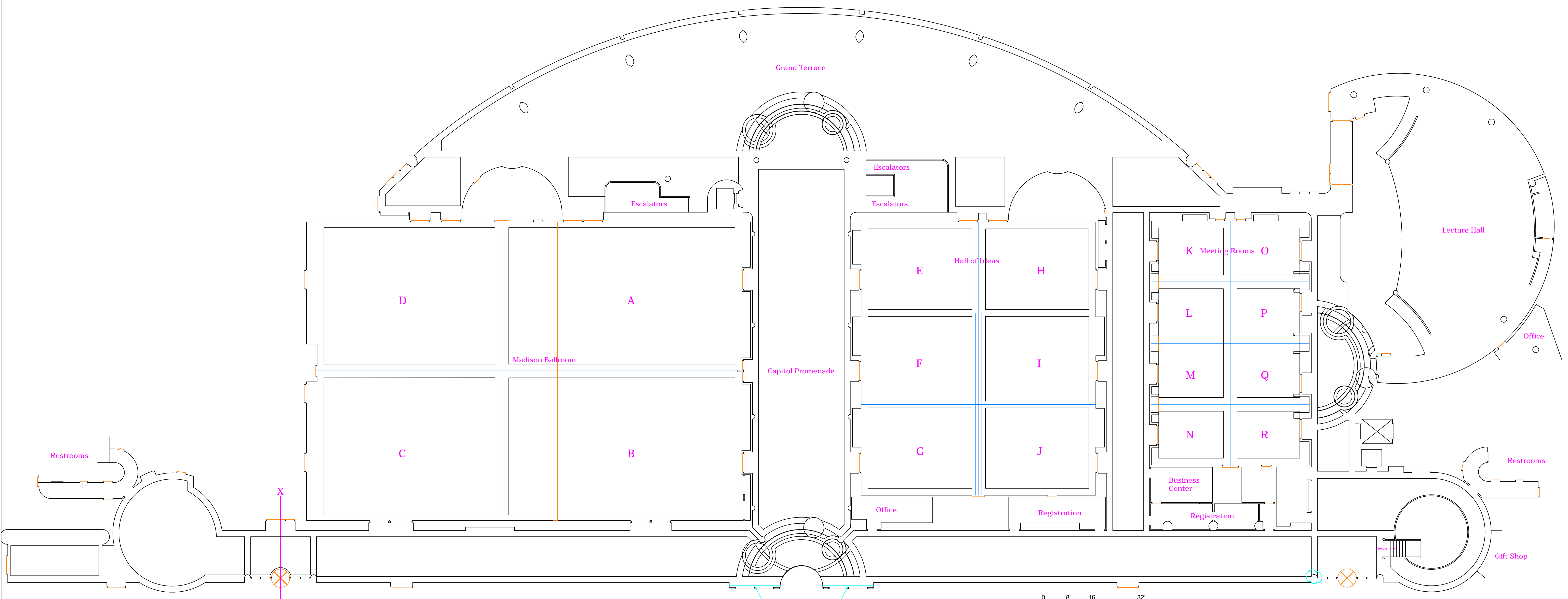

4th Floor

4th Floor

