

SIGN SPECIFICATIONS

[A] - CABINET

Lighting: Non-Lit
 Material: Aluminum
 Face Color: Paint White
 Cabinet Color: Paint White
 Installation: New Structure

[B] - BLUE CABINET

Lighting: Non-Lit
 Material: Aluminum
 Face Color: Paint To Match
 PMS Blue 2995c
 Cabinet Color: Paint To Match
 PMS Blue 2995c

[C] - COPY/ARROWS

Material: FCO Aluminum 1/8" Thick
 Color: Paint Black
 Installation: Stud Mount Flush

[D] - SMILE

Material: FCO Aluminum 1/8" Thick
 Color: Paint to Match PMS Blue 2995c
 Installation: Stud Mount Flush

[E] - BASE

Material: Concrete

[F] - DECOR

Material: Channel Rail Aluminum
 Depth: 1/4"
 Color: Paint DORIAN GRAY SW7017

[G] - SIDE DECOR

Material: Aluminum
 Color: Black

Proposed to UDC 11-4-20



This document is owned by and the information contained herein is proprietary to Poblocki Sign Company, LLC. By receipt hereof, the holder agrees not to use the information, disclose it to any third party or reproduce this document without the prior written consent of Poblocki Sign Company, LLC. Holder also agrees to immediately return this document upon request by Poblocki Sign Company, LLC. This document represents only an approximation of material colors specified. Actual product colors may vary from this print or digital image.

Project
Amazon
 Madison, WI

Scale: 3/4"=1'
 Original Page Size: 11" x 17"

Notes
 COPY/ARROW BOTH SIDES

Revisions		
REV	DESCRIPTION	BY DATE
01	non-Rt	RJE 7/2/20
02	specs	jeb 08/06/20

Rep.: Jim Pacioni
 Drawn By: Jean Hardeman Orig. Date: 6/29/20

Sign Loc. No. .
MON-02
 D/F Monument
 Sign. Type
89064 **JO1**
 OPP - Project - Job No. Design

SIGN SPECIFICATIONS

[A] - CABINET
 Lighting: Non-Lit
 Material: Aluminum
 Face Color: Paint White
 Cabinet Color: Paint White
 Installation: New Structure

[B] - BLUE CABINET
 Lighting: Non-Lit
 Material: Aluminum
 Face Color: Paint To Match
 PMS Blue 2995c
 Cabinet Color: Paint To Match
 PMS Blue 2995c

[C] - COPY/ ARROWS
 Material: FCO Aluminum 1/8" Thick
 Color: Paint Black
 Installation: Stud Mount Flush

[D] - SMILE
 Material: FCO Aluminum 1/8" Thick
 Color: Paint to Match PMS Blue 2995c
 Installation: Stud Mount Flush

[E] - BASE
 Material: Concrete

[F] - DECOR
 Material: Channel Rail Aluminum
 Depth: 1/4"
 Color: Paint DORIAN GRAY SW7017

[G] - SIDE DECOR
 Material: Aluminum
 Color: Black

Proposed to UDC 11-4-20



Proposed Layout Side B



Proposed Layout Side A

Side View



This document is owned by and the information contained in it is proprietary to Poblocki Sign Company, LLC. By receipt hereof, the holder agrees not to use the information, disclose it to any third party or reproduce this document without the prior written consent of Poblocki Sign Company, LLC. Holder also agrees to immediately return this document upon request by Poblocki Sign Company, LLC.
 This document represents only an approximation of material colors specified. Actual product colors may vary from this print or digital image.

Project
Amazon
 Madison, WI

Scale: 3/4"=1'
 Original Page Size: 11" x 17"

Notes
 COPY/ ARROW BOTH SIDES

Revisions

REV	DESCRIPTION	BY	DATE

Rep.: Jim Pecioni
 Drawn By: Sarah Biaglioni Orig. Date: 09/08/20

Sign Loc. No. .

MON-03
 D/F Monument
 Sign Type

89064 **CO1**
 OPP - Project - Job No. Design

SIGN SPECIFICATIONS

[A] - CABINET

Lighting: Non-Lit
 Material: Aluminum
 Face Color: Paint White
 Cabinet Color: Paint White
 Installation: New Structure

[B] - BLUE CABINET

Lighting: Non-Lit
 Material: Aluminum
 Face Color: Paint To Match
 PMS Blue 2995c
 Cabinet Color: Paint To Match
 PMS Blue 2995c

[C] - COPY/ ARROWS

Material: FCO Aluminum 1/8" Thick
 Color: Paint Black
 Installation: Stud Mount Flush

[D] - SMILE

Material: FCO Aluminum 1/8" Thick
 Color: Paint to Match PMS Blue 2995c
 Installation: Stud Mount Flush

[E] - BASE

Material: Concrete

[F] - DECOR

Material: Channel Rail Aluminum
 Depth: 1/4"
 Color: Paint DORIAN GRAY SW7017

[G] - SIDE DECOR

Material: Aluminum
 Color: Black

Proposed to UDC 11-4-20



Proposed Layout Side B



Proposed Layout Side A

Side View



322 S. 70th St., Milwaukee, WI 53214
 414.453.4010 • www.poblocki.com

This document is owned by and the information contained in it is proprietary to Poblocki Sign Company, LLC. By receipt hereof, the holder agrees not to use the information, disclose it to any third party or reproduce this document without the prior written consent of Poblocki Sign Company, LLC. Holder also agrees to immediately return this document upon request by Poblocki Sign Company, LLC.
 This document represents only an approximation of material colors specified. Actual product colors may vary from this print or digital image.

Project

Amazon
 Madison, WI

Scale: 3/4"=1'

Original Page Size: 11" x 17"

Notes

COPY/ ARROW BOTH SIDES

Revisions

REV	DESCRIPTION	BY	DATE

Rep.: Jim Pacioni
 Drawn By: Sarah Blagioni Orig. Date: 09/08/20

Sign Loc. No. .

MON-04

D/F Monument
 Sign. Type

89064

OPP - Project - Job No.

CO1

Design

EXISTING SITE INFORMATION AND CONTOURS
 OBTAINED FROM THE FOLLOWING:
 1) ALTA SURVEY DATED 8/19/2018 PREPARED BY KL ENGINEERING
 2) ALTA SURVEY DATED 9/20/2008 PREPARED BY AVRES ASSOCIATES
 3) SUPPLEMENTAL TOPOGRAPHIC COLLECTION ON 8/19/2018 PROVIDED BY QUAM ENGINEERING

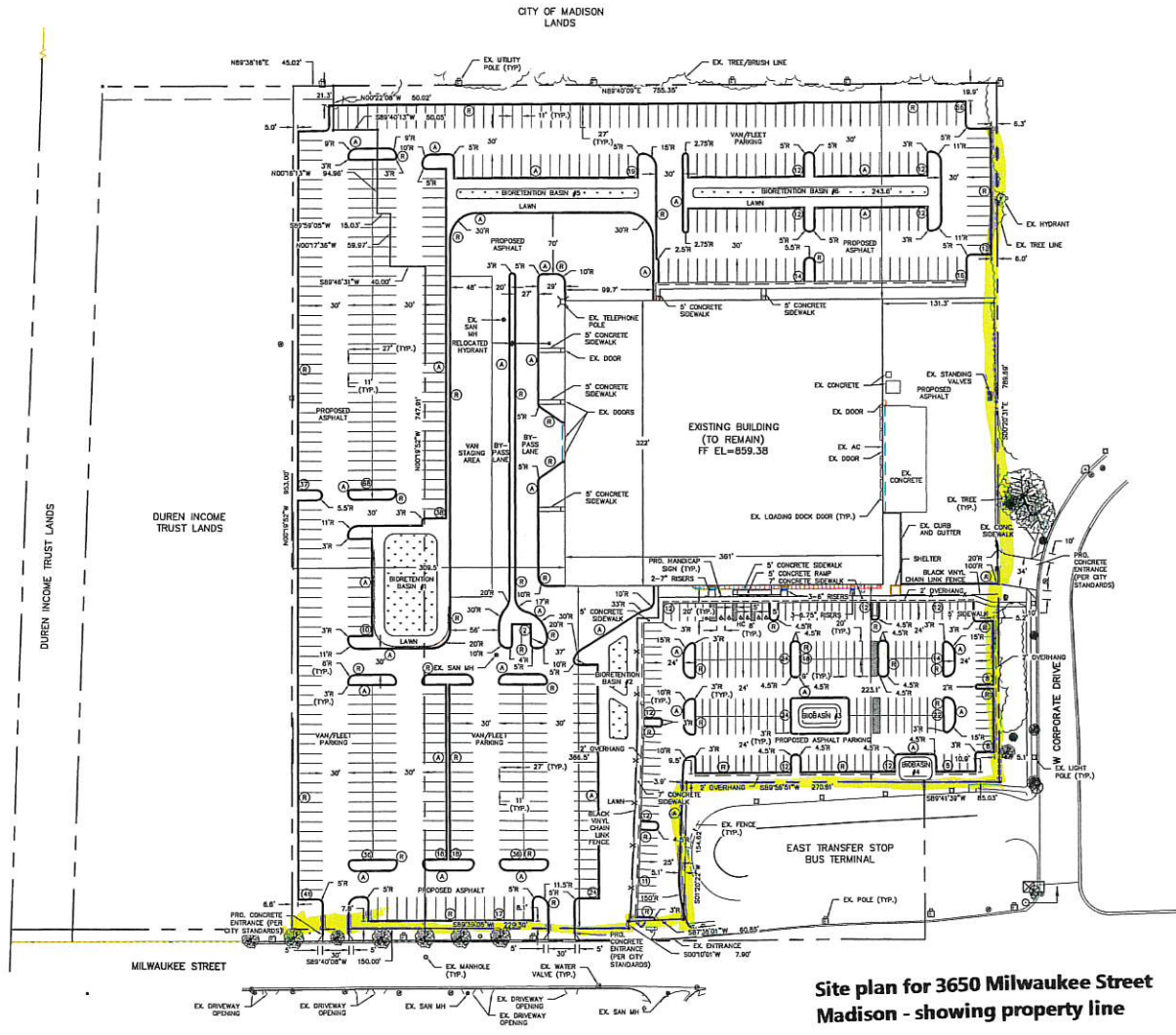

PARKING LOT PLAN SITE INFORMATION BLOCK

Site Address: 3650 MILWAUKEE STREET
 Site acreage (TYP): 16.53 Acres

Number of building stories (above grade): 1
 Building height: 30'
 DPSF type of construction (new structures or additions): 3/A
 Total square footage of building: 118,230 SF
 Total square footage of garage: N/A

Use of property: OFFICE AND STORAGE BUILDING
 General use of site: OFFICE
 Reference area: 16,530 SF
 Open space area: 11,870 SF
 LOT COVERAGE: 8.11%

Number of single drive stalls: 0
 Number of parking stalls:

Van/Mini Parking	3000
Employee Parking	211
Handicap	1
Total	3212

Number of trees shown (See Landscape Plan)

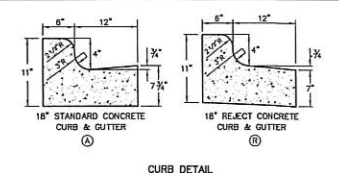
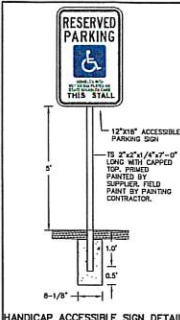

3650 MILWAUKEE STREET, CITY OF MADISON
 PRELIMINARY PROPOSED SITE PLAN
 PAGE: 2 OF 6
 DATED: OCTOBER 22, 2019

QUAM ENGINEERING, LLC
 Residential and Commercial Site Design Consultants
 www.quamengineering.com
 4604 Siggeikow Road, Suite A - McFarland, Wisconsin 53558
 Phone (608) 838-7750; Fax (608) 838-7752

**Site plan for 3650 Milwaukee Street
 Madison - showing property line**



DATE	BY	REVISION

AMAZON DELIVERY STATION - DW14
 3650 MILWAUKEE STREET
 MADISON, WI 53714

Project	752286-01
Site	AS 102103
City	CHI
County	SCU
Date	07.22.19

STRIPING AND SIGNAGE SITE PLAN
 A1.4B

Sign Face Legend

SYMBOL	SIGN TYPE
S-1	Stop Sign
S-2	Do Not Enter
S-3	Speed Limit, 5 MPH
S-3(mod)	Speed Bump Sign w/ 5 MPH Placard
S-4	Speed Limit, 10 MPH
S-4(mod)	Speed Bump Sign w/ 10 MPH Placard
S-5(L)	Pedestrian Crossing, Left Arrow (S-5(R) OPP.)
S-7(L)	One Way, Left Arrow (S-7(R) OPP.)
S-9(L)	Left Turn Only (S-9(R) OPP.)
S-11(L)	No Left Turn (S-11(R) OPP.)
S-12	No U Turn
S-13	Trucks Prohibited
S-14	No Parking
S-15	ADA Accessible Car Parking
S-16	ADA Accessible Van Parking
S-17	No Trespassing

Tenant Sign Face Legend

SYMBOL	SIGN TYPE
AS-1	Address Sign
AS-2	Trucks/Visitor Driver
AS-5	Yard Rules
AS-6	Track Entrance
AS-7	Driver's Lounge
AS-8	Receiving Driver Entrance
AS-9	Shipping Driver Entrance
AS-10	Tractor Parking
AS-12	Trailer 3FT From Wall
AS-13	No Entrance
AS-14	No Exit
AS-15	Exit
AS-16	Wayfinding
AS-17(L)	Group/Drop-Pick-Up Area, Left Arrow (AS-17(R) OPP.) (S-7(S) Straight Arrow)
AS-20	Dock Numbers
AS-22	Group-Off and Pick-Up
AS-23	Associate of the Month
AS-24	Visitor Parking
AS-25	Vendor Parking
AS-26	Master Area
AS-29	Motorcycle Parking
AS-30	Non-Smoking Area
AS-31	Customer Parking
AS-C1	Parking Location (AS-C1, AS-B1, AS-B1, AS-B1, AS-B1, AS-B1)

Pavement Graphic Legend

SYMBOL	GRAPHIC TYPE
PG-1	Stop Bar
PG-5	Straight Arrow
PG-6(L)	Left Turn Arrow (PG-6(R) OPP.)
PG-7(R)	Straight or Right Turn Arrows (PG-7(L) OPP.)
PG-8	Left or Right Turn Arrow
PG-9	Left, Straight, or Right Turn Arrows
PG-10	18" Stripping Outline and Fill at 45 Degrees
PG-11	12" Stripping Outline and Hatch @ 90° O.C. (White)
PG-12	12" Stripping Outline and Hatch @ 30° O.C. (Yellow)
PG-14	Trailer Space Numbering
PG-15	Speed Bump
PG-16	Speed Bump
PG-17	ADA Accessible Car Parking
PG-18	ADA Accessible Van Parking
PG-20	Pedestrian Table
PG-21	Empty Trailer Slip
PG-22	Tractor Dock Parking
PG-23	Jack Stand Area
PG-24	Warning Line

SIGNAGE NOTES:

- REFER TO SIGNAGE AND STRIPING PLAN FOR LOCATIONS OF SIGNS AND PAVEMENT MARKINGS.
- ALL SIGNAGE, STRIPING, AND OTHER TRAFFIC CONTROL DEVICES SHALL BE INSTALLED IN CONFORMANCE WITH THE LATEST EDITION OF THE MANUAL ON UNIFORM TRAFFIC CONTROL DEVICES (MUTCD).
- ALL STRIPING SHALL BE LONG LIFE EPOXY RESIN AND 4" WIDE UNLESS OTHERWISE NOTED. ALL PAVEMENT GRAPHICS SHALL BE HOT-APPLIED THERMOPLASTIC (REFLECTIVE).
- COLOR SHALL BE WHITE ON ASPHALT AND YELLOW ON CONCRETE, UNLESS OTHERWISE NOTED.
- ASPHALT SPEED HUMPS AND SPEED BUMPS SHALL BE USED IN COLDER CLIMATES WHERE SNOW REMOVAL EQUIPMENT IS INTENDED TO BE USED. RUBBER SPEED HUMPS AND SPEED BUMPS MAY BE USED IN WARMER CLIMATES OR REGIONS WHERE CONCRETE PAVEMENT IS PREVALENT.
- ALL PROPOSED SIGNAGE AND STRIPING SHALL BE INSTALLED IN ACCORDANCE WITH THE TENANT DEFACEMENT WORLDWIDE REAL ESTATE SIGNAGE STANDARDS REVISION 10 DATED QUARTER 2, 2019.
- FINAL QUANTITIES SHALL BE COORDINATED AND VERIFIED IN FIELD.
- ADDITIONAL SIGNAGE NOT SHOWN ON GRAPHICS PLAN (E.G. FIRE LANES) MAY BE REQUIRED PER LOCAL CODE AND/OR A.H.J. SUB-CONTRACTOR SHALL COORDINATE WITH LOCAL A.H.J. AND PROVIDE AS REQUIRED.
- MOUNT SIGNAGE ACCORDING TO LOCAL CODES.
- TYPICAL SIGN FONT IS SET IN AERIAL.

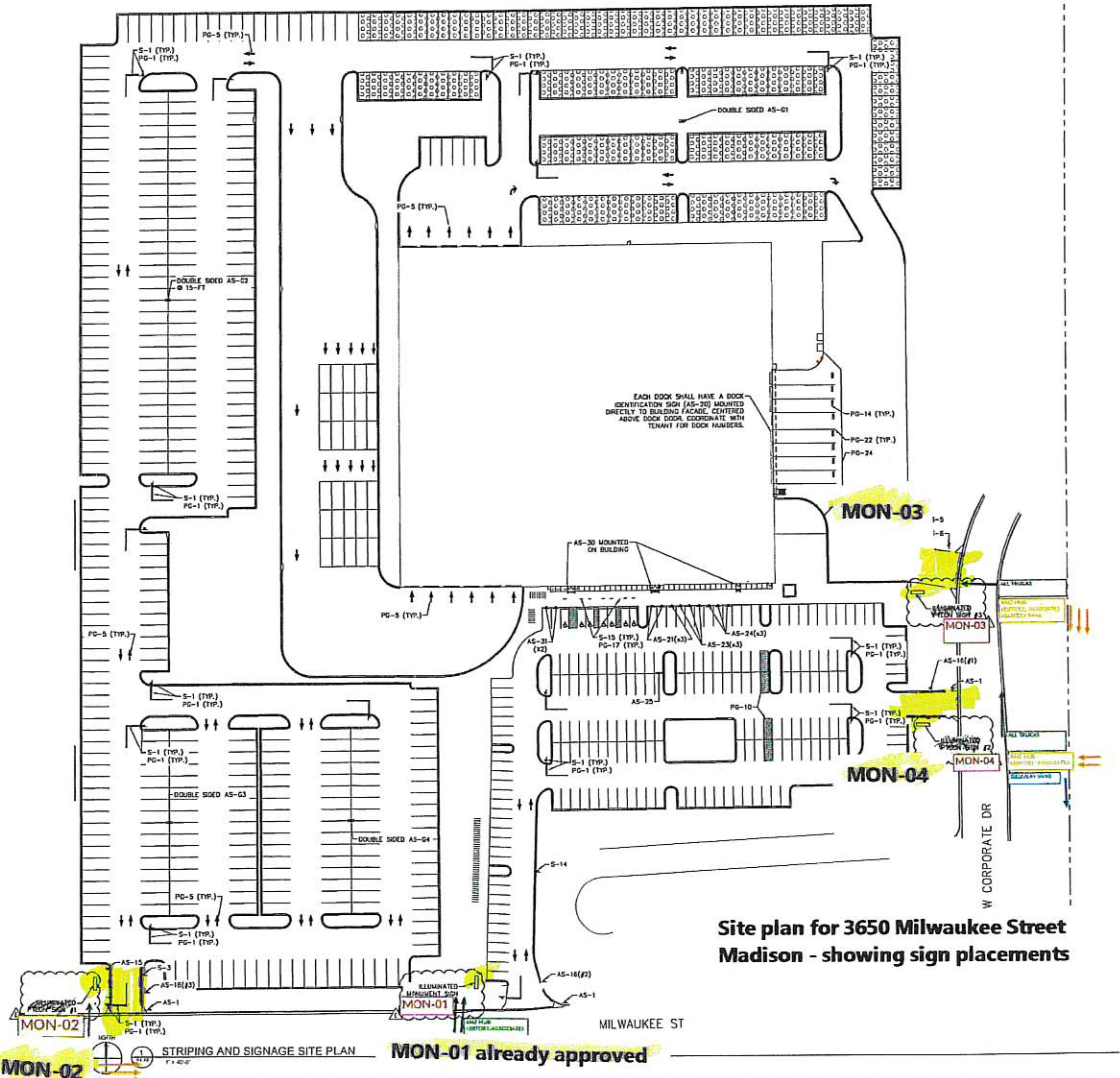

**Site plan for 3650 Milwaukee Street
 Madison - showing sign placements**

STRIPING AND SIGNAGE SITE PLAN
MON-01 already approved



amazon Delivery

Amazon Hub ←
Visitors / Associates ←
All Trucks ↑

MON-01 Installed

LL-02 Installed

amazon hub

S003



S002



amazon
HUB
ENTRANCE



LL-01 Installed

amazon
delivery

S014

S013

S012

RISER ROOM

VISITOR
PARKING

VISITOR
PARKING

