



\* 4 4 1 6 7 2 3 7 \*

DANE COUNTY

REGISTER OF DEEDS

DOCUMENT #

4416723

04/07/2008

02:13PM

Exempt #:

Rec. Fee: 23.00

Pages: 7

Recording Area

Name and Return Address

City Clerk  
210 Martin Luther King Jr. Blvd.  
Room 103  
Madison, WI 53703

Document Number

Document Title

**ATTACHMENT ORDINANCE**

This is to certify that the foregoing ordinance was adopted by the Common Council of the City of Madison, Wisconsin at a meeting held on the 26th day of February, 2008.

McAllen Attachment  
Ordinance #: ORD-08-00029  
ID#: 08889

Parcel Identification Number (PIN)

April 1, 2008  
Date

*Maribeth Witzel-Behl*  
Signature of Clerk

Maribeth Witzel-Behl, City Clerk  
\*Name printed

Date

n/a  
Signature of Grantor

\*Name printed

STATE OF WISCONSIN, County of Dane

This document was drafted by:  
(print or type name below)

Tammy Peters

Subscribed and sworn to before me on April 1, 2008 by the above named person(s)

Signature of notary or other person authorized to administer an oath (as per s 706 06 706 07)

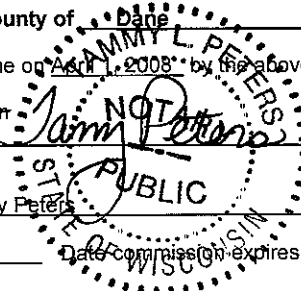

Print or type name: Tammy Peters

Title: Program Assistant 2 Date commission expires: 6-7-09

\*Names of persons signing in any capacity must be typed or printed below their signature

This information must be completed by submitter: document title, name & return address, and PIN (if required) Other information such as the granting clauses, legal description, etc., may be placed on this first page of the document or may be placed on additional pages of the document Note: Use of this cover page adds one page to your document and \$2 00 to the recording fee Wisconsin Statutes, 59 43(2m) USE BLACK INK. WRDA 5/1999

7/23



## Office of the City Clerk

---

210 Martin Luther King, Jr. Boulevard  
Madison, Wisconsin 53703-3342  
PH 608 266 4601  
FAX 608 266 4666  
TTY/Textnet 866 704 2340  
[www.cityofmadison.com/clerk](http://www.cityofmadison.com/clerk)

March 31, 2008

Annexations and Railroads  
Division of Government Records  
Office of the Secretary of State  
P. O. Box 7848  
Madison, WI 53707-7848

Dear Mr. LaFollette:

ENACTMENT NO. ORD-08-00029  
ID NO. 08889  
McAllen Attachment

I, Maribeth Witzel-Behl, City Clerk of the City of Madison, County of Dane, State of Wisconsin, pursuant to the City of Madison and Town of Blooming Grove Cooperative Plan, DO HEREBY CERTIFY adoption of attachment Enactment No. ORD-08-00029, ID No 08889 on February 26, 2008; thereby attaching territory from the Town of Blooming Grove and attaching same to the City of Madison.

A certified copy of Enactment No. ORD-08-00029, which contains an accurate metes and bounds description of the territory so affected is attached and the population identified in the attached territory is zero (0).

Sincerely,

Maribeth Witzel-Behl  
City Clerk  
MWB:tlp

cc:

Dane County Register of Deeds  
Clerk, Town of **Blooming Grove**  
**AT&T**  
**Mc Farland Schools**  
**MG&E (gas)**  
**Alliant Energy (electric)**  
Tim Parks, Planning & Development Unit (email)  
Al Schumacher, City Streets Department – West (email)  
City Assessor, Maureen Richards (email)  
Eric Pederson, City Engineering (4) (email)  
John Leach, Traffic Engineering (email)  
Gregg Knudtson, Fire Department  
Brad Murphy, Planning Unit (email)  
Dane County Clerk  
Dane County Community Analysis and Planning Division  
Dane County Planning & Development  
Dane County Tax Lister, Cheryl Zellmer (email)  
Dane County Public Safety Communications  
Dane County EMS  
Madison Area Metropolitan Planning Organization  
Madison Metropolitan Sewer District  
Charter Communications  
Sharon Milleville (email)  
City Clerk file (scan & attach)



# City of Madison

City of Madison  
Madison, WI 53703  
www.cityofmadison.com

## Certified Copy

Ordinance: ORD-08-00029

**File Number: 08889**

**Enactment Number: ORD-08-00029**

Creating Section 15.01(568) of the Madison General Ordinances entitled "City Boundaries" and being part of the chapter entitled "Aldermanic Districts and Wards" attaching to the Sixteenth Aldermanic District the McAllen Attachment and assigning a temporary zoning classification of A Agriculture District, and amending Section 15.02(2) of the Madison General Ordinances to add the attached property to Ward 2.

DRAFTER'S ANALYSIS: This ordinance attaches land in the Town of Blooming Grove.

\*\*\*\*\*

An ordinance to create Subsection (568) of Section 15.01 of the General Ordinances of the City of Madison entitled "City Boundaries" and being part of the chapter entitled "Aldermanic Districts and Wards".

WHEREAS, a petition for attachment with scale map attached was filed with the City Clerk of Madison on January 10, 2008, and has been presented to the Madison Common Council requesting attachment of the below-described territory to the City of Madison from the Town of Blooming Grove; said petition having been signed by the owners of all of the land in the territory and notice of the proposed attachment having been given to the Town of Blooming Grove; and

WHEREAS, pursuant to Wis. Stats. sec. 66.0217(14)(a)1., the City of Madison agrees to pay annually to the Town of Blooming Grove, for five (5) years, an amount equal to the amount of property taxes that the town levied on the annexed territory, as shown by the tax roll under Wis. Stats. sec. 70.65, in the year in which the annexation is final; and

WHEREAS, investigation by the City of Madison discloses that as of this date the above representations are true, the Common Council now accepts the petition as sufficient and determines that the said attachment proceeding meets the requirements of the City of Madison and Town of Blooming Grove Cooperative Plan approved pursuant to Section 66.0307, Wisconsin Statutes;

NOW, THEREFORE, the Common Council of the City of Madison do ordain as follows:

1. Subsection (568) of Section 15.01 of the Madison General Ordinances is hereby created to read as follows:

"15.01(568) - There is hereby attached to the 16th Aldermanic District, the City of Madison, Dane County, Wisconsin, the following described property:

A parcel of land located in the NE ¼ and SE ¼ of the SE ¼ of Section 23 and in the SW ¼ and NW ¼ of the SW ¼ of Section 24, T7N, R10E, Town of Blooming Grove, Dane County, Wisconsin, to-wit: Commencing at the east quarter corner of said Section 23, thence N88°38'10"E, 16.51 feet; thence S00°28'17"W, 500.30 feet to the point of beginning; thence continuing S00°28'17"W, 827.81 feet; thence N88°33'46"E, 1,312.90 feet; thence S00°26'16"W, 1,326.40 feet; thence S88°29'21"W, 1,330.24 feet; thence S87°31'20"W, 66.09 feet; thence S87°31'20"W, 1,266.12 feet; thence N00°28'21"E, 1,331.82 feet; thence N87°40'50"E, 150.89 feet; thence N00°26'41"E, 298.60 feet; thence S89°52'51"W, 150.58 feet; thence N00°28'21"E, 526.89 feet; thence N87°50'21"E, 1,348.33 feet to the point of beginning."

2. Subsection (2) of Section 15.02 entitled "Wards and Ward Boundaries" of the Madison General Ordinances is amended to read as follows:

Ward 2. Beginning at a point within the exterior limits line of the City of Madison, said point being the point of intersection of the East right-of-way line of Interstate Highway 90 and the South line of East Buckeye Road; thence Northerly along the Northerly prolongation of the East right-of-way line of Interstate Highway 90 to the centerline of East Buckeye Road; thence

y along the centerline of East Buckeye Road to the centerline of Droster Road; thence Northerly along the centerline of Droster Road to the centerline of Starker Avenue; thence Westerly along the centerline of Starker Avenue to the centerline of Acewood Boulevard; thence Northerly along the centerline of Acewood Boulevard to the centerline of Cottage Grove Road; thence Westerly along the centerline of Cottage Grove Road to the centerline of South Stoughton Road (U.S Highway 51); thence Southerly along the centerline of South Stoughton Road to the centerline of East Buckeye Road; thence Easterly along the centerline of East Buckeye Road to the centerline of the right-of-way of the Chicago & North Western Railroad; thence Southeasterly along the centerline of said right-of-way to the centerline of Vondron Road; thence Southerly and Westerly along the centerline of Vondron Road and the centerline of Pflaum Road to the centerline of Agriculture Drive; thence Southerly along the centerline of Agriculture Drive to the centerline of Femrite Drive; thence Easterly along the centerline of Femrite Drive, to the West line of Interstate Highway 90, (also the limits line of the City of Madison); thence Easterly, Northerly, Westerly, and Northerly along said limits line 4822 feet, more or less, to a point that is 524.00 feet West of the West line of the E ½ of the SE ¼ of Section 23, T7N, R10E, Dane County, Wisconsin, measured along the North line of the S ½ of the S ½ of said Section 23.; thence S03°17'00"W, 334.80 feet; thence N86°43'00"E, 274.58 feet; thence N06°14'41"E, 308.87 (342.07' per deed Doc #2926046) feet to the said North line; thence Easterly, along the said North line, 180 feet, more or less, to the centerline of Ohmeda Dr; thence Northerly, along the said centerline, 300 feet, more or less, to the Westerly prolongation of the North line of the deed described in Document # 3857701; thence Easterly, along said North line, 200 feet, more or less, to the Northeast corner thereof; thence S00°26'41"W, 298.60 feet to the Southeast corner thereof; thence S87°40'50"W, 150.89 feet, to the Southwest corner thereof, also being the Southwest corner of the NE ¼ of the SE ¼; thence S00°28'21"W, along the West line of the E ½ of the Southeast ¼, 1331.82 feet, to the South line of the SE ¼; thence N87°31'20"E, along the said South line, 1266.12 feet; thence continuing N87°31'20"E, along the said South line, 66.09 feet, to the SE corner of Section 23; thence N88°29'21"E, along the South line of the SW ¼, of Section 24, T7N, R10E, 1330.24 feet, to the SE corner of the SW ¼ of the SW ¼ of said Section 24 (also the exterior limits line of the City of Madison); thence N00°26'16"E, along the East line of the said SW ¼ of the SW ¼ and said limits line, 1326.40 feet, to the South line of the North ½ of the SW ¼ of said Section 24; thence East on the said South line and said limits line, 1339 feet, more or less, to the East line of the said SW ¼; thence North on the said East line and said limits line, 1,330 feet, more or less, to the North line of the said SW ¼; thence West on the said North line and said limits line, 740 feet, more or less; thence N01°26'00"W along the said limits line, 1,320 feet, more or less, to a point in the North line of the SE ¼ of the NW ¼ of said Section 24, that is S88°34'00"W, 745.40 feet from the Northeast corner of the said SE ¼ of the NW ¼; thence South 88°34'00"W, 417.72 feet along the said North line and said limits line; thence South 01°26'00"E along the said limits line, 521.77 feet; thence N88°34'00"E along the said limits line, 150.00 feet; thence S01°26'00"E along the said limits line, 798.23 feet, more or less, to the North line of the SW ¼ of said Section 24; thence West along the last mentioned North line, and the North line of the SE ¼ of said Section 23, also being said limits line, 2,980 feet, more or less, to the West line of the E ½ of the NE ¼ of said Section 23; thence North on the said West line and said limits line, 1,330 feet, more or less, to the South line of the NW ¼ of the NE ¼ of said Section 23; thence West on the said South line and said limits line, 660 feet, more or less, to the East line of the W ½ of the NW ¼ of the NE ¼ of said Section 23; thence North on the said East line and said limits line, 1,310 feet, more or less, to the South line of Section 14, T7N, R10E; thence East on the said South line and said limits line, 1,320 feet, more or less, to the West line of the E ½ of the E ½ of the E ½ of said Section 14; thence North on the said West line and said limits line, 1,750 feet, more or less, to the Northerly right-of-way line of the Chicago and Northwestern Transportation Company; thence Westerly along the said right-of-way line and said limits line,

t, more or less, to the East line of the NW ¼ of the SE ¼ of said Section 14; thence North along said East line and said limits line, 1,040 feet, more or less, to the North line of the S ½ of said Section 14; thence West along said North line and said limits line, 1320 feet, more or less, to the center of said Section 14; thence S87°32'35"W along the south line of the NW ¼ of said Section 14, also being the said limits line, 352.25 feet to a point located N87°32'55"E, 165.71 feet, as measured along said south line, from the easterly right-of-way line of Interstate Highway 90; thence S87°32'55"W, along said south line, 165.71 feet to the easterly right-of-way line of Interstate Highway 90; thence Northerly, along the said easterly right-of-way line of Interstate Highway 90, 1440 feet, more or less, to the point of beginning; excepting therefrom those portions of territories now in the Town of Blooming Grove Polling place at Lake City Church, 4909 Buckeye Road."

If any provision of this ordinance is invalid or unconstitutional, or if the application of this ordinance to any person or circumstances is invalid or unconstitutional, such invalidity or unconstitutionality shall not affect the other provisions or applications of this ordinance which can be given effect without the invalid or unconstitutional provision or application

I, Maribeth Witzel-Behl, certify that this is a true copy of Ordinance No. 08889, passed by the COMMON COUNCIL on 2/26/2008.

Maribeth Witzel-Behl  
 Maribeth Witzel-Behl

3-31-2008  
 Date Certified

[Signature]  
 Mayor's Signature

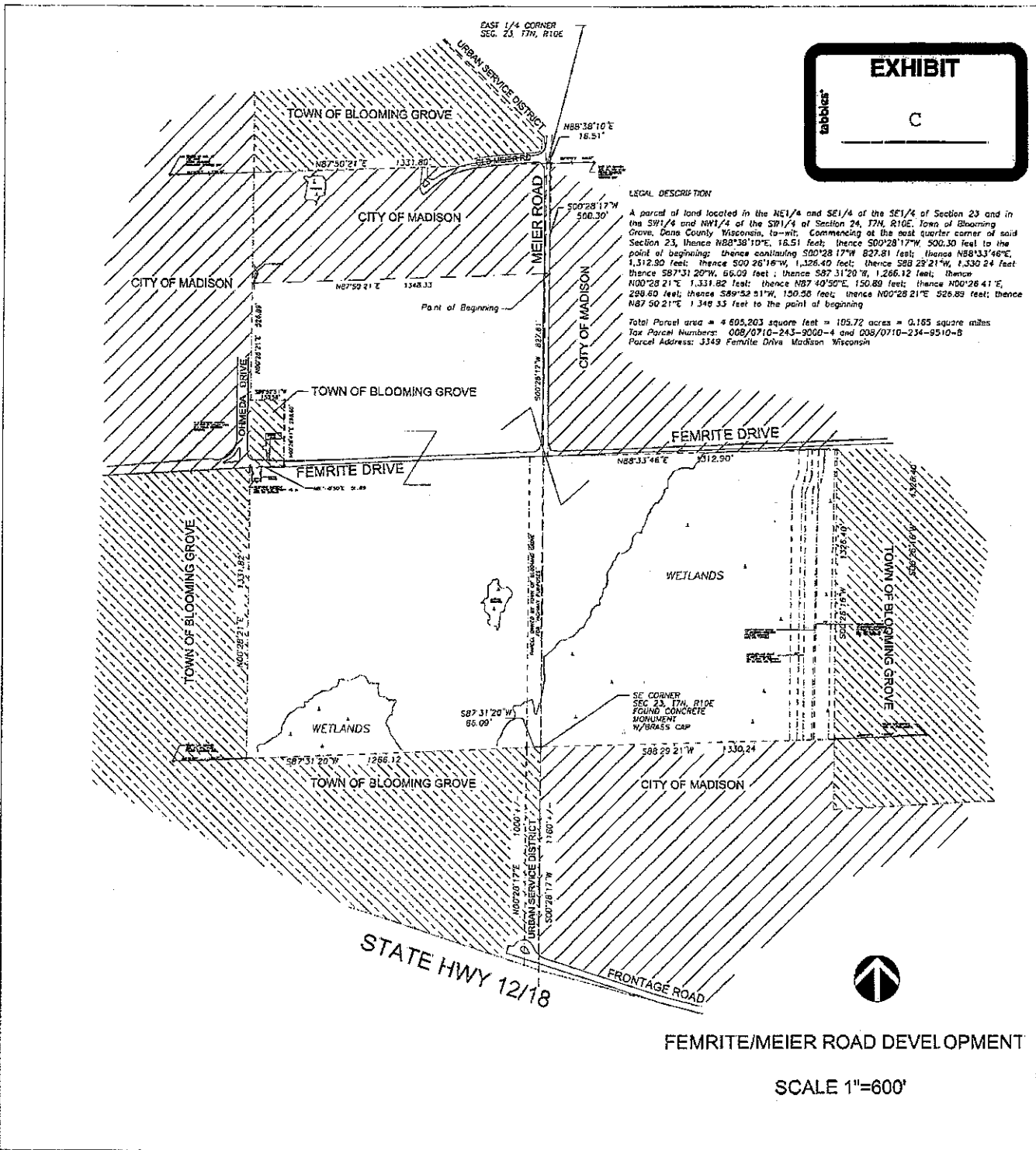

**SD-1**

FEMRITE/MEIER RD DEVELOPMENT  
 BLOOMING GROVE TOWNSHIP  
 MADISON, WISCONSIN

---

MUNICIPAL / TOWNSHIP BOUNDARIES

**RUEDEBUSCH DEVELOPMENT & CONSTRUCTION**

4605 DOVETAIL DR MADISON WISCONSIN 53704  
 PHONE (608) 249-2012 FAX (608) 249-2032

**NOTE:** Please be advised that the document grantor(s) hereby direct viewers to ignore the printed text material on this exhibit. Only the spatial relationships of the illustrations on the plan are being presented for your information.

Signed by grantor(s) or grantor's(s) agent: Maribeth Witzel-Behl Date: 3/31/08 (USE BLACK INK ONLY)  
 Name of grantor(s) or grantor's(s) agent printed: Maribeth Witzel-Behl (USE BLACK INK ONLY)