

REV. 07/30/2018 **AJM**
**ADDED TWO TYPICAL SECTIONS
TO REPRESENT VARIOUS TYPES
OF WORK REQUIRED FOR THE
CONSTRUCTION OF RIDGE ST.**

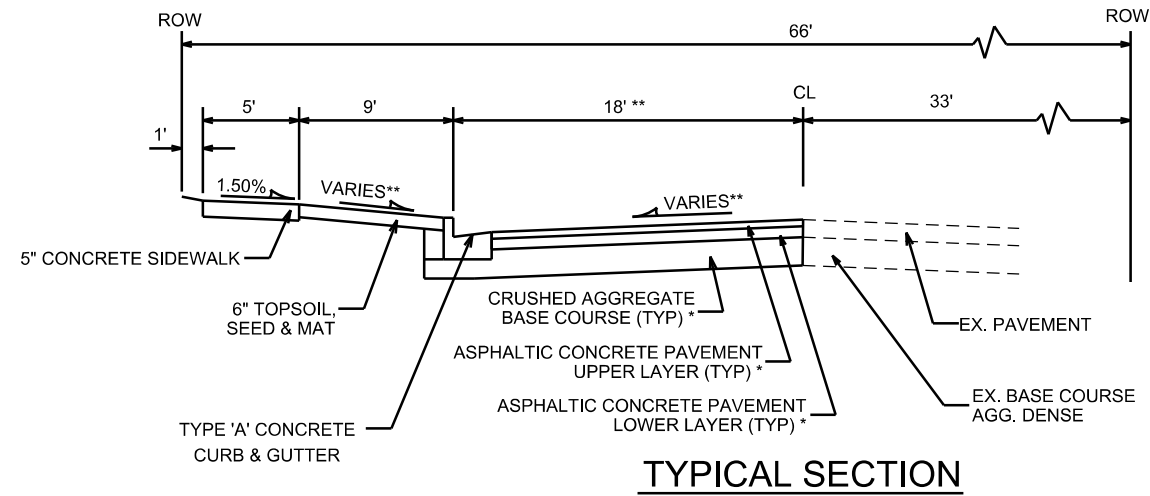

TYPICAL SECTION

RIDGE ST
STA 102+75 TO STA 103+50
NOT TO SCALE

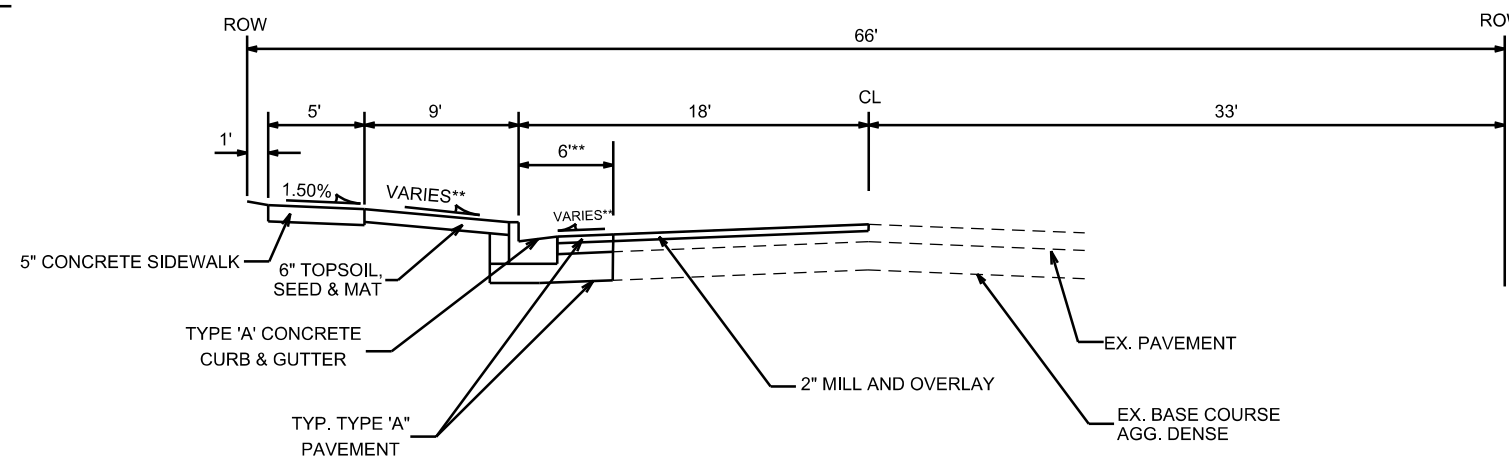

TYPICAL SECTION

RIDGE ST
STA 103+50 TO STA 104+42
NOT TO SCALE

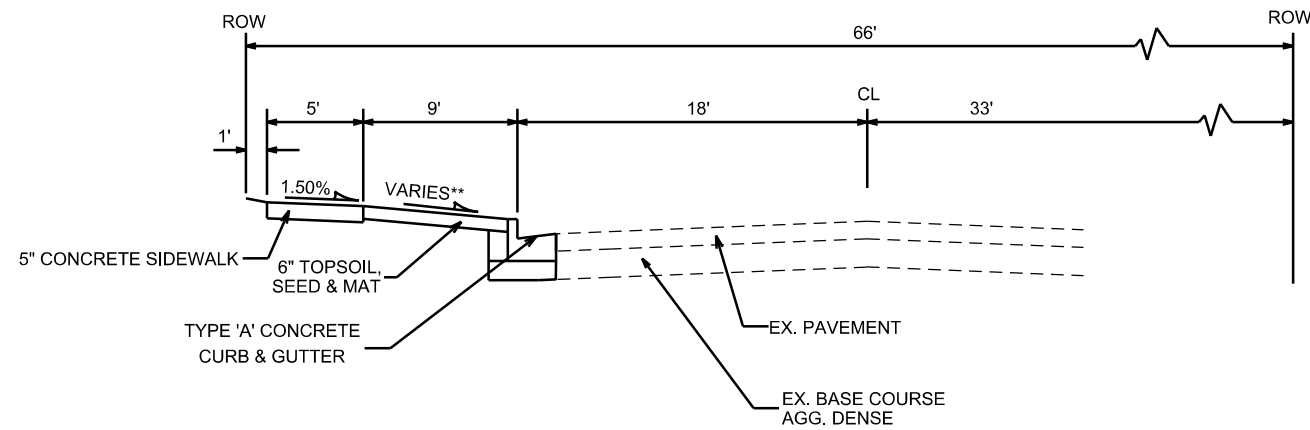

TYPICAL SECTION

RIDGE ST
STA 104+42 TO STA 104+68
NOT TO SCALE

CITY OF MADISON MINIMUM PAVEMENT DESIGN

| TYPE | CRUSHED AGG. BASE COURSE | | ASPHALTIC CONCRETE PAVEMENT | | | |
|------|--------------------------|-------------------------|--------------------------------|-----------|--------------------------------|-----------|
| | LOWER LAYER GRADATION 1 | UPPER LAYER GRADATION 2 | LOWER LAYER | | UPPER LAYER | |
| | | | TYPE | THICKNESS | TYPE | THICKNESS |
| A | 6" | 6" | 4 LT 58-28 S | 1.75" | 4 LT 58-28 S | 1.75" |
| B | 6" | 6" | 4 LT 58-28 S | 2.50" | 4 LT 58-28 S | 2.00" |
| C | 6" | 6" | 3 MT 58-28 S/H 3 HT 58-28 H | 3.50" | 4 MT 58-28 S/H 4 HT 58-28 H | 2.00" |

NOTES:

TYPICAL SECTIONS NOT TO SCALE

* HARVEY AND RIDGE ST TO BE CONSTRUCTED AS TYPE 'A' PAVEMENT PER CITY OF MADISON MINIMUM PAVEMENT DESIGN

** SEE CROSS SECTIONS FOR ELEVATIONS, SLOPES AND OFFSETS.

REV. 07/30/2018 AJM

HARVEY AND UNIVERSITY TYPICAL
SECTIONS MOVED TO ANOTHER
SHEET

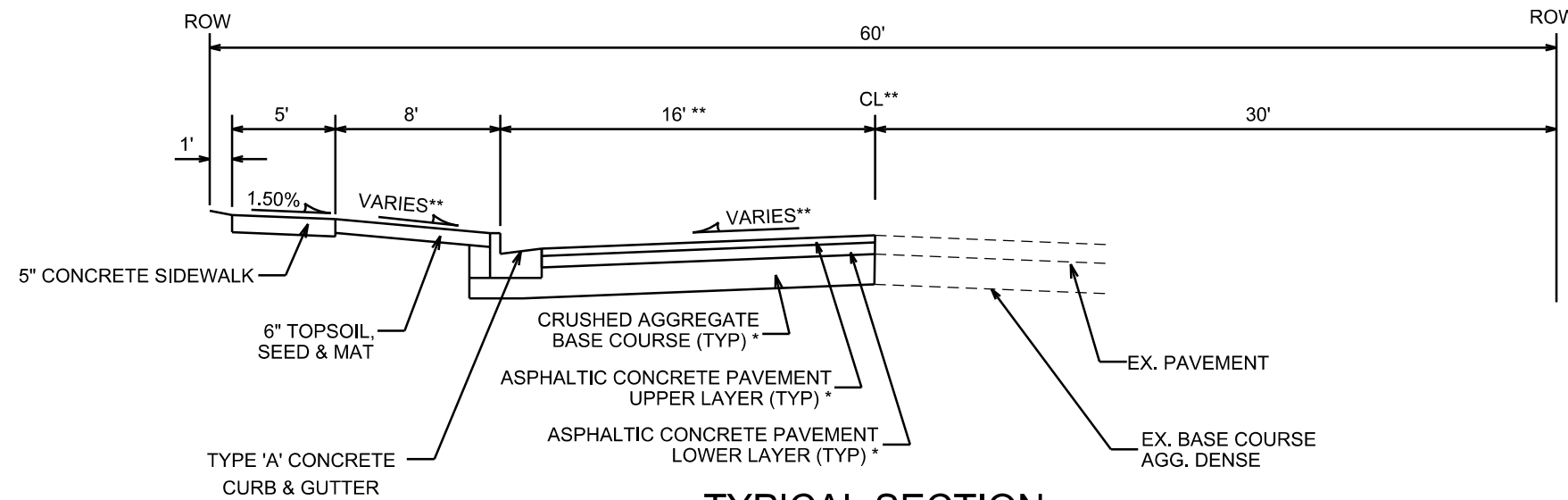

TYPICAL SECTION

HARVEY ST
STA 200+93 TO STA 202+74
NOT TO SCALE

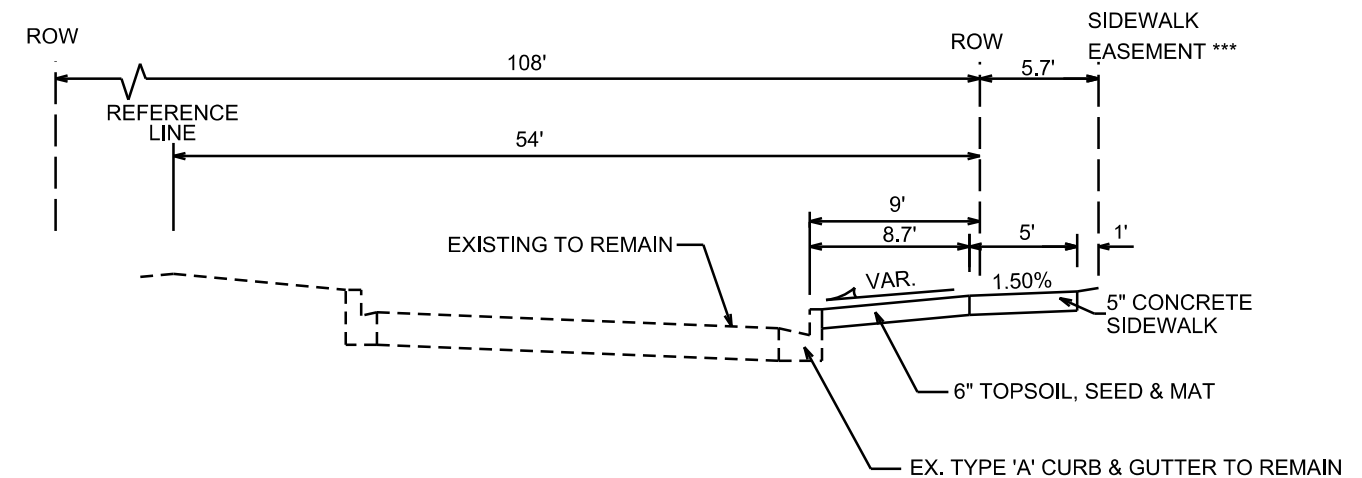

TYPICAL SECTION

UNIVERSITY AVE
STA 11+78 TO 13+61
NOT TO SCALE

CITY OF MADISON MINIMUM PAVEMENT DESIGN

| TYPE | CRUSHED AGG. BASE COURSE | | ASPHALTIC CONCRETE PAVEMENT | | | |
|------|--------------------------|-------------------------|--------------------------------|-----------|--------------------------------|-----------|
| | LOWER LAYER GRADATION 1 | UPPER LAYER GRADATION 2 | LOWER LAYER | | UPPER LAYER | |
| | | | TYPE | THICKNESS | TYPE | THICKNESS |
| A | 6" | 6" | 4 LT 58-28 S | 1.75" | 4 LT 58-28 S | 1.75" |
| B | 6" | 6" | 4 LT 58-28 S | 2.50" | 4 LT 58-28 S | 2.00" |
| C | 6" | 6" | 3 MT 58-28 S/H 3 HT 58-28 H | 3.50" | 4 MT 58-28 S/H 4 HT 58-28 H | 2.00" |

NOTES:

TYPICAL SECTIONS NOT TO SCALE

* HARVEY AND RIDGE ST TO BE CONSTRUCTED AS TYPE 'A' PAVEMENT PER CITY OF MADISON MINIMUM PAVEMENT DESIGN

** SEE CROSS SECTIONS FOR ELEVATIONS, SLOPES AND OFFSETS.

*** 5.7' SIDEWALK EASEMENT. SEE RECORDED DOCUMENT NO. 5404546

STREET PLAN AND PROFILE

HARVEY ST CITY OF MADISON

- NOTES:
1" = 30'
1. FINAL PAVEMENT REPAIR LIMITS TO BE DETERMINED BY THE CONSTRUCTION ENGINEER.
 2. DEVELOPER SHALL BE RESPONSIBLE FOR COORDINATING AND SCHEDULING ANY REQUIRED RELOCATION OR ADJUSTING OF PRIVATE UTILITY FACILITIES, SUCH AS POLES, PEDESTALS, BOXES, STRUCTURES, CASTINGS OR MANHOLES, WITH PRIVATE UTILITY COMPANIES
 3. SEE PRIVATE PLANS FOR WORK ON PRIVATE PROPERTY

LEGEND:
X = REMOVE TREE

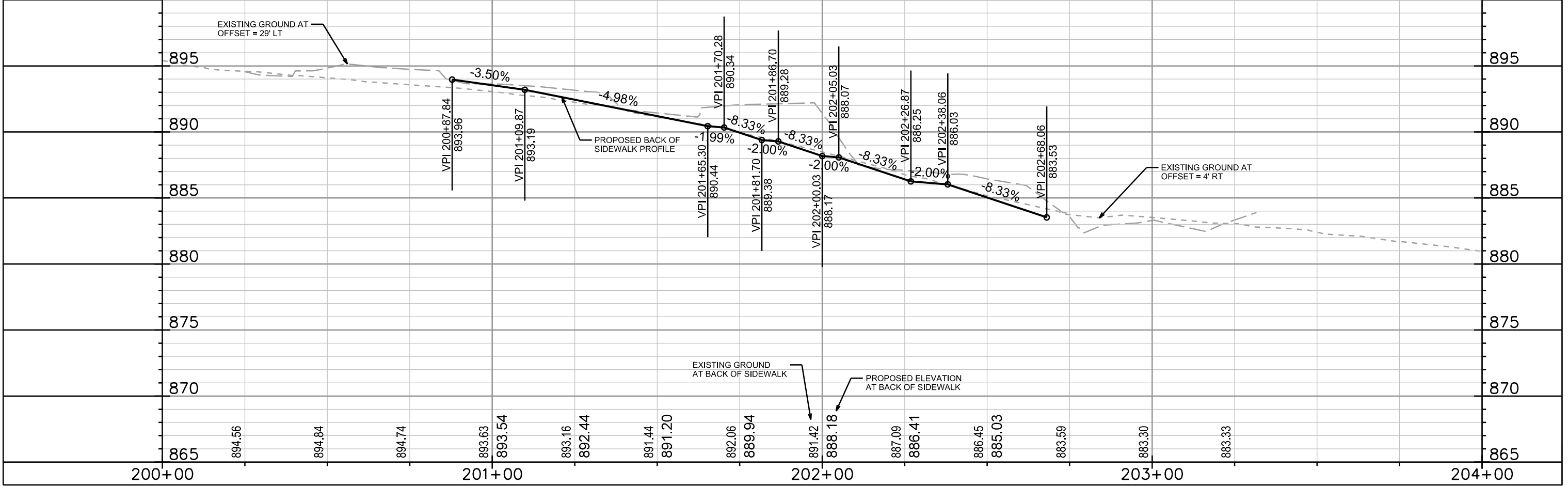
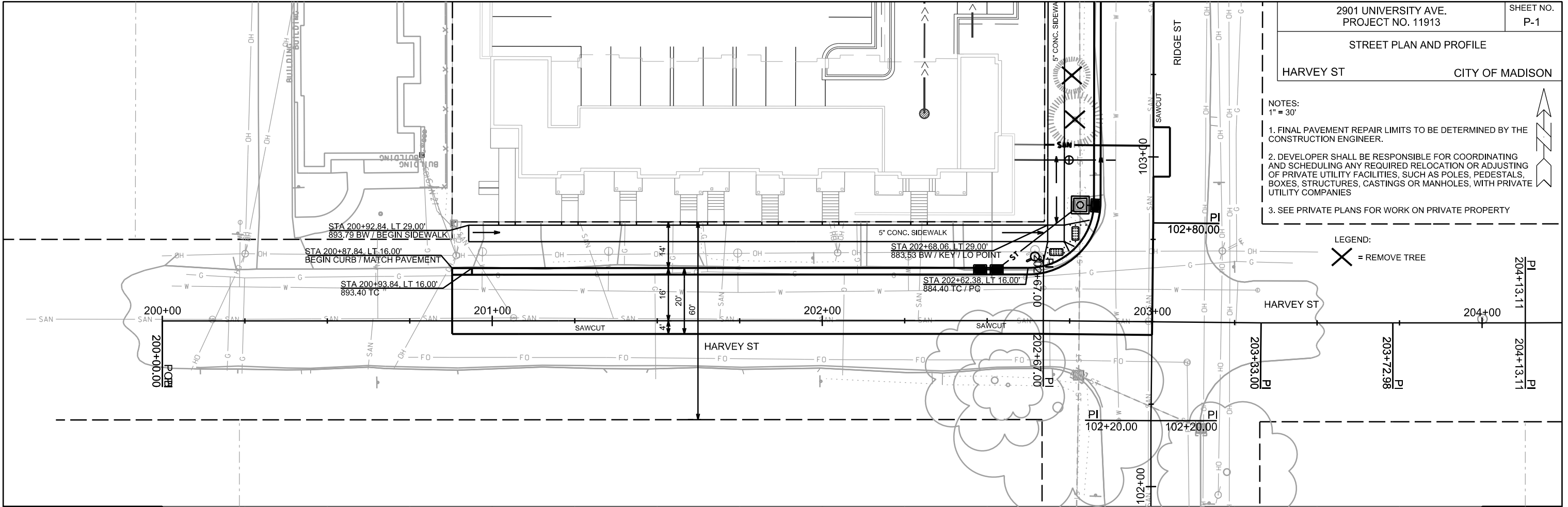

PLOT SCALE: _____

PLOT NAME: _____

REV. DATE: _____

ORIGINATOR: CITY OF MADISON, STREETS DIVISION

REVISED: 07/30/2018
**FULL DEPTH ROAD RECONST.
LIMITS REDUCED TO A MILL
& OVERLAY SECTION (SHOWN
AS HATCHED PATTERN)**

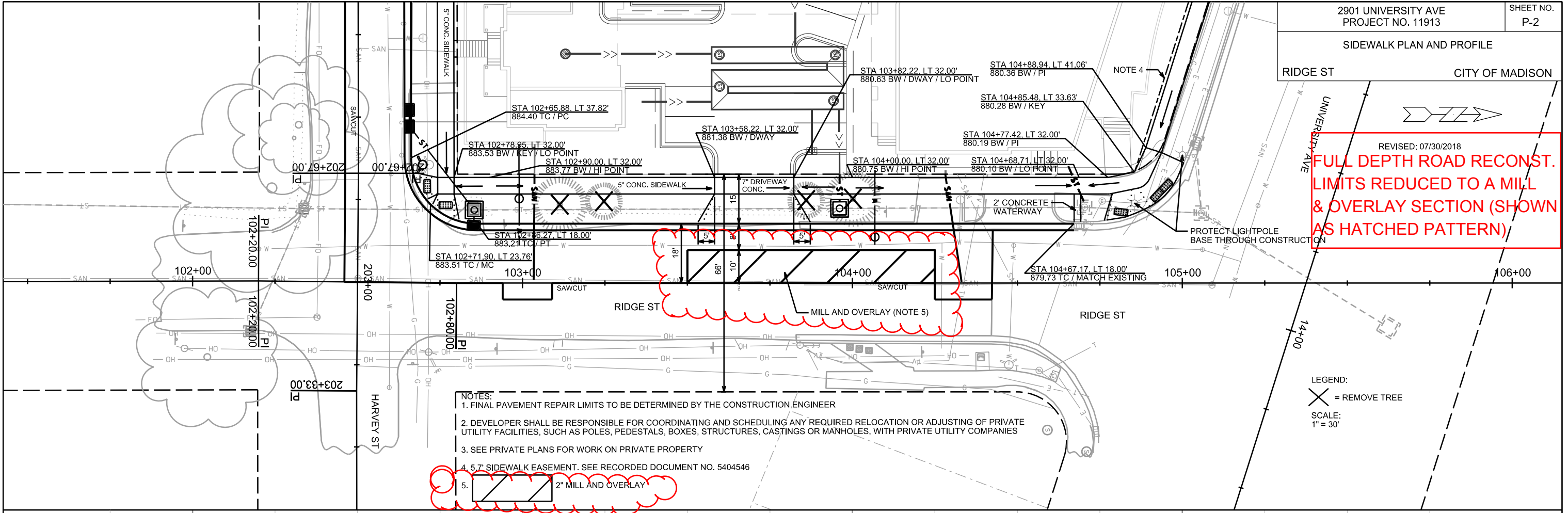

- NOTES:
1. FINAL PAVEMENT REPAIR LIMITS TO BE DETERMINED BY THE CONSTRUCTION ENGINEER
 2. DEVELOPER SHALL BE RESPONSIBLE FOR COORDINATING AND SCHEDULING ANY REQUIRED RELOCATION OR ADJUSTING OF PRIVATE UTILITY FACILITIES, SUCH AS POLES, PEDESTALS, BOXES, STRUCTURES, CASTINGS OR MANHOLES, WITH PRIVATE UTILITY COMPANIES
 3. SEE PRIVATE PLANS FOR WORK ON PRIVATE PROPERTY
 4. 5.7' SIDEWALK EASEMENT. SEE RECORDED DOCUMENT NO. 5404546
 5. 2" MILL AND OVERLAY

LEGEND:
 = REMOVE TREE
 SCALE:
 1" = 30'

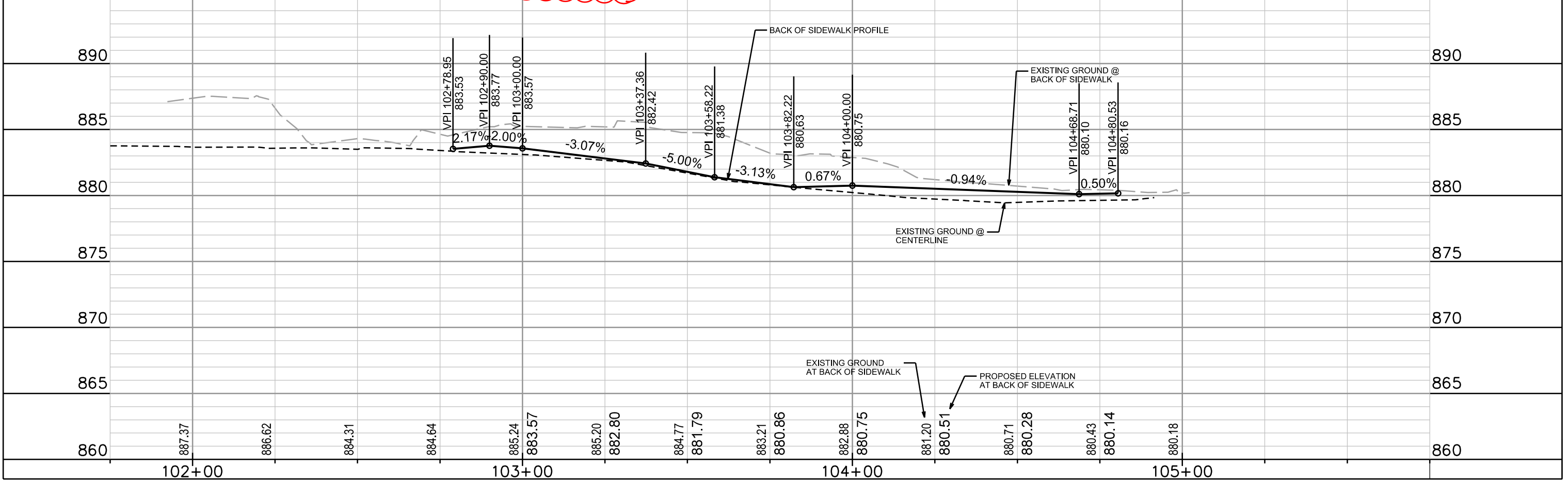

PLOT SCALE:

PLOT NAME:

REV. DATE:

ORIGINATOR: CITY OF MADISON, STREETS DIVISION

REV. 07-30-18 AJM

**FULL DEPTH ROAD RECONST.
LIMITS REDUCED TO A MILL
& OVERLAY SECTION (SHOWN
AS HATCHED PATTERN)**

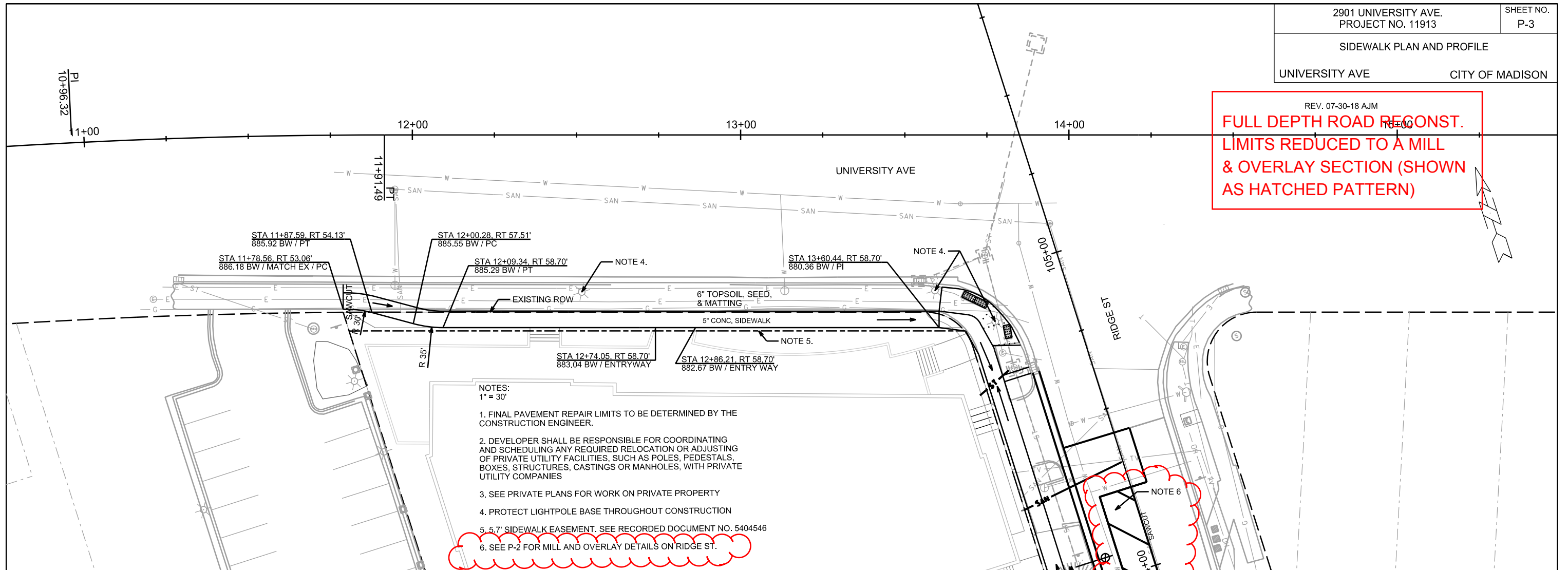

- NOTES:
1" = 30'
1. FINAL PAVEMENT REPAIR LIMITS TO BE DETERMINED BY THE CONSTRUCTION ENGINEER.
 2. DEVELOPER SHALL BE RESPONSIBLE FOR COORDINATING AND SCHEDULING ANY REQUIRED RELOCATION OR ADJUSTING OF PRIVATE UTILITY FACILITIES, SUCH AS POLES, PEDESTALS, BOXES, STRUCTURES, CASTINGS OR MANHOLES, WITH PRIVATE UTILITY COMPANIES
 3. SEE PRIVATE PLANS FOR WORK ON PRIVATE PROPERTY
 4. PROTECT LIGHTPOLE BASE THROUGHOUT CONSTRUCTION
 5. 5.7' SIDEWALK EASEMENT, SEE RECORDED DOCUMENT NO. 5404546
 6. SEE P-2 FOR MILL AND OVERLAY DETAILS ON RIDGE ST.

