

# AMENDMENT to the PIONEER NEIGHBORHOOD DEVELOPMENT PLAN Land Use and Street Plan

**Pioneer Neighborhood Plan as adopted April 2004  
and implemented through subdivision and zoning approvals.**

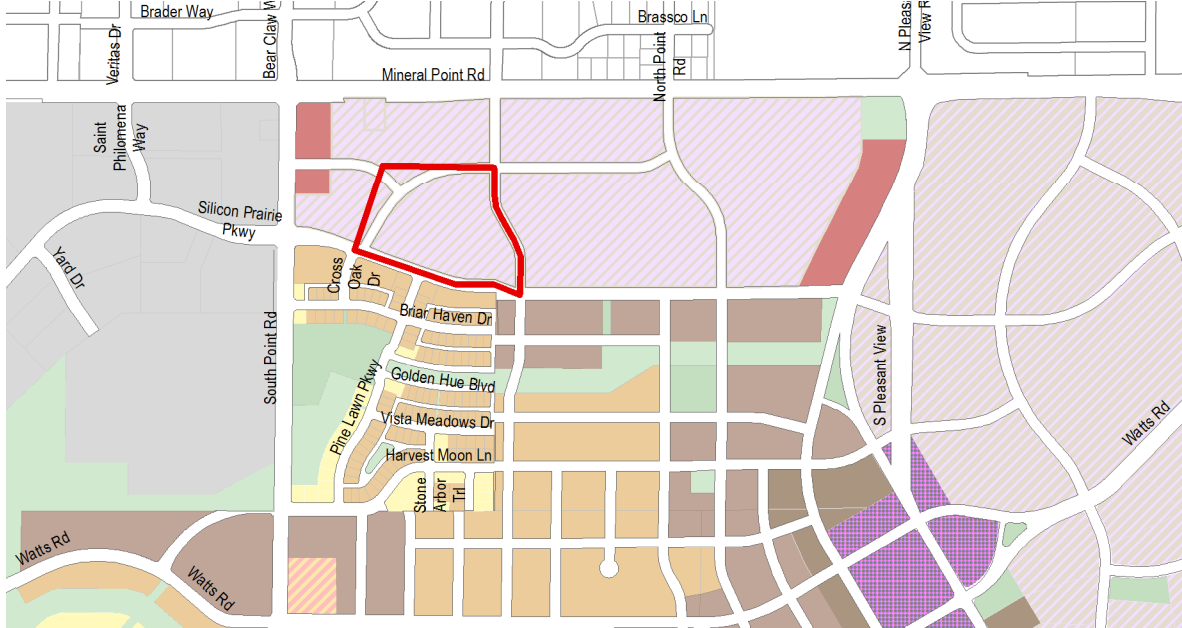

- |   |                                |                   |                                  |
|---|--------------------------------|-------------------|----------------------------------|
| Low Density Res.<br>less than 8 du/acre     | Residential-<br>Commercial Mix | Neigh. Commercial | Research &<br>Development        |
| Low-Med. Density Res.<br>8-15 du/acre       | MIXED USE urban mix            | Light Industrial  | Institutional                    |
| Med. Density Res.<br>16-25 du/acre          | MIXED USE neigh mix            | Employment        | Park, Drainage<br>and Open Space |
| Med. - High Density Res.<br>over 25 du/acre |                                |                   |                                  |

## Proposed Pioneer Neighborhood Development Plan Amendment, \_\_\_\_\_, 2013

0 500 Feet

