

EXHIBIT B

(page 1 of 2)

PERMIT ONLY

PDF MADE: SEPTEMBER 22, 2015



FIBER OPTIC NODE INSTALLATION
 NEW STREET LIGHT POLE
 NODE 01A - MADISON, WI
 SOUTH SIDE OF MINERAL POINT RD.
 10' EAST OF 2nd POLE, EAST FROM S. WESTFIELD RD.

NODE - 01A

SITE LOCATION MAP

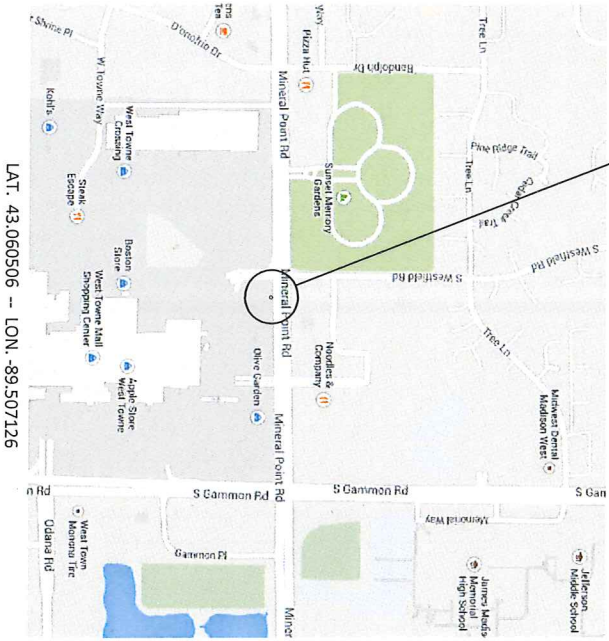

LAT. 43.060506 -- LON. -89.507126

SITE LOCATION SIM PHOTO



SEGMENT:
NODE 01A

OWNER/DEVELOPER



3030 Waverline Road
 Suite 200
 Elkhart, IN 46532

ENGINEER



4804 North 40th Street
 Sheboygan, WI 53083
 Phone: (920) 459-2600

CONTRACTOR



4804 North 40th Street
 Sheboygan, WI 53083
 Phone: (920) 459-2600

TITLE:
 FIBER OPTIC NODE
 INSTALLATION ONTO
 NEW STEEL POLE
 MADISON, WI

REVISIONS

REV	DATE	DESCRIPTION	BY
1			
2			
3			
4			
5			
6			
7			
8			

DESIGN BY: GABRES

CHECKED BY: GABRES

PROJECT NUMBER: EXTW15100

FILE NUMBER: NODE 01A

DWG NUMBER: 09.14.15

SCALE: N.T.S.

SHEET: 1 of 9



FIBER OPTIC NODE INSTALLATION
 NEW STREET LIGHT POLE W/ NEW CABINET
 NODE 02D - MADISON, WI
 NW CORNER OF N. GAMMON RD. & ODANA RD.

NODE - 02D

SITE LOCATION MAP

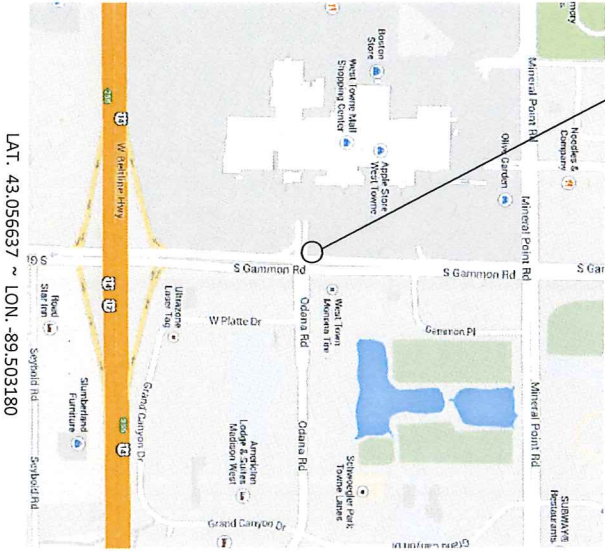

LAT. 43.056637 ~ LON. -89.503180

SITE LOCATION SIMI PHOTO

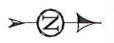

SEGMENT:
NODE 02D

OWNER/DEVELOPER



ENGINEER



4804 North 40th Street
 Sheboygan, WI 53083
 Phone: (920) 459-2600

CONTRACTOR



4804 North 40th Street
 Sheboygan, WI 53083
 Phone: (920) 459-2600

TITLE:
 FIBER OPTIC NODE
 INSTALLATION ONTO
 LIGHT POLE
 MADISON, WI

REVISIONS	
REV	DATE
1	
2	
3	
4	
5	
6	
7	
8	
9	

REV	DATE	DESCRIPTION	BY
1			
2			
3			
4			
5			
6			
7			
8			
9			

DESIGN BY	CHECKED BY	APPROVED BY
JO	GABRES	GABRES

PROJECT NUMBER	EXTW151000
FILE NUMBER	NODE 02D
DRAWING NO.	09.11.15
SCALE	N.T.S.