



# City of Madison Liquor/Beer License Application

On-Premises Consumption:  Class B Beer     Class B Liquor     Class C Wine  
Off-Premises Consumption:  Class A Beer     Class A Liquor

## Section A – Applicant

- If needed, a qualified interpreter can be provided at no charge to you. Would you like an interpreter?  
 Yes (language: \_\_\_\_\_)  
 No (If you answer no and you do require an interpreter, the ALRC will refer your application to a subsequent meeting and this may delay your application process)
- This application is for the license period ending June 30, 20<sup>16</sup>.
- List the name of your  Sole Proprietor,  Partnership,  Corporation/Nonprofit Organization or  Limited Liability Company exactly as it appears on your State Seller's Permit.  
 Indian Kitchens, Inc.
- Trade Name (doing business as) ~~Maharaja Indian Restaurant~~ To be determined
- Address to be licensed 6713 Odana Road, Madison, WI 53719 Space 12, rear of 384
- Mailing address \_\_\_\_\_
- Anticipated opening date 02/01/2016
- Is the applicant an employee or agent of, or acting of behalf of anyone except the applicant named in question 2?  
 No     Yes (explain) \_\_\_\_\_
- Does another alcohol beverage licensee or wholesale permittee have interest in this business?  
 No     Yes (explain) \_\_\_\_\_

## Section B—Premises

- Describe in words the building or buildings where alcohol beverages are to be sold and stored. Include all rooms including living quarters, if used, and any outdoor seating used for the sales, service, and/or storage of alcohol beverages and records. Alcohol beverages may be sold and stored only on the premises as approved by Common Council and described on license.  
 Alcohol will be stored in the on-site dry storage and in the retail display area.

Sq. Ft. 5840

- Attach a floor plan, no larger than 8 ½ by 14, showing the space described below.
- Applicants for on-premises consumption: list estimated capacity 99

A-19 (CLEAR)  
P-113

13. Describe existing parking and how parking lot is to be monitored.  
 Customer parking is available in the front and side of the building.

---

14. Was this premises licensed for the sale of liquor or beer during the past license year?  
 No  Yes, license issued to Nirmal Corporation (name of licensee)

15.  Attach copy of lease.

**Section C—Corporate Information**

This section applies to corporations, nonprofit organizations, and Limited Liability Companies only. Sole proprietorships and partnerships, skip to Section D.

16. Name of liquor license agent Anwar A. Zaidi

17. City, state in which agent resides Verona, WI

18. How long has the agent continuously resided in the State of Wisconsin? 11/08/2001

19.  Appointment of agent form and background check form are attached.

20. Has the liquor license agent completed the responsible beverage server training course?  
 No, but will complete prior to ALRC meeting  Yes, date completed \_\_\_\_\_

21. State and date of registration of corporation, nonprofit organization, or LLC.  
WI, 12/14/2015

22. In the table below list the directors of your corporation or the members of your LLC.  
 Attach background check forms for each director/member.

Title	Name	City and State of Residence
President	Reba Zaidi	Verona, WI
Vice President	Dev Raj	Madison, WI

23. Registered agent for your corporation or LLC. This is your agent for service of process, notice or demand required or permitted by law to be served on the corporation. This is not necessarily the same as your liquor agent.

Anwar A. Zaidi

24. Is applicant a subsidiary of any other corporation or LLC?  
 No  Yes (explain) \_\_\_\_\_



34. Describe how you plan to advertise and promote your business. What products will you be advertising?

Advertise with local newspapers, coupon magazines, online sites, our of website,  
radio and tv commercials.

35. Are you operating under a lease or franchise agreement?  No  Yes

36. Private organizations (clubs): Do your membership policies contain any requirement of "invidious" (likely to give offense) discrimination in regard to race, creed, color, or national origin?

No  Yes

### Section E—Consumption on Premises

This section applies to Class B and Class C applicants only. Class A license applicants (consumption off premises) may skip to Section F.

37. Do you plan to have live entertainment?  No  Yes—what kind? \_\_\_\_\_

38. What age range do you hope to attract to your establishment? 25-55

39. What type of food will you be serving, if any? \_\_\_\_\_  
 Breakfast  Brunch  Lunch  Dinner

40. Submit a sample menu if applicable. What will be included on your operational menu?  
 Appetizers  Salads  Soups  Sandwiches  Entrees  Desserts  
 Pizza  Full Dinners

41. During what hours of operation do you plan to serve food? 11:30a - 10:00p

42. What hours, if any, will food service not be available? 3p - 5p (between lunch and dinner)

43. Indicate any other product/service offered. N/A

44. Will your establishment have a kitchen manager?  No  Yes

45. Will you have a kitchen support staff?  No  Yes

46. How many wait staff do you anticipate will be employed at your establishment? 2-4  
During what hours do you anticipate they will be on duty? 11:30a - 2:00p; 5:00p - 10:00p

47. Do you plan to have hosts or hostesses seating customers?  No  Yes

48. Do your plans call for a full-service bar?  No  Yes  
If yes, how many barstools do you anticipate having at your bar? \_\_\_\_\_  
How many bartenders do you anticipate having work at one time on a busy night? \_\_\_\_\_

49. Will there be a kitchen facility separate from the bar?  No  Yes

50. Will there be a separate and specific area for eating only?  
 No  Yes, capacity of that area \_\_\_\_\_
51. What type of cooking equipment will you have?  
 Stove  Oven  Fryers  Grill  Microwave
52. Will you have a walk-in cooler and/or freezer dedicated solely to the storage of food products?  
 No  Yes
53. What percentage of payroll do you anticipate devoting to food operation salaries? 95%
54. If your business plan includes an advertising budget:  
 What percentage of your advertising budget do you anticipate will be related to food? 95%  
 What percentage of your advertising budget do you anticipate will be drink related? 5%
55. Are you currently, or do you plan to become, a member of the Madison—Dane County Tavern League or the Tavern League of Wisconsin?  No  Yes
56. Are you currently, or do you plan to become, a member of the Wisconsin Restaurant Association or the National Restaurant Association?  No  Yes
57. All restaurants and taverns serving alcohol must substantiate their gross receipts for food and alcohol beverage sales broken down by percentage. New establishments estimate percentages:  
5 % Alcohol 95 % Food 0 % Other
58. Do you have written records to document the percentages shown?  No  Yes  
 You may be required to submit documentation verifying the percentages you've indicated.

### Section F—Required Contacts and Filings

59. I understand that liquor/beer license renewal applications are due April 15 of every year, regardless of when license was initially granted.  No  Yes
60. I understand that I am required to host an information session at least one week before the ALRC meeting.  No  Yes
61. I agree to contact the Alderperson for this location to discuss my application and to invite the Alderperson to my information session.  No  Yes
62. I agree to contact the Police Department District Captain for this location prior to the ALRC meeting.  No  Yes
63. I agree to contact the Alcohol Policy Coordinator prior to the ALRC meeting.  No  Yes
64. I agree to contact the neighborhood association representative prior to the ALRC meeting.  
 No  Yes
65. I understand we must file a Special Occupational Tax return (TTB form 5630.5) before beginning business. [phone 1-800-937-8864]  No  Yes
66. I understand a Wisconsin Seller's Permit must be applied for and issued in the same name as that shown in section 2, above. [phone 608-266-2776]  No  Yes
67. Is the applicant indebted to any wholesaler beyond 15 days for beer or 30 days for liquor?  
 No  Yes

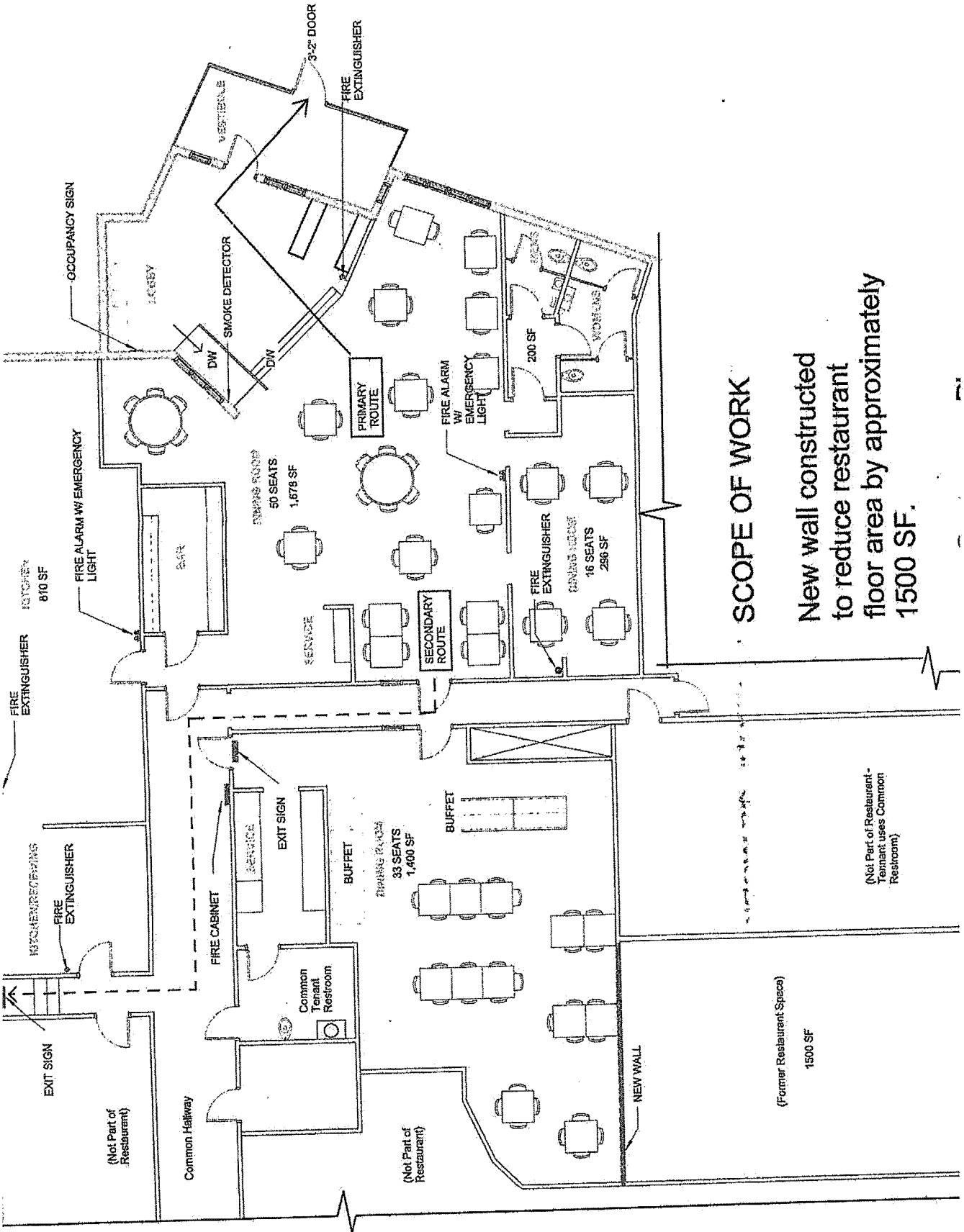

**SCOPE OF WORK**

New wall constructed to reduce restaurant floor area by approximately 1500 SF.

(Not Part of Restaurant - Tenant uses Common Restroom)

(Former Restaurant Space) 1500 SF

(Not Part of Restaurant)

(Not Part of Restaurant)