

Lakeland Avenue and Schurz Avenue Reconstruction Assessment District - 2010



Project Engineer: Glen Yoerger 261-9177
Alder: Marsha Runmmel, District 6
Project Limits: Lakeland Avenue, From Division St to Dunning St
 Schurz Avenue, From Yahara Place to Oakridge Ave

Project Summary: The proposed project includes reconstruction of Lakeland Avenue and Schurz Avenue within the project limits. All pavement, curb and gutter and drive aprons will be replaced. Sanitary sewer, storm sewer and water main will also be replaced. Sidewalk will be replaced as needed to repair any damaged sections and for the installation of sanitary sewer laterals. Street widths and corner radii are proposed to remain the same as existing.

Street: Lakeland Avenue		Existing	Proposed
Project Type			Reconstruction
Last Surfaced		Asphalt Surface - 1986	Asphalt - 2010
Pavement Rating		6	
Curb Rating		3	
Width		28' Face to Face	28' Face to Face
Surface Type		Asphalt over Concrete	Asphalt
Street: Schurz Avenue		Existing	Proposed
Project Type			Reconstruction
Last Surfaced		1924	Asphalt - 2010
Pavement Rating		4	
Curb Rating		4	
Width		24' Face to Face	24' Face to Face
Surface Type		Concrete	Asphalt
Sidewalk		Existing	Proposed
		Existing sidewalk to remain	Replace Damaged Sections/Ensure Ramps ADA Compliant and replace as required for installation of sewer laterals.
Storm Sewer		Existing	Proposed
Work Required			Upgrade storm sewer with concrete pipe
Design Storm			10 Year
Size		12 - 18 Inches	12 - 24 Inches
Material		VP	RCP
Year		1917	2010
Sanitary Sewer		Existing	Proposed
Work Required			Replace Sanitary Sewer Mains & Laterals
Size		varies 6 to 8 inches	8 Inches
Material		VP	PVC
Year		1916-1922	2010
Water Main		Existing	Proposed
Work Required			Replace water main
Size		varies 6 - 10 Inches	10 Inches
Material		Cast Iron	Ductile Iron
Year		varies 1915-1919	2010
Parking		Existing	Proposed
Parking Conditions		Parking Allowed - Restrictions Vary	No Changes
Street Lighting		Existing	Proposed
Street Lighting		Wood poles	No changes proposed
Cost			
Total Cost		\$806,000	
Street Assessments		\$46,000	
Sanitary Assessments		\$20,000	
City of Madison		\$740,000	

Assessment Policy

The cost of concrete items (curb & gutter, sidewalk and drive aprons) is assessed 50% to property owners with remaining 50% paid by the City. The cost for sanitary laterals is assessed 25% to property owner with remaining 75% paid by City. Assessments are payable in one lump or over a period of 8 years, with 3.5% interest charged on unpaid balance.

Schedule

Start Date: June, 2010
 Project Duration: 4 months

Traffic Calming: None proposed at this time
Traffic Detours: none
Real Estate Requirements: None
Tree Information: No removals at this time
Rain Garden Information: Not eligible for rain gardens, terraces are too narrow
Correspondence: Phone calls with questions regarding assessments

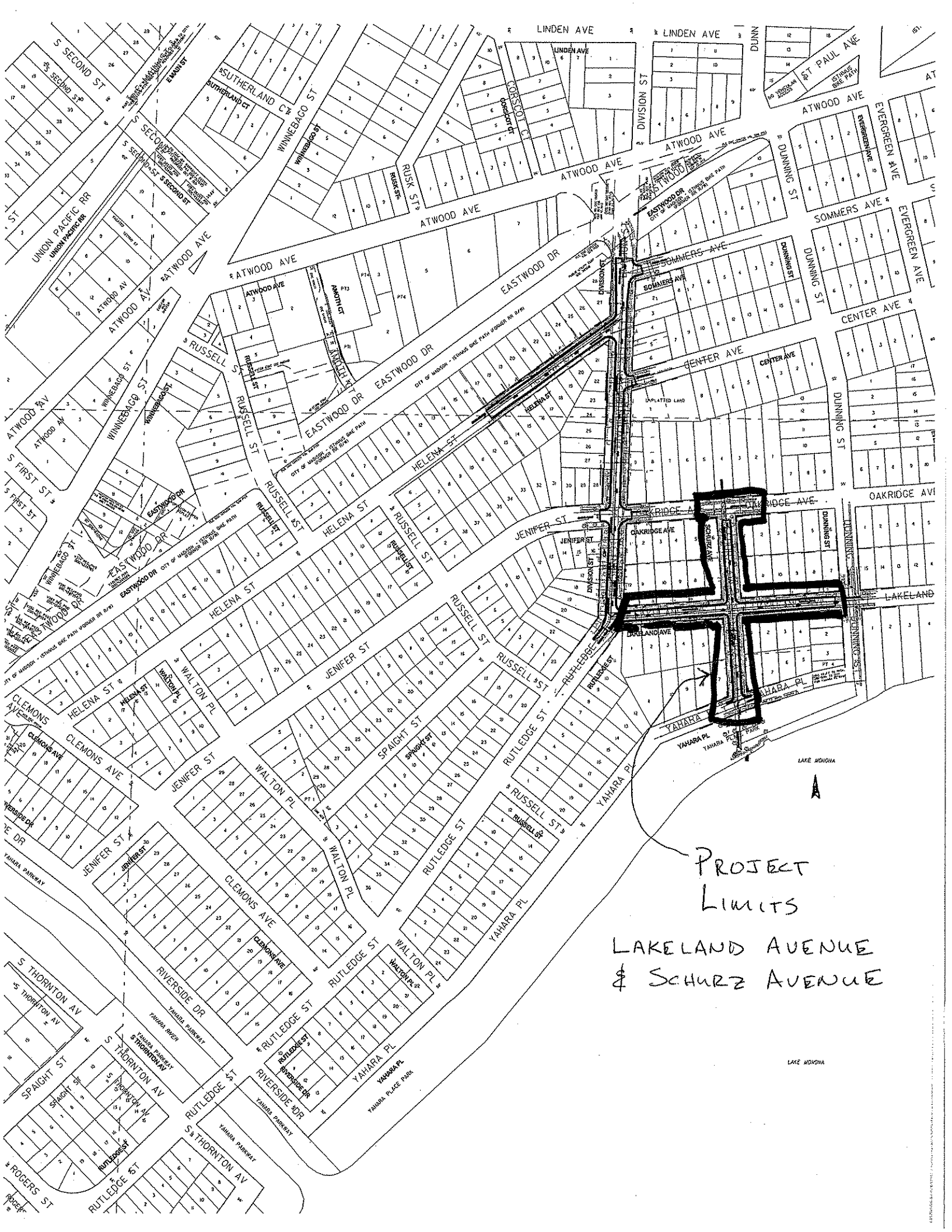

PROJECT
Limits
LAKELAND AVENUE
& SCHURZ AVENUE



LAKE MONONA