

Bulkhead Removal, Shore Stabilization and Canoe/Kayak Access in Yahara Place Park



Bulkhead Condition



- Metal is sound
- Displaced caps
- Sharp edges exposed
- Unclear purpose

9/9/14

Bulkhead Condition



PLOT SCALE: _____

PLOT NAME: _____

REV. DATE: _____

ORIGINATOR: CITY OF MADISON, STREETS DIVISION

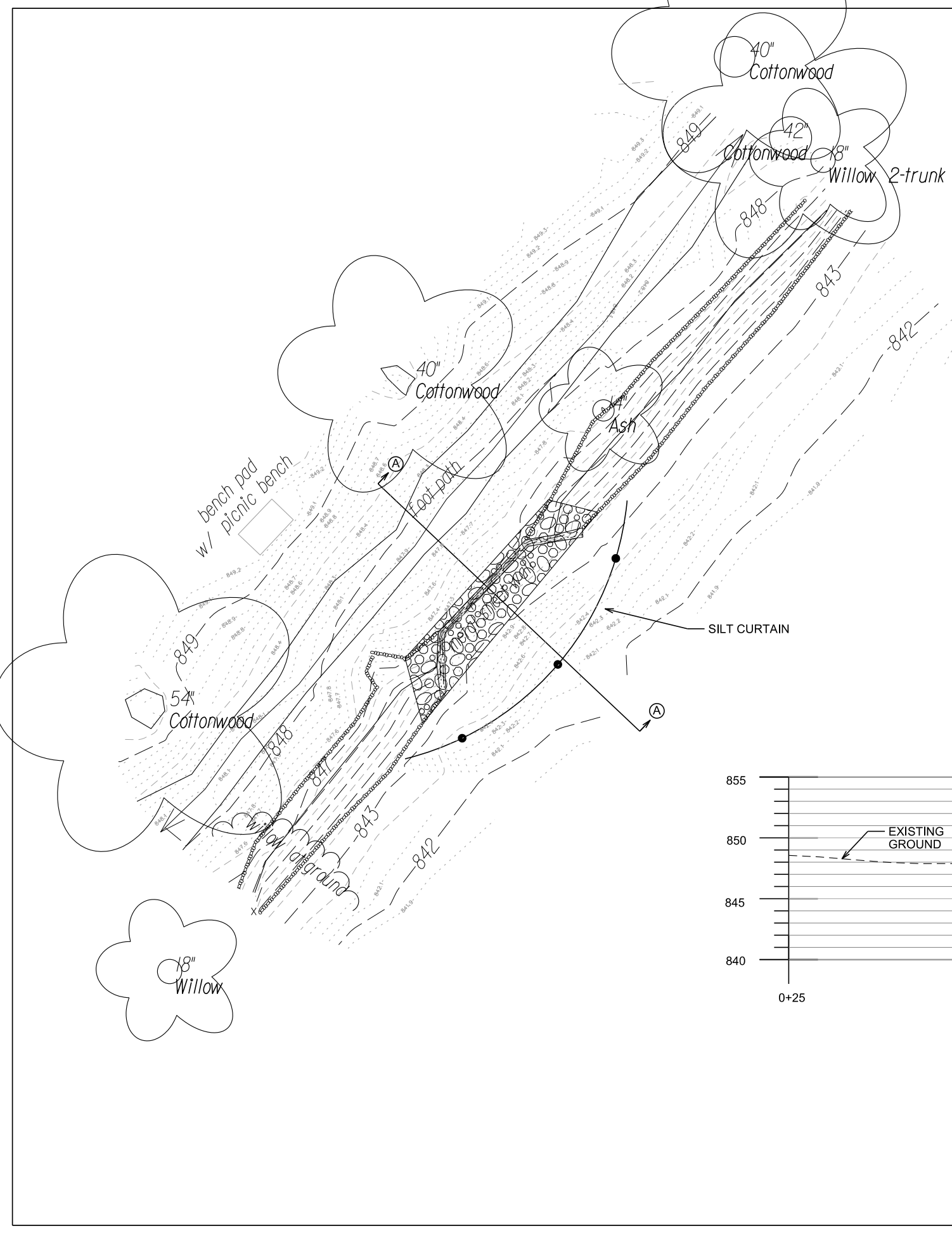

EROSION CONTROL NOTES:

- 1) PRIOR TO BEGINNING ANY EARTHWORK, THE CONTRACTOR SHALL INSTALL SILT CURTAIN PER WI DNR CONSERVATION PRACTICE STANDARD 1070.
- 2) ALL DISTURBED AREAS SHALL BE TOPSOILED, SEEDED WITH TERRACE SEED MIX, AND STABILIZED WITH EROSION CONTROL MATTING, CLASS I, URBAN TYPE A.
- 3) SILT FENCE OR SILT SOCK SHALL BE INSTALLED AS DIRECTED AND THAT THE DISCRETION OF THE CONSTRUCTION ENGINEER.
- 4) TEMPORARY POLYMER STABILIZATION SHALL BE PLACED AS DIRECTED BY THE CONSTRUCTION ENGINEER.
- 5) SILT FENCE SHALL BE PLACED DOWNSTREAM OF ALL STOCKPILE AREAS
- 6) THE PROJECT SITE SHALL BE INSPECTED WITHIN 24 HOURS OF A RAINFALL EXCEEDING 0.5" AND WEEKLY.

SECTION A-A: WALTON PLACE SHEET PILING

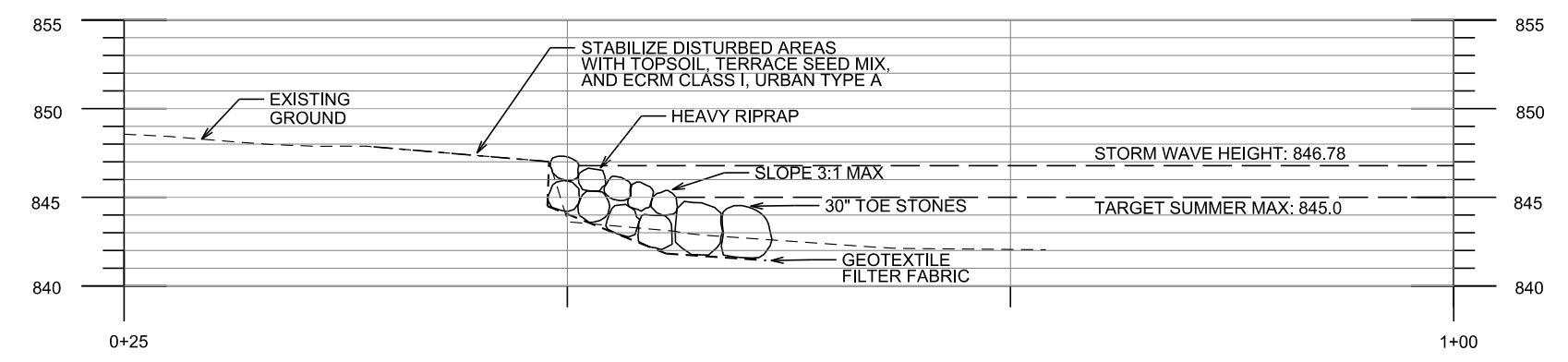

PLOT SCALE: _____

PLOT NAME: _____

REV. DATE: _____

ORIGINATOR: CITY OF MADISON, STREETS DIVISION

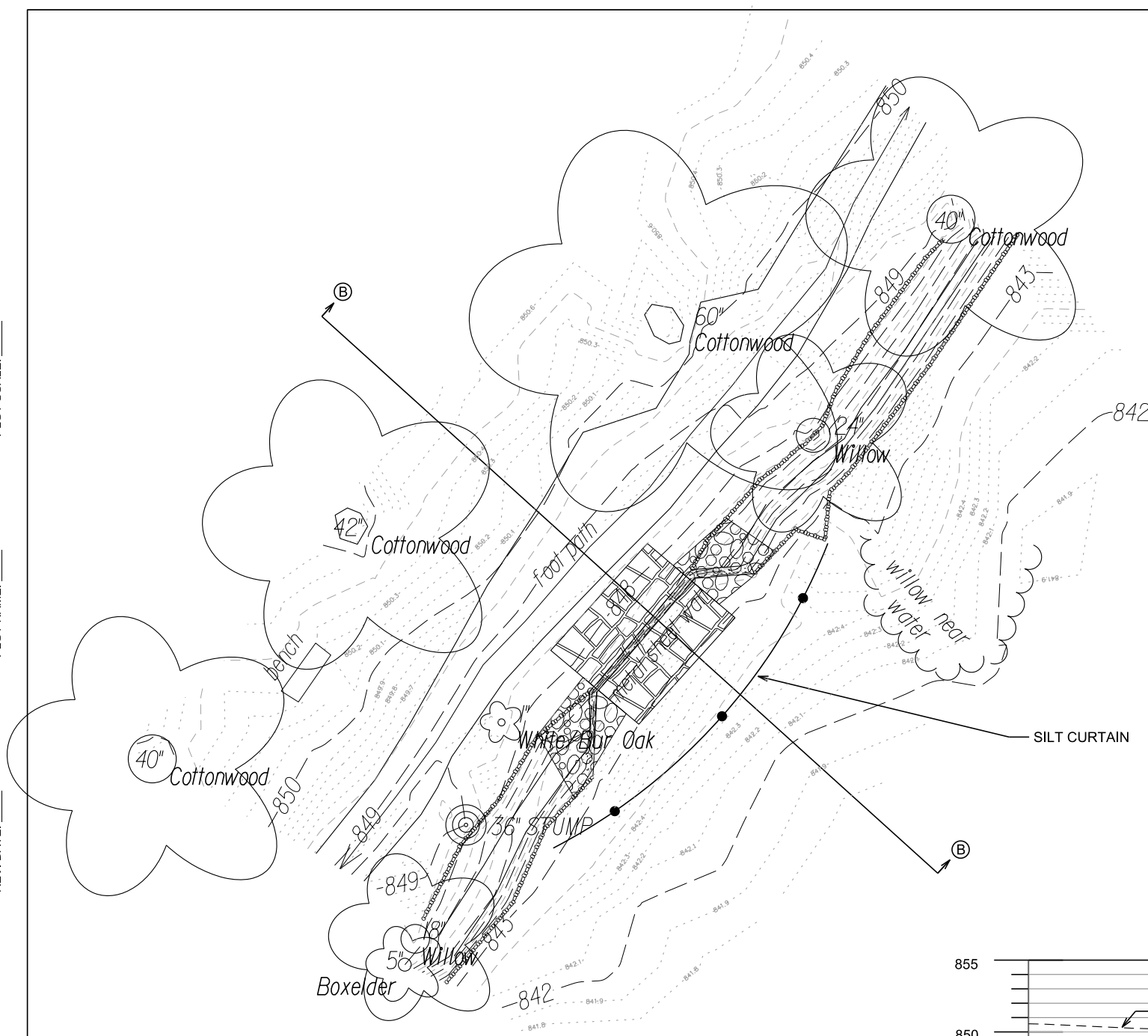

EROSION CONTROL NOTES:

- 1) PRIOR TO BEGINNING ANY EARTHWORK, THE CONTRACTOR SHALL INSTALL SILT CURTAIN PER WI DNR CONSERVATION PRACTICE STANDARD 1070.
- 2) ALL DISTURBED AREAS SHALL BE TOPSOILED, SEEDED WITH TERRACE SEED MIX, AND STABILIZED WITH EROSION CONTROL MATTING, CLASS I, URBAN TYPE A.
- 3) SILT FENCE OR SILT SOCK SHALL BE INSTALLED AS DIRECTED AND THAT THE DISCRETION OF THE CONSTRUCTION ENGINEER.
- 4) TEMPORARY POLYMER STABILIZATION SHALL BE PLACED AS DIRECTED BY THE CONSTRUCTION ENGINEER.
- 5) SILT FENCE SHALL BE PLACED DOWNSTREAM OF ALL STOCKPILE AREAS
- 6) THE PROJECT SITE SHALL BE INSPECTED WITHIN 24 HOURS OF A RAINFALL EXCEEDING 0.5" AND WEEKLY.

SECTION B-B: RUSSELL STREET SHEET PILING

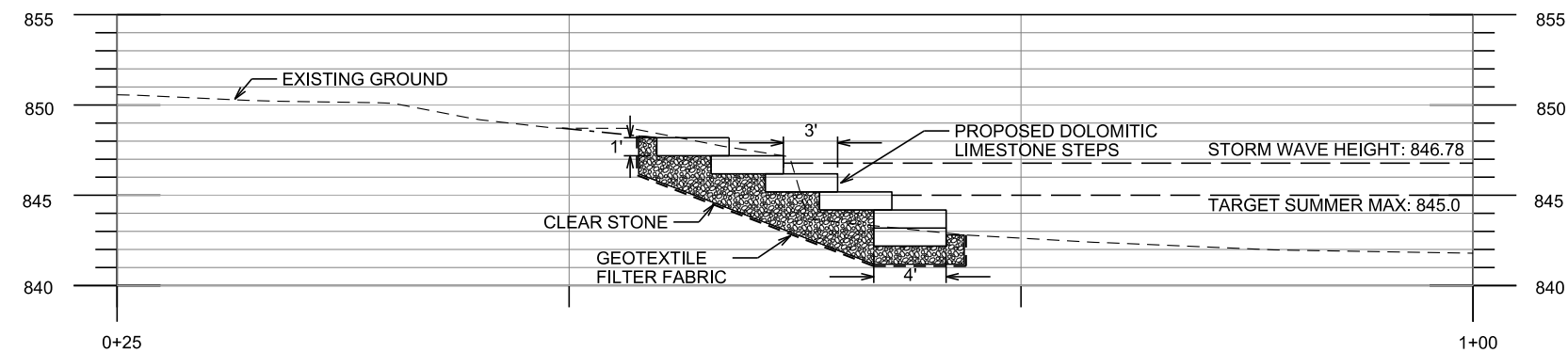

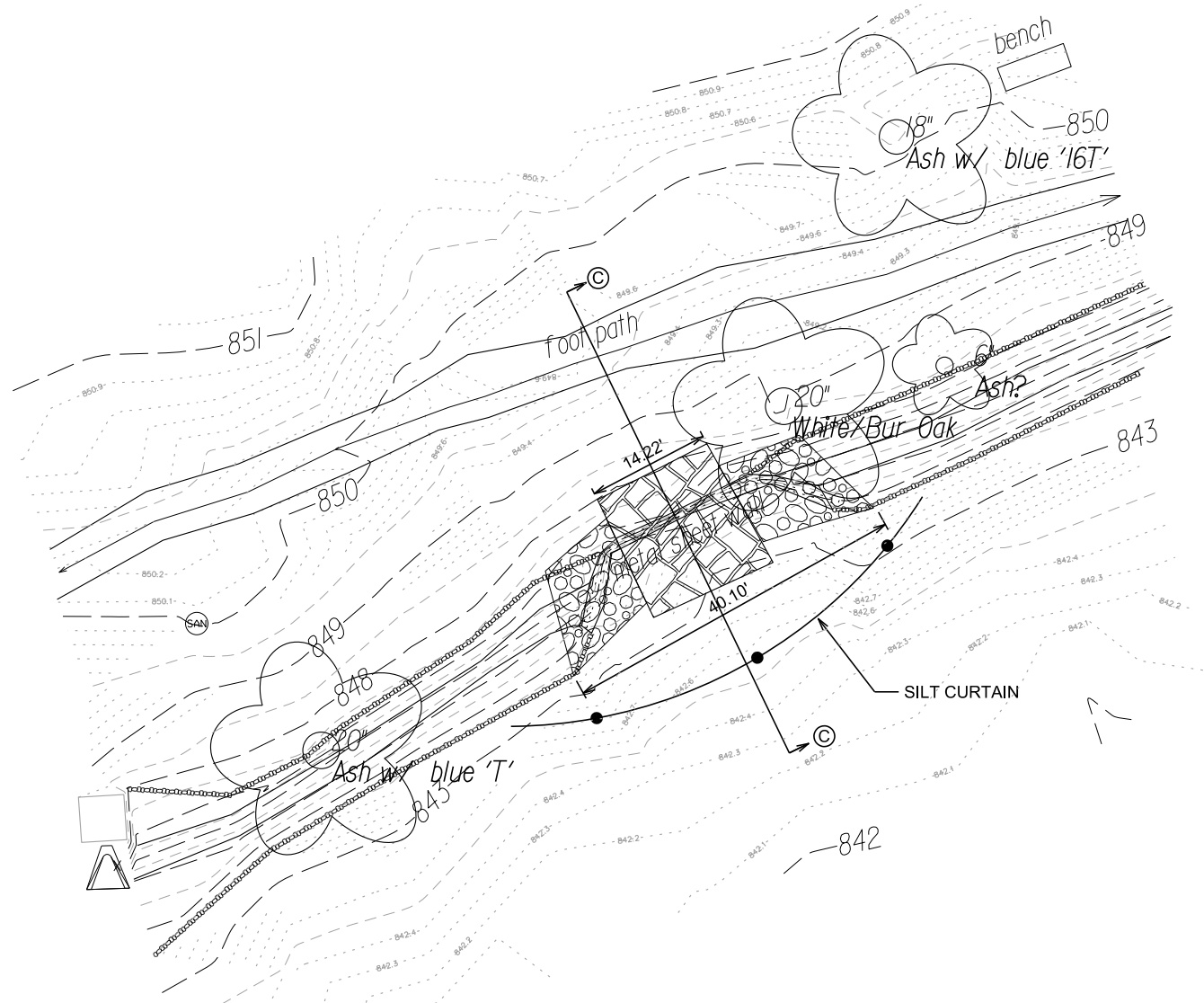

EROSION CONTROL NOTES:

- 1) PRIOR TO BEGINNING ANY EARTHWORK, THE CONTRACTOR SHALL INSTALL SILT CURTAIN PER WI DNR CONSERVATION PRACTICE STANDARD 1070.
- 2) ALL DISTURBED AREAS SHALL BE TOPSOILED, SEEDED WITH TERRACE SEED MIX, AND STABILIZED WITH EROSION CONTROL MATTING, CLASS I, URBAN TYPE A.
- 3) SILT FENCE OR SILT SOCK SHALL BE INSTALLED AS DIRECTED AND THAT THE DISCRETION OF THE CONSTRUCTION ENGINEER.
- 4) TEMPORARY POLYMER STABILIZATION SHALL BE PLACED AS DIRECTED BY THE CONSTRUCTION ENGINEER.
- 5) SILT FENCE SHALL BE PLACED DOWNSTREAM OF ALL STOCKPILE AREAS
- 6) THE PROJECT SITE SHALL BE INSPECTED WITHIN 24 HOURS OF A RAINFALL EXCEEDING 0.5" AND WEEKLY.

SECTION C-C: SCHURZ AVENUE SHEET PILING

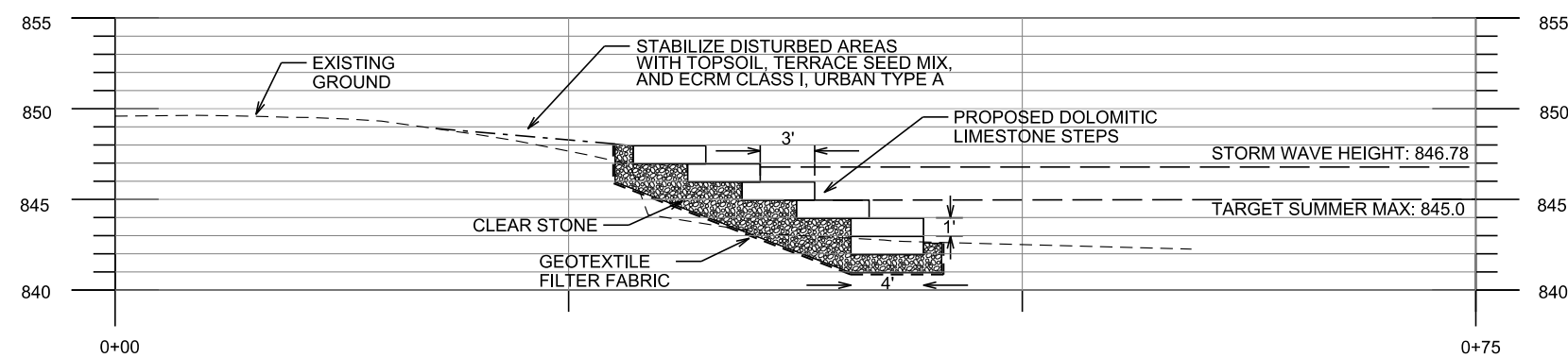

PLOT SCALE: _____

PLOT NAME: _____

REV. DATE: _____

ORIGINATOR: CITY OF MADISON, STREETS DIVISION