

BPW 6/20/2012 Handout

The plan is to open the gates located at the Jerome Street and Bainbridge Street intersections of E. Coldspring Avenue during the remainder of the 2012 Monona Drive reconstruction project and also during the 2013 Monona Drive reconstruction project. Monona Drive has been reduced to a two lane undivided roadway during construction and left turning movements can't be accommodated during construction. Currently the gates are closed during the weekday hours. Opening of the gates will allow for better traffic circulation during the reconstruction process.

The project currently underway is expected to be completed by October 31, 2012. The 2013 project includes Monona Drive from Winnequah Road to Pflaum Road is expected to start March 18, 2013 and run through November 15, 2013.

We are aware of the neighborhood concerns for safety with increased volume of traffic. As part of this proposal staff will work with both the City of Madison and City of Monona Police Departments to patrol and enforce traffic laws. The Monona Grove School District will educate their staff and students about these concerns and stress the importance of safe and courteous vehicle operation.

Attachment A: email opposing, 204 E. Winnequah Road

Attachment B: email opposing, 4211 Jerome Street

Attachment C: email supporting, 112 E. Dean Avenue

Attachment D: email opposing, 4208 Jerome Street

Attachment E: email from Madison Police Captain Schauf

Attachment F: letter supporting, Monona Grove High School Superintendent

Attachment G: traffic counts prior and post trial closure (2005)

Attachment H: 2010 traffic counts

Additional info: Monona Grove High School has 311 parking stalls. 150 stalls are assigned to students. Approximately 60% of the students live in Cottage Grove. School starts at 7:55 am and ends at 3:13 pm.

:

Bachmann, Christy

From: Kaya Freiman [kayafreiman@gmail.com]
Sent: Wednesday, June 20, 2012 3:04 PM
To: Bachmann, Christy
Cc: Palm, Larry; Jacklyn Da Walt
Subject: Opposition to opening Jerome and Bainbridge gates on Coldspring Ave.

Dear Christy,

I received your public meeting notice just one week prior to the scheduled meeting, which I wish would have been sent earlier to allow enough time for discussion and ample time for people to work around busy schedules in order to attend.

I am opposed to opening the gates on Coldspring Ave. I believe the city acted prudently when the gates were installed and that opening of gates will be a danger to pedestrians in the neighborhood.

I have concerns for increased traffic, particularly during high-traffic periods near Frank Allis School during drop-off and pick-up times. Additionally, cars are often parked on one side of Jerome near Frank Allis, which narrows the road and I believe increased traffic would be dangerous for pedestrians.

As you know, we do not have sidewalks like Buckeye, Pflaum, Monona, and Cottage Grove roads do, and feel this increase in traffic during high-volume times will cause an undue burden for the many pedestrians and bicyclists that use our peaceful neighborhood streets.

Aside from the pedestrian concerns, I am concerned about noise, speeding Monona Grove commuters and potential damage to the chip-sealed roads, which I presume were not engineered for the same volume of traffic as Monona Drive, Pflaum and Buckeye.

If you must open gates, I strongly urge you to reconsider the gate opening at Jerome, to avoid potential dangers to elementary school children that walk across Jerome to get to school. Additionally, I believe radar enforcement on any roads would be a good idea.

Thank you for the opportunity to provide written comments regarding this issue. I sincerely hope the City will listen to residents' concerns and not open the gates.

Sincerely,

Kaya (and Michael) Freiman

Thanks for your consideration.

Bachmann, Christy

From: Nancy Lendborg [nklendborg@att.net]
Sent: Wednesday, June 13, 2012 8:18 AM
To: Bachmann, Christy; Tom Krajewski
Subject: Opening of Gates on E. Coldspring Avenue



Hi Christy,

I am contacting you in regard to the current plan to open the gate on E. Coldspring Ave. during the upcoming school year, as was suggested in the City Engineering Division letter mailed to us, dated 6/7/12. I wish to let you know of my continued concerns, and in doing so hope that advance positive planning may result.

My husband, Steve & I have lived at 4211 Jerome Street for nearly 16 years. In those years, we have experienced much abuse previous to having the gate installed, on the part of the MG students speeding recklessly and behaving disrespectfully toward our properties. There are many young families on our street with small children in danger. Jerome Street also has many life-long residents who are elderly. They also feel threatened.

In past history, notifying either the Madison police or the Monona police had been problematic because this street appears to be at a "boundary" that was, perhaps, confusing(?) for them or not worth their energy(?). I have been treated disrespectfully by the police, when reporting incidents/specific vehicles that chronically speed, throw objects, or behave dangerously and as though Jerome Street is a "free for all". This is unacceptable. I dread this recurrence to start up again, as we all have the right to feel safe.

While I can truly accept that the gate should be kept open during off-school times, such as during the summer months, I am feeling quite tentative toward having this gate open through the upcoming school year. I need to understand specifically how the two police departments will work together to insure that Jerome Street will remain safe for all its residents.

Thank you,

Nancy K. Lendborg

Bachmann, Christy

Subject: RE: Online Contact the Mayor Submission

From: patsyeo1@tds.net [mailto:patsyeo1@tds.net]

Sent: Friday, May 11, 2012 1:03 PM

To: Mayor

Subject: Online Contact the Mayor Submission

Name: Pat Reuter
Address: 112 E Dean Avenue
Address 2:
City: Madison
State: WI
Zip Code: 53716
Home Phone:
Work Phone:
Cell Phone:
Email: patsyeo1@tds.net

Message:

Mayor Soglin, I am writing in regard to the street gates in the Coldspring Avenue location of east Madison. Ald. Larry Palm shared an email regarding the City Engineer requesting the gates be opened due to the Monona Drive construction & subsequent traffic issues. I sent him an email expressing the hope that at least one gate be opened. He noted in his initial e-mail that a proposal to open these gates will be on a Board of Public Works agenda on June 6 sponsored by you since the City Attorney's office has now determined that changes to the gate's time can be made on an administrative basis. I know he and others in that area are opposed to it. I strongly support opening at least the gate at the end of Coldspring. I live on East Dean Avenue and the traffic has become horrible. I sometimes have a hard time getting out of my driveway. I don't believe they even considered the impact on the East Dean Avenue residents by wanting to keep their gates closed. I am writing to you directly in hopes you will decide to open at least the one gate. Thank you.

Bachmann, Christy

Subject: RE: Online Contact the Mayor Submission

From: krajewskit@gmail.com [mailto:krajewskit@gmail.com]

Sent: Thursday, June 14, 2012 11:09 AM

To: Mayor

Subject: Online Contact the Mayor Submission

Name: Tom Krajewski

Address: 4208 Jerome St

Address 2:

City: Madison

State: WI

Zip Code: 53716

Home Phone: 608-222-6304

Work Phone: 608-222-6304

Cell Phone:

Email: krajewskit@gmail.com

Message:

What we did not have a chance to talk about Monday night - Monona Drive Reconstruction Dear Mayor Soglin, The purpose of this letter is to request your consideration for residents of Jerome Street and Lakeview St. as the city considers opening the traffic diverters on Jerome and Coldspring St. As a result of conversations with Christine Bachman of City Engineering, I have learned that the purpose of opening the diverters is to provide some relief for construction workers and provide additional options to residents and the students and teachers at Monona Grove High School. Ms. Bachman appears to understand that opening the diverters would not provide an additional viable option for Monona Drive traffic. The few people from the neighborhood that would use Coldspring if the diverters were open simply will not make a meaningful difference on the traffic count on Monona Drive. Residents on Jerome, Lakeview, Bainbridge and Winnequah are legitimately concerned about the high speed traffic from the school. The traffic diverters were not our preferred option but they have eliminated about 90% of the problems. These streets are not built for high speed traffic. They have a significant number children, walkers, and bikers. Lake View is on the Lake Monona Bike Trail. At the north end of Jerome around a blind corner is Frank Allis elementary school. MGHS students use Jerome and Bainbridge Streets for band practice and athletic warmups. Residents fear for their children and others before, during, open campus and after school hours, and before, during, after athletic events, and practices and special events. Now Monona Grove High School is adding insult to injury. As you may know Monona Grove School District has owned two vacant residential properties in the City of Madison on the south end of Jerome Street for more than 20 years. The school district pays no taxes on these properties. Over the years MG school district has deprived Madison taxpayers of an estimated 150,000. In addition the houses are not maintained, in disrepair and a blight on the neighborhood. Monona Grove High School is now cutting brush on the school grounds and transporting it to 4217 Jerome St, the property they own but do not pay taxes on in the City of Madison, so the City of Madison will pick up and remove this debris. I expect that a number of neighborhood residents will be understandably outraged when they learn this. They will likely be even more opposed to opening the traffic diverters to accommodate Monona Grove High School. As you may be aware, the opening of the traffic diverters is scheduled for discussion before the Board of Public Works on June 20th. I hope that we can come to a better resolution. Tom Krajewski 4208 Jerome St. Madison, WI 53716-1656

Bachmann, Christy

Subject: FW: Opening of Gates on E. Coldspring Avenue

From: Schauf, Mary
Sent: Friday, June 15, 2012 2:46 PM
To: Bachmann, Christy
Subject: RE: Opening of Gates on E. Coldspring Avenue

Nancy,

I have discussed the neighborhood traffic concerns with Christy Bachmann of the Engineering Team, as well as Monona Chief of Police Walter Ostrenga. We are committed to addressing the traffic concerns as resources allow. Please ask the neighbors to share specific concerns while this project is underway, and we will provide extra patrol services as time permits.

Mary A Schauf, Captain of Police
Madison Police Department | East District
809 S Thompson Dr | Madison WI 53716
608.267.2100 | mschauf@cityofmadison.com



Monona Grove School District

"Promoting Excellence for Global Opportunities"

5301 Monona Drive • Monona, WI 53716-3199

Phone: 608-221-7660 • Fax: 608-221-7688

www.mononagrove.org

June 7, 2012

Christy Bachman, P.E.
City of Madison Department of Public Works and Transportation
210 Martin Luther King Jr. Boulevard
Madison, WI 53703

Dear Ms. Bachman:

I am writing to express my support for the opening of the roadway gates at the intersection of Coldspring Avenue and Bainbridge Street, adjacent to our high school. I request that the gates remain open through the construction of the Monona Drive Phase II (Winnequah Road to Cottage Grove Road) until October 30, 2012. In addition, I also support that these gates be opened during the entire 2013 construction season of Monona Drive Phase III (Nichols Road to Winnequah Road), which is proposed to run from March 18, 2013 through November 15, 2013.

I am making this request to ensure the health and safety of our students and staff. The road construction has significantly increased traffic congestion around our high school and opening the gates described above will help mitigate the problem.

I will ensure that the Monona Grove School District communicates with our students, families and our faculty the need for increased caution and safety as they be allowed to drive within these surrounding neighborhoods.

If you have additional questions or concerns, please do not hesitate to contact me at my office at 221-7660 x-325.

Thank you for your attention with this matter.

Respectfully,

Craig Gerlach
Superintendent

cc: Kenneth Swanson, P.E., Strand Associates, Inc
Daniel Stephany, Director of Public Works – City of Monona
Pam Dunphy, P.E., Assistant Commissioner
Dane County Department of Public Works, Highway and Transportation
Paul Brost, Monona Grove High School Principal
Mark Scullion, Director of Facilities & Safety – Monona Grove School District

From 2005 Study

Coldspring Av Diverters

Proposed Locations For Permanent Closure

Trial 2

COLDSPRING DUAL DIVERTERS TRIAL
BEFORE (9/04) AND AFTER (9/05)
VOLUME AND SPEED DATA



DRAFTED BY: BWW 9/28/05
SK5004_BDDCN

WINNEQUAH RD

Volume	Speed (85 percentile)
Before 280	29 mph
After 390	31 mph

JEROME ST

Volume	Speed (85 percentile)
Before 420	29 mph
After 420	29 mph

JEROME ST

E WINNEQUAH RD

Volume	Speed (85 percentile)
Before 110	29 mph
After 220	29 mph

MONONA DR

JEROME ST

JEROME ST

Volume	Speed (85 percentile)
Before 760	32 mph
After 160	28 mph

Barricade

E COLDSPRING AVE

200 BLOCK OF DEAN AVE

Volume	Speed (85 percentile)
Before 1840	32 mph
After 1990	36 mph



Barricade

COLDSPRING AVE

Volume	Speed (85 percentile)
Before 850	30 mph
After 310	22 mph

BANBRIDGE ST

LAKEVIEW AVE

Volume	Speed (85 percentile)
Before 950	29 mph
After 510	29 mph

BUCKEYE RD

E LAKEVIEW AVE

5

2010 AVERAGE WEEKDAY TRAFFIC

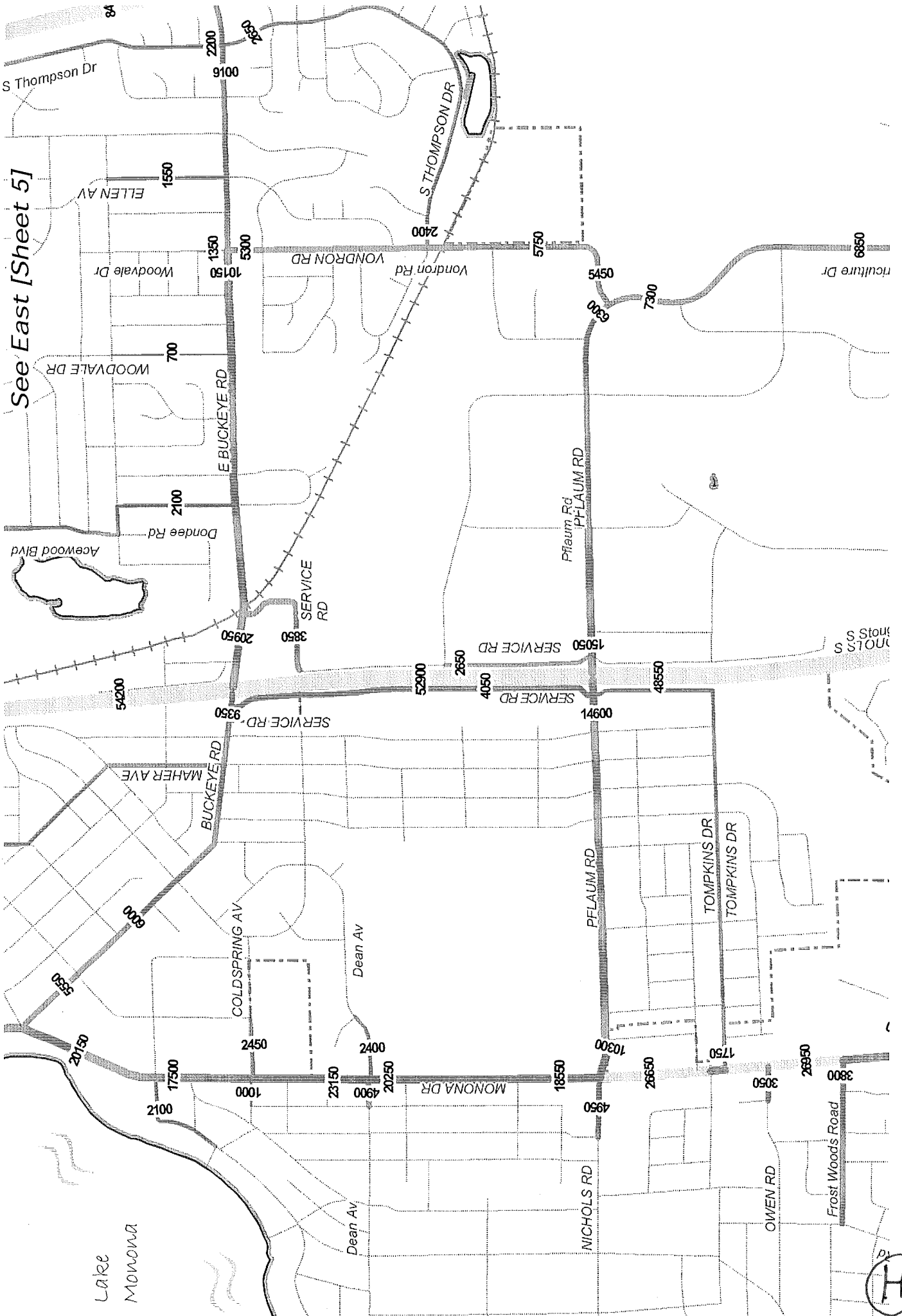

See East [Sheet 5]

Lake Monona

